

BEHRINGER HARVARD MCK LND LP.
DOC. NO. 0524480
D.R.C.C.T

OAKWOOD VILLAGE APARTMENTS INC.
DOC. NO. 20130109000037660
D.R.C.C.T

12.8179 ACRES
FAIRWAY MEADOWS ADDITION
CABINET 2012, SLIDE 379

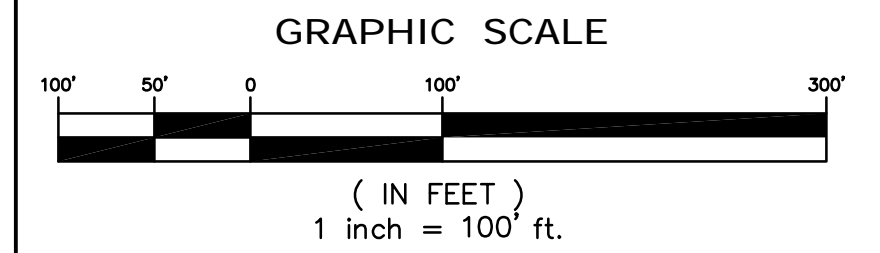
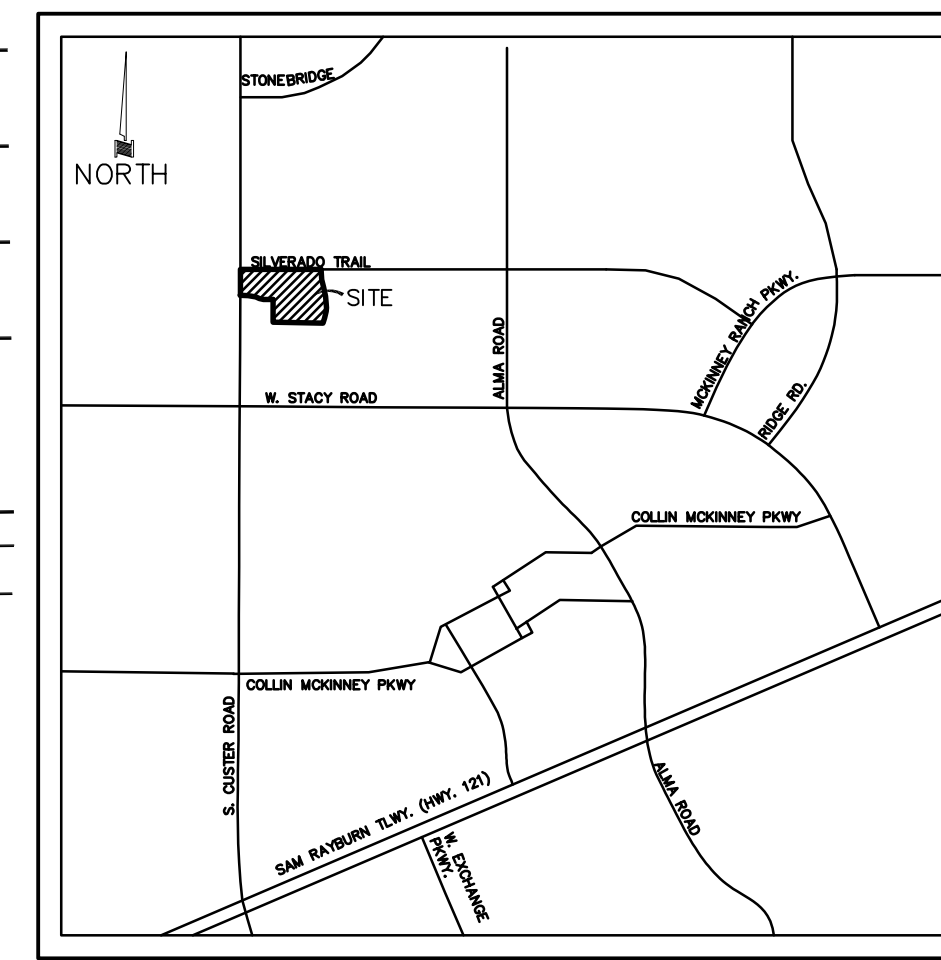

LOCATION MAP
NOT TO SCALE

- GENERAL NOTES:
- 1) ALL COMMON AREAS WILL BE OWNED AND MAINTAINED BY THE HOMEOWNER'S ASSOCIATION.
 - 2) ALL PROPOSED LOTS ARE LOCATED WITHIN THE CITY'S CORPORATE LIMITS, WITH THE MINIMUM SIZE REQUIREMENTS OF THE GOVERNING ZONING DISTRICT.
 - 3) OFFSITE DRAINAGE CHANNELS AND SWALES (DEDICATED BY SEPARATE INSTRUMENT) USED TO SERVE THIS PROPERTY, SHALL BE PERPETUALLY MAINTAINED BY THE H.O.A.
 - 4) TREE SURVEY TO BE PROVIDED AT ENGINEERING PLAN SUBMITTAL.
 - 5) FULLY DEVELOPED FLOODPLAIN AND EROSION HAZARD SETBACK TO BE DETERMINED AT TIME OF FINAL ENGINEERING ESTABLISHED FROM A MORE DETAILED TOPOGRAPHIC SURVEY.
 - 6) RETAINING WALLS AND CREEK STABILITY MAY BE REQUIRED FOR ILL ADJACENT TO ROWLETT CREEK.

TREE SURVEY NOTE

DEVELOPER SHALL PROVIDE A DETAILED TREE SURVEY PRIOR TO THE SUBMITTAL OF THE ENGINEERING CONSTRUCTION PLANS. THE TREE SURVEY SHALL MEET ALL REQUIREMENTS OUTLINED BY THE CITY OF MCKINNEY. IF ACCEPTABLE TO CITY STAFF, TREES NOT IMPACTED BY DEVELOPMENT OR USED FOR CREDITS SHALL NOT BE INCLUDED ON THE TREE SURVEY.

DEVELOPER ACKNOWLEDGES THAT POSTPONING THE TREE SURVEY COULD REDUCE THE TOTAL RESIDENTIAL LOT COUNT, AS SHOWN ON THE PRELIMINARY-FINAL PLAT, IF SPECIMEN TREES ARE LOCATED ON OR NEAR THE GRADING LIMITS OF THE LOTS. NO GRADE CHANGES ALLOWED WITHIN THE LIMITS OF THE PRIMARY ROOT ZONE.

**13-234PF
PRELIMINARY-FINAL PLAT
CREEKSIDE AT SILVERADO**

142 RESIDENTIAL LOTS
1 COMMERCIAL LOT
2 COMMON AREA LOTS
39.229 ACRES

AN ADDITION TO THE CITY OF MCKINNEY
GEORGE WHITE SURVEY, ABST NO. 993
COLLIN COUNTY, TEXAS

OCTOBER 2013 SCALE: 1"=100'

OWNER	DEVELOPER
MCKINNEY SEVEN STACY LP LONDON DEVELOPMENT CO. LLC.	4050 W. PARK BLVD.
6850 TPC DRIVE, SUITE 104	PLANO, TX 75093
MCKINNEY, TX 75070	972-529-5700
972-529-5700	214-619-2930

CONTACT: DAVID CRAIG CONTACT: JOHN LONDON

ENGINEER/SURVEYOR
DOWDEY, ANDERSON & ASSOCIATES, INC.
5225 Village Creek Drive, Suite 200 Plano, Texas 75093 972-931-0694
STATE REGISTRATION NUMBER: F-399
CONTACT : MICHAEL DOWDEY P.E.

LEGEND

- CA = COMMON AREA
- BL = BUILDING LINE
- SSE = SANITARY SEWER EASEMENT
- PAE = PEDESTRIAN ACCESS EASEMENT
- WE = WATER EASEMENT
- DE = DRAINAGE EASEMENT
- HOA = HOME OWNERS ASSOCIATION
- IRF = IRON ROD FOUND
- UE = UTILITY EASEMENT
- VE = VISIBILITY EASEMENT
- <CM> = CONTROL MONUMENT
- M.R.C.C.T. = MAP RECORDS, COLLIN COUNTY, TEXAS
- D.R.C.C.T. = DEED RECORDS, COLLIN COUNTY, TEXAS
- CCF = COUNTY CLERK'S FILE NUMBER
- ⊙_{IR} = 5/8" IRON ROD FOUND
- ⊙_{RS} = 5/8" IRON ROD SET
- ◇ = DENOTES STREET NAME CHANGE

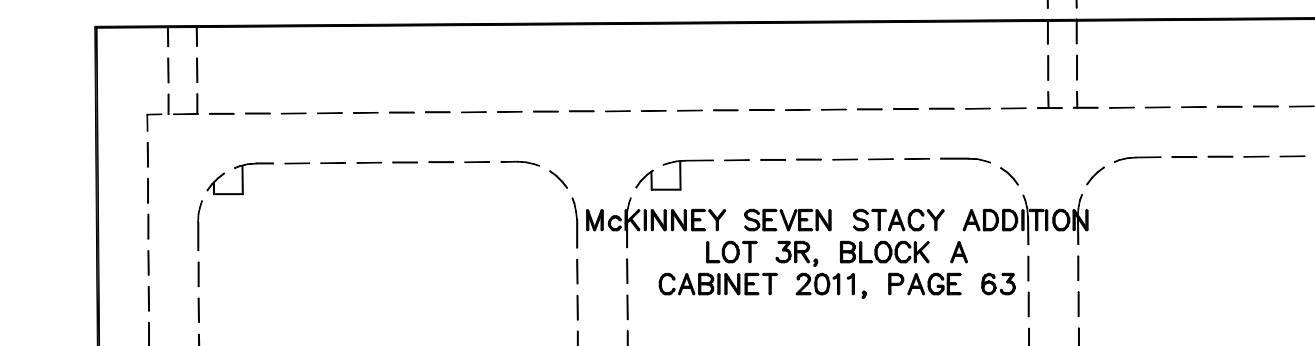

"PRELIMINARY-FINAL PLAT FOR REVIEW PURPOSES ONLY"

RECEIVED
By Kathy Wright at 3:03 pm, Nov 25, 2013

DOWDEY, ANDERSON & ASSOCIATES, INC.

FIELD NOTE DESCRIPTION

BEING a tract of land situated in the GEORGE WHITE SURVEY, ABSTRACT NUMBER 993, City of McKinney, Collin County, Texas and being a portion of that 108.412 acre tract of land described in a deed to McKinney Seven Stacy, LP according to the Document No. 20061215001772490, Deed Records, Collin County, Texas and being more particularly described as follows:

BEGINNING at a point for the intersection of the approximate centerline of Rowlett Creek with the approximate centerline of Silverado Trail, a variable width right-of-way; THENCE Southerly, with said approximate centerline of Rowlett Creek, the following nine (9) courses and distances:

South 01 degrees 49 minutes 15 seconds West, a distance of 173.46 feet to a point for corner;

South 13 degrees 53 minutes 10 seconds East, a distance of 81.82 feet to a point for corner;

South 29 degrees 10 minutes 14 seconds East, a distance of 155.76 feet to a point for corner;

South 17 degrees 42 minutes 01 seconds East, a distance of 153.75 feet to a point for corner;

South 09 degrees 14 minutes 44 seconds East, a distance of 174.74 feet to a point for corner;

South 03 degrees 13 minutes 54 seconds East, a distance of 136.67 feet to a point for corner;

South 28 degrees 56 minutes 35 seconds West, a distance of 202.47 feet to a point for corner;

South 30 degrees 34 minutes 44 seconds West, a distance of 101.32 feet to a point for corner;

South 13 degrees 02 minutes 16 seconds West, a distance of 22.60 feet to a point for corner;

THENCE South 89 degrees 33 minutes 08 seconds West, leaving said approximate center line of Rowlett Creek, a distance of 1,078.22 feet to a point for corner;

THENCE North 00 degrees 24 minutes 00 seconds West, a distance of 373.96 feet to a point for corner;

THENCE South 89 degrees 21 minutes 40 seconds West, a distance 113.42 to a point for corner at the beginning of a curve to the right having a central angle of 10 degrees 17 minutes 11 seconds, a radius of 525.00 feet and a chord bearing and distance of North 85 degrees 29 minutes 44 seconds West, 94.13 feet;

THENCE Westerly, with said curve to the right, an arc distance of 94.25 feet to a point for corner;

THENCE North 80 degrees 21 minutes 09 seconds West, a distance of 127.42 feet to a point for corner at the beginning of a curve to the left having a central angle of 10 degrees 10 minutes 33 seconds, a radius of 475.00 feet and a chord bearing and distance of North 85 degrees 26 minutes 25 seconds West, 84.25 feet;

THENCE Westerly, with said curve to the left, an arc distance of 84.36 feet to a point for corner;

THENCE South 89 degrees 28 minutes 18 seconds West, a distance of 161.02 feet to a point for corner in the east line of Custer Road, a 120 foot right-of-way;

THENCE North 00 degrees 23 minutes 43 seconds West, with said east line, a distance of 686.63 to a point for corner in the above mentioned approximate centerline of Silverado Trail,

THENCE Easterly, leaving said east line and with said approximate centerline of Silverado trail, the following five (5) courses and distances:

North 89 degrees 21 minutes 19 seconds East, a distance of 382.11 feet to a point for corner at the beginning of a curve to the left having a central angle of 07 minutes 15 minutes 02 seconds, a radius of 850.00 feet and a chord bearing and distance of North 85 degrees 43 minutes 48 seconds East, 107.49 feet;

Northerly, with said curve to the left, an arc distance of 107.56 feet to a point for corner;

North 82 degrees 06 minutes 17 seconds East, a distance of 82.39 feet to point for corner at the beginning of a curve to the right having a central angle of 07 minutes 45 minutes 46 seconds, a radius of 984.83 feet and a chord bearing and distance of North 84 degrees 53 minutes 12 seconds East, 133.38 feet;

Easterly, with said curve to the right, an arc distance of 133.48 to a point for corner;

North 89 degrees 22 minutes 29 seconds East, a distance of 941.77 feet to the POINT OF BEGINNING and containing 39.230 acres of land, more or less.

SURVEYORS CERTIFICATE

KNOW ALL MEN BY THESE PRESENTS:

That I, Sean Patton, do hereby certify that I prepared this plat and the field notes made a part thereof from an actual and accurate survey of the land and that the corner monuments shown thereon were property placed under my personal supervision, in accordance with the Subdivision Regulations of the City of McKinney, Texas.

"PRELIMINARY - FOR REVIEW ONLY"

SEAN PATTON
Registered Professional Land Surveyor No. 5660

STATE OF TEXAS §
COUNTY OF COLLIN §

BEFORE ME, the undersigned, a Notary Public in and for the State of Texas on this day personally appeared Sean Patton, known to me to be the person whose name is subscribed to the foregoing instrument and acknowledged to me that he executed the same for the purpose and considerations therein expressed and in the capacity therein stated.

GIVEN under my hand and seal of office this _____ day of _____, 20____.

Notary Public in and for the State of Texas

LOT LINE TABLE		
LINE	BEARING	LENGTH
T1	N44°28'50"E	14.17'
T2	S39°19'26"W	15.33'
T3	N46°50'06"W	13.84'
T4	S45°31'10"E	14.11'
T5	S44°28'50"W	14.17'
T6	N45°31'10"W	14.11'
T7	S50°28'14"E	15.28'
T8	S61°11'50"W	13.70'
T9	S31°50'16"E	15.27'
T10	S59°46'41"W	17.36'
T11	N45°31'10"W	14.11'
T12	N44°28'50"E	14.17'
T13	N45°24'00"W	14.14'
T14	N44°36'00"E	14.14'
T15	S45°24'00"E	14.14'
T16	S44°36'00"W	14.14'
T17	N45°25'26"W	14.14'
T18	S15°39'00"E	20.07'
T19	N72°03'22"W	35.48'
T20	S5°46'08"W	88.97'

LOT LINE TABLE		
LINE	BEARING	LENGTH
T27	N89°28'18"E	161.02'
T28	S80°21'09"E	127.42'
T29	N89°21'40"E	113.42'

LOT CURVE TABLE					
CURVE	DELTA	RADIUS	TANGENT	LENGTH	CHORD
C1	1°39'28"	475.00'	6.87'	13.74'	N76°16'44"E 13.74'
C3	12°33'31"	500.00'	55.02'	109.60'	N84°21'34"W 109.38'
C5	26°28'10"	500.00'	117.59'	230.99'	N88°41'06"E 228.94'
C7	13°54'38"	500.00'	61.00'	121.39'	S82°24'21"W 121.09'
C9	90°14'20"	45.00'	45.19'	70.87'	N45°31'10"W 63.77'
C11	80°20'13"	45.00'	37.99'	63.10'	N50°28'14"W 58.05'
C13	12°05'27"	500.00'	52.95'	105.51'	S83°18'56"W 105.32'
C15	16°42'53"	500.00'	73.45'	145.86'	N85°37'39"E 145.35'
C17	4°37'26"	500.00'	20.19'	40.35'	N88°19'37"W 40.34'
C19	8°36'43"	500.00'	37.65'	75.15'	N86°05'39"W 75.08'
C21	20°47'13"	400.00'	73.37'	145.12'	N87°49'06"E 144.33'
C23	12°10'30"	500.00'	53.32'	106.25'	S83°30'45"W 106.05'
C25	18°20'38"	250.00'	40.37'	80.04'	N81°13'41"W 79.70'
C27	12°10'29"	250.00'	26.66'	53.12'	S11°51'23"W 53.02'
C29	28°34'31"	250.00'	63.67'	124.68'	N20°03'24"E 123.40'
C31	55°12'29"	31.50'	16.47'	30.35'	N61°56'54"E 29.19'
C33	28°14'45"	250.00'	62.90'	123.25'	N3°49'15"E 122.00'
C35	28°34'31"	250.00'	63.67'	124.68'	N20°03'24"E 123.40'
C37	11°47'33"	400.00'	41.31'	82.33'	S83°39'22"W 82.18'
C39	11°47'33"	400.00'	41.31'	82.33'	N83°39'22"E 82.18'

LOT CURVE TABLE					
CURVE	DELTA	RADIUS	TANGENT	LENGTH	CHORD
C41	90°02'52"	45.00'	45.04'	70.72'	S45°25'26"E 63.67'
C43	101°7'11"	495.00'	44.55'	88.87'	S85°29'44"E 88.75'
C45	101°0'33"	505.00'	44.96'	89.69'	N85°26'25"W 89.57'
C47	163°30'03"	50.00'	344.86'	142.68'	S44°28'50"W 98.97'
C49	163°47'15"	50.00'	351.04'	142.93'	S45°25'26"E 99.00'
C51	55°12'26"	56.50'	29.54'	54.44'	N61°56'53"E 52.36'
C53	80°20'13"	31.50'	26.59'	44.17'	N50°28'14"W 40.64'
C55	163°58'43"	50.00'	355.29'	143.10'	N45°31'10"W 99.02'
C57	89°45'40"	45.00'	44.81'	70.50'	S44°28'50"W 63.51'
C61	71°5'02"	850.00'	53.85'	107.56'	N85°43'48"E 107.49'
C63	7°45'56"	984.83'	66.84'	133.48'	S84°53'12"W 133.38'
C65	101°7'11"	525.00'	47.25'	94.25'	S85°29'44"E 94.13'
C67	101°0'33"	475.00'	42.29'	84.36'	N85°26'25"W 84.25'
C73	101°7'11"	465.00'	41.85'	83.48'	S85°29'44"E 83.37'
C75	12°16'51"	262.00'	28.19'	56.16'	N84°23'16"W 56.05'
C77	2°06'18"	238.00'	4.37'	8.74'	S79°18'00"E 8.74'
C79	7°14'22"	901.35'	57.02'	113.89'	N85°43'48"E 113.81'

LOT AREA TABLE				
LOT	BLOCK	AREA (SF)	AREA (AC)	
1	B	6268	0.14	
2	B	5755	0.13	
3	B	5707	0.13	
4	B	5567	0.13	
5	B	5385	0.12	
6	B	5268	0.12	
7	B	5200	0.12	
8	B	5123	0.12	
9	B	5056	0.12	
10	B	5073	0.12	
11	B	5096	0.12	
12	B	5057	0.12	
13	B	5633	0.13	
14	B	5623	0.13	
15	B	5015	0.12	
16	B	5056	0.12	
17	B	5071	0.12	
18	B	5078	0.12	
19	B	5165	0.12	
20	B	5242	0.12	

LOT AREA TABLE				
LOT	BLOCK	AREA (SF)	AREA (AC)	
21	B	5304	0.12	
22	B	5399	0.12	
23	B	5561	0.13	
24	B	5676	0.13	
25	B	5729	0.13	
26	B	6281	0.14	

LOT AREA TABLE				
LOT	BLOCK	AREA (SF)	AREA (AC)	
1	C	5434	0.12	
2	C	5027	0.12	
3	C	5238	0.12	
4	C	5038	0.12	
5	C	5038	0.12	
6	C	5103	0.12	
7	C	5140	0.12	
8	C	5155	0.12	
9	C	5105	0.12	
10	C	5121	0.12	
11	C	5148	0.12	
12	C	5149	0.12	
13	C	5128	0.12	
14	C	5127	0.12	
15	C	5127	0.12	
16	C	6332	0.15	
17	C	6505	0.15	
18	C	5126	0.12	
19	C	5063	0.12	
20	C	5052	0.12	

LOT AREA TABLE				
LOT	BLOCK	AREA (SF)	AREA (AC)	
21	C	5052	0.12	
22	C	5504	0.13	
23	C	5443	0.12	
24	C	5507	0.13	
25	C	5408	0.12	
26	C	5786	0.13	
27	C	5530	0.13	
28	C	5289	0.12	
29	C	5142	0.12	
30	C	5201	0.12	
31	C	5072	0.12	
32	C	5414	0.12	

LOT AREA TABLE				
LOT	BLOCK	AREA (SF)	AREA (AC)	
1	A	5459	0.13	
2	A	5000	0.11	
3	A	5000	0.11	
4	A	5000	0.11	
5	A	5000	0.11	
6	A	5000	0.11	
7	A	5000	0.11	
8	A	5000	0.11	
9	A	5133	0.12	
10	A	5813	0.13	
11	A	9483	0.22	
12	A	6262	0.14	
13	A	5273	0.12	
14	A	5032	0.12	
15	A	5253	0.12	
16	A	5710	0.13	
17	A	6256	0.14	
18	A	6513	0.15	
19	A	6370	0.15	
20	A	6102	0.14	

LOT AREA TABLE				
LOT	BLOCK	AREA (SF)	AREA (AC)	
21	A	5701	0.13	
22	A	5553	0.13	

LOT AREA TABLE				
LOT	BLOCK	AREA (SF)	AREA (AC)	
1	D	5950	0.14	
2	D	5600	0.13	
3	D	5780	0.13	
4	D	5450	0.13	
5	D	5722	0.13	
6	D	5671	0.13	
7	D	5494	0.13	
8	D	5308	0.12	
9	D	5215	0.12	
10	D	5158	0.12	
11	D	5152	0.12	
12	D	5206	0.12	
13	D	5374	0.12	
14	D	5599	0.13	
15	D	5706	0.13	
16	D	5707	0.13	
17	D	5706	0.13	
18	D	7849	0.18	
19	D	8827	0.20	
20	D	5935	0.14	

LOT AREA TABLE				
LOT	BLOCK	AREA (SF)	AREA (AC)	
21	D	5928	0.14	
22	D	5859	0.13	
23	D	5655	0.13	
24	D	5429	0.12	
25	D	5364	0.12	
26	D	5399	0.12	
27	D	5468	0.13	
28	D	5528	0.13	
29	D	5693	0.13	
30	D	5866	0.13	
31	D	5958	0.14	

LOT AREA TABLE				
LOT	BLOCK	AREA (SF)	AREA (AC)	
1	E	5441	0.12	
2	E	5000	0.11	
3	E	5000	0.11	
4	E	5105	0.12	
5	E	6132	0.14	
6	E	12030	0.28	
7	E	5581	0.13	
8	E	5000	0.11	
9	E	5000	0.11	
10	E	5000	0.11	
11	E	5		