

Module #2

Module Type	Total Acres (Excluding Flood Plain)	Vacant Acres (Excluding Flood Plain)	Uses	Developed and/or Zoned Acres	Minimum	Maximum	Base Percentage	Low %	High %	Acres Remaining to Reach Min.	Acres Remaining to Reach Max
Community Village	62.0562	57.14	Retail	18.60	21.72	34.13	45%	35%	55%	3.12	15.53
			Office - Urban	0.00	6.21	12.41	15%	10%	20%	6.21	12.41
			Medium Density Res.	0.00	6.21	12.41	15%	10%	20%	6.21	12.41
			Single Family Res.	8.40	3.10	9.31	10%	5%	15%	-5.30	0.91
			Entertainment	0.00	3.10	6.21	5%	5%	10%	3.10	6.21
			Mixed Use	0.00	0.00	12.41	0%	0%	20%	0.00	12.41
			Community Facilities	0.00	3.10	9.31	10%	5%	15%	3.10	9.31
			Other	0.00							

	Existing Zoning as of 03/24/04	Proposed Zoning of Clark Tract as of 12/31/12							
Retail	0.00	18.60							
Office - Urban	0.00								
Medium Density Res.	0.00								
Single Family Res.	0.00	8.40							
Entertainment	0.00								
Mixed Use	0.00								
Community Facilities	0.00								
Other	0.00								

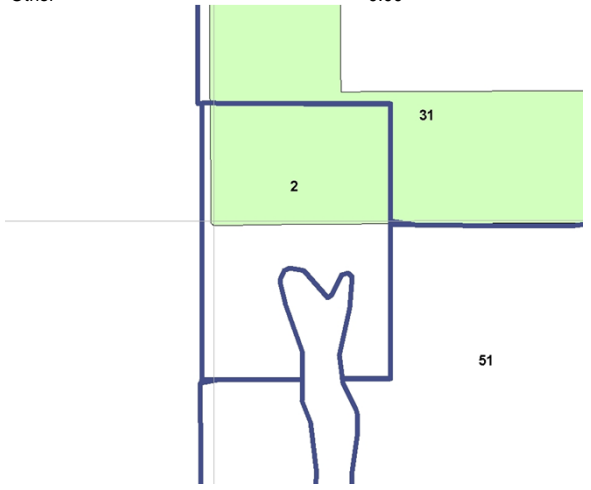

Module #51

Module Type	Total Acres (Excluding Flood Plain)	Vacant Acres (Excluding Flood Plain)	Uses	Developed and/or Zoned Acres	Minimum	Maximum	Base Percentage	Low %	High %	Acres Remaining to Reach Min.	Acres Remaining to Reach Max
Suburban Mix	1902.6399	1423.88	Single Family Res.	1,141.86	1,046.45	1,426.98	65%	55%	75%	-95.41	285.12
			Medium Density Res.	24.06	95.13	190.26	10%	5%	10%	71.07	166.20
			Office - Neighborhood	0.00	0.00	190.26	5%	0%	10%	0.00	190.26
			Retail - Neighborhood	72.85	95.13	190.26	5%	5%	10%	22.28	117.41
			Community Services	372.37	285.40	380.53	15%	15%	20%	-86.97	8.16
			Other	80.80							-80.80

	Existing Zoning and developed as of 03/24/04	Billingsley Rezone April 6, 2004	1.27 acre Wade tract	Southern Land 42.69 acres	Billingsley Rezone July 2012	Proposed Zoning of Clark Tract as of 12/31/12					
Single Family Res.	648.54	415.93	0.00	42.69	5.00	29.70					
Medium Density Res.	14.96	14.10	0.00	0.00	-5.00						
Office - Neighborhood	109.00	-109.00	0.00	0.00	0.00						
Retail - Neighborhood	78.28	-6.70	1.27	0.00	0.00						
Community Services	252.47	119.90	0.00	0.00	0.00						
Other	97.38	-16.58	0.00	0.00	0.00						

