

VICINITY MAP
NTS

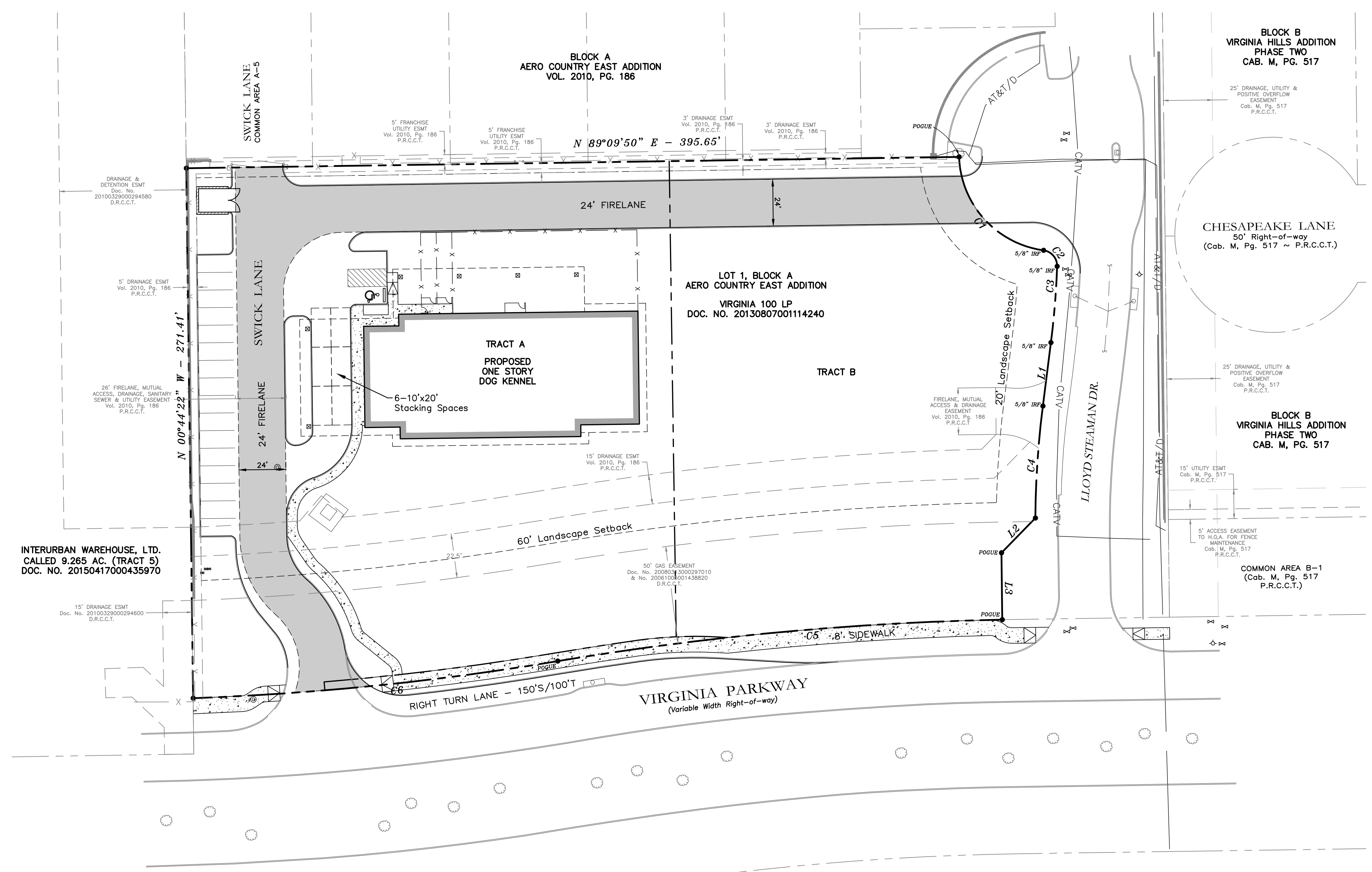
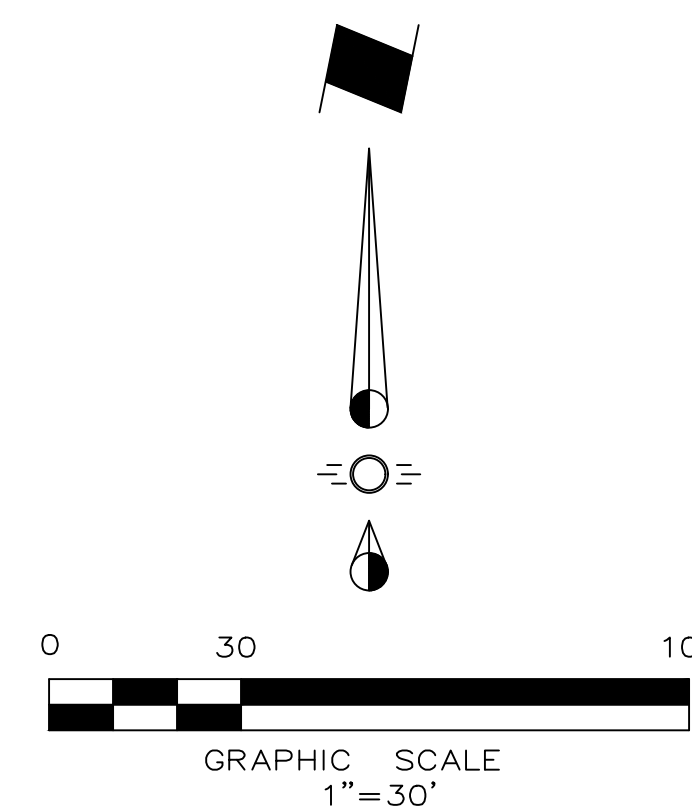

INTERURBAN WAREHOUSE, LTD.
CALLED 9.265 AC. (TRACT 5)
DOC. NO. 20150417000435970

15' DRAINAGE ESMT
Vol. 2010, Pg. 186
P.R.C.C.T.

25' FIRELANE, MUTUAL
ACCESS, DRAINAGE, SANITARY
SEWER & UTILITY EASEMENT
Vol. 2010, Pg. 186
P.R.C.C.T.

DRAINAGE &
DETENTION ESMT
Doc. No. 2010032900294550
D.R.C.C.T.

5' DRAINAGE ESMT
Vol. 2010, Pg. 186
P.R.C.C.T.

5' FRANCHISE
UTILITY ESMT
Vol. 2010, Pg. 186
P.R.C.C.T.

5' FRANCHISE
UTILITY ESMT
Vol. 2010, Pg. 186
P.R.C.C.T.

3' DRAINAGE ESMT
Vol. 2010, Pg. 186
P.R.C.C.T.

3' DRAINAGE ESMT
Vol. 2010, Pg. 186
P.R.C.C.T.

BLOCK B
VIRGINIA HILLS ADDITION
PHASE TWO
CAB. M. PG. 517

25' DRAINAGE, UTILITY &
POSITIVE OVERFLOW
EASEMENT
Cab. M. Pg. 517
P.R.C.C.T.

CHESAPEAKE LANE
50' Right-of-way
(Cab. M. Pg. 517 ~ P.R.C.C.T.)

25' DRAINAGE, UTILITY &
POSITIVE OVERFLOW
EASEMENT
Cab. M. Pg. 517
P.R.C.C.T.

BLOCK B
VIRGINIA HILLS ADDITION
PHASE TWO
CAB. M. PG. 517

15' UTILITY ESMT
Cab. M. Pg. 517
P.R.C.C.T.

5' ACCESS EASEMENT
TO H.O.A. FOR FENCE
MAINTENANCE
Cab. M. Pg. 517
P.R.C.C.T.

COMMON AREA B-1
(Cab. M. Pg. 517
P.R.C.C.T.)

50' GAS EASEMENT
Doc. No. 2008610000297010
& No. 2008100001438820
D.R.C.C.T.

BLOCK A
FAIRWAYS NORTH AT
WESTRIDGE

LINE TABLE:

LINE	BEARING	DISTANCE
L1	S 07°15'45" W	32.77'
L2	S 44°20'06" W	24.88'
L3	S 00°39'54" E	34.24'

CURVE TABLE:

CURVE	DELTA ANGLE	RADIUS	ARC LENGTH	CHORD BEARING	CHORD LENGTH
C1	80°18'59"	50.00'	70.09'	S 42°08'19" E	64.49'
C2	84°13'50"	8.00'	11.76'	S 40°09'34" E	10.73'
C3	5°17'12"	425.00'	39.21'	S 04°37'09" W	39.20'
C4	8°56'15"	475.00'	57.52'	S 03°47'42" W	57.48'
C5	8°24'03"	1560.00'	228.73'	S 84°40'01" W	228.53'
C6	7°28'14"	1440.00'	187.75'	S 84°12'06" W	187.62'

CITY BENCHMARK:

COM-38 = Aluminum Disc in concrete at the Southwest corner of Virginia Parkway and Peregrine Drive. Elev. = 740.77

SITE BENCHMARK:

BM-1 = 'X' in northeast corner of concrete curb inlet on the north side of Virginia Parkway, 145± east of the west drive entrance to the subject property. Elev. = 764.31

BM-2 = 'X' in southwest corner of concrete curb inlet on the west side of the eastern drive entrance to the subject property and 181± north of Virginia Parkway. Elev. = 767.1

NOTE: THIS IS NOT A CONSTRUCTION DOCUMENT.
THIS DOCUMENT IS FOR CONCEPTUAL PLANNING PURPOSES ONLY.

Issue Dates:	Revision & Date:
1	1
2	2
3	3
4	4
5	5
6	6

CROSS ENGINEERING CONSULTANTS
1720 W. Virginia Street
972.562.4409
McKinney, Texas 75069
Texas P.E. Firm No. F-5935

Drawn By: C.E.C.I.
Checked By: C.E.C.I.
Scale: 1"=30'

CONCEPTUAL SITE PLAN
Sheet No. CSP
Project No. 22034

UNDERDOG KENNELS
LOT 1, BLOCK A
AERO COUNTRY EAST ADDITION
McKINNEY, TEXAS

ENGINEER:
Cross Engineering Consultants, Inc.
1720 W. Virginia Street
McKinney, Texas 75069
Phone (972) 562-4409
Fax (972) 562-4471
Contact: Jon David Cross, P.E.

ARCHITECT:
Hidell Associates Architects
3033 Kellway Drive, Suite 120
Carrollton, Texas 75006
Phone (972) 416-4666
Email ababcock@hidell.com
Contact: Aaron Babcock

SURVEYOR:
Ringley & Associates
701 S. Tennessee St.
McKinney, TX, 75069
Phone (972) 542-1266
Fax (972) 542-8682
Contact: Lawrence Ringley

UNDERDOG KENNELS