

**COOPERATIVE SERVICE AGREEMENT
NORTH TEXAS MUNICIPAL WATER DISTRICT
NORTH COLLIN WATER SUPPLY CORPORATION
CITY OF MCKINNEY**

THE STATE OF TEXAS §
 §
THE COUNTY OF COLLIN §

THIS CONTRACT (the "Contract") made and entered into as of this the _____ day of _____, 2013 (the "Effective Date"), by and between the North Texas Municipal Water District, hereinafter called "NTMWD," a conservation and reclamation district created under Article 16, Section 59, of the Texas Constitution, the North Collin Water Supply Corporation ("North Collin"), a nonprofit water supply corporation in the State of Texas, and the City of McKinney ("McKinney"), a home-rule municipality and political subdivision of the State of Texas, also all each referred to as a "Party," or collectively, the "Parties."

W I T N E S S E T H :

WHEREAS, NTMWD, North Collin, and McKinney are authorized to enter into this Contract pursuant to Chapter 62, Acts of the 52nd Legislature, 1951 (Article 8280-141, Vernon's Texas Civil Statutes) and other applicable laws;

WHEREAS, pursuant to a Potable Water Supply Contract dated June 22, 1995, and amended on August 27, 1998 ("Customer Contract"), North Collin purchases treated water from NTMWD;

WHEREAS, McKinney is a member city of NTMWD and purchases treated water from NTMWD pursuant to the NTMWD Regional Water Supply Facilities Amendatory Contract dated August 1, 1988 ("Regional Contract");

WHEREAS, a new development, Trinity Falls, is proposed within the retail water service area of both McKinney and North Collin, as identified in Exhibit A and described by metes and bounds in Exhibits B-1, B-2, B-3, and B-4 (collectively, "Trinity Falls");

WHEREAS, McKinney intends to provide retail water service to Trinity Falls on a long-term basis, but the initial water demands of Trinity Falls make it infeasible for McKinney to initially provide retail water service;

WHEREAS, McKinney has requested that North Collin provide retail water service on a temporary basis until Trinity Falls has sufficient water demands for McKinney's infrastructure to provide retail water service to Trinity Falls;

WHEREAS, in order to accommodate the Trinity Falls developer, North Collin is currently providing water to one or more contractors performing construction work at Trinity Falls through construction meters;

WHEREAS, North Collin agrees to continue to provide temporary retail water service for the construction of the Trinity Falls development and to subsequently provide water service to Trinity Falls as

long as providing this quantity of water on a temporary basis does not permanently increase North Collin's annual minimum quantity of water under its Customer Contract;

NOW, THEREFORE, in consideration of the mutual covenants and agreements herein contained, the sufficiency of which are hereby conclusively acknowledged, and subject to the terms and conditions hereinafter set forth, NTMWD, McKinney, and North Collin mutually undertake, promise, and agree as follows:

AGREEMENT

Section 1. **TEMPORARY SERVICE FOR TRINITY FALLS.** During the term of this Contract, North Collin agrees to continue to provide retail water service for the construction of the Trinity Falls development and to Trinity Falls until such time that Trinity Falls has an adequate water demand ("Water Demand") sufficient to support the construction of a new twenty-four inch (24") pipeline (the "Pipeline") through which McKinney will provide retail water service to Trinity Falls. Once Water Demand is sufficient to support construction of the Pipeline, and upon completion of construction of such Pipeline, North Collin will cease providing retail water service to Trinity Falls and McKinney shall become the sole provider of retail water service to Trinity Falls.

Section 2. **TRINITY FALLS DELIVERY POINT AND METER.** North Collin will deliver water to Trinity Falls via a pipeline to a delivery point and metering station owned and operated by McKinney (the "Trinity Falls Delivery Point and Meter"). North Collin will continue to allow contractors that are performing construction work at Trinity Falls to take water from North Collin's water system by way of construction meters dedicated to that construction project (the "Construction Delivery Point and Meter"). Exhibit C attached hereto identifies the location of the Construction Delivery Point and Meter and the Trinity Falls Delivery Point and Meter. At such time as the Trinity Falls Delivery Point and Meter is established, the contractors performing construction work at Trinity Falls will take water from the Trinity Falls side of the Trinity Falls Delivery Point and Meter, will cease taking water from the Construction Delivery Point and Meter, and the Construction Delivery Point and Meter shall no longer be used for the delivery of water. McKinney agrees to read the Trinity Falls meter on a monthly basis and promptly provide NTMWD with the monthly readings of the quantity of water provided to contractors for the construction of the Trinity Falls development or to Trinity Falls ("Trinity Falls Quantity"). In addition to the forgoing, the Trinity Falls Quantity will include all water delivered through the Construction Delivery Point and Meter by North Collin to the contractor(s) constructing the Trinity Falls project including but not limited to water delivered through the Construction Delivery Point and Meter prior to the Effective Date of this Contract. North Collin will provide satisfactory evidence to McKinney and the NTMWD of the quantity of such water.

Section 3. **TRINITY FALLS QUANTITY.** Beginning October 1, 2013, NTMWD will deduct the Trinity Falls Quantity from North Collin's monthly quantity of water supplied by NTMWD to North Collin pursuant to the Customer Contract and then add the Trinity Falls Quantity to McKinney's monthly quantity of water supplied by NTMWD to McKinney pursuant to the Regional Contract. The parties agree that North Collin's annual minimum as discussed in Section 8 of the Customer Contract shall not be increased by the Trinity Falls Quantity and that such quantity shall only increase McKinney's annual minimum as provided in Section 9 of the Regional Contract.

Section 4. **TERM OF CONTRACT.** This Contract shall commence on the Contract Date and shall terminate upon the earlier of following: (i) five (5) years following the Contract Date; or (ii) McKinney's commencement of retail water service to Trinity Falls. Upon the mutual agreement of the Parties, this Contract may be renewed for one (1) additional term of five years.

Section 5. MODIFICATION. This Contract may be changed or modified only by written agreement of the Parties and only after having obtained approval from the governing bodies of all the Parties.

Section 6. FORCE MAJEURE. If by reason of force majeure any Party hereto shall be rendered unable wholly or in part to carry out its obligations under this Contract, other than the obligations of McKinney and North Collin to make the payments required under the Regional Contract and Customer Contract, then if such Party shall give notice and full particulars of such force majeure in writing to the other Party within a reasonable time after occurrence of the event or cause relied on, the obligation of the Party giving such notice, so far as it is affected by such force majeure, shall be suspended during the continuance of the inability then claimed, but for no longer period, and any such Party shall endeavor to remove or overcome such inability with all reasonable dispatch. The term "force majeure" as employed herein shall mean acts of God, strikes, lockouts, or other industrial disturbances, acts of public enemy, orders of any kind of the Government of the United States or the State of Texas, or any civil or military authority, insurrection, riots, epidemics, landslides, lightning, earthquake, fires, hurricanes, storms, floods, washouts, droughts, arrests, restraint of government and people, civil disturbances, explosions, breakage or accidents to machinery, pipelines or canals, partial or entire failure of water supply, or on account of any other causes not reasonably within the control of the Party claiming such inability.

Section 7. REGULATORY BODIES AND LAWS. This Contract is subject to all applicable Federal and State Laws and any applicable permits, ordinances, rules, orders, and regulations of any local, state or federal governmental authority having or asserting jurisdiction, but nothing contained herein shall be construed as a waiver of any right to question or contest any such law, ordinance, order, rule, or regulation in any forum, having jurisdiction.

Section 8. NOTICES. Unless otherwise provided herein, any notice, communication, request, reply, or advice (herein severally and collectively, for convenience, called "Notice") herein provided or permitted to be given, made, or accepted by any Party to any other Party must be in writing and may be given or be served by depositing the same in the United States mail postpaid and registered or certified and addressed to the Party to be notified, with return receipt requested, or by delivering the same to an officer of such Party, or by prepaid telegram when appropriate, addressed to the Party to be notified. Notice deposited in the mail in the manner hereinabove described shall be conclusively deemed to be effective, unless otherwise stated herein, from and after the expiration of three (3) days after it is so deposited. Notice given in any other manner shall be effective only if and when received by the Party to be notified. For the purposes of Notice, the addresses of the Parties shall, until changed as hereinafter provided, be as follows:

If to NTMWD, to:

North Texas Municipal Water District
Attn: Executive Director/General Manager
P.O. Box 2408
Wylie, Texas 75098

If to McKinney, to:

City of McKinney, Texas
Attn: City Manager
P.O. Box 512
McKinney, Texas 75069

Copy to: Attn: City Attorney
 Mark Houser
 Brown & Hofmeister
 740 East Campbell Road, Suite 800
 Richardson, Texas 75081
 E-mail: mhouser@bhlaw.net
 Fax: (214) 747-6111

If to North Collin, to:

North Collin Water Supply Corporation
Attn: System Administrator
P.O. Box 343
2333 Sam Rayburn Hwy.
Melissa, Texas 75454-0343

Copy to: John Rapier, Attorney
 Rapier, Wilson & Wendland, P.C.
 1333 W. McDermott, Suite 100
 Allen, Texas 75213
 E-mail: rapier@rapierwilson.com
 Fax: (972) 727-9904

The Parties hereto shall have the right from time to time and at any time to change their respective addresses and each shall have the right to specify as its address any other address by at least fifteen (15) days written notice to the other Parties hereto.

Section 9. SEVERABILITY. The Parties hereto specifically agree that in case any one or more of the sections, subsections, provisions, clauses, or words of this Contract or the application of such sections, subsections, provisions, clauses, or words to any situation or circumstance should be, or should be held to be, for any reason, invalid or unconstitutional, under the laws or constitutions of the State of Texas or the United States of America, or in contravention of any such laws or constitutions, such invalidity, unconstitutionality, or contravention shall not affect any other sections, subsections, provisions, clauses, or words of this Contract or the application of such sections, subsections, provisions, clauses, or words to any other situation or circumstance, and it is intended that this Contract shall be severable and shall be construed and applied as if any such invalid or unconstitutional section, subsection, provision, clause, or word had not been included herein, and the rights and obligations of the Parties hereto shall be construed and remain in force accordingly.

Section 10. VENUE. All amounts due under this Contract including, but not limited to, payments due under this Contract or damages for the breach of this Contract, shall be paid and be due in Collin County, Texas, which is the County in which the principal administrative offices of NTMWD are located. It is specifically agreed among the Parties to this Contract that Collin County, Texas, is a principal place of performance of this Contract.

Section 11. SOLE AGREEMENT. This Contract constitutes the sole and only agreement of NTMWD, McKinney, and North Collin and supersedes any prior understanding or oral or written agreements between NTMWD, McKinney, and North Collin with respect to the subject matter of this Contract.

Section 12. NO THIRD PARTY BENEFICIARIES. This Contract shall inure only to the benefit of the Parties hereto and third persons not privy hereto shall not, in any form or manner, be considered a third-party beneficiary of this Contract. Each Party hereto shall be solely responsible for the fulfillment of its customer contracts or commitments, and NTMWD shall not be construed to be responsible for McKinney's or North Collin's contracts or commitments by virtue of this Contract or any provision contained herein.

Section 13. SUCCESSION AND ASSIGNMENT. This Contract is binding upon and shall inure to the benefit of the Parties, their heirs, successors and assigns. This Contract may not be assigned by any Party hereto without the prior written notice to, and prior written approval by, the other Parties, which consent may be withheld without cause.

Section 14. RECITALS AND EXHIBITS INCORPORATED. The recitals contained in the preamble hereof and the exhibits hereto are hereby found to be true, and such recitals and exhibits are hereby made a part of this Contract for all purposes.

Section 15. AUTHORITY TO EXECUTE. Each person signing on behalf of the Parties hereby confirms that they have the authority to execute this Contract on behalf of the Party indicated by their signature.

IN WITNESS WHEREOF, the Parties hereto acting under authority of their respective governing bodies have caused this Contract to be duly executed in several counterparts, each of which shall constitute an original, all as of the day and year first above written, which is the Effective Date of this Contract.

(Signatures on following pages)

NORTH COLLIN WATER SUPPLY CORPORATION

By: _____
Duke Monson, President Date

ATTEST:

_____, _____

STATE OF TEXAS §
 §
COUNTY OF COLLIN §

This instrument was acknowledged before me on this _____ day of _____, 2013, by Duke Monson, President of North Collin Water Supply Corporation, a nonprofit water supply corporation in the State of Texas, on behalf of said nonprofit water supply corporation.

Notary Public, State of Texas
Printed Name of Notary:

My Commission Expires: _____

CITY OF MCKINNEY

By: _____
Jason Gray, City Manager Date

ATTEST:

Sandy Hart, City Secretary

STATE OF TEXAS §
 §
COUNTY OF COLLIN §

This instrument was acknowledged before me on this _____ day of _____, 2013, by Jason Gray, City Manager of the City of McKinney, a home-rule municipality and political subdivision of the State of Texas, on behalf of said municipality.

Notary Public, State of Texas
Printed Name of Notary:

My Commission Expires: _____

NORTH TEXAS MUNICIPAL WATER DISTRICT

By: _____
Bill Lofland, President _____
Date

ATTEST:

Joe Joplin, Secretary

STATE OF TEXAS §
 §
COUNTY OF COLLIN §

This instrument was acknowledged before me on this _____ day of _____, 2013, by Bill Lofland, President of North Texas Municipal Water District, a conservation and reclamation district and political subdivision of the State of Texas, on behalf of said conservation and reclamation district.

Notary Public, State of Texas
Printed Name of Notary:

My Commission Expires: _____

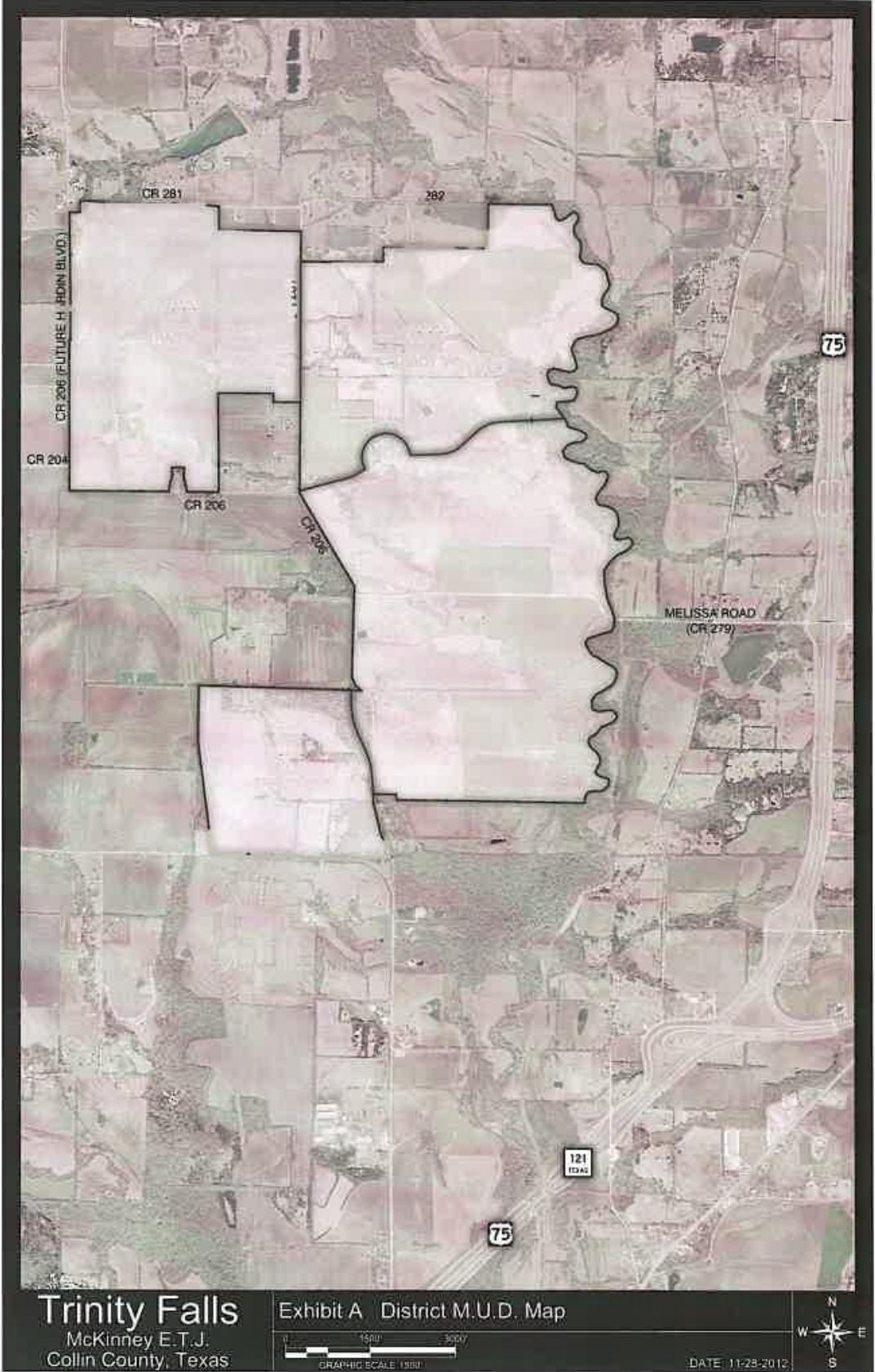

Exhibit B-1
Legal Description
673.759 acres
(MUD 1/TRACT A)

BEING A 673.759 ACRE TRACT OF LAND SITUATED IN THE THOMAS BRUCE SURVEY, ABSTRACT NO. 103, THE JOHN EMBERSON SURVEY, ABSTRACT NO. 294 AND THE THOMAS LINDSAY SURVEY, ABSTRACT NO. 521, COLLIN COUNTY, TEXAS, AND BEING PART OF A CALLED 1113.084 ACRE TRACT OF LAND CONVEYED TO MA BB OWEN, LP, BY DEED RECORDED IN COUNTY CLERK'S FILE NO. 20060616000829800, OFFICIAL PUBLIC RECORDS, COLLIN COUNTY, TEXAS, AND BEING PART OF A CALLED 182.711 ACRE TRACT OF LAND CONVEYED AS "TRACT 1", AND BEING ALL OF A CALLED 0.469 ACRE TRACT OF LAND CONVEYED AS "TRACT 2" TO MA-BBO FIVE, LP, BY DEED RECORDED IN COUNTY CLERK'S FILE NO. 20060918001344730, OFFICIAL PUBLIC RECORDS, COLLIN COUNTY, TEXAS, AND BEING PART OF A CALLED 26.423 ACRE TRACT OF LAND CONVEYED AS "TRACT 1", AND BEING PART OF A CALLED 0.653 ACRE TRACT OF LAND CONVEYED AS "TRACT 2" TO MA-BBO FIVE, LP, BY DEED RECORDED IN COUNTY CLERK'S FILE NO. 20060918001344720, OFFICIAL PUBLIC RECORD, COLLIN COUNTY, TEXAS, SAID 673.759 ACRE TRACT, WITH BEARING BASIS BEING GRID NORTH, TEXAS STATE PLANE COORDINATES, NORTH CENTRAL ZONE, NAD83 (CORS), DETERMINED BY GPS OBSERVATIONS ON JULIAN DAY 320, 2005, CALCULATED FROM DENTON CORS ARP (PID-DF8986), ARLINGTON RRP2 CORS ARP (PID-DF 5387) AND COLLIN CORS ARP (PID-8982), AND BEING MORE PARTICULARLY DESCRIBED BY METES AND BOUNDS AS FOLLOWS:

BEGINNING AT A 3/8 INCH IRON ROD FOUND FOR AN OUTSIDE ELL CORNER OF SAID 1113.084 ACRE TRACT AND BEING THE SOUTHEAST CORNER OF A CALLED 1 ACRE TRACT OF LAND CONVEYED AS "TRACT 2" TO PROVINCE RES ESTATE HOLDING BY DEED RECORDED IN COUNTY CLERK'S FILE NO. 2002-0005148, LAND RECORDS, COLLIN COUNTY, TEXAS, SAME BEING ON THE NORTH LINE OF A CALLED 57 ACRE TRACT OF LAND CONVEYED AS "TRACT 1" TO PROVINCE RES ESTATE HOLDING BY DEED RECORDED IN COUNTY CLERK'S FILE NO. 2002-0005148, LAND RECORDS, COLLIN COUNTY, TEXAS;

THENCE, NORTH 06 DEGREES 29 MINUTES 28 SECONDS WEST, ALONG A WEST LINE OF SAID 1113.084 ACRE TRACT AND THE COMMON EAST LINE OF AFORESAID 1 ACRE TRACT A DISTANCE OF 105.30 FEET TO A 3/8 INCH IRON ROD FOUND FOR AN INSIDE ELL CORNER OF SAID 1113.084 ACRE TRACT AND BEING THE NORTHEAST CORNER OF SAID 1 ACRE TRACT;

THENCE, NORTH 89 DEGREES 19 MINUTES 40 SECONDS WEST, ALONG A SOUTH LINE OF SAID 1113.084 ACRE TRACT AND THE COMMON NORTH LINE OF AFORESAID 1 ACRE TRACT, PASSING AT A DISTANCE OF 381.99 FEET A 3/8 INCH IRON ROD FOUND FOR WITNESS, CONTINUING A TOTAL DISTANCE OF 408.28 FEET TO A POINT FOR A SOUTHWEST CORNER OF SAID 1113.084 ACRE TRACT AND THE NORTHWEST CORNER OF SAID 1 ACRE TRACT, SAID POINT ALSO BEING ON THE EAST LINE OF SAID 26.423 ACRE TRACT AND THE COMMON APPROXIMATE CENTERLINE OF COLLIN COUNTY ROAD NO. 206 (A VARIABLE WIDTH PRESCRIPTIVE RIGHT-OF-WAY);

THENCE, NORTH 00 DEGREES 34 MINUTES 35 SECONDS WEST, ALONG THE WEST LINE OF SAID 1113.084 ACRE TRACT, THE EAST LINE OF SAID 26.423 ACRE TRACT AND THE

COMMON APPROXIMATE CENTERLINE OF AFORESAID COLLIN COUNTY ROAD NO. 206, A DISTANCE OF 41.52 FEET TO A POINT FOR CORNER;

THENCE, OVER AND ACROSS SAID 26.423 ACRE TRACT, SAID 0.653 ACRE TRACT AND SAID 182.711 ACRE TRACT, THE FOLLOWING COURSES AND DISTANCES:

NORTH 02 DEGREES 57 MINUTES 15 SECONDS WEST, A DISTANCE OF 237.94 FEET TO A POINT FOR CORNER AND THE BEGINNING OF A TANGENT CURVE TO THE LEFT HAVING A CENTRAL ANGLE OF 22 DEGREES 02 MINUTES 58 SECONDS, A RADIUS OF 1450.00 FEET, A LONG CHORD THAT BEARS, NORTH 13 DEGREES 58 MINUTES 44 SECONDS WEST, A DISTANCE OF 554.58 FEET;

ALONG SAID TANGENT CURVE TO THE LEFT, AN ARC DISTANCE OF 558.01 FEET TO A POINT FOR CORNER;

NORTH 25 DEGREES 00 MINUTES 13 SECONDS WEST, A DISTANCE OF 241.04 FEET TO A POINT FOR CORNER AND THE BEGINNING OF A TANGENT CURVE TO THE RIGHT HAVING A CENTRAL ANGLE OF 26 DEGREES 38 MINUTES 26 SECONDS, A RADIUS OF 1450.00 FEET, A LONG CHORD THAT BEARS, NORTH 11 DEGREES 41 MINUTES 00 SECONDS WEST, A DISTANCE OF 668.15 FEET;

ALONG SAID TANGENT CURVE TO THE RIGHT, AN ARC DISTANCE OF 674.20 FEET TO A POINT FOR CORNER;

NORTH 01 DEGREES 38 MINUTES 13 SECONDS EAST, A DISTANCE OF 160.00 FEET TO A POINT FOR CORNER ON THE NORTH LINE OF SAID 182.711 ACRE TRACT AND BEING ON THE SOUTH LINE OF A CALLED 361.66 ACRE TRACT OF LAND CONVEYED TO HERITAGE FARM TRUST BY DEED RECORDED IN COUNTY CLERK'S FILE NO. 98-0084317, LAND RECORDS, COLLIN COUNTY, TEXAS;

THENCE, SOUTH 88 DEGREES 16 MINUTES 45 SECONDS EAST, ALONG THE NORTH LINE OF AFORESAID 182.711 ACRE TRACT AND ALONG THE COMMON SOUTH LINE OF SAID 361.66 ACRE TRACT, A DISTANCE OF 172.26 FEET TO A PK NAIL SET ON THE WEST LINE OF AFORESAID 1113.084 ACRE TRACT AND THE APPROXIMATE CENTERLINE OF AFORESAID COLLIN COUNTY ROAD NO. 206;

THENCE, ALONG THE WEST LINE OF SAID 1113.084 ACRE TRACT AND THE APPROXIMATE CENTERLINE OF SAID COLLIN COUNTY ROAD NO. 206, THE FOLLOWING COURSES AND DISTANCES:

NORTH 47 DEGREES 40 MINUTES 01 SECONDS WEST, A DISTANCE OF 140.42 FEET TO A PK NAIL SET FOR CORNER;

NORTH 22 DEGREES 24 MINUTES 21 SECONDS WEST, A DISTANCE OF 161.50 FEET TO A PK NAIL SET FOR CORNER;

NORTH 01 DEGREES 38 MINUTES 13 SECONDS EAST, A DISTANCE OF 1615.59 FEET TO A 3/4 INCH IRON ROD FOUND FOR CORNER;

NORTH 30 DEGREES 25 MINUTES 03 SECONDS WEST, A DISTANCE OF 1907.40 FEET TO A PK NAIL SET FOR CORNER IN COLLIN COUNTY ROAD NO. 281 (A VARIABLE WIDTH PRESCRIPTIVE RIGHT-OF-WAY);

NORTH 88 DEGREES 57 MINUTES 17 SECONDS WEST, A DISTANCE OF 8.67 FEET TO A 1/2 INCH IRON ROD FOUND FOR CORNER IN THE APPROXIMATE CENTERLINE OF SAID COLLIN COUNTY ROAD NO. 281;

NORTH 00 DEGREES 31 MINUTES 40 SECONDS EAST, A DISTANCE OF 53.37 FEET TO A POINT FOR CORNER;

THENCE, OVER AND ACROSS SAID 1113.084 ACRE TRACT, THE FOLLOWING COURSES AND DISTANCES:

NORTH 75 DEGREES 20 MINUTES 45 SECONDS EAST, A DISTANCE OF 877.21 FEET TO A POINT FOR CORNER AND THE BEGINNING OF A TANGENT CURVE TO THE LEFT HAVING A CENTRAL ANGLE OF 17 DEGREES 46 MINUTES 00 SECONDS, A RADIUS OF 570.00 FEET, A LONG CHORD THAT BEARS, NORTH 66 DEGREES 27 MINUTES 46 SECONDS EAST, A DISTANCE OF 176.04 FEET,

ALONG SAID TANGENT CURVE TO THE LEFT, AN ARC DISTANCE OF 176.75 FEET TO A POINT FOR CORNER;

NORTH 57 DEGREES 34 MINUTES 46 SECONDS EAST, A DISTANCE OF 177.27 FEET TO A POINT FOR CORNER AND THE BEGINNING OF A NON-TANGENT CURVE TO THE RIGHT HAVING A CENTRAL ANGLE OF 202 DEGREES 43 MINUTES 24 SECONDS, A RADIUS OF 430.00 FEET, A LONG CHORD THAT BEARS, NORTH 72 DEGREES 56 MINUTES 30 SECONDS EAST, A DISTANCE OF 843.15 FEET;

ALONG SAID NON-TANGENT CURVE TO THE RIGHT, AN ARC DISTANCE OF 1521.42 FEET TO A POINT FOR CORNER;

NORTH 88 DEGREES 18 MINUTES 14 SECONDS EAST, A DISTANCE OF 536.71 FEET TO A POINT FOR CORNER AND THE BEGINNING OF A TANGENT CURVE TO THE LEFT HAVING A CENTRAL ANGLE OF 41 DEGREES 03 MINUTES 11 SECONDS, A RADIUS OF 570.00 FEET, A LONG CHORD THAT BEARS, NORTH 67 DEGREES 46 MINUTES 38 SECONDS EAST, A DISTANCE OF 399.73 FEET;

ALONG SAID TANGENT CURVE TO THE LEFT, AN ARC DISTANCE OF 408.41 FEET TO A POINT FOR CORNER;

NORTH 47 DEGREES 15 MINUTES 03 SECONDS EAST, A DISTANCE OF 379.74 FEET TO A POINT FOR CORNER AND THE BEGINNING OF A TANGENT CURVE TO THE RIGHT HAVING A CENTRAL ANGLE OF 39 DEGREES 50 MINUTES 38 SECONDS, A RADIUS OF 630.00 FEET, A LONG CHORD THAT BEARS, NORTH 67 DEGREES 10 MINUTES 22 SECONDS EAST, A DISTANCE OF 429.33 FEET;

ALONG SAID TANGENT CURVE TO THE RIGHT, AN ARC DISTANCE OF 438.11 FEET TO A POINT FOR CORNER;

NORTH 87 DEGREES 05 MINUTES 41 SECONDS EAST, A DISTANCE OF 1162.77 FEET TO A POINT FOR CORNER IN THE CENTERLINE OF THE EAST FORK OF THE TRINITY RIVER;

THENCE ALONG THE CENTERLINE OF AFORESAID EAST FORK OF THE TRINITY RIVER THE FOLLOWING COURSES AND DISTANCES:

SOUTH 38 DEGREES 12 MINUTES 58 SECONDS EAST, A DISTANCE OF 14.58 FEET TO A POINT FOR CORNER;

SOUTH 23 DEGREES 36 MINUTES 46 SECONDS EAST, A DISTANCE OF 152.22 FEET TO A POINT FOR CORNER;

SOUTH 73 DEGREES 18 MINUTES 32 SECONDS EAST, A DISTANCE OF 197.85 FEET TO A POINT FOR CORNER;

SOUTH 61 DEGREES 18 MINUTES 14 SECONDS EAST, A DISTANCE OF 140.67 FEET TO A POINT FOR CORNER;

SOUTH 06 DEGREES 50 MINUTES 35 SECONDS EAST, A DISTANCE OF 70.23 FEET TO A POINT FOR CORNER;

SOUTH 54 DEGREES 16 MINUTES 01 SECONDS WEST, A DISTANCE OF 128.08 FEET TO A POINT FOR CORNER;

SOUTH 88 DEGREES 46 MINUTES 36 SECONDS WEST, A DISTANCE OF 114.66 FEET TO A POINT FOR CORNER;

SOUTH 70 DEGREES 15 MINUTES 18 SECONDS WEST, A DISTANCE OF 121.85 FEET TO A POINT FOR CORNER;

SOUTH 40 DEGREES 45 MINUTES 34 SECONDS WEST, A DISTANCE OF 145.62 FEET TO A POINT FOR CORNER;

SOUTH 18 DEGREES 00 MINUTES 30 SECONDS EAST, A DISTANCE OF 129.56 FEET TO A POINT FOR CORNER;

SOUTH 65 DEGREES 18 MINUTES 02 SECONDS EAST, A DISTANCE OF 118.06 FEET TO A POINT FOR CORNER;

SOUTH 71 DEGREES 54 MINUTES 16 SECONDS EAST, A DISTANCE OF 144.48 FEET TO A POINT FOR CORNER;

SOUTH 83 DEGREES 52 MINUTES 48 SECONDS EAST, A DISTANCE OF 100.92 FEET TO A POINT FOR CORNER;

SOUTH 47 DEGREES 56 MINUTES 19 SECONDS EAST, A DISTANCE OF 156.94 FEET TO A POINT FOR CORNER;

SOUTH 67 DEGREES 38 MINUTES 56 SECONDS EAST, A DISTANCE OF 153.79 FEET TO A POINT FOR CORNER;

NORTH 61 DEGREES 13 MINUTES 24 SECONDS EAST, A DISTANCE OF 64.37 FEET TO A POINT FOR CORNER;

SOUTH 85 DEGREES 51 MINUTES 50 SECONDS EAST, A DISTANCE OF 65.53 FEET TO A POINT FOR CORNER;

SOUTH 41 DEGREES 34 MINUTES 58 SECONDS EAST, A DISTANCE OF 40.91 FEET TO A POINT FOR CORNER;

SOUTH 19 DEGREES 54 MINUTES 49 SECONDS EAST, A DISTANCE OF 29.69 FEET TO A POINT FOR CORNER;

SOUTH 06 DEGREES 11 MINUTES 20 SECONDS EAST, A DISTANCE OF 37.94 FEET TO A POINT FOR CORNER;

SOUTH 14 DEGREES 05 MINUTES 13 SECONDS WEST, A DISTANCE OF 62.62 FEET TO A POINT FOR CORNER;

SOUTH 24 DEGREES 25 MINUTES 18 SECONDS WEST, A DISTANCE OF 81.96 FEET TO A POINT FOR CORNER;

SOUTH 37 DEGREES 40 MINUTES 18 SECONDS WEST, A DISTANCE OF 234.69 FEET TO A POINT FOR CORNER;

SOUTH 18 DEGREES 54 MINUTES 14 SECONDS WEST, A DISTANCE OF 81.98 FEET TO A POINT FOR CORNER;

SOUTH 31 DEGREES 46 MINUTES 10 SECONDS EAST, A DISTANCE OF 104.64 FEET TO A POINT FOR CORNER;

SOUTH 56 DEGREES 34 MINUTES 36 SECONDS EAST, A DISTANCE OF 34.72 FEET TO A POINT FOR CORNER;

SOUTH 81 DEGREES 42 MINUTES 01 SECONDS EAST, A DISTANCE OF 110.27 FEET TO A POINT FOR CORNER;

SOUTH 67 DEGREES 09 MINUTES 59 SECONDS EAST, A DISTANCE OF 138.27 FEET TO A POINT FOR CORNER;

SOUTH 37 DEGREES 29 MINUTES 50 SECONDS EAST, A DISTANCE OF 105.30 FEET TO A POINT FOR CORNER;

SOUTH 13 DEGREES 20 MINUTES 33 SECONDS EAST, A DISTANCE OF 131.83 FEET TO A POINT FOR CORNER;

SOUTH 05 DEGREES 36 MINUTES 33 SECONDS WEST, A DISTANCE OF 102.37 FEET TO A POINT FOR CORNER;

SOUTH 33 DEGREES 06 MINUTES 41 SECONDS WEST, A DISTANCE OF 97.83 FEET TO A POINT FOR CORNER;

SOUTH 13 DEGREES 16 MINUTES 04 SECONDS WEST, A DISTANCE OF 92.57 FEET TO A POINT FOR CORNER;

SOUTH 30 DEGREES 25 MINUTES 24 SECONDS EAST, A DISTANCE OF 39.87 FEET TO A POINT FOR CORNER;

SOUTH 61 DEGREES 06 MINUTES 56 SECONDS EAST, A DISTANCE OF 33.44 FEET TO A POINT FOR CORNER;

SOUTH 73 DEGREES 18 MINUTES 22 SECONDS EAST, A DISTANCE OF 35.43 FEET TO A POINT FOR CORNER;

NORTH 76 DEGREES 47 MINUTES 02 SECONDS EAST, A DISTANCE OF 171.81 FEET TO A POINT FOR CORNER;

SOUTH 62 DEGREES 02 MINUTES 58 SECONDS EAST, A DISTANCE OF 64.49 FEET TO A POINT FOR CORNER;

SOUTH 22 DEGREES 03 MINUTES 32 SECONDS EAST, A DISTANCE OF 76.90 FEET TO A POINT FOR CORNER;

SOUTH 34 DEGREES 33 MINUTES 13 SECONDS WEST, A DISTANCE OF 85.11 FEET TO A POINT FOR CORNER;

SOUTH 48 DEGREES 39 MINUTES 03 SECONDS WEST, A DISTANCE OF 86.15 FEET TO A POINT FOR CORNER;

SOUTH 64 DEGREES 28 MINUTES 51 SECONDS WEST, A DISTANCE OF 59.05 FEET TO A POINT FOR CORNER;

SOUTH 64 DEGREES 31 MINUTES 40 SECONDS WEST, A DISTANCE OF 142.65 FEET TO A POINT FOR CORNER;

SOUTH 44 DEGREES 15 MINUTES 01 SECONDS WEST, A DISTANCE OF 173.52 FEET TO A POINT FOR CORNER;

SOUTH 34 DEGREES 24 MINUTES 08 SECONDS WEST, A DISTANCE OF 183.38 FEET TO A POINT FOR CORNER;

SOUTH 03 DEGREES 40 MINUTES 02 SECONDS EAST, A DISTANCE OF 250.79 FEET TO A POINT FOR CORNER;

SOUTH 09 DEGREES 55 MINUTES 21 SECONDS EAST, A DISTANCE OF 203.25 FEET TO A POINT FOR CORNER;

SOUTH 12 DEGREES 33 MINUTES 26 SECONDS EAST, A DISTANCE OF 84.94 FEET TO A POINT FOR CORNER;

SOUTH 23 DEGREES 50 MINUTES 50 SECONDS EAST, A DISTANCE OF 173.87 FEET TO A POINT FOR CORNER;

SOUTH 16 DEGREES 37 MINUTES 27 SECONDS EAST, A DISTANCE OF 153.46 FEET TO A POINT FOR CORNER;

SOUTH 02 DEGREES 31 MINUTES 58 SECONDS WEST, A DISTANCE OF 62.97 FEET TO A POINT FOR CORNER;

SOUTH 00 DEGREES 10 MINUTES 42 SECONDS EAST, A DISTANCE OF 67.93 FEET TO A POINT FOR CORNER;

SOUTH 08 DEGREES 58 MINUTES 15 SECONDS WEST, A DISTANCE OF 31.06 FEET TO A POINT FOR CORNER;

SOUTH 34 DEGREES 59 MINUTES 35 SECONDS WEST, A DISTANCE OF 95.76 FEET TO A POINT FOR CORNER;

SOUTH 73 DEGREES 34 MINUTES 06 SECONDS WEST, A DISTANCE OF 219.32 FEET TO A POINT FOR CORNER;

SOUTH 72 DEGREES 18 MINUTES 27 SECONDS WEST, A DISTANCE OF 181.66 FEET TO A POINT FOR CORNER;

SOUTH 62 DEGREES 14 MINUTES 18 SECONDS WEST, A DISTANCE OF 39.13 FEET TO A POINT FOR CORNER;

SOUTH 26 DEGREES 02 MINUTES 25 SECONDS WEST, A DISTANCE OF 76.21 FEET TO A POINT FOR CORNER;

SOUTH 06 DEGREES 15 MINUTES 13 SECONDS EAST, A DISTANCE OF 15.43 FEET TO A POINT FOR CORNER;

SOUTH 27 DEGREES 46 MINUTES 10 SECONDS EAST, A DISTANCE OF 146.70 FEET TO A POINT FOR CORNER;

SOUTH 38 DEGREES 38 MINUTES 48 SECONDS EAST, A DISTANCE OF 98.77 FEET TO A POINT FOR CORNER;

SOUTH 65 DEGREES 28 MINUTES 12 SECONDS EAST, A DISTANCE OF 90.87 FEET TO A POINT FOR CORNER;

SOUTH 58 DEGREES 46 MINUTES 14 SECONDS EAST, A DISTANCE OF 89.05 FEET TO A POINT FOR CORNER;

SOUTH 55 DEGREES 38 MINUTES 18 SECONDS EAST, A DISTANCE OF 81.34 FEET TO A POINT FOR CORNER;

SOUTH 61 DEGREES 13 MINUTES 57 SECONDS EAST, A DISTANCE OF 131.93 FEET TO A POINT FOR CORNER;

SOUTH 50 DEGREES 02 MINUTES 00 SECONDS EAST, A DISTANCE OF 83.53 FEET TO A POINT FOR CORNER;

SOUTH 15 DEGREES 41 MINUTES 08 SECONDS EAST, A DISTANCE OF 65.63 FEET TO A POINT FOR CORNER;

SOUTH 60 DEGREES 25 MINUTES 17 SECONDS WEST, A DISTANCE OF 38.95 FEET TO A POINT FOR CORNER;

SOUTH 13 DEGREES 46 MINUTES 24 SECONDS WEST, A DISTANCE OF 78.87 FEET TO A POINT FOR CORNER;

SOUTH 26 DEGREES 57 MINUTES 48 SECONDS WEST, A DISTANCE OF 85.04 FEET TO A POINT FOR CORNER;

SOUTH 53 DEGREES 42 MINUTES 03 SECONDS WEST, A DISTANCE OF 103.78 FEET TO A POINT FOR CORNER;

SOUTH 54 DEGREES 31 MINUTES 27 SECONDS WEST, A DISTANCE OF 81.58 FEET TO A POINT FOR CORNER;

SOUTH 61 DEGREES 55 MINUTES 50 SECONDS WEST, A DISTANCE OF 124.05 FEET TO A POINT FOR CORNER;

SOUTH 61 DEGREES 26 MINUTES 59 SECONDS WEST, A DISTANCE OF 70.28 FEET TO A POINT FOR CORNER;

SOUTH 32 DEGREES 20 MINUTES 11 SECONDS WEST, A DISTANCE OF 99.01 FEET TO A POINT FOR CORNER;

SOUTH 10 DEGREES 50 MINUTES 27 SECONDS WEST, A DISTANCE OF 37.28 FEET TO A POINT FOR CORNER;

SOUTH 01 DEGREES 02 MINUTES 10 SECONDS EAST, A DISTANCE OF 113.13 FEET TO A POINT FOR CORNER;

SOUTH 29 DEGREES 02 MINUTES 49 SECONDS EAST, A DISTANCE OF 36.57 FEET TO A POINT FOR CORNER;

SOUTH 71 DEGREES 45 MINUTES 23 SECONDS EAST, A DISTANCE OF 91.85 FEET TO A POINT FOR CORNER;

NORTH 89 DEGREES 05 MINUTES 15 SECONDS EAST, A DISTANCE OF 84.92 FEET TO A POINT FOR CORNER;

NORTH 75 DEGREES 55 MINUTES 22 SECONDS EAST, A DISTANCE OF 78.29 FEET TO A POINT FOR CORNER;

SOUTH 87 DEGREES 29 MINUTES 47 SECONDS EAST, A DISTANCE OF 86.59 FEET TO A POINT FOR CORNER;

SOUTH 64 DEGREES 37 MINUTES 20 SECONDS EAST, A DISTANCE OF 61.40 FEET TO A POINT FOR CORNER;

SOUTH 24 DEGREES 13 MINUTES 36 SECONDS EAST, A DISTANCE OF 83.75 FEET TO A POINT FOR CORNER;

SOUTH 09 DEGREES 51 MINUTES 21 SECONDS EAST, A DISTANCE OF 22.63 FEET TO A POINT FOR CORNER;

SOUTH 43 DEGREES 56 MINUTES 54 SECONDS WEST, A DISTANCE OF 138.97 FEET TO A POINT FOR CORNER;

SOUTH 70 DEGREES 14 MINUTES 33 SECONDS WEST, A DISTANCE OF 148.31 FEET TO A POINT FOR CORNER;

SOUTH 61 DEGREES 57 MINUTES 04 SECONDS WEST, A DISTANCE OF 54.03 FEET TO A POINT FOR CORNER;

SOUTH 34 DEGREES 32 MINUTES 38 SECONDS WEST, A DISTANCE OF 119.53 FEET TO A POINT FOR CORNER;

SOUTH 56 DEGREES 50 MINUTES 51 SECONDS WEST, A DISTANCE OF 164.17 FEET TO A POINT FOR CORNER;

SOUTH 20 DEGREES 09 MINUTES 48 SECONDS WEST, A DISTANCE OF 75.03 FEET TO A POINT FOR CORNER;

SOUTH 24 DEGREES 31 MINUTES 58 SECONDS EAST, A DISTANCE OF 91.04 FEET TO A POINT FOR CORNER;

SOUTH 43 DEGREES 08 MINUTES 09 SECONDS EAST, A DISTANCE OF 65.53 FEET TO A POINT FOR CORNER;

SOUTH 48 DEGREES 45 MINUTES 48 SECONDS EAST, A DISTANCE OF 86.33 FEET TO A POINT FOR CORNER;

SOUTH 36 DEGREES 37 MINUTES 04 SECONDS EAST, A DISTANCE OF 80.56 FEET TO A POINT FOR CORNER;

SOUTH 14 DEGREES 39 MINUTES 59 SECONDS EAST, A DISTANCE OF 83.23 FEET TO A POINT FOR CORNER;

SOUTH 09 DEGREES 30 MINUTES 21 SECONDS WEST, A DISTANCE OF 47.73 FEET TO A POINT FOR CORNER;

SOUTH 29 DEGREES 12 MINUTES 38 SECONDS WEST, A DISTANCE OF 148.32 FEET TO A POINT FOR CORNER;

SOUTH 10 DEGREES 23 MINUTES 51 SECONDS WEST, A DISTANCE OF 54.05 FEET TO A POINT FOR CORNER;

SOUTH 54 DEGREES 54 MINUTES 18 SECONDS EAST, A DISTANCE OF 74.80 FEET TO A POINT FOR CORNER;

SOUTH 68 DEGREES 03 MINUTES 59 SECONDS EAST, A DISTANCE OF 45.10 FEET TO A POINT FOR CORNER;

SOUTH 74 DEGREES 45 MINUTES 02 SECONDS EAST, A DISTANCE OF 120.98 FEET TO A POINT FOR CORNER;

SOUTH 37 DEGREES 58 MINUTES 42 SECONDS EAST, A DISTANCE OF 30.84 FEET TO A POINT FOR CORNER;

SOUTH 09 DEGREES 47 MINUTES 01 SECONDS EAST, A DISTANCE OF 26.13 FEET TO A POINT FOR CORNER;

SOUTH 13 DEGREES 19 MINUTES 51 SECONDS WEST, A DISTANCE OF 84.18 FEET TO A POINT FOR CORNER;

SOUTH 43 DEGREES 24 MINUTES 44 SECONDS WEST, A DISTANCE OF 68.56 FEET TO A POINT FOR CORNER;

SOUTH 58 DEGREES 05 MINUTES 12 SECONDS WEST, A DISTANCE OF 63.97 FEET TO A POINT FOR CORNER;

SOUTH 71 DEGREES 39 MINUTES 45 SECONDS WEST, A DISTANCE OF 48.06 FEET TO A POINT FOR CORNER;

NORTH 84 DEGREES 13 MINUTES 05 SECONDS WEST, A DISTANCE OF 97.44 FEET TO A POINT FOR CORNER;

SOUTH 78 DEGREES 06 MINUTES 14 SECONDS WEST, A DISTANCE OF 96.50 FEET TO A POINT FOR CORNER;

SOUTH 52 DEGREES 36 MINUTES 49 SECONDS WEST, A DISTANCE OF 47.07 FEET TO A POINT FOR CORNER;

SOUTH 26 DEGREES 13 MINUTES 00 SECONDS WEST, A DISTANCE OF 68.00 FEET TO A POINT FOR CORNER;

SOUTH 07 DEGREES 14 MINUTES 06 SECONDS WEST, A DISTANCE OF 107.55 FEET TO A POINT FOR THE SOUTHEAST CORNER OF SAID 1113.084 ACRE TRACT AND BEING THE NORTHEAST CORNER OF AFORESAID 57 ACRE TRACT;

THENCE, ALONG THE SOUTH LINE OF SAID 1113.084 ACRE TRACT AND THE COMMON NORTH LINE OF SAID 57 ACRE TRACT, THE FOLLOWING COURSES AND DISTANCES:

NORTH 88 DEGREES 57 MINUTES 19 SECONDS WEST, PASSING AT A DISTANCE OF 100.00 FEET A 5/8 INCH IRON ROD WITH A YELLOW PLASTIC CAP STAMPED "CARTER BURGESS" SET FOR WITNESS, CONTINUING A TOTAL DISTANCE OF 2153.25 FEET TO A 60D NAIL FOUND FOR CORNER;

NORTH 89 DEGREES 29 MINUTES 57 SECONDS WEST, A DISTANCE OF 1179.76 FEET TO THE POINT OF BEGINNING, AND CONTAINING 673.759 ACRES OF LAND, MORE OR LESS.

Exhibit B-2
Legal Description
202.330 acres
(MUD 1/TRACT B)

BEING A 202.362 ACRE TRACT OF LAND SITUATED IN THE JOHN EMBERSON SURVEY, ABSTRACT NO. 294, AND THE MEREDITH HART SURVEY, ABSTRACT NO. 371, COLLIN COUNTY, TEXAS, AND BEING PART OF A 0.469 ACRE TRACT CONVEYED AS "TRACT 2" AND A 182.711 ACRE TRACT OF LAND CONVEYED AS "TRACT 1" TO MA-BBO FIVE, LP, BY DEED RECORDED IN COUNTY CLERK'S FILE NO. 20060718001344730, OFFICIAL PUBLIC RECORDS, COLLIN COUNTY, TEXAS, AND PART OF A 26.423 ACRE TRACT OF LAND CONVEYED AS "TRACT 1" AND A 0.653 ACRE TRACT OF LAND CONVEYED AS "TRACT 2" TO MA-BBO FIVE, LP, BY DEED RECORDED IN COUNTY CLERK'S FILE NO. 20060918001344720, OFFICIAL PUBLIC RECORDS, COLLIN COUNTY, TEXAS. SAID 202.362 ACRE TRACT, WITH BEARING BASIS BEING GRID NORTH, TEXAS STATE PLANE COORDINATES, NORTH CENTRAL ZONE, NAD83 (CORS), DETERMINED BY GPS OBSERVATIONS ON JULIAN DAY 320, 2005, CALCULATED FROM DENTON CORS ARP (PID-DF8986), ARLINGTON RRP2 CORS ARP (PID-DF 5387) AND COLLIN CORS ARP (PID-DF8982), BEING MORE PARTICULARLY DESCRIBED BY METES AND BOUNDS AS FOLLOWS:

BEGINNING AT A 3/8 INCH IRON ROD FOUND FOR THE NORTHWEST CORNER OF AFORESAID 182.711 ACRE TRACT AND BEING THE NORTHEAST CORNER OF A CALLED 20.300 ACRE TRACT OF LAND CONVEYED TO TOM B. WILSON BY DEED RECORDED IN VOLUME 935, PAGE 598, DEED RECORDS, COLLIN COUNTY, TEXAS AND BEING ON THE SOUTH LINE OF A CALLED 361.66 ACRE TRACT OF LAND CONVEYED TO HERITAGE FARM TRUST BY DEED RECORDED IN COUNTY CLERK'S FILE NO. 98-0084317, LAND RECORDS, COLLIN COUNTY, TEXAS;

THENCE, SOUTH 88 DEGREES 16 MINUTES 45 SECONDS EAST, ALONG THE NORTH LINE OF AFORESAID 182.711 ACRE TRACT AND ALONG THE COMMON SOUTH LINE OF AFORESAID 361.66 ACRE TRACT, A DISTANCE OF 2721.12 FEET TO A POINT FOR CORNER;

THENCE, OVER AND ACROSS SAID 182.711 ACRE TRACT, SAID 0.469 ACRE TRACT AND SAID 26.423 ACRE TRACT, THE FOLLOWING COURSES AND DISTANCES:

SOUTH 01 DEGREES 38 MINUTES 13 SECONDS WEST, A DISTANCE OF 160.00 FEET TO A POINT FOR CORNER AND THE BEGINNING OF A TANGENT CURVE TO THE LEFT HAVING A CENTRAL ANGLE OF 26 DEGREES 38 MINUTES 26 SECONDS, A RADIUS OF 1450.00 FEET, AND A LONG CHORD THAT BEARS SOUTH 11 DEGREES 41 MINUTES 00 SECONDS EAST, A DISTANCE OF 668.15 FEET;

ALONG SAID TANGENT CURVE TO THE LEFT, AN ARC LENGTH OF 674.20 FEET TO A POINT FOR CORNER;

SOUTH 25 DEGREES 00 MINUTES 13 SECONDS EAST, A DISTANCE OF 241.04 FEET TO A POINT FOR CORNER AND THE BEGINNING OF A TANGENT CURVE TO THE RIGHT HAVING A CENTRAL ANGLE OF 22 DEGREES 02 MINUTES 58 SECONDS, A RADIUS OF 1450.00 FEET, AND A LONG CHORD THAT BEARS SOUTH 13 DEGREES 58 MINUTES 44 SECONDS EAST, A DISTANCE OF 554.58 FEET;

ALONG SAID TANGENT CURVE TO THE RIGHT, AN ARC LENGTH OF 558.01 FEET TO A POINT FOR CORNER;

SOUTH 02 DEGREES 57 MINUTES 15 SECONDS EAST, A DISTANCE OF 237.94 FEET TO A POINT FOR CORNER ON THE EAST LINE OF SAID 26.423 ACRE TRACT AND BEING IN COLLIN COUNTY ROAD NO. 206 (A VARIABLE WIDTH PRESCRIPTIVE RIGHT-OF-WAY);

THENCE, SOUTH 00 DEGREES 34 MINUTES 35 SECONDS EAST, ALONG THE EAST LINE OF SAID 26.423 ACRE TRACT AND THE APPROXIMATE CENTERLINE OF AFORESAID COLLIN COUNTY ROAD NO. 206 A DISTANCE OF 169.57 FEET TO A PK NAIL SET FOR THE SOUTHEAST CORNER OF SAID 26.423 ACRE TRACT AND A COMMON EAST CORNER OF SAID 182.711 ACRE TRACT;

THENCE, ALONG THE EAST LINE OF SAID 182.711 ACRE TRACT, AND THE APPROXIMATE CENTERLINE OF AFORESAID COLLIN COUNTY ROAD NO. 206 THE FOLLOWING COURSES AND DISTANCES:

SOUTH 13 DEGREES 23 MINUTES 32 SECONDS EAST, A DISTANCE OF 619.60 FEET TO A 5/8 INCH IRON ROD WITH A YELLOW PLASTIC CAP STAMPED "CARTER BURGESS" SET FOR CORNER;

SOUTH 26 DEGREES 26 MINUTES 21 SECONDS EAST, A DISTANCE OF 308.47 FEET TO A 5/8 INCH IRON ROD WITH A YELLOW PLASTIC CAP STAMPED "CARTER BURGESS" SET FOR CORNER AND THE BEGINNING OF A NON-TANGENT CURVE TO THE RIGHT HAVING A CENTRAL ANGLE OF 12 DEGREES 30 MINUTES 28 SECONDS, A RADIUS OF 570.00 FEET, AND A LONG CHORD THAT BEARS SOUTH 23 DEGREES 04 MINUTES 21 SECONDS EAST, A DISTANCE OF 124.18 FEET;

ALONG SAID NON-TANGENT CURVE TO THE RIGHT, AN ARC LENGTH OF 124.43 FEET TO A 5/8 INCH IRON ROD WITH A YELLOW PLASTIC CAP STAMPED "CARTER BURGESS" SET FOR THE SOUTHEAST CORNER OF SAID 182.711 ACRE TRACT;

THENCE, ALONG THE SOUTH LINE OF AFORESAID 182.711 ACRE TRACT AND THE COMMON NORTH RIGHT-OF-WAY OF F.M. 543 (A VARIABLE WIDTH RIGHT-OF-WAY), THE FOLLOWING COURSES AND DISTANCES:

SOUTH 88 DEGREES 19 MINUTES 01 SECONDS WEST, PASSING AT A DISTANCE OF 21.52 FEET, A PK NAIL FOUND FOR WITNESS, CONTINUING A TOTAL DISTANCE OF 887.99 FEET TO A 5/8 INCH IRON ROD WITH A YELLOW PLASTIC CAP STAMPED "CARTER BURGESS" SET FOR CORNER AND THE BEGINNING OF A TANGENT CURVE TO THE RIGHT HAVING A CENTRAL ANGLE OF 05 DEGREES 16 MINUTES 00 SECONDS, A RADIUS OF 1870.34 FEET, A CHORD BEARING OF NORTH 89 DEGREES 02 MINUTES 59 SECONDS WEST, AND A CHORD LENGTH OF 171.86 FEET;

ALONG SAID TANGENT CURVE TO THE RIGHT HAVING AN ARC LENGTH OF 171.92 FEET TO A 5/8 INCH IRON ROD WITH A YELLOW PLASTIC CAP STAMPED "CARTER BURGESS" SET FOR CORNER;

NORTH 86 DEGREES 24 MINUTES 59 SECONDS WEST, A DISTANCE OF 819.32 FEET TO A 5/8 INCH IRON ROD WITH A YELLOW PLASTIC CAP STAMPED "CARTER BURGESS" SET FOR CORNER;

NORTH 87 DEGREES 54 MINUTES 59 SECONDS WEST, A DISTANCE OF 1322.00 FEET TO A 5/8 INCH IRON ROD WITH A YELLOW PLASTIC CAP STAMPED "CARTER BURGESS" SET FOR THE SOUTHWEST CORNER OF AFORESAID 182.711 ACRE TRACT AND BEING THE SOUTHEAST CORNER OF A CALLED 6.72 ACRE TRACT OF LAND CONVEYED TO GRAYSON-COLLIN ELECTRIC COOPERATIVE BY DEED RECORDED IN COUNTY CLERK'S FILE NO. 2000-0133812, LAND RECORDS, COLLIN COUNTY, TEXAS;

THENCE, ALONG THE WEST LINE OF AFORESAID 182.711 ACRE TRACT THE FOLLOWING COURSES AND DISTANCES:

NORTH 07 DEGREES 04 MINUTES 31 SECONDS WEST, ALONG THE EAST LINE OF AFORESAID 6.72 ACRE TRACT, A DISTANCE OF 2005.98 FEET TO A 1/2 INCH IRON ROD FOUND FOR THE NORTH CORNER OF SAID 6.72 ACRE TRACT AND BEING ON THE EAST LINE OF AFORESAID 20.300 ACRE TRACT;

NORTH 00 DEGREES 53 MINUTES 45 SECONDS EAST, ALONG THE EAST LINE OF AFORESAID 20.300 ACRE TRACT, A DISTANCE OF 986.32 FEET TO THE POINT OF BEGINNING, AND CONTAINING 202.362 ACRES OF LAND, MORE OR LESS.

SAVE AND EXCEPT A 0.032 ACRE TRACT OF LAND, BEING ALL OF A CALLED 0.03 ACRE TRACT OF LAND DESCRIBED AS "FAMILY BURIAL GROUNDS" IN DEED RECORDED IN VOLUME 294, PAGE 43, DEED RECORDS, COLLIN COUNTY, TEXAS.

SAID 0.032 ACRE TRACT OF LAND BEING MORE PARTICULARLY DESCRIBED BY METES AND BOUNDS AS FOLLOWS:

COMMENCING AT 3/8 INCH IRON ROD FOUND FOR THE NORTHWEST CORNER OF AFORESAID 182.82 ACRE TRACT AND BEING THE NORTHEAST CORNER OF AFORESAID 20.300 ACRE TRACT AND BEING ON THE SOUTH LINE OF AFORESAID 361.66 ACRE TRACT;

THENCE, SOUTH 88 DEGREES 16 MINUTES 45 SECONDS EAST, ALONG THE NORTH LINE OF SAID 182.82 ACRE TRACT AND ALONG THE COMMON SOUTH LINE OF SAID 361.66 ACRE TRACT, A DISTANCE OF 618.15 FEET TO A POINT;

THENCE, SOUTH 01 DEGREES 05 MINUTES 01 SECONDS WEST, OVER AND ACROSS SAID 182.82 ACRE TRACT, A DISTANCE OF 31.10 FEET TO A FENCE CORNER POST FOUND FOR THE **POINT OF BEGINNING**;

THENCE, CONTINUING OVER AND ACROSS SAID 182.82 ACRE TRACT, THE FOLLOWING COURSES AND DISTANCES:

NORTH 89 DEGREES 39 MINUTES 44 SECONDS EAST, A DISTANCE OF 39.36 FEET TO A FENCE CORNER POST FOUND FOR CORNER;

SOUTH 00 DEGREES 24 MINUTES 46 SECONDS EAST, A DISTANCE OF 35.96 FEET TO A FENCE CORNER POST FOUND FOR CORNER;

NORTH 88 DEGREES 50 MINUTES 03 SECONDS WEST, A DISTANCE OF 40.28 FEET TO A FENCE CORNER POST FOUND FOR CORNER;

NORTH 01 DEGREES 05 MINUTES 01 SECONDS EAST, A DISTANCE OF 34.92 FEET TO THE **POINT OF BEGINNING**, AND CONTAINING 0.032 ACRES OF LAND, MORE OR LESS, LEAVING A NET ACREAGE OF 202.330 ACRES OF LAND, MORE OR LESS.

Exhibit B-3
Legal Description
(MUD 2/TRACT A)

BEING A 423.553 ACRE TRACT OF LAND SITUATED IN THE THOMAS BRUCE SURVEY, ABSTRACT NO. 103, THE THOMAS LINDSAY SURVEY, ABSTRACT NO. 521, COLLIN COUNTY, TEXAS, AND BEING ALL OF A CALLED 106.762 ACRE TRACT OF LAND CONVEYED TO MA-BBO FIVE, LP, BY DEED RECORDED IN COUNTY CLERK'S FILE NO. 20060918001344750, OFFICIAL PUBLIC RECORDS, COLLIN COUNTY, TEXAS, AND BEING ALL OF A CALLED 118.259 ACRE TRACT OF LAND CONVEYED TO MA-BBO FIVE, LP, BY DEED RECORDED IN COUNTY CLERK'S FILE NO. 20060918001344760, OFFICIAL PUBLIC RECORDS, COLLIN COUNTY, TEXAS, AND BEING PART OF A CALLED 1113.084 ACRE TRACT OF LAND CONVEYED TO MA BB OWEN, LP, BY DEED RECORDED IN COUNTY CLERK'S FILE NO. 20060616000829800, OFFICIAL PUBLIC RECORDS, COLLIN COUNTY, TEXAS, SAID 423.553 ACRE TRACT, WITH BEARING BASIS BEING GRID NORTH, TEXAS STATE PLANE COORDINATES, NORTH CENTRAL ZONE, NAD83 (CORS), DETERMINED BY GPS OBSERVATIONS ON JULLAN DAY 320, 2005, CALCULATED FROM DENTON CORS ARP (PID-DF8986), ARLINGTON RRP2 CORS ARP (PID-DF 5387) AND COLLIN CORS ARP (PID-8982), AND BEING MORE PARTICULARLY DESCRIBED BY METES AND BOUNDS AS FOLLOWS:

BEGINNING AT A 5/8 INCH IRON ROD FOUND FOR THE NORTHWEST CORNER OF SAID 106.762 ACRE TRACT AND THE NORTHEAST CORNER OF A 39.06 ACRE TRACT OF LAND DESCRIBED IN A DEED TO THOMAS M. FRIS AS RECORDED IN COLLIN COUNTY CLERK'S FILE NO. 96-0104896, LAND RECORDS, COLLIN COUNTY, TEXAS, SAID POINT ALSO BEING ON THE SOUTH LINE OF A TRACT OF LAND DESCRIBED IN A DEED TO JOHN P. WALDEN & WIFE JANE WALDEN AS RECORDED IN VOLUME 551, PAGE 366 OF THE DEED RECORDS OF COLLIN COUNTY, TEXAS;

THENCE, ALONG COMMON LINES OF SAID 106.762 ACRE TRACT AND SAID WALDEN TRACT, THE FOLLOWING COURSES AND DISTANCES:

SOUTH 89 DEGREES 11 MINUTES 59 SECONDS EAST, A DISTANCE OF 900.54 FEET TO A 5/8 INCH IRON ROD FOUND FOR CORNER;

SOUTH 89 DEGREES 27 MINUTES 53 SECONDS EAST, A DISTANCE OF 161.43 FEET TO A 5/8 INCH IRON ROD WITH YELLOW PLASTIC CAP STAMPED "CARTER BURGESS" SET FOR CORNER;

NORTH 83 DEGREES 20 MINUTES 49 SECONDS EAST, A DISTANCE OF 67.79 FEET TO THE NORTHEAST CORNER OF SAID 106.762 ACRE TRACT AND THE APPROXIMATE CENTERLINE OF EAST FORK OF THE TRINITY RIVER;

THENCE, ALONG THE EAST PROPERTY LINE OF SAID 106.762 ACRE TRACT, AND WITH THE CENTERLINE OF AFORESAID EAST FORK OF THE TRINITY RIVER, THE FOLLOWING COURSES AND DISTANCES:

SOUTH 20 DEGREES 21 MINUTES 50 SECONDS EAST, A DISTANCE OF 147.67 FEET TO A POINT FOR CORNER;

SOUTH 15 DEGREES 11 MINUTES 51 SECONDS EAST, A DISTANCE OF 121.20 FEET TO A POINT FOR CORNER;

SOUTH 53 DEGREES 55 MINUTES 47 SECONDS EAST, A DISTANCE OF 57.30 FEET TO A POINT FOR CORNER;

NORTH 81 DEGREES 40 MINUTES 31 SECONDS EAST, A DISTANCE OF 68.17 FEET TO A POINT FOR CORNER;

NORTH 55 DEGREES 58 MINUTES 51 SECONDS EAST, A DISTANCE OF 70.86 FEET TO A POINT FOR CORNER;

NORTH 50 DEGREES 52 MINUTES 37 SECONDS EAST, A DISTANCE OF 167.34 FEET TO A POINT FOR CORNER;

SOUTH 63 DEGREES 52 MINUTES 45 SECONDS EAST, A DISTANCE OF 76.94 FEET TO A POINT FOR CORNER;

SOUTH 24 DEGREES 20 MINUTES 33 SECONDS EAST, A DISTANCE OF 73.75 FEET TO A POINT FOR CORNER;

SOUTH 19 DEGREES 16 MINUTES 49 SECONDS WEST, A DISTANCE OF 61.92 FEET TO A POINT FOR CORNER;

SOUTH 29 DEGREES 28 MINUTES 37 SECONDS WEST, A DISTANCE OF 67.28 FEET TO A POINT FOR CORNER;

SOUTH 29 DEGREES 53 MINUTES 46 SECONDS WEST, A DISTANCE OF 70.84 FEET TO A POINT FOR CORNER;

SOUTH 04 DEGREES 46 MINUTES 27 SECONDS EAST, A DISTANCE OF 98.68 FEET TO A POINT FOR CORNER;

SOUTH 27 DEGREES 59 MINUTES 37 SECONDS EAST, A DISTANCE OF 72.48 FEET TO A POINT FOR CORNER;

SOUTH 38 DEGREES 58 MINUTES 18 SECONDS EAST, A DISTANCE OF 131.77 FEET TO A POINT FOR CORNER;

SOUTH 03 DEGREES 11 MINUTES 20 SECONDS EAST, A DISTANCE OF 91.41 FEET TO A POINT FOR CORNER;

SOUTH 06 DEGREES 35 MINUTES 41 SECONDS WEST, A DISTANCE OF 188.59 FEET TO A POINT FOR CORNER;

SOUTH 36 DEGREES 55 MINUTES 44 SECONDS EAST, A DISTANCE OF 101.19 FEET TO A POINT FOR CORNER;

SOUTH 77 DEGREES 27 MINUTES 27 SECONDS EAST, A DISTANCE OF 101.27 FEET TO A POINT FOR CORNER;

SOUTH 89 DEGREES 08 MINUTES 21 SECONDS EAST, A DISTANCE OF 137.11 FEET TO A POINT FOR CORNER;

SOUTH 56 DEGREES 41 MINUTES 24 SECONDS EAST, A DISTANCE OF 136.45 FEET TO A POINT FOR CORNER;

SOUTH 41 DEGREES 28 MINUTES 51 SECONDS EAST, A DISTANCE OF 84.90 FEET TO A POINT FOR CORNER;

SOUTH 16 DEGREES 13 MINUTES 08 SECONDS EAST, A DISTANCE OF 239.45 FEET TO A POINT FOR CORNER;

SOUTH 20 DEGREES 49 MINUTES 08 SECONDS WEST, A DISTANCE OF 84.82 FEET TO A POINT FOR CORNER;

SOUTH 38 DEGREES 02 MINUTES 36 SECONDS WEST, A DISTANCE OF 120.85 FEET TO A POINT FOR CORNER;

SOUTH 16 DEGREES 50 MINUTES 36 SECONDS WEST, A DISTANCE OF 106.92 FEET TO A POINT FOR CORNER;

SOUTH 04 DEGREES 08 MINUTES 50 SECONDS WEST, A DISTANCE OF 83.94 FEET TO A POINT FOR CORNER;

SOUTH 45 DEGREES 46 MINUTES 39 SECONDS EAST, A DISTANCE OF 70.50 FEET TO A POINT FOR CORNER;

SOUTH 65 DEGREES 20 MINUTES 11 SECONDS EAST, A DISTANCE OF 154.89 FEET TO A POINT FOR CORNER;

SOUTH 57 DEGREES 43 MINUTES 24 SECONDS EAST, A DISTANCE OF 104.47 FEET TO A POINT FOR CORNER;

SOUTH 08 DEGREES 58 MINUTES 00 SECONDS EAST, A DISTANCE OF 103.87 FEET TO A POINT FOR CORNER;

SOUTH 30 DEGREES 16 MINUTES 36 SECONDS WEST, A DISTANCE OF 92.56 FEET TO A POINT FOR CORNER;

SOUTH 48 DEGREES 18 MINUTES 00 SECONDS WEST, A DISTANCE OF 95.11 FEET TO A POINT FOR CORNER;

SOUTH 64 DEGREES 48 MINUTES 37 SECONDS WEST, A DISTANCE OF 115.06 FEET TO A POINT FOR CORNER;

SOUTH 63 DEGREES 46 MINUTES 10 SECONDS WEST, A DISTANCE OF 108.90 FEET TO A POINT FOR CORNER;

SOUTH 74 DEGREES 52 MINUTES 48 SECONDS WEST, A DISTANCE OF 108.83 FEET TO A POINT FOR CORNER;

SOUTH 80 DEGREES 20 MINUTES 18 SECONDS WEST, A DISTANCE OF 130.42 FEET TO A POINT FOR CORNER;

SOUTH 77 DEGREES 33 MINUTES 24 SECONDS WEST, A DISTANCE OF 159.57 FEET TO A POINT FOR CORNER;

SOUTH 49 DEGREES 37 MINUTES 34 SECONDS WEST, A DISTANCE OF 79.64 FEET TO A POINT FOR CORNER;

SOUTH 30 DEGREES 51 MINUTES 57 SECONDS WEST, A DISTANCE OF 127.68 FEET TO A POINT FOR CORNER;

SOUTH 08 DEGREES 15 MINUTES 52 SECONDS EAST, A DISTANCE OF 88.75 FEET TO A POINT FOR CORNER;

SOUTH 20 DEGREES 25 MINUTES 34 SECONDS EAST, A DISTANCE OF 191.80 FEET TO A POINT FOR CORNER;

SOUTH 08 DEGREES 27 MINUTES 55 SECONDS EAST, A DISTANCE OF 92.30 FEET TO A POINT FOR CORNER;

SOUTH 39 DEGREES 42 MINUTES 15 SECONDS WEST, A DISTANCE OF 84.38 FEET TO A POINT FOR CORNER;

SOUTH 80 DEGREES 08 MINUTES 27 SECONDS WEST, A DISTANCE OF 92.47 FEET TO A POINT FOR CORNER;

NORTH 75 DEGREES 29 MINUTES 03 SECONDS WEST, A DISTANCE OF 181.83 FEET TO A POINT FOR CORNER;

NORTH 78 DEGREES 44 MINUTES 38 SECONDS WEST, A DISTANCE OF 106.12 FEET TO A POINT FOR CORNER;

SOUTH 69 DEGREES 37 MINUTES 05 SECONDS WEST, A DISTANCE OF 80.67 FEET TO A POINT FOR CORNER;

SOUTH 20 DEGREES 46 MINUTES 24 SECONDS WEST, A DISTANCE OF 87.62 FEET TO A POINT FOR CORNER;

SOUTH 14 DEGREES 45 MINUTES 22 SECONDS EAST, PASSING AT A DISTANCE OF 71.19 FEET THE SOUTHEAST CORNER OF SAID 106.762 ACRE TRACT, SAME BEING A NORTHEAST CORNER OF AFORESAID 1113.084 ACRE TRACT, CONTINUING WITH THE CENTERLINE OF SAID EAST FORK OF THE TRINITY RIVER AND THE EAST PROPERTY LINE OF SAID 1113.084 ACRE TRACT, IN ALL A TOTAL DISTANCE OF 120.37 FEET TO A POINT FOR CORNER;

THENCE, CONTINUING WITH THE CENTERLINE OF SAID EAST FORK OF THE TRINITY RIVER AND ALONG THE EAST PROPERTY LINE OF SAID 1113.084 ACRE TRACT, THE FOLLOWING COURSES AND DISTANCES:

SOUTH 34 DEGREES 39 MINUTES 08 SECONDS EAST, A DISTANCE OF 74.62 FEET TO A POINT FOR CORNER;

SOUTH 84 DEGREES 34 MINUTES 58 SECONDS EAST, A DISTANCE OF 126.28 FEET TO A POINT FOR CORNER;

SOUTH 65 DEGREES 27 MINUTES 27 SECONDS EAST, A DISTANCE OF 133.32 FEET TO A POINT FOR CORNER;

NORTH 71 DEGREES 35 MINUTES 21 SECONDS EAST, A DISTANCE OF 110.32 FEET TO A POINT FOR CORNER;

SOUTH 75 DEGREES 11 MINUTES 25 SECONDS EAST, A DISTANCE OF 99.44 FEET TO A POINT FOR CORNER;

SOUTH 16 DEGREES 58 MINUTES 48 SECONDS EAST, A DISTANCE OF 54.42 FEET TO A POINT FOR CORNER;

SOUTH 06 DEGREES 07 MINUTES 16 SECONDS WEST, A DISTANCE OF 82.33 FEET TO A POINT FOR CORNER;

SOUTH 34 DEGREES 19 MINUTES 44 SECONDS WEST, A DISTANCE OF 114.95 FEET TO A POINT FOR CORNER;

SOUTH 85 DEGREES 30 MINUTES 45 SECONDS WEST, A DISTANCE OF 291.84 FEET TO A POINT FOR CORNER;

SOUTH 08 DEGREES 46 MINUTES 06 SECONDS WEST, A DISTANCE OF 95.18 FEET TO A POINT FOR CORNER;

SOUTH 37 DEGREES 06 MINUTES 09 SECONDS EAST, A DISTANCE OF 121.86 FEET TO A POINT FOR CORNER;

SOUTH 38 DEGREES 12 MINUTES 58 SECONDS EAST, A DISTANCE OF 130.83 FEET TO A POINT FOR CORNER;

THENCE, OVER AND ACROSS SAID 1113.084 ACRE TRACT, THE FOLLOWING COURSES AND DISTANCES:

SOUTH 87 DEGREES 05 MINUTES 41 SECONDS WEST, A DISTANCE OF 1162.77 FEET TO A POINT FOR CORNER AND THE BEGINNING OF A TANGENT CURVE TO THE LEFT HAVING A CENTRAL ANGLE OF 39 DEGREES 50 MINUTES 38 SECONDS, A RADIUS OF 630.00 FEET, A LONG CHORD THAT BEARS, SOUTH 67 DEGREES 10 MINUTES 22 SECONDS WEST, A DISTANCE OF 429.33 FEET;

ALONG SAID TANGENT CURVE TO THE LEFT, AN ARC DISTANCE OF 438.11 FEET TO A POINT FOR CORNER;

SOUTH 47 DEGREES 15 MINUTES 03 SECONDS WEST, A DISTANCE OF 379.74 FEET TO A POINT FOR CORNER AND THE BEGINNING OF A TANGENT CURVE TO THE RIGHT HAVING A CENTRAL ANGLE OF 41 DEGREES 03 MINUTES 11 SECONDS, A

RADIUS OF 570.00 FEET, A LONG CHORD THAT BEARS, SOUTH 67 DEGREES 46 MINUTES 38 SECONDS WEST, A DISTANCE OF 399.73 FEET;

ALONG SAID TANGENT CURVE TO THE RIGHT, AN ARC DISTANCE OF 408.41 FEET TO A POINT FOR CORNER;

SOUTH 88 DEGREES 18 MINUTES 14 SECONDS WEST, A DISTANCE OF 536.71 FEET TO A POINT FOR CORNER AND THE BEGINNING OF A NON-TANGENT CURVE TO THE LEFT HAVING A CENTRAL ANGLE OF 202 DEGREES 43 MINUTES 24 SECONDS, A RADIUS OF 430.00 FEET, A LONG CHORD THAT BEARS, SOUTH 72 DEGREES 56 MINUTES 30 SECONDS WEST, A DISTANCE OF 843.15 FEET;

ALONG SAID NON-TANGENT CURVE TO THE LEFT, AN ARC DISTANCE OF 1521.42 FEET TO A POINT FOR CORNER;

SOUTH 57 DEGREES 34 MINUTES 46 SECONDS WEST, A DISTANCE OF 177.27 FEET TO A POINT FOR CORNER AND THE BEGINNING OF A TANGENT CURVE TO THE RIGHT HAVING A CENTRAL ANGLE OF 17 DEGREES 46 MINUTES 00 SECONDS, A RADIUS OF 570.00 FEET, A LONG CHORD THAT BEARS, SOUTH 66 DEGREES 27 MINUTES 46 SECONDS WEST, A DISTANCE OF 176.04 FEET;

ALONG SAID TANGENT CURVE TO THE RIGHT, AN ARC LENGTH OF 176.75 FEET TO A POINT FOR CORNER;

SOUTH 75 DEGREES 20 MINUTES 45 SECONDS WEST, A DISTANCE OF 877.21 FEET TO A POINT FOR CORNER IN THE WEST LINE OF SAID 1113.084 ACRE TRACT, SAME BEING THE APPROXIMATE CENTERLINE OF COLLIN COUNTY ROAD NO. 281 (A VARIABLE WIDTH RIGHT-OF-WAY);

THENCE, NORTH 00 DEGREES 31 MINUTES 40 SECONDS EAST, ALONG THE WEST LINE OF SAID 1113.084 ACRE TRACT AND THE APPROXIMATE CENTERLINE OF SAID COLLIN COUNTY ROAD NO. 281, A DISTANCE OF 1574.34 FEET TO A 1/2 INCH IRON ROD FOUND FOR AN INSIDE ELL CORNER OF SAID 1113.084 ACRE TRACT AND THE NORTHEAST CORNER OF A CALLED 3.000 ACRE TRACT OF LAND CONVEYED TO TERRY L. HERTWICK AND ROSE ETTA JONES BY DEED RECORDED IN COUNTY CLERK'S FILE NO. 2002-0001673, LAND RECORDS, COLLIN COUNTY, TEXAS;

THENCE, NORTH 00 DEGREES 04 MINUTES 47 SECONDS EAST, OVER AND ACROSS SAID 1113.084 ACRE TRACT, CONTINUING ALONG THE APPROXIMATE CENTERLINE OF SAID COLLIN COUNTY ROAD NO. 281, A DISTANCE OF 2505.18 FEET TO A POINT FOR AN INSIDE ELL CORNER OF SAID 1113.084 ACRE TRACT;

THENCE, SOUTH 89 DEGREES 21 MINUTES 54 SECONDS EAST, ALONG THE NORTH LINE OF SAID 1113.084 ACRE TRACT, PASSING AT A DISTANCE OF 40.00 FEET A 5/8 INCH IRON ROD WITH YELLOW PLASTIC CAP STAMPED "CARTER BURGESS" SET FOR WITNESS, CONTINUING A TOTAL DISTANCE OF 1290.73 FEET TO A 5/8 INCH IRON ROD FOUND FOR THE A NORTHEAST CORNER OF SAID 1113.084 ACRE TRACT AND BEING ON THE WEST LINE OF SAID 118.259 ACRE TRACT;

THENCE, NORTH 00 DEGREES 11 MINUTES 31 SECONDS WEST, ALONG THE WEST LINE OF SAID 118.259 ACRE TRACT, A DISTANCE OF 15.14 FEET TO A 1/2 INCH IRON ROD FOUND FOR A NORTHWEST CORNER OF SAID 118.259 ACRE TRACT AND THE SOUTHWEST CORNER OF A CALLED 1.071 ACRE TRACT OF LAND DESCRIBED IN A DEED TO ANITA L. GRAY AND HUSBAND, JIMMY L. GRAY AS RECORDED IN COLLIN COUNTY CLERK'S FILE NO. 94-0054427 OF THE LAND RECORDS OF COLLIN COUNTY, TEXAS;

THENCE SOUTH 89 DEGREES 10 MINUTES 20 SECONDS EAST, ALONG THE SOUTH LINE OF AFORESAID 1.071 ACRE TRACT, A DISTANCE OF 182.65 FEET TO A 5/8 INCH IRON ROD WITH A YELLOW PLASTIC CAP STAMPED "CARTER BURGESS" SET FOR THE SOUTHEAST CORNER OF SAID 1.071 ACRE TRACT;

THENCE NORTH 00 DEGREES 11 MINUTES 36 SECONDS WEST, ALONG THE EAST LINE OF AFORESAID 1.071 ACRE TRACT, A DISTANCE OF 254.52 FEET TO A POINT FOR CORNER, FROM WHICH A 5/8 INCH IRON ROD FOUND BEARS NORTH 00 DEGREES 11 MINUTES 36 SECONDS WEST, A DISTANCE OF 0.64 FEET, SAID POINT BEING IN THE SOUTH LINE OF A CALLED 10.000 ACRE TRACT OF LAND DESCRIBED IN A DEED TO CABE W. CHADICK AS RECORDED IN COLLIN COUNTY CLERK'S FILE NO. 2000-0095879 OF THE LAND RECORDS OF COLLIN COUNTY, TEXAS;

THENCE, SOUTH 89 DEGREES 20 MINUTES 27 SECONDS EAST, ALONG THE NORTH LINE OF SAID 118.259 ACRE TRACT, THE SOUTH LINE OF SAID 10.000 ACRE TRACT, THE SOUTH LINE OF AFORESAID 39.06 ACRE TRACT, A DISTANCE OF 1856.29 FEET TO A 3/8 INCH IRON ROD FOUND FOR THE SOUTHEAST CORNER OF SAID THOMAS M. FRIS TRACT;

THENCE, NORTH 00 DEGREES 05 MINUTES 19 SECONDS EAST, ALONG THE WEST LINE OF SAID 106.762 ACRE TRACT AND THE EAST LINE OF SAID THOMAS M. FRIS TRACT, A DISTANCE OF 794.23 FEET TO THE POINT OF BEGINNING, AND CONTAINING 423.553 ACRES OF LAND, MORE OR LESS.

Exhibit B-4
Legal Description
407.211 acres
(MUD 2/TRACT B)

BEING A 407.211 ACRE TRACT OF LAND SITUATED IN THE JOHN LARIMON SURVEY, ABSTRACT NO. 530, AND THE THOMAS BRUCE SURVEY, ABSTRACT NO. 103, COLLIN COUNTY, TEXAS, AND BEING PART OF A 158.524 ACRE TRACT OF LAND CONVEYED TO MA-BBO FIVE, L.P. BY DEED RECORDED IN COUNTY CLERK'S FILE NO. 20060718001344740, OFFICIAL PUBLIC RECORDS, COLLIN COUNTY, TEXAS AND BEING PART OF A 1113.084 ACRE TRACT OF LAND CONVEYED TO MA BB OWEN, L.P. BY DEED RECORDED IN COUNTY CLERK'S FILE NO. 20060616000829800, OFFICIAL PUBLIC RECORDS, COLLIN COUNTY, TEXAS. SAID 407.211 ACRE TRACT, WITH BEARING BASIS BEING GRID NORTH, TEXAS STATE PLANE COORDINATES, NORTH CENTRAL ZONE, NAD83 (CORS), DETERMINED BY GPS OBSERVATIONS ON JULIAN DAY 320, 2005, CALCULATED FROM DENTON CORS ARP (PID-DF8986), ARLINGTON RRP2 CORS ARP (PID-DF 5387) AND COLLIN CORS ARP (PID-8982), BEING MORE PARTICULARLY DESCRIBED BY METES AND BOUNDS AS FOLLOWS:

BEGINNING AT A POINT AT A NORTHWEST CORNER OF AFORESAID 1113.084 ACRE TRACT AND BEING THE SOUTHWEST CORNER OF A CALLED 0.998 ACRE TRACT OF LAND CONVEYED TO CHAMBERVILLE CEMETERY ASSOCIATION BY DEED RECORDED IN VOLUME 2034, PAGE 573, DEED RECORDS, COLLIN COUNTY, TEXAS AND BEING IN COLLIN COUNTY ROAD NO. 206 (A VARIABLE WIDTH PRESCRIPTIVE RIGHT-OF-WAY);

THENCE NORTH 89 DEGREES 45 MINUTES 16 SECONDS EAST, ALONG THE SOUTH LINE OF AFORESAID 0.998 ACRE TRACT, PASSING AT A DISTANCE OF 9.74 FEET A 5/8 INCH IRON ROD FOUND FOR WITNESS, CONTINUING A TOTAL DISTANCE OF 188.45 FEET TO A 5/8 INCH IRON ROD WITH A YELLOW PLASTIC CAP STAMPED "CARTER BURGESS" SET FOR AN INSIDE ELL CORNER OF AFORESAID 1113.084 ACRE TRACT AND BEING THE SOUTHEAST CORNER OF SAID 0.998 ACRE TRACT;

THENCE NORTH 00 DEGREES 55 MINUTES 15 SECONDS WEST, ALONG THE EAST LINE OF AFORESAID 0.998 ACRE TRACT PASSING AT A DISTANCE OF 177.66 FEET A 1/2 INCH IRON ROD FOUND FOR WITNESS, CONTINUING A TOTAL DISTANCE OF 206.50 FEET TO A POINT FOR A NORTHEAST CORNER OF SAID 0.998 ACRE TRACT AND BEING A NORTHWEST CORNER OF AFORESAID 1113.084 ACRE TRACT AND BEING IN THE APPROXIMATE CENTERLINE OF COLLIN COUNTY ROAD NO. 281 (A VARIABLE WIDTH PRESCRIPTIVE RIGHT-OF-WAY);

THENCE ALONG THE NORTH LINE OF AFORESAID 1113.084 ACRE TRACT AND THE APPROXIMATE CENTERLINE OF AFORESAID COLLIN COUNTY ROAD NO. 281 THE FOLLOWING COURSES AND DISTANCES:

SOUTH 88 DEGREES 11 MINUTES 52 SECONDS EAST, A DISTANCE OF 172.87 FEET TO A 5/8 INCH IRON ROD WITH YELLOW PLASTIC CAP STAMPED "CARTER BURGESS" SET FOR CORNER;

SOUTH 84 DEGREES 50 MINUTES 48 SECONDS EAST, A DISTANCE OF 300.57 FEET TO A 5/8 INCH IRON ROD WITH YELLOW PLASTIC CAP STAMPED "CARTER BURGESS" SET FOR CORNER;

SOUTH 88 DEGREES 57 MINUTES 46 SECONDS EAST, A DISTANCE OF 689.46 FEET TO A 5/8 INCH IRON ROD WITH YELLOW PLASTIC CAP STAMPED "CARTER BURGESS" SET FOR CORNER;

NORTH 89 DEGREES 51 MINUTES 11 SECONDS EAST, A DISTANCE OF 691.44 FEET TO A 5/8 INCH IRON ROD WITH YELLOW PLASTIC CAP STAMPED "CARTER BURGESS" SET FOR CORNER;

SOUTH 84 DEGREES 42 MINUTES 34 SECONDS EAST, A DISTANCE OF 623.13 FEET TO A 3/4 INCH IRON ROD FOUND FOR THE MOST NORTHERN NORTHEAST CORNER OF AFORESAID 1113.084 ACRE TRACT AND BEING THE NORTHWEST CORNER OF A CALLED 7.04 ACRE TRACT OF LAND CONVEYED TO ROBERT W. GANTER AND ELIZABETH A. GANTER BY DEED RECORDED IN COUNTY CLERK'S NO. 97-0024749. LAND RECORDS, COLLIN COUNTY, TEXAS;

SOUTH 00 DEGREES 29 MINUTES 01 SECONDS WEST, ALONG AN EAST LINE OF AFORESAID 1113.084 ACRE TRACT AND THE COMMON WEST LINE OF AFORESAID 7.04 ACRE TRACT, A DISTANCE OF 411.24 FEET TO A 1/2 INCH IRON PIPE FOUND FOR THE SOUTHWEST CORNER OF SAID 7.04 ACRE TRACT;

SOUTH 89 DEGREES 02 MINUTES 06 SECONDS EAST, ALONG THE NORTH LINE OF SAID 1113.084 ACRE TRACT AND THE COMMON SOUTH LINE OF AFORESAID 7.04 ACRE TRACT, A DISTANCE OF 1471.42 FEET TO A 1/2 INCH IRON PIPE FOUND FOR CORNER AND BEING ON THE WEST LINE OF A CALLED 5.660 ACRE TRACT OF LAND CONVEYED TO DONALD DWAYNE TUCKER AND WIFE, JEAN TUCKER RECORDED IN VOLUME 931, PAGE 368, DEED RECORDS, COLLIN COUNTY, TEXAS AND BEING IN THE APPROXIMATE CENTERLINE OF AFORESAID COLLIN COUNTY ROAD NO. 281;

THENCE SOUTH 00 DEGREES 40 MINUTES 36 SECONDS WEST, ALONG AN EAST LINE OF SAID 1113.084 ACRE TRACT AND THE COMMON WEST LINES OF AFORESAID 5.660 TUCKER TRACT AND OF A CALLED 1.39 ACRE TRACT OF LAND CONVEYED TO CALVIN JARRETT AND KAREN JARRETT BY DEED RECORDED IN COUNTY CLERK'S FILE NO. 2005-0097078, LAND RECORDS, COLLIN COUNTY,

TEXAS AND THE APPROXIMATE CENTERLINE OF AFORESAID COLLIN COUNTY ROAD NO. 281, A DISTANCE OF 537.51 FEET TO A POINT FOR THE CORNER;

THENCE, SOUTH 00 DEGREES 04 MINUTES 47 SECONDS WEST, OVER AND ACROSS SAID 1113.084 ACRE TRACT, A DISTANCE OF 2505.18 FEET TO A 1/2 INCH IRON ROD FOUND ON A SOUTH LINE OF SAID 1113.084 ACRE TRACT AND THE COMMON NORTHEAST CORNER OF A CALLED 3.000 ACRE TRACT OF LAND CONVEYED TO TERRY L. HARTWICK AND ROSE ETTA JONES BY DEED RECORDED IN COUNTY CLERK'S FILE NO. 2002-0001673, LAND RECORDS, COLLIN COUNTY, TEXAS;

THENCE, NORTH 89 DEGREES 54 MINUTES 23 SECONDS WEST, ALONG THE SOUTH LINE OF SAID 1113.084 ACRE TRACT, AND THE COMMON NORTH LINE OF SAID 3.000 ACRE TRACT, A DISTANCE OF 484.37 FEET TO A 5/8 INCH IRON ROD WITH YELLOW PLASTIC CAP STAMPED "CARTER BURGESS" SET FOR CORNER ON THE EAST LINE OF A 19.33 ACRE TRACT OF LAND CONVEYED TO TERRY L. HARTWICK AND ROSE ETTA JONES BY DEED RECORDED IN COUNTY CLERK'S FILE NO. 94-0065235, LAND RECORDS, COLLIN COUNTY, TEXAS;

THENCE, NORTH 00 DEGREES 14 MINUTES 32 SECONDS WEST, A DISTANCE OF 154.99 FEET TO A 5/8 INCH IRON ROD FOUND FOR THE NORTHEAST CORNER OF SAID 19.33 ACRE TRACT;

THENCE, NORTH 89 DEGREES 39 MINUTES 30 SECONDS WEST, ALONG THE SOUTH LINE OF SAID 1113.084 ACRE TRACT AND THE COMMON NORTH LINE OF SAID 19.33 ACRE TRACT, A DISTANCE OF 988.76 FEET TO A 5/8 INCH IRON ROD WITH YELLOW PLASTIC CAP STAMPED "CARTER BURGESS" SET FOR CORNER ON THE EAST LINE OF SAID 158.524 ACRE TRACT;

THENCE, SOUTH 00 DEGREES 26 MINUTES 33 SECONDS EAST, ALONG THE EAST LINE OF SAID 158.524 ACRE TRACT AND THE COMMON WEST LINES OF SAID 19.33 ACRE TRACT AND A CALLED 11.06 ACRE TRACT OF LAND CONVEYED TO HUGH P. McADAMS BY DEED RECORDED IN COUNTY CLERK'S FILE NO. 92-0003436, LAND RECORDS, COLLIN COUNTY, TEXAS, A DISTANCE OF 1763.02 FEET TO A POINT FOR THE SOUTHEAST CORNER OF SAID 158.524 ACRE TRACT AND BEING THE SOUTHWEST CORNER OF SAID 11.06 ACRE TRACT AND BEING IN THE APPROXIMATE CENTERLINE OF COLLIN COUNTY ROAD NO. 206 (A VARIABLE WIDTH PRESCRIPTIVE RIGHT-OF-WAY) AND BEING ON THE NORTH LINE OF A CALLED 72 ACRE TRACT OF LAND CONVEYED TO J.L. MELL, BEVERLY ANN ALLEN & NANCY JO. LAWRENCE BY DEED RECORDED IN COUNTY CLERKS' FILE NO. 2000-0101341, LAND RECORDS, COLLIN COUNTY, TEXAS;

THENCE NORTH 89 DEGREES 36 MINUTES 20 SECONDS WEST, ALONG THE SOUTH LINE OF AFORESAID 158.524 ACRE TRACT AND THE COMMON NORTH LINE OF AFORESAID 72 ACRE TRACT AND ALONG THE APPROXIMATE CENTERLINE OF AFORESAID COLLIN COUNTY ROAD NO. 206 A DISTANCE OF 576.42 FEET TO A POINT FOR AN ELL CORNER OF SAID 158.524 ACRE TRACT AND BEING THE SOUTHEAST CORNER OF THE REMAINDER OF A TRACT OF LAND CONVEYED TO

DONALD M. MOTSENBACKER AND WIFE, NORMA FAYE MOTSENBACKER BY DEED RECORDED IN VOLUME 2678, PAGE 833, DEED RECORDS, COLLIN COUNTY, TEXAS;

THENCE ALONG THE COMMON LINES BETWEEN AFORESAID 158.524 ACRE TRACT AND AFORESAID REMAINDER MOTSENBACKER TRACT THE FOLLOWING COURSES AND DISTANCES:

NORTH 01 DEGREES 01 MINUTES 34 SECONDS EAST, PASSING AT A DISTANCE OF 28.19 FEET A 1/2 INCH IRON ROD FOUND FOR WITNESS, CONTINUING A TOTAL DISTANCE OF 95.45 FEET TO A 1/2 INCH IRON ROD FOUND FOR CORNER;

NORTH 46 DEGREES 22 MINUTES 09 SECONDS WEST, A DISTANCE OF 30.04 FEET TO A 1/2 INCH IRON ROD FOUND FOR CORNER;

NORTH 01 DEGREES 02 MINUTES 48 SECONDS EAST, A DISTANCE OF 66.35 FEET TO A 1/2 INCH IRON ROD FOUND FOR CORNER;

NORTH 48 DEGREES 15 MINUTES 02 SECONDS WEST, A DISTANCE OF 30.38 FEET TO A 1/2 INCH IRON ROD FOUND FOR CORNER;

NORTH 01 DEGREES 27 MINUTES 43 SECONDS EAST, A DISTANCE OF 66.57 FEET TO A 1/2 INCH IRON ROD FOUND FOR CORNER;

NORTH 46 DEGREES 58 MINUTES 13 SECONDS WEST, A DISTANCE OF 23.59 FEET TO A 1/2 INCH IRON ROD FOUND FOR CORNER;

NORTH 00 DEGREES 24 MINUTES 20 SECONDS EAST, A DISTANCE OF 25.48 FEET TO A 1/2 INCH IRON ROD FOUND FOR CORNER;

NORTH 71 DEGREES 03 MINUTES 06 SECONDS EAST, A DISTANCE OF 10.41 FEET TO A 1/2 INCH IRON ROD FOUND FOR CORNER;

NORTH 39 DEGREES 44 MINUTES 59 SECONDS EAST, A DISTANCE OF 10.78 FEET TO A 1/2 INCH IRON ROD FOUND FOR CORNER;

NORTH 00 DEGREES 21 MINUTES 32 SECONDS WEST, A DISTANCE OF 98.69 FEET TO A 1/2 INCH IRON ROD FOUND FOR CORNER;

NORTH 43 DEGREES 09 MINUTES 55 SECONDS WEST, A DISTANCE OF 11.67 FEET TO A 1/2 INCH IRON ROD FOUND FOR CORNER;

NORTH 88 DEGREES 23 MINUTES 42 SECONDS WEST, A DISTANCE OF 201.10 FEET TO A 1/2 INCH IRON ROD FOUND FOR CORNER;

SOUTH 46 DEGREES 23 MINUTES 42 SECONDS WEST, A DISTANCE OF 10.70 FEET TO A 1/2 INCH IRON ROD FOUND FOR CORNER;

SOUTH 14 DEGREES 06 MINUTES 56 SECONDS WEST, A DISTANCE OF 10.35 FEET TO A 1/2 INCH IRON ROD FOUND FOR CORNER;

SOUTH 01 DEGREES 47 MINUTES 24 SECONDS WEST, A DISTANCE OF 81.41 FEET TO A 1/2 INCH IRON ROD FOUND FOR CORNER;

SOUTH 19 DEGREES 38 MINUTES 16 SECONDS EAST, A DISTANCE OF 10.39 FEET TO A 1/2 INCH IRON ROD FOUND FOR CORNER;

SOUTH 52 DEGREES 48 MINUTES 19 SECONDS EAST, A DISTANCE OF 10.82 FEET TO A 1/2 INCH IRON ROD FOUND FOR CORNER;

SOUTH 76 DEGREES 36 MINUTES 21 SECONDS EAST, A DISTANCE OF 10.30 FEET TO A 1/2 INCH IRON ROD FOUND FOR CORNER;

SOUTH 02 DEGREES 21 MINUTES 20 SECONDS WEST, A DISTANCE OF 25.12 FEET TO A 1/2 INCH IRON ROD FOUND FOR CORNER;

SOUTH 47 DEGREES 10 MINUTES 36 SECONDS WEST, A DISTANCE OF 33.81 FEET TO A 1/2 INCH IRON ROD FOUND FOR CORNER;

SOUTH 00 DEGREES 47 MINUTES 06 SECONDS EAST, A DISTANCE OF 63.78 FEET TO A 1/2 INCH IRON ROD FOUND FOR CORNER;

SOUTH 44 DEGREES 58 MINUTES 54 SECONDS WEST, A DISTANCE OF 31.86 FEET TO A 1/2 INCH IRON ROD FOUND FOR CORNER;

SOUTH 00 DEGREES 34 MINUTES 55 SECONDS EAST, A DISTANCE OF 65.94 FEET TO A 1/2 INCH IRON ROD FOUND FOR CORNER;

SOUTH 48 DEGREES 15 MINUTES 30 SECONDS WEST, A DISTANCE OF 30.58 FEET TO A 1/2 INCH IRON ROD FOUND FOR CORNER;

SOUTH 00 DEGREES 40 MINUTES 17 SECONDS EAST, PASSING AT A DISTANCE OF 66.78 FEET A 1/2 INCH IRON ROD FOUND FOR WITNESS, CONTINUING A TOTAL DISTANCE OF 95.05 FEET TO A POINT FOR AN ELL CORNER OF AFORESAID 158.524 ACRE TRACT AND THE SOUTHWEST CORNER OF AFORESAID REMAINDER MOTSENBACKER TRACT AND BEING ON THE NORTH LINE OF A CALLED 36.145 ACRE TRACT OF LAND CONVEYED TO CAROLYN PUTNEY BY DEED RECORDED IN COUNTY CLERK'S FILE NO. 2003-0016137, LAND RECORDS, COLLIN COUNTY, TEXAS AND BEING IN THE APPROXIMATE CENTERLINE OF AFORESAID COLLIN COUNTY ROAD NO.206;

THENCE NORTH 89 DEGREES 36 MINUTES 20 SECONDS WEST, ALONG THE SOUTH LINE OF AFORESAID 158.524 ACRE TRACT AND THE COMMON NORTH LINE OF AFORESAID 36.145 ACRE TRACT AND THE APPROXIMATE CENTERLINE OF AFORESAID COLLIN COUNTY ROAD NO. 206, A DISTANCE OF 1762.31 FEET TO A POINT FOR CORNER;

THENCE NORTH 00 DEGREES 08 MINUTES 15 SECONDS WEST, PASSING AT A DISTANCE OF 26.32 FEET A 1/2 INCH IRON ROD FOUND FOR WITNESS, CONTINUING ALONG THE WEST LINE OF AFORESAID 158.524 ACRE TRACT AND THE COMMON EAST LINE OF THE FOLLOWING TRACTS, A CALLED 22.030 ACRE TRACT OF LAND CONVEYED TO BILLY J. DRURY, ET AL BY DEED RECORDED IN VOLUME 1043, PAGE 346, DEED RECORDS, COLLIN COUNTY, TEXAS AND A CALLED 22.030 ACRE TRACT OF LAND CONVEYED TO JIMMIE L. DRURY BY DEED RECORDED IN COUNTY CLERK'S FILE NO. 2003-0060252, LAND RECORDS, COLLIN COUNTY, TEXAS AND A CALLED 3.67 ACRE TRACT OF LAND CONVEYED TO RODNEY C. NIXON BY DEED RECORDED IN COUNTY CLERK'S FILE NO. 93-0108403, LAND RECORDS, COLLIN COUNTY, TEXAS AND A CALLED 3.67 ACRE TRACT OF LAND CONVEYED TO RODNEY C. NIXON BY DEED RECORDED IN COUNTY CLERK'S FILE NO. 93-0108402, LAND RECORDS, COLLIN COUNTY, TEXAS AND A CALLED 11.015 ACRE TRACT OF LAND CONVEYED TO QUIDA NIXON BY DEED RECORDED IN VOLUME 1043, PAGE 338, DEED RECORDS, COLLIN COUNTY, TEXAS AND A CALLED 11.015 ACRE TRACT OF LAND CONVEYED TO DEAN ANDERSON BY DEED RECORDED IN VOLUME 1043, PAGE 333, DEED RECORDS, COLLIN COUNTY, TEXAS AND ALONG THE APPROXIMATE CENTERLINE OF AFORESAID COLLIN COUNTY ROAD NO. 206, A DISTANCE OF 2672.26 FEET TO A POINT FOR CORNER;

THENCE, SOUTH 88 DEGREES 53 MINUTES 46 SECONDS EAST, A DISTANCE OF 19.61 FEET TO A 5/8 INCH IRON ROD WITH A YELLOW PLASTIC CAP STAMPED "CARTER BURGESS" SET FOR THE SOUTHWEST CORNER OF SAID 1113.084 ACRE TRACT;

THENCE ALONG THE WEST LINE OF AFORESAID 1113.084 ACRE TRACT THE FOLLOWING COURSES AND DISTANCES:

NORTH 00 DEGREES 12 MINUTES 11 SECONDS WEST, A DISTANCE OF 1035.01 FEET TO A POINT FOR CORNER;

NORTH 00 DEGREES 50 MINUTES 11 SECONDS WEST, A DISTANCE OF 1248.29 FEET TO THE POINT OF BEGINNING, AND CONTAINING 407.211 ACRES OF LAND, MORE OR LESS.

EXHIBIT C

Location of Delivery Point and Metering Station

