

SITE & LEVEL 1 PLAN

April 27, 2015

PRELIMINARY

Concept 1A



CHARLOTTE
CHICAGO
CLEVELAND
DALLAS
INDIANAPOLIS
KALAMAZOO
PHILADELPHIA

Carl Walker, Inc.
2801 Network Blvd.
Suite 101
Frisco, TX 75034
P - 214.619.0700

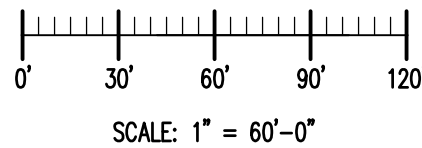

Sheet 1 of 14

City of McKinney
Proposed Parking Structure
McKinney, Texas

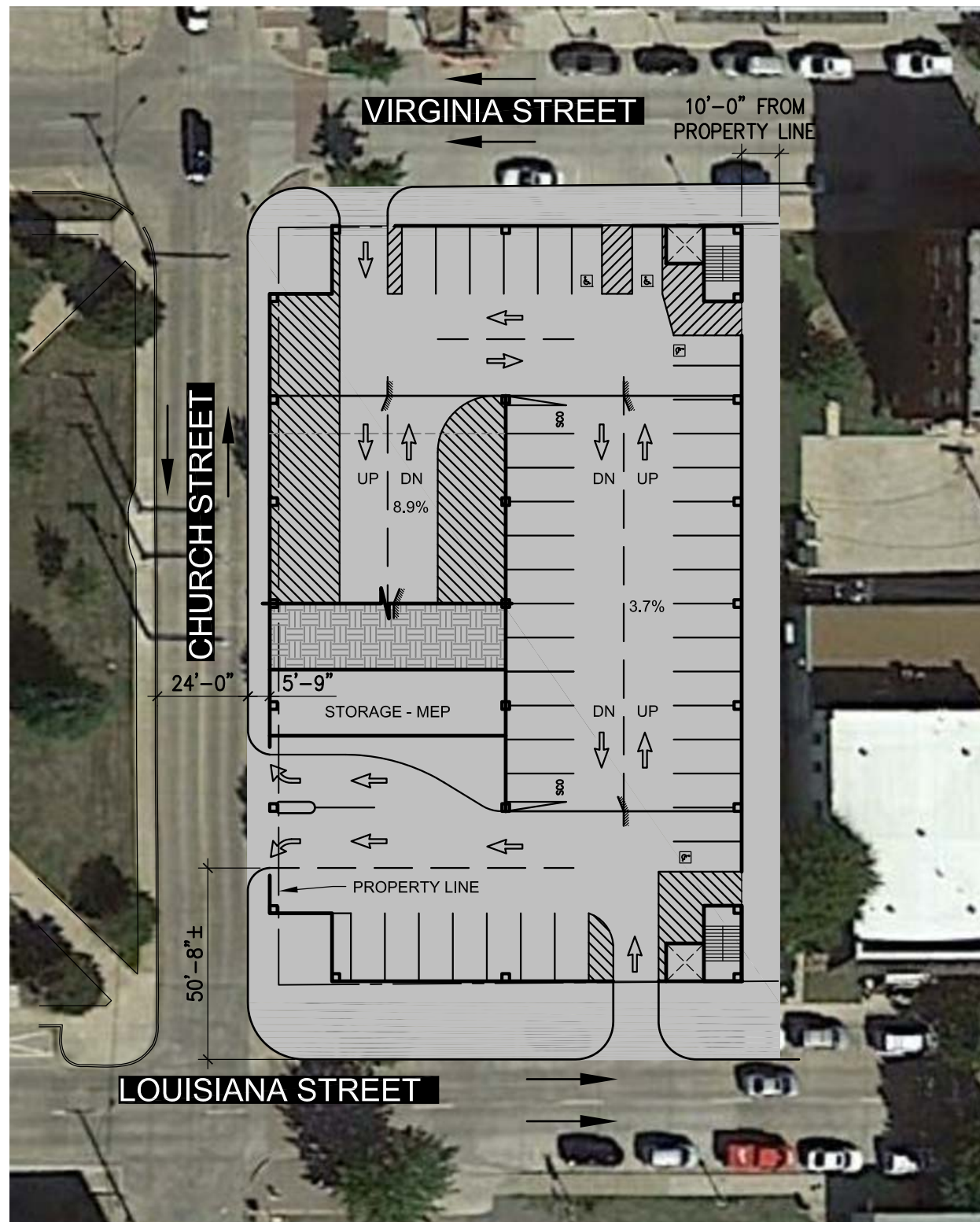

SITE & LEVEL 1 PLAN

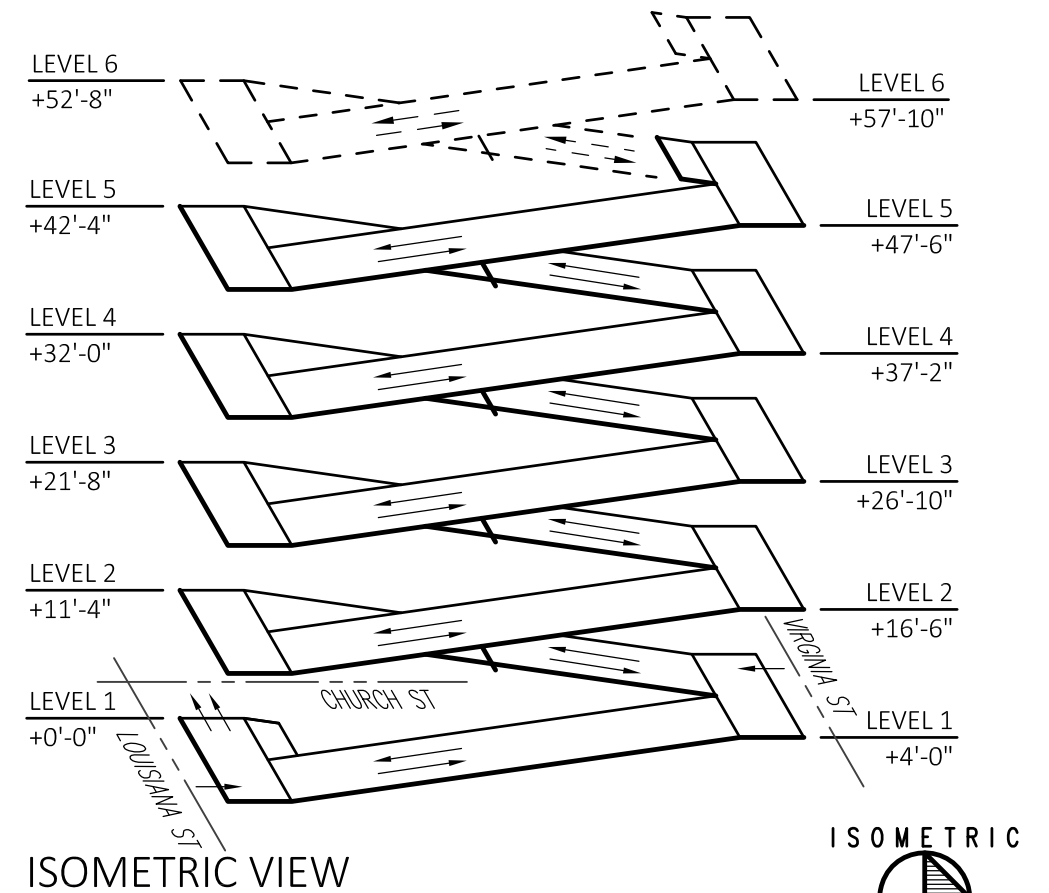

ISOMETRIC VIEW

NOT TO SCALE

ISOMETRIC



NORTH

SPACE TABULATION

| DESCRIPTION | STANDARD | SCO | ADA | TOTAL | AREA (SF) |
|-------------------------------|----------------|-----|-----|-------|-----------|
| LEVEL 5 | 64 | 3 | --- | 67 | 22,200 |
| LEVEL 4 | 72 | 4 | --- | 76 | 24,400 |
| LEVEL 3 | 70 | 4 | 2 | 76 | 24,400 |
| LEVEL 2 | 70 | 4 | 2 | 76 | 24,400 |
| LEVEL 1 | 36 | 2 | 4 | 42 | 23,300 |
| TOTAL | 312 | 17 | 8 | 337 | 118,700 |
| EXISTING LOT | 71 | --- | 4 | 75 | --- |
| NET GAIN | 241 | 17 | 4 | 262 | --- |
| STANDARD SPACE SIZE | 9'-0" X 18'-0" | | | | |
| COMPACT CAR SPACE SIZE | 8'-0" X 15'-0" | | | | |
| PARKING EFFICIENCY (SF/SPACE) | 352 | | | | |

NOTES:
 NUMBER OF SPACES ADDED WITH LEVEL 6 = 76 SPACES, TOTAL NUMBER OF SPACES = 413 SPACES (TOP LEVEL EL. = +57'-10")

Concept 1A

April 27, 2015

PRELIMINARY



CHARLOTTE
 CHICAGO
 CLEVELAND
 DALLAS
 INDIANAPOLIS
 KALAMAZOO
 PHILADELPHIA

Carl Walker, Inc.
 2801 Network Blvd.
 Suite 101
 Frisco, TX 75034
 P - 214.619.0700

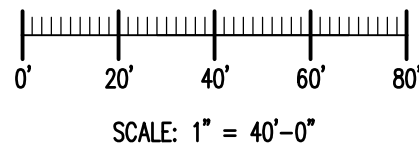

NORTH

Sheet 2 of 14

City of McKinney
 Proposed Parking Structure
 McKinney, Texas

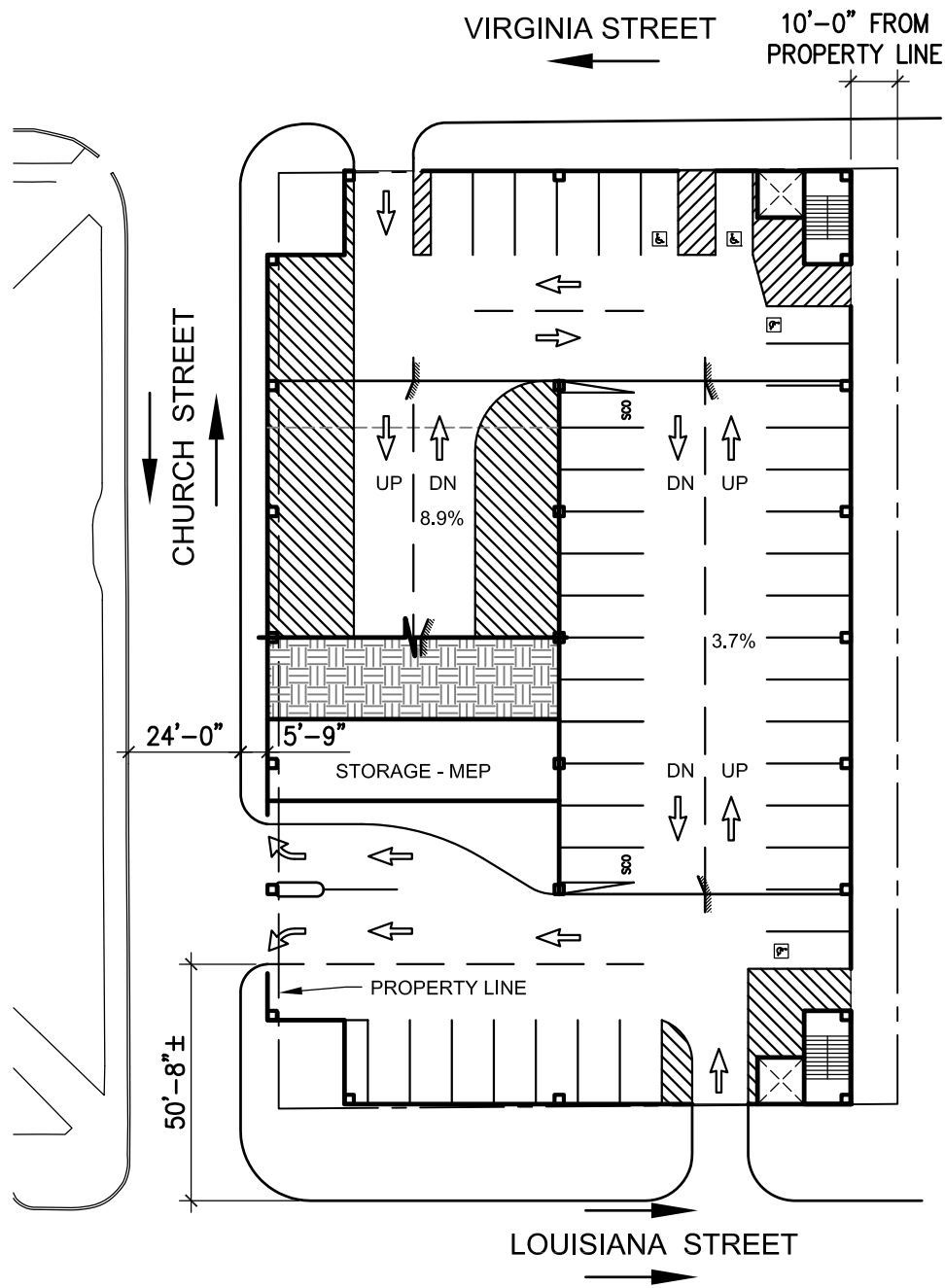

LEVEL 1 PLAN

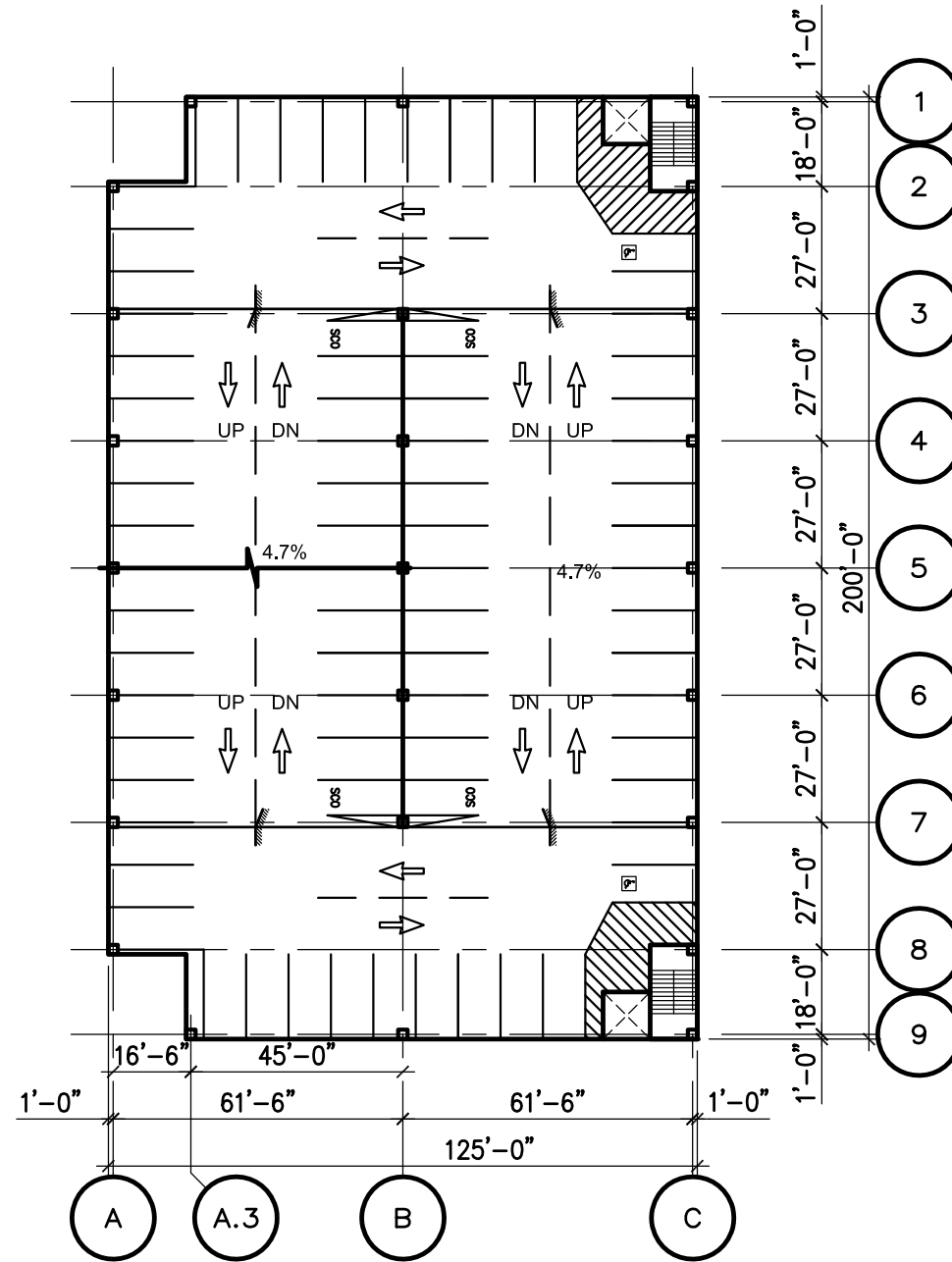

TYPICAL LEVEL PLAN (2, 3 & 4)

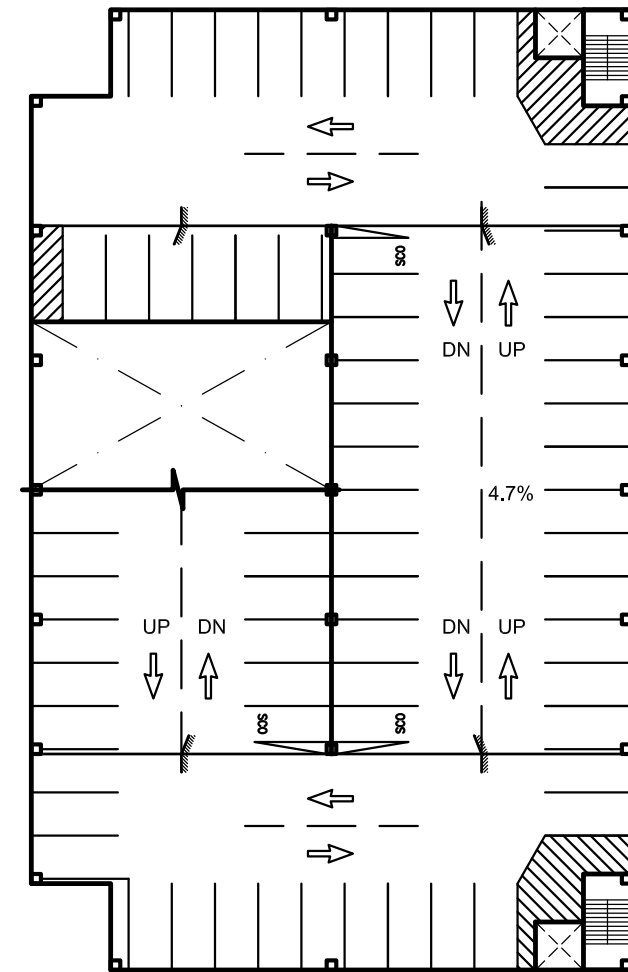

LEVEL 5 PLAN

April 27, 2015

PRELIMINARY

Concept 1A



CHARLOTTE
CHICAGO
CLEVELAND
DALLAS
INDIANAPOLIS
KALAMAZOO
PHILADELPHIA

Carl Walker, Inc.
2801 Network Blvd.
Suite 101
Frisco, TX 75034
P - 214.619.0700

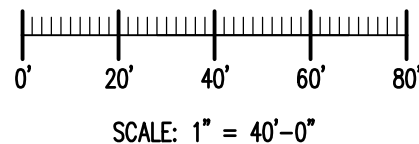

Sheet 3 of 14

City of McKinney
Proposed Parking Structure
McKinney, Texas

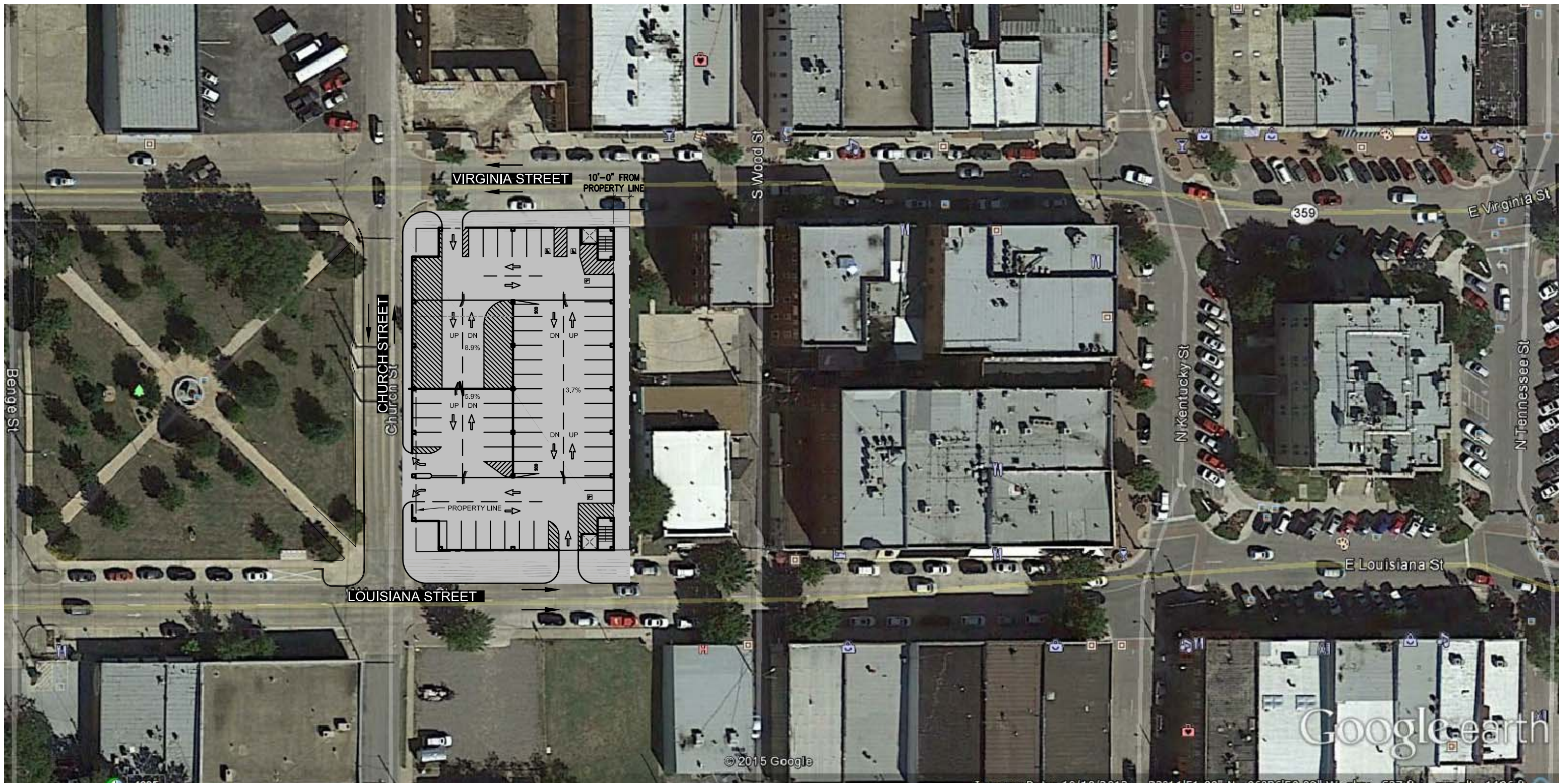

SITE & LEVEL 1 PLAN

April 27, 2015

PRELIMINARY

Concept 1B



CHARLOTTE
CHICAGO
CLEVELAND
DALLAS
INDIANAPOLIS
KALAMAZOO
PHILADELPHIA

Carl Walker, Inc.
2801 Network Blvd.
Suite 101
Frisco, TX 75034
P - 214.619.0700

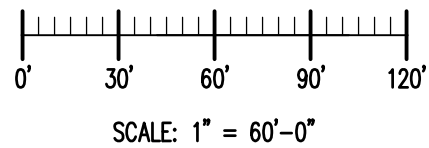

Sheet 4 of 14

City of McKinney
Proposed Parking Structure
McKinney, Texas

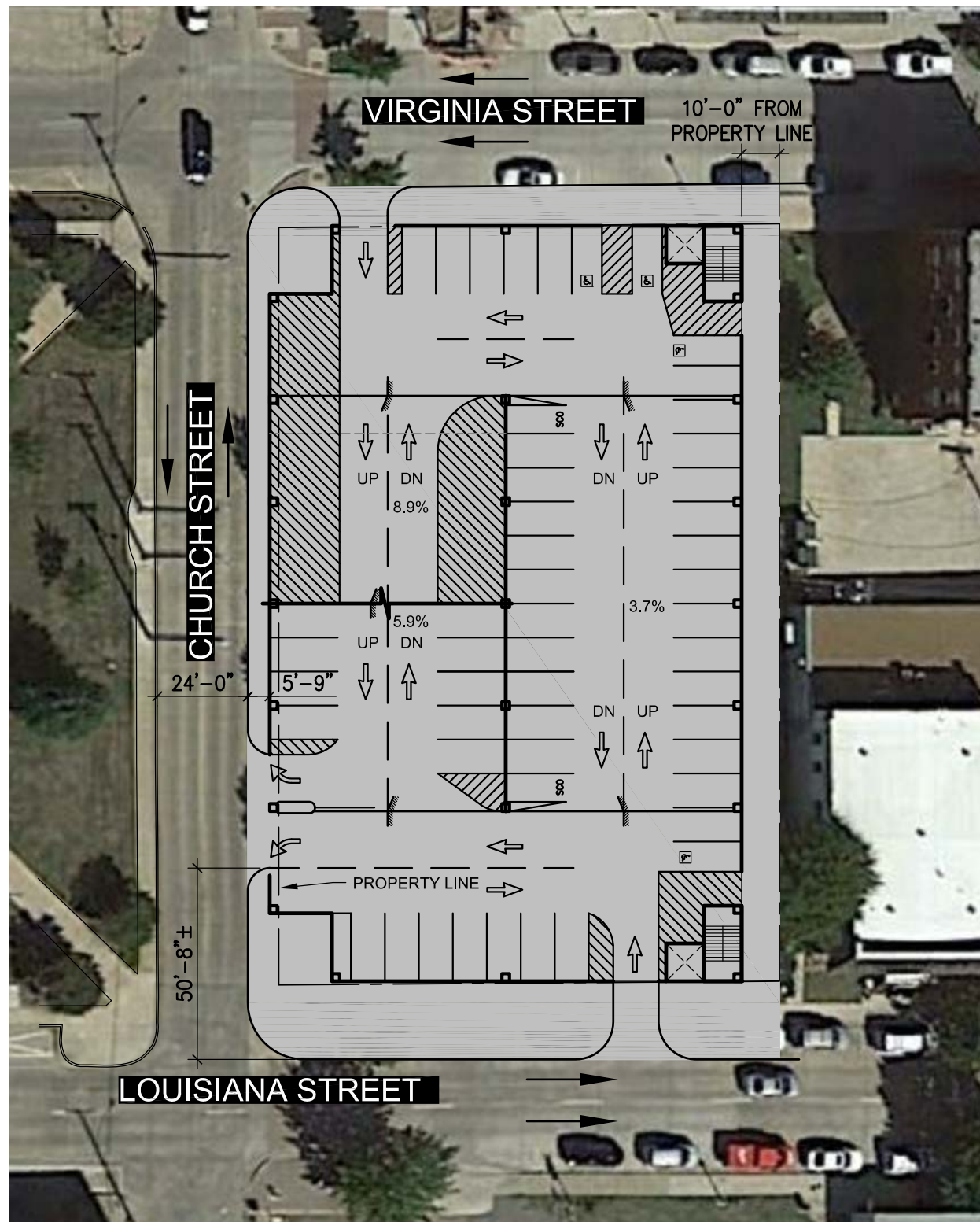

SITE & LEVEL 1 PLAN

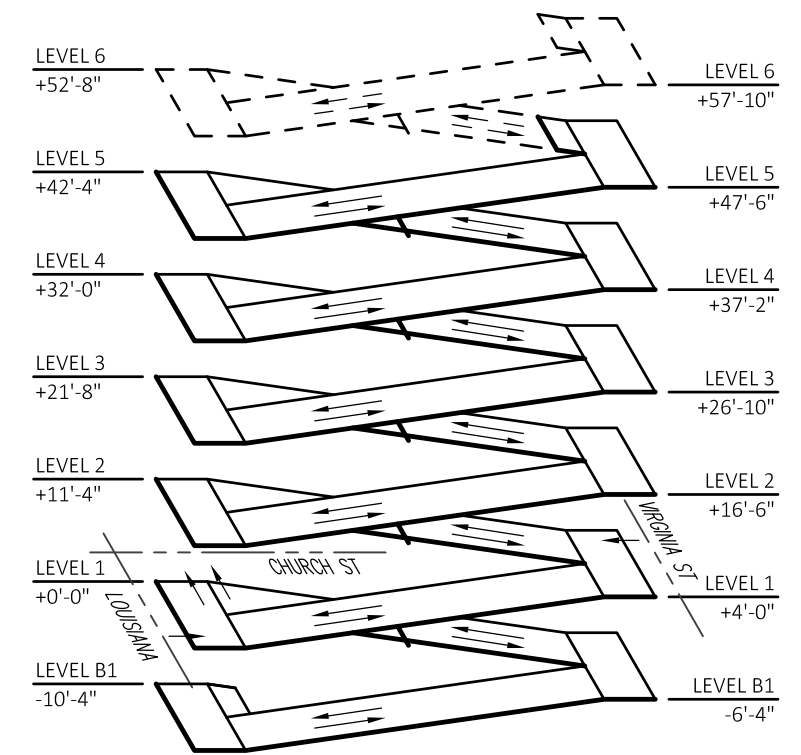

ISOMETRIC VIEW

NOT TO SCALE



SPACE TABULATION

| DESCRIPTION | STANDARD | SCO | ADA | TOTAL | AREA (SF) |
|-------------------------------|----------|-----|-----|----------------|-----------|
| LEVEL 5 | 64 | 3 | --- | 67 | 22,200 |
| LEVEL 4 | 72 | 4 | --- | 76 | 24,400 |
| LEVEL 3 | 70 | 4 | 2 | 76 | 24,400 |
| LEVEL 2 | 70 | 4 | 2 | 76 | 24,400 |
| LEVEL 1 | 45 | 2 | 4 | 51 | 24,400 |
| LEVEL B1 | 64 | 3 | --- | 67 | 23,300 |
| TOTAL | 385 | 20 | 8 | 413 | 143,100 |
| EXISTING LOT | 71 | --- | 4 | 75 | --- |
| NET GAIN | 314 | 20 | 4 | 338 | --- |
| STANDARD SPACE SIZE | | | | 9'-0" X 18'-0" | |
| COMPACT CAR SPACE SIZE | | | | 8'-0" X 15'-0" | |
| PARKING EFFICIENCY (SF/SPACE) | | | | 346 | |

NOTES:
 NUMBER OF SPACES ADDED WITH LEVEL 6 = 76 SPACES, TOTAL NUMBER OF SPACES = 489 SPACES (TOP LEVEL EL. = +57'-10")

April 27, 2015

PRELIMINARY

Concept 1B



CHARLOTTE
 CHICAGO
 CLEVELAND
 DALLAS
 INDIANAPOLIS
 KALAMAZOO
 PHILADELPHIA

Carl Walker, Inc.
 2801 Network Blvd.
 Suite 101
 Frisco, TX 75034
 P - 214.619.0700

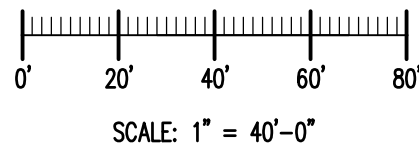

Sheet 5 of 14

City of McKinney
 Proposed Parking Structure
 McKinney, Texas

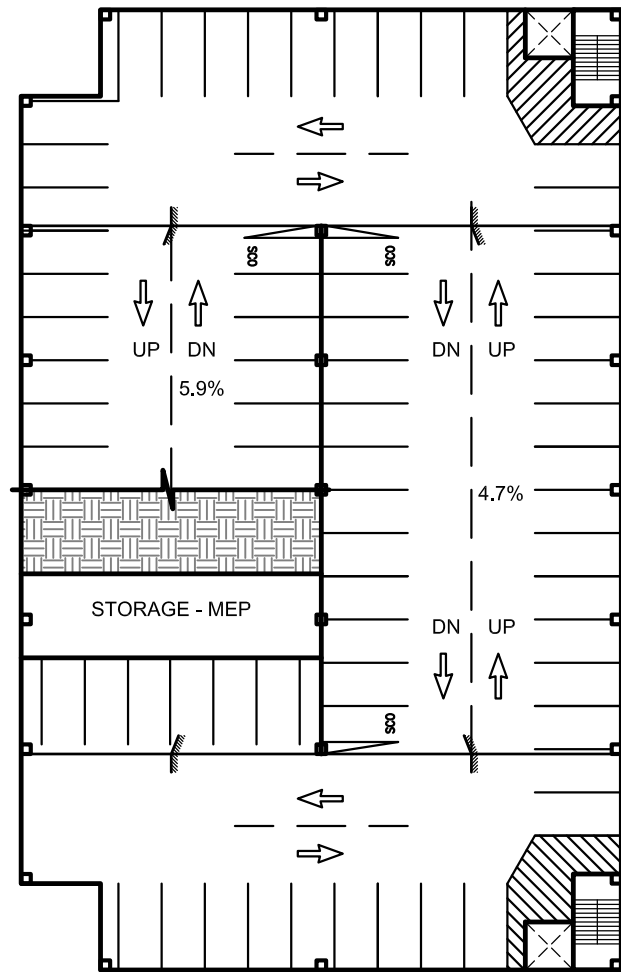

BASEMENT PLAN

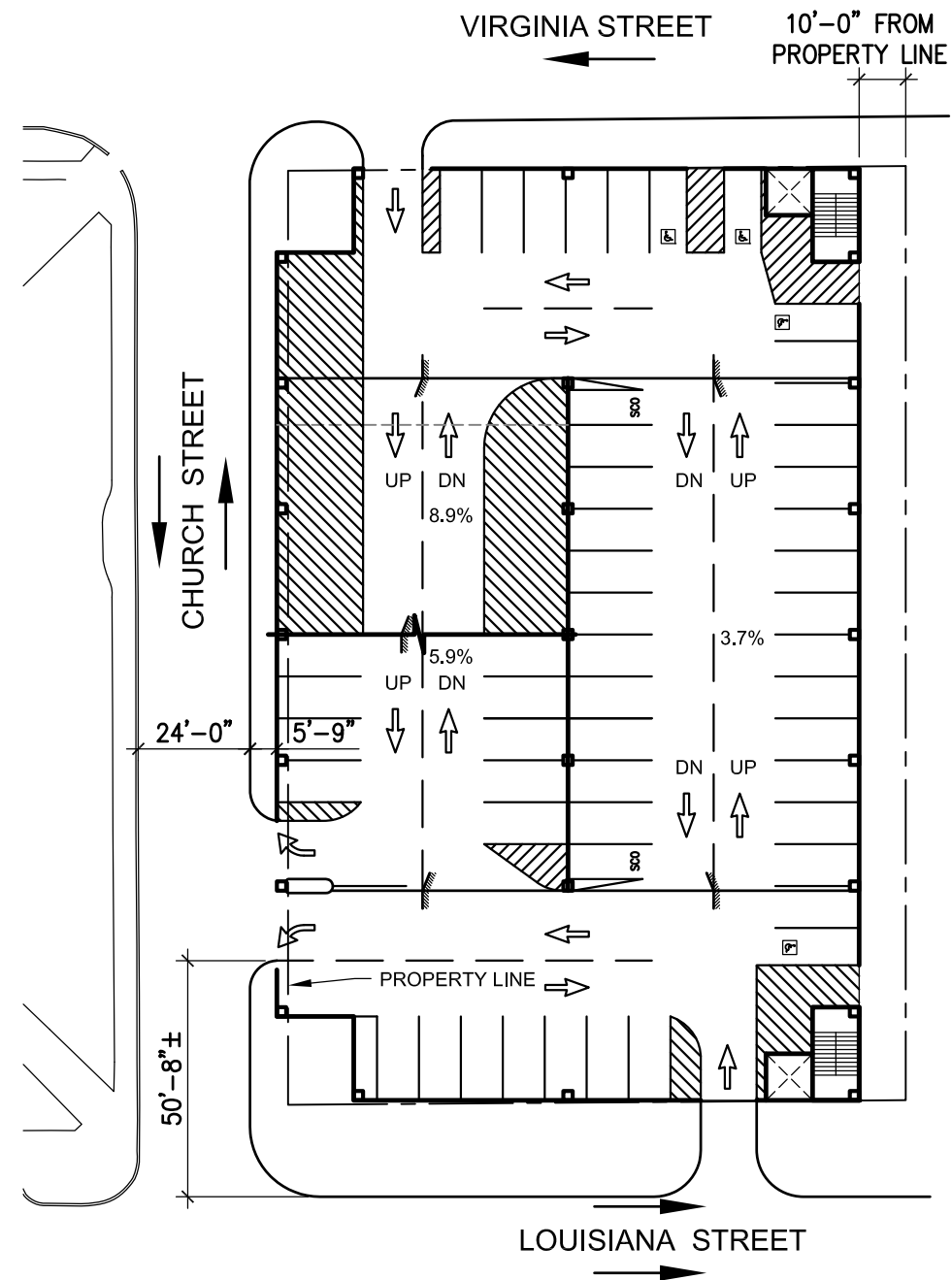

LEVEL 1 PLAN

PRELIMINARY

April 27, 2015

Concept 1B



CHARLOTTE
CHICAGO
CLEVELAND
DALLAS
INDIANAPOLIS
KALAMAZOO
PHILADELPHIA

Carl Walker, Inc.
2801 Network Blvd.
Suite 101
Frisco, TX 75034
P - 214.619.0700

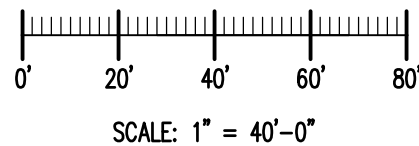

Sheet 6 of 14

City of McKinney
Proposed Parking Structure
McKinney, Texas

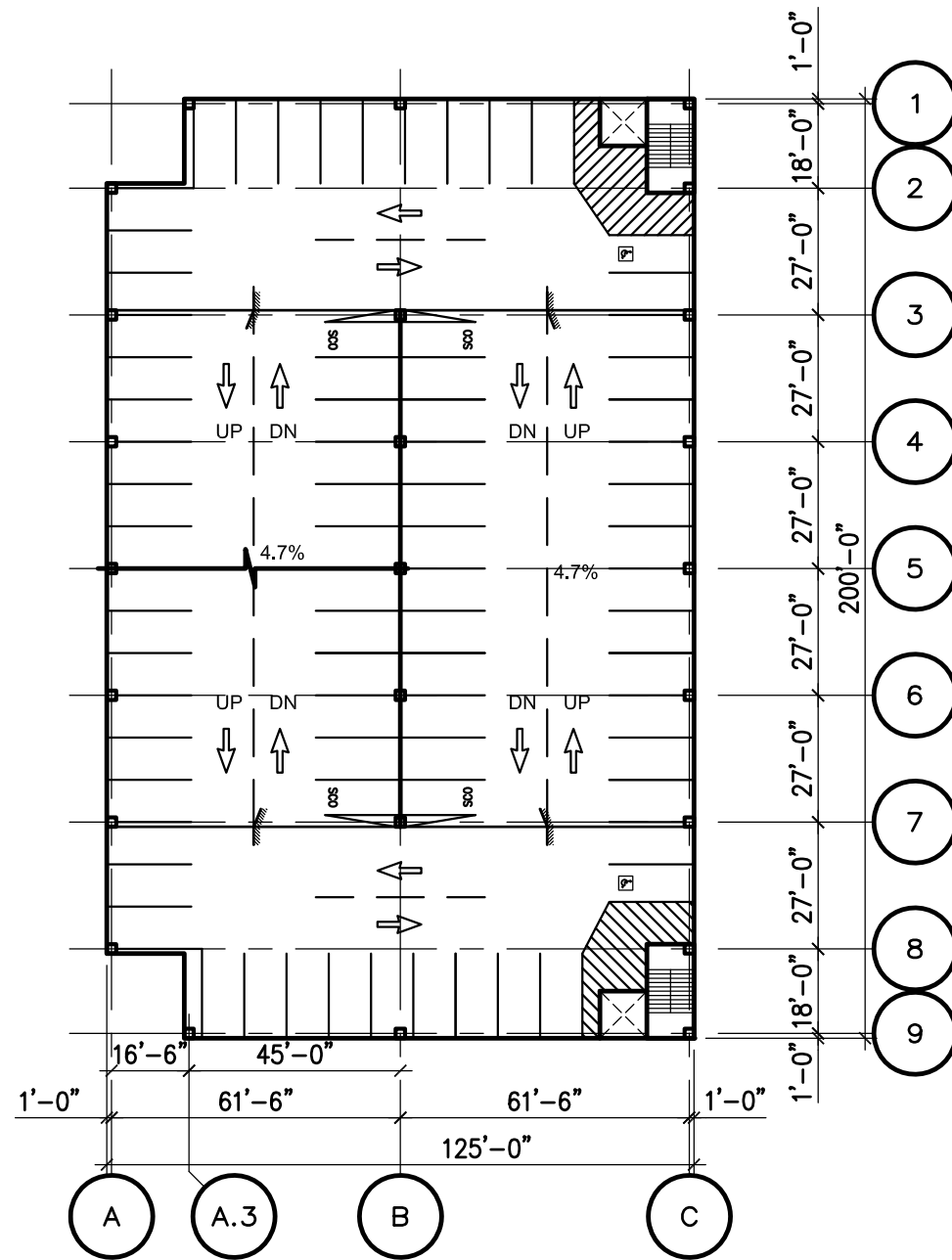

TYPICAL LEVEL PLAN (2, 3 & 4)

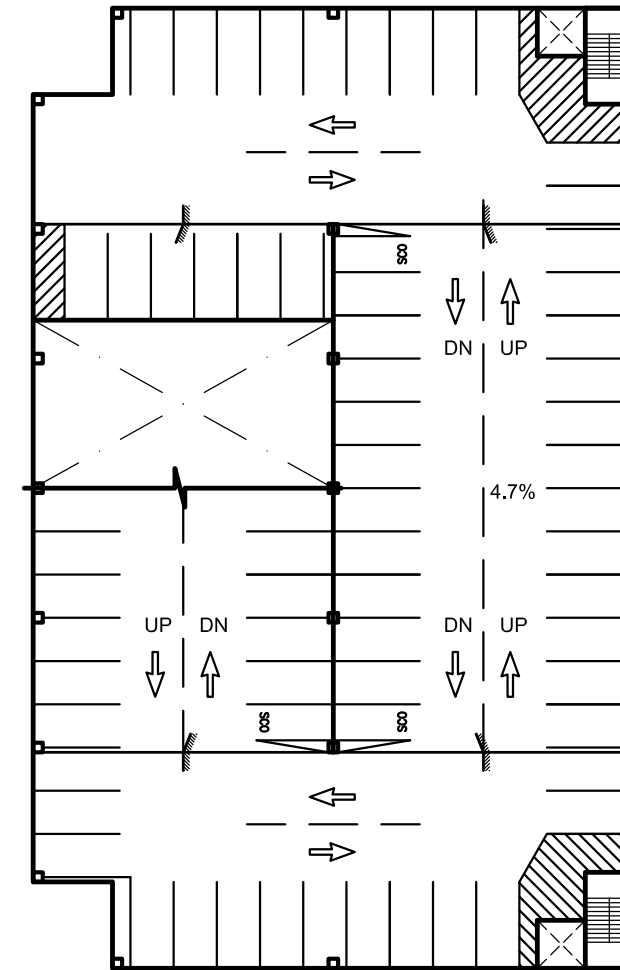

LEVEL 5 PLAN

PRELIMINARY

April 27, 2015

Concept 1B



CHARLOTTE
CHICAGO
CLEVELAND
DALLAS
INDIANAPOLIS
KALAMAZOO
PHILADELPHIA

Carl Walker, Inc.
2801 Network Blvd.
Suite 101
Frisco, TX 75034
P - 214.619.0700

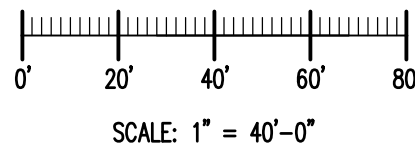

Sheet 7 of 14

City of McKinney
Proposed Parking Structure
McKinney, Texas

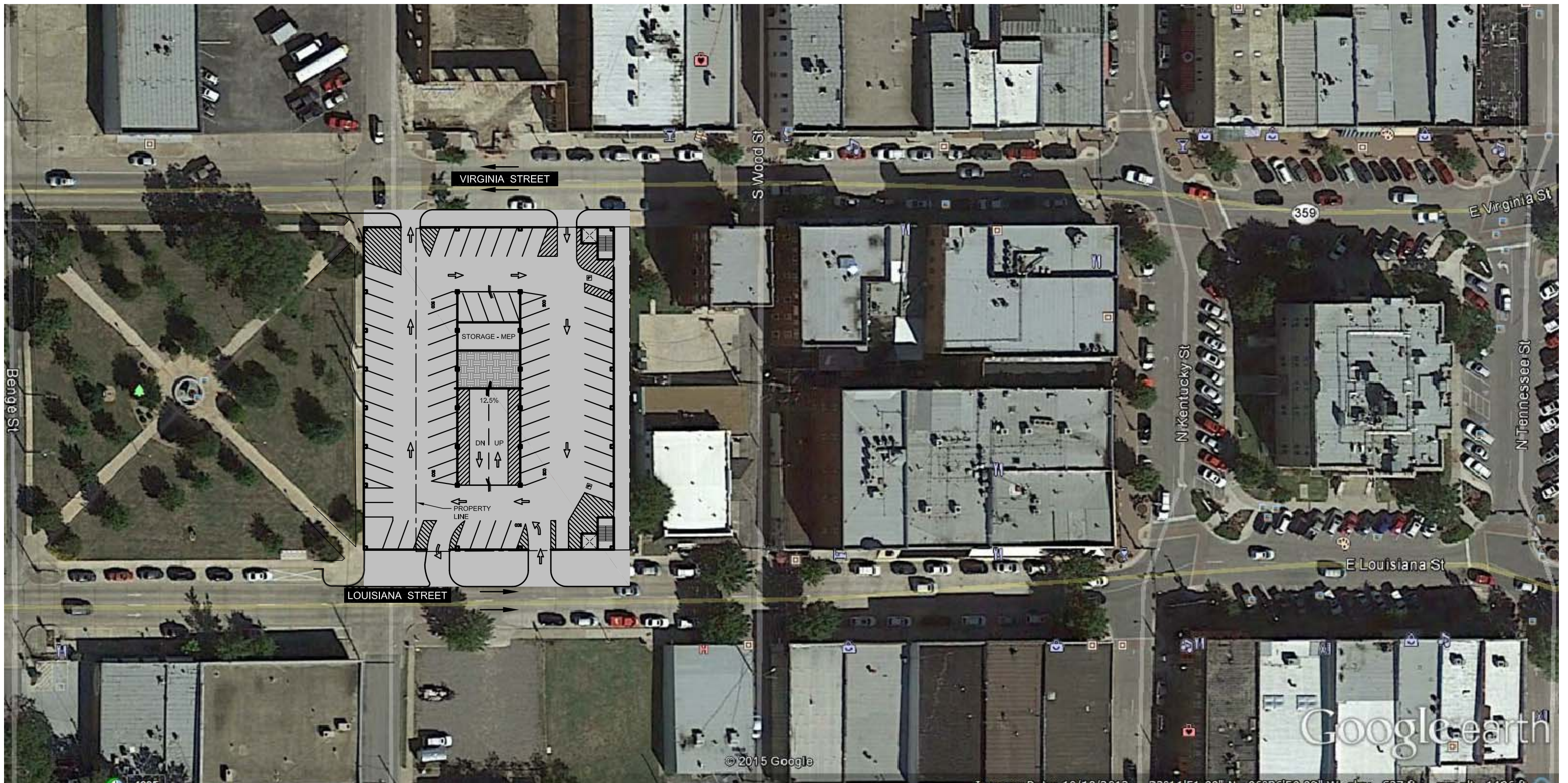

SITE & LEVEL 1 PLAN

April 27, 2015

PRELIMINARY

Concept 2A



CHARLOTTE
CHICAGO
CLEVELAND
DALLAS
INDIANAPOLIS
KALAMAZOO
PHILADELPHIA

Carl Walker, Inc.
2801 Network Blvd.
Suite 101
Frisco, TX 75034
P - 214.619.0700

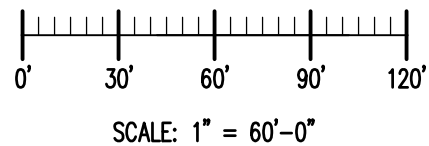

Sheet 8 of 14

City of McKinney
Proposed Parking Structure
McKinney, Texas

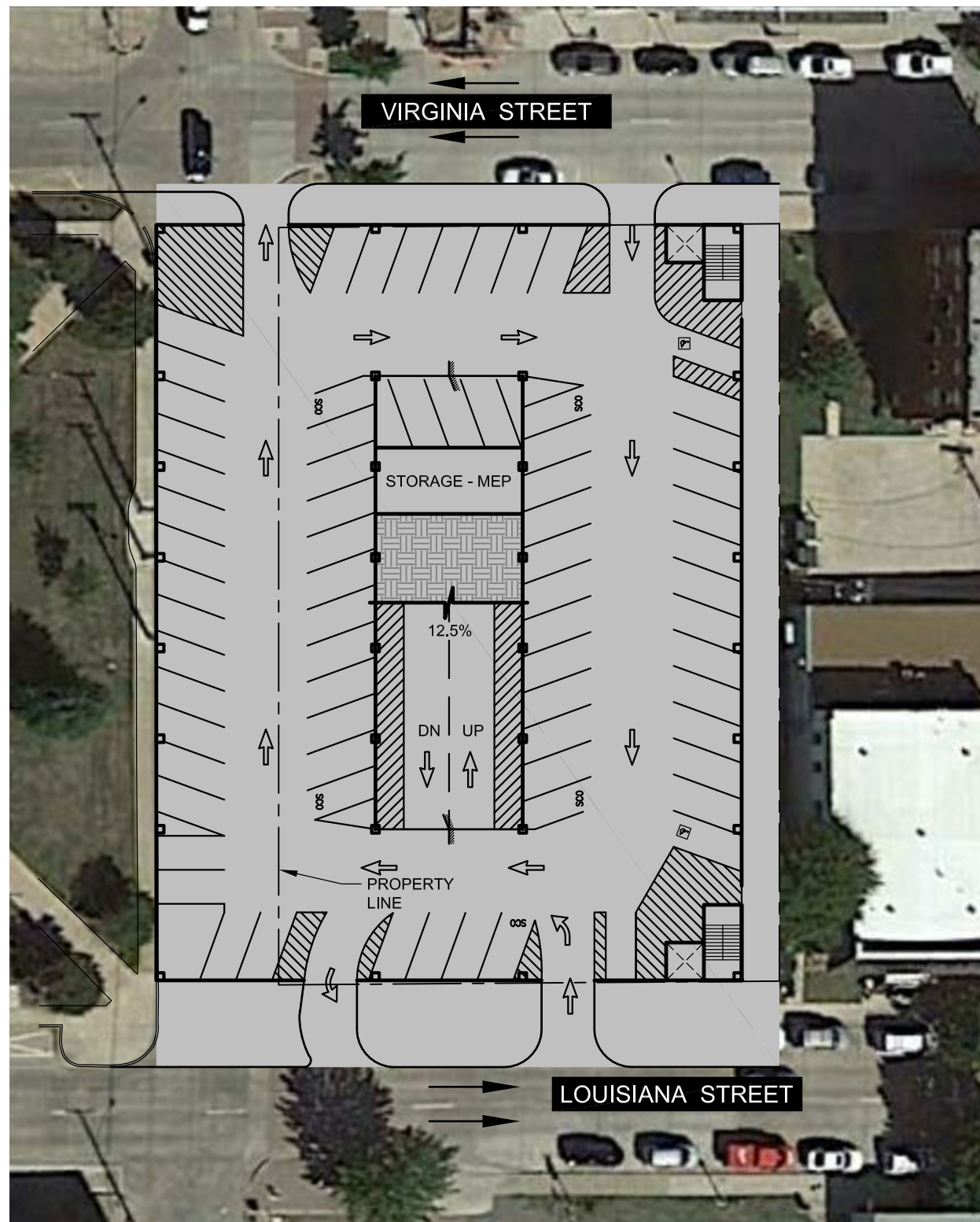

SITE & LEVEL 1 PLAN

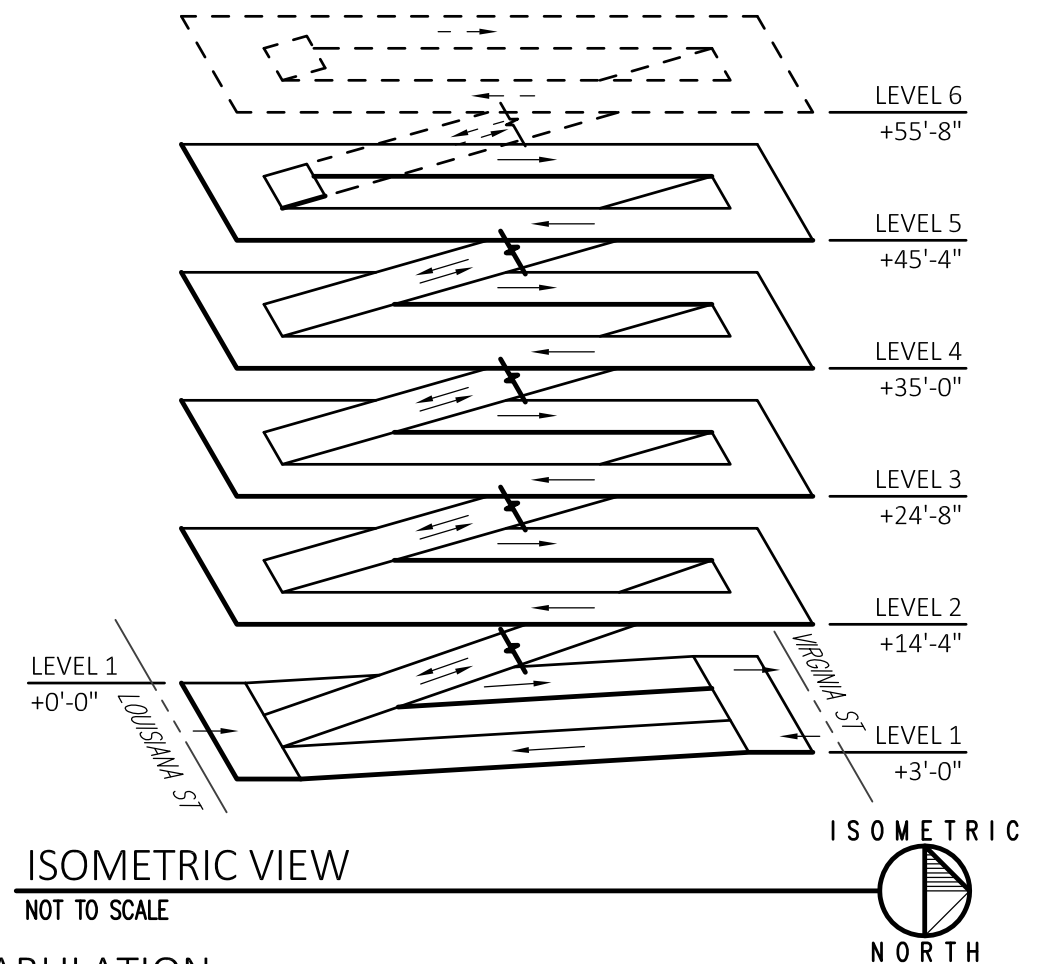

ISOMETRIC VIEW
NOT TO SCALE

SPACE TABULATION

| DESCRIPTION | STANDARD | SCO | ADA | TOTAL | AREA (SF) |
|-------------------------------|---|-----|-----|-------|-----------|
| LEVEL 5 | 80 | 4 | --- | 84 | 28,500 |
| LEVEL 4 | 75 | 4 | 2 | 81 | 31,000 |
| LEVEL 3 | 75 | 4 | 2 | 81 | 31,000 |
| LEVEL 2 | 75 | 4 | 2 | 81 | 31,000 |
| LEVEL 1 | 63 | 5 | 2 | 70 | 29,500 |
| TOTAL | 368 | 21 | 8 | 397 | 151,000 |
| EXISTING LOT | 71 | --- | 4 | 75 | --- |
| NET GAIN | 297 | 21 | 4 | 322 | --- |
| STANDARD SPACE SIZE | 9'-0" X 18'-0" (70° & 90° PARKING ANGLES) | | | | |
| COMPACT CAR SPACE SIZE | 8'-0" X 15'-0" | | | | |
| PARKING EFFICIENCY (SF/SPACE) | 380 | | | | |

NOTES:
NUMBER OF SPACES ADDED WITH LEVEL 6 = 81 SPACES, TOTAL NUMBER OF SPACES = 478 (TOP LEVEL EL. = 55'-8")

Concept 2A

April 27, 2015

PRELIMINARY

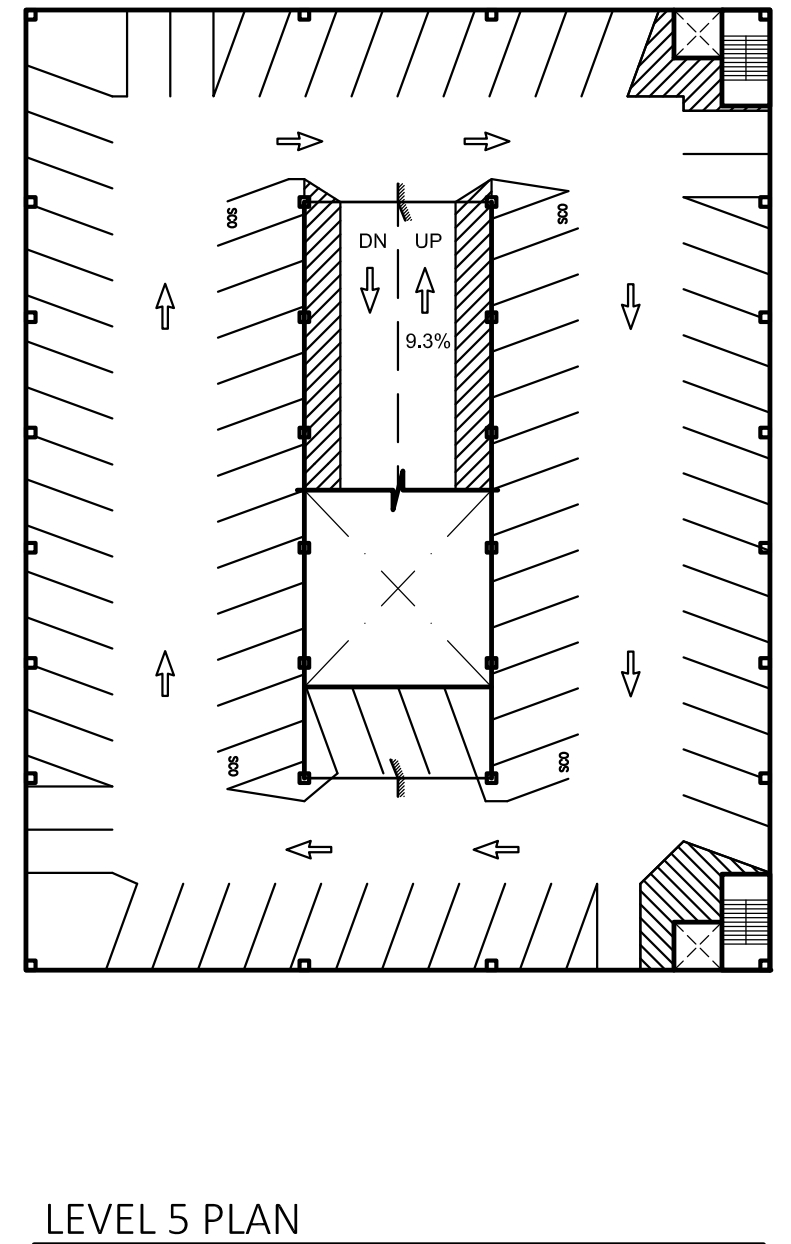
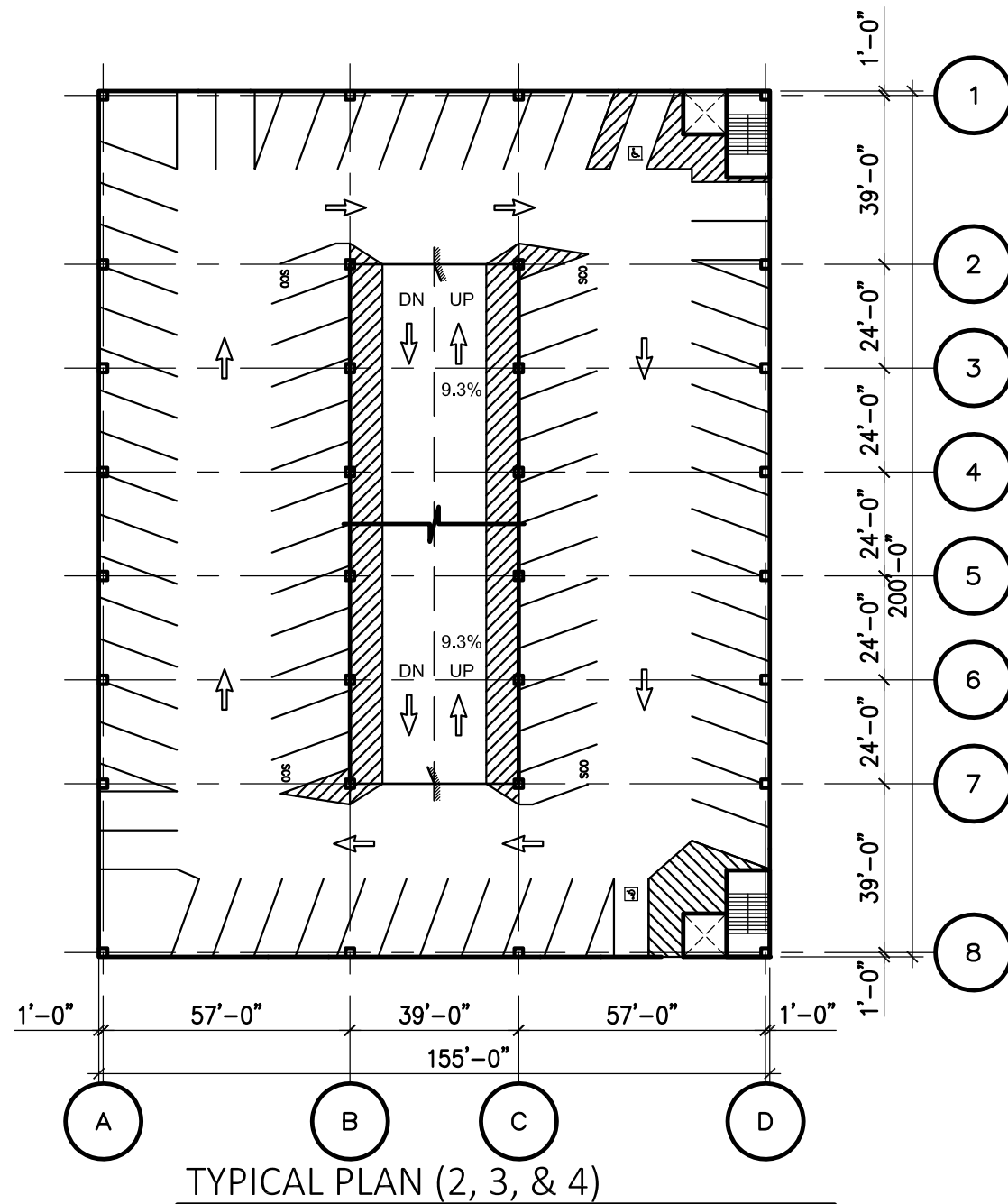
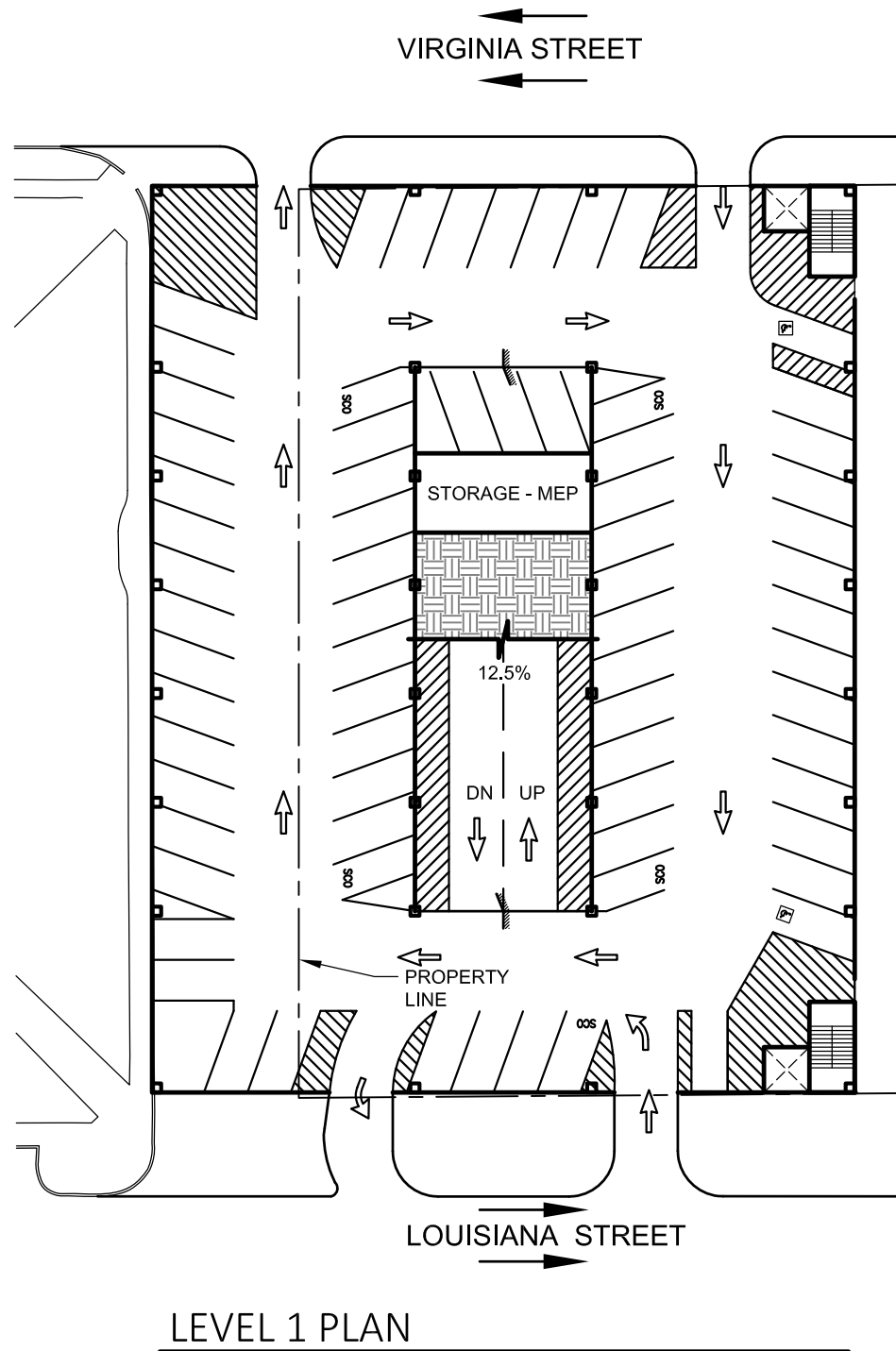

April 27, 2015

PRELIMINARY

Concept 2A



CHARLOTTE
CHICAGO
CLEVELAND
DALLAS
INDIANAPOLIS
KALAMAZOO
PHILADELPHIA

Carl Walker, Inc.
2801 Network Blvd.
Suite 101
Frisco, TX 75034
P - 214.619.0700

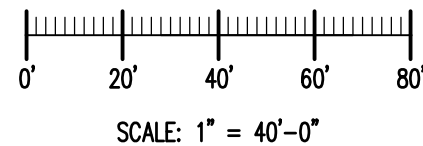

Sheet 10 of 14

City of McKinney
Proposed Parking Structure
McKinney, Texas

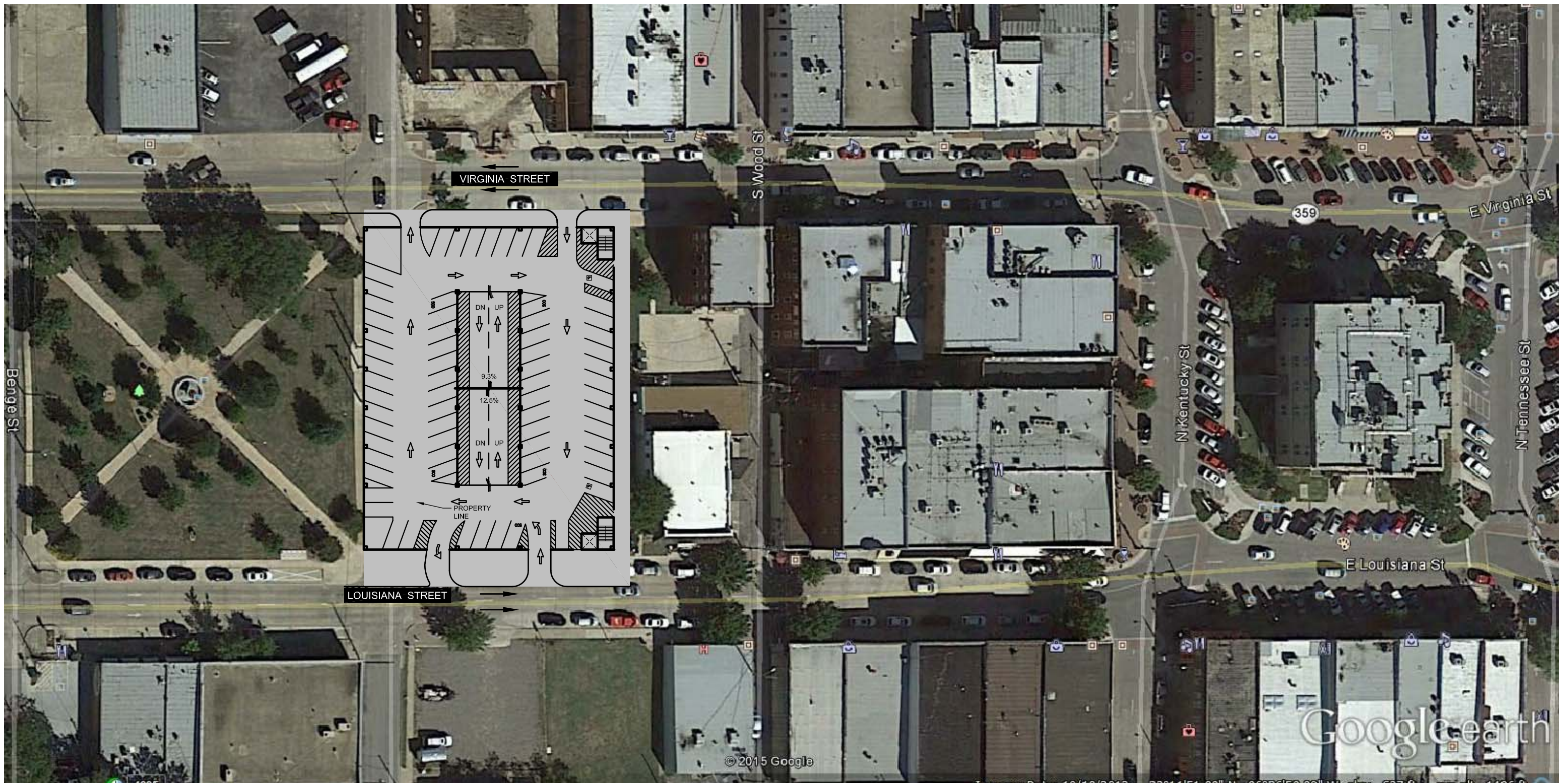

SITE & LEVEL 1 PLAN

April 27, 2015

PRELIMINARY

Concept 2B



CHARLOTTE
CHICAGO
CLEVELAND
DALLAS
INDIANAPOLIS
KALAMAZOO
PHILADELPHIA

Carl Walker, Inc.
2801 Network Blvd.
Suite 101
Frisco, TX 75034
P - 214.619.0700

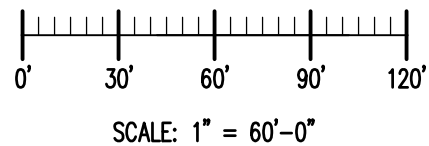

Sheet 11 of 14

City of McKinney
Proposed Parking Structure
McKinney, Texas

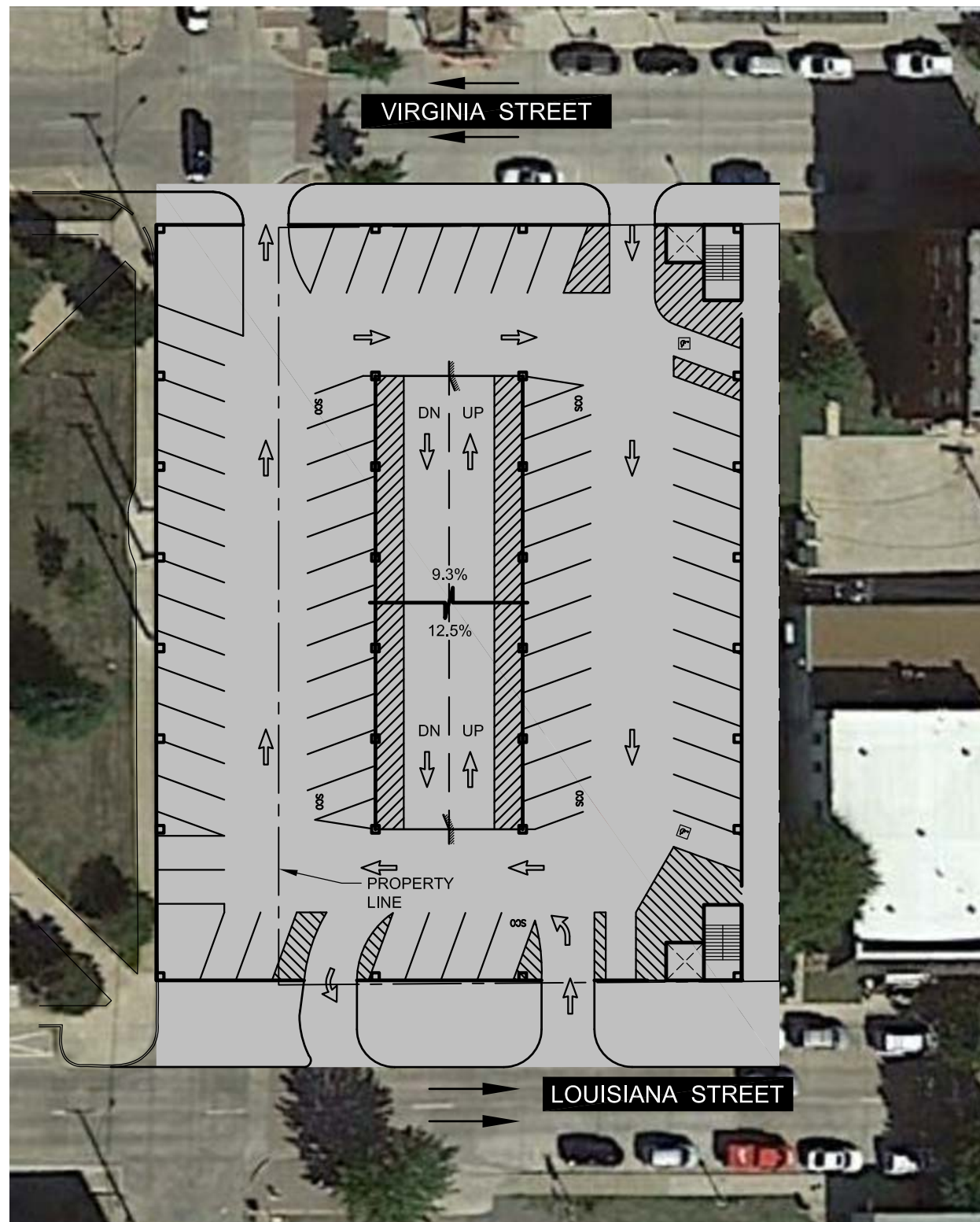

SITE & LEVEL 1 PLAN

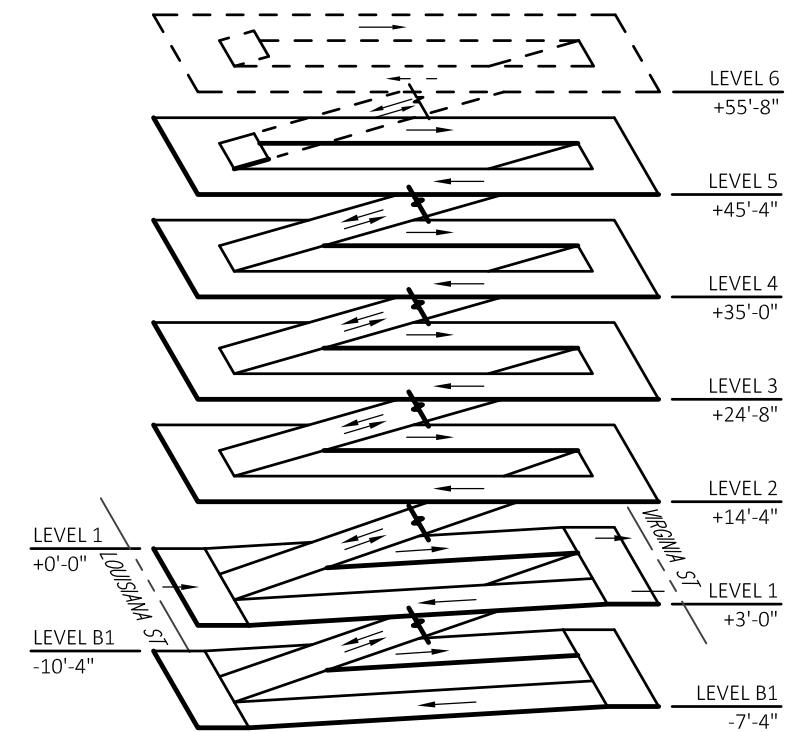

ISOMETRIC VIEW

NOT TO SCALE

ISOMETRIC



NORTH

SPACE TABULATION

| DESCRIPTION | STANDARD | SCO | ADA | TOTAL | AREA (SF) |
|-------------------------------|---|-----------|-----------|------------|----------------|
| LEVEL 5 | 80 | 4 | --- | 84 | 28,500 |
| LEVEL 4 | 75 | 4 | 2 | 81 | 31,000 |
| LEVEL 3 | 75 | 4 | 2 | 81 | 31,000 |
| LEVEL 2 | 75 | 4 | 2 | 81 | 31,000 |
| LEVEL 1 | 60 | 5 | 2 | 67 | 31,000 |
| LEVEL B1 | 76 | 4 | 2 | 82 | 30,100 |
| TOTAL | 441 | 25 | 10 | 476 | 182,600 |
| EXISTING LOT | 71 | --- | 4 | 75 | --- |
| NET GAIN | 370 | 25 | 6 | 401 | --- |
| STANDARD SPACE SIZE | 9'-0" X 18'-0" (70° & 90° PARKING ANGLES) | | | | |
| COMPACT CAR SPACE SIZE | 8'-0" X 15'-0" | | | | |
| PARKING EFFICIENCY (SF/SPACE) | 384 | | | | |

NOTES:

NUMBER OF SPACES ADDED WITH LEVEL 6 = 81 SPACES, TOTAL NUMBER OF SPACES = 557 (TOP LEVEL EL. = 55'-8")

Concept 2B

April 27, 2015

PRELIMINARY



CHARLOTTE
CHICAGO
CLEVELAND
DALLAS
INDIANAPOLIS
KALAMAZOO
PHILADELPHIA

Carl Walker, Inc.
2801 Network Blvd.
Suite 101
Frisco, TX 75034
P - 214.619.0700

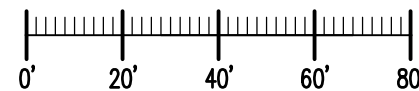

SCALE: 1" = 40'-0"



NORTH

Sheet 12 of 14

City of McKinney
Proposed Parking Structure
McKinney, Texas

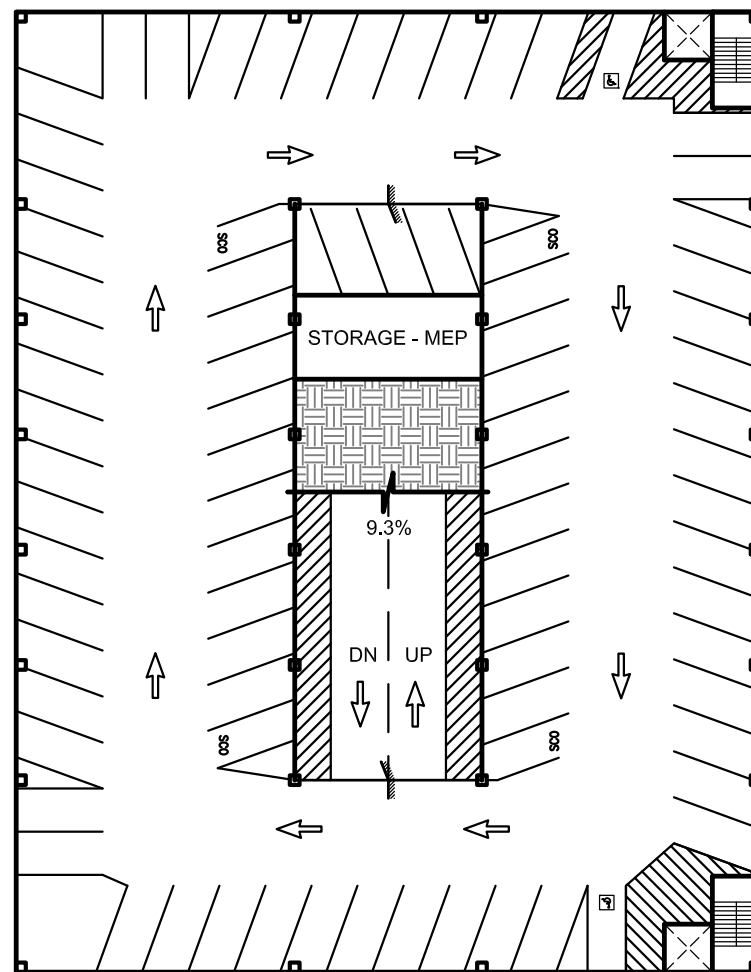

BASEMENT PLAN

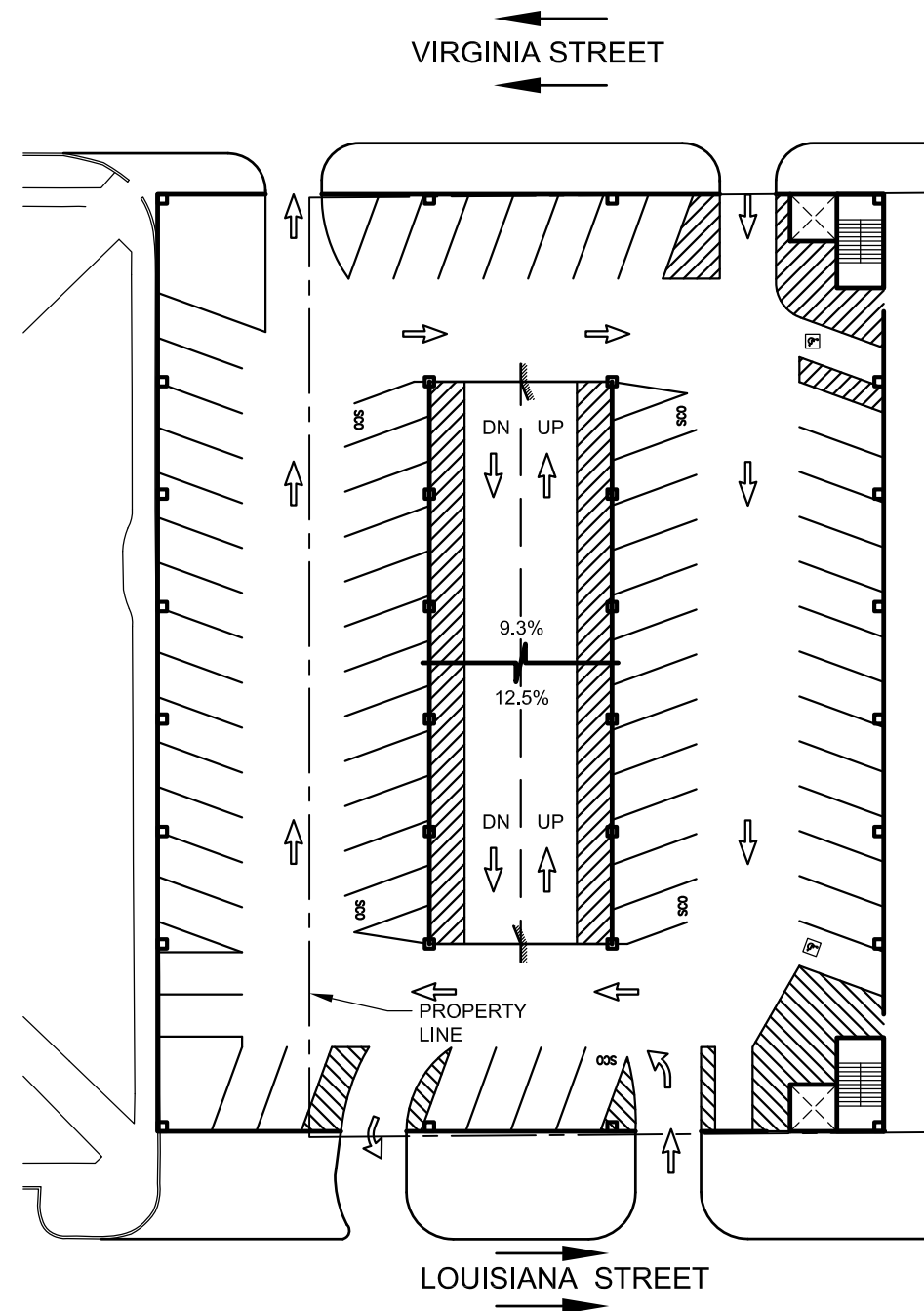

LEVEL 1 PLAN

April 27, 2015

PRELIMINARY

Concept 2B



CHARLOTTE
CHICAGO
CLEVELAND
DALLAS
INDIANAPOLIS
KALAMAZOO
PHILADELPHIA

Carl Walker, Inc.
2801 Network Blvd.
Suite 101
Frisco, TX 75034
P - 214.619.0700

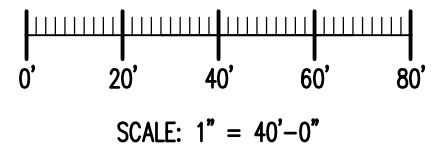

Sheet 13 of 14

City of McKinney
Proposed Parking Structure
McKinney, Texas

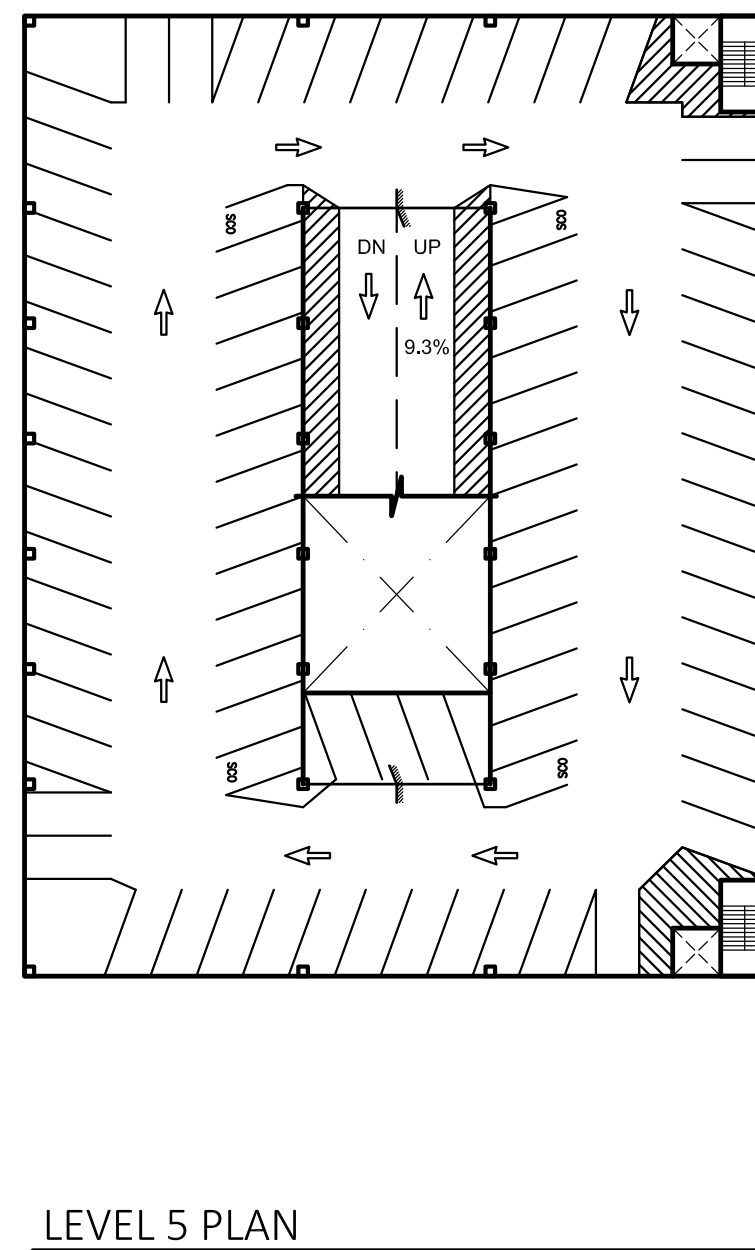
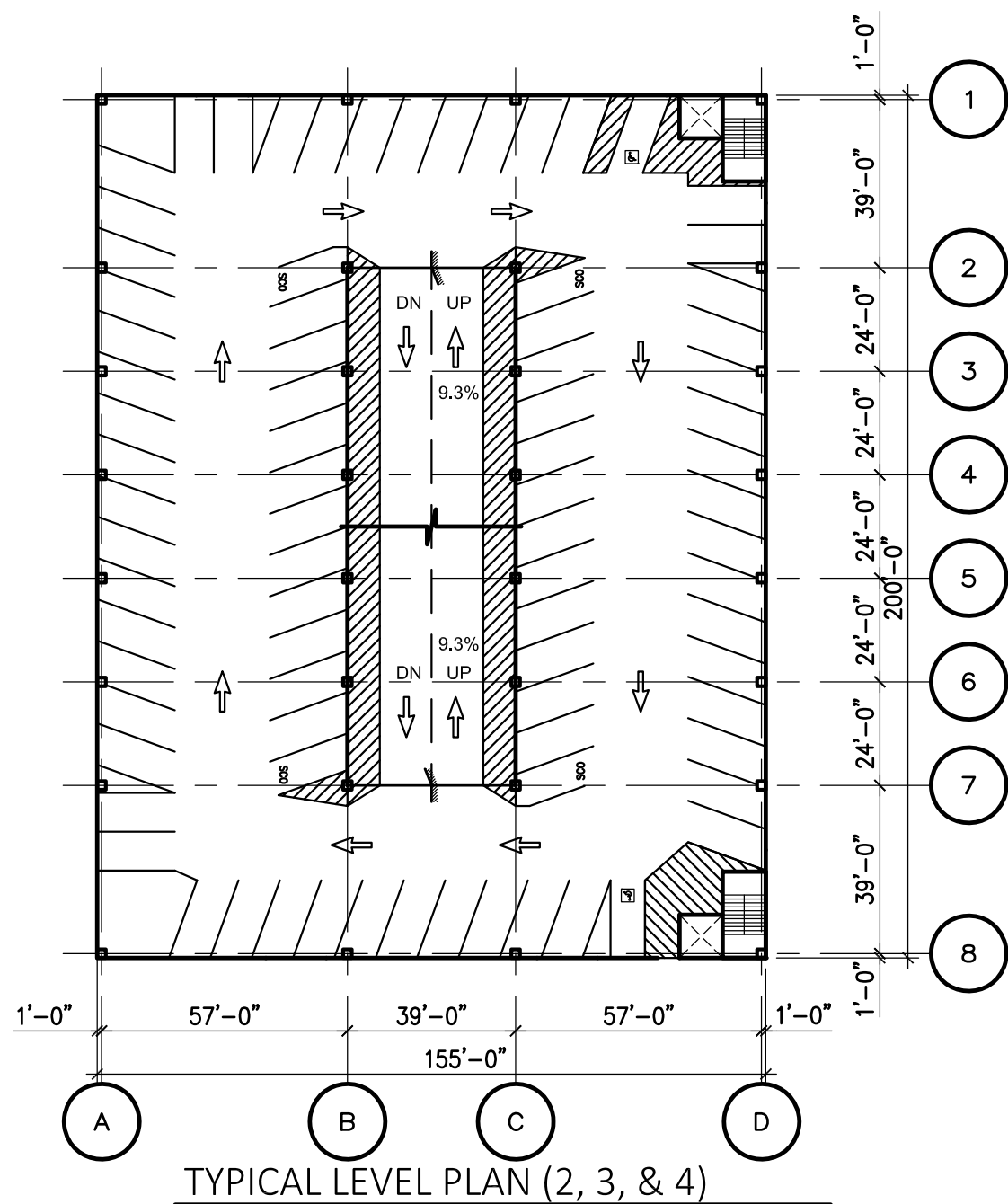

April 27, 2015

PRELIMINARY

Concept 2B



CHARLOTTE
CHICAGO
CLEVELAND
DALLAS
INDIANAPOLIS
KALAMAZOO
PHILADELPHIA

Carl Walker, Inc.
2801 Network Blvd.
Suite 101
Frisco, TX 75034
P - 214.619.0700

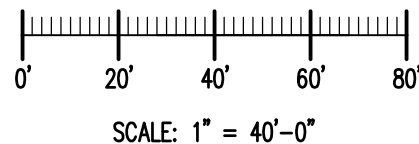

Sheet 14 of 14

City of McKinney
Proposed Parking Structure
McKinney, Texas