

SITE DATA TABLE

EXISTING ZONING:	PD 1533
LOT AREA:	12.581 ACRES OR 547,141 SQUARE FEET
LOT COVERAGE AND FAR:	18%
PERCENT IMPERVIOUS AREA:	48%
PERCENT OF SITE LANDSCAPED:	52%
PARKING PROVIDED:	231 (91 GARAGES, 91 DRIVEWAY SPACES, 49 SURFACE PARKING)
TOTAL NUMBER OF UNITS:	91
TWO-BEDROOM:	9
THREE-BEDROOM:	71
FOUR-BEDROOM:	13
AMENITIES BEING PROVIDED:	SWIMMING POOL, JACUZZI/HOT TUB
	CENTRAL OPEN SPACE, WALKING TRAIL, FITNESS CENTER
	SQUARE FOOTAGE POOL: 1000
	SQUARE FOOTAGE CLUBHOUSE: 2986
	CLUBHOUSE HEIGHT/STORIES: 30'-2"
	APARTMENT HEIGHT/STORIES: 24'-6 1/2"

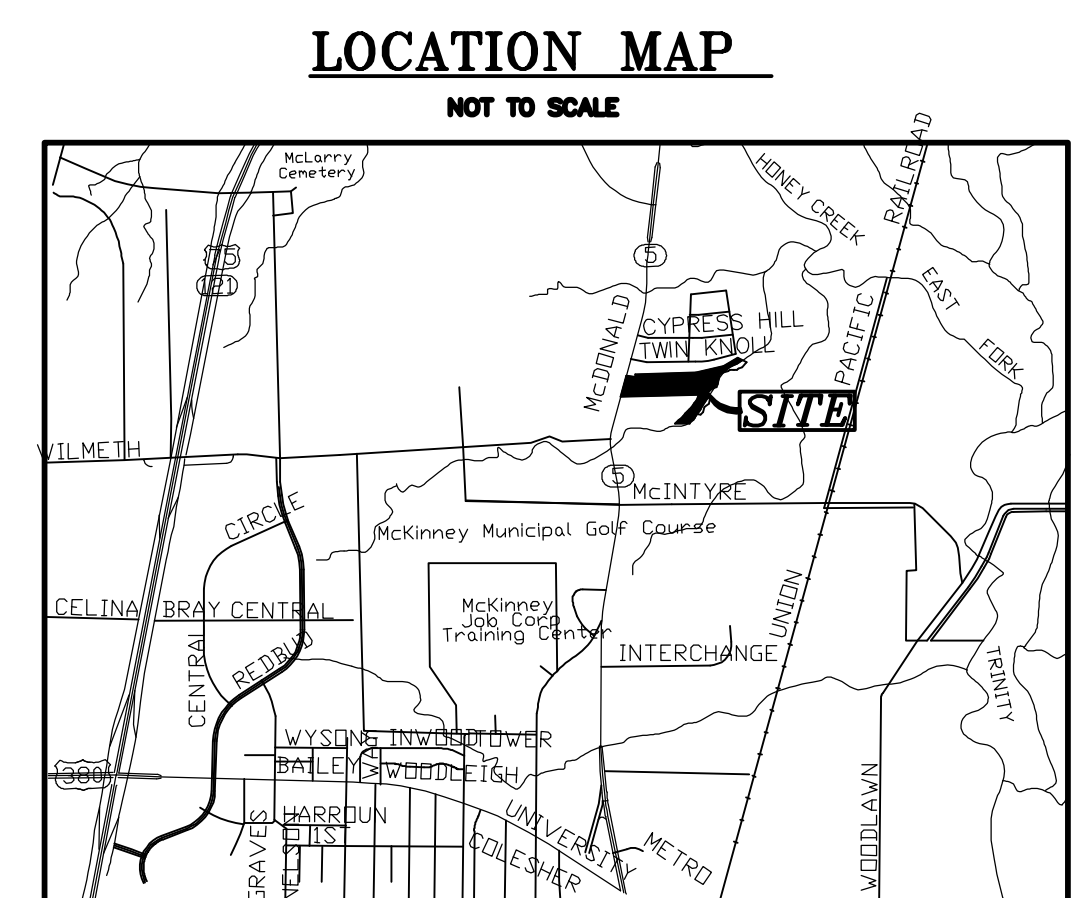
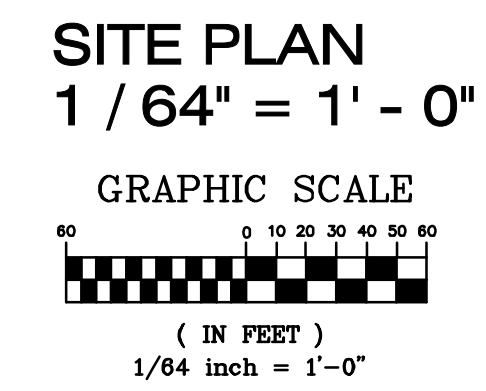
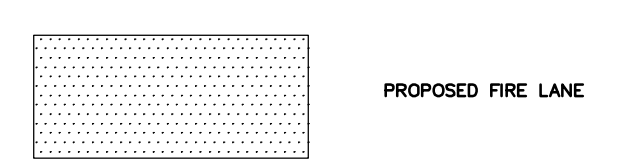

THE SANITATION CONTAINERS SCREENING WALLS SHALL BE BRICK MASONRY, STONE MASONRY, OR OTHER ARCHITECTURAL MASONRY WITH A METAL GATE, FINISH AND PAINTED. THE SANITATION CONTAINERS SCREENING WALLS, GATE AND PAD SITE SHALL BE CONSTRUCTED IN ACCORDANCE WITH THE CITY DESIGN SPECIFICATIONS. MASONRY WALL HEIGHT SHALL BE 1' MINUS INTERIOR ELEVATION OF SCREENING WALLS SHALL BE 1' 0" MINUS 1" TOLERANCE.

MECHANICAL AND HEATING AND AIR CONDITIONING EQUIPMENT IN NON-RESIDENTIAL USES SHALL BE SCREENED FROM VIEW FROM THE PUBLIC RIGHT OF WAY AND FROM ADJACENT RESIDENTIAL PROPERTIES.

THE LIGHTING FOR THE SUBJECT PROPERTY WILL BE CONSTRUCTED AND OPERATED IN CONFORMANCE WITH CHAPTER 56 OF THE CITY OF MCKINNEY CODE OF ORDINANCES.

APPLICANT
 TX MCKINNEY NORTH, L.P.
 10815 DALLAS PARKWAY
 DALLAS, TEXAS 75248
 PHONE: 214-608-7205

OWNER
 TRUSS WAREHOUSE, LTD.
 7161 VALLEY VIEW ROAD
 FENDALE, WA 98248

PROJECT
 MCKINNEY NORTH
 MULTI FAMILY
 3352 N. McDONALD STREET
 MCKINNEY, TEXAS 75071
 MIXED INCOME AFFORDABLE - 80/20

REVISIONS

1/21/16	2/18/16
2/3/16	3/3/16
2/8/16	
2/10/16	
2/17/16	

DATE	SHEET
10 OCT 2015	
FOLDER	SITE

RECEIVED