

Family Video Parking Lot Expansion (14-206SP)

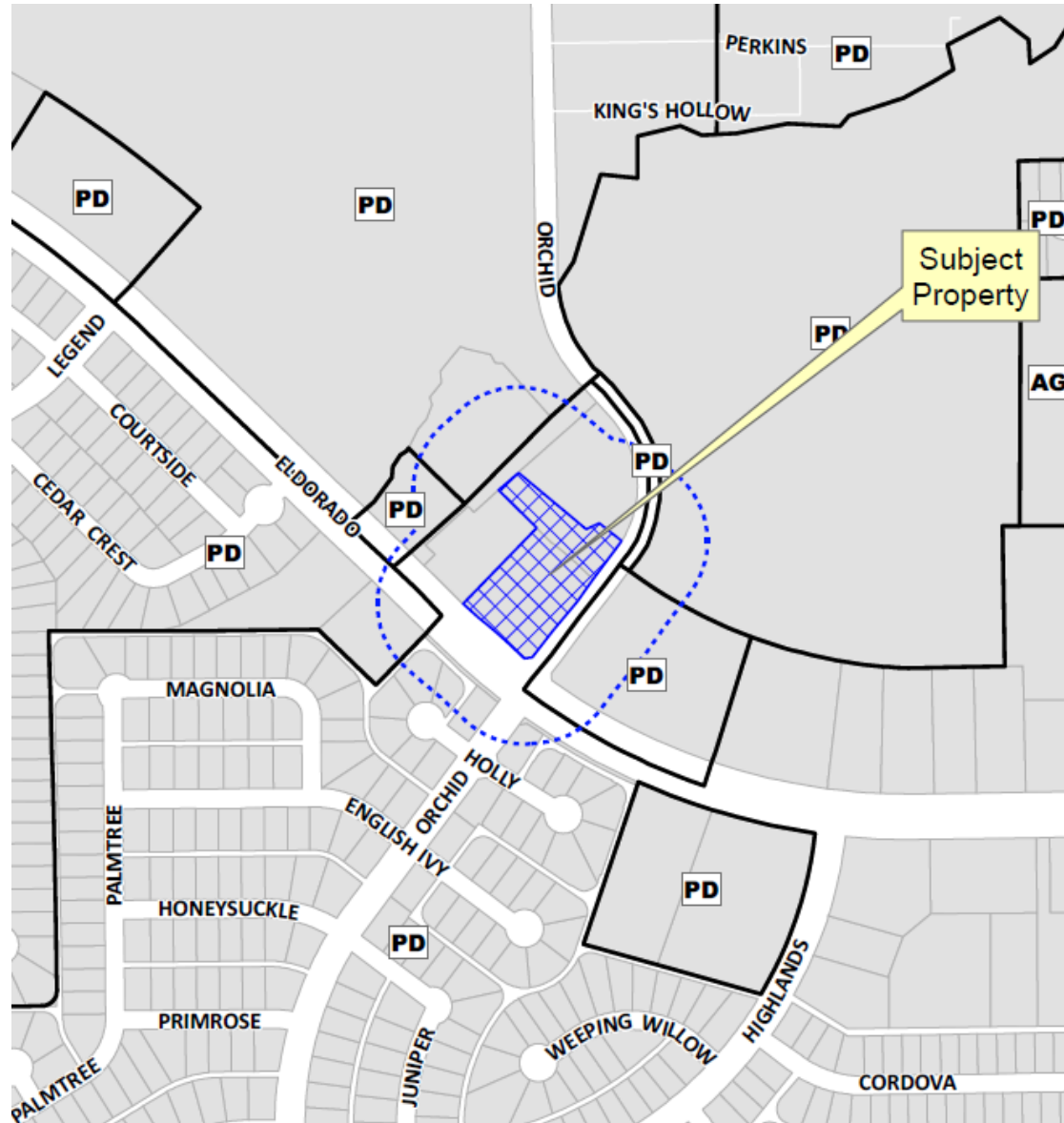

Location Map



Aerial Exhibit



Proposed Site Plan

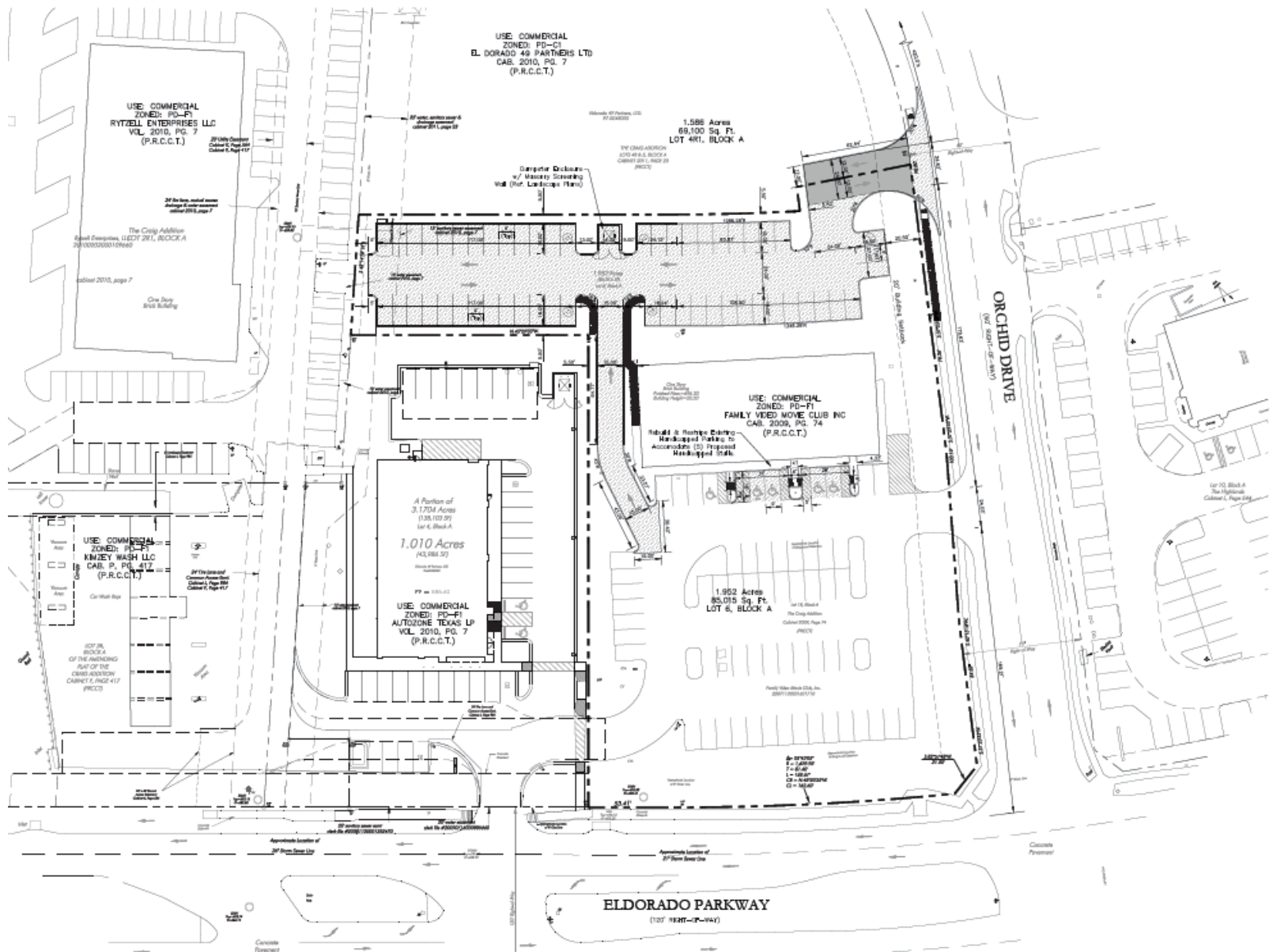

USE: COMMERCIAL
 ZONED: PD-F1
 B. DORADO 48 PARTNERS LTD
 CAB. 2010, PG. 7
 (P.R.C.C.T.)

USE: COMMERCIAL
 ZONED: PD-F1
 RYTZELL ENTERPRISES LLC
 VOL. 2010, PG. 7
 (P.R.C.C.T.)

1,988 Acres
 69,100 Sq. Ft.
 LOT 4R1, BLOCK A

USE: COMMERCIAL
 ZONED: PD-F1
 FAMILY VIDEO MOVE CLUB INC
 CAB. 2009, PG. 74
 (P.R.C.C.T.)

1,010 Acres
 (43,988.32)

USE: COMMERCIAL
 ZONED: PD-F1
 AUTOTUNE TEXAS LP
 VOL. 2010, PG. 7
 (P.R.C.C.T.)

1,952 Acres
 85,075 Sq. Ft.
 LOT 6, BLOCK A

USE: COMMERCIAL
 ZONED: PD-F1
 KINZEY WASH LLC
 CAB. P. PG. 417
 (P.R.C.C.T.)

A Part of the
 REMAINING
 PART OF THE
 CHINA-ARNDSON
 CABINET 5, PAGE 417
 (P.R.C.C.T.)

ELDORADO PARKWAY
 (107' RIGHT-OF-WAY)

EXISTING
 NEW
 L - LANDSCAPE
 C - CONCRETE
 G - ASPHALT

Proposed Landscape Plan

