

**OFFICE / WAREHOUSE**  
 4023 WEST UNIVERSITY, MCKINNEY, TEXAS

Vicinity Map

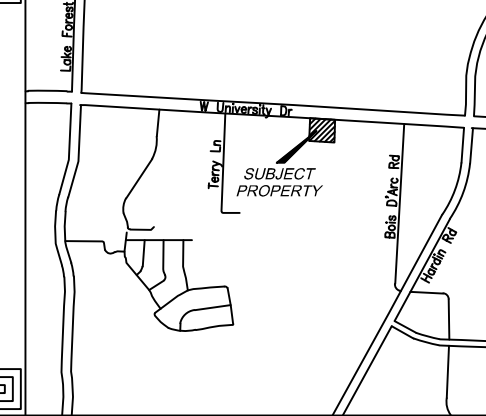

**COPYRIGHT**  
 ALL INFORMATION, EITHER DRAWN, WRITTEN, OR IMPLIED APPEARING ON THIS DOCUMENT SHALL NOT BE DUPLICATED, DISCLOSED OR OTHERWISE USED WITHOUT WRITTEN PERMISSION OF THE AUTHOR.  
 THIS DOCUMENT IS AN INSTRUMENT OF SERVICE AND IS THE SOLE PROPERTY OF THE AUTHOR. FURTHERMORE, THE USE OF THIS DOCUMENT FOR ANY PURPOSE SHALL BE REVOKED, IF THE INTENT OF THE DESIGN OR THE CONSTRUCTION TECHNIQUES OR DETAILS SHOWN HEREIN ARE NOT ADHERED TO OR THE CONTRACTUAL AGREEMENT GOVERNING THEIR USE IS NOT STRICTLY ADHERED TO.

No.	REVISION/ISSUE	DATE
1	CITY MARK-UP	12/10

**DALLAS DESIGN BUILD**  
 7980 SOUTH FM 549  
 ROCKWALL, TEXAS 75087  
 972-877-6630  
 DALLASDESIGNBUILD@YAHOO.COM

**PROJECT**  
**DAP 380 Addition**  
 Lot 1, Block A  
 being part of a 1.988 acre tract of land as recorded under  
 Dec. # 2012040900040200, CCLR  
 William H. Hunt Survey, Abstract No. 450  
 City of McKinney, Collin County, Texas  
 September 21, 2012  
 City File No. \_\_\_\_\_

**DESCRIPTION**  
 LANDSCAPE PLAN  
 PLAN

DATE	11/1/12
DRAWN BY	SLE
SCALE	1"=20'

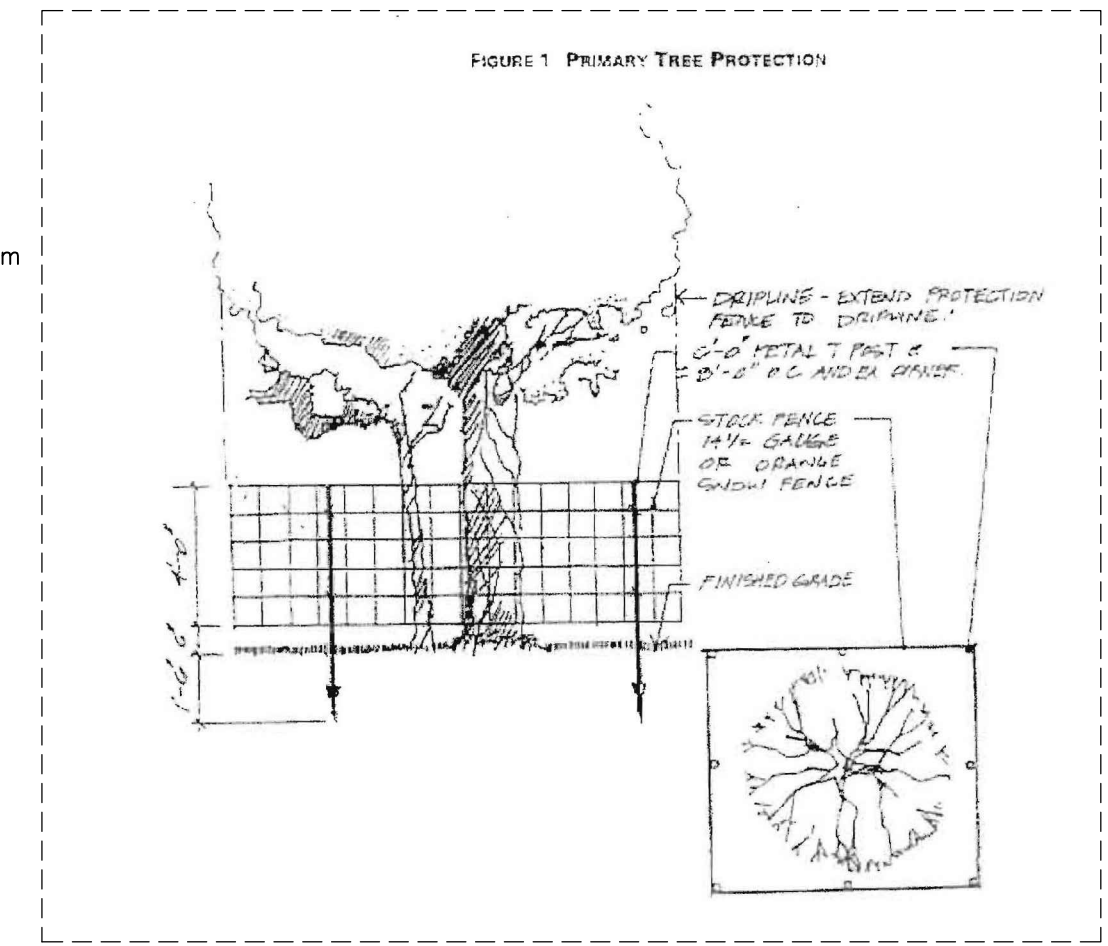

**LANDSCAPE TABLE**

	9,920 SF	BERNUDA SOD	
	22 EA.	ILEX ATTENUATA FOSTER HOLLY	7 GAL., 36" AT PLANTING
	4 EA.	ACER RUBRUM 'TRIDENT' TRIDENT RED MARLE	4" CALIPER, 12" AT PLANTING
	4 EA.	EXISTING PECAN TREE	16" TO 26" CALIPER

**LANDSCAPE:**  
 STREET YARD: 2,354 S.F.  
 REQUIRED 15% = 353 S.F.  
 PROVIDED 67.9% = 1,599 S.F.  
 LOT: 34,630 S.F.  
 REQUIRED 10% = 3,463 S.F.  
 PROVIDED 21.1% = 7,310 S.F.  
 STREET TREES REQUIRED = 2  
 STREET TREES PROVIDED = 3

**RECEIVED**  
 By sgleinser at 12:52 pm, Jan 18, 2013

- LANDSCAPE NOTES:**
- ALL REQUIRED LANDSCAPE AREAS SHALL BE PROVIDED WITH AN AUTOMATIC INDEGROUND IRRIGATION SYSTEM WITH RAIN AND FREEZE SENSORS AND EVAPORTRANSPIRATION WEATHER BASED CONTROLLERS AND SAID IRRIGATION SYSTEM SHALL BE DESIGNED BY A QUALIFIED PROFESSIONAL AND INSTALLED BY A LICENSED IRRIGATOR.
  - GRASS AREAS SHALL BE ESTABLISHED IN 100% COVERAGE AND 70% DENSITY PRIOR TO ISSUANCE OF C/O.
  - NO TREE SHALL BE PLANTED CLOSER THAN 4' TO A ROW AND 8' TO A PUBLIC UTILITY LINE. BECAUSE OF THE LOCATION OF EXISTING EASEMENTS AND UTILITIES, CONTACT EMILY BRIGHT @ 972-547-7408 FOR EXACT LOCATION OF TREES TO BE PLANTED.

PRELIMINARY PLANS  
 FINAL PLANS TO BE SEALED  
 BY RYAN KIM, PE 93939  
 817-308-6243

