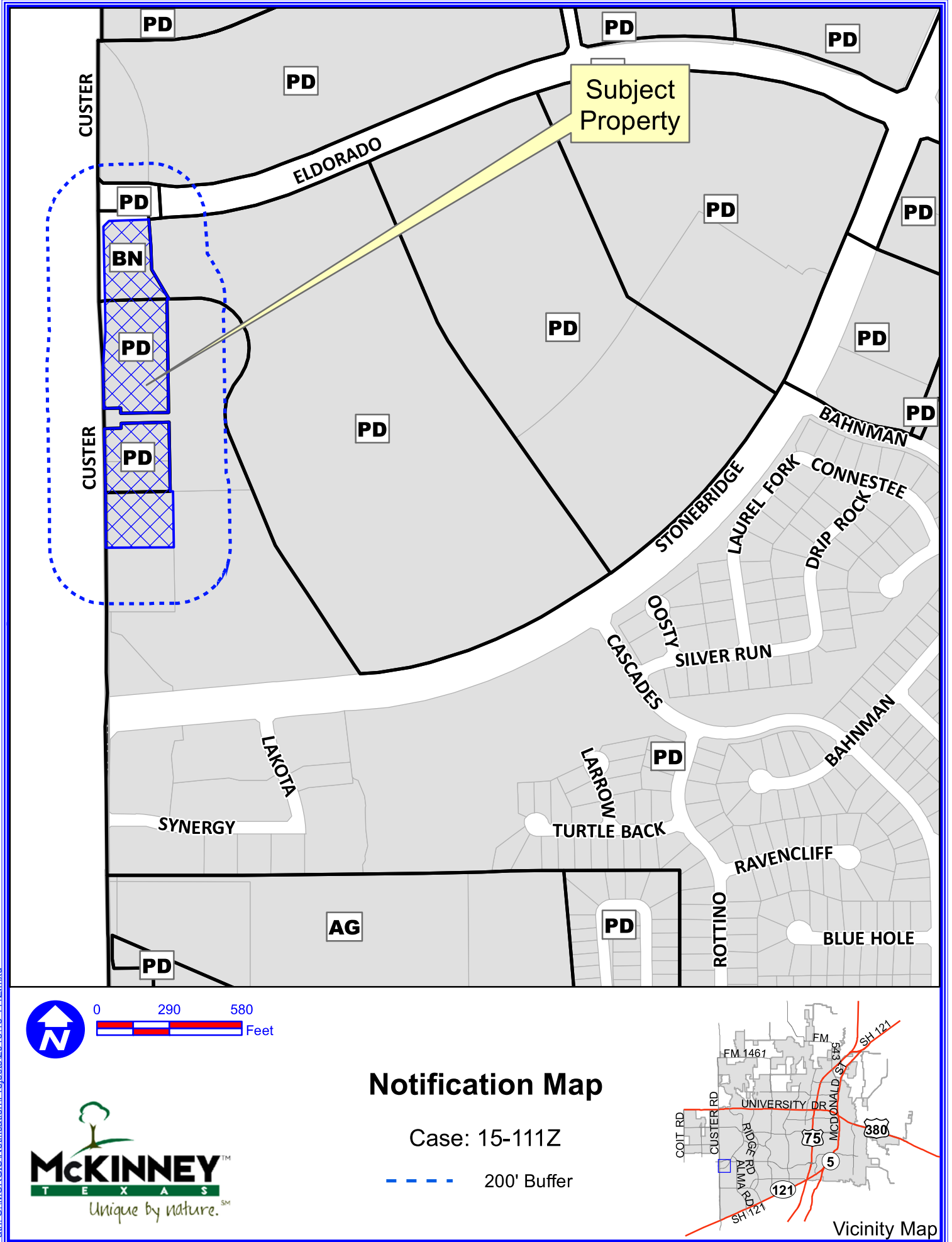

Exhibit A



Path: S:\MCKGIS\Notification\Projects\2015\15-111Z.mxd



0 290 580 Feet



Notification Map

Case: 15-111Z

--- 200' Buffer

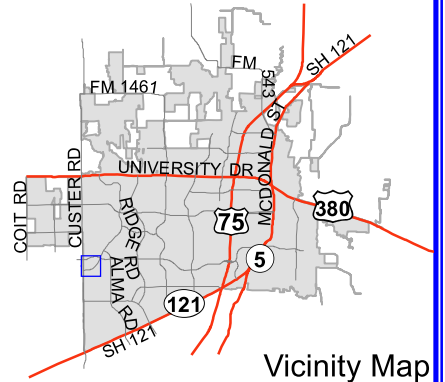

DISCLAIMER: This map and information contained in it were developed exclusively for use by the City of McKinney. Any use or reliance on this map by anyone else is at that party's risk and without liability to the City of McKinney, its officials or employees for any discrepancies, errors, or variances which may exist.

Exhibit B

ZONING METES AND BOUNDS DESCRIPTION North Tract

BEING a 4.0068 acre tract of land in the J. J. Naugle Survey, Abstract No. 662, and being all of Tract 2, recorded in instrument number 20130807001112170, Collin County Public Records, and all of Lot 3, Block A, Eldorado-Custer Addition, an addition to the City of McKinney, Collin County, Texas, recorded in Volume 5829, Page 2872, of the Collin County Public Records, and being described by metes and bounds as follows:

BEGINNING at a point at the southwest corner of the above mentioned Lot 3, Block A, Eldorado-Custer Addition, said point also being in the east right-of-way line of Custer Road;

THENCE along with the east right-of-way line of Custer Road, North 00 deg. 33 min. 00 sec. West, 165.73 feet to a point;

THENCE continuing along with the east right-of-way line of Custer Road, North 04 deg. 39 min. 57 sec. East, 140.51 feet to a point;

THENCE continuing along with the east right-of-way line of Custer Road, North 00 deg. 33 min. 00 sec. West, 125.13 feet to a point;

THENCE continuing along with the east right-of-way line of Custer Road, North 88 deg. 52 min. 14 sec. East, 9.49 feet to a point;

THENCE continuing along with the east right-of-way line of Custer Road, North 00 deg. 36 min. 02 sec. West, 161.02 feet to a point at the beginning of a curve to the right having a radius of 8,535.98 feet and a central angle of 00 deg. 58 min. 33 sec.;

THENCE continuing along with the east right-of-way line of Custer Road and said curve to the right, a distance of 145.39 feet to a point;

THENCE departing the east right-of-way line of Custer Road, North 45 deg. 14 min. 14 sec. East, 19.19 feet to a point, said point being in the south right-of-way line of Eldorado Parkway;

THENCE continuing along with the south right-of-way line of Eldorado Parkway, North 89 deg. 27 min. 00 sec. East, 272.46 feet to a point at the beginning of a curve to the left having a radius of 265.00 feet and a central angle of 08 deg. 30 min. 18 sec.;

THENCE continuing along with the south right-of-way line of Eldorado Parkway and said curve to the left, a distance of 39.34 feet to a point;

THENCE departing the south right-of-way line of Eldorado Parkway, South 02 deg. 16 min. 17 sec. East, 199.30 feet to a point;

THENCE South 28 deg. 14 min. 38 sec. East, 136.94 feet to a point;

THENCE South 88 deg. 44 min. 29 sec. West, 4.91 feet to a point;

THENCE South 00 deg. 33 min. 00 sec. East, 453.22 feet to a point;

THENCE South 89 deg. 27 min. 00 sec. West, 192.00 feet to a point;

THENCE North 00 deg. 33 min. 00 sec. West, 20.00 feet to a point;

Exhibit B

THENCE South 89 deg. 27 min. 00 sec. West, 68.00 feet to the POINT OF BEGINNING and containing 4.0068 acres of land, more or less.

Exhibit B

ZONING METES AND BOUNDS DESCRIPTION South Tract

BEING a 3.024 acre tract of land in the J. J. Naugle Survey, Abstract No. 662, and being all of Lot 2, Block A, Eldorado-Custer Addition, an addition to the City of McKinney, Collin County, Texas, recorded in Volume 5819, Page 569, of the Collin County Public Records, and all of Lot 1R3, Block A, Eldorado-Custer Addition, an addition to the City of McKinney, Collin County, Texas, recorded in instrument number 20140728000785910, of the Collin County Public Records, and being described by metes and bounds as follows:

BEGINNING at a point at the southwest corner of the above mentioned Lot 1R3, Block A, Eldorado-Custer Addition, said point also being in the east right-of-way line of Custer Road;

THENCE along with the east right-of-way line of Custer Road, North 00 deg. 33 min. 00 sec. West, 428.10 feet to a point;

THENCE departing the east right-of-way line of Custer Road, North 89 deg. 27 min. 00 sec. East, 68.00 feet to a point;

THENCE North 00 deg. 33 min. 00 sec. West, 20.00 feet to a point;

THENCE North 89 deg. 27 min. 00 sec. East, 192.00 feet to a point;

THENCE South 00 deg. 33 min. 00 sec. East, 276.00 feet to a point;

THENCE North 89 deg. 27 min. 00 sec. East, 12.45 feet to a point;

THENCE South 00 deg. 33 min. 00 sec. East, 223.89 feet to a point;

THENCE North 89 deg. 49 min. 15 sec. West, 273.09 feet to the POINT OF BEGINNING and containing 3.024 acres of land, more or less.