

# Consider/Discuss/Act Reallocation of MCDC Funds

Gabe Nesbitt Community Park Master Plan

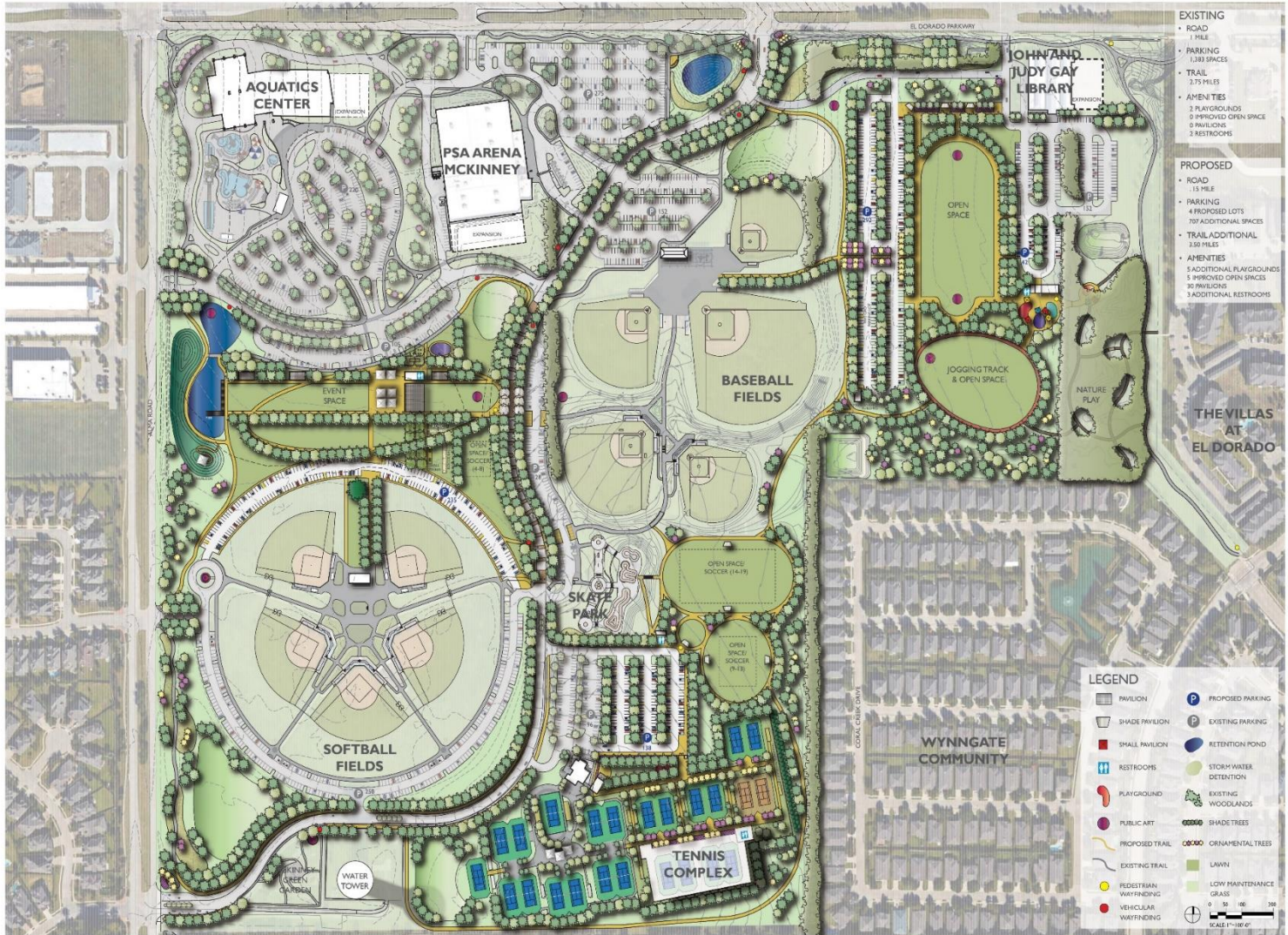



- EXISTING**
- ROAD  
1 MILE
  - PARKING  
1,383 SPACES
  - TRAIL  
2.75 MILES
  - AMENITIES  
3 PLAYGROUNDS  
9 IMPROVED OPEN SPACE  
9 PAVILIONS  
3 RESTROOMS

- PROPOSED**
- ROAD  
1.5 MILE
  - PARKING  
4 PROPOSED LOTS  
107 ADDITIONAL SPACES
  - TRAIL ADDITIONAL  
2.50 MILES
  - AMENITIES  
5 ADDITIONAL PLAYGROUNDS  
1 IMPROVED OPEN SPACE  
30 PAVILIONS  
3 ADDITIONAL RESTROOMS

**LEGEND**

- PAVILION
  - SHADE PAVILION
  - SMALL PAVILION
  - RESTROOMS
  - PLAYGROUND
  - PUBLIC ART
  - PROPOSED TRAIL
  - EXISTING TRAIL
  - PEDESTRIAN WAYFINDING
  - VEHICULAR WAYFINDING
  - PROPOSED PARKING
  - EXISTING PARKING
  - RETENTION POND
  - STORM WATER DETENTION
  - EXISTING WOODLANDS
  - SHADE TREES
  - ORNAMENTAL TREES
  - LAWN
  - LOW MAINTENANCE GRASS
- SCALE 1" = 100' 0"

THE VILLAS AT EL DORADO

WYNNGATE COMMUNITY

GABE NESBITT FINAL MASTER PLAN

GABE NESBITT PARK MASTER PLAN UPDATE

OCTOBER 5, 2015

FINAL MASTER PLAN



Unique by nature.™

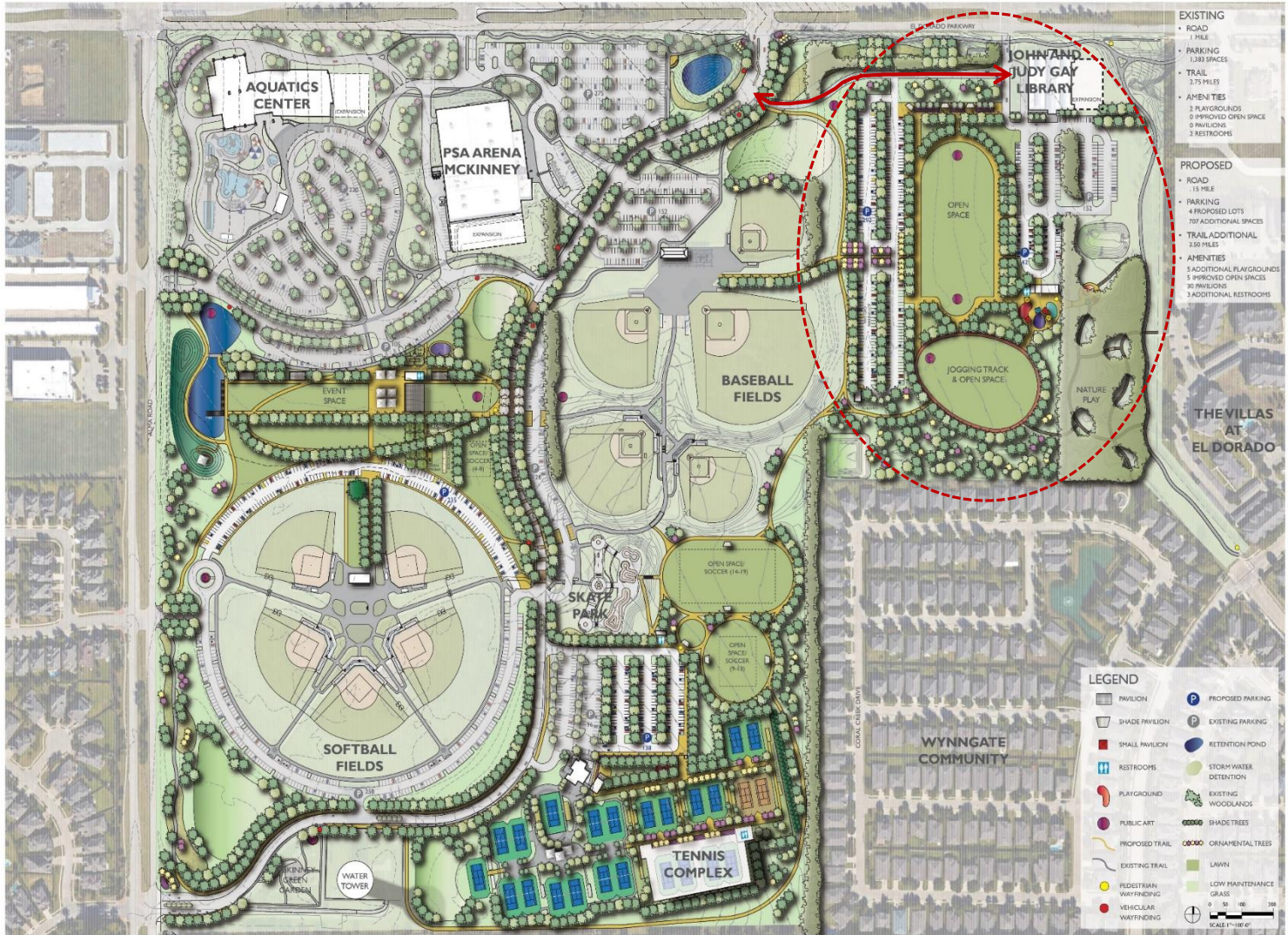

- EXISTING**
- ROAD  
1.5 MILE
  - PARKING  
1,383 SPACES
  - TRAIL  
2.75 MILES
  - AMENITIES  
3 PLAYGROUNDS  
9 IMPROVED OPEN SPACE  
9 PAVILIONS  
3 RESTROOMS
- PROPOSED**
- ROAD  
1.5 MILE
  - PARKING  
4 PROPOSED LOTS  
757 ADDITIONAL SPACES
  - TRAIL ADDITIONAL  
2.50 MILES
  - AMENITIES  
5 ADDITIONAL PLAYGROUNDS  
8 IMPROVED OPEN SPACES  
30 PAVILIONS  
3 ADDITIONAL RESTROOMS

**LEGEND**

	PAVILION		PROPOSED PARKING
	SHADE PAVILION		EXISTING PARKING
	SMALL PAVILION		RETENTION POND
	RESTROOMS		STORM WATER DETENTION
	PLAYGROUND		EXISTING WOODLANDS
	PUBLIC ART		SHADE TREES
	PROPOSED TRAIL		ORNAMENTAL TREES
	EXISTING TRAIL		LAWN
	PEDESTRIAN WAYFINDING		LOW MAINTENANCE GRASS
	VEHICULAR WAYFINDING		0 50 100 200 SCALE 1" = 100.0'

THE VILLAS AT EL DORADO

WYNGATE COMMUNITY

GABE NESBITT FINAL MASTER PLAN

GABE NESBITT PARK MASTER PLAN UPDATE

OCTOBER 5, 2015

FINAL MASTER PLAN





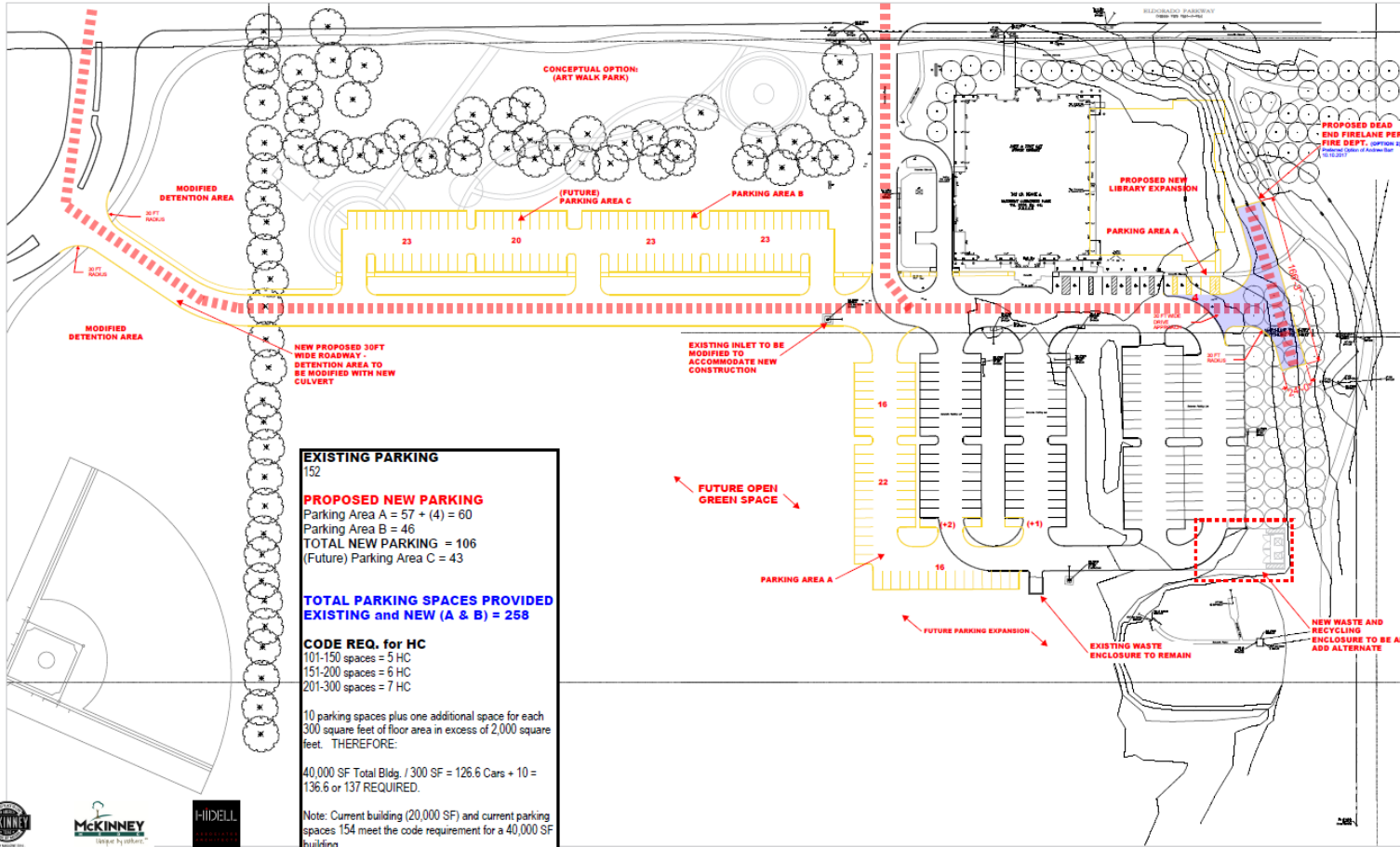

**JOHN AND JUDY GAY LIBRARY**  
 Hidell and Associates Architects  
 October 20 2017

PROPOSED FIRELANE STRIPPING

Concept

OPTION G.1



