

**TREE LEGEND**

**Canopy Trees**

- LO Live Oak
- TA Texas Ash
- CO Chingquapin Oak
- SO Shumard Oak

**Ornamental Trees**

- CM Crapemyrtle

**PLANT LIST**

| CANOPY TREES     |    |                     |                                      |   |
|------------------|----|---------------------|--------------------------------------|---|
| 2                | TA | Texas Ash           | Fraxinus texensis                    | 4" cal. 12' ht. x 6' spread                           |
| 5                | LO | Live Oak            | Quercus virginiana                   | 4" cal. 12' ht. x 6' spread                           |
| 2                | SO | Shumard Oak         | Quercus shumardi                     | 4" cal. 12' ht. x 6' spread                           |
| 3                | CO | Chingquapin Oak     | Quercus muhlenbergii                 | 4" cal. 12' ht. x 6' spread                           |
| ORNAMENTAL TREES |    |                     |                                      |   |
| 5                | CM | Crape Myrtle        | Lagerstroemia indica 'Bathurst Pink' | 30 gal. 2" cal. min., 8' ht. x 4' spread, multi-trunk |
| SHRUBS           |    |                     |                                      |   |
| 17               | DB | Dwarf Burford Holly | Ilex cornuta 'Burfordi Nana'         | 5 gal. 36" oc   |
| GRASSES          |    |                     |                                      |   |
|                  |    | Common Bermudagrass | Cynodon dactylon                     | Solid Sod   |

**LANDSCAPE NOTES**

- All landscaped areas shall be watered by an underground automatic irrigation system with rain and freeze sensors and evapotranspiration (ET) weather based controller and shall be designed and installed by a qualified licensed irrigator. System shall comply with the City of McKinney's water conservation ordinance.
- Backfill all planting pits using a 1:1 mix of parent soil from planting pit (void of rocks or other debris) and an approved planting mix composed of minimum 75% composted amendments.
- Install 3" layer of shredded hardwood mulch to all tree planting rings.
- Shredded hardwood mulch must contain long strands along with double shred finer material obtained from a local source.
- Install 2 inches of clean topsoil in all areas of the site disturbed by grading and construction operations. Topsoil shall be free from sticks, debris and rocks larger than 2 inches in diameter and have an organic matter level of 3 percent minimum and a pH range between 5.5 and 7.4 percent. Provide soil test analysis from a soil test laboratory showing soil makeup and organic percentage.
- All landscape areas shall be protected by a monolithic curb or wheel stops and remain free of trash, litter, and car bumper overhangs.

**LANDSCAPE CALCULATIONS**

Total Site Area = 3.6961 ac. (161,002 s.f.)

|                                     | Required                 | Provided          |
|-------------------------------------|--------------------------|-------------------|
| Total Site Area Landscaped          | 10% = 16,100 s.f.        | 25% = 40,217 s.f. |
| Total Street Yard Area = 8,762 s.f. | 15% = 1,314 s.f.         | 77% = 6,772 s.f.  |
| Street Frontage Canopy Trees        | 351 l.f. / 40' = 9 trees | 9 trees           |
| Total Parking Spaces - 7            |                          |                   |

**NOTE:**  
 The Contractor shall verify water restrictions within the City of McKinney at time of planting. Should water restrictions not allow hydromulch, hydroseeding, or sprigging (Stage 3 and Stage 4 water restrictions) an approved alternative for grassing shall be installed.

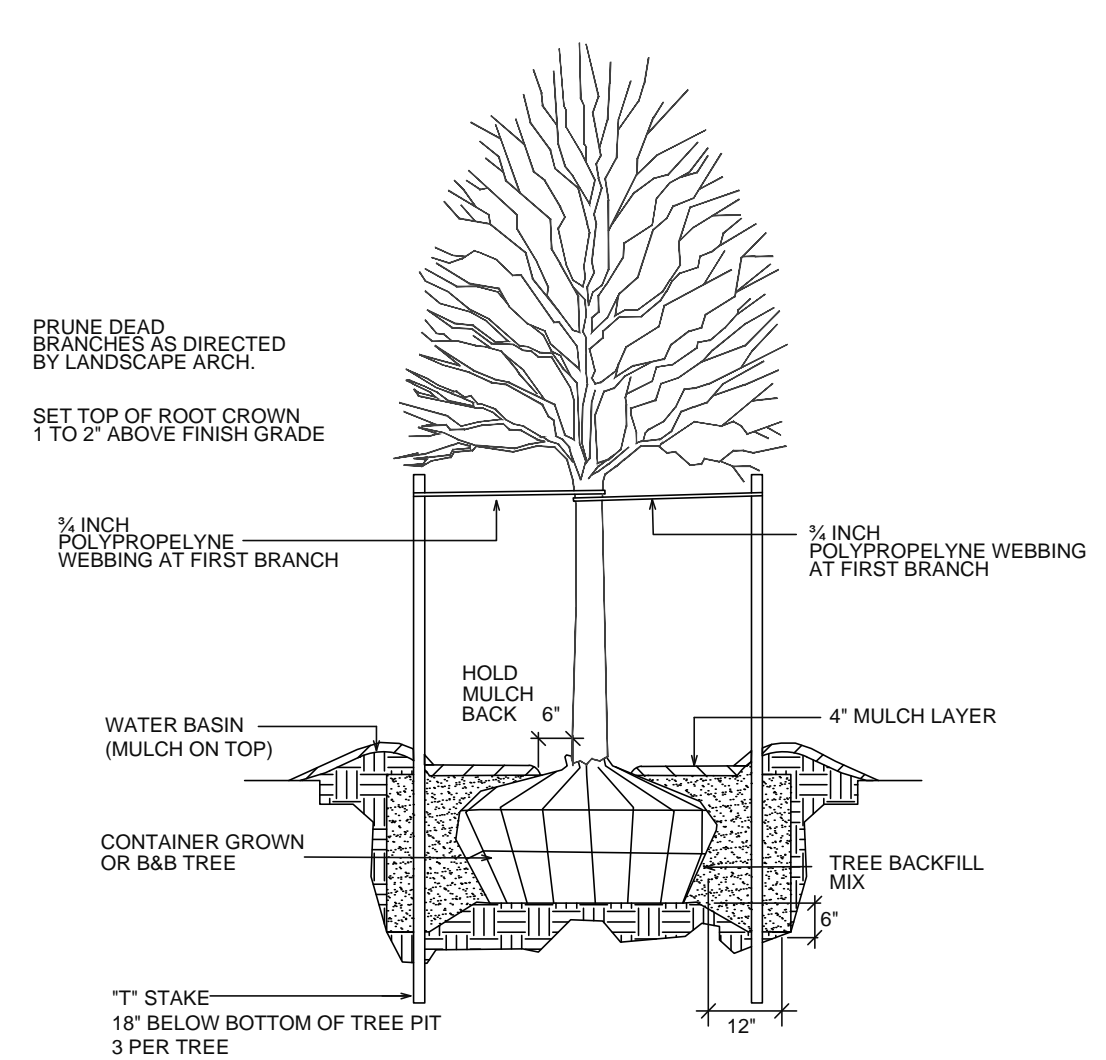
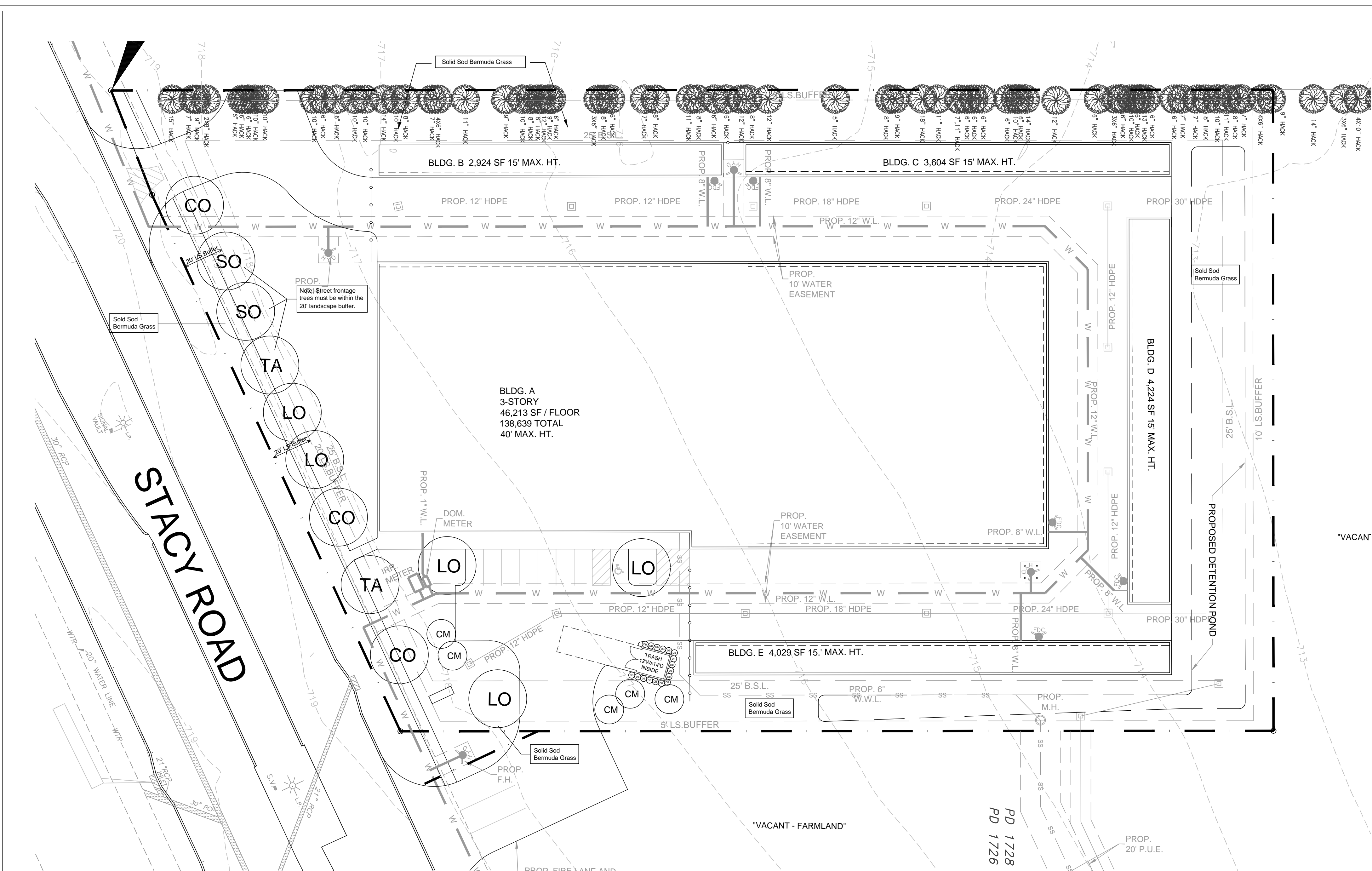

**1 CANOPY TREE PLANTING**  
 NOT TO SCALE

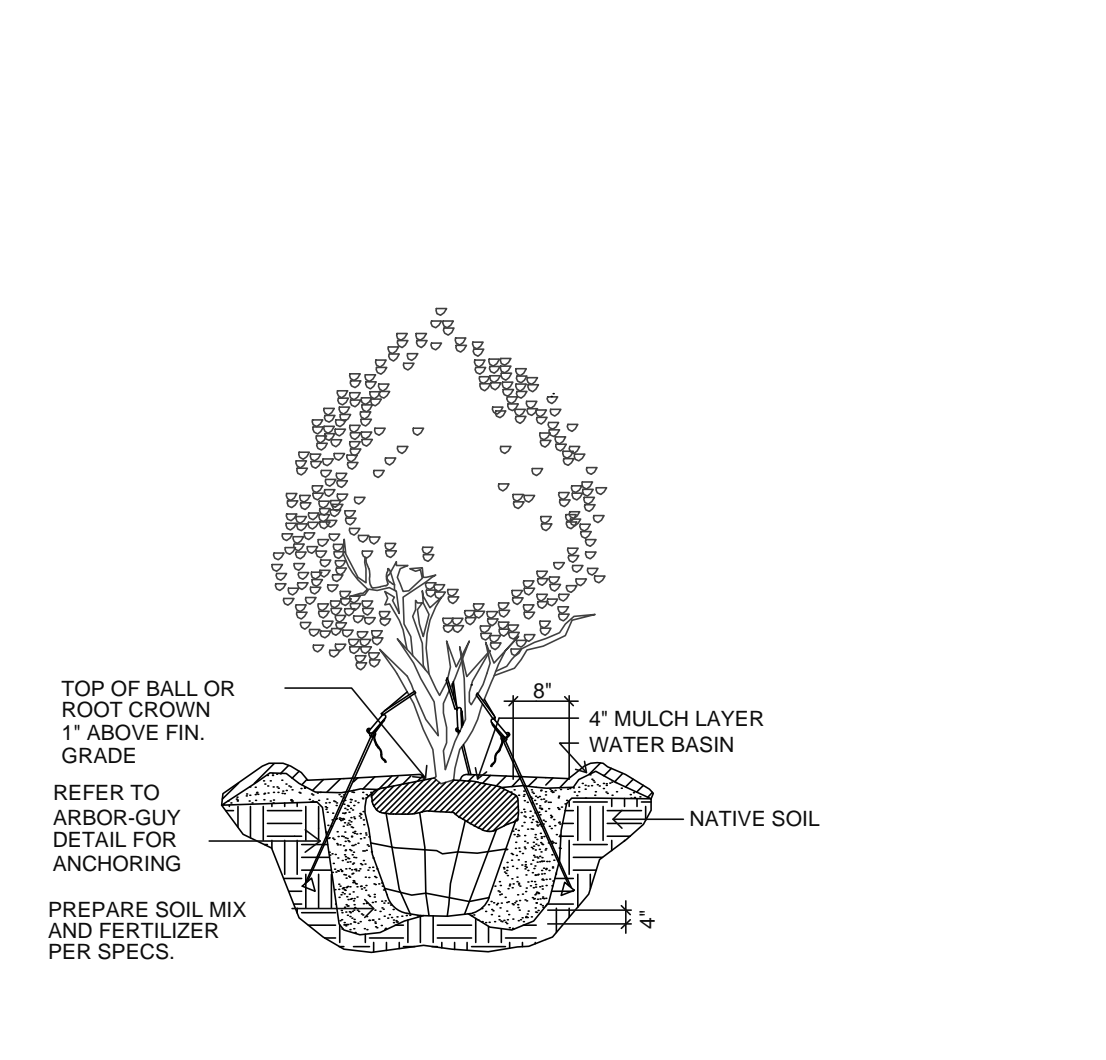

**2 MULTI-TRUNK PLANTING**  
 NOT TO SCALE

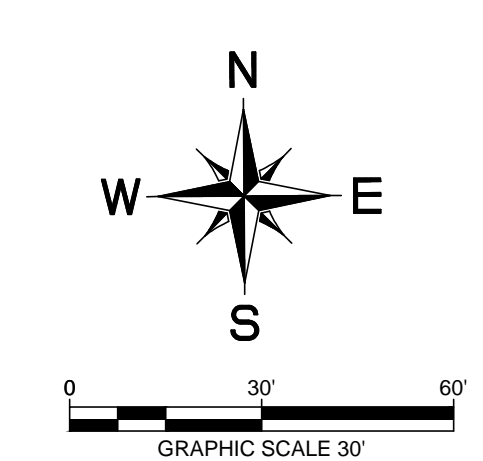

| App. | Revisions | Date | No. |
|------|-----------|------|-----|
|      |           |      |     |
|      |           |      |     |
|      |           |      |     |
|      |           |      |     |
|      |           |      |     |
|      |           |      |     |
|      |           |      |     |
|      |           |      |     |
|      |           |      |     |
|      |           |      |     |

**PUBLIC STORAGE**  
 Stacy Road & SH 121 McKinney, Texas

**LANDSCAPE PLAN**

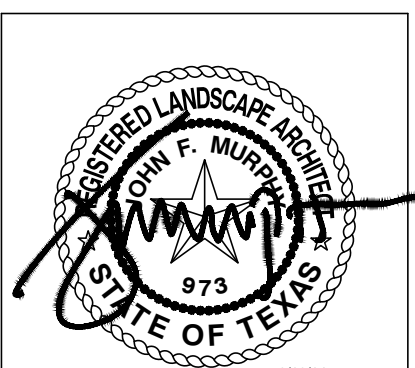

Project No.: 14015  
 Issued: 9/16/2014  
 Drawn By: JFM  
 Checked By: JAB  
 Sheet Size: 22"X34"

**L-1**