

PETITION

STATE OF TEXAS  
COUNTY OF COLLIN

TO THE COMMISSIONERS' COURT OF COLLIN COUNTY TEXAS

We, the undersigned freeholders in Commissioners Precinct No. 1 – Matt Shaheen, Collin County, and being freeholders most vitally interested in the road hereinafter petitioned to be abandoned, do hereby respectfully petition the Commissioners' Court of Collin County to take all necessary steps and to make all necessary orders for the purpose of abandoning the following described public road situated in Commissioners Precinct No. 1, Collin County, Texas, said road situated and lying as follows:

Being that portion of a county road located east of County Road 124 and intersecting on the north opening with County Road 161, and the centerline of said road being on the common north/south line of the Malachi Tucker Survey, Abstract No. 904 and the H I Upsher Survey, Abstract 934. Said portion of abandoned County Road being more particularly shown on Exhibit "A" attached hereto.

WITNESS OUR HANDS, this the 28 day of February, 2012.

[Signature]  
Felix Y. Chen

Purchased From: : Curtis A. Baker & Shirley A. Baker  
3006 838 February 23, 1989  
Volume and Page or Co. Clerk No. Date

Print or type name under signature  
[Signature]

Purchased From: \_\_\_\_\_

[Signature]  
Print or type name under signature

Volume and Page or Co. Clerk No. Date

[Signature]  
Print or type name under signature

Purchased From: \_\_\_\_\_

[Signature]  
Print or type name under signature

Volume and Page or Co. Clerk No. Date

[Signature]  
Print or type name under signature

Purchased From: \_\_\_\_\_

[Signature]  
Print or type name under signature

Volume and Page or Co. Clerk No. Date

[Signature]  
Print or type name under signature

Purchased From: \_\_\_\_\_

[Signature]  
Print or type name under signature

Volume and Page or Co. Clerk No. Date

[Signature]  
Print or type name under signature

Purchased From: \_\_\_\_\_

[Signature]  
Print or type name under signature

Volume and Page or Co. Clerk No. Date

[Signature]  
Print or type name under signature

Purchased From: \_\_\_\_\_

[Signature]  
Print or type name under signature

Volume and Page or Co. Clerk No. Date

\_\_\_\_\_

Volume and Page or Co. Clerk No. Date

Purchased From: \_\_\_\_\_

NOTICE

STATE OF TEXAS  
COUNTY OF COLLIN

NOTICE IS HEREBY GIVEN THAT, application will be made to the Commissioners' Court of Collin County, Texas, at a regular term thereof to be held on \_\_\_\_\_, 2012, or at the next earliest meeting of the Commissioners' Court on the 6<sup>th</sup> floor at the courthouse in said county, to abandon the following public road:

Being that portion of a county road located east of County Road 124 and intersecting on the north opening with County Road 161, and the centerline of said road being on the common north/south line of the Malachi Tucker Survey, Abstract No. 904 and the H I Upsher Survey, Abstract 934. Said portion of abandoned County Road being more particularly shown on Exhibit "A" attached hereto.

We the undersigned freeholders of Commissioners Precinct No. 1, Collin County, Texas, give notice of said application and hearing to be hears by the Commissioners' Court upon the presentation of said application.

WITNESS OUR HANDS, this the 28 day of February, 2012

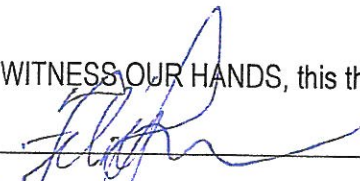
  
\_\_\_\_\_  
Felix Y. Chen  
Print or type name under signature

Purchased From: : Curtis A. Baker & Shirley A. Baker  
3006                      838                      February 23, 1989  
Volume and Page or Co. Clerk No.                      Date

  
\_\_\_\_\_  
Dale Clark  
Print or type name under signature

Purchased From: \_\_\_\_\_  
\_\_\_\_\_  
Volume and Page or Co. Clerk No.                      Date

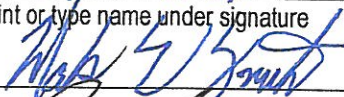
  
\_\_\_\_\_  
Mark E. Smith  
Print or type name under signature

Purchased From: \_\_\_\_\_  
\_\_\_\_\_  
Volume and Page or Co. Clerk No.                      Date

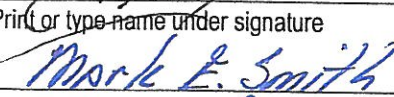
  
\_\_\_\_\_  
Jerry R. Long  
Print or type name under signature

Purchased From: \_\_\_\_\_  
\_\_\_\_\_  
Volume and Page or Co. Clerk No.                      Date

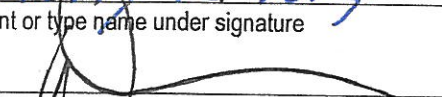
  
\_\_\_\_\_  
Richard Franklin  
Print or type name under signature

Purchased From: \_\_\_\_\_  
\_\_\_\_\_  
Volume and Page or Co. Clerk No.                      Date

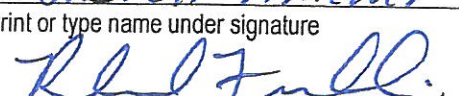
  
\_\_\_\_\_  
ERWIN H. GIBSON Sr.  
Print or type name under signature

Purchased From: \_\_\_\_\_  
\_\_\_\_\_  
Volume and Page or Co. Clerk No.                      Date

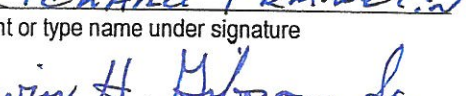
  
\_\_\_\_\_  
OWEN HAGGARD  
Print or type name under signature

Purchased From: \_\_\_\_\_  
\_\_\_\_\_  
Volume and Page or Co. Clerk No.                      Date

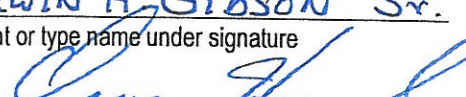
  
\_\_\_\_\_  
OWEN HAGGARD  
Print or type name under signature

Purchased From: \_\_\_\_\_  
\_\_\_\_\_  
Volume and Page or Co. Clerk No.                      Date



Felix Y Chen

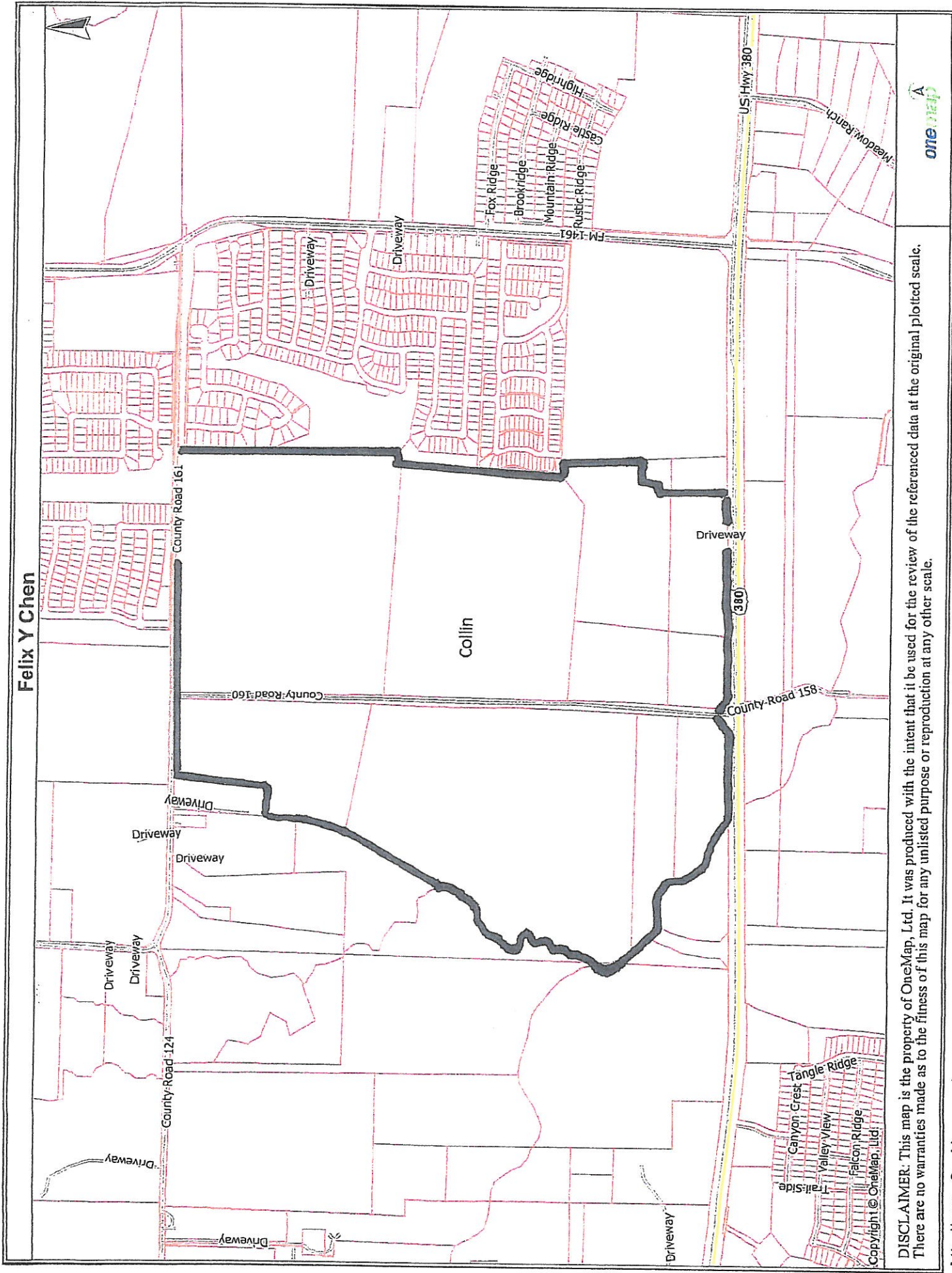

DISCLAIMER: This map is the property of OneMap, Ltd. It was produced with the intent that it be used for the review of the referenced data at the original plotted scale. There are no warranties made as to the fitness of this map for any unlisted purpose or reproduction at any other scale.



<http://www.OneMap.com/>

February 28, 2012