

# OPTION #1: Alpolic Metal Panel

**Page/**

TEL 214 522 3900  
FAX 214 522 4380

**Page Southerland Page, Inc.**  
1800 Main Street, Suite 123  
Dallas, Texas 75201  
pagethink.com

**Lindsey Leah Brigati, AIA**  
Architect, Associate

October 15, 2014

Jennifer Arnold  
Planning Manager  
City of McKinney

Dear Jennifer and Planning Team,

Attached is a sample of the Alpolic metal panel that we would like to consider utilizing for the roof screen at McKinney Medical Village. We greatly appreciate your team's consideration on this request for an *Alternate Equivalent Screening*. The Alpolic panel is a solid, non-combustible, prefinished, light weight, heavy-gauge metal panel.



Lindsey Leah Brigati, AIA  
Architect, Associate



# ALPOLIC®/fr MATERIALS

MITSUBISHI PLASTICS COMPOSITES AMERICA, INC.

## anodized

ALPOLIC®/fr Anodized aluminum composite material with a fire resistant mineral filled core is stocked in a clear anodized Class 1 finish. Many custom anodized finishes are available and any of the different panel finishes will provide a dramatic statement to a building or design element.

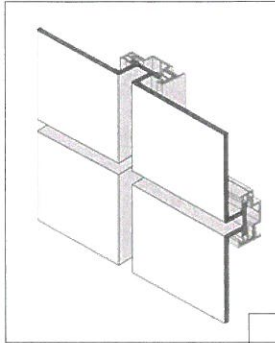

### CONSTRUCTION INFORMATION

PROJECT: Century Bank

ARCHITECT: Beacon Architecture

PRODUCT: ALPOLIC™ Clear Anodized



### GENERAL INFORMATION

We stock both 50-inch and 62-inch panels in Clear Anodized and untreated for custom anodized finishes. Material is manufactured with 1100 alloy aluminum.

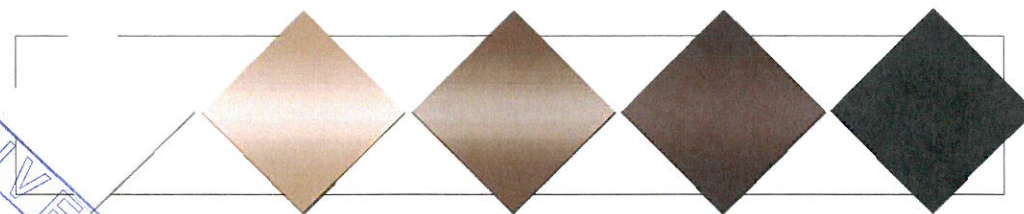

CLEAR ANODIZED  
4-ACLR

CHAMPAGNE ANODIZED  
4-ICMR  
(Custom Color)

LIGHT BRONZE  
ANODIZED 4-ILBR  
(Custom Color)

MEDIUM BRONZE  
ANODIZED 4-IMBR  
(Custom Color)

BLACK ANODIZED  
4-IBLK  
(Custom Color)

RECEIVED  
OCT 15 2014  
PLANNING



# ALPOLIC®/fr anodized

INTERIOR AND EXTERIOR SURFACING  
INTERIOR AND EXTERIOR SIGNAGE

## SURFACE TREATMENT

ALPOLIC®/fr Anodized material is a sandwiched aluminum skinned composite panel with a Class 1 anodized finish on the top side. Available stock Anodized finish is CLR Clear Anodized. Custom colors and untreated panels available.

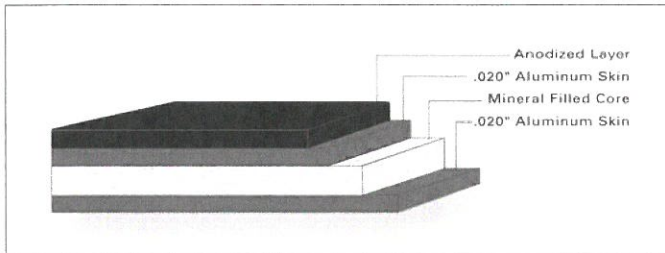

## STANDARD PANEL SIZE

Standard stock widths are 50" (1270mm) and 62" (1575mm) and lengths of 148" (3759mm) and 198" (5029mm). Panels are stocked in 4mm thickness. Standard crate is 32 pieces and 24 pieces for 62 x 196. Custom lengths, thickness, and standard polyethylene core available. Please contact ALPOLIC® Customer Service for current available stock and additional information.

## FINISH TOLERANCE

Color: DE 5.0 (CMC) variation within one lot\*

Gloss: Nominal +/-10 units

\*Please note that Anodized panels can not be color controlled as tightly as painted panels and some color variation should be expected.

## PRODUCT TOLERANCE

Width: ± 0.08" (2mm)

Length: ± 0.16" (4mm)

Thickness: 4mm: ± 0.008" (0.2mm)

6mm: ± 0.012" (0.3mm)

Bow: maximum 0.5% of length and/or width

Squareness: maximum 0.2" (5mm)

Peel Strength: >22 in lb/in (ASTM D1781)

ALPOLIC® material is trimmed and squared with cut edges to offer the best panel edge conditions in the industry.

## FIRE PERFORMANCE

Fire resistant ALPOLIC®/fr Anodized finish panels with a mineral filled core have been tested by independent testing laboratories using nationally recognized tests.

This material meets all requirements of the International Building Code for non-combustible construction:

IBC Listed

Please visit [www.alpolic-northamerica.com](http://www.alpolic-northamerica.com) or call technical support for complete report listings and additional information.

## WARRANTY

Standard panel warranty: 10 Year

Finish warranty: 5 Year

Call ALPOLIC® Customer Service for exclusions and warranty details.

## PRODUCT NOTES

- Panels should be stored flat in a dry, indoor environment.
- Fabricate panels at temperatures above 55°F.
- Protective film should be removed from panels soon after installation.
- Please refer to ALPOLIC® Anodized Fabrication Manual for routing and fabrication recommendations.
- Crating fees apply to orders for less than standard piece crate.
- For best color consistency, ALPOLIC® recommends ordering all required Anodized paint finish panels at one time in the same width and maintaining consistent panel orientation during installation.
- Different lots of Anodized finish should not be mixed on building elevation.

FOR TECHNICAL INFORMATION, PLEASE  
CALL 1.800.422.7270

### U.S. HEADQUARTERS

**MITSUBISHI PLASTICS COMPOSITES AMERICA, INC.**

401 Volvo Parkway, Chesapeake, VA 23320

Telephone: 800-422-7270, Facsimile: 757-436-1896

[www.alpolic-northamerica.com](http://www.alpolic-northamerica.com) e-mail: [info@alpolic.com](mailto:info@alpolic.com)

