

PAVING & JOINTING LAYOUT LEGEND

DJI	DOWELED ISOLATION JOINT
---	SAWN CONTROL JOINT
[Pattern]	8" CONCRETE PAVING ON TREATED SUBGRADE PER DETS. A1/LD500 & C3/LD500
[Pattern]	6" CONCRETE PAVING ON TREATED SUBGRADE PER DETS. A1/LD500 & C3/LD500
[Pattern]	5" CONCRETE PAVING ON TREATED SUBGRADE PER DETS. A1/LD500 & C3/LD500
[Pattern]	5" CONCRETE PAVING ON COMPACTED SUBGRADE PER DET. C3/LD500 & D3/LD500
[Pattern]	ASPHALT PAVING ON FLEX BASE PER DET. -LD500 & -LD500
[Pattern]	STRUCTURAL CONCRETE PAVING (REF. STRUCTURAL SHEETS)
[Pattern]	DECOMPOSED GRANITE PER DET. -LD500

STANDARD NOTATIONS

- A. SANITATION CONTAINER SCREENING WALLS WILL BE BRICK MASONRY, STONE, MASONRY, OR OTHER ARCHITECTURAL MASONRY FINISH, INCLUDING A METAL GATE, PRIMED AND PAINTED, AND THE SANITATION CONTAINER SCREENING WALLS, GATE, AND PAD SITE WILL BE CONSTRUCTED IN ACCORDANCE WITH THE CITY'S DESIGN SPECIFICATIONS.
- B. MECHANICAL AND HEATING AND AIR CONDITIONING EQUIPMENT IN NON-RESIDENTIAL USES SHALL BE SCREENED FROM VIEW FROM THE PUBLIC RIGHT-OF-WAY AND FROM ADJACENT RESIDENT PROPERTIES.
- C. LIGHTING FOR THE SUBJECT PROPERTY WILL BE CONSTRUCTED IN CONFORMANCE WITH CHAPTER 52 OF THE CITY OF MCKINNEY CODE OF ORDINANCES.

KEY NOTES

- AS INDICATED BY: (A)
- 8" CONC. PAVING W/ MONOLITHIC CURB ON TREATED SUBGRADE
 - 6" CONC. PAVING W/ MONOLITHIC CURB ON TREATED SUBGRADE
 - 5" CONC. PAVING ON TREATED SUBGRADE
 - 5" CONC. PAVING W/ MONOLITHIC CURB ON TREATED SUBGRADE
 - 5" CONC. PAVING ON COMPACTED SUBGRADE PER CONCRETE PAVERS ON CONCRETE SUBGRADE
 - SPECIALTY CONCRETE PAVING ON COMPACTED/TREATED SUBGRADE
 - DECOMPOSED GRANITE
 - CONCRETE AT BUILDING SLAB
 - CONCRETE STEPS & HANDRAIL
 - CURB & SIDEWALK CONNECTION
 - CONNECTION TO EX CONCRETE
 - ASPHALT PAVING ON FLEX BASE
 - CONCRETE TO ASPHALT PAVING CONNECTION
 - PEDESTRIAN CROSSWALK TYPE A
 - PEDESTRIAN CROSSWALK TYPE B
 - ELEVATED PEDESTRIAN CROSSWALK TYPE A
 - ELEVATED PEDESTRIAN CROSSWALK TYPE B
 - PLAZA FIRE LANE MARKINGS
 - FIRE LANE STRIPING
 - STOP BAR STRIPING
 - STOP SIGN
 - CURB RAMP TYPE A
 - CURB RAMP TYPE B
 - CURB RAMP TYPE C
 - ACCESSIBLE PARKING
 - CONCRETE WHEELSTOP
 - ACCESSIBLE RAMP AND HANDRAIL
 - RETAINING WALL
 - LUEDERS BLOCK BENCH
 - WATER FEATURE
 - WEST 14" DIA. CISTERN
 - NORTHEAST 12" DIA. CISTERN
 - SOUTHEAST 12" DIA. CISTERN
 - TREE GRATE
 - BOLLARD
 - REMOVABLE BOLLARD
 - FOOD TRUCK HOOKUP
 - DUMPSTER ENCLOSURE
 - LIVING SCREEN WALL
 - MCKINNEY MUNICIPAL COMPLEX RE: ARCH. SHEETS
 - BUILDING ENTRY RE: ARCH. SHEETS
 - BUILDING CANOPY RE: ARCH. SHEETS
 - CIVIC PLAZA PAVILION RE: ARCH. SHEETS
 - CENTRAL UTILITY PLANT RE: ARCH. SHEETS
 - BACK OF HOUSE LOADING AREA
 - CURB INLET RE: CIVIL SHEETS
 - FIRE HYDRANT RE: CIVIL SHEETS
 - WATER METER RE: CIVIL SHEETS
 - WATER VAULT RE: CIVIL SHEETS
 - REMOTE FDC RE: CIVIL SHEETS
 - FDC BOLLARD RE: CIVIL SHEETS
 - MANHOLE RE: CIVIL SHEETS
 - CLEANOUT RE: CIVIL SHEETS
 - DRAIN INLET RE: CIVIL SHEETS
 - ELECTRICAL TRANSFORMER
 - ELECTRICAL EMERGENCY GENERATOR
 - LOCATION FOR ELECTRICAL TEMPORARY GENERATOR
 - ELECTRICAL SWITCH GEAR
 - LIGHT FIXTURE
 - STREET LIGHT POLE
 - PEDESTRIAN LIGHT POLE
 - HEADWALL AND RIPRAP RE: CIVIL SHEETS
 - CONCRETE FLUME RE: CIVIL SHEETS
 - PROPOSED EASEMENT RE: CIVIL SHEETS
 - FARS ROOM
 - FIRE COMMAND CENTER
 - FIRE PUMP ROOM
 - MOBILE AIR CONNECTION (EMAC)
 - RIGHT OF WAY
 - SIDEWALK BY OTHERS
 - MCKINNEY SEAL
 - ICE HOUSE RETAINING WALL
 - ICE HOUSE SURVEY MONUMENT EMBEDDED IN PAVEMENT
 - EV CHARGING STATION
 - LIGHTING CABINET

BUILDING OCCUPANCY AREA CALCULATIONS (SF)

FLOOR	A-3 ASSEMBLY (SEPARATED)	A-3 ASSEMBLY (ACCESS TO B)	BUSINESS
1	8,973	1,694	31,614
2			37,232
3			34,868
4		1,818	32,370
5			26,740
SUBTOTAL	8,973	3,512	162,824
		TOTAL	175,309

SITE DATA TABLE

EXISTING ZONING	MTC - MCKINNEY TOWN CENTER
PROPOSED USE	MTC - MCKINNEY TOWN CENTER
BUILDING AREA	175,309 SF
BUILDING HEIGHT	84'-0"
LOT COVERAGE	8.81 AC
FLOOR AREA RATIO	.45
IMPERVIOUS AREA	7.06 AC
PARKING REQUIRED	350
PARKING PROVIDED	
STANDARD ACCESSIBLE	370
ACCESSIBLE	18
TOTAL	388
FOOD TRUCK	2

VICINITY MAP



OWNER/DEVELOPER:
CITY OF MCKINNEY
222 N. TENNESSEE ST.
MCKINNEY, TEXAS 75069
PH. (972) 547-7439
CONTACT: PATRICIA JACKSON,
FACILITIES CONSTRUCTION MANAGER

ENGINEER/APPLICANT:
LAKE FLATO + PARKHILL
3000 INTERNET BOULEVARD, SUITE 650
FRISCO, TEXAS 75034
PH. (972) 987-1670

EXISTING UTILITIES
CONTRACTOR MUST VERIFY LOCATION OF ALL OVERHEAD AND UNDERGROUND UTILITIES PRIOR TO CONSTRUCTION. CONTRACTOR SHALL COORDINATE WITH CITY OFFICIALS AND UTILITY COMPANIES IN LOCATING UTILITIES. CONTRACTOR SHALL BE HELD RESPONSIBLE FOR LOSSES DUE TO DAMAGE TO UTILITIES. LOCATION FOR ALL UTILITIES SHOWN ON PLANS ARE APPROXIMATE. CONTRACTOR SHALL CALL TEXAS 811, 1-800-344-8377.

CONTROL POINT #1 "X" CUT TBM #26310 N - 7125948.59 E - 2546389.86 ELEV. 600.40	CONTROL POINT #2 "X" CUT TBM #27498 N - 7125927.73 E - 2546391.77 ELEV. - 603.99
---	---

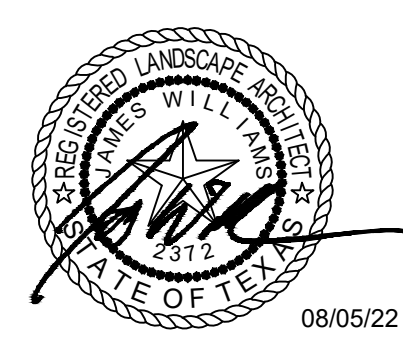
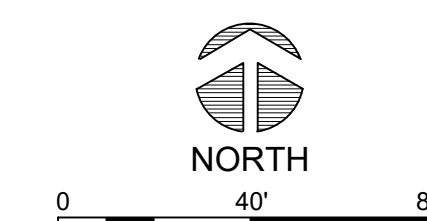

CLIENT
City of McKinney
201 E Virginia St
McKinney, TX 75069

PROJECT NO.
6028.20

KEY PLAN

#	DATE	DESCRIPTION
1	08/05/2022	Site Plan Resubmittal
	05/31/2022	Site Plan Submittal

PAVING & JOINTING LAYOUT LEGEND

- DJ DOWELED ISOLATION JOINT
- SAWN CONTROL JOINT
- 8" CONCRETE PAVING ON TREATED SUBGRADE PER DETS. A1/LD500 & C3/LD500
- 6" CONCRETE PAVING ON TREATED SUBGRADE PER DETS. A1/LD500 & C3/LD500
- 5" CONCRETE PAVING ON TREATED SUBGRADE PER DETS. A1/LD500 & C3/LD500
- 5" CONCRETE PAVING ON COMPACTED SUBGRADE PER DET. C3/LD500 & D3/LD500
- ASPHALT PAVING ON FLEX BASE PER DET. -LD500 & -LD500
- STRUCTURAL CONCRETE PAVING (REF. STRUCTURAL SHEETS)
- DECOMPOSED GRANITE PER DET. -LD500

KEY NOTES

- AS INDICATED BY:
1. 8" CONC. PAVING W/ MONOLITHIC CURB ON TREATED SUBGRADE
 2. 6" CONC. PAVING W/ MONOLITHIC CURB ON TREATED SUBGRADE
 3. 5" CONC. PAVING W/ MONOLITHIC CURB ON TREATED SUBGRADE
 4. 5" CONC. PAVING ON COMPACTED SUBGRADE PER
 5. CONCRETE PAVERS ON CONCRETE SUBGRADE
 6. SPECIALTY CONCRETE PAVING ON COMPACTED/TREATED SUBGRADE
 7. DECOMPOSED GRANITE
 8. CONCRETE AT BUILDING SLAB
 9. CONCRETE STEPS & HANDRAIL
 10. CURB & SIDEWALK CONNECTION
 11. CONNECTION TO EX. CONCRETE
 12. ASPHALT PAVING ON FLEX BASE
 13. CONCRETE TO ASPHALT PAVING CONNECTION
 14. PEDESTRIAN CROSSWALK TYPE A
 15. PEDESTRIAN CROSSWALK TYPE B
 16. ELEVATED PEDESTRIAN CROSSWALK TYPE A
 17. ELEVATED PEDESTRIAN CROSSWALK TYPE B
 18. PLAZA FIRE LANE MARKINGS
 19. FIRE LANE STRIPING
 20. STOP BAR STRIPING
 21. STOP SIGN
 22. CURB RAMP TYPE A
 23. CURB RAMP TYPE B
 24. CURB RAMP TYPE C
 25. ACCESSIBLE PARKING
 26. CONCRETE WHEELSTOP
 27. ACCESSIBLE RAMP AND HANDRAIL
 28. RETAINING WALL
 29. LUEDERS BLOCK BENCH
 30. WATER FEATURE
 31. WEST 14" DIA. CISTERN
 32. NORTHEAST 12" DIA. CISTERN
 33. SOUTHEAST 12" DIA. CISTERN
 34. TREE GRATE
 35. BOLLARD
 36. REMOVABLE BOLLARD
 37. FOOD TRUCK HOOKUP
 38. DUMPSTER ENCLOSURE
 39. LIVING SCREEN WALL
 40. MCKINNEY MUNICIPAL COMPLEX RE: ARCH. SHEETS
 41. BUILDING ENTRY RE: ARCH. SHEETS
 42. BUILDING CANOPY RE: ARCH. SHEETS
 43. CIVIC PLAZA PAVILION RE: ARCH. SHEETS
 44. CENTRAL UTILITY PLANT RE: ARCH. SHEETS
 45. BACK OF HOUSE LOADING AREA
 46. CURB INLET RE: CIVIL SHEETS
 47. FIRE HYDRANT RE: CIVIL SHEETS
 48. WATER METER RE: CIVIL SHEETS
 49. WATER VAULT RE: CIVIL SHEETS
 50. REMOTE FDC RE: CIVIL SHEETS
 51. FDC BOLLARD RE: CIVIL SHEETS
 52. MANHOLE RE: CIVIL SHEETS
 53. CLEANOUT RE: CIVIL SHEETS
 54. DRAIN INLET RE: CIVIL SHEETS
 55. ELECTRICAL TRANSFORMER
 56. ELECTRICAL EMERGENCY GENERATOR
 57. LOCATION FOR ELECTRICAL TEMPORARY GENERATOR
 58. ELECTRICAL SWITCH GEAR
 59. LIGHT FIXTURE
 60. STREET LIGHT POLE
 61. PEDESTRIAN LIGHT POLE
 62. HEADWALL AND RIPRAP RE: CIVIL SHEETS
 63. CONCRETE FLUME RE: CIVIL SHEETS
 64. PROPOSED EASEMENT RE: CIVIL SHEETS
 65. FARS ROOM
 66. FIRE COMMAND CENTER
 67. FIRE PUMP ROOM
 68. MOBILE AIR CONNECTION (EMAC)
 69. RIGHT OF WAY
 70. SIDEWALK BY OTHERS
 71. MCKINNEY SEAL
 72. ICE HOUSE RETAINING WALL
 73. ICE HOUSE SURVEY MONUMENT EMBEDDED IN PAVEMENT
 74. EV CHARGING STATION
 75. LIGHTING CABINET

VICINITY MAP



CONTROL POINT #1 "X" CUT TBM #26310	CONTROL POINT #2 "X" CUT TBM #27498
N - 7125648.99 E - 2546389.86 ELEV. 600.40	N - 7125027.73 E - 2546391.77 ELEV. - 603.99

EXISTING UTILITIES
CONTRACTOR MUST VERIFY LOCATION OF ALL OVERHEAD AND UNDERGROUND UTILITIES PRIOR TO CONSTRUCTION. CONTRACTOR SHALL COORDINATE WITH CITY OFFICIALS AND UTILITY COMPANIES IN LOCATING UTILITIES. CONTRACTOR SHALL BE HELD RESPONSIBLE FOR LOSSES DUE TO DAMAGE TO UTILITIES. LOCATION FOR ALL UTILITIES SHOWN ON PLANS ARE APPROXIMATE. CONTRACTOR SHALL CALL TEXAS 811, 1-800-344-8377.

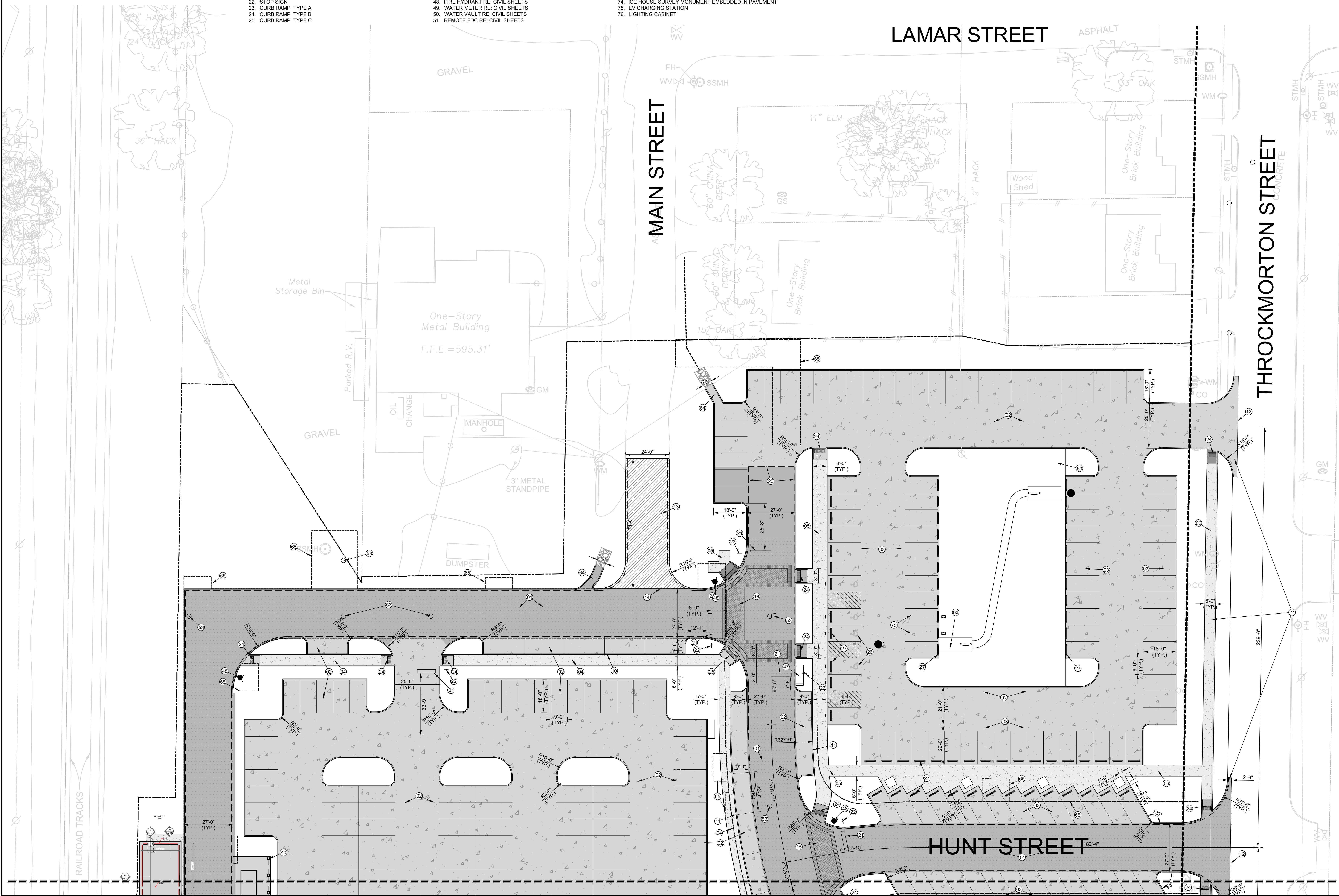

LAKE FLATO
+ **Parkhill**



Parkhill.com

McKinney Municipal Complex
City Hall and Council Chambers



CLIENT
City of McKinney
201 E Virginia St
McKinney, TX 75069

PROJECT NO.
6028.20

KEY PLAN

#	DATE	DESCRIPTION
1	08/05/2022	Site Plan Resubmittal
2	05/31/2022	Site Plan Submittal

Site Plan Area A
L-2

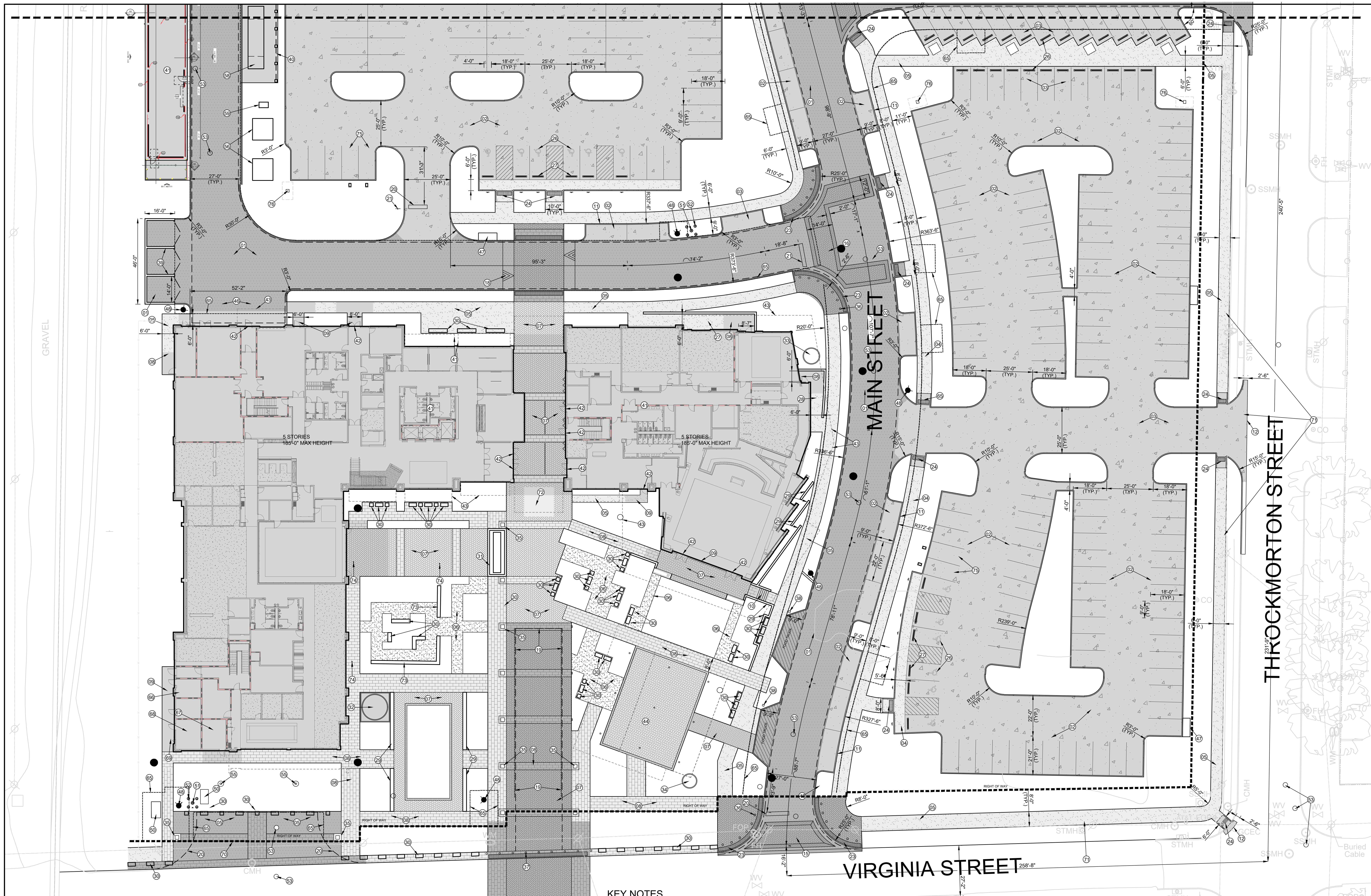

PAVING & JOINTING LAYOUT LEGEND

	DOWELED ISOLATION JOINT
	SAWED CONTROL JOINT
	8" CONCRETE PAVING ON TREATED SUBGRADE PER DETS. A1/LD500 & C3/LD500
	6" CONCRETE PAVING ON TREATED SUBGRADE PER DETS. A1/LD500 & C3/LD500
	5" CONCRETE PAVING ON TREATED SUBGRADE PER DETS. A1/LD500 & C3/LD500
	5" CONCRETE PAVING ON COMPACTED SUBGRADE PER DET. C3/LD500 & D3/LD500
	ASPHALT PAVING ON FLEX BASE PER DET. -LD500 & -LD500
	STRUCTURAL CONCRETE PAVING (REF. STRUCTURAL SHEETS)
	DECOMPOSED GRANITE PER DET. -LD500

EXISTING UTILITIES
 CONTRACTOR MUST VERIFY LOCATION OF ALL OVERHEAD AND UNDERGROUND UTILITIES PRIOR TO CONSTRUCTION. CONTRACTOR SHALL COORDINATE WITH CITY OFFICIALS AND UTILITY COMPANIES IN LOCATING UTILITIES. CONTRACTOR SHALL BE HELD RESPONSIBLE FOR LOSSES DUE TO DAMAGE TO UTILITIES. LOCATION FOR ALL UTILITIES SHOWN ON PLANS ARE APPROXIMATE. CONTRACTOR SHALL CALL TEXAS 811, 1-800-344-8377.

CONTROL POINT #1 "X" CUT TBM #26310	CONTROL POINT #2 "X" CUT TBM #27498
N - 7125048.99 E - 2546389.86 ELEV. - 600.40	N - 7125027.73 E - 2546391.77 ELEV. - 603.99

KEY NOTES

- AS INDICATED BY: (C)
- 8" CONC. PAVING W/ MONOLITHIC CURB ON TREATED SUBGRADE
 - 6" CONC. PAVING W/ MONOLITHIC CURB ON TREATED SUBGRADE
 - 6" CONC. PAVING ON TREATED SUBGRADE
 - 5" CONC. PAVING W/ MONOLITHIC CURB ON TREATED SUBGRADE
 - 5" CONC. PAVING ON COMPACTED SUBGRADE PER CONCRETE PAVERS ON CONCRETE SUBGRADE
 - SPECIALTY CONCRETE PAVING ON COMPACTED/TREATED SUBGRADE
 - DECOMPOSED GRANITE
 - CONCRETE AT BUILDING SLAB
 - CONCRETE STEPS & HANDRAIL
 - CURB & SIDEWALK CONNECTION
 - CONNECTION TO EX. CONCRETE
 - ASPHALT PAVING ON FLEX BASE
 - CONCRETE TO ASPHALT PAVING CONNECTION
 - PEDESTRIAN CROSSWALK TYPE A
 - PEDESTRIAN CROSSWALK TYPE B
 - ELEVATED PEDESTRIAN CROSSWALK TYPE A
 - ELEVATED PEDESTRIAN CROSSWALK TYPE B
 - PLAZA FIRE LANE MARKINGS
 - FIRE LANE STRIPING
 - STOP BAR STRIPING
 - STOP SIGN
 - CURB RAMP TYPE A
 - CURB RAMP TYPE B
 - CURB RAMP TYPE C
 - ACCESSIBLE PARKING
 - CONCRETE WHEELSTOP
 - ACCESSIBLE RAMP AND HANDRAIL
 - RETAINING WALL
 - LUEDERS BLOCK BENCH
 - WATER FEATURE
 - WEST 14'-2" DIA. CISTERN
 - NORTHEAST 12" DIA. CISTERN
 - SOUTHEAST 12" DIA. CISTERN
 - TREE GRATE
 - BOLLARD
 - REMOVABLE BOLLARD
 - FOOD TRUCK HOOKUP
 - DUMPSTER ENCLOSURE
 - LIVING SCREEN WALL
 - MCKINNEY MUNICIPAL COMPLEX RE: ARCH. SHEETS
 - PEDESTRIAN CROSSWALK TYPE B
 - BUILDING CANOPY RE: ARCH. SHEETS
 - CIVIC PLAZA PAVILION RE: ARCH. SHEETS
 - CENTRAL UTILITY PLANT RE: ARCH. SHEETS
 - BACK OF HOUSE LOADING AREA
 - CURB INLET RE: CIVIL SHEETS
 - FIRE HYDRANT RE: CIVIL SHEETS
 - WATER METER RE: CIVIL SHEETS
 - WATER VAULT RE: CIVIL SHEETS
 - REMOTE FDC RE: CIVIL SHEETS
 - FDC BOLLARD RE: CIVIL SHEETS
 - MANHOLE RE: CIVIL SHEETS
 - CLEANOUT RE: CIVIL SHEETS
 - DRAIN INLET RE: CIVIL SHEETS
 - ELECTRICAL TRANSFORMER
 - ELECTRICAL EMERGENCY GENERATOR
 - LOCATION FOR ELECTRICAL TEMPORARY GENERATOR
 - ELECTRICAL SWITCH GEAR
 - LIGHT FIXTURE
 - STREET LIGHT POLE
 - PEDESTRIAN LIGHT POLE
 - HEADWALL AND RIPRAP RE: CIVIL SHEETS
 - CONCRETE FLUME RE: CIVIL SHEETS
 - PROPOSED EASEMENT RE: CIVIL SHEETS
 - FARS ROOM
 - FIRE COMMAND CENTER
 - FIRE PUMP ROOM
 - MOBILE AIR CONNECTION (EMAC)
 - RIGHT OF WAY
 - SIDEWALK BY OTHERS
 - MCKINNEY SEAL
 - ICE HOUSE RETAINING WALL
 - ICE HOUSE SURVEY MONUMENT EMBEDDED IN PAVEMENT
 - EV CHARGING STATION
 - LIGHTING CABINET

VICINITY MAP

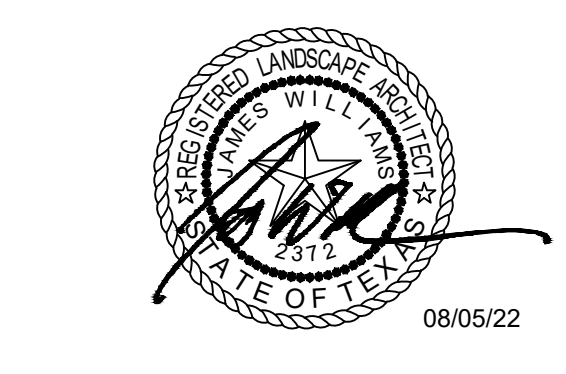

#	DATE	DESCRIPTION
1	08/05/2022	Site Plan Resubmittal
2	05/31/2022	Site Plan Submittal

