

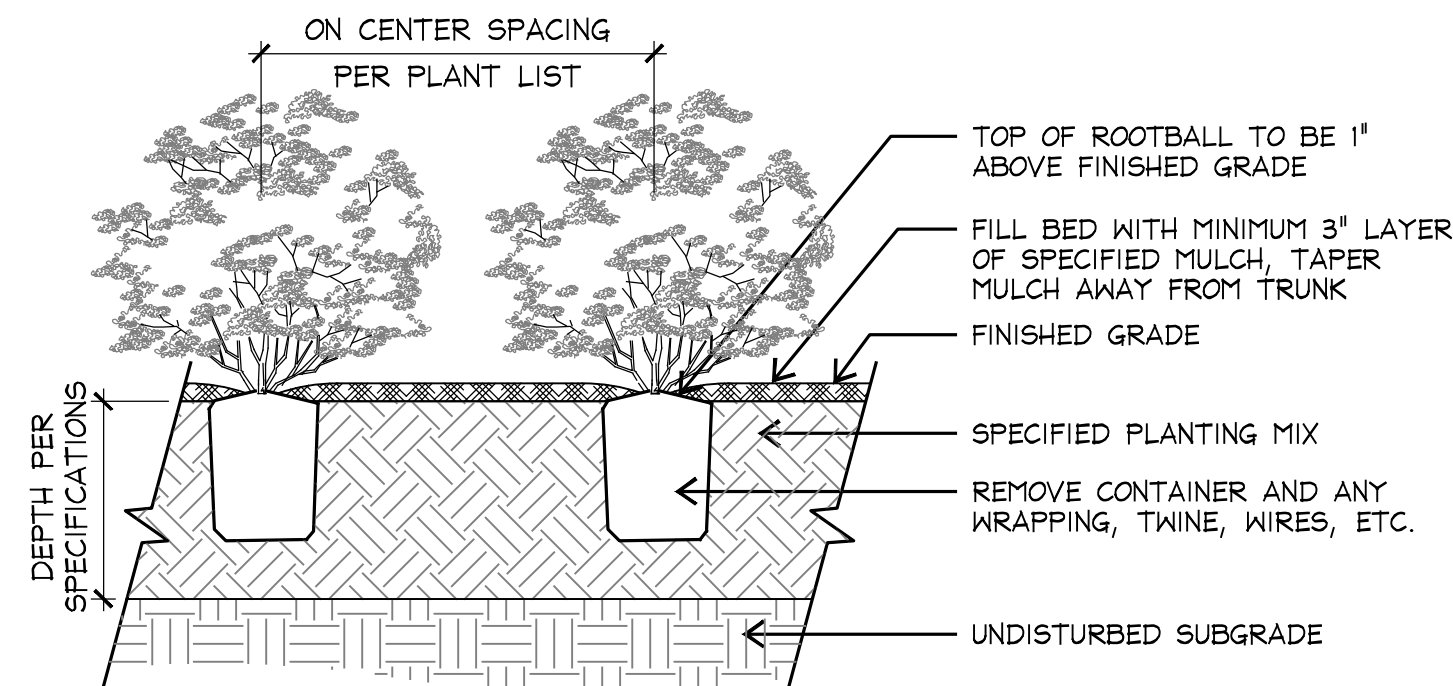



**GENERAL LANDSCAPE NOTES:**

- 1) THE CONTRACTOR SHALL BE FAMILIAR WITH EXISTING SITE CONDITIONS AND UNDERGROUND UTILITIES, SMALL PIPES AND STRUCTURES. THE CONTRACTOR SHALL TAKE SOLE RESPONSIBILITY FOR ANY COST INCURRED DUE TO BODILY INJURY AND/OR DAMAGE TO OWNER'S PROPERTY OR SAID UTILITIES. THE CONTRACTOR IS RESPONSIBLE FOR CONTACTING UTILITY COMPANIES BEFORE EXCAVATION.
- 2) THE CONTRACTOR SHALL LOCATE AND VERIFY THE CONDITION OF UTILITIES PRIOR TO ANY EXCAVATION. EXTREME CARE SHALL BE EXERCISED IN EXCAVATING AND WORKING NEAR EXISTING UTILITIES. THE CONTRACTOR SHALL HAND DIG PLANTING PITS AND HAND RAKE LAWN AREAS AS REQUIRED.
- 3) ALL CONFLICTING INFORMATION SHALL BE BROUGHT TO THE ATTENTION OF THE LANDSCAPE ARCHITECT.
- 4) THE CONTRACTOR SHALL NOT WILLFULLY PROCEED WITH CONSTRUCTION AS DESIGNED WHEN OBSTRUCTIONS AND/OR GRADE DIFFERENCES EXIST THAT MAY HAVE NOT BEEN KNOWN DURING DESIGN. SUCH CONDITIONS SHALL BE IMMEDIATELY BROUGHT TO THE ATTENTION OF THE LANDSCAPE ARCHITECT. THE CONTRACTOR SHALL ASSUME FULL RESPONSIBILITY FOR ALL NECESSARY REVISIONS DUE TO FAILURE TO GIVE SUCH NOTIFICATION.
- 5) THE CONTRACTOR SHALL BE RESPONSIBLE FOR ALL COORDINATION WITH HIS SUBCONTRACTORS TO ACCOMPLISH HIS SCOPE OF WORK. THE CONTRACTOR SHALL COORDINATE WITH OTHER TRADES WORKING ON THE SITE SIMULTANEOUSLY.
- 6) THE CONTRACTOR SHALL NOTIFY THE OWNER AND LANDSCAPE ARCHITECT 48 HOURS PRIOR TO THE COMMENCEMENT OF WORK TO COORDINATE PROJECT INSPECTION SCHEDULES.
- 7) THE CONTRACTOR SHALL BE RESPONSIBLE FOR FIELD VERIFICATION OF EXISTING CONDITIONS, AND SHALL PERFORM FIELD MEASUREMENTS PRIOR TO FABRICATION AND/OR PURCHASE OF ANY MATERIAL. THE CONTRACTOR SHALL CONTACT THE LANDSCAPE ARCHITECT SHOULD EXISTING CONDITIONS BE DIFFERENT FROM THE DESIGN DRAWINGS FOR THIS PROJECT. ALL CONFLICTS ARISING DUE TO LACK OF COORDINATION SHALL BE THE RESPONSIBILITY AND EXPENSE OF THE CONTRACTOR.
- 8) ANY REQUIRED CHANGES TO THE DRAWINGS RESULTING FROM THE ACCEPTANCE OF THE CONTRACTOR'S ALTERNATES AND/OR SUBSTITUTIONS ARE THE RESPONSIBILITY OF THE CONTRACTOR AND SHALL BE SUBMITTED TO THE LANDSCAPE ARCHITECT AND THE OWNER FOR APPROVAL.
- 9) THE CONTRACTOR SHALL COORDINATE THE STORAGE OF MATERIALS, PARKING OF VEHICLES AND RESTRICTIONS OF WORK AND ACCESS WITH THE OWNER. UNDER NO CIRCUMSTANCES SHALL ANY CONTRACTOR STORE MATERIALS OR PARK VEHICLES UNDER THE CANOPY OF EXISTING TREES.
- 10) THE CONTRACTOR SHALL COMPLY WITH ALL APPLICABLE FEDERAL, STATE AND LOCAL LAWS, ORDINANCES & CODE REQUIREMENTS. REQUIRED PERMITS SHALL BE OBTAINED BY THE CONTRACTOR.
- 11) THE CONTRACTOR SHALL PROVIDE UNIT PRICES BASED UPON THE QUANTITIES SHOWN WITHIN THE DOCUMENTS. FIELD CONDITIONS MAY REVISE ACTUAL LOCATION, INCREASING OR DECREASING THE EXTENT OF WORK PERFORMED. CHANGES TO THE EXTENT OF WORK RESULTING IN AN INCREASE OR DECREASE WILL BE BASED ON UNIT PRICES AND PERFORMED SUBJECT TO APPROVAL OF THE OWNER AND THE LANDSCAPE ARCHITECT IN THE FORM OF A CHANGE ORDER.
- 12) UNIT PRICES SHALL NOT ONLY INCLUDE THE COST OF THE ITEM BUT ALSO ALL LABOR, EQUIPMENT, AND OTHER MATERIALS (I.E. BACKFILL MIX, MULCH, STEEL EDGING, ETC.) ASSOCIATED WITH AND NECESSARY TO DELIVER THE ITEM COMPLETE AS DOCUMENTED IN THE DRAWINGS AND SPECIFICATIONS.
- 13) THE CONTRACTOR SHALL PROVIDE ALL LABOR, MATERIALS AND SUPERVISION NECESSARY TO ACCOMPLISH THE WORK AS SHOWN AND NOTED ON THE DRAWINGS, UNLESS OTHERWISE NOTED.
- 14) ALL CONTRACTORS AND SUBCONTRACTORS ARE RESPONSIBLE FOR REMOVAL OF TRASH AND REPAIR OF HAZARDOUS CONDITIONS (I.E. TOOLS, OPEN HOLES, ETC.) ON A DAILY BASIS BY END OF WORK DAY.
- 15) UPON COMPLETION OF CONSTRUCTION AND PRIOR TO FINAL APPROVAL, THE CONTRACTOR SHALL THOROUGHLY CLEAN UP THE PROJECT SITE OF ALL TRASH, SCRAPS, BRICK, ROCKS, MORTAR, ETC. REPAIR ALL DAMAGE TO FINISH GRADE INCLUDING TAILINGS FROM EXCAVATIONS, WHEEL RUTS OR ANY SETTLING OR EROSION OCCURRING PRIOR TO COMPLETION.
- 16) ALL REQUIRED LANDSCAPE AREAS SHALL BE PROVIDED WITH AN AUTOMATIC UNDERGROUND IRRIGATION SYSTEM WITH RAIN AND FREEZE SENSORS AND EVAPOTRANSPIRATION (ET) WEATHER BASED CONTROLLERS AND SAID IRRIGATION SYSTEM SHALL BE DESIGNED BY A QUALIFIED PROFESSIONAL AND INSTALLED BY A LICENSED IRRIGATOR.
- 17) THE CONTRACTOR SHALL VERIFY WATER RESTRICTIONS WITHIN THE CITY OF MCKINNEY AT TIME OF PLANTING. SHOULD WATER RESTRICTIONS NOT ALLOW HYDROMULCH, HYDROSEEDING, OR SPRIGGING (STAGE 3 AND STAGE 4 WATER RESTRICTIONS), AN APPROVED ALTERNATIVE FOR GRASSING SHALL BE INSTALLED.



**4 SHRUB PLANTING**  
ELEV SCALE: 1/2"=1'-0"

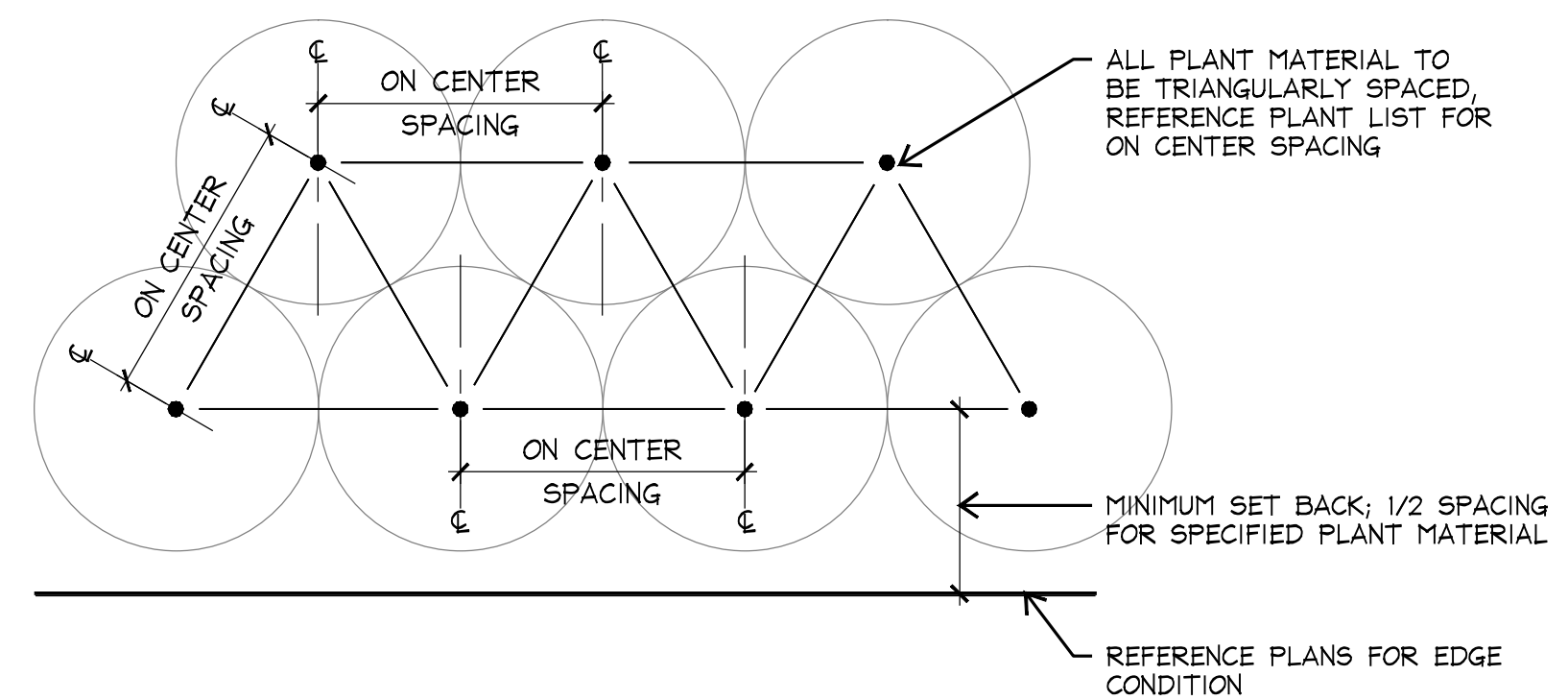

**3 PLANT SPACING**  
PLAN SCALE: 1/2"=1'-0"

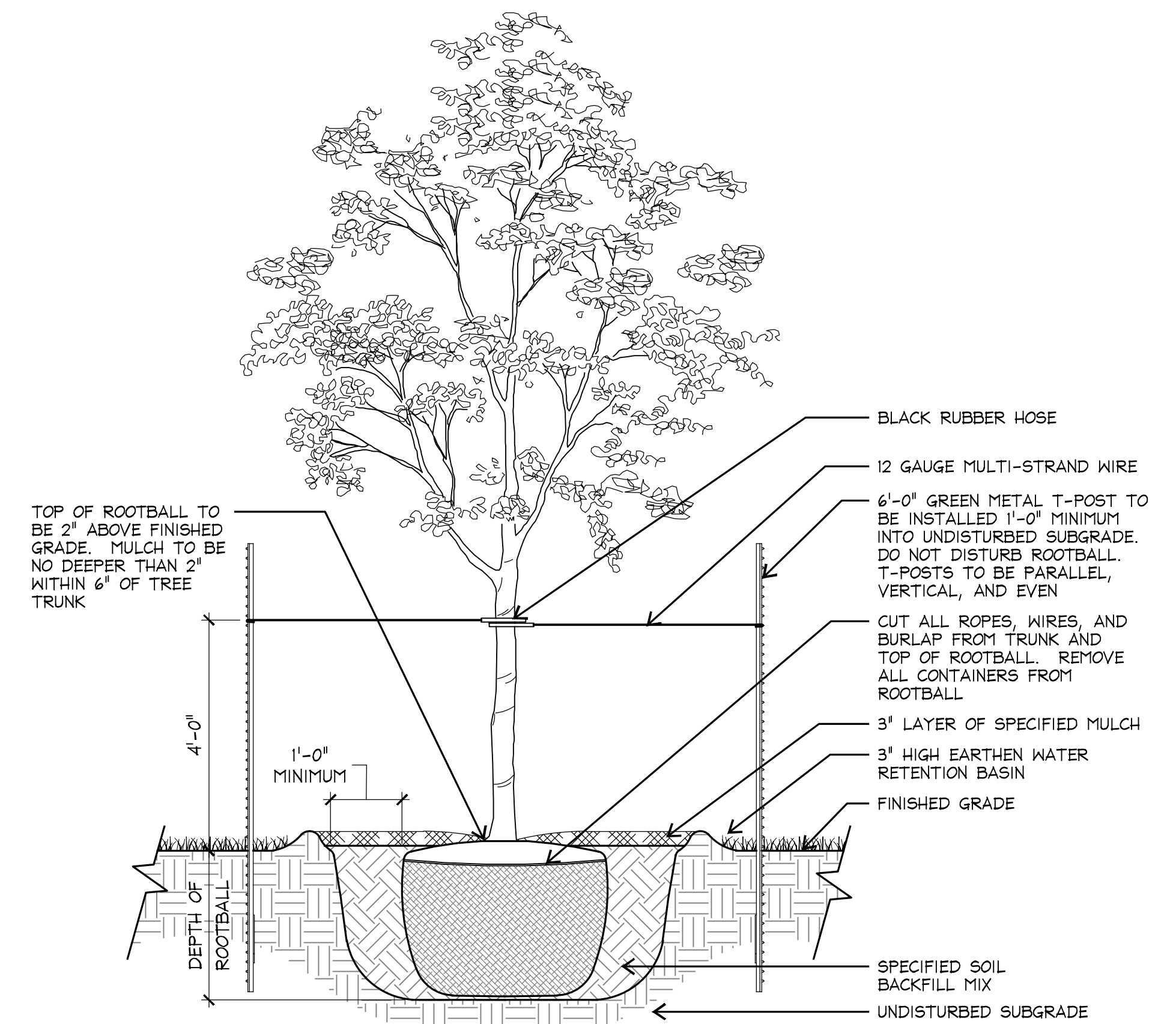

**2 STANDARD TRUNK TREE PLANTING**  
SECTION SCALE: 1/2"=1'-0"

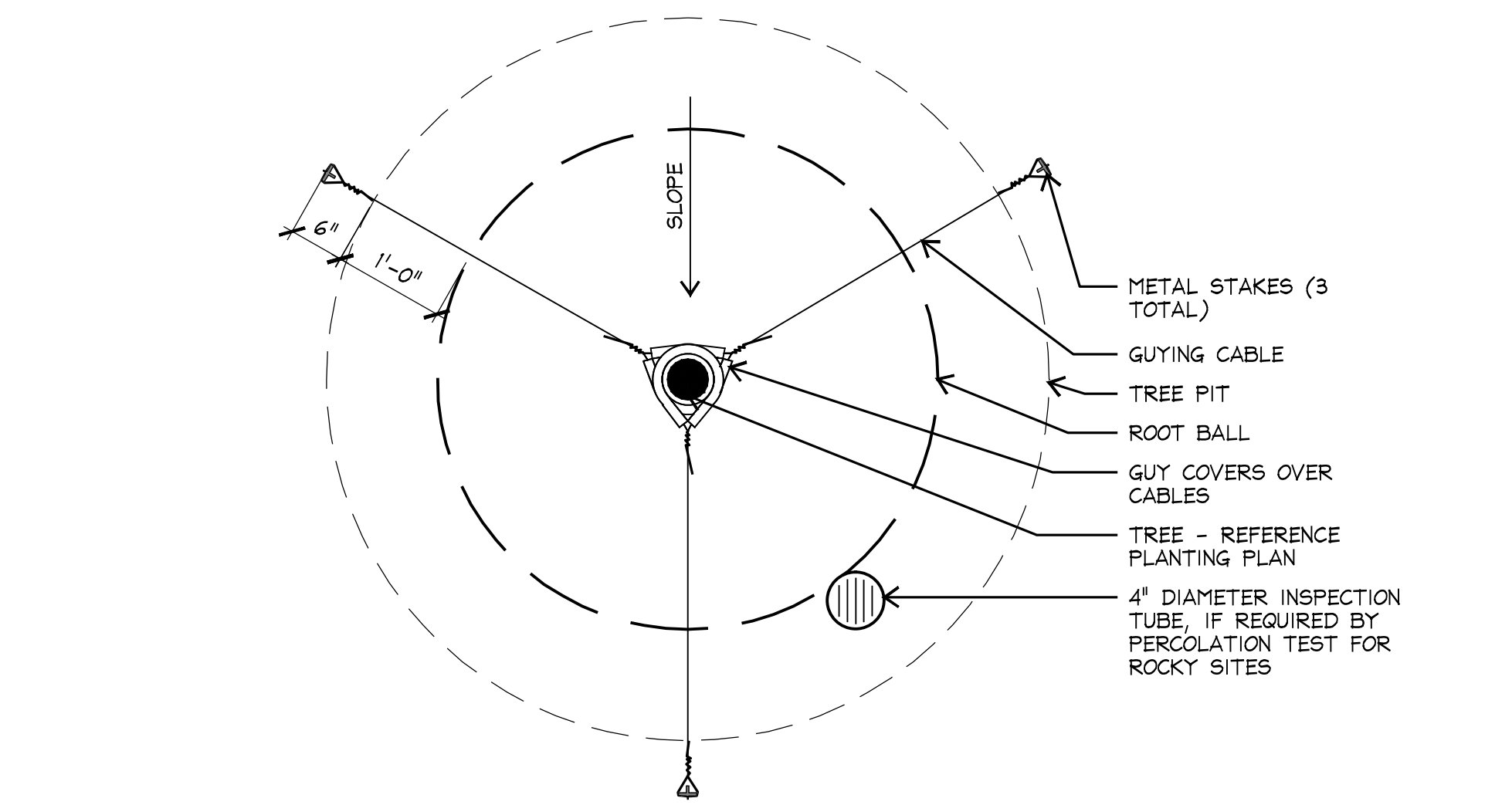

**1 >3" TREE STAKING**  
PLAN SCALE: 1/2"=1'-0"

**RECEIVED**  
By Kathy Wright at 7:53 am, Sep 10, 2013

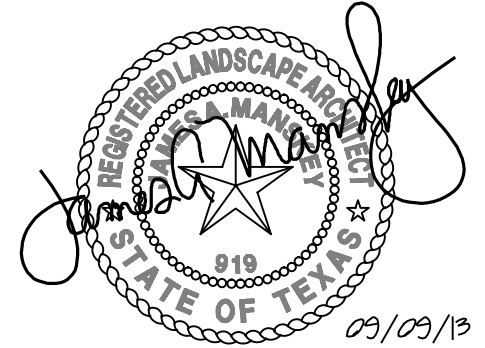

Landscape Architects • Planners  
5307 East Mockingbird Lane, Suite 120  
Dallas, Texas 75206  
(214) 744-0757 Fax: (214) 744-6785  
Austin • Dallas • Fort Lauderdale  
Fort Worth • Houston • San Antonio • Tulsa

Project:  
**GATEWAY HOTEL & EVENT CENTER**

ISSUE FOR PERMIT

1900 GATEWAY BLVD  
MCKINNEY, TEXAS

Project Number:  
D13749

Designed: JC  
Drawn: AB  
Reviewed: SA, JM

Date Issued:  
September 9, 2013

Revisions:  
\_\_\_\_\_  
\_\_\_\_\_  
\_\_\_\_\_  
\_\_\_\_\_

Sheet Title:  
**LANDSCAPE PERMIT PLANTING DETAILS**

Sheet Number:  
**LP 1.2**