

PLOT DATE: Friday, February 16, 2018  
 FILE NAME: E15-13 X-SP-Cinema Landscape 2018-01-31.dwg  
 FILE PATH: C:\Users\Shaka\_Jazzbeaux\Dropbox (Rodney)\EDG - Shirena\2017\380 Crossing At Headington Heights\_SWC\Cinema

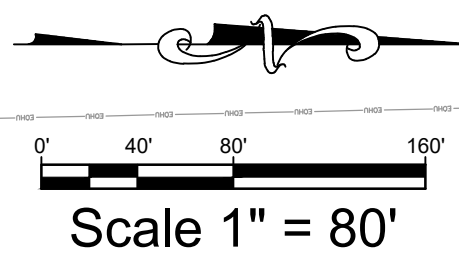
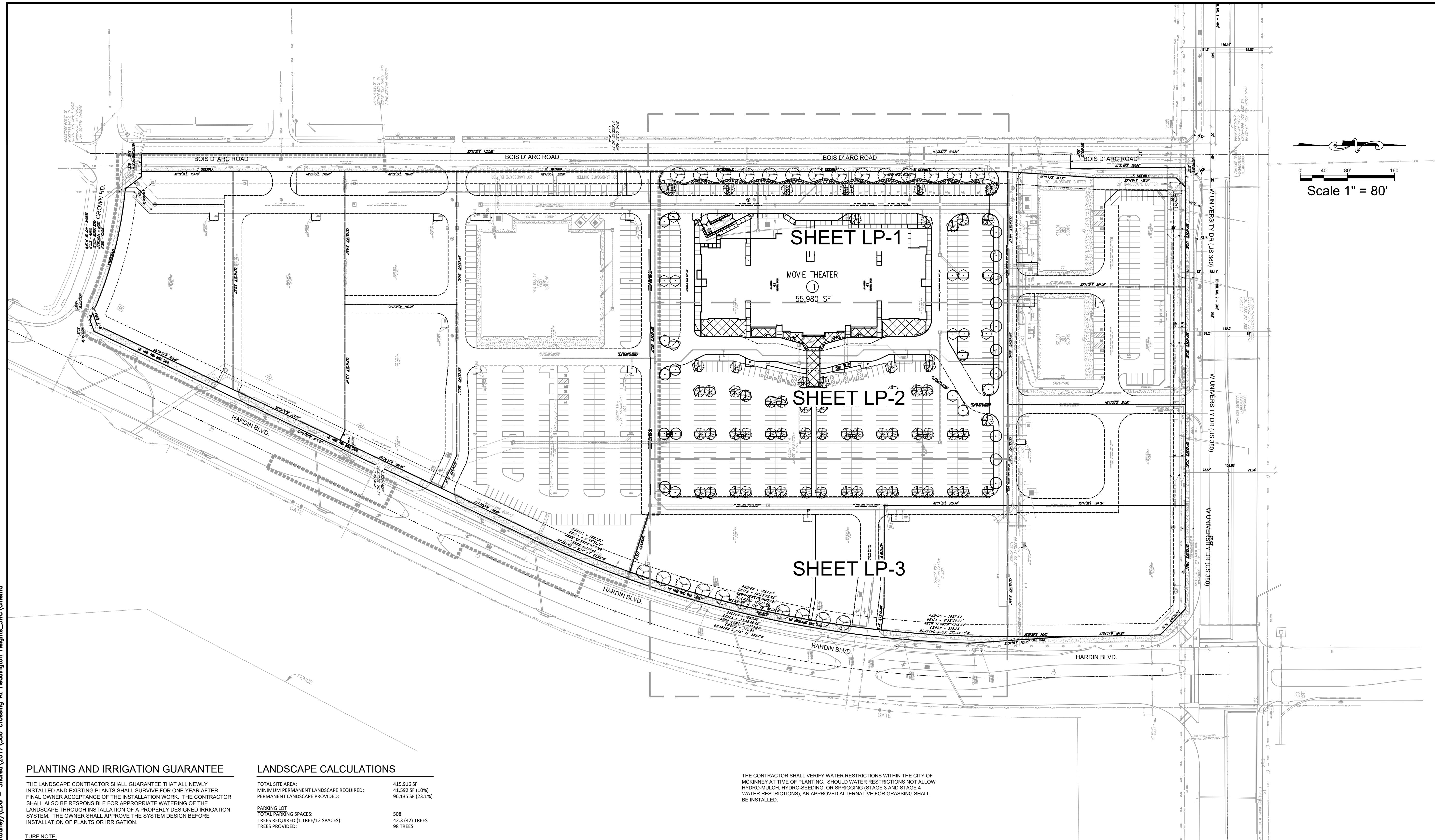

**PLANTING AND IRRIGATION GUARANTEE**

THE LANDSCAPE CONTRACTOR SHALL GUARANTEE THAT ALL NEWLY INSTALLED AND EXISTING PLANTS SHALL SURVIVE FOR ONE YEAR AFTER FINAL OWNER ACCEPTANCE OF THE INSTALLATION WORK. THE CONTRACTOR SHALL ALSO BE RESPONSIBLE FOR APPROPRIATE WATERING OF THE LANDSCAPE THROUGH INSTALLATION OF A PROPERLY DESIGNED IRRIGATION SYSTEM. THE OWNER SHALL APPROVE THE SYSTEM DESIGN BEFORE INSTALLATION OF PLANTS OR IRRIGATION.

**TURF NOTE:**  
 CONTRACTOR SHALL VERIFY CURRENT WATER RESTRICTIONS WITHIN THE CITY OF MCKINNEY PRIOR TO INSTALLATION. SHOULD WATER RESTRICTIONS PROHIBIT HYDROMULCH PER SPECIFICATION, (STAGE 3 OR STAGE 4 WATER RESTRICTIONS), AN APPROVED ALTERNATIVE FOR TURF INSTALLATION SHALL BE INSTALLED.

**IRRIGATION NOTE:**  
 ALL REQUIRED LANDSCAPE AREAS SHALL BE PROVIDED WITH AN AUTOMATIC UNDERGROUND IRRIGATION SYSTEM WITH RAIN AND FREEZE SENSORS AND EVAPOTRANSPIRATION (ET) WEATHER BASED CONTROLLERS AND SAID IRRIGATION SYSTEM SHALL BE DESIGNED BY A QUALIFIED PROFESSIONAL AND INSTALLED BY A LICENSED IRRIGATOR.

**LANDSCAPE CALCULATIONS**

TOTAL SITE AREA:	415,916 SF
MINIMUM PERMANENT LANDSCAPE REQUIRED:	41,592 SF (10%)
PERMANENT LANDSCAPE PROVIDED:	96,135 SF (23.1%)
<b>PARKING LOT</b>	
TOTAL PARKING SPACES:	508
TREES REQUIRED (1 TREE/12 SPACES):	42.3 (42) TREES
TREES PROVIDED:	98 TREES
<b>STREET YARD</b>	
HARDIN BLVD. TOTAL STREET YARD AREA:	13,131 SF
MINIMUM PERMANENT LANDSCAPE REQUIRED:	1,969 SF (15%)
PERMANENT LANDSCAPE PROVIDED:	11,177 SF (85%)
BOIS D'ARC TOTAL STREET YARD AREA:	12,326 SF
MINIMUM PERMANENT LANDSCAPE REQUIRED:	6,729 SF (55%)
PERMANENT LANDSCAPE PROVIDED:	10,503 SF (85%)
<b>STREET TREES</b>	
HARDIN BLVD @ 438 LF	
TREES REQUIRED (1 TREE/40 LF):	11 TREES
TREES PROVIDED:	11 TREES
BOIS D'ARC @ 563 LF	
TREES REQUIRED (1 TREE/40 LF):	14 TREES
TREES PROVIDED:	14 TREES

THE CONTRACTOR SHALL VERIFY WATER RESTRICTIONS WITHIN THE CITY OF MCKINNEY AT TIME OF PLANTING. SHOULD WATER RESTRICTIONS NOT ALLOW HYDRO-MULCH, HYDRO-SEEDING, OR SPRIGGING (STAGE 3 AND STAGE 4 WATER RESTRICTIONS), AN APPROVED ALTERNATIVE FOR GRASSING SHALL BE INSTALLED.



ISSUES		
NO.	DATE	DESCRIPTION



**CINEMARK @ 380 COMMONS**  
 LOT 4, 380 COMMONS AT  
 HEADINGTON HEIGHTS ADDITION  
 CITY OF MCKINNEY COLLIN COUNTY, TEXAS

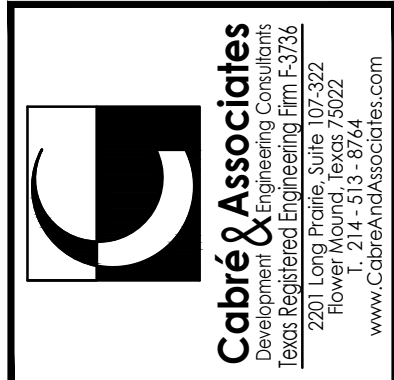
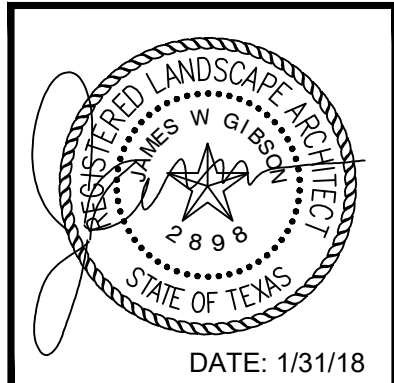

**LANDSCAPE PLANTINGS OVERALL PLAN**

DRAWING TITLE: LANDSCAPE PLANTINGS OVERALL PLAN

DATE: 2/16/18

SCALE: 1" = 80'

JOB NUMBER: 16-10

DRAWING NUMBER: LP-0

THIS DOCUMENT REPRESENTS THE DESIGN EFFORT OF CABRE & ASSOCIATES. CABRE & ASSOCIATES RETAINS TITLE AND OWNERSHIP OF THIS DOCUMENT. WHETHER THE PROJECT IS PROVIDED OR NOT AND FOR WHATEVER REASON, NO PART OF THIS DOCUMENT SHALL BE REPRODUCED OR TRANSMITTED IN ANY FORM OR BY ANY MEANS, OR USED ON OTHER PROJECTS OR EXTENSIONS TO THIS PROJECTS, UNLESS AUTHORIZED IN WRITING BY CABRE & ASSOCIATES.



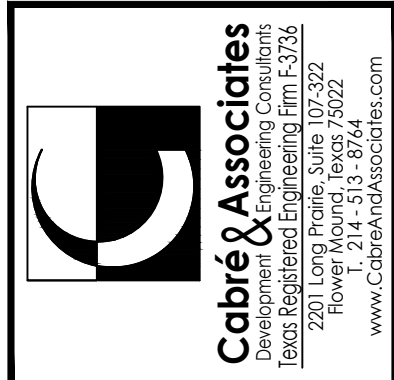
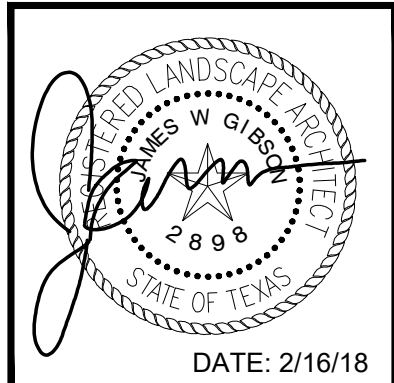

**LANDSCAPE PLANTINGS**

THIS DOCUMENT REPRESENTS THE DESIGN EFFORT OF CABRÉ & ASSOCIATES. CABRÉ & ASSOCIATES RETAINS TITLE AND OWNERSHIP OF THIS DOCUMENT. NO PART OF THIS DOCUMENT IS TO BE REPRODUCED, COPIED, OR TRANSMITTED IN ANY FORM OR BY ANY MEANS, WITHOUT THE WRITTEN PERMISSION OF CABRÉ & ASSOCIATES. THIS DOCUMENT IS TO BE USED ONLY FOR THE PROJECTS AND EXTENSIONS TO THIS PROJECTS, UNLESS AUTHORIZED IN WRITING BY CABRÉ & ASSOCIATES.

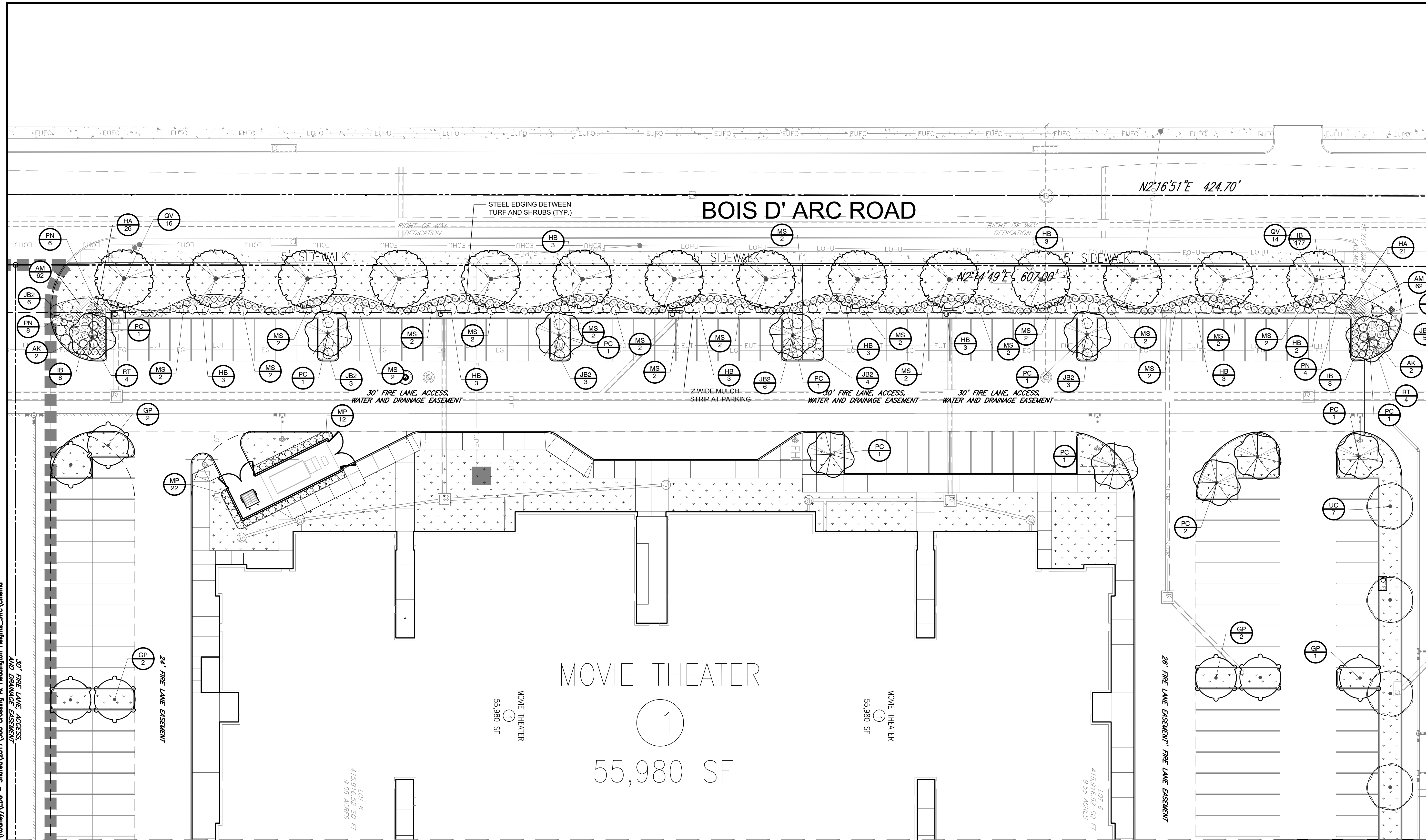

MATCHLINE - SEE SHEET LI-3

NOTE: SEE PLANT SCHEDULE ON SHEET LP-1

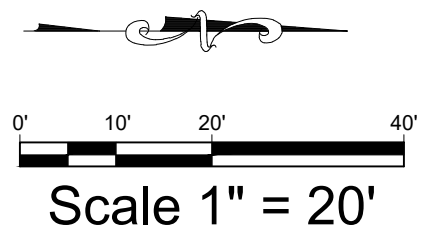

ISSUES		
NO.	DATE	DESCRIPTION

**DRAWING NUMBER:**  
**LP-2**

**DATE:** 2/16/18  
**SCALE:** 1" = 20'  
**JOB NUMBER:** 16-10

DATE: Friday, February 16, 2018  
 FILE NAME: 15-13 X-SP-Cinema Landscape 2018-01-31.dwg  
 FILE PATH: C:\Users\Shaka Jazbeaux\Dropbox (Rodney)\EDG - Shrews\2017\380 Crossing At Headington Heights\_SWC\Cinema

PLOT DATE: Friday, February 16, 2018  
 FILE NAME: 15-13 X-SP-Cinema Landscape 2018-01-31.dwg  
 FILE PATH: C:\Users\Shaka Jazbeaux\Dropbox (Rodney)\EDG - Shreve\2017\380 Crossing At Headington Heights\_SWC Cinema

587.48' 28" E 572.27'

30' FIRE LANE ACCESS

MATCHLINE - SEE SHEET LI-2

55,980 SF

LOT 6  
 415,916.52 SQ FT  
 9.55 ACRES

LOT 6  
 415,916.52 SQ FT  
 9.55 ACRES

LOT 6  
 415,916.52 SQ FT  
 9.55 ACRES

LOT 6  
 415,916.52 SQ FT  
 9.55 ACRES

MATCHLINE - SEE SHEET LI-4

NOTE: SEE PLANT SCHEDULE ON SHEET LI-1

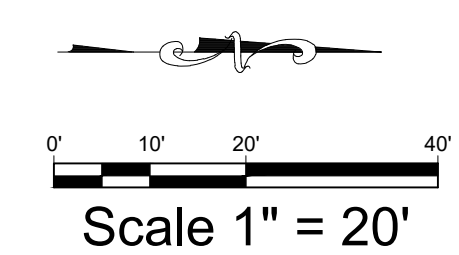

CINEMARK USA, INC.  
 3900 DALLAS PARKWAY, SUITE 500  
 PLANO, TX 75093

**CINEMARK @ 380 COMMONS**  
 LOT 4, 380 COMMONS AT  
 HEADINGTON HEIGHTS ADDITION  
 CITY OF MCKINNEY COLLIN COUNTY, TEXAS

**Cabré & Associates**  
 Development & Engineering Consultants  
 2201 Long Prairie, Suite 107-232  
 Flower Mound, Texas 75022  
 www.CabreandAssociates.com

**LANDSCAPE PLANTINGS**

THIS DOCUMENT REPRESENTS THE DESIGN EFFORT OF CABRE & ASSOCIATES. CABRE & ASSOCIATES RETAINS TITLE AND OWNERSHIP OF THIS DOCUMENT. WHETHER THE PROJECTS BE COMPLETED OR NOT, CABRE & ASSOCIATES SHALL NOT BE LIABLE FOR OR USED ON OTHER PROJECTS OR EXTENSIONS TO THIS PROJECTS, UNLESS AUTHORIZED IN WRITING BY CABRE & ASSOCIATES.

DRAWING TITLE: **LANDSCAPE PLANTINGS**

DATE: 2/16/18

SCALE: 1" = 20'

JOB NUMBER: 16-10

DRAWING NUMBER: **LP-3**

ISSUES		
NO.	DATE	DESCRIPTION

WATERWAY AND DRAINAGE EASEMENT

30' FIRE LANE ACCESS AND WATER EASEMENT

30' FIRE LANE ACCESS AND WATER EASEMENT

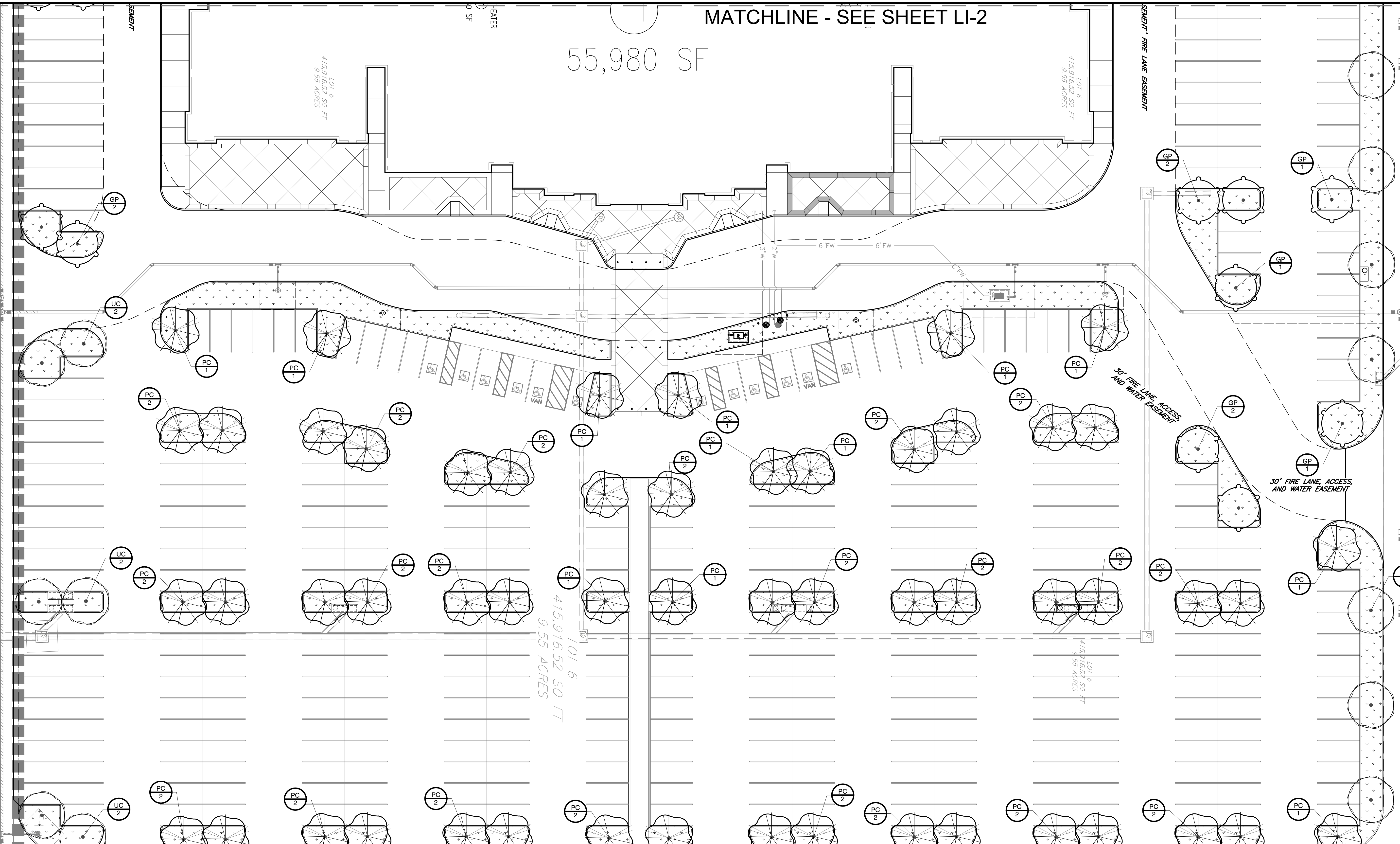

DATE: Friday, February 16, 2018  
 FILE NAME: 15-13 X-SP-Cinema Landscape 2018-01-31.dwg  
 FILE PATH: C:\Users\Shaka Jazbeaux\Dropbox (Rodney)\EDG - Shirena\2017\380 Crossing At Headington Heights\_SWC\Cinema

MATCHLINE - SEE SHEET LP-3

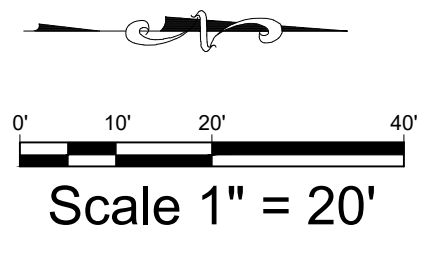
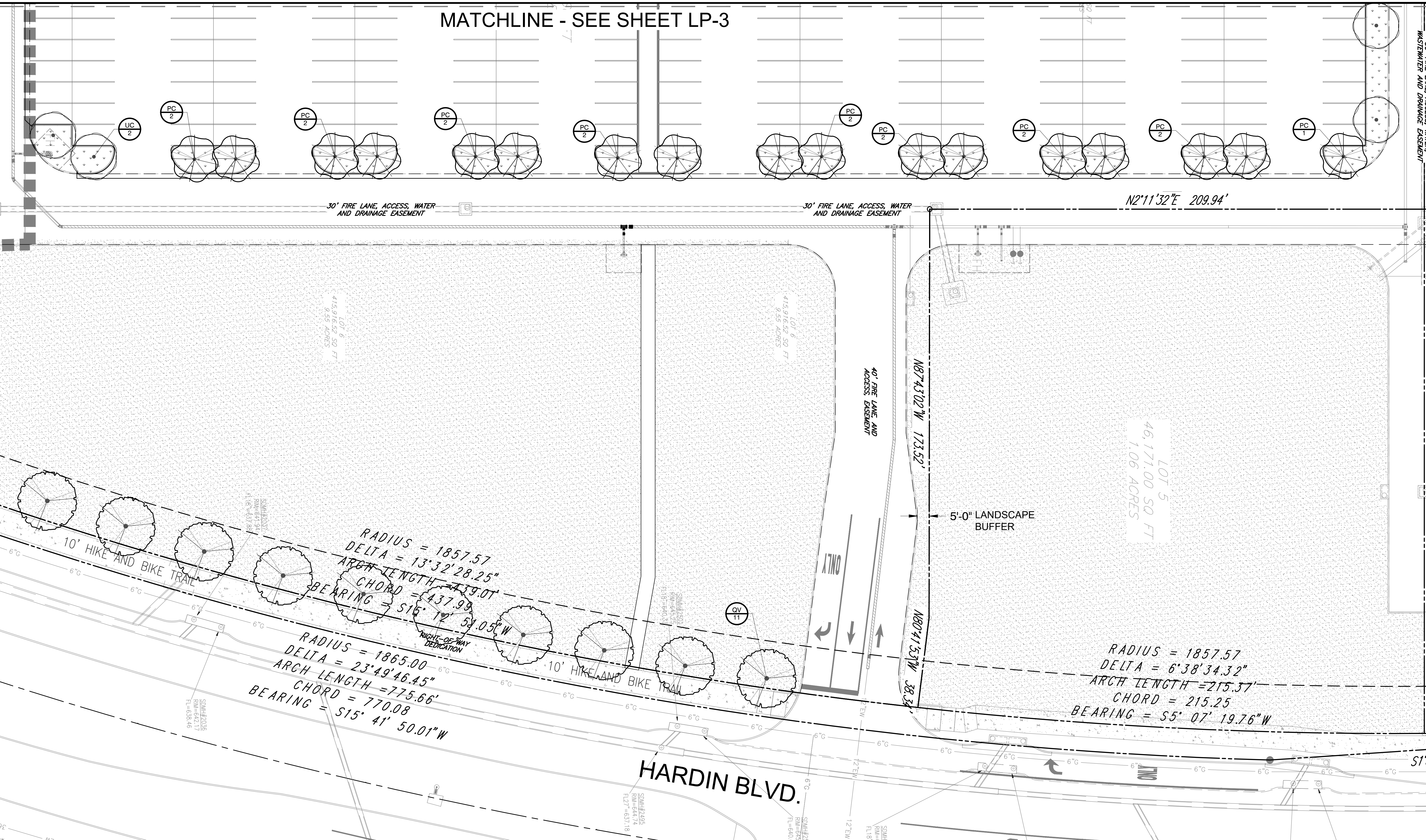

THE CONTRACTOR SHALL VERIFY WATER RESTRICTIONS WITHIN THE CITY OF MCKINNEY AT TIME OF PLANTING. SHOULD WATER RESTRICTIONS NOT ALLOW HYDRO-MULCH, HYDRO-SEEDING, OR SPRIGGING (STAGE 3 AND STAGE 4 WATER RESTRICTIONS), AN APPROVED ALTERNATIVE FOR GRASSING SHALL BE INSTALLED.

NOTE: SEE PLANT SCHEDULE ON SHEET LP-1



ISSUES		
NO.	DATE	DESCRIPTION

CINEMARK USA, INC.  
 3900 DALLAS PARKWAY, SUITE 500  
 PLANO, TX 75093

**CINEMARK @ 380 COMMONS**  
 LOT 4, 380 COMMONS AT  
 HEADINGTON HEIGHTS ADDITION  
 CITY OF MCKINNEY COLLIN COUNTY, TEXAS

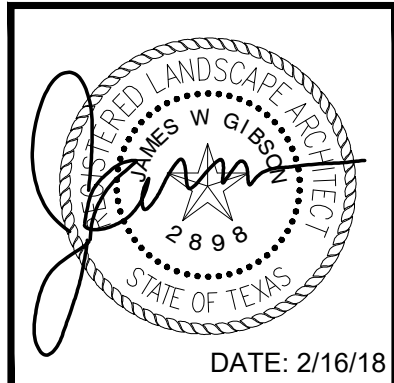

**LANDSCAPE PLANTINGS**

DRAWING TITLE: LANDSCAPE PLANTINGS

DATE: 2/16/18

SCALE: 1" = 20'

JOB NUMBER: 16-10

DRAWING NUMBER: **LP-4**

THIS DOCUMENT REPRESENTS THE DESIGN EFFORT OF CABRE & ASSOCIATES, INC. CABRE & ASSOCIATES, INC. RETAINS TITLE AND OWNERSHIP OF THIS DOCUMENT. NO PART OF THIS DOCUMENT IS TO BE REPRODUCED OR TRANSMITTED IN ANY FORM OR BY ANY MEANS, ELECTRONIC OR MECHANICAL, INCLUDING PHOTOCOPYING, RECORDING, OR BY ANY INFORMATION STORAGE AND RETRIEVAL SYSTEM, WITHOUT THE WRITTEN PERMISSION OF CABRE & ASSOCIATES, INC. THIS DOCUMENT IS NOT TO BE USED FOR ANY OTHER PROJECTS OR EXTENSIONS TO THIS PROJECTS, UNLESS AUTHORIZED IN WRITING BY CABRE & ASSOCIATES.

# PLANTING SPECIFICATIONS

## GENERAL

- A. QUALIFICATIONS OF LANDSCAPE CONTRACTOR**
- ALL LANDSCAPE WORK SHOWN ON THESE PLANS SHALL BE PERFORMED BY A SINGLE FIRM SPECIALIZING IN LANDSCAPE PLANTING.
  - A LIST OF SUCCESSFULLY COMPLETED PROJECTS OF THIS TYPE, SIZE AND NATURE MAY BE REQUESTED BY THE OWNER FOR FURTHER QUALIFICATION MEASURES.
  - THE LANDSCAPE CONTRACTOR SHALL HOLD A VALID NURSERY AND FLORAL CERTIFICATE ISSUED BY THE TEXAS DEPARTMENT OF AGRICULTURE, AS WELL AS OPERATE UNDER A COMMERCIAL PESTICIDE APPLICATOR LICENSE ISSUED BY EITHER THE TEXAS DEPARTMENT OF AGRICULTURE OR THE TEXAS STRUCTURAL PEST CONTROL BOARD.
- B. SCOPE OF WORK**
- WORK COVERED BY THESE SECTIONS INCLUDES THE FURNISHING AND PAYMENT OF ALL MATERIALS, LABOR, SERVICES, EQUIPMENT, LICENSES, TAXES AND ANY OTHER ITEMS THAT ARE NECESSARY FOR THE EXECUTION, INSTALLATION AND COMPLETION OF ALL WORK, SPECIFIED HEREIN AND / OR SHOWN ON THE LANDSCAPE PLANS, NOTES, AND DETAILS.
  - ALL WORK SHALL BE PERFORMED IN ACCORDANCE WITH ALL APPLICABLE LAWS, CODES AND REGULATIONS REQUIRED BY AUTHORITIES HAVING JURISDICTION OVER SUCH WORK, INCLUDING ALL INSPECTIONS AND PERMITS REQUIRED BY FEDERAL, STATE AND LOCAL AUTHORITIES IN SUPPLY, TRANSPORTATION AND INSTALLATION OF MATERIALS.
  - THE LANDSCAPE CONTRACTOR SHALL VERIFY THE LOCATION OF ALL UNDERGROUND UTILITY LINES (WATER, SEWER, ELECTRICAL, TELEPHONE, GAS, CABLE, TELEVISION, ETC.) PRIOR TO THE START OF ANY WORK.

## PRODUCTS

- A. ALL MANUFACTURED PRODUCTS SHALL BE NEW.**
- B. CONTAINER AND BALLED-AND-BURLAPPED PLANTS:**
- FURNISH NURSERY-GROWN PLANTS COMPLYING WITH ANSI Z60.1-2014. PROVIDE WELL-SHAPED, FULLY BRANCHED, HEALTHY, VIGOROUS STOCK FREE OF DISEASE, INSECTS, EGGS, LARVAE, AND DEFECTS SUCH AS KNOTS, SUN SCALD, INJURIES, ABRASIONS, AND DISFIGUREMENT. ALL PLANTS WITHIN A SPECIES SHALL HAVE SIMILAR SIZE, AND SHALL BE OF A FORM TYPICAL FOR THE SPECIES. ALL TREES SHALL BE OBTAINED FROM SOURCES WITHIN 200 MILES OF THE PROJECT SITE, AND WITH SIMILAR CLIMATIC CONDITIONS. ROOT SYSTEMS SHALL BE HEALTHY, DENSELY BRANCHED ROOT SYSTEMS, NON-POT-BOUND, FREE FROM ENCIRCLING AND/OR GIRDLING ROOTS, AND FREE FROM ANY OTHER ROOT DEFECTS (SUCH AS J-SHAPED ROOTS).
  - ANY PLANT DEEMED UNACCEPTABLE BY THE LANDSCAPE ARCHITECT OR OWNER SHALL BE IMMEDIATELY REMOVED FROM THE SITE AND SHALL BE REPLACED WITH AN ACCEPTABLE PLANT OF LIKE TYPE AND SIZE AT THE CONTRACTOR'S OWN EXPENSE. ANY PLANTS APPEARING TO BE UNHEALTHY, EVEN IF DETERMINED TO STILL BE ALIVE, SHALL NOT BE ACCEPTED. THE LANDSCAPE ARCHITECT AND OWNER SHALL BE THE SOLE JUDGES AS TO THE ACCEPTABILITY OF PLANT MATERIAL.
  - ALL TREES SHALL BE STANDARD IN FORM, UNLESS OTHERWISE SPECIFIED. TREES WITH CENTRAL LEADERS WILL NOT BE ACCEPTED IF LEADER IS DAMAGED OR REMOVED. PRUNE ALL DAMAGED TWIGS AFTER PLANTING.
  - CALIPER MEASUREMENTS FOR STANDARD (SINGLE TRUNK) TREES SHALL BE AS FOLLOWS: SIX INCHES ABOVE THE ROOT FLARE FOR TREES UP TO AND INCLUDING FOUR INCHES IN CALIPER, AND TWELVE INCHES ABOVE THE ROOT FLARE FOR TREES EXCEEDING FOUR INCHES IN CALIPER.
  - MULTI-TRUNK TREES SHALL BE MEASURED BY THEIR OVERALL HEIGHT, MEASURED FROM THE TOP OF THE ROOT BALL.
  - ANY TREE OR SHRUB SHOWN TO HAVE EXCESS SOIL PLACED ON TOP OF THE ROOT BALL, SO THAT THE ROOT FLARE HAS BEEN COMPLETELY COVERED, SHALL BE REJECTED.
- C. SOD:** PROVIDE WELL-ROOTED SOD OF THE VARIETY NOTED ON THE PLANS. SOD SHALL BE CUT FROM HEALTHY, MATURE TURF WITH SOIL THICKNESS OF 3/4" TO 1". EACH PALLET OF SOD SHALL BE ACCOMPANIED BY A CERTIFICATE FROM SUPPLIER STATING THE COMPOSITION OF THE SOD.
- D. SEED:** PROVIDE BLEND OF SPECIES AND VARIETIES AS NOTED ON THE PLANS, WITH MAXIMUM PERCENTAGES OF PURITY, GERMINATION, AND MINIMUM PERCENTAGE OF WEED SEED AS INDICATED ON PLANS. EACH BAG OF SEED SHALL BE ACCOMPANIED BY A TAG FROM THE SUPPLIER INDICATING THE COMPOSITION OF THE SEED, TOPSOIL, SANDY TO CLAY LOAM TOPSOIL, FREE OF STONES LARGER THAN 1/2 INCH, FOREIGN MATTER, PLANTS, ROOTS, AND SEEDS.
- F. COMPOST:** WELL-COMPOSTED, STABLE, AND WEED-FREE ORGANIC MATTER, pH RANGE OF 5.5 TO 8; MOISTURE CONTENT 35 TO 55 PERCENT BY WEIGHT; 100 PERCENT PASSING THROUGH 3/4-INCH SIEVE; SOLUBLE SALT CONTENT OF 5 TO 10 DECISEMENS/M; NOT EXCEEDING 0.5 PERCENT INERT CONTAMINANTS AND FREE OF SUBSTANCES TOXIC TO PLANTINGS. NO MANURE OR ANIMAL-BASED PRODUCTS SHALL BE USED.
- G. PLANTING MIX FOR POTS:** AN EQUAL PART MIXTURE OF TOPSOIL, SAND AND COMPOST. INCORPORATE "GELSCAPE", AS MADE BY AMERCO, INC. (800) 832-8788, AT THE RATE OF 3 LB. PER CUBIC YARD OF PLANTING MIX.
- H. FERTILIZER:** GRANULAR FERTILIZER CONSISTING OF NITROGEN, PHOSPHORUS, POTASSIUM, AND OTHER NUTRIENTS IN PROPORTIONS, AMOUNTS, AND RELEASE RATES RECOMMENDED IN A SOIL REPORT FROM A QUALIFIED SOIL-TESTING AGENCY (SEE BELOW).
- I. MULCH:** SIZE AND TYPE AS INDICATED ON PLANS. FREE FROM DELETERIOUS MATERIALS AND SUITABLE AS A TOP DRESSING OF TREES AND SHRUBS.
- J. WEED FABRIC:** 5 OUNCE, WOVEN, NEEDLE-PUNCHED FABRIC, SUCH AS DEWITT PROS LANDSCAPE FABRIC (OR APPROVED EQUAL).
- K. TREE STAKING AND GUYING**
- STAKES: 6' LONG GREEN METAL T-POSTS.
  - GUY AND TIE WIRE: ASTM A 641, CLASS 1, GALVANIZED-STEEL WIRE, 2-STRAND, TWISTED, 0.106 INCH DIAMETER.
  - STRAP CHAFING GUARD: REINFORCED NYLON OR CANVAS AT LEAST 1-1/2 INCH WIDE, WITH GROMMETS TO PROTECT TREE TRUNKS FROM DAMAGE.
- L. STEEL EDGING:** PROFESSIONAL STEEL EDGING, 14 GAUGE THICK X 4 INCHES WIDE, FACTORY PAINTED DARK GREEN. ACCEPTABLE MANUFACTURERS INCLUDE COL-MET OR APPROVED EQUAL.
- M. PRE-EMERGENT HERBICIDES:** ANY GRANULAR, NON-STAINING PRE-EMERGENT HERBICIDE THAT IS LABELED FOR THE SPECIFIC ORNAMENTALS OR TURF ON WHICH IT WILL BE UTILIZED. PRE-EMERGENT HERBICIDES SHALL BE APPLIED PER THE MANUFACTURER'S LABELED RATES.

## METHODS

- A. SOIL PREPARATION**
- BEFORE STARTING WORK, THE LANDSCAPE CONTRACTOR SHALL VERIFY THAT THE GRADE OF ALL LANDSCAPE AREAS ARE WITHIN +0.1' OF FINISH GRADE. THE CONTRACTOR SHALL NOTIFY THE OWNER IMMEDIATELY SHOULD ANY DISCREPANCIES EXIST.
  - SOIL TESTING:
    - AFTER FINISH GRADES HAVE BEEN ESTABLISHED, CONTRACTOR SHALL HAVE SOIL SAMPLES TESTED BY AN ESTABLISHED SOIL TESTING LABORATORY FOR THE FOLLOWING: SOIL TEXTURAL CLASS, GENERAL SOIL FERTILITY, pH, ORGANIC MATTER CONTENT, SALT (CEC), LIME, SODIUM ADSORPTION RATIO (SAR) AND BORON CONTENT. EACH SAMPLE SUBMITTED SHALL CONTAIN NO LESS THAN ONE QUART OF SOIL.
    - CONTRACTOR SHALL ALSO SUBMIT THE PROJECT'S PLANT LIST TO THE LABORATORY ALONG WITH THE SOIL SAMPLES.
    - THE SOIL REPORT PRODUCED BY THE LABORATORY SHALL CONTAIN RECOMMENDATIONS FOR THE FOLLOWING (AS APPROPRIATE): GENERAL SOIL PREPARATION AND BACKFILL MIXES, PRE-PLANT FERTILIZER APPLICATIONS, AND ANY OTHER SOIL RELATED ISSUES. THE REPORT SHALL ALSO PROVIDE A FERTILIZER PROGRAM FOR THE ESTABLISHMENT PERIOD AND FOR LONG-TERM MAINTENANCE.
  - THE CONTRACTOR SHALL INSTALL SOIL AMENDMENTS AND FERTILIZERS PER THE SOILS REPORT RECOMMENDATIONS. ANY CHANGE IN COST DUE TO THE SOILS REPORT RECOMMENDATIONS, EITHER INCREASE OR DECREASE, SHALL BE SUBMITTED TO THE OWNER WITH THE REPORT.
  - FOR SODDING PURPOSES ONLY, THE SOIL PREPARATION SHALL CONSIST OF THE FOLLOWING:
    - TURF: INCORPORATE THE FOLLOWING AMENDMENTS INTO THE TOP 8" OF SOIL BY MEANS OF ROTOTILLING AFTER CROSS-RIPPING:
      - NITROGEN STABILIZED ORGANIC AMENDMENT - 4 CU. YDS. PER 1,000 S.F.
      - AMMONIUM PHOSPHATE 16-20-0 - 15 LBS PER 1,000 S.F.
      - AGRICULTURAL GYPSUM - 100 LBS PER 1,000 S.F.
    - TREES, SHRUBS, AND PERENNIALS: INCORPORATE THE FOLLOWING AMENDMENTS INTO THE TOP 8" OF SOIL BY MEANS OF ROTOTILLING AFTER CROSS-RIPPING:
      - NITROGEN STABILIZED ORGANIC AMENDMENT - 4 CU. YDS. PER 1,000 S.F.
      - 12-12-12 FERTILIZER - 10 LBS. PER CU. YD.
      - AGRICULTURAL GYPSUM - 10 LBS. PER CU. YD.
    - IRON SULPHATE - 2 LBS. PER CU. YD.
  - CONTRACTOR SHALL ENSURE THAT THE GRADE IN SOD AREAS SHALL BE 1" BELOW FINISH GRADE BEFORE INSTALLING SOIL AMENDMENTS, AND 2" BELOW FINISH GRADE IN SHRUB AREAS BEFORE INSTALLING SOIL AMENDMENTS. MULCH COVER WITHIN 6" OF CONCRETE WALKS AND CURBS SHALL NOT PROTRUDE ABOVE THE FINISH SURFACE OF THE WALKS AND CURBS. MULCH COVER WITHIN 12" OF WALLS SHALL BE AT LEAST 3" LOWER THAN THE TOP OF WALL.
  - ONCE SOIL PREPARATION IS COMPLETE, THE LANDSCAPE CONTRACTOR SHALL ENSURE THAT THERE ARE NO DEBRIS, TRASH, OR STONES LARGER THAN 1" REMAINING IN THE TOP 6" OF SOIL.

## B. GENERAL PLANTING

- REMOVE ALL NURSERY TAGS AND STAKES FROM PLANTS.
  - EXCEPT IN AREAS TO BE PLANTED WITH ORNAMENTAL GRASSES, APPLY PRE-EMERGENT HERBICIDES AT THE MANUFACTURER'S RECOMMENDED RATE.
  - TRENCHING NEAR EXISTING TREES:
    - CONTRACTOR SHALL NOT DISTURB ROOTS 1-1/2' AND LARGER IN DIAMETER WITHIN THE CRITICAL ROOT ZONE (CRZ) OF EXISTING TREES, AND SHALL EXERCISE ALL POSSIBLE CARE AND PRECAUTIONS TO AVOID INJURY TO TREE ROOTS, TRUNKS, AND BRANCHES. THE CRZ IS DEFINED AS A CIRCULAR AREA EXTENDING OUTWARD FROM THE TREE TRUNK, WITH A RADIUS EQUAL TO 1' FOR EVERY 1" OF TRUNK DIAMETER-AT-BREAST-HEIGHT (4.5' ABOVE THE AVERAGE GRADE AT THE TRUNK).
    - ALL EXCAVATION WITHIN THE CRZ SHALL BE PERFORMED USING HAND TOOLS. NO MACHINE EXCAVATION OR TRENCHING OF ANY KIND SHALL BE ALLOWED WITHIN THE CRZ.
    - ALTER ALIGNMENT OF PIPE TO AVOID TREE ROOTS 1-1/2' AND LARGER IN DIAMETER. WHERE TREE ROOTS 1-1/2' AND LARGER IN DIAMETER ARE ENCOUNTERED IN THE FIELD, TUNNEL UNDER SUCH ROOTS. WRAP EXPOSED ROOTS WITH SEVERAL LAYERS OF BURLAP AND KEEP MOIST. CLOSE ALL TRENCHES WITHIN THE CANOPY DRIP LINES WITHIN 24 HOURS.
    - ALL SEVERED ROOTS SHALL BE HAND PRUNED WITH SHARP TOOLS AND ALLOWED TO AIR-DRY. DO NOT USE ANY SORT OF SEALERS OR WOUND PAINTS.
- C. TREE PLANTING**
- TREE PLANTING HOLES SHALL BE EXCAVATED TO MINIMUM WIDTH OF TWO TIMES THE WIDTH OF THE ROOTBALL, AND TO A DEPTH EQUAL TO THE DEPTH OF THE ROOTBALL LESS TWO TO FOUR INCHES.
  - SCARIFY THE SIDES AND BOTTOM OF THE PLANTING HOLE PRIOR TO THE PLACEMENT OF THE TREE. REMOVE ANY GLAZING THAT MAY HAVE BEEN CAUSED DURING THE EXCAVATION OF THE HOLE.
  - FOR CONTAINER AND BOX TREES, TO REMOVE ANY POTENTIALLY GIRDLING ROOTS AND OTHER ROOT DEFECTS, THE CONTRACTOR SHALL SHAVE A 1" LAYER OFF OF THE SIDES AND BOTTOM OF THE ROOTBALL OF ALL TREES JUST BEFORE PLACING INTO THE PLANTING PIT. DO NOT "TEASE" ROOTS OUT FROM THE ROOTBALL.
  - INSTALL THE TREE ON UNDISTURBED SUBGRADE SO THAT THE TOP OF THE ROOTBALL IS TWO TO FOUR INCHES ABOVE THE SURROUNDING GRADE.
  - BACKFILL THE TREE HOLE UTILIZING THE EXISTING TOPSOIL FROM ON-SITE. ROCKS LARGER THAN 1" DIA. AND ALL OTHER DEBRIS SHALL BE REMOVED FROM THE SOIL PRIOR TO THE BACKFILL. SHOULD ADDITIONAL SOIL BE REQUIRED TO ACCOMPLISH THIS TASK, USE STORED TOPSOIL FROM ON-SITE OR IMPORT ADDITIONAL TOPSOIL FROM OFF-SITE AT NO ADDITIONAL COST TO THE OWNER. IMPORTED TOPSOIL SHALL BE OF SIMILAR TEXTURAL CLASS AND COMPOSITION TO THE ON-SITE SOIL.
  - THE TOTAL NUMBER OF TREE STAKES (BEYOND THE MINIMUMS LISTED BELOW) WILL BE LEFT TO THE LANDSCAPE CONTRACTOR'S DISCRETION. SHOULD ANY TREES FALL OR LEAN, THE LANDSCAPE CONTRACTOR SHALL STRAIGHTEN THE TREE, OR REPLACE IT SHOULD IT BECOME DAMAGED. TREE STAKING SHALL ADHERE TO THE FOLLOWING GUIDELINES:
    - 1"-2" TREES: TWO STAKES PER TREE
    - 2"-1/2"-4" TREES: THREE STAKES PER TREE
    - TREES OVER 4" CALIPER: GUY AS NEEDED
    - MULTI-TRUNK TREES: THREE STAKES PER TREE MINIMUM, QUANTITY AND POSITIONS AS NEEDED TO STABILIZE THE TREE
  - UPON COMPLETION OF PLANTING, CONSTRUCT AN EARTH WATERING BASIN AROUND THE TREE. COVER THE INTERIOR OF THE TREE RINGS WITH MULCH (TYPE AND DEPTH PER PLANS).
- D. SHRUB, PERENNIAL, AND GROUND-COVER PLANTING**
- DIG THE PLANTING HOLES TWICE AS WIDE AND 2" LESS DEEP THAN EACH PLANT'S ROOTBALL. INSTALL THE PLANT IN THE HOLE. BACKFILL AROUND THE PLANT WITH SOIL AMENDED PER SOIL TEST RECOMMENDATIONS.
  - WHERE PLANTING IS CONSIDERED, INSTALL MULCH (TYPE AND DEPTH PER PLANS) OVER ALL PLANTING BEDS, COVERING THE ENTIRE PLANTING AREA.
- E. SODDING**
- SOD VARIETY TO BE AS SPECIFIED ON THE LANDSCAPE PLAN.
  - LAY SOD WITHIN 24 HOURS FROM THE TIME OF STRIPPING. DO NOT LAY IF THE GROUND IS FROZEN.
  - LAY THE SOD TO FORM A SOLID MASS WITH TIGHTLY FITTED JOINTS. BUTT ENDS AND SIDES OF SOD STRIPS - DO NOT OVERLAP. STAGGER STRIPS TO OFFSET JOINTS IN ADJACENT COURSES.
  - ROLL THE SOD TO ENSURE GOOD CONTACT OF THE SOD'S ROOT SYSTEM WITH THE SOIL UNDERNEATH.
  - WATER THE SOD THOROUGHLY WITH A FINE SPRAY IMMEDIATELY AFTER PLANTING TO OBTAIN AT LEAST SIX INCHES OF PENETRATION INTO THE SOIL BELOW THE SOD.
- F. HYDROMULCHING**
- TURF HYDROMULCH MIX (PER 1,000 SF) SHALL BE AS FOLLOWS:
    - WINTER MIX (OCTOBER 1 - MARCH 31)
      - 50# CELLULOSE FIBER MULCH
      - 2# UNHULLED BERMUODA SEED
      - 2# PERENNIAL RYE SEED
      - 15# 15-15-15 WATER SOLUBLE FERTILIZER
    - SUMMER MIX (APRIL 1 - SEPTEMBER 30)
      - 50# CELLULOSE FIBER MULCH
      - 2# UNHULLED BERMUODA SEED
      - 15# 15-15-15 WATER SOLUBLE FERTILIZER
  - SEED HYDROMULCH MIX (PER 1,000 SF) SHALL BE AS FOLLOWS:
    - GENERAL
      - 50# CELLULOSE FIBER MULCH
      - 15# 15-15-15 WATER SOLUBLE FERTILIZER
      - SEED RATE PER LEGEND

## G. CLEAN UP

- DURING LANDSCAPE PREPARATION AND PLANTING, KEEP ALL PAVEMENT CLEAN AND ALL WORK AREAS IN A NEAT, ORDERLY CONDITION.
- DISPOSED LEGALLY OF ALL EXCAVATED MATERIALS OFF THE PROJECT SITE.

## H. INSPECTION AND ACCEPTANCE

- UPON COMPLETION OF THE WORK, THE LANDSCAPE CONTRACTOR SHALL PROVIDE THE SITE CLEAN, FREE OF DEBRIS AND TRASH, AND SUITABLE FOR USE AS INTENDED. THE LANDSCAPE CONTRACTOR SHALL THEN REQUEST AN INSPECTION BY THE OWNER TO DETERMINE FINAL ACCEPTABILITY.
  - WHEN THE INSPECTED PLANTING WORK DOES NOT COMPLY WITH THE CONTRACT DOCUMENTS, THE LANDSCAPE CONTRACTOR SHALL REPLACE AND/OR REPAIR THE REJECTED WORK TO THE OWNER'S SATISFACTION WITHIN 24 HOURS.
  - THE LANDSCAPE MAINTENANCE PERIOD WILL NOT COMMENCE UNTIL THE LANDSCAPE WORK HAS BEEN RE-INSPECTED BY THE OWNER AND FOUND TO BE ACCEPTABLE. AT THAT TIME, A WRITTEN NOTICE OF FINAL ACCEPTANCE WILL BE ISSUED BY THE OWNER, AND THE MAINTENANCE AND GUARANTEE PERIODS WILL COMMENCE.
- I. LANDSCAPE MAINTENANCE**
- THE LANDSCAPE CONTRACTOR SHALL BE RESPONSIBLE FOR THE MAINTENANCE OF ALL WORK SHOWN ON THESE PLANS FOR 90 DAYS BEYOND FINAL ACCEPTANCE OF ALL LANDSCAPE WORK BY THE OWNER. LANDSCAPE MAINTENANCE SHALL INCLUDE WEEKLY SITE VISITS FOR THE FOLLOWING ACTIONS (AS APPROPRIATE): PROPER PRUNING, RESTAKING OF TREES, RESETTING OF PLANTS THAT HAVE SETTLED, MOWING AND AERATION OF LAWNS, WEEDING, RESEEDING AREAS WHICH HAVE NOT GERMINATED WELL, TREATING FOR INSECTS AND DISEASES, REPLACEMENT OF MULCH, REMOVAL OF LITTER, REPAIRS TO THE IRRIGATION SYSTEM DUE TO FAULTY PARTS AND/OR WORKMANSHIP, AND THE APPROPRIATE WATERING OF ALL PLANTINGS. THE LANDSCAPE CONTRACTOR SHALL MAINTAIN THE IRRIGATION SYSTEM IN PROPER WORKING ORDER, WITH SCHEDULING ADJUSTMENTS BY SEASON TO MAXIMIZE WATER CONSERVATION.
  - SHOULD SEEDING AND/OR SODDED AREAS NOT BE COVERED BY AN AUTOMATIC IRRIGATION SYSTEM, THE LANDSCAPE CONTRACTOR SHALL BE RESPONSIBLE FOR WATERING THESE AREAS AND OBTAINING A FULL, HEALTHY STAND OF GRASS AT NO ADDITIONAL COST TO THE OWNER.
  - TO ACHIEVE FINAL ACCEPTANCE AT THE END OF THE MAINTENANCE PERIOD, ALL OF THE FOLLOWING CONDITIONS MUST OCCUR:
    - THE LANDSCAPE SHALL SHOW ACTIVE, HEALTHY GROWTH (WITH EXCEPTIONS MADE FOR SEASONAL DORMANCY). ALL PLANTS NOT MEETING THIS CONDITION SHALL BE REJECTED AND REPLACED BY HEALTHY PLANT MATERIAL PRIOR TO FINAL ACCEPTANCE.
    - ALL HARDSCAPE SHALL BE CLEANED PRIOR TO FINAL ACCEPTANCE.
    - SODDED AREAS MUST BE ACTIVELY GROWING AND MUST REACH A MINIMUM HEIGHT OF 1 1/2 INCHES BEFORE FIRST MOWING. HYDROMULCHED AREAS SHALL SHOW ACTIVE, HEALTHY GROWTH. BARE AREAS LARGER THAN TWELVE SQUARE INCHES SHALL BE RESEDED OR RESEEDED (AS APPROPRIATE) PRIOR TO FINAL ACCEPTANCE. ALL SODDED TURF SHALL BE NEATLY MOWED.
- J. WARRANTY PERIOD, PLANT GUARANTEE AND REPLACEMENTS**
- THE LANDSCAPE CONTRACTOR SHALL GUARANTEE ALL TREES, SHRUBS, PERENNIALS, SOD SEEDING/HYDROMULCHED AREAS, AND IRRIGATION SYSTEMS FOR A PERIOD OF ONE YEAR FROM THE DATE OF THE OWNER'S FINAL ACCEPTANCE (90 DAYS FOR ANNUAL PLANTS). THE CONTRACTOR SHALL REPLACE, AT HIS OWN EXPENSE AND TO THE SATISFACTION OF THE OWNER, ANY PLANTS WHICH DIE IN THAT TIME, OR REPAIR ANY PORTIONS OF THE IRRIGATION SYSTEM WHICH OPERATE IMPROPERLY.
  - AFTER THE INITIAL MAINTENANCE PERIOD AND DURING THE GUARANTEE PERIOD, THE LANDSCAPE CONTRACTOR SHALL ONLY BE RESPONSIBLE FOR REPLACEMENT OF PLANTS WHEN PLANT DEATH CANNOT BE ATTRIBUTED DIRECTLY TO OVERWATERING OR OTHER DAMAGE BY HUMAN ACTIONS.
- PROVIDE A MINIMUM OF (2) COPIES OF RECORD DRAWINGS TO THE OWNER UPON COMPLETION OF WORK. A RECORD DRAWING IS A RECORD OF ALL CHANGES THAT OCCURRED IN THE FIELD AND THAT ARE DOCUMENTED THROUGH CHANGE ORDERS, ADDENDA, OR CONTRACTOR/CONSULTANT DRAWING MARKUPS.

## K. LANDSCAPE MAINTENANCE

- THE LANDSCAPE CONTRACTOR SHALL GUARANTEE ALL TREES, SHRUBS, PERENNIALS, SOD SEEDING/HYDROMULCHED AREAS, AND IRRIGATION SYSTEMS FOR A PERIOD OF ONE YEAR FROM THE DATE OF THE OWNER'S FINAL ACCEPTANCE (90 DAYS FOR ANNUAL PLANTS). THE CONTRACTOR SHALL REPLACE, AT HIS OWN EXPENSE AND TO THE SATISFACTION OF THE OWNER, ANY PLANTS WHICH DIE IN THAT TIME, OR REPAIR ANY PORTIONS OF THE IRRIGATION SYSTEM WHICH OPERATE IMPROPERLY.
  - AFTER THE INITIAL MAINTENANCE PERIOD AND DURING THE GUARANTEE PERIOD, THE LANDSCAPE CONTRACTOR SHALL ONLY BE RESPONSIBLE FOR REPLACEMENT OF PLANTS WHEN PLANT DEATH CANNOT BE ATTRIBUTED DIRECTLY TO OVERWATERING OR OTHER DAMAGE BY HUMAN ACTIONS.
- PROVIDE A MINIMUM OF (2) COPIES OF RECORD DRAWINGS TO THE OWNER UPON COMPLETION OF WORK. A RECORD DRAWING IS A RECORD OF ALL CHANGES THAT OCCURRED IN THE FIELD AND THAT ARE DOCUMENTED THROUGH CHANGE ORDERS, ADDENDA, OR CONTRACTOR/CONSULTANT DRAWING MARKUPS.

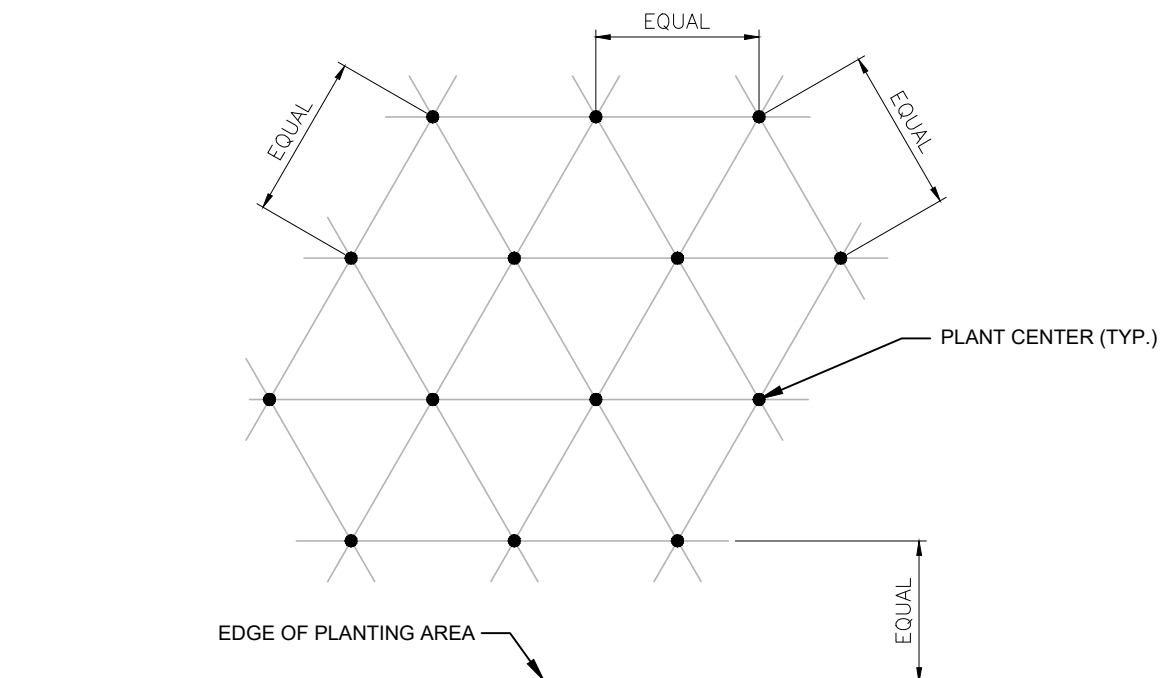

NOTE: ALL PLANTS SHALL BE PLANTED AT EQUAL TRIANGULAR SPACING (EXCEPT WHERE SHOWN ON PLANS AS INFORMAL GROUPINGS). REFER TO PLANT LEGEND FOR SPACING DISTANCE BETWEEN PLANTS.

1) STEP 1: DETERMINE TOTAL PLANTS FOR THE AREA WITH THE FOLLOWING FORMULA:  
TOTAL AREA / AREA DIVIDER = TOTAL PLANTS

PLANT SPACING	AREA DIVIDER	PLANT SPACING	AREA DIVIDER
6"	0.22	18"	1.95
8"	0.39	24"	3.46
10"	0.60	30"	5.41
12"	0.87	36"	7.79
15"	1.35		

2) STEP 2: SUBTRACT THE ROW(S) OF PLANTS THAT WOULD OCCUR AT THE EDGE OF THE PLANTED AREA WITH THE FOLLOWING FORMULA: TOTAL PERIMETER LENGTH / PLANT SPACING = TOTAL PLANT SUBTRACTION

EXAMPLE: PLANTS AT 18" O.C. IN 100 SF PLANTING AREA, 40 LF PERIMETER  
STEP 1: 100 SF / 95 = 51 PLANTS  
STEP 2: 51 PLANTS - (40 LF / 1.95 = 21 PLANTS) = 30 PLANTS TOTAL

## C. PLANT SPACING

SCALE: NTS

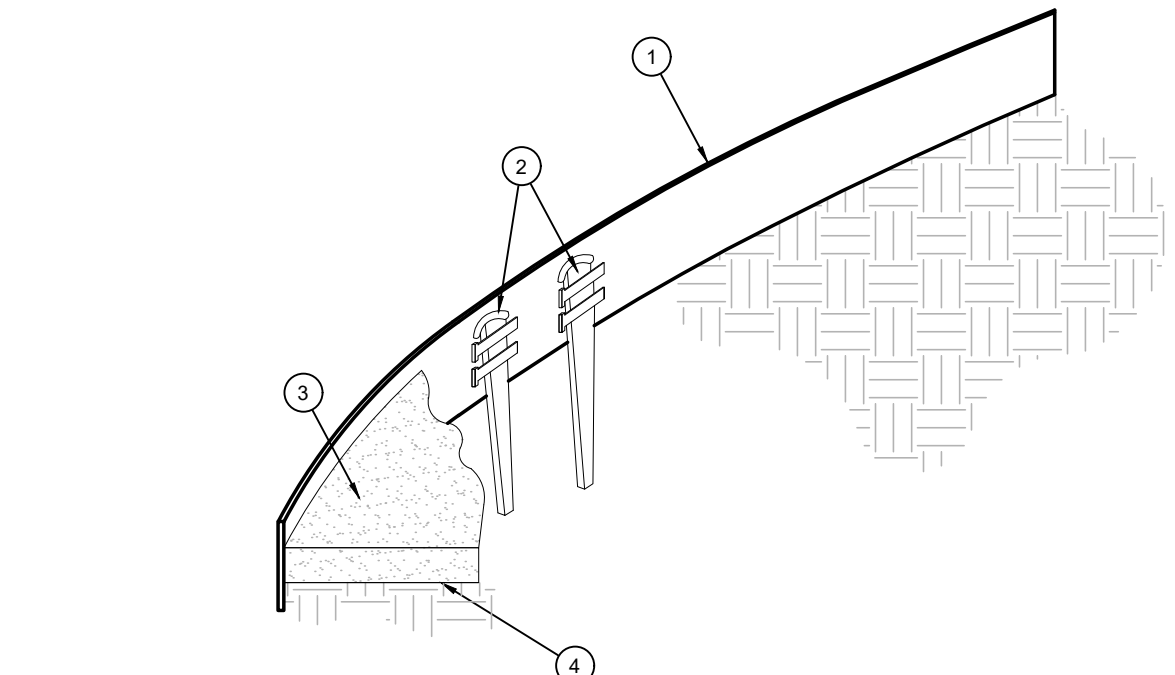

- ROLLED-TOP STEEL EDGING PER PLANS.
- TAPERED STEEL STAKES.
- MULCH, TYPE AND DEPTH PER PLANS.
- FINISH GRADE.

NOTES:  
1) INSTALL EDGING SO THAT STAKES WILL BE ON INSIDE OF PLANTING BED.  
2) BOTTOM OF EDGING SHALL BE BURIED A MINIMUM OF 1" BELOW FINISH GRADE.  
3) TOP OF MULCH SHALL BE 1" LOWER THAN TOP OF EDGING.

## D. STEEL EDGING

SCALE: NOT TO SCALE

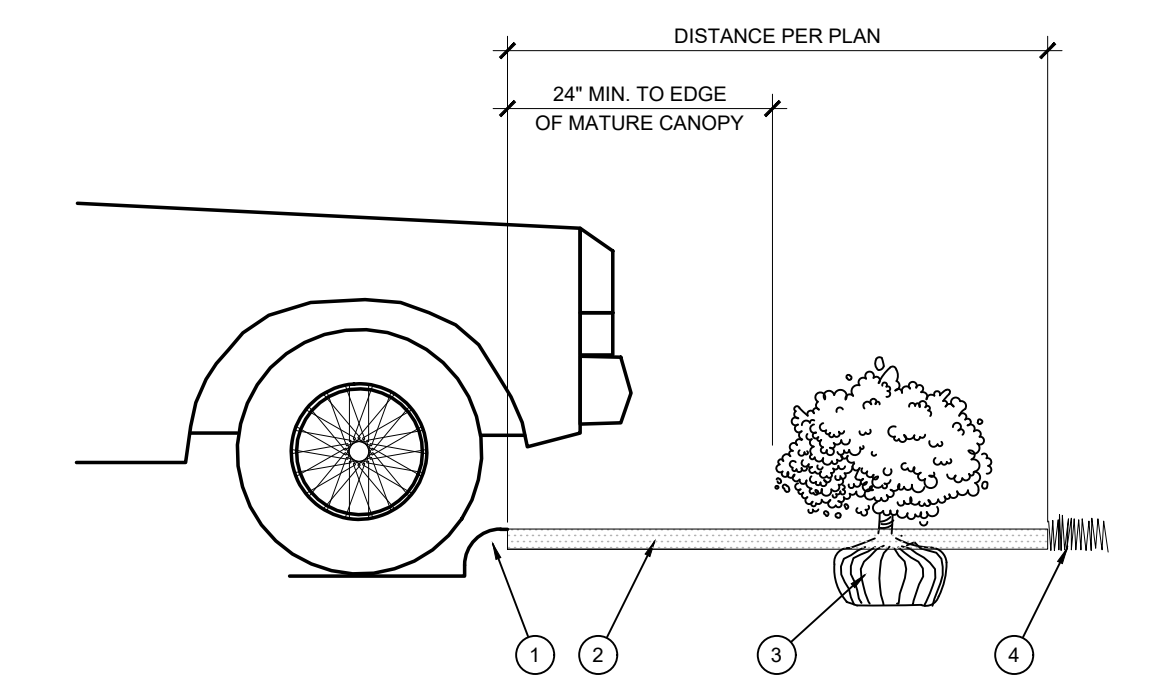

- CURB.
- MULCH LAYER.
- PLANT.
- TURF (WHERE SHOWN ON PLAN).

## E. HEDGE PLANTING AT PARKING AREA

SCALE: NOT TO SCALE

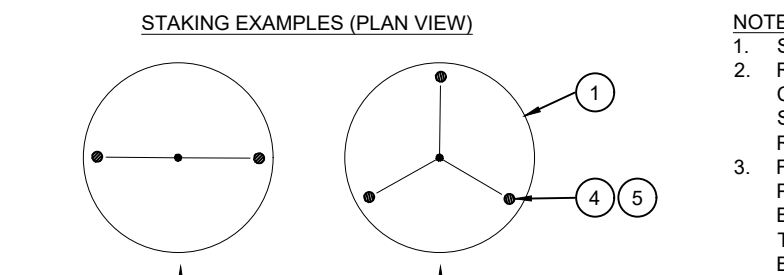
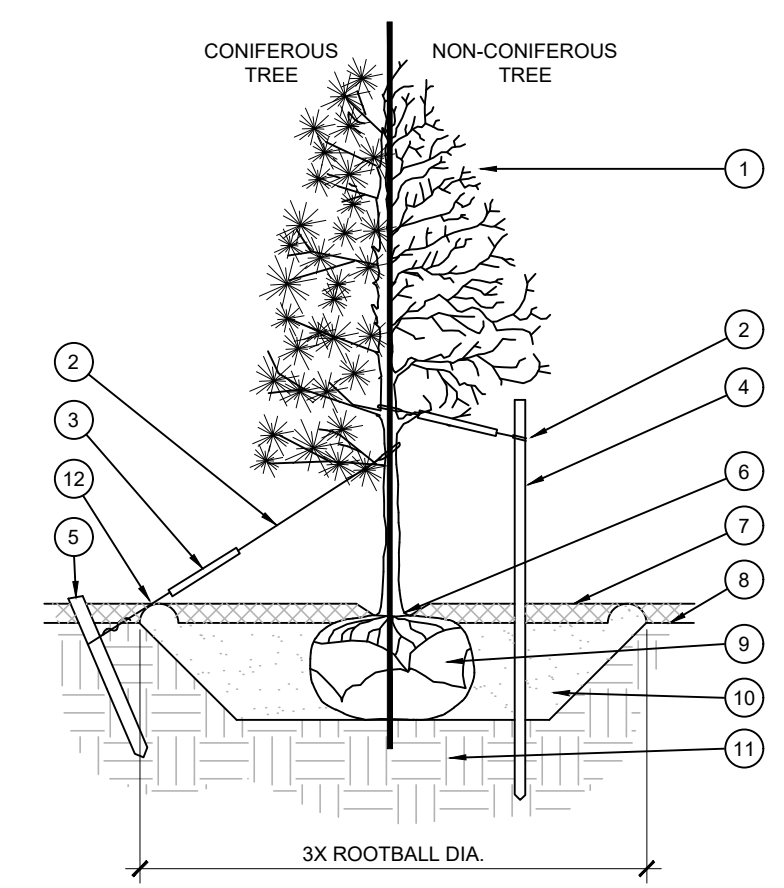

## A. TREE PLANTING

SCALE: NOT TO SCALE

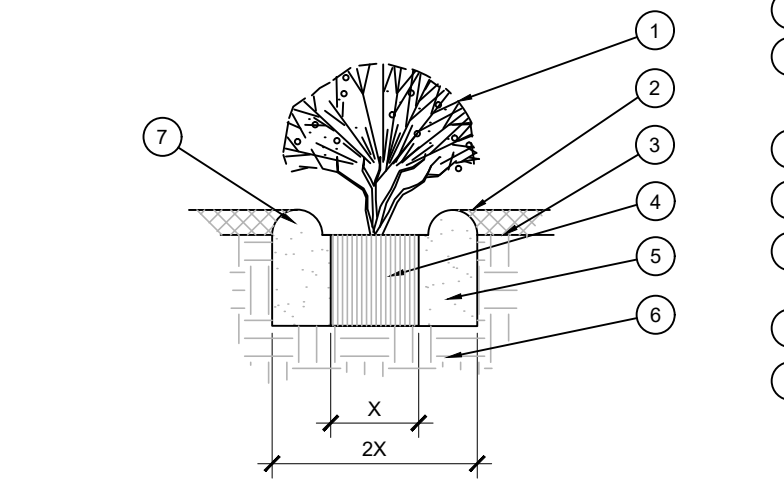

- SHRUB, PERENNIAL, OR ORNAMENTAL GRASS.
- MULCH, TYPE AND DEPTH PER PLANS. PLACE NO MORE THAN 1" OF MULCH WITHIN 6" OF PLANT CENTER.
- FINISH GRADE.
- ROOT BALL.
- BACKFILL, AMEND AND FERTILIZE ONLY AS RECOMMENDED IN SOIL FERTILITY ANALYSIS.
- UNDISTURBED NATIVE SOIL.
- 3" HIGH EARTHEN WATERING BASIN.

## B. SHRUB AND PERENNIAL PLANTING

SCALE: NTS

- TREE CANOPY.
- CINCH-TIES (24" BOX TREES AND SMALLER) OR 12 GAUGE GALVANIZED WIRE WITH NYLON TREE STRAPS AT TREE AND STAKE (8" BOX TREES AND LARGER). SECURE TIES OR STRAPS TO TRUNK JUST ABOVE LOWEST MAJOR BRANCHES.
- 24" X 3/4" P.V.C. MARKERS OVER WIRES.
- GREEN STEEL T-POSTS. EXTEND POSTS 12" MIN. INTO UNDISTURBED SOIL.
- PRESSURE-TREATED WOOD DEADMAN, TWO PER TREE (MIN.). BURY OUTSIDE OF PLANTING PIT AND 18" MIN. INTO UNDISTURBED SOIL.
- TRUNK FLARE.
- MULCH, TYPE AND DEPTH PER PLANS. DO NOT PLACE MULCH WITHIN 6" OF TRUNK.
- FINISH GRADE.
- ROOT BALL.
- BACKFILL, AMEND AND FERTILIZE ONLY AS RECOMMENDED IN SOIL FERTILITY ANALYSIS.
- UNDISTURBED NATIVE SOIL.
- 4" HIGH EARTHEN WATERING BASIN.

NOTES:  
1) SCARIFY SIDES OF PLANTING PIT PRIOR TO SETTING TREE.  
2) REMOVE EXCESS SOIL APPLIED ON TOP OF THE ROOTBALL THAT COVERS THE ROOT FLARE. THE PLANTING HOLE DEPTH SHALL BE SUCH THAT THE ROOTBALL RESTS ON UNDISTURBED SOIL, AND THE ROOT FLARE IS 3"-5" ABOVE FINISH GRADE.  
3) FOR 8-8 TREES, CUT OFF BOTTOM 1/3 OF WIRE BASKET BEFORE PLACING TREE IN HOLE. CUT OFF AND REMOVE REMAINDER OF BASKET AFTER TREE IS SET IN HOLE. REMOVE ALL NYLON TIES, TWINE, ROPE, AND OTHER PACKING MATERIAL. REMOVE AS MUCH BURLAP FROM AROUND ROOTBALL AS IS PRACTICAL.  
4) REMOVE ALL NURSERY STAKES AFTER PLANTING.  
5) FOR TREES OVER 3" CALIPER AND TREES 36" BOX AND LARGER, USE THREE STAKES OR DEADMEN (AS APPROPRIATE), SPACED EVENLY AROUND TREE.  
6) STAKING SHALL BE TIGHT ENOUGH TO PREVENT TRUNK FROM BENDING, BUT LOOSE ENOUGH TO ALLOW SOME TRUNK MOVEMENT IN WIND.

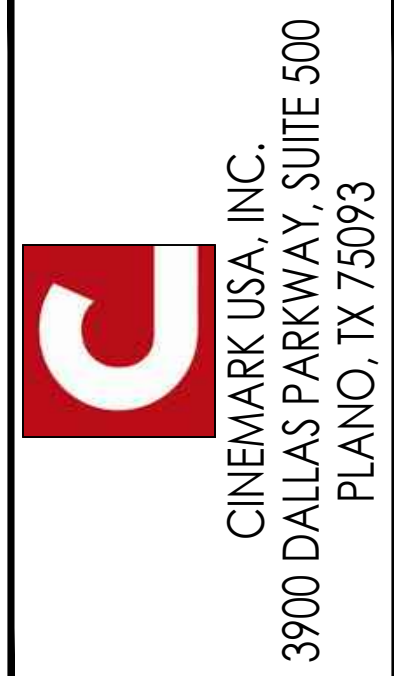

**CINEMARK @ 380 COMMONS**  
LOT 4, 380 COMMONS AT  
HEADINGTON HEIGHTS ADDITION  
CITY OF MCKINNEY COLLIN COUNTY, TEXAS

3900 DALLAS PARKWAY, SUITE 500  
PLANO, TX 75093

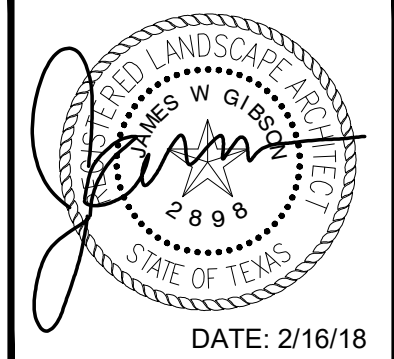

**EVERGREEN DESIGN GROUP**  
(800) 680-6630  
15305 Dallas Pkwy., Ste 300  
Addicks, TX 75001  
www.landscape-consultants.net

DRAWING TITLE: **LANDSCAPE DETAILS AND SPECIFICATIONS**

DATE: 2/16/18

SCALE: N/A

JOB NUMBER: 16-10

DRAWING NUMBER: **LP-5**

ISSUES		
NO.	DATE	DESCRIPTION

PLOT DATE: Friday, February 16, 2018  
FILE NAME: 15-X-SP-Cinema Landscape 2018-01-31.dwg  
FILE PATH: C:\Users\Shaika Jazbeaux\Dropbox (Rodney)\EDG - Sharew\2017\380 Crossing At Headington Heights\_SWC\Cinema