

SITE DATA
 EXISTING ZONING: PD 2007-10-103
 EXISTING LAND USE: COMMERCIAL

SITE DATA
 EXISTING ZONING: PD 2007-10-103
 EXISTING LAND USE: COMMERCIAL

SITE DATA
 EXISTING ZONING: PD 1895
 EXISTING LAND USE: VACANT

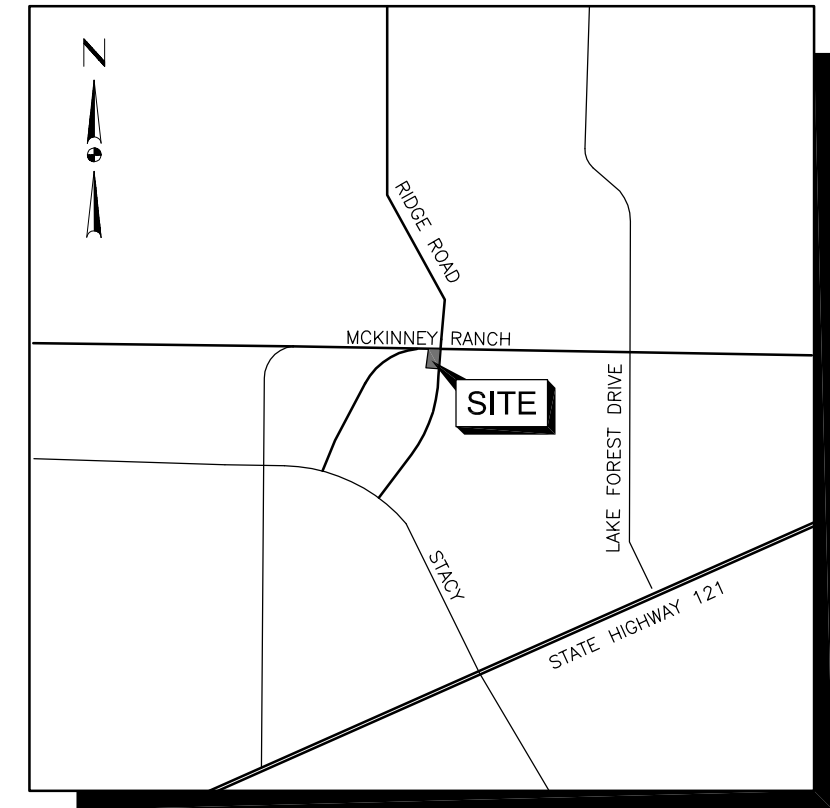
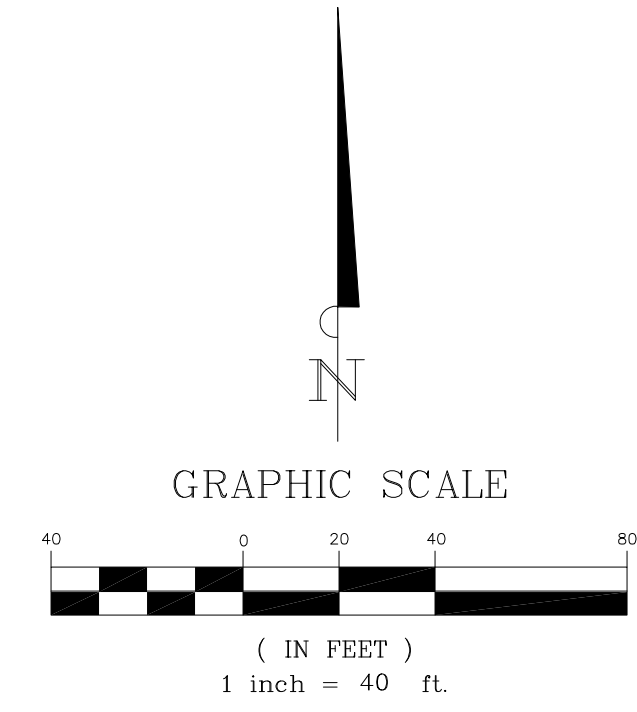

VICINITY MAP
 N.T.S.

MCKINNEY RANCH PARKWAY

N 7109359.2590
 E 2520693.8699

S86°47'40"E
 77.44'

N89°23'30"E
 130.00'

$\Delta=60^{\circ}58'48''$
 $R=67.00'$
 $L=71.31'$
 $T=39.45$
 $CB=S60^{\circ}06'59''E$
 $CH=67.99'$

N00°37'47"W
 170.94'

SITE DATA
 EXISTING ZONING: PD 2016-03-021
 EXISTING LAND USE: VACANT
 PROPOSED ZONING: C2
 (LOCAL COMMERCIAL)

SUBJECT TRACT
 LOT 3, BLK A
 1.01 AC

S07°25'20"E
 47.32'
 $M_{84.28}$
 S03°33'58"E
 84.28'

RIDGE ROAD

N89°22'13"E 265.27"

SITE DATA
 EXISTING ZONING: PD 2016-04-012
 EXISTING LAND USE: VACANT

SITE DATA
 EXISTING ZONING: PD 2016-03-021
 EXISTING LAND USE: VACANT

SITE DATA
 EXISTING ZONING: PD 2016-03-021
 EXISTING LAND USE: COMMERCIAL

THIS DRAWING IS TO BE USED FOR EXHIBIT PURPOSES ONLY

MEINEKE CAR CARE CENTER

ZONING EXHIBIT

Scale: SEE GRAPHIC SCALE
 Designed by: CDR
 Drawn by: CDR
 Checked by: RGS
 Date: 12/12/2018
 Project No. XXXXX-XXX

EXHIBIT