

SITE DATA SUMMARY

SUBDIVISION	WESTRIDGE
TRACT 1213	CUSTER WEST PARTNERS
ZONING	PD - PLANNED DEVELOPMENT
AREA OF LAND	737,906 SF (16.94 AC.)
BUILDING	N/A
PROPOSED PARKING IMPROVEMENTS	1
ADA ACCESSIBLE	25
PROPOSED TOTAL*	26
*ADA ACCESSIBLE PARKING TO COMPLY WITH TAS STANDARDS	
STREET FRONTAGE (SEE SHEET LA-11P)	
REAGAN DR. STREET FRONTAGE 480 L.F.	
WESTRIDGE BLVD. STREET FRONTAGE 1,185 L.F.	
MEMORY DR. STREET FRONTAGE 1,045 L.F.	
HARRY TRUMAN DR. STREET FRONTAGE 170 L.F.	
TOTAL STREET FRONTAGE 2,880 L.F.	
STREET TREES REQUIRED	QTY: 72 (CANOPY TREES)
STREET TREES PROVIDED	QTY: 78 (3" CAL.)
INTERIOR LANDSCAPE	69,846 S.F.
IMPERVIOUS SURFACE	147,800 S.F. MIN.
IRRIGATED TURF	

UPDATING NOTE:
The lighting for the subject property will be constructed in conformance with the Chapter 58 of the Light Code Regulations of the City of McKinney, Code of Ordinances.

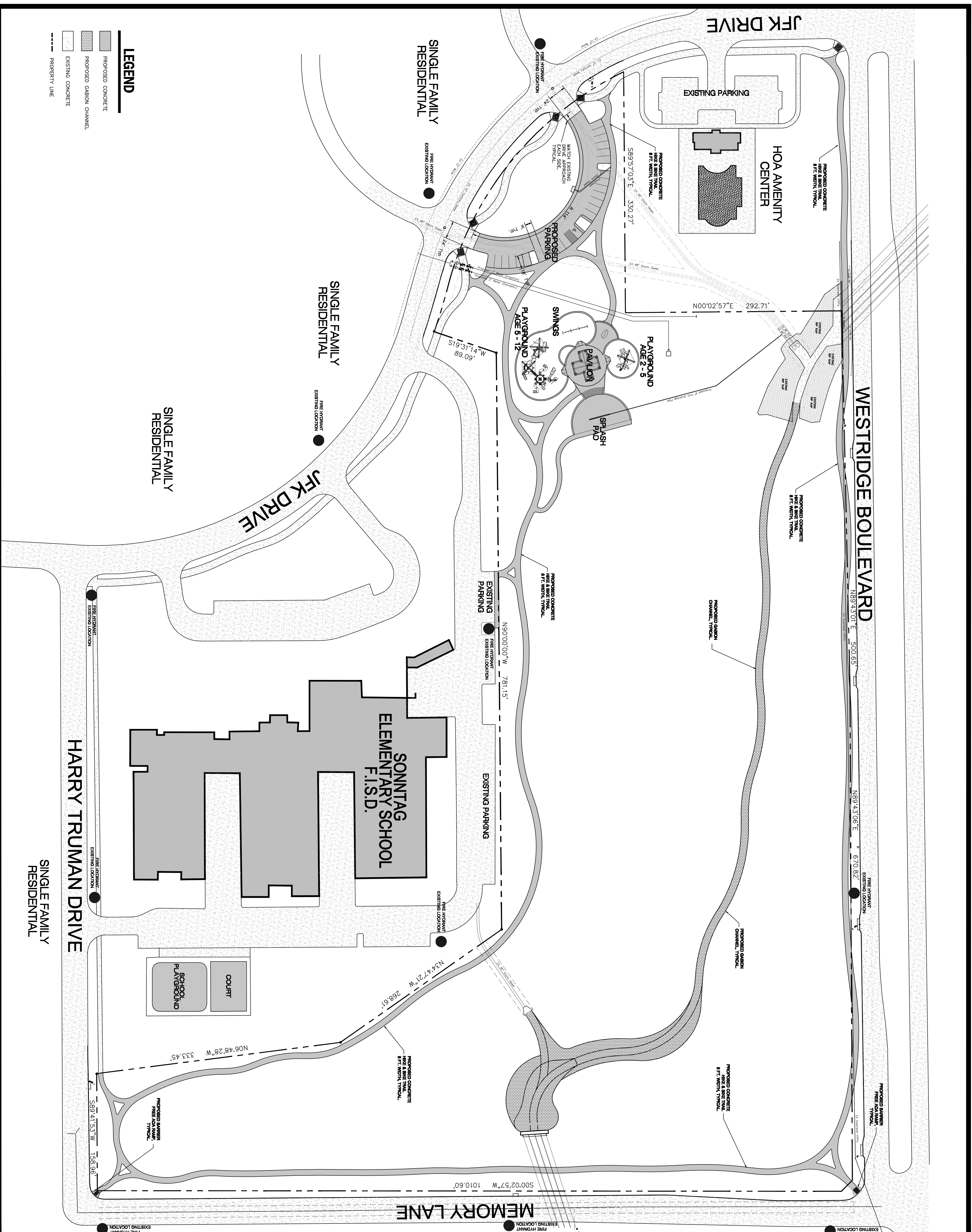
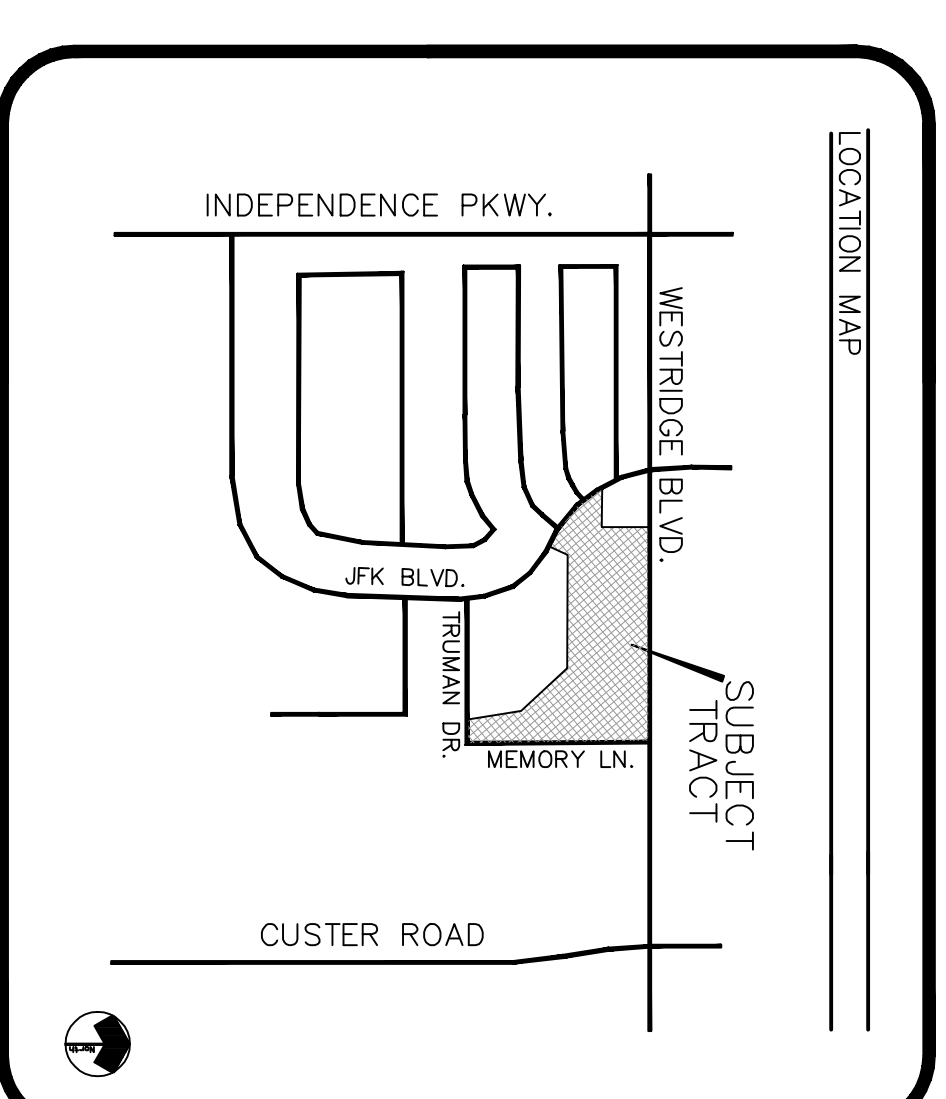
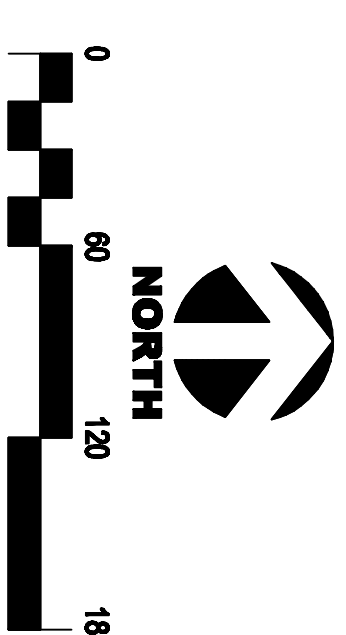

LEGEND

- PROPOSED CONCRETE
- PROPOSED GABION CHANNEL
- EXISTING CONCRETE
- PROPERTY LINE

SONNTAG PARK

SITE PLAN

APPRIANT: **LANARC DESIGN INC.**

808 S. COLLEGE, SUITE 223, MCKINNEY TEXAS 75069
PH: 214.733.8805 FX: 214.733.8806

OWNER: **CITY OF MCKINNEY**

PARKS, RECREATION, & OPEN SPACE DEPARTMENT
MCKINNEY, TEXAS 75070
PH: 972.547.7488

DATE: **FEB. 13, 2012** JDR: **001208-01** REVISED: **ONE**