

01 LANDSCAPE PLAN
SCALE 1"=40'-0"

PLANT MATERIAL SCHEDULE

TREES					
TYPE	QTY	COMMON NAME	BOTANICAL NAME	SIZE	REMARKS
CE	26	Cedar Elm	<i>Ulmus crassifolia</i>	4" cal.	container, 14" ht., 6" spread, 5' clear straight trunk
LO	26	Live Oak	<i>Quercus virginiana</i>	4" cal.	container, 14" ht., 5" spread, 5' clear straight trunk
RO	23	Red Oak	<i>Quercus shumardii</i>	4" cal.	container, 14" ht., 5" spread, 5' clear straight trunk
VT	33	Vitex	<i>Vitex angust castus</i>	2" cal.	container, 8" ht., 4" spread, 3 or 5 canes, tree form
SHRUBS					
TYPE	QTY	COMMON NAME	BOTANICAL NAME	SIZE	REMARKS
NPH	612	Needlepoint Holly	<i>Ilex cornuta 'Needlepoint'</i>	5 gal.	container, 24" ht., 20" spread
NRS1	45	Nellie R. Stevens	<i>Ilex x 'Nellie R. Stevens'</i>	6" ht.	container, 4' spread, full to base
NRS2	24	Nellie R. Stevens	<i>Ilex x 'Nellie R. Stevens'</i>	3' ht.	container, 36" ht., 24" spread, 36" o.c.
GROUNDCOVERS					
TYPE	QTY	COMMON NAME	BOTANICAL NAME	SIZE	REMARKS
WC	5758	Purple Wintercreeper	<i>Euonymus fortunei 'Coloratus'</i>	4" pots	container, 3-12" runners min., 12" o.c. selection by owner, full pots, 10" o.c.
SC	552	Seasonal Color '419' Bermudagrass	<i>Cynodon dactylon '419'</i>	4" pots	Solid Sod refer to notes

NOTE: Plant list is an aid to bidders only. Contractor shall verify all quantities on plan. All heights and spreads are minimums. All plant material shall meet or exceed remarks as indicated. All trees to have straight trunks and be matching within varieties.

LANDSCAPE TABULATIONS: City of McKinney

STREETYARD (Streetyard: 210,700 s.f., Total Site: 259,345 s.f.)
Requirements: 15% of streetyard to be landscape
10% of total site area to be landscape

Required	Provided
31,605 s.f. (15%)	50,034 s.f. (24%)
25,935.3 s.f. (10%)	51,176 s.f. (20%)

STREET TREES

Requirements: One (1) canopy tree per 40 l.f. of street frontage, (3) ornamental trees for (1) canopy tree where there is overhead power lines

STATE HIGHWAY 121 (433.25 l.f.)

Required	Provided
(11) trees, 4" cal.	(33) ornamental trees

HARDIN BLVD (726.75 l.f.)

Required	Provided
(18) trees, 4" cal.	(18) trees, 4" cal

COLLIN MCKINNEY PKWY (393.55 l.f.)

Required	Provided
(10) trees, 4" cal.	(10) trees, 4" cal.

PARKING LOT (345 spaces)

Requirements: (1) tree per 10 parking spaces
evergreen parking lot screen

Required	Provided
(34) trees, 4" cal.	(44) trees, 4" cal.
parking lot screen	24" ht hedge

SCREENING:

Requirements: overnight parking to be screened with 6' ht. evergreen shrubs
6' ht. Nellie R. Stevens Holly hedge provided

LANDSCAPE NOTES

- CONTRACTOR SHALL VERIFY ALL EXISTING AND PROPOSED SITE ELEMENTS AND NOTIFY ARCHITECT OF ANY DISCREPANCIES. SURVEY DATA OF EXISTING CONDITIONS WAS SUPPLIED BY OTHERS.
- CONTRACTOR SHALL LOCATE ALL EXISTING UNDERGROUND UTILITIES AND NOTIFY ARCHITECT OF ANY CONFLICTS. CONTRACTOR SHALL EXERCISE CAUTION WHEN WORKING IN THE VICINITY OF UNDERGROUND UTILITIES.
- CONTRACTOR IS RESPONSIBLE FOR OBTAINING ALL REQUIRED LANDSCAPE AND IRRIGATION PERMITS.
- CONTRACTOR TO PROVIDE A MINIMUM 2% SLOPE AWAY FROM ALL STRUCTURES.
- ALL PLANTING BEDS AND LAWN AREAS TO BE SEPARATED BY STEEL EDGING. NO STEEL TO BE INSTALLED ADJACENT TO SIDEWALKS OR CURBS.
- ALL LANDSCAPE AREAS TO BE 100% IRRIGATED WITH AN UNDERGROUND AUTOMATIC IRRIGATION SYSTEM AND SHALL INCLUDE RAIN AND FREEZE SENSORS.
- ALL LAWN AREAS TO BE SOLID SOD BERMUDAGRASS, UNLESS OTHERWISE NOTED ON THE DRAWINGS.
- THE CONTRACTOR SHALL VERIFY WATER RESTRICTIONS WITHIN THE CITY OF MCKINNEY AT TIME OF PLANTING. SHOULD WATER RESTRICTIONS NOT ALLOW HYDRO-MULCH HYDRO-SEEDING, OR SPRIGGING (STAGE 3 AND STAGE 4 WATER RESTRICTIONS), AN APPROVED ALTERNATIVE FOR GRASSING SHALL BE INSTALLED.
- ALL REQUIRED LANDSCAPE AREAS SHALL BE PROVIDED WITH AN AUTOMATIC UNDERGROUND IRRIGATION SYSTEM WITH RAIN AND FREEZE SENSORS AND EVAPOTRANSPIRATION (ET) WEATHER BASED CONTROLLERS AND SAID IRRIGATION SYSTEM SHALL BE DESIGNED BY A QUALIFIED PROFESSIONAL AND INSTALLED BY A LICENSED IRRIGATOR.

SOLID SOD NOTES

- FINE GRADE AREAS TO ACHIEVE FINAL CONTOURS INDICATED. LEAVE AREAS TO RECEIVE TOPSOIL 3" BELOW FINAL DESIRED GRADE IN PLANTING AREAS AND 1" BELOW FINAL GRADE IN TURF AREAS.
- ADJUST CONTOURS TO ACHIEVE POSITIVE DRAINAGE AWAY FROM BUILDINGS. PROVIDE UNIFORM ROUNDING AT TOP AND BOTTOM OF SLOPES AND OTHER BREAKS IN GRADE. CORRECT IRREGULARITIES AND AREAS WHERE WATER MAY STAND.
- ALL LAWN AREAS TO RECEIVE SOLID SOD SHALL BE LEFT IN A MAXIMUM OF 1" BELOW FINAL FINISH GRADE. CONTRACTOR TO COORDINATE OPERATIONS WITH ON-SITE CONSTRUCTION MANAGER.
- CONTRACTOR TO COORDINATE WITH ON-SITE CONSTRUCTION MANAGER FOR AVAILABILITY OF EXISTING TOPSOIL.
- PLANT SOD BY HAND TO COVER INDICATED AREA COMPLETELY. INSURE EDGES OF SOD ARE TOUCHING. TOP DRESS JOINTS BY HAND WITH TOPSOIL TO FILL VOIDS.
- ROLL GRASS AREAS TO ACHIEVE A SMOOTH, EVEN SURFACE, FREE FROM UNNATURAL UNDULATIONS.
- WATER SOD THOROUGHLY AS SOD OPERATION PROGRESSES.
- CONTRACTOR SHALL MAINTAIN ALL LAWN AREAS UNTIL FINAL ACCEPTANCE. THIS SHALL INCLUDE, BUT NOT LIMITED TO: MOWING, WATERING, WEEDING, CULTIVATING, CLEANING AND REPLACING DEAD OR BARE AREAS TO KEEP PLANTS IN A VIGOROUS, HEALTHY CONDITION.
- CONTRACTOR SHALL GUARANTEE ESTABLISHMENT OF AN ACCEPTABLE TURF AREA AND SHALL PROVIDE REPLACEMENT FROM LOCAL SUPPLY IF NECESSARY.
- IF INSTALLATION OCCURS BETWEEN SEPTEMBER 1 AND MARCH 1, ALL SOD AREAS TO BE OVER-SEEDDED WITH WINTER RYEGRASS, AT A RATE OF (4) POUNDS PER ONE THOUSAND (1000) SQUARE FEET.

GENERAL LAWN NOTES

- FINE GRADE AREAS TO ACHIEVE FINAL CONTOURS INDICATED ON CIVIL PLANS.
- ADJUST CONTOURS TO ACHIEVE POSITIVE DRAINAGE AWAY FROM BUILDINGS. PROVIDE UNIFORM ROUNDING AT TOP AND BOTTOM OF SLOPES AND OTHER BREAKS IN GRADE. CORRECT IRREGULARITIES AND AREAS WHERE WATER MAY STAND.
- ALL LAWN AREAS TO RECEIVE SOLID SOD SHALL BE LEFT IN A MAXIMUM OF 1" BELOW FINAL FINISH GRADE. CONTRACTOR TO COORDINATE OPERATIONS WITH ON-SITE CONSTRUCTION MANAGER.
- IMPORTED TOPSOIL SHALL BE NATURAL, FRIABLE SOIL FROM THE REGION, KNOWN AS BOTTOM AND SOIL, FREE FROM LUMPS, CLAY, TOXIC SUBSTANCES, ROOTS, DEBRIS, VEGETATION, STONES, CONTAINING NO SALT AND BLACK TO BROWN IN COLOR.
- ALL LAWN AREAS TO BE FINE GRADED, IRRIGATION TRENCHES COMPLETELY SETTLED, AND FINISH GRADE APPROVED BY THE OWNER'S CONSTRUCTION MANAGER OR ARCHITECT PRIOR TO INSTALLATION.
- ALL ROCKS 3/4" DIAMETER AND LARGER, DIRT CLOUDS, STICKS, CONCRETE SPOILS, ETC. SHALL BE REMOVED PRIOR TO PLACING TOPSOIL AND ANY LAWN INSTALLATION
- CONTRACTOR SHALL PROVIDE (1") ONE INCH OF IMPORTED TOPSOIL ON ALL AREAS TO RECEIVE LAWN.

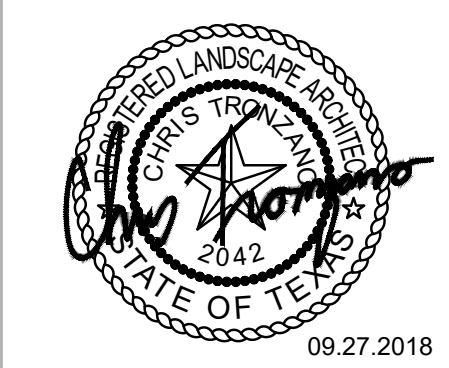

AUTONATION MCKINNEY PORSCHE
CITY OF MCKINNEY
COLLIN COUNTY, TEXAS

ISSUE:

DATE:
09.27.2018

SHEET NAME:
LANDSCAPE PLAN

SHEET NUMBER:
L.1

SECTION 02900 - LANDSCAPE

PART 1 - GENERAL

1.1 REFERENCED DOCUMENTS

Refer to bidding requirements, special provisions, and schedules for additional requirements.

1.2 DESCRIPTION OF WORK

Work included: Furnish all supervision, labor, materials, services, equipment and appliances required to complete the work covered in conjunction with the landscaping covered in these specifications and landscaping plans, including:

1. Planting (trees, shrubs, and grass)
2. Bed preparation and fertilization
3. Notification of sources
4. Water and Maintenance until final acceptance
5. Guarantee

1.3 REFERENCE STANDARDS

- A. American Standard for Nursery Stock published by American Association of Nurserymen: 27 October 1980, Edition, by American National Standards Institute, Inc. (Z50.1) - plant material.
- B. American Joint Committee on Horticultural Nomenclature: 1942 Edition of Standardized Plant Names.
- C. Texas Association of Nurserymen, Grades and Standards.
- D. Hortis Third, 1976 - Cornell University

1.4 NOTIFICATION OF SOURCES AND SUBMITTALS

- A. The Contractor shall, within ten (10) days following acceptance of bid, notify the Architect/Owner of the sources of plant materials and bed preparation required for the project.
- B. Samples: Provide representative quantities of sandy loam soil, mulch, bed mix material, gravel, and crushed stone. Samples shall be approved by Architect before use on project.
- C. Product Data: Submit complete product data and specifications on all other specified materials.
- D. Submit three representative samples of each variety of ornamental trees, shrubs, and groundcover plants for Architect's approval. When approved, tag, install, and maintain as representative samples for final installed plant materials.
- E. File Certificates of Inspection of plant material by state, county, and federal authorities with Architect, if required.
- F. Soil Analysis: Provide sandy loam soil analysis if requested by the Architect.

PART 3 - EXECUTION

3.1 BED PREPARATION & FERTILIZATION

- A. Landscape Contractor to inspect all existing conditions and report any deficiencies to the Owner.
- B. All planting areas shall be conditioned as follows:
 1. Prepare new planting beds by scraping away existing grass and weeds as necessary. Till existing soil to a depth of six (6") inches prior to placing compost and fertilizer. Apply fertilizer as per manufacturers recommendations. Add six (6") inches of compost and till into a depth of six (6") inches of the topsoil. Apply organic fertilizer such as Sustane or Green Sense at the rate of twenty (20) pounds per one thousand (1,000) square feet.
 2. All planting areas shall receive a two (2") inch layer of specified mulch.
 3. Backfill for tree pits shall be as follows: Use existing top soil on site (use imported topsoil as needed) free from large clumps, rocks, debris, caliche, subsoils, etc., placed in nine (9") inch layers and watered in thoroughly.
- C. Grass Areas:
 1. Areas to be Solid Sod Bermudagrass: Blocks of sod should be laid joint to joint, (staggered joints) after fertilizing the ground first. Roll grass areas to achieve a smooth, even surface. The joints between the blocks of sod should be filled with topsoil where they are evidently gaped open, then watered thoroughly.
 2. Areas to be Hydromulch Common Bermudagrass: Hydromulch with bermudagrass seed at a rate of two (2) pounds per one thousand (1,000) square feet. Use a 4' x 6' batter board against the bed areas.

3.2 INSTALLATION

- A. Maintenance of plant materials shall begin immediately after each plant is delivered to the site and shall continue until all construction has been satisfactorily accomplished.
- B. Plant materials shall be delivered to the site only after the beds are prepared and area ready for planting. All shipments of nursery materials shall be thoroughly protected from the drying winds during transit. All plants which cannot be planted at once, after delivery to the site, shall be well protected against the possibility of drying by wind and sun. Balls of earth of B & B plants shall be kept covered with soil or other acceptable material. All plants remain the property of the Contractor until final acceptance.
- C. Position the trees and shrubs in their intended location as per plan.
- D. Notify the Landscape Architect for inspection and approval of all positioning of plant materials.
- E. Excavate pits with vertical sides and horizontal bottom. Tree pits shall be large enough to permit handling and planting without injury to balls of earth or roots and shall be of such depth that, when planted and settled, the crown of the plant shall bear the same relationship to the finish grade as it did to soil surface in original place of growth.

JOB CONDITIONS

- A. General Contractor to complete the following punch list: Prior to Landscape Contractor initiating any portion of landscape installation, General Contractor shall leave planting bed areas three (3") inches below finish grade of sidewalks, drives and curbs as shown on the drawings. All lawn areas to receive solid sod shall be left one (1") inch below the finish grade of sidewalks, drives, and curbs. All construction debris shall be removed prior to Landscape Contractor beginning any work.
- B. General Contractor shall provide topsoil as described in Section 02200 - Earthwork.
- C. Storage of materials and equipment at the job site will be at the risk of the Landscape Contractor. The Owner cannot be held responsible for theft or damage.

1.6 MAINTENANCE AND GUARANTEE

- A. Maintenance:
 1. The Landscape Contractor will be held responsible for the maintenance of all work from the time of planting until final acceptance by the Owner. No trees, shrubs, groundcover or grass will be accepted unless they show a healthy growth and satisfactory foliage conditions.
 2. Maintenance shall include watering of trees and plants, cultivation, weeding, spraying, edging, pruning of trees, mowing of grass, cleaning up and all other work necessary of maintenance.
 3. A written notice requesting final inspection and acceptance should be submitted to the Owner at least seven (7) days prior to completion. An on-site inspection by Owner and Landscape Contractor will be completed prior to written acceptance.
 4. After final acceptance of installation, the Landscape Contractor will not be required to do any of the above listed work.
- B. Guarantee:
 1. Trees shall be guaranteed for a twelve (12) month period after acceptance. Shrubs and groundcover shall be guaranteed for twelve (12) months. The Contractor shall replace all dead materials as soon as weather permits and upon notification of the Owner. Plants, including trees, which have partially died so that shape, size, or symmetry has been damaged, shall be considered subject to replacement. In such cases, the opinion of the Owner shall be final.
 - a. Plants used for replacement shall be of the same size and kind as those originally planted and shall be planted as originally specified. All work, including materials, labor and equipment used in replacements, shall carry a twelve (12) month guarantee. Any damage, including ruts in lawn or bed areas, incurred as a result of making replacements shall be immediately repaired.
 - b. At the direction of the Owner, plants may be replaced at the start of the next year's planting season. In such cases, dead plants shall be removed from the premises immediately.
 - c. When plant replacements are made, plants, soil, mulch, fertilizer and mulch are to be utilized as originally specified and reinspected for full compliance with Contract requirements. All replacements are to be included under "Work" of this section.

1.7 QUALITY ASSURANCE

- A. General: Comply with applicable Federal, State, County and Local regulations governing landscape materials and work.
- B. Personnel: Employ only experienced personnel who are familiar with the required work. Provide full time supervision by a qualified foreman acceptable to Landscape Architect.
- C. Selection of Plant Material:
 1. Make contact with suppliers immediately upon obtaining notice of contract acceptance to select and book materials. Develop a program of maintenance (pruning and fertilization) which will insure the purchased materials will meet and/or exceed project specifications.
 2. Landscape Architect will provide a key identifying each tree location on site. Written verification will be required to document material selection, source and delivery schedules to site.
 3. Owner and/or Architect shall inspect all plant materials when reasonable at place of growth for compliance with requirements for genus, species, cultivar/variety, size and quality.
 4. Owner and/or Architect retains the right to further inspect all plant material upon arrival at the site and during installation for size and condition of root balls, limbs, branching habit, insects, injuries, and latent defects.
 5. Owner and/or Architect may reject unsatisfactory or defective material at any time during the process of work. Remove rejected materials from the site immediately. Plants damaged in transit or at job site shall be rejected.

1.8 PRODUCT DELIVERY, STORAGE AND HANDLING

- A. Preparation:
 1. Balled and Burlapped (B&B) Plants: Dig and prepare shipment in a manner that will not damage roots, branches, shape, and future development.
 2. Container Grown Plants: Deliver plants in rigid container to hold ball shape and protect root mass.

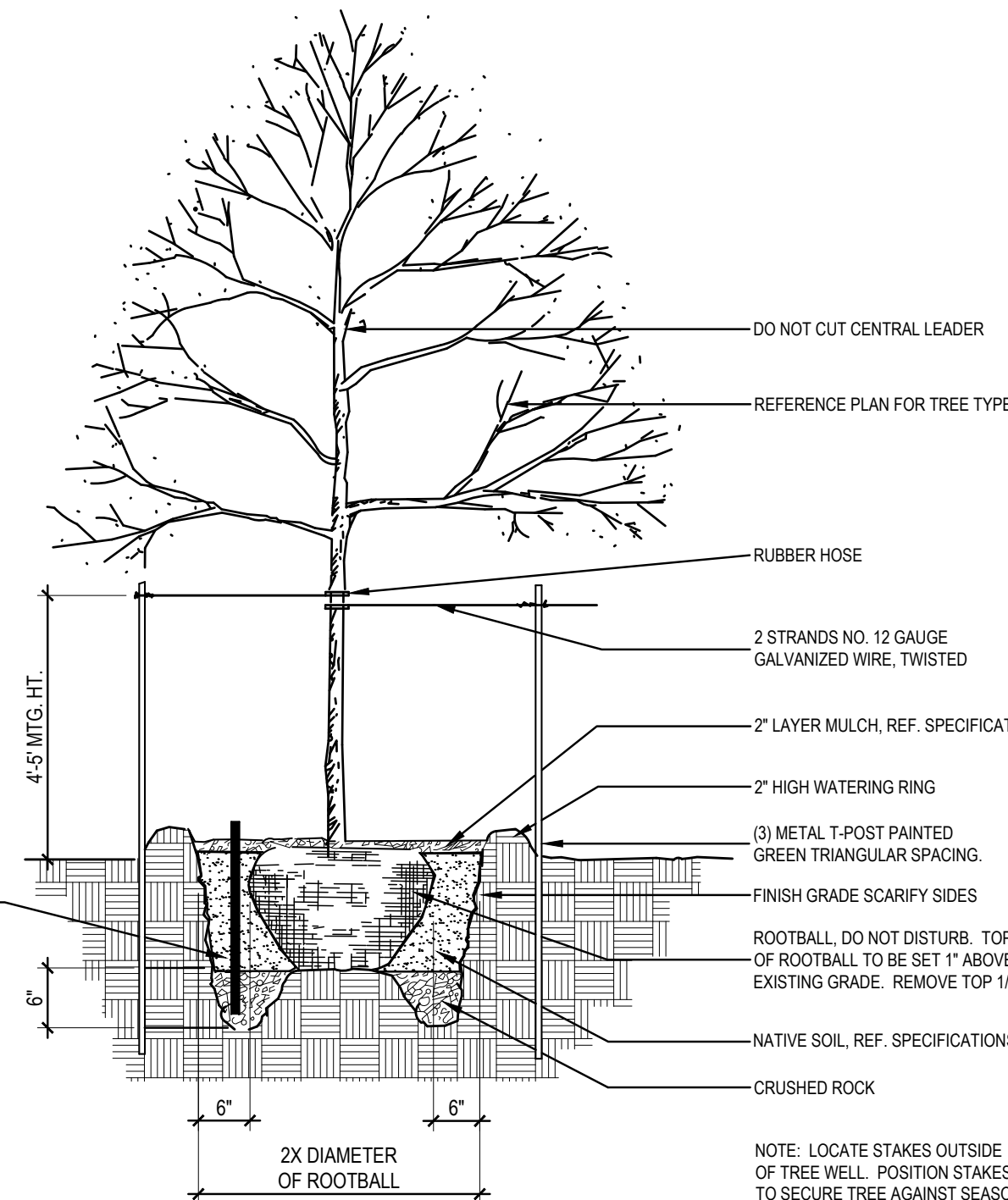

01 TREE PLANTING DETAIL
NOT TO SCALE

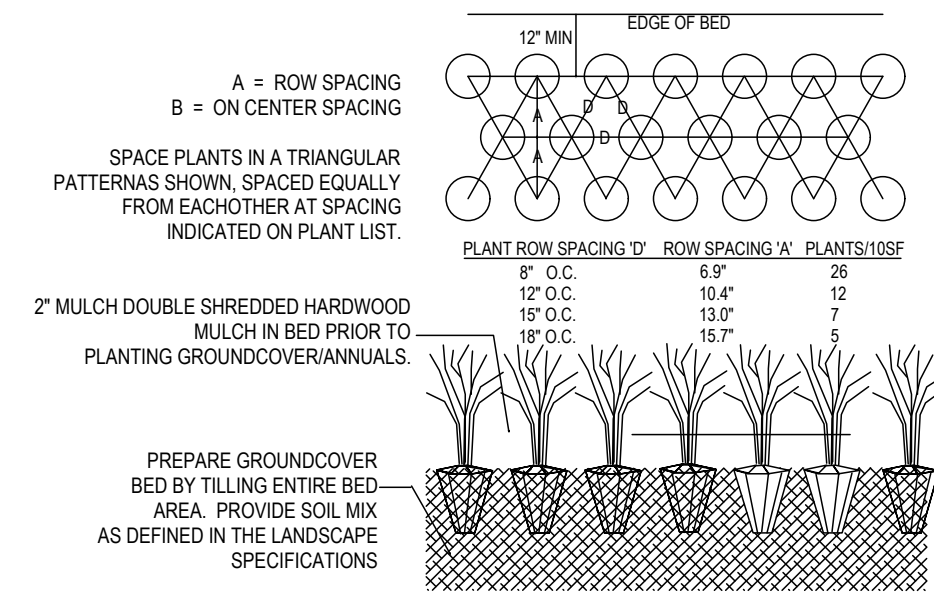

02 GROUNDCOVER PLANTING DETAIL
NOT TO SCALE

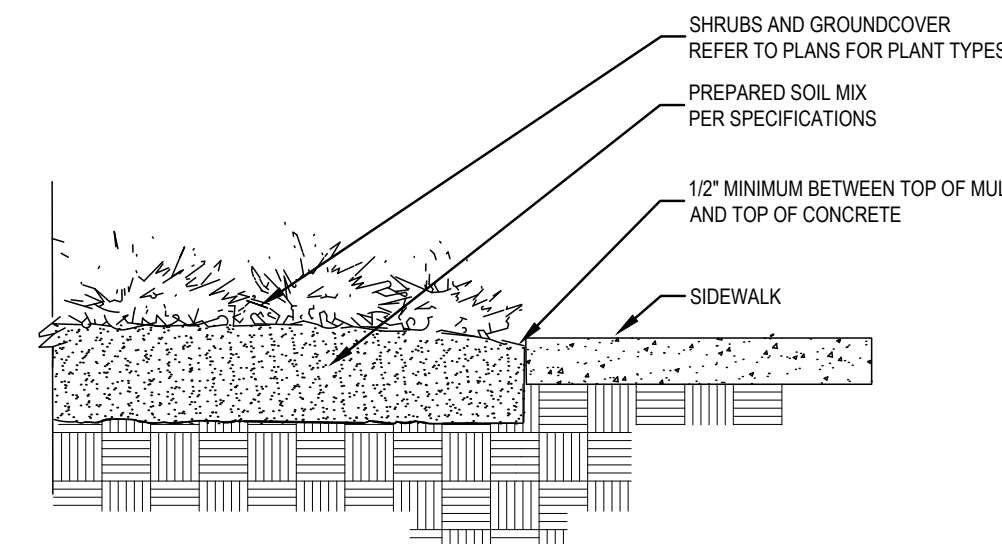

03 SIDEWALK / MULCH DETAIL
no steel along sidewalks
NOT TO SCALE

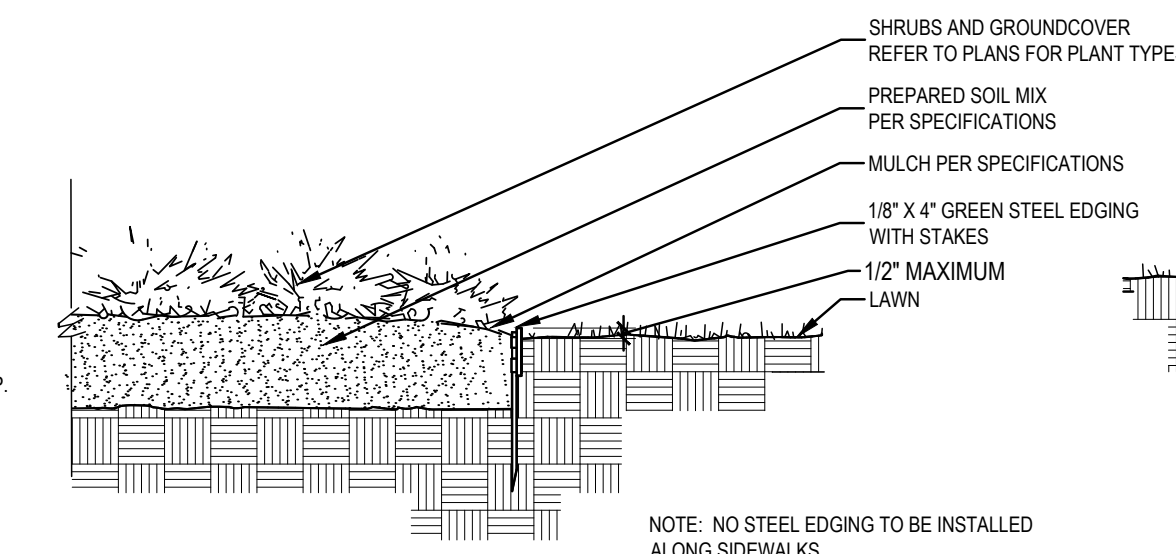

04 STEEL EDGING DETAIL
NOTE: NO STEEL EDGING TO BE INSTALLED ALONG SIDEWALKS
NOT TO SCALE

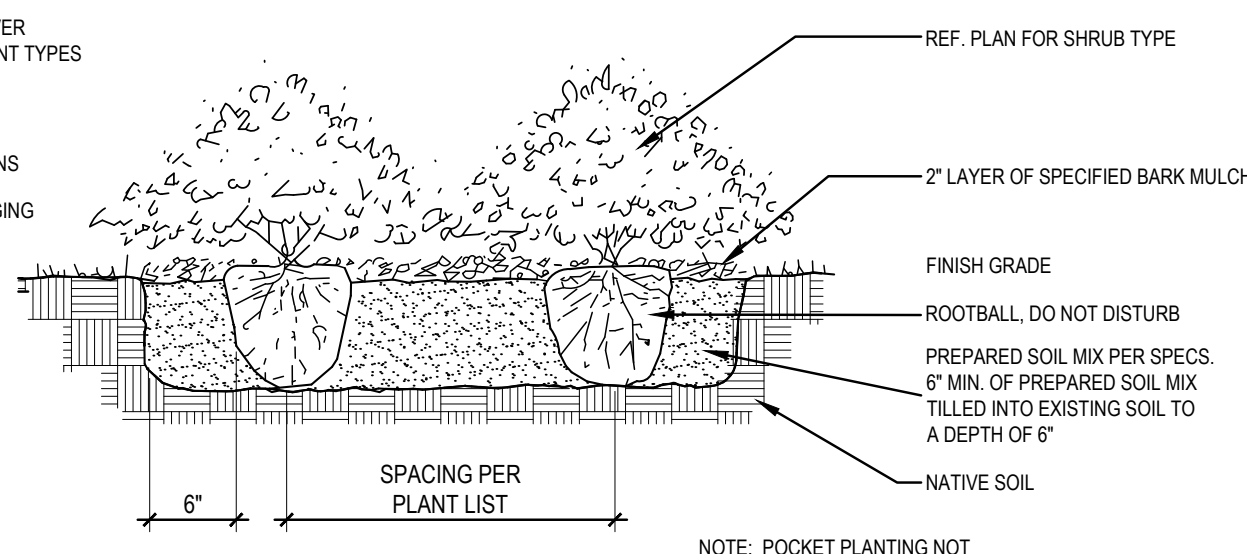

05 SHRUB PLANTING DETAIL
NOTE: POCKET PLANTING NOT ALLOWED
NOT TO SCALE

3.3 CLEANUP AND ACCEPTANCE

- A. Cleanup: During the work, the premises shall be kept neat and orderly at all times. Storage areas for all materials shall be so organized that they, too, are neat and orderly. All trash and debris shall be removed from the site as work progresses. Keep paved areas clean by sweeping or hosing at end of each days work.

END OF SECTION



LANDSCAPE ARCHITECT
STUDIO GREEN SPOT, INC.
1784 W. McDERMOTT DRIVE, SUITE 110
ALLEN, TEXAS 75013
CHRIS TRONZANO
(469) 369-4448
CHRIS@STUDIOGREENSPOT.COM



09.10.2018

AUTONATION MCKINNEY PORSCHE
CITY OF MCKINNEY
COLLIN COUNTY, TEXAS

ISSUE:

DATE:
09.10.2018

SHEET NAME:
LANDSCAPE SPECIFICATIONS

SHEET NUMBER:

L.2