

**Metes & Bounds Description
Tract 1**

SITUATED in the State of Texas, County of Collin, and City of McKinney, being part of the T.T. Bradley Survey, Abstract No. 88, and being part of an unimproved alley located south of the Hill Street Addition, an addition to the City of McKinney as recorded in Volume 2011, Page 351 of the Collin County Map Records with said premises being more particularly described as follows:

BEGINNING at a 3/8-inch iron rod found marking the northwest corner of said premises, the southwest corner of said Hill Street Addition, and being in the east line of Lot 2, Block 12 of Waddill Addition, an addition to the City of McKinney as recorded in Volume 78, Page 478 of the Collin County Map Records;

THENCE with the north line of said premises and the south line of said Hill Street Addition, North 88°10'31" East, 169.22 feet to a 3/8-inch iron rod found marking the northeast corner of said premises, the southeast corner of said Hill Street Addition, and the southwest corner of a 0.002 acre tract as recorded under Document No. 20111014001102580 of the Collin County Land Records;

THENCE with the east line of said premises, South, 36.65 feet to a Roome capped iron rod set marking the southeast corner of said premises;

THENCE with the south line of said premises, South 84°13'56" West, 170.97 feet to a 3/8-inch iron rod found marking the southwest corner of said premises and the southeast corner of the aforementioned Lot 2;

THENCE with the west line of said premises and the east line of said Lot 2, North 01°08'33" East, 48.45 feet to the point of beginning and containing 7,211 square feet or 0.166 acre of land.

**Metes & Bounds Description
Tract 2**

SITUATED in the State of Texas, County of Collin, and City of McKinney, being part of the T.T. Bradley Survey, Abstract No. 88, and being part of an unimproved alley located south of the Hill Street Addition, an addition to the City of McKinney as recorded in Volume 2011, Page 351 of the Collin County Map Records with said premises being more particularly described as follows:

BEGINNING at the southeast corner of Lot 2, Block A of said addition, the northwest corner of said premises, and the southwest corner of a 0.002 acre tract as recorded under Document No. 20111014001102580 of the Collin County Land Records;

THENCE with the north line of said premises and the south line of said 0.002 acre tract, North 88°10'31" East, 4.17 feet to a Roome capped iron rod set marking the northeast corner of said premises, the southeast corner of said 0.002 acre tract, and being in the west line of a called 9,310 square foot tract of land as recorded in Volume 5747, Page 2243 of the Collin County Land Records;

THENCE with the east line of said premises and the west line of said 9,310 square foot tract, South 01°47'14" East, 36.27 feet to a Roome capped iron rod set marking the southeast corner of said premises and the southwest corner of said 9,310 square foot tract;

THENCE with the south line of said premises, South 84°13'56" West, 5.32 feet to a Roome capped iron rod set marking the southwest corner of said premises;

THENCE with the west line of said premises, North, 36.65 feet to the point of beginning and containing 173 square feet or 0.004 acre of land.

Surveyor's Certificate

THAT I, John Glas, a Registered Professional Land Surveyor in the State of Texas, do hereby certify that I prepared this plat from an actual and accurate survey of the land and that the corner monuments shown thereon were properly placed under my personal supervision, in accordance with the subdivision regulations of the City of McKinney, Texas.

John Glas
R.P.L.S. No. 6081



Line Table

LINE	BEARING	DISTANCE
L1	N88°10'31"E	4.17'
L2	S01°47'14"E	36.27'
L3	S84°13'56"W	5.32'
L4	NORTH	36.65'
L5	SOUTH	36.65'

Legend

Roome Cpd. I.R.S.	Roome Capped Iron Rod Set
C.C.M.R.	Collin County Map Records
C.C.L.R.	Collin County Land Records
IRF	Iron Rod Found
CNS	Could Not Set

Flood Note: No part of the property described herein lies within a Special Flood Hazard Area according to the Federal Emergency Management Agency Flood Insurance Rate Map, Community-Panel No. 48085C0260 J and 48085C0280 J, present effective date of map June 2, 2009, herein property situated within Zone X (unshaded). The flood statement does not imply that the property and/or structures will be free from flooding or flood damage. On occasion, greater floods can and will occur and flood heights may be increased by man-made or natural causes. This flood statement shall not create liability on the part of the surveyor.

Notes: 1) CM = Controlling monument; 2) Survey was performed without the benefit of a title commitment. 3) Subject property affected by any or all easements of record. 4) Source bearing is based on the Hill Street Addition, an addition to the City of McKinney as recorded in Volume 2011, Page 351 of the Collin County Map Records.

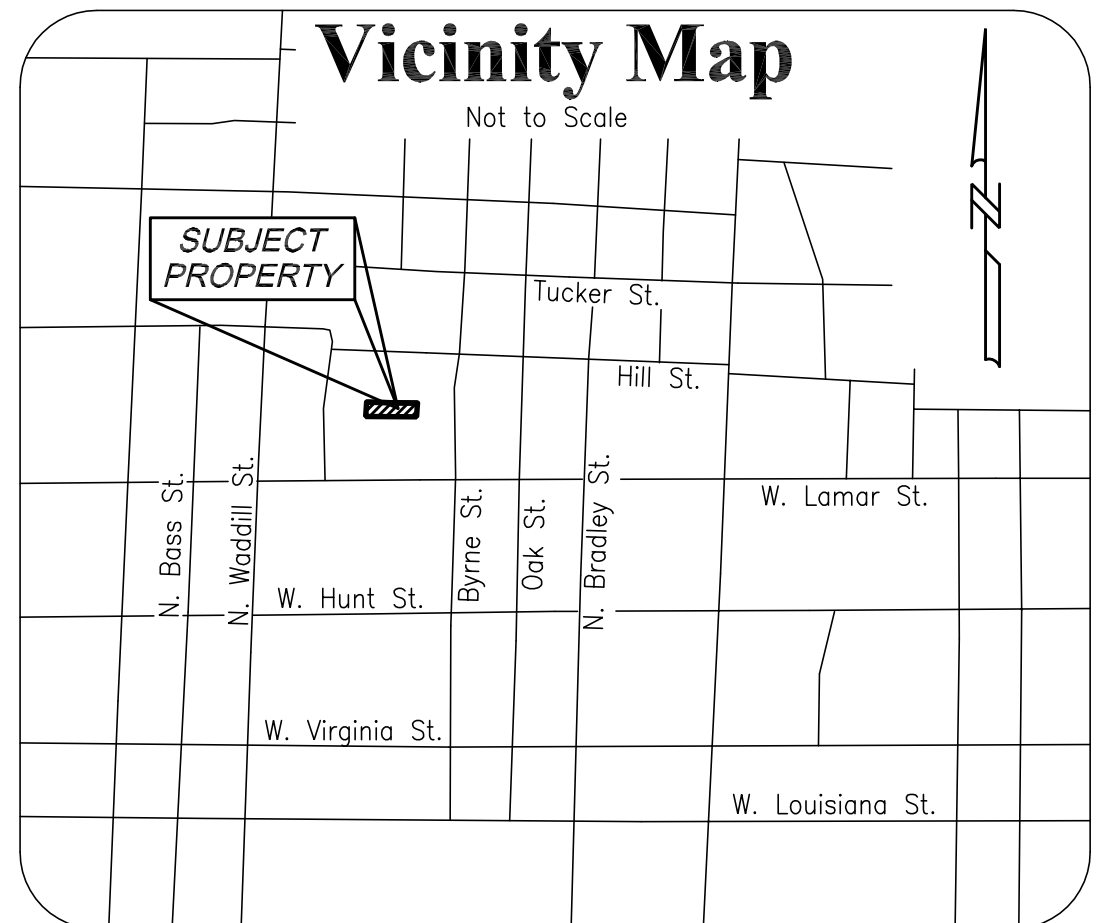
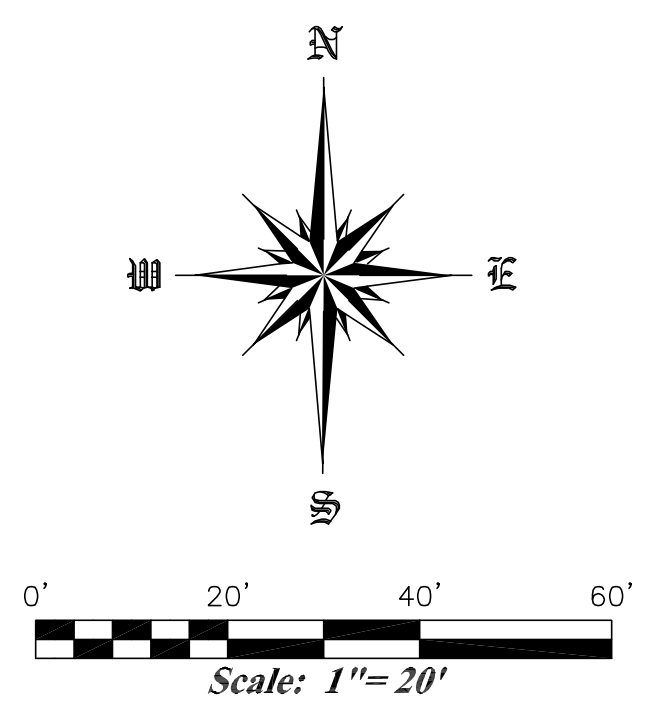

RECEIVED
By Kathy Wright at 8:23 am, Sep 24, 2012

Exhibit A

Alley Abandonment
7,211 Sq.Ft. or 0.166 Acre
173 Sq.Ft. or 0.004 Acre
T.T. Bradley Survey, Abstract No. 88
City of McKinney, Collin County, Texas
September 4, 2012

Revised: 9/20/2012
P:\AC\201203\AC101662.dwg

Roome Land Surveying, Inc.
2000 Avenue G, Suite 810
Plano, Texas 75074
Phone (972) 423-4372 / Fax (972) 423-7523
www.roomesurveying.com