

REMOVE ALL TAGS, TWINE OR OTHER NON-Biodegradable MATERIALS ATTACHED TO THE PLANT OR ROOT MASS.

PRUNE PLANT TO REMOVE DEAD OR BROKEN BRANCHES.

4 INCH DEPTH OF MULCH. DO NOT PLACE MULCH IN CONTACT WITH PLANT TRUNK. MAINTAIN THE MULCH WEED FREE.

MULCH SHALL BE KEPT MIN. 2 INCHES AWAY FROM TRUNK OF PLANT.

PLANT PIT TO BE AT LEAST 2X WIDER THAN ROOT BALL. SCARIFY AND ANGLE SIDES OF THE HOLE.

REMOVE CONTAINER FROM ROOT MASS. LOOSEN ROOTS FROM POTBOUND PLANTS BY SCORING OR PULLING.

DAMPEN SOIL PRIOR TO PLANTING.

BACKFILL HOLE WITH THOROUGH MIXTURE OF 1 PT. SAND, 1 PT. ORGANIC HUMUS, 1 PT. NATIVE TOPSOIL.

AMENDMENTS SHALL BE ADDED TO SOIL BASED ON RESULTS OF SOIL TESTS.

PLACE BOTTOM OF ROOT BALL ON ON TAMPED SOIL THAT HAS BEEN SETTLED WITH WATER.

PLANT SOIL LEVEL SHALL BE 1" HIGHER THAN SURROUNDING GRADE.

TAMP SOIL AROUND ROOT BALL LIGHTLY WITH FOOT OR HAND PRESSURE TO PREVENT SHIFTING.

PROVIDE DRAINAGE IN PLANTING PIT AS DEEMED NECESSARY BY A SOIL PERCOLATION TEST.

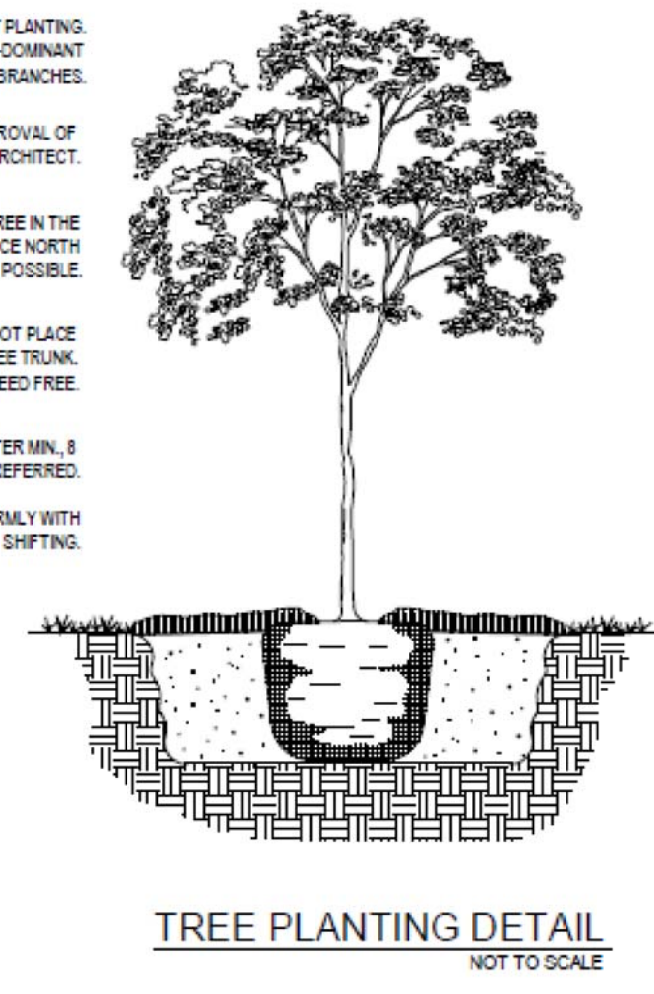

DO NOT HEAVILY PRUNE TREE AT PLANTING. PRUNE ONLY CROSSOVER LIMBS, CO-DOMINANT LEADERS, AND BROKEN OR DEAD BRANCHES.

STAKE TREE ONLY AT THE APPROVAL OF THE LANDSCAPE ARCHITECT.

MARK THE NORTH SIDE OF THE TREE IN THE NURSERY, AND ROTATE TREE TO FACE NORTH AT THE SITE WHENEVER POSSIBLE.

4 INCH DEPTH OF MULCH. DO NOT PLACE MULCH IN CONTACT WITH TREE TRUNK. MAINTAIN THE MULCH WEED FREE.

MULCH RING TO BE 6 INCH DIAMETER MIN. 8 INCH DIAMETER PREFERRED.

TAMP SOIL AROUND ROOT BALL FIRMLY WITH FOOT PRESSURE TO PREVENT SHIFTING.

TREE PIT TO BE 3X WIDER THAN ROOT BALL. SCARIFY AND ANGLE SIDES OF THE HOLE.

SET TOP OF ROOT BALL 1 INCH ABOVE FINISH GRADE.

PLACE BOTTOM OF ROOT BALL ON UNEXCAVATED OR TAMPED SOIL.

REMOVE ALL TWINE, ROPE, WIRE, AND BURLAP FROM TOP HALF OF ROOT BALL.

BACKFILL HOLE WITH EXISTING SOIL.

AMENDMENTS SHALL BE ADDED TO SOIL BASED ON RESULTS OF SOIL TESTS.

THE TOP OF ROOT BALL SHALL NOT BE COVERED WITH SOIL.

PROVIDE DRAINAGE IN PLANTING PIT AS DEEMED NECESSARY BY A SOIL PERCOLATION TEST.

LANDSCAPE REQUIREMENT CALCULATIONS

Required Percentage of Total Site Landscaping	Min. 10%
Site Area	0.5 Acres
Proposed Landscape Area	0.128 Acres
Percentage of Site to be in Living Landscape	25.7%

Required # of Min 4"Cal/12 Trees along Street Frontage (S.Chestnut St)	1 per 40'
Length of Street Frontage	181.91'
Number of Trees Required	5
Number of Trees Provided	5

Required Percentage of Street Yard Landscaping	Min. 15%
Street Yard Area	
Street Yard Landscape Area	3,055 Sqft
Percentage of Street Yard Landscaped	

Required # of Min 4"Cal/12 Trees along Street Frontage (S.McDonald St)	1 per 40'
Length of Street Frontage	178.90'
Number of Trees Required	5
Number of Trees Provided	5

Number of Site Parking Spaces	23
Number of Trees Req'd 1 per 10 Space	3
Number of Parking Lot Trees Provided	6

PROPOSED TREES

Symbol	Key	Name	Size	Spacing
TA	TA	Ash, Texas <i>Fraxinus texensis</i>	4"Cal/12'Ht.	As Scaled
CP	CP	Pistache, Chinese <i>Pistachia chinensis</i>	4"Cal/12'Ht.	As Scaled

PROPOSED PLANTS

Symbol	Key	Name	Size	Spacing
SVA	SVA	Abelia, Sunrise Variegated <i>Abelia grandiflora 'Sunrise'</i>	2 Gal/18"Ht.	36"
DBH	DBH	Holly, Dwarf Burford <i>Ilex cornuta 'Dwarf Burfordii'</i>	2 Gal/18"Ht.	36"
AJ	AJ	Jasmine, Asian <i>Trachelospermum asiaticum</i>	4"Cont.	24"
J	J	Juniper <i>Juniper spp.</i>	36" Ht.	72"

Common Bermuda Sod-4,607 Sqft

NOTE:
THE CONTRACTOR SHALL VERIFY WATER RESTRICTIONS WITH THE CITY OF MCKINNEY AT TIME OF PLANTING.
SHOULD WATER RESTRICTIONS NOT ALLOW FOR HYDROMULCH, HYDROSEEDING, OR SPRIGGING (STAGE 3 AND 4 WATER RESTRICTIONS), AN APPROVED ALTERNATIVE FOR GRASSING SHALL BE INSTALLED.

NOTES:
NO CHANGES SHALL BE MADE TO THE PLANS, INCLUDING PLANT MATERIAL TYPE AND LOCATION WITHOUT PRIOR APPROVAL FROM LANDSCAPE ARCHITECT OR OWNER.
ALL PLANT MATERIAL SHALL BE GUARANTEED FOR A PERIOD OF 1 YEAR FROM DATE OF INSTALLATION COMPLETION. WORDING TO THIS EFFECT SHALL BE INCLUDED IN CONTRACTOR'S PROPOSAL.
THE CONTRACTOR SHALL NOTIFY THE LANDSCAPE ARCHITECT IN WRITING OF DISCREPANCIES BETWEEN THE PLANS AND ACTUAL SITE CONDITIONS PRIOR TO COMMENCING WORK. FAILURE TO DO SO SHALL BE INTERPRETED AS THE CONTRACTOR ACCEPTING SUCH CONDITIONS AND RESPONSIBLE AT NO ADDITIONAL COST TO OWNER, FOR ANY FUTURE ADJUSTMENTS THAT NEED TO BE MADE.
ALL WORK SHALL BE IN ACCORDANCE TO PLANS. ANY DEFECTIVE WORK SHALL BE CORRECTED AT NO ADDITIONAL COST.
THE QUALITY OF THE PLANT MATERIAL IS SUBJECT TO THE APPROVAL OF THE LANDSCAPE ARCHITECT AND MAY BE REJECTED BEFORE OR AFTER INSTALLATION. ALL PLANT MATERIAL MUST MEET ALL AMERICAN STANDARD FOR NURSERY STOCK STANDARDS (ANSNS). MINOR FIELD ADJUSTMENTS MAY BE MADE TO THE LOCATION OF PLANT MATERIALS BY THE LANDSCAPE ARCHITECT AND SHALL BE MADE BY THE CONTRACTOR AT NO ADDITIONAL COST.
ALL AREAS TO BE SODDED SHALL FIRST BE TILLED TO A UNIFORM DEPTH OF 4 INCHES IN TWO, CROSSING DIRECTIONS. AFTER THE INITIAL TILLING OPERATION, INCORPORATE 1,500 POUNDS PER ACRE OF 10-20-10 FERTILIZER OR AS SPECIFIED BY A SOIL TEST.
APPLY AMENDMENTS AS SPECIFIED BY A SOIL TEST.
SOD STRIPS SHALL BE PULLED TIGHTLY TOGETHER IN A NEAT ORDERLY MANNER. DO NOT OVERLAP SOD STRIPS AND DO NOT USE ANY STRIPS THAT EXHIBIT WEAK OR THIN SOIL.
INSTALLED SOD THAT TURNS YELLOW SHALL BE GIVEN 7 DAYS TO RECOVER BEFORE IT WILL BE REJECTED. REPLACE REJECTED SOD BY COMPLETELY AND UNIFORMLY CUTTING OUT AREA TO MAKE THE REPAIR. AFTER INSTALLATION, THE SOD SHALL BE ROLLED IN TWO DIRECTIONS WITH A ROLLER NOT WEIGHING LESS THAN 100 LBS. PER SQUARE FOOT.
AMENDMENTS SHALL BE ADDED TO EACH PLANTING PIT AND BED AREA.
ALL BURLAP MATERIAL ON BALLED AND BURLAPPED PLANTS SHALL BE THE TYPE THAT DECOMPOSES WITHIN TWO YEARS.
SYNTHETIC OR PLASTIC TYPE WRAPPINGS ARE NOT ALLOWED.
AFTER SETTING BALLED AND BURLAPPED PLANTS, REMOVE THE TOP 1/3 OF THE BURLAP AND COMPLETELY REMOVE ALL BINDER twine. NO BURLAP SHALL SHOW ABOVE THE SURFACE.
ALL PLANTING AREAS SHALL BE GRADED SMOOTH, WITHOUT THE PRESENCE OF LOW SPOTS, DEPRESSIONS OR IRREGULAR HUMPS.
AREAS AROUND PLANTING BEDS SHALL BE CONSTRUCTED TO RE-DIRECT DRAINAGE AROUND AND AWAY FROM PLANTING AREAS. ALL PLANTING AREAS SHALL BE CONSTRUCTED AND GRADED TO ENSURE POSITIVE DRAINAGE AWAY FROM STRUCTURES.
CEDAR MULCH SHALL BE APPLIED WITHIN 24 HOURS OF PLANTING OF NEW PLANT MATERIAL. MULCH SHALL BE SPREAD EVENLY TO A SETTLED DEPTH OF 4" AROUND ALL TREES AND SHRUBS TO THE LIMITS OF THE PLANTING BEDS AS SHOWN ON PLANS.
ALL PLANTINGS SHALL BE "WATERED IN" BY FLOODING THE BACKFIELD HOLE WITHIN THE SAME WORKING DAY UPON WHICH THEY WERE PLANTED. ALL PLANTS SHALL BE ADJUSTED AS NECESSARY TO ENSURE CORRECT DEPTH OF PLANTING, VERTICAL ALIGNMENT AND/OR TO COMPENSATE FOR SETTLING. SOIL SHALL BE FIRMED AROUND AROUND EACH PLANT AS FINAL ADJUSTMENTS ARE MADE.

Drawing: W:\Civil\N&A Auto\PLANS\LANDSCAPE PLAN.dwg of May 25, 2018--11:17am by Om_GC Layout: D-Size Xrefs: MCDONALD-EXIST FEATURES.dwg - X-BASE.dwg - Base Drawing.dwg

no.	revision	by	date

iCIVIL ENGINEERING
202 REPUBLIC LN
EULESS, TX 76040
PH: (972) 523-5493

TBPE: F-19293

scale
horiz
1"=20'
vert
N/A
date
MAY, 2018



Texas Auto Source, LLC

LANDSCAPE PLAN
North Texas Auto Source
1208 S McDOLAND ST, MCKINNEY, TX 75069

PROJECT NO.
JN 1801

sheet
8
of
9