

VICINITY MAP  
NTS

GENERAL NOTES:

- SANITATION CONTAINER SCREENING WALLS WILL BE BRICK MASONRY, STONE MASONRY, OR OTHER ARCHITECTURAL MASONRY FINISH, INCLUDING A METAL GATE, PRIMED AND PAINTED, AND THE SANITATION CONTAINER SCREENING WALLS, GATE, AND PAD SITE WILL BE CONSTRUCTED IN ACCORDANCE WITH THE CITY'S DESIGN SPECIFICATIONS.
- MECHANICAL AND HEATING AND AIR CONDITIONING EQUIPMENT IN NON-RESIDENTIAL USES SHALL BE SCREENED FROM VIEW FROM THE PUBLIC RIGHT-OF-WAY AND FROM ADJACENT RESIDENTIAL PROPERTIES.
- LIGHTING FOR THE SUBJECT PROPERTY WILL BE CONSTRUCTED IN CONFORMANCE WITH CHAPTER 58 OF THE CITY OF MCKINNEY CODE OF ORDINANCES.

SITE DATA SUMMARY TABLE		BLOUNT SITE
ZONING		PD 1563
PROPOSED USE		LIGHT MANUFACTURING
LOT AREA (SF / ACRES)		479160 / 11
SITE AREA (SF / ACRES)		479160 / 11
PROPOSED BUILDING (SF)		115,718
BUILDING HEIGHT (FT)		39
LOT COVERAGE %		24.15%
FLOOR AREA RATIO		0.241:1
PARKING REQUIRED		
Office Area (1,400 SF)	21,456	54
Manufacturing (1:1000 up to 20,000 SF)	20,000	20
Manufacturing (1:2000 SF over 20,000 SF)	42,670	22
Warehouse	31,592	8
Total	115718	
PARKING PROVIDED FOR PROP. BLDG.		104
SITE IMPERVIOUS AREA (SF)		283147.50

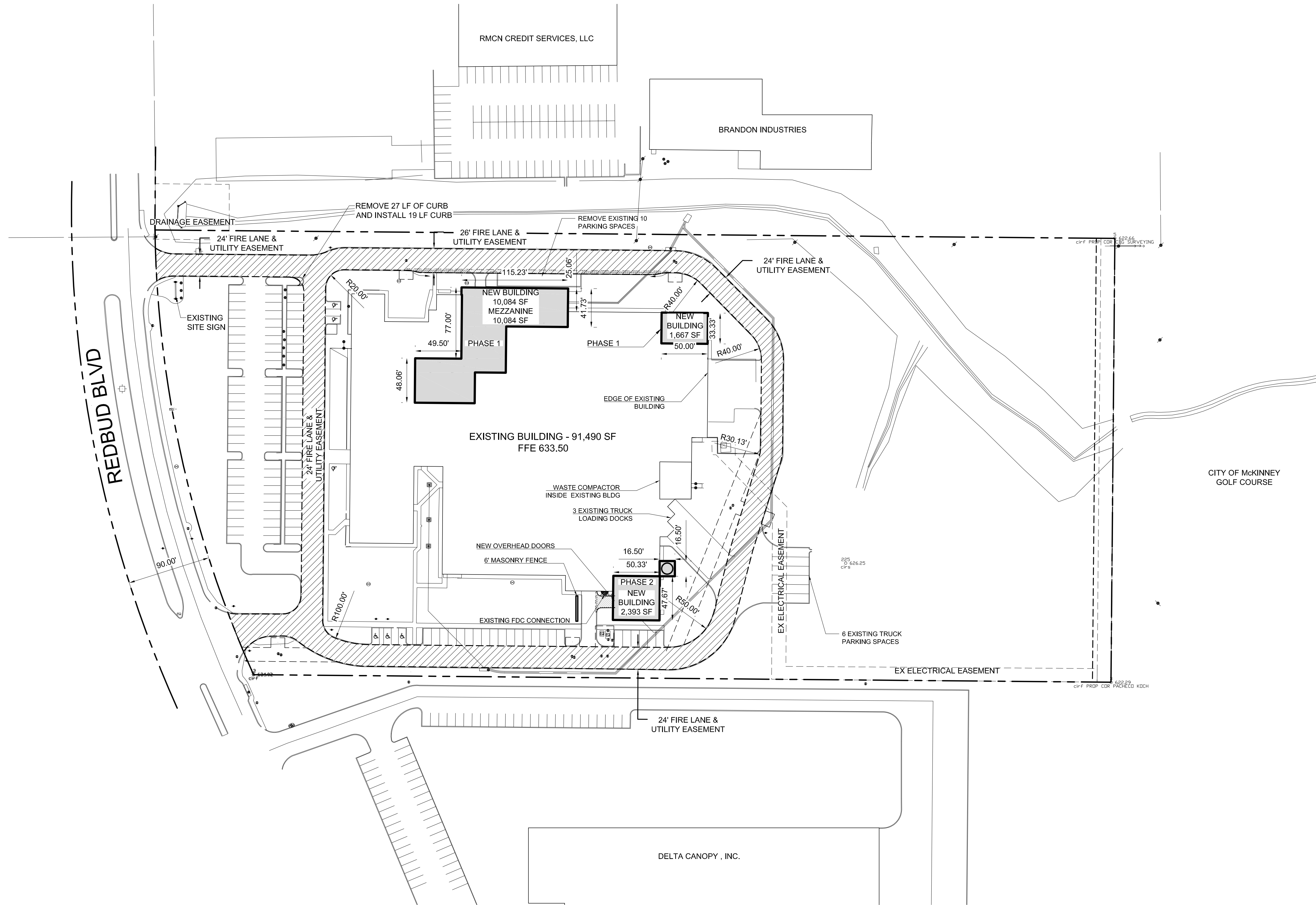
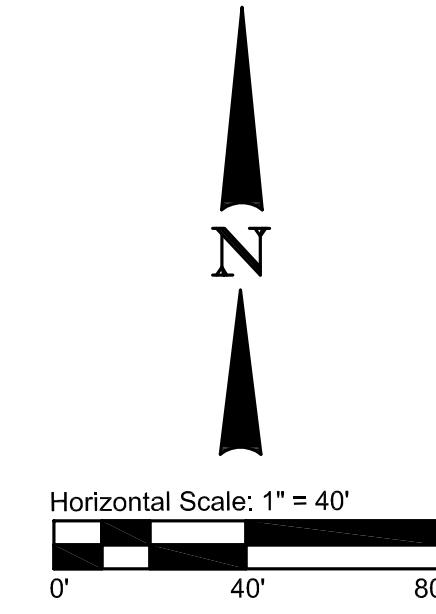

File name: \\usdal1fp002.na.aecomnet.com\Data\LD\LDSTeam Group\60480142 Blount Foods\900-WorkingDocs-CAD\02-SHEETS\60480142-SHT-30-PH01-C-SIT-0001.dwg  
 Date: Thursday, March 31, 2016 Time: 5:31 AM  
 Plotted by: Gonzalez, Jeremy

**RECEIVED**  
By Planning Department at 3:37 pm, Mar 31, 2016

**BLOUNT**  
fine foods

MCKINNEY, TEXAS  
630 Currant Road  
Fall River, Massachusetts 02720  
Ph: (774) 888-1300  
www.blountfinefoods.com

CONSULTANT:

**TEAM GROUP**  
Technology, Engineering, Architecture, Management  
TEAM Group, Ltd.  
1001 W. EULESS BLVD., SUITE 200 • EULESS, TX 76040  
Phone 817-545-1515 • Fax 817-545-2122

**AECOM**  
16000 Dallas Parkway - Suite 350  
Dallas, Texas 75248  
Ph: (972) 735-3000 Fax: (972) 735-3001  
www.aecom.com TEPE Reg. No. F-3560

SEAL:  
REVISIONS:

REV.	DATE	BY	DESCRIPTION

**BRAY CENTRAL TWO ADDITION  
BLK "D" LOT 1D  
2200 REDBUD BLVD  
MCKINNEY, TX 75069-8217  
11.00 AC - LOT ACREAGE**

IF SHEET IS LESS THAN  
24" x 36"  
IT IS A REDUCED PRINT -  
SCALE REDUCED ACCORDINGLY

DRAWN BY: JAG DATE: -  
CHECKED BY: RC DATE: -

All concepts and arrangements shown on this drawing are the property of TEAM Group, Ltd. These documents are released specifically for use on this project and may not be reproduced in whole or in part except for purposes relating to the construction of this project. Any disclosures or reuse of these documents for purposes unrelated to this project is prohibited.

PROJECT TITLE:  
**2016 FACILITY**

DRAWING TITLE:  
**SITE PLAN**

PROJECT NO.	DRAWING NO.	REV.	STATUS
15478	C1.0	0	F