

# 2018 QUALIFIED ALLOCATION PLAN

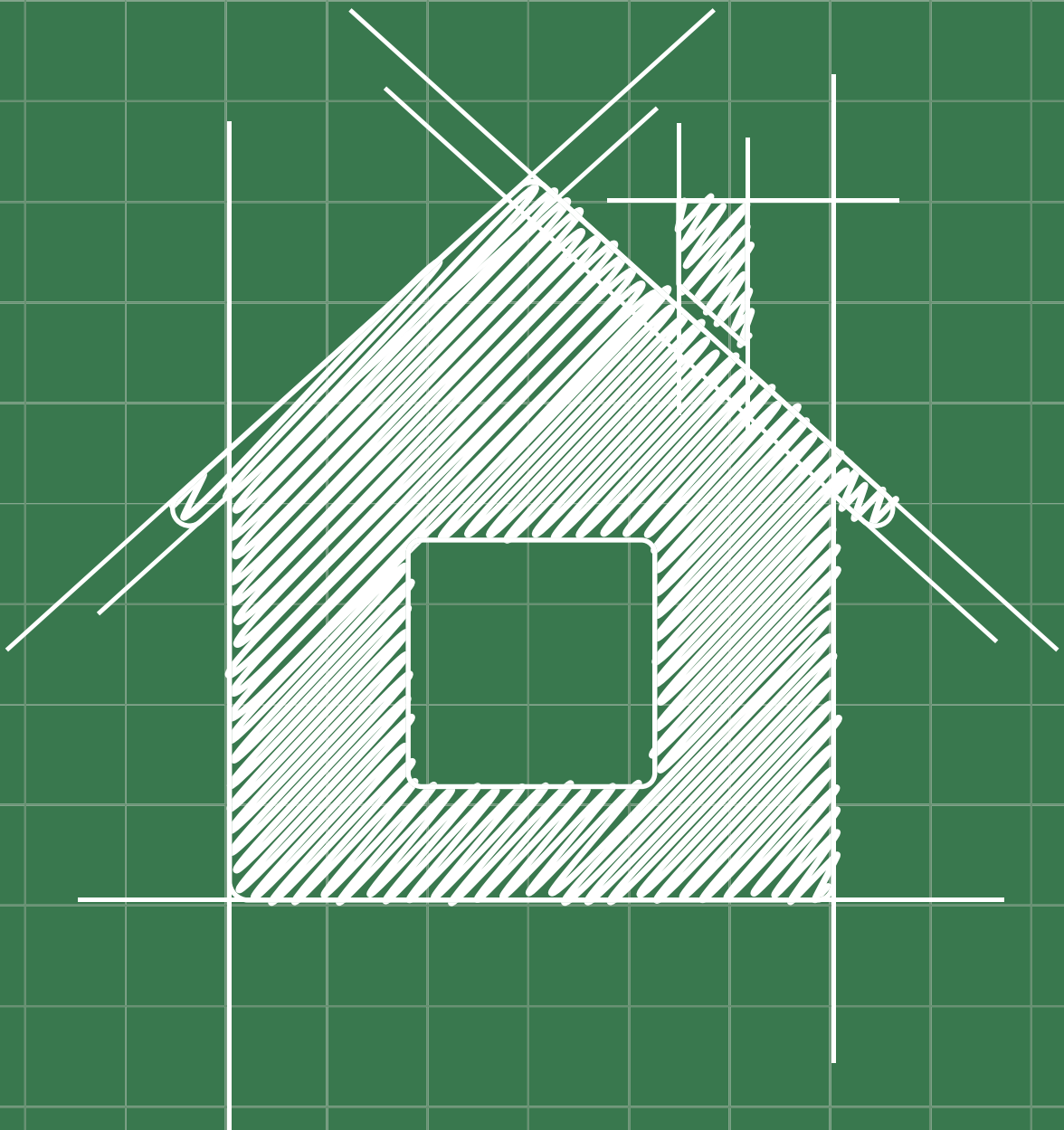

TEXAS DEPARTMENT of HOUSING  
and COMMUNITY AFFAIRS



Prepared by the Multifamily Finance Division  
P.O. Box 13941, Austin, TX 78711  
Phone: 512-475-3976 • Fax: 512-475-0070  
[www.tdhca.state.tx.us](http://www.tdhca.state.tx.us)

Equal Opportunity Employer/Program.  
Auxiliary aids and services are available upon request to individuals with disabilities.  
Relay Texas: 800-735-2989 (TTY) and 711 (Voice).



**Texas Department of Housing and Community Affairs**

Street Address: 221 East 11th Street, Austin, TX 78701 • Mailing Address: P.O. Box 13941, Austin, TX 78711  
512-475-3800 • 800-525-0657 • [info@tdhca.state.tx.us](mailto:info@tdhca.state.tx.us) • [www.tdhca.state.tx.us](http://www.tdhca.state.tx.us)

## Housing Tax Credit Program Qualified Allocation Plan

### §11.1.General.

**(a) Authority.** This chapter applies to the awarding and allocation by the Texas Department of Housing and Community Affairs (the "Department") of Housing Tax Credits. The federal laws providing for the awarding and allocation of Housing Tax Credits require states to adopt a qualified allocation plan. Pursuant to Tex. Gov't Code, Chapter 2306, Subchapter DD, the Department is assigned responsibility for this activity. As required by Internal Revenue Code (the "Code"), §42(m)(1), the Department has developed this Qualified Allocation Plan ("QAP") and it has been duly approved to establish the procedures and requirements relating to an award and allocation of Housing Tax Credits. All requirements herein and all those applicable to a Housing Tax Credit Development or an Application under Chapter 10 of this title (relating to Uniform Multifamily Rules), or otherwise incorporated by reference herein collectively constitute the QAP required by Tex. Gov't Code §2306.67022.

**(b) Due Diligence and Applicant Responsibility.** Department staff may, from time to time, make available for use by Applicants information and informal guidance in the form of reports, frequently asked questions, and responses to specific questions. The Department encourages communication with staff in order to clarify any issues that may not be fully addressed in the QAP or may be unclear when applied to specific facts. However, while these resources are offered to help Applicants prepare and submit accurate information, Applicants should also appreciate that this type of guidance is limited by its nature and that staff will apply the rules of the QAP to each specific situation as it is presented in the submitted Application. The Multifamily Programs Procedures Manual and Frequently Asked Questions website posting are not rules and are provided as good faith guidance and assistance, but in all respects the statutes and rules governing the Low Income Housing Tax Credit program supersede these guidelines and are controlling. Moreover, after the time that an issue is initially presented and guidance is provided, additional information may be identified and/or the issue itself may continue to develop based upon additional research and guidance. Thus, until confirmed through final action of the Board, staff guidance must be considered merely as an aid and an Applicant continues to assume full responsibility for any actions Applicant takes regarding an Application. In addition, although the Department may compile data from outside sources in order to assist Applicants in the Application process, **it remains the sole responsibility of the Applicant to perform independently the necessary due diligence to research, confirm, and verify any data, opinions, interpretations, or other information upon which an Applicant bases an Application or includes in any submittal in connection with an Application.** As provided by Tex. Gov't Code §2306.6715(c), an Applicant is given until the later of the seventh day of the publication on the Department's website of a scoring log reflecting that applicant's score or the seventh day from the date of transmittal of a scoring notice; provided, however, that an applicant may not appeal any scoring matter after the award of credits unless they are within the above-described time limitations and have appeared at the meeting when the Department's Governing Board makes competitive tax credit awards and stated on the record that they have an actual or possible appeal that has not been heard. Appeal rights may be triggered by the publication on the Department's website of the results of the evaluation process.

**(c) Competitive Nature of Program.** Applying for competitive housing tax credits is a technical process that must be followed completely and correctly. Any person who desires to request any reasonable accommodation for any aspect of this process is directed to 10 TAC §1.1. As a result of the highly competitive nature of applying for tax credits, an Applicant should proceed on the

assumption that deadlines are fixed and firm with respect to both date and time and cannot be waived except where authorized and for truly extraordinary circumstances, such as the occurrence of a significant natural disaster that could not have been anticipated and makes timely adherence impossible. If an Applicant chooses, where permitted, to submit by delivering an item physically to the Department, it is the Applicant's responsibility to be within the Department's doors by the appointed deadline. Applicants should further ensure that all required documents are included, legible, properly organized, and tabbed, and that materials in required formats involving digital media are complete and fully readable. Applicants are strongly encouraged to submit the required items well in advance of established deadlines. Staff, when accepting Applications, may conduct limited reviews at the time of intake as a courtesy only. If staff misses an issue in such a limited review, the fact that the Application was accepted by staff or that the issue was not identified does not operate to waive the requirement or validate the completeness, readability, or any other aspect of the Application.

**(d) Definitions.** The capitalized terms or phrases used herein are defined in §10.3 of this title (relating to Definitions), unless the context clearly indicates otherwise. Any capitalized terms that are defined in Tex. Gov't Code Chapter 2306, §42 of the Code, or other Department rules have, when capitalized, the meanings ascribed to them therein. Defined terms when not capitalized, are to be read in context and construed according to common usage.

**(e) Data.** Where this chapter requires the use of American Community Survey data, the Department shall use the most current data available as of October 1, 2017, unless specifically otherwise provided in federal or state law or in the rules. All American Community Survey data must be 5-year estimates, unless otherwise specified. The availability of more current data shall be disregarded. Where other data sources are specifically required, such as Neighborhoodscout, the data available after October 1, but before Pre-Application Final Delivery Date, will be permissible. The NeighborhoodScout report submitted in the Application must include the report date.

**(f) Deadlines.** Where a specific date or deadline is identified in this chapter, the information or documentation subject to the deadline must be submitted on or before 5:00 p.m. Austin local time on the day of the deadline. If the deadline falls on a weekend or holiday, the deadline is 5:00 p.m. Austin local time on the next day which is not a weekend or holiday and on which the Department is open for general operation. Unless otherwise noted or provided in statute, deadlines are based on calendar days.

**(g) Documentation to Substantiate Items and Representations in an Application.** In order to ensure the appropriate level of transparency in this highly competitive program, Applications and all correspondence and other information relating to each Application are posted on the Department's website and updated on a regular basis. Applicants should use the Application form posted online to provide appropriate support for each item substantiating a claim or representation, such as claims for points, qualification for set-asides, or meeting of threshold requirements. Any Application that staff identifies as having insufficient support information will be directed to cure the matter via the Administrative Deficiency process, unless the missing documentation is determined to be a Material Deficiency. Applicants are reminded that this process may not be used to increase a scoring item's points or to change any aspect of the proposed Development, financing structure, or other element of the Application. The sole purpose of this mandatory Administrative Deficiency will be to substantiate one or more aspects of the Application to enable an efficient and effective review by staff. Although a responsive narrative will be created after Application submission, all facts and

materials to substantiate any item in response to such an Administrative Deficiency must have been clearly established at the time of submission of the Application,

**§11.2. Program Calendar for Competitive Housing Tax Credits.**

Non-statutory deadlines specifically listed in the Program Calendar may be extended by the Department for a period of not more than five (5) business days provided that the Applicant has, in writing, requested an extension prior to the date of the original deadline and has established to the reasonable satisfaction of the Department that there is good cause for the extension. Except as provided for under 10 TAC §1.1 relating to Reasonable Accommodation Requests, extensions relating to Administrative Deficiency deadlines may only be extended if documentation needed to resolve the item is needed from a Third Party or the documentation involves signatures needed on certifications in the Application.

Deadline	Documentation Required
01/04/2018	Application Acceptance Period Begins.
01/09/2018	Pre-Application Final Delivery Date (including waiver requests).
02/16/2018	Deadline for submission of application for .ftp access if pre-application not submitted
03/01/2018	<p>Full Application Delivery Date (including Quantifiable Community Participation documentation; Environmental Site Assessments (ESAs), Property Condition Assessments (PCAs); Appraisals; Primary Market Area Map; Site Design and Development Feasibility Report; all Resolutions necessary under §11.3 of this chapter related to Housing De-Concentration Factors).</p> <p>Final Input from Elected Officials Delivery Date (including Resolution for Local Government Support pursuant to §11.9(d)(1) of this chapter and State Representative Input pursuant to §11.9(d)(5) of this chapter).</p>
04/02/2018	Market Analysis Delivery Date pursuant to §10.205 of this title.
05/01/2018	Third Party Request for Administrative Deficiency
Mid-May	Scoring Notices Issued for Majority of Applications Considered “Competitive.”
06/22/2018	Public Comment to be included in the Board materials relating to presentation for awards are due in accordance with 10 TAC §1.10.
June	On or before June 30, publication of the list of Eligible Applications for

Deadline	Documentation Required
	Consideration for Award in July.
July	Final Awards.
Mid-August	Commitments are Issued.
<u>10/31/2018</u>	<u>Deadline for closing under §11.9(c)(8)</u>
11/01/2018	Carryover Documentation Delivery Date.
07/01/2019	10 Percent Test Documentation Delivery Date.
12/31/2020	Placement in Service.
Five (5) business days after the date on the Deficiency Notice (without incurring point loss)	Administrative Deficiency Response Deadline (unless an extension has been granted).

**§11.3.Housing De-Concentration Factors.**

(a) Rules reciting statutory limitations are provided as a convenient reference only, and to the extent there is any deviation from the provisions of statute, the statutory language is controlling.

(b) **Two Mile Same Year Rule (Competitive HTC Only).** As required by Tex. Gov't Code §2306.6711(f), staff will not recommend for award, and the Board will not make an award to an Application that proposes a Development Site located in a county with a population that exceeds one million if the proposed Development Site is also located less than two linear miles from the proposed Development Site of another Application within said county that is awarded in the same calendar year. If two or more Applications are submitted that would violate this rule, the lower scoring Application will be considered a non-priority Application and will not be reviewed unless the higher scoring Application is terminated or withdrawn.

(c) **Twice the State Average Per Capita.** As provided for in Tex. Gov't Code §2306.6703(a)(4), if a proposed Development is located in a municipality, or if located completely outside a municipality, a county, that has more than twice the state average of units per capita supported by Housing Tax Credits or private activity bonds at the time the Application Acceptance Period Begins (or for Tax-Exempt Bond Developments, Applications submitted after the Application Acceptance Period Begins ), then the Applicant must obtain prior approval of the Development from the Governing Body of the appropriate municipality or county containing the Development. Such approval must include a resolution adopted by the Governing Body of the municipality or county, as applicable, setting forth a written statement of support, specifically citing Tex. Gov't Code §2306.6703(a)(4) in

the text of the actual adopted resolution, and authorizing an allocation of Housing Tax Credits for the Development. An acceptable, but not required, form of resolution may be obtained in the Uniform Multifamily Application Templates. Required documentation must be submitted by the Full Application Delivery Date as identified in §11.2 of this chapter (relating to Program Calendar for Competitive Housing Tax Credits) or Resolutions Delivery Date in §10.4 of this title (relating to Program Dates), as applicable.

**(d) One Mile Three Year Rule.** (§2306.6703(a)(3))

(1) An Application that proposes the New Construction or Adaptive Reuse of a Development that is located one linear mile or less (measured between closest boundaries by a straight line on a map) from another development that meets all of the criteria in subparagraphs (A) - (C) of this paragraph shall be considered ineligible.

(A) The Development serves the same type of household as the proposed Development, regardless of whether the Development serves families, elderly individuals, or another type of household; and

(B) The Development has received an allocation of Housing Tax Credits or private activity bonds for any New Construction at any time during the three-year period preceding the date the Application Round begins (or for Tax-Exempt Bond Developments the three-year period preceding the date the Certificate of Reservation is issued); and

(C) The Development has not been withdrawn or terminated from the Housing Tax Credit Program.

(2) Paragraph (1) of this subsection does not apply to a Development:

(A) that is using federal HOPE VI (or successor program) funds received through HUD;

(B) that is using locally approved funds received from a public improvement district or a tax increment financing district;

(C) that is using funds provided to the state under the Cranston-Gonzalez National Affordable Housing Act (42 U.S.C. §§12701 et seq.);

(D) that is using funds provided to the state and participating jurisdictions under the Housing and Community Development Act of 1974 (42 U.S.C. §§5301 et seq.);

(E) that is located in a county with a population of less than one million;

(F) that is located outside of a metropolitan statistical area; or

(G) that the Governing Body of the appropriate municipality or county where the Development is to be located has by vote specifically allowed the construction of a new Development located within one linear mile or less from a Development described under paragraph (1)(A) of this subsection. An acceptable, but not required, form of resolution may be obtained in the Uniform Multifamily Application Templates. Required documentation



must be submitted by the Full Application Delivery Date as identified in §11.2 of this chapter or Resolutions Delivery Date in §10.4 of this title, as applicable.

(3) Where a specific source of funding is referenced in paragraph (2)(A) - (D) of this subsection, a commitment or resolution documenting a commitment of the funds must be provided in the Application.

**(e) Limitations on Developments in Certain Census Tracts.** An Application that proposes the New Construction or Adaptive Reuse of a Development proposed to be located in a census tract that has more than 20 percent Housing Tax Credit Units per total households as established by the 5-year American Community Survey shall be considered ineligible unless the Governing Body of the appropriate municipality or county containing the Development has, by vote, specifically allowed the Development and submits to the Department a resolution stating the proposed Development is consistent with the jurisdiction's obligation to affirmatively further fair housing. The resolution must be submitted by the Full Application Delivery Date as identified in §11.2 of this chapter or Resolutions Delivery Date in §10.4 of this title, as applicable.

**(f) Additional Phase.** Applications proposing an additional phase of an existing tax credit Development serving the same Target Population or Applications proposing Developments that are adjacent to an existing tax credit Development serving the same Target Population, shall be considered ineligible unless the other Developments or phase(s) of the Development have been completed and have maintained occupancy of at least 90 percent for a minimum six (6) month period as reflected in the submitted rent roll. If the Application proposes the Rehabilitation or replacement of existing federally-assisted affordable housing units or federally-assisted affordable housing units demolished on the same site within two years of the beginning of the Application Acceptance Period, this provision does not apply.

**(g) Proximity of Development Sites.** If two or more Competitive HTC Applications that are proposing Developments serving the same Target Population on contiguous sites are submitted in the same program year, the lower scoring Application, including consideration of tie-breaker factors if there are tied scores, will be considered a non-priority Application and will not be reviewed unless the higher scoring Application is terminated or withdrawn.

#### **§11.4. Tax Credit Request and Award Limits.**

**(a) Credit Amount (Competitive HTC Only).** (§2306.6711(b)) The Board may not award or allocate to an Applicant, Developer, Affiliate or Guarantor (unless the Guarantor is also the General Contractor or provides the guaranty only during the construction period, and is not a Principal of the Applicant, Developer or Affiliate of the Development Owner) Housing Tax Credits in an aggregate amount greater than \$3 million in a single Application Round. Prior to June 29, an Applicant that has Applications pending for more than \$3 million in credit may notify staff in writing or by email of the Application(s) they will not pursue in order to bring their request within the \$3 million cap. If the Applicant has not made this self-selection by this date, staff may make the selection. The methodology for making this determination will be to assign first priority to an Application that will enable the Department to comply with the state and federal non-profit set-asides and second to the highest scoring Application, including consideration of tie-breakers if there are tied scores. The Application(s) that does not meet Department criteria will not be considered a priority Application and will not be reviewed unless the Applicant withdraws a priority Application. The non-priority Application(s) will be terminated when the Department awards \$3 million to other

Applications. Any Application terminated for this reason is subject to reinstatement if necessary to meet a required set-aside. All entities that are under common Control are Affiliates. For purposes of determining the \$3 million limitation, a Person is not deemed to be an Applicant, Developer, Affiliate or Guarantor solely because it:

- (1) raises or provides equity;
- (2) provides "qualified commercial financing;"
- (3) is a Qualified Nonprofit Organization or other not-for-profit entity that is providing solely loan funds, grant funds or social services; or
- (4) receives fees as a consultant or advisor that do not exceed \$200,000.

**(b) Maximum Request Limit (Competitive HTC Only).** For any given Development, an Applicant may not request more than 150 percent of the credit amount available in the subregion based on estimates released by the Department on December 1, or \$1,500,000, whichever is less, or \$2,000,000 for Applications under the At-Risk Set-Aside. In addition, for Elderly Developments in a Uniform State Service Region containing a county with a population that exceeds one million, the request may not exceed the final amount published on the Department's website after the release of the Internal Revenue Service notice regarding the 2018 credit ceiling. For all Applications, the Department will consider the amount in the funding request of the pre-application and Application to be the amount of Housing Tax Credits requested and will automatically reduce the Applicant's request to the maximum allowable under this subsection if exceeded. Regardless of the credit amount requested or any subsequent changes to the request made by staff, the Board may not award to any individual Development more than \$2 million in a single Application Round. (§2306.6711(b))

**(c) Increase in Eligible Basis (30 percent Boost).** Applications will be evaluated for an increase of up to but not to exceed 30 percent in Eligible Basis provided they meet the criteria identified in paragraphs (1) - (3) of this subsection, or if required under §42 of the Code. Staff will recommend no increase or a partial increase in Eligible Basis if it is determined it would cause the Development to be over sourced, as evaluated by the Real Estate Analysis division, in which case a credit amount necessary to fill the gap in financing will be recommended. In no instance will the boost exceed more than the amount of credits required to create the HTC rent-restricted units, as determined by the Real Estate Analysis division of TDHCA. The criteria in paragraph (3) of this subsection are not applicable to Tax-Exempt Bond Developments.

(1) The Development is located in a Qualified Census Tract (QCT) (as determined by the Secretary of HUD) that has less than 20 percent Housing Tax Credit Units per total households in the tract as established by the U.S. Census Bureau for the 5-year American Community Survey. New Construction or Adaptive Reuse Developments located in a QCT that has in excess of 20 percent Housing Tax Credit Units per total households in the tract are not eligible to qualify for a 30 percent increase in Eligible Basis, which would otherwise be available for the Development Site pursuant to §42(d)(5) of the Code. For Tax-Exempt Bond Developments, as a general rule, a QCT designation would have to coincide with the program year the Certificate of Reservation is issued in order for the Department to apply the 30 percent boost in its underwriting evaluation. For New Construction or Adaptive Reuse Developments located in a QCT with 20 percent or greater Housing Tax Credit Units per total households, the Development is eligible for the boost if the Application includes a resolution stating that the Governing Body of the appropriate municipality or county containing the Development has by vote specifically allowed the construction of the new Development and referencing this rule. An acceptable, but not required,

form of resolution may be obtained in the Multifamily Programs Procedures Manual. Required documentation must be submitted by the Full Application Delivery Date as identified in §11.2 of this chapter or Resolutions Delivery Date in §10.4 of this title, as applicable. Applicants must submit a copy of the census map that includes the 11-digit census tract number and clearly shows that the proposed Development is located within a QCT; OR

(2) The Development is located in a Small Area Difficult Development Area (“SADDA”) (based on Small Area Fair Market Rents (“FMRs”) as determined by the Secretary of HUD) that has high construction, land and utility costs relative to the AMGI. For Tax-Exempt Bond Developments, as a general rule, a SADDA designation would have to coincide with the program year the Certificate of Reservation is issued in order for the Department to apply the 30 percent boost in its underwriting evaluation. Applicants must submit a copy of the SADDA map that clearly shows the proposed Development is located within the boundaries of a SADDA; OR

(3) The Development meets one of the criteria described in subparagraphs (A) - (E) of this paragraph pursuant to §42(d)(5) of the Code:

(A) the Development is located in a Rural Area;

(B) the Development is proposing entirely Supportive Housing and is expected to be debt free or have no foreclosable or non-cash flow debt;

(C) the Development meets the criteria for the Opportunity Index as defined in §11.9(c)(4) of this chapter (relating to Competitive HTC Selection Criteria);

(D) the Applicant elects to restrict an additional 10 percent of the proposed low income Units for households at or below 30 percent of AMGI. These Units must be in addition to Units required under any other provision of this chapter, or required under any other funding source from the Multifamily Direct Loan program; or

(E) the Development is in an area covered by a concerted revitalization plan, is not an Elderly Development, and is not located in a QCT. A Development will be considered to be in an area covered by a concerted revitalization plan if it is eligible for and elects points under §11.9(d)(7) of this chapter.

**§11.5. Competitive HTC Set-Asides.** (§2306.111(d)) This section identifies the statutorily-mandated Set-asides which the Department is required to administer. An Applicant may elect to compete in each of the Set-asides for which the proposed Development qualifies. In order to be eligible to compete in the Set-aside, the Application must meet the requirements of the Set-aside as of the Full Application Delivery Date. Election to compete in a Set-aside does not constitute eligibility to compete in the Set-aside, and Applicants who are ultimately deemed not to qualify to compete in the Set-aside will be considered not to be participating in the Set-aside for purposes of qualifying for points under §11.9(3) of this chapter (related to pre-application Participation). Commitments of Competitive HTCs issued by the Board in the current program year will be applied to each Set-aside, Rural regional allocation, Urban regional allocation, and/or USDA Set-aside for the current Application round as appropriate.

**(1) Nonprofit Set-Aside.** (§2306.6729 and §2306.6706(b)) At least 10 percent of the State Housing Credit Ceiling for each calendar year shall be allocated to Qualified Nonprofit Developments which meet the requirements of §42(h)(5) of the Code and Tex. Gov't Code §2306.6729 and §2306.6706(b). Qualified Nonprofit Organizations must have the controlling interest in the Development Owner applying for this Set-aside (*i.e.*, greater than 50 percent ownership in the

General Partner). If the Application is filed on behalf of a limited partnership, the Qualified Nonprofit Organization must be the Managing General Partner. If the Application is filed on behalf of a limited liability company, the Qualified Nonprofit Organization must be the controlling Managing Member. Additionally, for Qualified Nonprofit Development in the Nonprofit Set-aside the nonprofit entity or its nonprofit Affiliate or subsidiary must be the Developer or a co-Developer as evidenced in the development agreement. An Applicant that meets the requirements to be in the Qualified Nonprofit Set-aside is deemed to be applying under that Set-aside unless their Application specifically includes an affirmative election to not be treated under that Set-aside and a certification that they do not expect to receive a benefit in the allocation of tax credits as a result of being affiliated with a nonprofit. The Department reserves the right to request a change in this election and/or not recommend credits for those unwilling to change elections if insufficient Applications in the Nonprofit Set-Aside are received. Applicants may not use different organizations to satisfy the state and federal requirements of the Set-aside.

**(2) USDA Set-Aside.** (§2306.111(d-2)) At least 5 percent of the State Housing Credit Ceiling for each calendar year shall be allocated to Rural Developments which are financed through USDA. If an Application in this Set-aside involves Rehabilitation it will be attributed to and come from the At-Risk Development Set-aside; if an Application in this set-aside involves New Construction it will be attributed to and come from the applicable Uniform State Service Region and will compete within the applicable subregion unless the Application is receiving USDA Section 514 funding. Applications must also meet all requirements of Tex Gov't Code, §2306.111(d-2).

(A) Eligibility of Certain Developments to Participate in the USDA or Rural Set-asides. (§2306.111(d-4)) A proposed or Existing Residential Development that, before September 1, 2013, has been awarded or has received federal financial assistance provided under Section 514, 515, or 516 of the Housing Act of 1949 (42 U.S.C. Section 1484, 1485, or 1486) may be attributed to and come from the At-Risk Development Set-aside or the Uniform State Service Region in which the Development is located, regardless of whether the Development is located in a Rural area.

(B) All Applications that can score under the USDA Set-aside will be considered Rural for all scoring items under this chapter. If a Property receiving USDA financing is unable to score under the USDA Set-aside and it is located in an Urban subregion, it will be scored as Urban.

**(3) At-Risk Set-Aside.** (§2306.6714; §2306.6702)

(A) At least 15 percent of the State Housing Credit Ceiling for each calendar year will be allocated under the At-Risk Development Set-aside and will be deducted from the State Housing Credit Ceiling prior to the application of the regional allocation formula required under §11.6 of this chapter (relating to Competitive HTC Allocation Process). Through this Set-aside, the Department, to the extent possible, shall allocate credits to Applications involving the preservation of Developments identified as At-Risk Developments. (§2306.6714) Up to 5 percent of the State Housing Credit Ceiling associated with this Set-aside may be given priority to Rehabilitation Developments under the USDA Set-aside.

(B) An At-Risk Development qualifying under Tex. Gov't Code §2306.6702(a)(5)(A) must meet the following requirements :

(i) Pursuant to Tex. Gov't Code §2306.6702(a)(5)(A)(i), a Development must have received a subsidy in the form of a qualified below-market interest rate loan, interest rate reduction, rental subsidy, Section 8 housing assistance payment, rental supplement payment, rental assistance payment, or equity incentive. Applications participating in the At-Risk Set-Aside must include evidence of the qualifying subsidy.

(ii) Any stipulation to maintain affordability in the contract granting the subsidy pursuant to Tex. Gov't Code §2306.6702(a)(5)(A)(ii)(a), or any HUD-insured or HUD-held mortgage will be considered to be nearing expiration or nearing the end of its term if expiration will occur or the term will end within two (2) years of July 31 of the year the Application is submitted. Developments with HUD-insured or HUD-held mortgages qualifying as At-Risk under §2306.6702(a)(5)(A)(ii)(b) may be eligible if the HUD-insured or HUD-held mortgage is eligible for prepayment or has been prepaid.

(iii) Developments with existing Department LURAs must have completed all applicable Right of First Refusal procedures prior to the pre-application Final Delivery Date.

(C) An At-Risk Development qualifying under Tex. Gov't Code §2306.6702(a)(5)(B) must meet one of the following requirements:

(i) Units to be Rehabilitated or Reconstructed must be owned by a public housing authority or a public facility corporation created by a public housing authority under Chapter 303, Local Government Code and received assistance under §9, United States Housing Act of 1937 (42 U.S.C. section 1437g); or

(ii) Units to be Rehabilitated or Reconstructed must have been disposed of or demolished by a public housing authority in the two-year period preceding the Application for housing tax credits; and

(iii) For Developments including Units to be Reconstructed, the Application will be categorized as New Construction; and

(iv) To the extent that an Application is eligible under Tex. Gov't Code §2306.6702(a)(5)(B)(iii), the Development must receive assistance through the Rental Assistance Demonstration ("RAD") program administered by the United States Department of Housing and Urban Development ("HUD"). Applications must include evidence that RAD participation is included in the applicable public housing plan that was most recently approved by HUD, and evidence (in the form of a Commitment to enter into a Housing Assistance Payment ("CHAP")) that HUD has approved the units proposed for Rehabilitation or Reconstruction for participation in the RAD program; and

(v) Notwithstanding any other provision of law, an at-risk Development described by Tex. Gov't Code § 2306.6702(a)(5)(B) that was previously allocated housing tax credits set aside under Subsection (a) does not lose eligibility for those credits if the portion of units reserved for public housing as a condition of eligibility for the credits under Tex. Gov't Code § 2306.6714 (a-1)(2) are later converted under RAD.

(D) An Application for a Development that includes the demolition of the existing Units which have received the financial benefit described in Tex. Gov't Code §2306.6702(a)(5) will not

qualify as an At-Risk Development unless the redevelopment will include at least a portion of the same site. Alternatively, pursuant to Tex. Gov't Code §2306.6702(a)(5)(B), an Applicant may propose relocation of the existing units in an otherwise qualifying At-Risk Development if:

- (i) the affordability restrictions and any At-Risk eligible subsidies are approved to be transferred with the units proposed for Rehabilitation or Reconstruction prior to the tax credit Carryover deadline;
- (ii) the Applicant seeking tax credits must propose the same number of restricted units (*e.g.*, the Applicant may add market rate units); and
- (iii) the new Development Site must either qualify for points on the Opportunity Index under §11.9(c)(4) of this chapter (relating to Competitive HTC Selection Criteria); OR
- (iv) the local Governing Body of the applicable municipality or county (if completely outside of a municipality) in which that Development is located must submit a resolution confirming that the proposed Development is supported by the municipality or county in order to carry out a previously adopted plan that meets the requirements of §11.9(d)(7). Development Sites that cross jurisdictional boundaries must provide a resolution from both local governing bodies.

(E) If Developments at risk of losing affordability from the financial benefits available to the Development are able to retain, renew, or replace the existing financial benefits and affordability they must do so unless regulatory barriers necessitate elimination of all or a portion of that benefit for the Development.

(i) Evidence of the legal requirements that will unambiguously cause the loss of affordability and that this will occur within the two calendar years after the year in which the Application is made must be included with the application.

(ii) For Developments qualifying under Tex. Gov't Code §2306.6702(a)(5)(B), only a portion of the subsidy must be retained for the proposed Development, but no less than 25 percent of the proposed Units must be public housing units supported by public housing operating subsidy. (§2306.6714(a-1)). If less than 100 percent of the public housing benefits are transferred to the proposed Development, an explanation of the disposition of the remaining public housing benefits must be included in the Application, as well as a copy of the HUD-approved plan for demolition and disposition.

(F) Nearing expiration on a requirement to maintain affordability includes Developments eligible to request a Qualified Contract under §42 of the Code. Evidence must be provided in the form of a copy of the recorded LURA, the first year's IRS Forms 8609 for all buildings showing Part II of the form completed and, if applicable, documentation from the original application regarding the Right of First Refusal. The Application must also include evidence that any applicable Right of First Refusal procedures have been completed prior to the pre-application Final Delivery Date.

(G) An amendment to any aspect of the existing tax credit property sought to enable the Development to qualify as an At-Risk Development, that is submitted to the Department after the Application has been filed and is under review will not be accepted.

**§11.6.Competitive HTC Allocation Process.** This section identifies the general allocation process and the methodology by which awards are made.

**(1) Regional Allocation Formula.** The Department shall initially make available in each Rural Area and Urban Area of each Uniform State Service Region ("subregion") Housing Tax Credits in an amount consistent with the Regional Allocation Formula developed in compliance with Tex. Gov't Code §2306.1115. The process of awarding the funds made available within each subregion shall follow the process described in this section. Where a particular situation that is not contemplated and addressed explicitly by the process described herein, Department staff shall formulate a recommendation for the Board's consideration based on the objectives of regional allocation together with other policies and purposes set out in Tex. Gov't Code Chapter 2306 and the Department shall provide Applicants the opportunity to comment on and propose alternatives to such a recommendation. In general, such a recommendation shall not involve broad reductions in the funding request amounts solely to accommodate regional allocation and shall not involve rearranging the priority of Applications within a particular subregion or set-aside except as described herein. If the Department determines that an allocation recommendation would cause a violation of the \$3 million credit limit per Applicant, the Department will make its recommendation based on the criteria described in §11.4(a) of this chapter. Where sufficient credit becomes available to award an Application on the waiting list late in the calendar year, staff may allow flexibility in meeting the Carryover Allocation submission deadline and/or changes to the Application as necessary to ensure to the fullest extent feasible that available resources are allocated by December 31.

**(2) Credits Returned and National Pool Allocated After January 1.** For any credits returned after January 1 and eligible for reallocation (not including credit returned and reallocated under *force majeure* provisions), the Department shall first return the credits to the subregion or set-aside from which the original allocation was made. The credits will be treated in a manner consistent with the allocation process described in this section and may ultimately flow from the subregion and be awarded in the collapse process to an Application in another region, subregion or set-aside. For any credit received from the "national pool" after the initial approval of awards in late July, the credits will be added to any remaining credits and awarded to the next Application on the waiting list for the state collapse, if sufficient credits are available to meet the requirements of the Application as may be amended after underwriting review.

**(3) Award Recommendation Methodology.** (§2306.6710(a) - (f); §2306.111) The Department will assign, as described herein, Developments for review by the program and underwriting divisions. In general, Applications will be prioritized for assignment, with highest priority given to those identified as most competitive based upon the Applicant self-score and an initial program review. The procedure identified in subparagraphs (A) - (F) of this paragraph will also be used in making recommendations to the Board.

(A) USDA Set-Aside Application Selection (Step 1). The first level of priority review will be those Applications with the highest scores in the USDA Set-Aside until the minimum requirements stated in §11.5(2) of this chapter (relating to Competitive HTC Set-Asides. (§2306.111(d)) are attained. The minimum requirement may be exceeded in order to award the full credit request or underwritten amount of the last Application selected to meet the At-Risk Set-Aside requirement;

(B) At-Risk Set-Aside Application Selection (Step 2). The second level of priority review will be those Applications with the highest scores in the At-Risk Set-Aside statewide until the minimum

requirements stated in §11.5(3) of this chapter are attained. This may require the minimum requirement to be exceeded to award the full credit request or underwritten amount of the last Application selected to meet the At-Risk Set-Aside requirement. This step may leave less than originally anticipated in the 26 subregions to award under the remaining steps;

(C) Initial Application Selection in Each Subregion (Step 3). The highest scoring Applications within each of the 26 subregions will then be selected provided there are sufficient funds within the subregion to fully award the Application. Applications electing the At-Risk or USDA Set-Asides will not be eligible to receive an award from funds made generally available within each of the subregions. The Department will, for each such Urban subregion, calculate the maximum percentage in accordance with Tex. Gov't Code §2306.6711(h) and will publish such percentages on its website.

(i) In Uniform State Service Regions containing a county with a population that exceeds one million, the Board may not allocate more than the maximum percentage of credits available for Elderly Developments, unless there are no other qualified Applications in the subregion.

(ii) In accordance with Tex Gov't Code, §2306.6711(g), in Uniform State Service Regions containing a county with a population that exceeds 1.7 million, the Board shall allocate competitive tax credits to the highest scoring development, if any, that is part of a concerted revitalization plan that meets the requirements of §11.9(d)(7) (except for §11.9(d)(7)(A)(ii)(III) and §11.9(d)(7)(B)(iii)), is located in an urban subregion, and is within the boundaries of a municipality with a population that exceeds 500,000.

(D) Rural Collapse (Step 4). If there are any tax credits set-aside for Developments in a Rural Area in a specific Uniform State Service Region ("Rural subregion") that remain after award under subparagraph (C) of this paragraph, those tax credits shall be combined into one "pool" and then be made available in any other Rural Area in the state to the Application in the most underserved Rural subregion as compared to the subregion's allocation. This rural redistribution will continue until all of the tax credits in the "pool" are allocated to Rural Applications and at least 20 percent of the funds available to the State are allocated to Applications in Rural Areas. (§2306.111(d)(3)) In the event that more than one subregion is underserved by the same percentage, the priorities described in clauses (i) - (ii) of this subparagraph will be used to select the next most underserved subregion:

(i) the subregion with no recommended At-Risk Applications from the same Application Round; and

(ii) the subregion that was the most underserved during the Application Round during the year immediately preceding the current Application Round.

(E) Statewide Collapse (Step 5). Any credits remaining after the Rural Collapse, including those in any subregion in the State, will be combined into one "pool." The funds will be used to award the highest scoring Application (not selected in a prior step) in the most underserved subregion in the State compared to the amount originally made available in each subregion. In Uniform State Service Regions containing a county with a population that exceeds one million, the Board may not allocate more than the maximum percentage of credits available for Elderly Developments, unless there are no other qualified Applications in the subregion. The Department will, for each such Urban subregion, calculate the maximum percentage in accordance with Tex. Gov't Code §2306.6711(h) and will publish such percentages on its



website. This process will continue until the funds remaining are insufficient to award the next highest scoring Application in the next most underserved subregion. In the event that more than one subregion is underserved by the same percentage, the priorities described in clauses (i) and (ii) of this subparagraph will be used to select the next most underserved subregion:

- (i) the subregion with no recommended At-Risk Applications from the same Application Round; and
- (ii) the subregion that was the most underserved during the Application Round during the year immediately preceding the current Application Round.

(F) Contingent Qualified Nonprofit Set-aside Step (Step 6). If an insufficient number of Applications participating in the Nonprofit Set-Aside are selected after implementing the criteria described in subparagraphs (A) - (E) of this paragraph to meet the requirements of the 10 percent Nonprofit Set-Aside, action must be taken to modify the criteria described in subparagraphs (A) - (E) of this paragraph to ensure the Set-aside requirements are met. Therefore, the criteria described in subparagraphs (C) - (E) of this paragraph will be repeated after selection of the highest scoring Application(s) under the Nonprofit Set-aside statewide are selected to meet the minimum requirements of the Nonprofit Set-Aside. This step may cause some lower scoring Applications in a subregion to be selected instead of a higher scoring Application not participating in the Nonprofit Set-aside.

**(4) Waiting List.** The Applications that do not receive an award by July 31 and remain active and eligible will be recommended for placement on the waiting list. The waiting list is not static. The allocation process will be used in determining the Application to award. For example, if credits are returned, those credits will first be made available in the set-aside or subregion from which they were originally awarded. This means that the first Application on the waiting list is in part contingent on the nature of the credits that became available for award. The Department shall hold all credit available after the late-July awards until September 30 in order to collect credit that may become available when tax credit Commitments are submitted. Credit confirmed to be available, as of September 30, may be awarded to Applications on the waiting list unless insufficient credits are available to fund the next Application on the waiting list. For credit returned after September 30, awards from the waiting list will be made when the remaining balance is sufficient to award the next Application as may be amended on the waiting list based on the date(s) of returned credit. Notwithstanding the foregoing, if decisions related to any returns or rescissions of tax credits are under appeal or are otherwise contested, the Department may delay awards until resolution of such issues. The Department will evaluate all waiting list awards for compliance with requested Set-asides. This may cause some lower scoring Applications to be selected instead of a higher scoring Application. (§2306.6710(a) - (f); §2306.111)

**(5) Credit Returns Resulting from Force Majeure Events.** In the event that the Department receives a return of Competitive HTCs during the current program year from an Application that received a Competitive Housing Tax Credit award during any of the preceding three years, such returned credit will, if the Board determines that all of the requirements of this paragraph are met to its satisfaction, be allocated separately from the current year's tax credit allocation, and not be subject to the requirements of paragraph (2) of this section. Requests to allocate returned credit separately where all of the requirements of this paragraph have not been met or requests for waivers of any part of this paragraph will not be considered. For purposes of this paragraph, credits returned after September 30 of the preceding program year may be considered to have been returned on January 1 of the current year in accordance with the treatment described in §(b)(2)(C)(iii) of Treasury

Regulation 1.42-14. The Department's Governing Board may approve the execution of a current program year Carryover Agreement regarding the returned credits with the Development Owner that returned such credits only if:

(A) The credits were returned as a result of "*Force Majeure*" events that occurred after the start of construction and before issuance of Forms 8609. Force Majeure events are the following sudden and unforeseen circumstances outside the control of the Development Owner: acts of God such as fire, tornado, flooding, significant and unusual rainfall or subfreezing temperatures, or loss of access to necessary water or utilities as a direct result of significant weather events; explosion; vandalism; orders or acts of military authority; litigation; changes in law, rules, or regulations; national emergency or insurrection; riot; acts of terrorism; supplier failures; or materials or labor shortages. If a *Force Majeure* event is also a presidentially declared disaster, the Department may treat the matter under the applicable federal provisions. *Force Majeure* events must make construction activity impossible or materially impede its progress;

(B) Acts or events caused by the negligent or willful act or omission of the Development Owner, Affiliate or a Related Party shall under no circumstance be considered to be caused by *Force Majeure*;

(C) A Development Owner claiming *Force Majeure* must provide evidence of the type of event, as described in subparagraph (A) of this paragraph, when the event occurred, and that the loss was a direct result of the event;

(D) The Development Owner must prove that reasonable steps were taken to minimize or mitigate any delay or damages, that the Development Owner substantially fulfilled all obligations not impeded by the event, including timely closing of all financing and start of construction, that the Development and Development Owner was properly insured and that the Department was timely notified of the likelihood or actual occurrence of an event described in subparagraph (A) of this paragraph;

(E) The event prevents the Development Owner from meeting the placement in service requirements of the original allocation;

(F) The requested current year Carryover Agreement allocates the same amount of credit as that which was returned; and

(G) The Department's Real Estate Analysis Division determines that the Development continues to be financially viable in accordance with the Department's underwriting rules after taking into account any insurance proceeds related to the event.

#### **§11.7. Tie Breaker Factors.**

In the event there are Competitive HTC Applications that receive the same number of points in any given set-aside category, rural regional allocation or urban regional allocation, or rural or statewide collapse, the Department will utilize the factors in this section, in the order they are presented, to determine which Development will receive preference in consideration for an award. For the purposes of this section, all measurements will include ingress/egress requirements and any easements regardless of how they will be held. The tie breaker factors are not intended to specifically address a tie between equally underserved subregions in the rural or statewide collapse.

- (1) Applications having achieved a score on Proximity to the Urban Core. This item does not apply to the At-Risk Set-Aside.
- (2) Applications scoring higher on the Opportunity Index under §11.9(c)(4) or Concerted Revitalization Plan under §11.9(d)(7) of this chapter (relating to Competitive HTC Selection Criteria) as compared to another Application with the same score.
- (3) Applications proposed to be located in a Place, or if located completely outside a Place, a county, that has the fewest HTC units per capita, as compared to another Application with the same score. The HTCs per capita measure (by Place or county) is located in the 2018 HTC Site Demographic Characteristics Report.
- (4) Applications proposed to be located in a census tract with the lowest poverty rate as compared to another Application with the same score.
- (5) Applications proposed to be located the greatest linear distance from the nearest Housing Tax Credit assisted Development. Developments awarded Housing Tax Credits but do not yet have a Land Use Restriction Agreement in place will be considered Housing Tax Credit assisted Developments for purposes of this paragraph according to the property inventory included in the HTC Site Demographic Characteristics Report. The linear measurement will be performed from closest boundary to closest boundary.

### **§11.8. Pre-Application Requirements (Competitive HTC Only).**

**(a) General Submission Requirements.** The pre-application process allows Applicants interested in pursuing an Application to assess potential competition across the thirteen (13) state service regions, subregions and set-asides. Based on an understanding of the potential competition they can make a more informed decision whether they wish to proceed to prepare and submit an Application. A complete pre-application is a pre-application that meets all of the Department's criteria, as outlined in subsections (a) and (b) of this section,

- (1) The pre-application must be submitted using the URL provided by the Department, as outlined in the Multifamily Programs Procedures Manual, along with the required pre-application fee as described in §10.901 of this title (relating to Fee Schedule), not later than the pre-application Final Delivery Date as identified in §11.2 of this chapter (relating to Program Calendar for Competitive Housing Tax Credits). If the pre-application and corresponding fee is not submitted on or before this deadline the Applicant will be deemed to have not made a pre-application.
- (2) Only one pre-application may be submitted by an Applicant for each Development Site.
- (3) Department review at this stage is limited, and not all issues of eligibility and threshold are reviewed or addressed at pre-application. Acceptance by staff of a pre-application does not ensure that an Applicant satisfies all Application eligibility, threshold or documentation requirements. While the pre-application is more limited in scope than the Application, pre-applications are subject to the same limitations, restrictions, or causes for disqualification or termination as Applications, and pre-applications will thus be subject to the same consequences for violation, including but not limited to loss of points and termination of the pre-application.

**(b) Pre-Application Threshold Criteria.** Pursuant to Tex Gov't Code, §2306.6704(c) pre-applications will be terminated unless they meet the threshold criteria described in subsection (a) of this section and paragraphs (1) and (2) of this subsection:

- (1) Submission of the competitive HTC pre-application in the form prescribed by the Department which identifies at a minimum:
  - (A) Site Control meeting the requirements of §10.204(10) of this title (relating to Required Documentation for Application Submission). For purposes of meeting this specific requirement related to pre-application threshold criteria, proof of consideration and any documentation required for identity of interest transactions is not required at the time of pre-application submission but will be required at the time of full application submission;
  - (B) Funding request;
  - (C) Target Population;
  - (D) Requested set-asides (At-Risk, USDA, Nonprofit, and/or Rural);
  - (E) Total Number of Units proposed;
  - (F) Census tract number in which the Development Site is located, and a map of that census tract with an outline of the proposed Development Site;
  - (G) Expected score for each of the scoring items identified in the pre-application materials;
  - (H) Proposed name of ownership entity; and
  - (I) Disclosure of the following Undesirable Neighborhood Characteristics under §10.101(a)(3):
    - (i) The Development Site is located in a census tract or within 1,000 feet of any census tract in an Urban Area and the rate of Part I violent crime is greater than 18 per 1,000 persons (annually) as reported on neighborhoodscout.com.
    - (ii) The Development Site is located within the attendance zones of an elementary school, a middle school or a high school that does not have a Met Standard rating by the Texas Education Agency.
- (2) Evidence in the form of a certification provided in the pre-application, that all of the notifications required under this paragraph have been made. (§2306.6704)
  - (A) The Applicant must list in the pre-application all Neighborhood Organizations on record with the county or state whose boundaries include the entire proposed Development Site as of the beginning of the Application Acceptance Period.
  - (B) Notification Recipients. No later than the date the pre-application is submitted, notification must be sent to all of the persons or entities prescribed in clauses (i) – (viii) of this subparagraph. Developments located in an ETJ of a municipality are required to notify both municipal and county officials. The notifications may be sent by e-mail, fax or mail with registered return receipt or similar tracking mechanism in the format required in the Public Notification Template provided in the Uniform 2018 Multifamily Application Template. The Applicant is required to retain proof of delivery in the event the Department requests proof of notification. Acceptable evidence of such delivery is demonstrated by signed receipt for mail or courier delivery and confirmation of delivery for fax and e-mail. Officials to be notified are those officials in office at the time the pre-application is submitted. Note that between the time of pre-application (if made) and full Application, such officials may change and the boundaries of their jurisdictions may change. By way of example and not by way of limitation, events such as redistricting may cause changes which will necessitate additional notifications at full Application. Meetings and discussions do not

constitute notification. Only a timely and compliant written notification to the correct person constitutes notification.

- (i) Neighborhood Organizations on record with the state or county as of the beginning of the Application Acceptance Period whose boundaries include the entire proposed Development Site;
- (ii) Superintendent of the school district in which the Development Site is located;
- (iii) Presiding officer of the board of trustees of the school district in which the Development Site is located;
- (iv) Mayor of the municipality (if the Development Site is within a municipality or its extraterritorial jurisdiction);
- (v) All elected members of the Governing Body of the municipality (if the Development Site is within a municipality or its extraterritorial jurisdiction);
- (vi) Presiding officer of the Governing Body of the county in which the Development Site is located;
- (vii) All elected members of the Governing Body of the county in which the Development Site is located; and
- (viii) State Senator and State Representative of the districts whose boundaries include the proposed Development Site;

(C) Contents of Notification.

- (i) The notification must include, at a minimum, all of the information described in subclauses (I) – (VI) of this clause.
  - (I) the Applicant's name, address, an individual contact name and phone number;
  - (II) the Development name, address, city, and county;
  - (III) a statement informing the entity or individual being notified that the Applicant is submitting a request for Housing Tax Credits with the Texas Department of Housing and Community Affairs;
  - (IV) whether the Development proposes New Construction, Reconstruction, Adaptive Reuse, or Rehabilitation;
  - (V) the physical type of Development being proposed (*e.g.* single family homes, duplex, apartments, high-rise, etc.); and
  - (VI) the approximate total number of Units and approximate total number of Low-Income Units.
- (ii) The Applicant must disclose that, in accordance with the Department's rules, aspects of the Development may not yet have been determined or selected or may be subject to change, such as changes in the amenities ultimately selected and provided;
- (iii) The notification may not contain any false or misleading statements. Without limiting the generality of the foregoing, the notification may not create the impression that the proposed Development will serve a Target Population exclusively or as a preference unless such targeting or preference is documented in the Application and is in full compliance with all applicable state and federal laws, including state and federal fair housing laws; and

(iv) Notifications or any other communications may not contain any statement that violates Department rules, statute, code, or federal requirements.

**(c) Pre-Application Results.** Only pre-applications which have satisfied all of the pre-application requirements, including those in §11.9(e)(3) of this chapter, will be eligible for pre-application points. The order and scores of those Developments released on the pre-application Submission Log do not represent a Commitment on the part of the Department or the Board to allocate tax credits to any Development and the Department bears no liability for decisions made by Applicants based on the results of the pre-application Submission Log. Inclusion of a pre-application on the pre-application Submission Log does not ensure that an Applicant will receive points for a pre-application.

### **§11.9.Competitive HTC Selection Criteria.**

**(a) General Information.** This section identifies the scoring criteria used in evaluating and ranking Applications. The criteria identified in subsections (b) - (e) of this section include those items required under Tex. Gov't Code Chapter 2306, §42 of the Code, and other criteria established in a manner consistent with Chapter 2306 and §42 of the Code. There is no rounding of numbers in this section for any of the calculations in order to achieve the desired requirement or limitation, unless rounding is explicitly stated as allowed for that particular calculation or criteria. The Application must include one or more maps indicating the location of the Development Site and the related distance to the applicable facility. Distances are to be measured from the nearest boundary of the Development Site to the nearest boundary of the property or easement containing the facility, unless otherwise noted. For the purposes of this section, all measurements will include ingress/egress requirements and any easements regardless of how they will be held. Due to the highly competitive nature of the program, Applicants that elect points where supporting documentation is required but fail to provide any supporting documentation will not be allowed to cure the issue through an Administrative Deficiency. However, Department staff may provide the Applicant an opportunity to explain how they believe the Application, as submitted, meets the requirements for points or otherwise satisfies the requirements.

#### **(b) Criteria promoting development of high quality housing.**

(1) Size and Quality of the Units. (§2306.6710(b)(1)(D); §42(m)(1)(C)(iii)) An Application may qualify for up to fifteen (15) points under subparagraphs (A) and (B) of this paragraph.

(A) Unit Sizes (8 points). The Development must meet the minimum requirements identified in this subparagraph to qualify for points. Points for this item will be automatically granted for Applications involving Rehabilitation (excluding Reconstruction), for Developments receiving funding from USDA, or for Supportive Housing Developments without meeting these square footage minimums only if requested in the Self Scoring Form.

- (i) five-hundred fifty (550) square feet for an Efficiency Unit;
- (ii) six-hundred fifty (650) square feet for a one Bedroom Unit;
- (iii) eight-hundred fifty (850) square feet for a two Bedroom Unit;
- (iv) one-thousand fifty (1,050) square feet for a three Bedroom Unit; and
- (v) one-thousand two-hundred fifty (1,250) square feet for a four Bedroom Unit.

(B) Unit and Development Features (7 points). Applicants that elect in an Application to provide specific amenity and quality features in every Unit at no extra charge to the tenant will be awarded points based on the point structure provided in §10.101(b)(6)(B) of this title (relating to Site and Development Requirements and Restrictions) and as certified to in the Application. The amenities will be required to be identified in the LURA. Rehabilitation Developments will start with a base score of three (3) points and Supportive Housing Developments will start with a base score of five (5) points.

(2) Sponsor Characteristics. (§42(m)(1)(C)(iv)) An Application may qualify to receive either one (1) or two (2) points if it meets one of the following conditions. Any Application that includes a HUB must include a narrative description of the HUB's experience directly related to the housing industry.

(A) The ownership structure contains either a HUB certified by the Texas Comptroller of Public Accounts by the Full Application Delivery Date or it contains a Qualified Nonprofit Organization, provided the Application is under the Nonprofit Set-Aside. The HUB or Qualified Nonprofit Organization must have some combination of ownership interest in the General Partner of the Applicant, Cash Flow from operations, and Developer Fee which taken together equal at least 50 percent and no less than 5 percent for any category. For example, a HUB or Qualified Nonprofit Organization may have 20 percent ownership interest, 25 percent of the Developer Fee, and 5 percent of Cash Flow from operations. The HUB or Qualified Nonprofit Organization must also materially participate in the Development and operation of the Development throughout the Compliance Period and must have experience directly related to the housing industry, which may include experience with property management, construction, development, financing, or compliance. Material participation means that the HUB or Qualified Nonprofit is regularly, continuously, and substantially involved in providing services integral to the Development Team; providing services as an independent contractor is not sufficient. A Principal of the HUB or Qualified Nonprofit Organization cannot be a Related Party to any other Principal of the Applicant or Developer (excluding another Principal of said HUB or Qualified Nonprofit Organization). (2 points)

(B) The HUB or Nonprofit Organization must be involved with the Development Services or in the provision of on-site tenant services during the Development's Affordability Period. Selecting this item because of the involvement of a Nonprofit Organization does not make an Application eligible for the Nonprofit Set-Aside. A Principal of the HUB or Nonprofit Organization cannot be a Related Party to any other Principal of the Applicant or Developer (excluding another Principal of said HUB or Nonprofit Organization). (1 point)

**(c) Criteria to serve and support Texans most in need.**

(1) Income Levels of Tenants. (§§2306.111(g)(3)(B) and (E); 2306.6710(b)(1)(C) and (e); and §42(m)(1)(B)(ii)(I)) An Application may qualify for up to sixteen (16) points for rent and income restricting a Development for the entire Affordability Period at the levels identified in subparagraph (A) or (B) of this paragraph.

(A) For any Development located within a non-Rural Area of the Dallas, Fort Worth, Houston, San Antonio, or Austin MSAs:

- (i) At least 40 percent of all Low-Income Units at 50 percent or less of AMGI (16 points);
- (ii) At least 30 percent of all Low-Income Units at 50 percent or less of AMGI (14 points); or
- (iii) At least 20 percent of all Low-Income Units at 50 percent or less of AMGI (12 points).

(B) For Developments proposed to be located in areas other than those listed in subparagraph (A) of this paragraph:

- (i) At least 20 percent of all Low-Income Units at 50 percent or less of AMGI (16 points);
- (ii) At least 15 percent of all Low-Income Units at 50 percent or less of AMGI (14 points); or
- (iii) At least 10 percent of all Low-Income Units at 50 percent or less of AMGI (12 points).

(2) Rent Levels of Tenants. (§2306.6710(b)(1)(E)) An Application may qualify to receive up to thirteen (13) points for rent and income restricting a Development for the entire Affordability Period. These levels are in addition to those committed under paragraph (1) of this subsection.

(A) At least 20 percent of all Low-Income Units at 30 percent or less of AMGI for Supportive Housing Developments proposed by a Qualified Nonprofit (13 points);

(B) At least 10 percent of all Low-Income Units at 30 percent or less of AMGI or, for a Development located in a Rural Area, 7.5 percent of all low-income Units at 30 percent or less of AMGI (11 points); or

(C) At least 5 percent of all Low-Income Units at 30 percent or less of AMGI (7 points).

(3) Tenant Services. (§2306.6710(b)(1)(G) and §2306.6725(a)(1)) A Supportive Housing Development proposed by a Qualified Nonprofit may qualify to receive up to eleven (11) points and all other Developments may receive up to ten (10) points.

(A) By electing points, the Applicant certifies that the Development will provide a combination of supportive services, which are listed in §10.101(b)(7) of this title, appropriate for the proposed tenants and that there is adequate space for the intended services. The provision and complete list of supportive services will be included in the LURA. The Owner may change, from time to time, the services offered; however, the overall points as selected at Application will remain the same. No fees may be charged to the tenants for any of the services. Services must be provided on-site or transportation to those off-site services identified on the list must be provided. The same service may not be used for more than one scoring item. (10 points for Supportive Housing, 9 points for all other Development)

(B) The Applicant certifies that the Development will contact local nonprofit and governmental providers of services that would support the health and well-being of the Department's tenants, and will make Development community space available to them on a regularly-scheduled basis to provide outreach services and education to the tenants.



Applicants may contact service providers on the Department list, or contact other providers that serve the general area in which the Development is located. (1 point)

(4) Opportunity Index. The Department may refer to locations qualifying for points under this scoring item as high opportunity areas in some materials. A Development is eligible for a maximum of seven (7) opportunity index points.

(A) A proposed Development is eligible for up to two (2) opportunity index points if it is located entirely within a census tract with a poverty rate of less than the greater of 20% or the median poverty rate for the region and meets the requirements in (i) or (ii) below.

(i) The Development Site is located entirely within a census tract that has a poverty rate of less than the greater of 20% or the median poverty rate for the region and a median household income rate in the two highest quartiles within the uniform service region. (2 points)

(ii) The Development Site is located entirely within a census tract that has a poverty rate of less than the greater of 20% or the median poverty rate for the region, with a median household income in the third quartile within the region, and is contiguous to a census tract in the first or second quartile, without physical barriers such as highways or rivers between, and the Development Site is no more than 2 miles from the boundary between the census tracts. For purposes of this scoring item, a highway is a limited-access road with a speed limit of 50 miles per hour or more; and, (1 point)

(B) An Application that meets the foregoing criteria may qualify for additional points for any one or more of the following factors. Each amenity may be used only once for scoring purposes, unless allowed within the scoring item, regardless of the number of categories it fits. All members of the Applicant or Affiliates cannot have had an ownership position in the amenity or served on the board or staff of a nonprofit that owned or managed that amenity within the year preceding the Pre-Application Final Delivery Date. All amenities must be operational or have started Site Work at the Pre-Application Final Delivery Date. Any age restrictions associated with an amenity must positively correspond to the target population of the proposed Development.:

(i) For Developments located in an Urban Area (other than Applicants competing in the USDA Set-Aside), an Application may qualify to receive points through a combination of requirements in subclauses (I) through (XIV) of this clause.

(I) The Development Site is located on a route, with sidewalks for pedestrians, that is 1/2 mile or less from the entrance to a public park with a playground. The entirety of the sidewalk route must consist of smooth hard surfaces, curb ramps, and marked pedestrian crossings when traversing a street. (1 point)

(II) The Development Site is located on a route, with sidewalks for pedestrians, that is 1/2 mile or less from the entrance of a public transportation stop or station with a route schedule that provides regular service to employment and basic services. The entirety of the sidewalk route must consist of smooth hard surfaces, curb ramps, and marked pedestrian crossings when traversing a street. For purposes of this scoring item, regular is defined as scheduled service beyond 8 a.m. to 5 p.m., plus weekend service (both Saturday and Sunday). (1 point)

(III) The Development Site is located within 1 mile of a full-service grocery store. A full service grocery store is a store of sufficient size and volume to provide for the needs of the surrounding neighborhood including the proposed Development; and the space of the store is dedicated primarily to offering a wide variety of fresh, frozen, canned and prepared foods, including but not limited to a variety of fresh meats, poultry, and seafood; a wide selection of fresh produce including a selection of different fruits and vegetables; a selection of baked goods and a wide array of dairy products including cheeses, and a wide variety of household goods, paper goods and toiletry items. (1 point)

(IV) The Development Site is located within 1 mile of a pharmacy. For the purposes of this menu item only, the pharmacy may be claimed if it is within the same building as a grocery store. (1 point)

(V) The Development Site is located within 3 miles of a health-related facility, such as a full service hospital, community health center, minor emergency center, emergency room or urgent care facility. Physician offices and physician specialty offices are not considered in this category. (1 point)

(VI) The Development Site is within 2 miles of a center that is licensed by the Department of Family and Protective Services (“DFPS”) specifically to provide a school-age program or to provide a child care program for infants, toddlers, and/or pre-kindergarten. The Application must include evidence from DFPS that the center meets the above requirements. (1 point)

(VII) The Development Site is located in a census tract with a property crime rate of 26 per 1,000 persons or less as defined by neighborhoodscout.com, or local law enforcement data sources. If employing the latter source, the formula for determining the crime rate will include only data relevant to the census tract in which the Development Site is located. (1 point)

(VIII) The development Site is located within 1 mile of a public library that has indoor meeting space, physical books that can be checked out and that are of a general and wide-ranging subject matter, computers and internet access, and that is open 50 hours or more per week. The library must not be age or subject-restricted and must be at least partially funded with government funding. (1 point)

(IX) The Development Site is located within 5 miles of an accredited university or community college, as confirmed by the Texas Higher Education Coordination Board (“THECB”). To be considered a university for these purposes, the provider of higher education must have the authority to confer bachelor’s degrees. Two-year colleges are considered community colleges, and to be considered for these purposes must confer at least associate’s degrees. The university or community college must have a physical campus, where classes are regularly held for students pursuing their degrees, within the required distance; online-only institutions do not qualify under this item. (1 point)

(X) Development Site is located in a census tract where the percentage of adults age 25 and older with an Associate's Degree or higher is 27% or higher as tabulated by the 2011-2015 American Community Survey 5-year Estimate. (1 point)

(XI) Development Site is within 1 mile of an indoor recreation facility available to the public. Examples include a gym, health club, a bowling alley, a theater, or a municipal or county community center. (1 point)

(XII) Development Site is within 1 mile of an outdoor, dedicated, and permanent recreation facility available to the public. Examples include swimming pools or splash pads, tennis courts, golf courses, softball fields, or basketball courts. (1 point)

(XIII) Development Site is within 1 mile of community, civic or service organizations that provide regular and recurring substantive services available to the entire community (this could include religious organizations or organizations like the Kiwanis or Rotary Club as long as they make services available without regard to affiliation or membership). (1 point)

(XIV) Development Site is in the current service area of Meals on Wheels or similar nonprofit service that provides regular visits and meals to individuals in their homes. (1 point)

(ii) For Developments located in a Rural Area and any Application qualifying under the USDA set-aside, an Application may qualify to receive points through a combination of requirements in subclauses (I) through (XIII) of this clause.

(I) The Development Site is located within 4 miles of a full-service grocery store. A full service grocery store is a store of sufficient size and volume to provide for the needs of the surrounding neighborhood including the proposed Development; and the space of the store is dedicated primarily to offering a wide variety of fresh, frozen, canned and prepared foods, including but not limited to a variety of fresh meats, poultry, and seafood; a wide selection of fresh produce including a selection of different fruits and vegetables; a selection of baked goods and a wide array of dairy products including cheeses, and a wide variety of household goods, paper goods and toiletry items. (1 point)

(II) The Development Site is located within 4 miles of a pharmacy. For the purposes of this menu item only, the pharmacy may be claimed if it is within the same building as a grocery store. (1 point)

(III) The Development Site is located within 4 miles of health-related facility, such as a full service hospital, community health center, or minor emergency center. Physician offices and physician specialty offices are not considered in this category. (1 point)

(IV) The Development Site is located within 4 miles of a center that is licensed by the Department of Family and Protective Services (“DFPS”) specifically to provide a school-age program or to provide a child care program for infants, toddlers, and/or pre-kindergarten. The Application must include evidence from DFPS that the center meets the above requirements. (1 point)

(V) The Development Site is located in a census tract with a property crime rate 26 per 1,000 or less, as defined by neighborhoodscout.com, or local law enforcement data sources. If employing the latter source, the formula for determining the crime

rate will include only data relevant to the census tract in which the Development Site is located. (1 point)

(VI) The Development Site is located within 4 miles of a public library that has indoor meeting space, physical books that can be checked out and that are of a general and wide-ranging subject matter, computers and internet access, and that is open 40 hours or more per week. The library must not be age or subject-restricted and must be at least partially funded with government funding. (1 point)

(VII) The Development Site is located within 4 miles of a public park with a playground. (1 point)

(VIII) The Development Site is located within 15 miles of an accredited university or community college, as confirmed by the Texas Higher Education Coordination Board (“THECB”). To be considered a university for these purposes, the provider of higher education must have the authority to confer bachelor’s degrees. Two-year colleges are considered community colleges, and to be considered for these purposes must confer at least associate’s degrees. The university or community college must have a physical campus, where classes are regularly held for students pursuing their degrees, within the required distance; online-only institutions do not qualify under this item. (1 point)

(IX) Development Site is located in a census tract where the percentage of adults age 25 and older with an Associate’s Degree or higher is 27% or higher. (1 point)

(X) Development Site is within 3 miles of an indoor recreation facility available to the public. Examples include a gym, health club, a bowling alley, a theater, or a municipal or county community center. (1 point)

(XI) Development Site is within 3 miles of an outdoor, dedicated, and permanent recreation facility available to the public. Examples include swimming pools or splash pads, tennis courts, golf courses, softball fields, or basketball courts. (1 point)

(XII) Development Site is within 3 miles of community, civic or service organizations that provide regular and recurring substantive services available to the entire community (this could include religious organizations or organizations like the Kiwanis or Rotary Club as long as they make services available without regard to affiliation or membership). (1 point)

(XIII) Development Site is in the current service area of Meals on Wheels or similar nonprofit service that provides regular visits and meals to individuals in their homes. (1 point)

(5) Underserved Area. (§§2306.6725(b)(2); 2306.127(3), 42(m)(1)(C)(ii)) An Application may qualify to receive up to five (5) points if the Development Site is located in one of the areas described in subparagraphs (A) - (E) of this paragraph, and the Application contains evidence substantiating qualification for the points. If an Application qualifies for points under paragraph §11.9(c)(4) of this subsection then the Application is not eligible for points under subparagraphs (A) and (B) of this paragraph. The Application must include evidence that the Development Site meets the requirements.

(A) The Development Site is located wholly or partially within the boundaries of a colonia as such boundaries are determined by the Office of the Attorney General and within 150 miles of the Rio Grande River border. For purposes of this scoring item, the colonia must lack water, wastewater, or electricity provided to all residents of the colonia at a level commensurate with the quality and quantity expected of a municipality and the proposed Development must make available any such missing water, wastewater, and electricity supply infrastructure physically within the borders of the colonia in a manner that would enable the current dwellings within the colonia to connect to such infrastructure (2 points);

(B) The Development Site is located entirely within the boundaries of an Economically Distressed Area (1 point);

(C) The Development Site is located entirely within a census tract that does not have a Development that was awarded less than 30 years ago according to the Department's property inventory tab of the Site Demographic Characteristics Report; (3 points);

(D) For areas not scoring points for (C) above, the Development Site is located entirely within a census tract that does not have a Development that was awarded less than 15 years ago according to the Department's property inventory tab of the Site Demographic Characteristics Report. (2 points);

(E) The Development Site is located entirely within a census tract whose boundaries are wholly within an incorporated area and the census tract itself and all of its contiguous census tracts do not have a Development that was awarded less than 15 years ago according to the Department's property inventory tab of the Site Demographic Characteristics Report. This item will apply in Places with a population of 150,000 or more, and will not apply in the At-Risk Set-Aside (5 points).

(6) Tenant Populations with Special Housing Needs. (§42(m)(1)(C)(v)) An Application may qualify to receive two (2) points by serving Tenants with Special Housing Needs. Points will be awarded as described in subparagraphs (A) - (C) of this paragraph. If pursuing these points, Applicants must try to score first with subparagraph (A) and then subparagraph (B), unless the Applicant can establish its lack of legal authority to commit Section 811 PRA Program units in a Development. Subparagraphs (A) and (B) pertain to the requirements of the Section 811 Project Rental Assistance Program ("Section 811 PRA Program") (10 TAC Chapter 8). Only if an Applicant or Affiliate cannot meet the requirements of subparagraphs (A) or (B) may an Application qualify for subparagraph (C).

(A) An Applicant or Affiliate that Owns or Controls an Existing Development that is eligible to participate in the Department's Section 811 Project Rental Assistance Program ("Section 811 PRA Program") must do so in order to receive two (2) points. In order to qualify for points, the Existing Development must commit to the Section 811 PRA Program at minimum 10 Section 811 PRA Program Units, unless the Integrated Housing Rule, 10 TAC §1.15, or the 811 Program Rental Assistance Rule ("811 Rule"), 10 TAC Chapter 8, limits the Existing Development to fewer than 10 Section 811 PRA Program Units. The same Section 811 PRA Program Units cannot be used to qualify for points in more than one HTC Application. The Applicant or Affiliate will comply with the requirements of 10 TAC Chapter 8.

(B) An Applicant or Affiliate that does not meet the Existing Development requirements of 10 TAC Chapter 8 but still meets the requirements of 10 TAC Chapter 8.3 is eligible to receive two (2) points by committing Units in the proposed Development to participate in the Department's Section 811 PRA Program. In order to be eligible for points, Applicants must commit at least 10 Section 811 PRA Program Units in the proposed Development for participation in the Section 811 PRA Program unless the Integrated Housing Rule, 10 TAC §1.15, or the 811 Program Rental Assistance Rule ("811 Rule"), 10 TAC Chapter 8, limits the Development to fewer than 10 Section 811 PRA Program Units. The same Section 811 PRA Program Units cannot be used to qualify for points in more than one HTC Application. The Applicant will comply with the requirements of 10 TAC Chapter 8.

(C) Applications that are unable to meet the requirements of subparagraphs (A) or (B) of this paragraph may qualify for two (2) points by meeting the requirements of this subparagraph, (C). In order to qualify for points, Applicants must agree to set-aside at least 5 percent of the total Units for Persons with Special Needs. The units identified for this scoring item may not be the same units identified for Section 811 Project Rental Assistance Demonstration program. For purposes of this subparagraph, Persons with Special Needs is defined as households where one individual has alcohol and/or drug addictions, Colonia resident, Persons with Disabilities, Violence Against Women Act Protections (domestic violence, dating violence, sexual assault, and stalking), persons with HIV/AIDS, homeless populations, veterans, wounded warriors (as defined by the Caring for Wounded Warriors Act of 2008), and farmworkers. Throughout the Compliance Period, unless otherwise permitted by the Department, the Development Owner agrees to affirmatively market Units to Persons with Special Needs. In addition, the Department will require an initial minimum twelve-month period during which Units must either be occupied by Persons with Special Needs or held vacant, unless the units receive HOME funds from any source. After the initial twelve-month period, the Development Owner will no longer be required to hold Units vacant for Persons with Special Needs, but will be required to continue to specifically market Units to Persons with Special Needs.

(7) Proximity to the Urban Core. A Development in a Place, as defined by the US Census Bureau, with a population over 200,000 may qualify for points under this item. The Development Site must be located within 4 miles of the main municipal government administration building if the population of the Place is 500,000 or more, or within 2 miles of the main municipal government administration building if the population of the city is 200,000 - 499,999. The main municipal government administration building will be determined by the location of regularly scheduled municipal governing body meetings. Distances are measured from the nearest property boundaries, not inclusive of non-contiguous parking areas. This scoring item will not apply to Applications under the At-Risk Set-Aside. (5 points)

(8) Readiness to proceed in disaster impacted counties. Application for a proposed development, located in a county declared by the Federal Emergency Management Agency to be eligible for individual assistance within the year proceeding the Full Application Delivery Date, that provides evidence they will close all financing and fully execute the construction contract on or before the last business day of October. Evidence may include, but is not limited to, loan or equity commitments with evidence of completed due diligence, permit-ready architectural plans, and construction contracts or permits. Applications must include evidence that appropriate zoning will be in place at award. The Board cannot and will not waive the deadline and will not consider waiver under its general rule regarding waivers. Failure to close all financing and

provide evidence of an executed construction contract by the October deadline will result in penalty under 10 TAC §11.9(f), as determined solely by the Board. (5 points)

**(d) Criteria promoting community support and engagement.**

(1) Local Government Support. (§2306.6710(b)(1)(B)) An Application may qualify for up to seventeen (17) points for a resolution or resolutions voted on and adopted by the bodies reflected in subparagraphs (A) - (C) of this paragraph, as applicable. The resolution(s) must be dated prior to Final Input from Elected Officials Delivery Date and must be submitted to the Department no later than the Final Input from Elected Officials Delivery Date as identified in §11.2 of this chapter. Such resolution(s) must specifically identify the Development whether by legal description, address, Development name, Application number or other verifiable method. In providing a resolution a municipality or county should consult its own staff and legal counsel as to whether such resolution will be consistent with Fair Housing laws as they may apply, including, as applicable, consistency with any Fair Housing Activity Statement-Texas (“FHAST”) form on file, any current Analysis of Impediments to Fair Housing Choice, or any current plans such as one year action plans or five year consolidated plans for HUD block grant funds, such as HOME or CDBG funds. Resolutions received by the Department setting forth that the municipality and/or county objects to or opposes the Application or Development will result in zero points awarded to the Application for that Governing Body. Such resolutions will be added to the Application posted on the Department’s website. Once a resolution is submitted to the Department it may not be changed or withdrawn. For an Application with a proposed Development Site that, at the time of the initial filing of the Application, is:

(A) Within a municipality, the Application will receive:

- (i) seventeen (17) points for a resolution from the Governing Body of that municipality expressly setting forth that the municipality supports the Application or Development; or
- (ii) fourteen (14) points for a resolution from the Governing Body of that municipality expressly setting forth that the municipality has no objection to the Application or Development.

(B) Within the extraterritorial jurisdiction of a municipality, the Application may receive points under clause (i) or (ii) of this subparagraph and under clause (iii) or (iv) of this subparagraph:

- (i) eight and one-half (8.5) points for a resolution from the Governing Body of that municipality expressly setting forth that the municipality supports the Application or Development; or
- (ii) seven (7) points for a resolution from the Governing Body of that municipality expressly setting forth that the municipality has no objection to the Application or Development; and
- (iii) eight and one-half (8.5) points for a resolution from the Governing Body of that county expressly setting forth that the county supports the Application or Development; or

(iv) seven (7) points for a resolution from the Governing Body of that county expressly setting forth that the county has no objection to the Application or Development.

(C) Within a county and not within a municipality or the extraterritorial jurisdiction of a municipality:

(i) seventeen (17) points for a resolution from the Governing Body of that county expressly setting forth that the county supports the Application or Development; or

(ii) fourteen (14) points for a resolution from the Governing Body of that county expressly setting forth that the county has no objection to the Application or Development.

(2) Commitment of Development Funding by Local Political Subdivision. (§2306.6725(a)(5)) An Application may receive one (1) point for a commitment of Development funding from the city (if located in a city) or county in which the Development Site is located. The commitment of Development funding must be reflected in the Application as a financial benefit to the Development, i.e. reported as a source of funds on the Sources and Uses Form and/or reflected in a lower cost in the Development Cost Schedule, such as notation of a reduction in building permits and related costs. Documentation must include a letter from an official of the municipality, county, or other instrumentality with jurisdiction over the proposed Development stating they will provide a loan, grant, reduced fees or contribution of other value that equals \$500 or more for Applications located in Urban subregions or \$250 or more for Applications located in Rural subregions for the benefit of the Development. The letter must describe the value of the contribution, the form of the contribution, e.g. reduced fees or gap funding, and any caveats to delivering the contribution. Once a letter is submitted to the Department it may not be changed or withdrawn.

(3) Declared Disaster Area. (§2306.6710(b)(1)(H)) An Application may receive ten (10) points if at the time of Application submission or at any time within the two-year period preceding the date of submission, the Development Site is located in an area declared to be a disaster area under the Tex Gov't Code, §418.014.

~~(3) Declared Disaster Area. (§2306.6710(b)(1)(H)) An Application may receive ten (10) points if the Development Site is located in an area declared to be a disaster area under Tex. Gov't Code §418.014 at the time of Full Application Delivery Date or at any time within the two-year period preceding the Full Application Delivery Date.~~

(4) Quantifiable Community Participation. (§2306.6710(b)(1)(I); §2306.6725(a)(2)) An Application may qualify for up to nine (9) points for written statements from a Neighborhood Organization. In order for the statement to qualify for review, the Neighborhood Organization must have been in current, valid existence with boundaries that contain the entire Development Site as of the Pre-Application Final Delivery Date. In addition, the Neighborhood Organization must be on record with the Secretary of State or county in which the Development Site is located. Once a letter is submitted to the Department it may not be changed or withdrawn. The written statement must meet all of the requirements in subparagraph (A) of this paragraph. Letters received by the Department setting forth that the eligible Neighborhood Organization objects to or opposes the Application or Development will be added to the Application posted on the Department's website. Written statements from the Neighborhood Organizations included in an Application and not received by the Department from the Neighborhood Organization will not be scored but will be counted as public comment.



(A) Statement Requirements. If an organization cannot make the following affirmative certifications or statements then the organization will not be considered a Neighborhood Organization for purposes of this paragraph.

(i) the Neighborhood Organization's name, a written description and map of the organization's boundaries, signatures and contact information (phone, email and mailing address) of at least two individual members with authority to sign on behalf of the organization;

(ii) certification that the boundaries of the Neighborhood Organization contain the entire Development Site and that the Neighborhood Organization meets the definition pursuant to Tex. Gov't Code §2306.004(23-a) and includes at least two separate residential households;

(iii) certification that no person required to be listed in accordance with Tex. Gov't Code §2306.6707 with respect to the Development to which the Application requiring their listing relates participated in any way in the deliberations of the Neighborhood Organization, including any votes taken;

(iv) certification that at least 80 percent of the current membership of the Neighborhood Organization consists of homeowners and/or tenants living within the boundaries of the Neighborhood Organization; and

(v) an explicit expression of support, opposition, or neutrality. Any expression of opposition must be accompanied with at least one reason forming the basis of that opposition. A Neighborhood Organization should be prepared to provide additional information with regard to opposition.

(B) Technical Assistance. For purposes of this paragraph, if and only if there is no Neighborhood Organization already in existence or on record, the Applicant, Development Owner, or Developer is allowed to provide technical assistance in the creation of and/or placing on record of a Neighborhood Organization. Technical assistance is limited to:

(i) the use of a facsimile, copy machine/copying, email and accommodations at public meetings;

(ii) assistance in completing the QCP Neighborhood Information Packet, providing boundary maps and assisting in the Administrative Deficiency process; and

(iii) presentation of information and response to questions at duly held meetings where such matter is considered.

(C) Point Values for Quantifiable Community Participation. An Application may receive points based on the values in clauses (i) - (vi) of this subparagraph. Points will not be cumulative. Where more than one written statement is received for an Application, the average of all statements received in accordance with this subparagraph will be assessed and awarded.

(i) nine (9) points for explicit support from a Neighborhood Organization that, during at least one of the three prior Application Rounds, provided a written statement that qualified as Quantifiable Community Participation opposing any Competitive Housing Tax Credit Application and whose boundaries remain unchanged;

(ii) eight (8) points for explicitly stated support from a Neighborhood Organization;

(iii) six (6) points for explicit neutrality from a Neighborhood Organization that, during at least one of the three prior Application Rounds provided a written statement, that qualified as Quantifiable Community Participation opposing any Competitive Housing Tax Credit Application and whose boundaries remain unchanged;

(iv) four (4) points for statements of neutrality from a Neighborhood Organization or statements not explicitly stating support or opposition, or an existing Neighborhood Organization provides no statement of either support, opposition or neutrality, which will be viewed as the equivalent of neutrality or lack of objection;

(v) four (4) points for areas where no Neighborhood Organization is in existence, equating to neutrality or lack of objection, or where the Neighborhood Organization did not meet the explicit requirements of this section; or

(vi) zero (0) points for statements of opposition meeting the requirements of this subsection.

(D) Challenges to opposition. Any written statement from a Neighborhood Organization expressing opposition to an Application may be challenged if it is contrary to findings or determinations, including zoning determinations, of a municipality, county, school district, or other local Governmental Entity having jurisdiction or oversight over the finding or determination. If any such statement is challenged, the challenger must declare the basis for the challenge and submit such challenge by the Challenges to Neighborhood Organization Opposition Delivery Date May 1, 2018. The Neighborhood Organization expressing opposition will be given seven (7) calendar days to provide any information related to the issue of whether their assertions are contrary to the findings or determinations of a local Governmental Entity. All such materials and the analysis of the Department's staff will be provided to a fact finder, chosen by the Department, for review and a determination of the issue presented by this subsection. The fact finder will not make determinations as to the accuracy of the statements presented, but only with regard to whether the statements are contrary to findings or determinations of a local Governmental Entity. The fact finder's determination will be final and may not be waived or appealed.

(5) Community Support from State Representative. (§2306.6710(b)(1)(J); §2306.6725(a)(2)) Applications may receive up to eight (8) points or have deducted up to eight (8) points for this scoring item. To qualify under this paragraph letters must be on the State Representative's letterhead, be signed by the State Representative, identify the specific Development and express whether the letter conveys support, neutrality, or opposition. This documentation will be accepted with the Application or through delivery to the Department from the Applicant or the State Representative and must be submitted no later than the Final Input from Elected Officials Delivery Date as identified in §11.2 of this chapter. Letters received by the Department setting forth that the State Representative objects to or opposes the Application or Development will

be added to the Application posted on the Department's website. Once a letter is submitted to the Department it may not be changed or withdrawn. Therefore, it is encouraged that letters not be submitted well in advance of the specified deadline in order to facilitate consideration of all constituent comment and other relevant input on the proposed Development. State Representatives to be considered are those in office at the time the letter is submitted and whose district boundaries include the Development Site. If the office is vacant, the Application will be considered to have received a neutral letter. Neutral letters, letters of opposition, or letters that do not specifically refer to the Development will receive zero (0) points. A letter from a state representative expressing the level of community support may be expressly based on the representative's understanding or assessments of indications of support by others, such as local government officials, constituents, and/or other applicable representatives of the community.

(6) Input from Community Organizations. (§2306.6725(a)(2)) Where, at the time of Application, the Development Site does not fall within the boundaries of any qualifying Neighborhood Organization, then, in order to ascertain if there is community support, an Application may receive up to four (4) points for letters that qualify for points under subparagraphs (A), (B), and/or (C) of this paragraph. No more than four (4) points will be awarded under this point item under any circumstances. All letters of support must be submitted within the Application. Once a letter is submitted to the Department it may not be changed or withdrawn. Should an Applicant elect this option and the Application receives letters in opposition, then one (1) point will be subtracted from the score under this paragraph for each letter in opposition, provided that the letter is from an organization that would otherwise qualify under this paragraph. However, at no time will the Application receive a score lower than zero (0) for this item. Letters received by the Department setting forth that the community organization objects to or opposes the Application or Development will be added to the Application posted on the Department's website.

(A) An Application may receive two (2) points for each letter of support submitted from a community or civic organization that serves the community in which the Development Site is located. Letters of support must identify the specific Development and must state support of the specific Development at the proposed location. To qualify, the organization must be qualified as tax exempt and have as a primary (not ancillary or secondary) purpose the overall betterment, development, or improvement of the community as a whole or of a major aspect of the community such as improvement of schools, fire protection, law enforcement, city-wide transit, flood mitigation, or the like. The Applicant must provide evidence that the community or civic organization remains in good standing by providing evidence from a federal or state government database confirming that the exempt status continues. An Organization must also provide evidence of its participation in the community in which the Development Site is located including, but not limited to, a listing of services and/or members, brochures, annual reports, etc. Letters of support from organizations that cannot provide reasonable evidence that they are active in the area that includes the location of the Development Site will not be awarded points. For purposes of this subparagraph, community and civic organizations do not include neighborhood organizations, governmental entities (excluding Special Management Districts as described in subparagraph C), or taxing entities.

(B) An Application may receive two (2) points for a letter of support from a property owners association created for a master planned community whose boundaries include the Development Site and that does not meet the requirements of a Neighborhood Organization for the purpose of awarding points under paragraph (4) of this subsection.

(C) An Application may receive two (2) points for a letter of support from a Special Management District whose boundaries, as of the Full Application Delivery Date as identified in §11.2 of this chapter (relating to Program Calendar for Competitive Housing Tax Credits), include the Development Site.

(D) Input that evidences unlawful discrimination against classes of persons protected by Fair Housing law or the scoring of which the Department determines to be contrary to the Department's efforts to affirmatively further fair housing will not be considered. If the Department receives input that could reasonably be suspected to implicate issues of non-compliance under the Fair Housing Act, staff will refer the matter to the Texas Workforce Commission for investigation, but such referral will not, standing alone, cause staff or the Department to terminate the Application. Staff will report all such referrals to the Board and summarize the status of any such referrals in any recommendations.

(7) Concerted Revitalization Plan. An Application may qualify for points under this paragraph only if no points are elected under subsection (c)(4) of this section, related to Opportunity Index.

(A) For Developments located in an Urban Area:

(i) An Application may qualify to receive points if the Development Site is located in a distinct area that was once vital and has lapsed into a situation requiring concerted revitalization, and where a concerted revitalization plan has been developed and executed. The area targeted for revitalization must be larger than the assisted housing footprint and should be a neighborhood or small group of contiguous neighborhoods with common attributes and problems. The Application must include a copy of the plan or a link to the online plan and a description of where specific information required below can be found in the plan. The concerted revitalization plan, which may be a Tax Increment Reinvestment Zone ("TIRZ") or Tax Increment Finance ("TIF") or similar plan, must meet the criteria described in subclauses (I) - (V) of this clause:

(I) The concerted revitalization plan must have been adopted by the municipality or county in which the Development Site is located. The resolution adopting the plan, or if development of the plan and budget were delegated the resolution of delegation and other evidence in the form of certifications by authorized persons confirming the adoption of the plan and budget, must be submitted with the application.

(II) The problems in the revitalization area must be identified through a process in which affected local residents had an opportunity to express their views on problems facing the area, and how those problems should be addressed and prioritized. These problems may include the following:

(-a-) long-term disinvestment, such as significant presence of residential and/or commercial blight, streets infrastructure neglect such as inadequate drainage, and/or sidewalks in significant disrepair;

(-b-) declining quality of life for area residents, such as high levels of violent crime, property crime, gang activity, or other significant criminal matters such as the manufacture or distribution of illegal substances or overt illegal activities;

(III) Staff will review the target area for presence of the problems identified in the plan and for targeted efforts within the plan to address those problems. In addition, but not in lieu of, such a plan may be augmented with targeted efforts to promote a more vital local economy and a more desirable neighborhood, including but not limited to:

- (-a-) creation of needed affordable housing by improvement of existing affordable housing that is in need of replacement or major renovation;
- (-b-) attracting private sector development of housing and/or business;
- (-c-) developing health care facilities;
- (-d-) providing public transportation;
- (-e-) developing significant recreational facilities; and/or
- (-f-) improving under-performing schools.

(IV) The adopted plan must have sufficient, documented and committed funding to accomplish its purposes on its established timetable. This funding must have been flowing in accordance with the plan, such that the problems identified within the plan will have been sufficiently mitigated and addressed prior to the Development being placed into service.

(V) The plan must be current at the time of Application and must officially continue for a minimum of three years thereafter.

(ii) Up to seven (7) points will be awarded based on:

(I) Applications will receive four (4) points for a letter from the appropriate local official providing documentation of measurable improvements within the revitalization area based on the target efforts outlined in the plan. The letter must also discuss how the improvements will lead to an appropriate area for the placement of housing; and

(II) Applications may receive (2) points in addition to those under subclause (I) of this clause if the Development is explicitly identified in a resolution by the municipality, or county as contributing more than any other to the concerted revitalization efforts of the municipality or county (as applicable). A municipality or county may only identify one Development per CRP area during each Application Round for the additional points under this subclause, unless the concerted revitalization plan includes more than one distinct area within the city or county, in which case a resolution may be provided for each Development in its respective area. The resolution from the Governing Body of the municipality or county that approved the plan is required to be submitted in the Application. If multiple Applications submit resolutions under this subclause from the same Governing Body for the same CRP area, none of the Applications shall be eligible for the additional points, unless the resolutions address the respective and distinct areas described in the plan; and

(III) Applications will receive (1) point in addition to those under subclause (I) and (II) if the development is in a location that would score at least 4 points under Opportunity Index, §11.9(c)(4)(B), except for the criteria found in §11.9(c)(4)(A) and subparagraphs §11.9(c)(4)(A)(i) and §11.9(c)(4)(A)(ii).

(B) For Developments located in a Rural Area.

(i) Applications will receive 4 points for the rehabilitation or demolition and reconstruction of a development in a rural area that has been leased at 85% or greater for the six months preceding Application by low income households and which was initially constructed 25 or more years prior to Application submission as either public housing or as affordable housing with support from USDA, HUD, the HOME program, or the CDBG program. The occupancy percentage will not include units that cannot be occupied due to needed repairs, as confirmed by the PCA or CNA. Demolition and relocation of units must be determined locally to be necessary to comply with the Affirmatively Furthering Fair Housing Rule, or if necessary to create an acceptable distance from Undesirable Site Features or Undesirable Neighborhood Characteristics.

(ii) Applications may receive (2) points in addition to those under clause (i) of this subparagraph if the Development is explicitly identified in a resolution by the municipality (or county if the Development Site is completely outside of a city) as contributing more than any other to the concerted revitalization efforts of the municipality or county (as applicable). Where a Development Site crosses jurisdictional boundaries, resolutions from all applicable governing bodies must be submitted. A municipality or county may only identify one single Development during each Application Round for each specific area to be eligible for the additional points under this subclause. If multiple Applications submit resolutions under this subclause from the same Governing Body for a specific area described in the plan, none of the Applications shall be eligible for the additional points; and

(iii) Applications may receive (1) additional point if the development is in a location that would score at least 4 points under Opportunity Index, §11.9(c)(4)(B), except for the criteria found in §11.9(c)(4)(A) and subparagraphs §11.9(c)(4)(A)(i) and §11.9(c)(4)(A)(ii)..

**(e) Criteria promoting the efficient use of limited resources and applicant accountability.**

(1) Financial Feasibility. (§2306.6710(b)(1)(A)) An Application may qualify to receive a maximum of eighteen (18) points for this item. To qualify for points, a 15-year pro forma itemizing all projected income including Unit rental rate assumptions, operating expenses and debt service, and specifying the underlying growth assumptions and reflecting a minimum must-pay debt coverage ratio of 1.15 for each year must be submitted. The pro forma must include the signature and contact information evidencing that it has been reviewed and found to be acceptable by an authorized representative of a proposed Third Party construction or permanent lender. In addition to the signed pro forma, a lender approval letter must be submitted. An acceptable form of lender approval letter may be obtained in the Uniform Multifamily Application Templates. If the letter evidences review of the Development alone it will receive sixteen (16) points. If the letter evidences review of the Development and the Principals, it will receive eighteen (18) points.

(2) Cost of Development per Square Foot. (§2306.6710(b)(1)(F); §42(m)(1)(C)(iii)) An Application may qualify to receive up to twelve (12) points based on either the Eligible Building Cost or the Eligible Hard Costs per square foot of the proposed Development voluntarily included in eligible basis as originally submitted in the Application. For purposes of this-scoring item, Eligible Building Costs will be defined as Building Costs includable in Eligible Basis for the purposes of determining a Housing Credit Allocation. Eligible Building Costs will exclude structured parking or commercial space that is not included in Eligible Basis, and Eligible Hard Costs will include general contractor overhead, profit, and general requirements. Structured parking or commercial space costs must be supported by a cost estimate from a Third Party General Contractor or subcontractor with experience in structured parking or commercial construction, as applicable. The square footage used will be the Net Rentable Area (NRA). The calculations will be based on the cost listed in the Development Cost Schedule and NRA shown in the Rent Schedule. If the proposed Development is a Supportive Housing Development, the NRA will include common area up to 50 square feet per Unit.

(A) A high cost development is a Development that meets one of the following conditions:

- (i) the Development is elevator served, meaning it is either a Elderly Development with an elevator or a Development with one or more buildings any of which have elevators serving four or more floors;
- (ii) the Development is more than 75 percent single family design;
- (iii) the Development is Supportive Housing; or
- (iv) the Development Site qualifies for a minimum of five (5) points under subsection (c)(4) of this section, related to Opportunity Index, and is located in an Urban Area.

(B) Applications proposing New Construction or Reconstruction will be eligible for twelve (12) points if one of the following conditions is met:

- (i) The voluntary Eligible Building Cost per square foot is less than \$72.80 per square foot;
- (ii) The voluntary Eligible Building Cost per square foot is less than \$78 per square foot, and the Development meets the definition of a high cost development;
- (iii) The voluntary Eligible Hard Cost per square foot is less than \$93.60 per square foot; or
- (iv) The voluntary Eligible Hard Cost per square foot is less than \$104 per square foot, and the Development meets the definition of high cost development.

(C) Applications proposing New Construction or Reconstruction will be eligible for eleven (11) points if one of the following conditions is met:

- (i) The voluntary Eligible Building Cost per square foot is less than \$78 per square foot;

- (ii) The voluntary Eligible Building Cost per square foot is less than \$83.20 per square foot, and the Development meets the definition of a high cost development;
- (iii) The voluntary Eligible Hard Cost per square foot is less than \$98.80 per square foot;  
or
- (iv) The voluntary Eligible Hard Cost per square foot is less than \$109.20 per square foot, and the Development meets the definition of high cost development.

(D) Applications proposing New Construction or Reconstruction will be eligible for ten (10) points if one of the following conditions is met:

- (i) The voluntary Eligible Building Cost is less than \$93.60 per square foot; or
- (ii) The voluntary Eligible Hard Cost is less than \$114.40 per square foot.

(E) Applications proposing Adaptive Reuse or Rehabilitation (excluding Reconstruction) will be eligible for points if one of the following conditions is met:

- (i) Twelve (12) points for Applications which include voluntary Eligible Hard Costs plus acquisition costs included in Eligible Basis that are less than \$104 per square foot;
- (ii) Twelve (12) points for Applications which include voluntary Eligible Hard Costs plus acquisition costs included in Eligible Basis that are less than \$135.20 per square foot, located in an Urban Area, and that qualify for 5 or 7 points under subsection (c)(4) of this section, related to Opportunity Index; or
- (iii) Eleven (11) points for Applications which include voluntary Eligible Hard Costs plus acquisition costs included in Eligible Basis that are less than \$135.20 per square foot.

(3) Pre-application Participation. (§2306.6704) An Application may qualify to receive up to six (6) points provided a pre-application was submitted by the pre-application Final Delivery Date. Applications that meet the requirements described in subparagraphs (A) - (G) of this paragraph will qualify for six (6) points:

- (A) The total number of Units does not increase by more than ten (10) percent from pre-application to Application;
- (B) The designation of the proposed Development as Rural or Urban remains the same;
- (C) The proposed Development serves the same Target Population;
- (D) The pre-application and Application are participating in the same set-asides (At-Risk, USDA, Non-Profit, and/or Rural);
- (E) The Application final score (inclusive of only scoring items reflected on the self score form) does not vary by more than four (4) points from what was reflected in the pre-application self score;



(F) The Development Site at Application is at least in part the Development Site at pre-application, and the census tract number listed at pre-application is the same at Application. The site at full Application may not require notification to any person or entity not required to have been notified at pre-application;

(G) The Development Site does not have the following Undesirable Neighborhood Characteristics as described in 10 TAC §10.101(a)(3) that were not disclosed with the pre-application:

(i) The Development Site is located in a census tract or within 1,000 feet of any census tract in an Urban Area and the rate of Part I violent crime is greater than 18 per 1,000 persons (annually) as reported on neighborhoodscout.com.

(ii) The Development Site is located within the attendance zones of an elementary school, a middle school or a high school that does not have a Met Standard rating by the Texas Education Agency.

(H) The pre-application met all applicable requirements.

(4) Leveraging of Private, State, and Federal Resources. (§2306.6725(a)(3))

(A) An Application may qualify to receive up to three (3) points if at least five (5) percent of the total Units are restricted to serve households at or below 30 percent of AMGI (restrictions elected under other point items may count) and the Housing Tax Credit funding request for the proposed Development meet one of the levels described in clauses (i) - (iv) of this subparagraph:

(i) the Development leverages CDBG Disaster Recovery, HOPE VI, RAD, or Choice Neighborhoods funding and the Housing Tax Credit Funding Request is less than 9 percent of the Total Housing Development Cost (3 points). The Application must include a commitment of such funding; or

(ii) If the Housing Tax Credit funding request is less than eight (8) percent of the Total Housing Development Cost (3 points); or

(iii) If the Housing Tax Credit funding request is less than nine (9) percent of the Total Housing Development Cost (2 points); or

(iv) If the Housing Tax Credit funding request is less than ten (10) percent of the Total Housing Development Cost (1 point).

(B) The calculation of the percentages stated in subparagraph (A) of this paragraph will be based strictly on the figures listed in the Funding Request and Development Cost Schedule. Should staff issue an Administrative Deficiency that requires a change in either form, then the calculation will be performed again and the score adjusted, as necessary. However, points may not increase based on changes to the Application. In order to be eligible for points, no more than 50 percent of the developer fee can be deferred. Where costs or financing change after completion of underwriting or award (whichever occurs later), the points attributed to an Application under this scoring item will not be reassessed unless there is clear evidence that the information in the Application was intentionally misleading or incorrect.

(5) Extended Affordability. (§§2306.6725(a)(5); 2306.111(g)(3)(C); 2306.185(a)(1) and (c); 2306.6710(e)(2); and 42(m)(1)(B)(ii)(II)) In accordance with the Code, each Development is required to maintain its affordability for a 15-year Compliance Period and, subject to certain exceptions, an additional 15-year Extended Use Period. Development Owners that agree to extend the Affordability Period for a Development to thirty-five (35) years total may receive two (2) points.

(6) Historic Preservation. (§2306.6725(a)(5)) At least seventy-five percent of the residential units shall reside within the Certified Historic Structure and the Development must reasonably be expected to qualify to receive and document receipt of historic tax credits by issuance of Forms 8609. The Application must include either documentation from the Texas Historical Commission that the property is currently a Certified Historic Structure, or documentation determining preliminary eligibility for Certified Historic Structure status (5 points).

(7) Right of First Refusal. (§2306.6725(b)(1); §42(m)(1)(C)(viii)) An Application may qualify to receive (1 point) for Development Owners that will agree to provide a right of first refusal to purchase the Development upon or following the end of the Compliance Period in accordance with Tex Gov't Code, §2306.6726 and the Department's rules including §10.407 of this title (relating to Right of First Refusal) and §10.408 of this title (relating to Qualified Contract Requirements).

(8) Funding Request Amount. An Application may qualify to receive one (1) point if the Application reflects a Funding Request of Housing Tax Credits, as identified in the original Application submission, of no more than 100% of the amount available within the subregion or set-aside as determined by the application of the regional allocation formula on or before December 1, 2017.

#### **(f) Factors Affecting Eligibility in the 2019 Application Round**

Staff may recommend to the Board and the Board may find that an Applicant or Affiliate should be ineligible to compete in the 2019 Application Round or that it should be assigned a penalty deduction of one (1) point for each submitted Application (Tex. Gov't Code 2306.6710(b)(2)) because it made a deduction of up to five (5) points for any of the items listed in paragraphs (1) – (5) of this subsection, unless the person approving the extension (the Board or Executive Director, as applicable) makes an affirmative finding setting forth that the facts which gave rise to the need for the extension were beyond the reasonable control of the Applicant and could not have been reasonably anticipated. Any such matter to be presented for final determination of deduction by the Board must include notice from the Department to the affected party not less than fourteen (14) days prior to the scheduled Board meeting. The Executive Director may, but is not required, to issue a formal notice after disclosure if it is determined that the matter does not warrant point deductions. (§2306.6710(b)(2))

(1) If the Applicant or Affiliate failed to meet the original Carryover submission or 10 percent Test deadline(s) or has requested an extension of the Carryover submission deadline, the 10 percent Test deadline (relating to either submission or expenditure).

(2) If the Applicant or Affiliate failed to meet the commitment or expenditure requirements of a HOME or National Housing Trust Fund award from the Department.

(3) If the Developer or Principal of the Applicant violates the Adherence to Obligations.

(4) Any deductions assessed by the Board for paragraph (1) or (2) of this subsection based on a Housing Tax Credit Commitment from the preceding Application Round will be attributable to the Applicant or Affiliate of an Application submitted in the current Application Round.

(5) If the Applicant or Affiliate fails to meet the deadline to both close financing and provide evidence of an executed construction contract under 10 TAC §11.9(c)(8) related to construction in specific disaster counties.

#### **§11.10. Third Party Request for Administrative Deficiency for Competitive HTC Applications.**

The purpose of the Third Party Request for Administrative Deficiency ("RFAD") process is to allow an unrelated person or entity to bring new, material information about an Application to staff's attention. Such Person may request the staff to consider whether a matter in an Application in which the Person has no involvement should be the subject of an Administrative Deficiency. Staff will consider the request and proceed as it deems appropriate under the applicable rules including, if the Application in question is determined by staff to not be a priority Application, not reviewing the matter further. Requestors must provide, at the time of filing the challenge, all briefings, documentation, and other information that the requestor offers in support of the deficiency. A copy of the request and supporting information must be provided by the requestor directly to the Applicant at the same time it is provided to the Department. Requestors must provide sufficient credible evidence that, if confirmed, would substantiate the deficiency request. Assertions not accompanied by supporting documentation susceptible to confirmation will not be considered. Staff shall provide to the Board a written report summarizing each third party request for administrative deficiency and the manner in which it was addressed. Interested persons may provide testimony on this report before the Board takes any formal action to accept the report. The results of a RFAD may not be appealed by the Requestor. Information received after the RFAD deadline will not be considered by staff or presented to the Board.