

# Case No. 11-007Z

Conduct a Public Hearing to Consider/Discuss/Act on the Request by Francisco Gomez, for Approval of a Request to Rezone Approximately 0.35 Acres from “PD” – Planned Development District to “PD” – Planned Development District, Generally to Modify the Development Standards, Located on the Southwest Corner of Josephine Street and Kentucky Street.

# Location Map

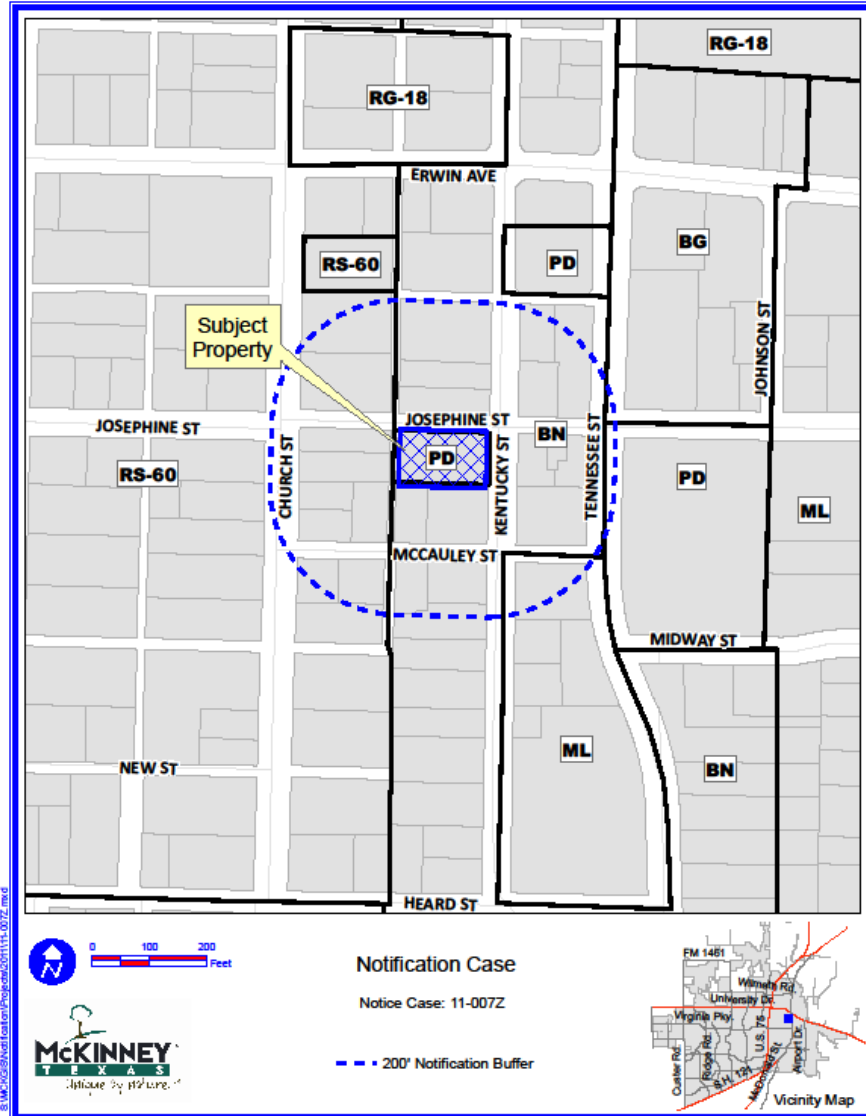

E:\MCKINNEY\Notices\Program\20111115\_007Z.mxd

DISCLAIMER: This map and information contained in it were developed exclusively for use by the City of McKinney. Any use or reliance on this map by anyone else is at that party's risk and without liability to the City of McKinney, its officials or employees for any discrepancies, errors, or omissions which may exist.



# Aerial Exhibit



E:\MCKINNEY\Aerial\Aerial\Project\201111\_007Z.mxd

DISCLAIMER: This map and information contained in it was developed exclusively for use by the City of McKinney. Any use or reliance on this map by anyone else is at that party's risk and without liability to the City of McKinney, its officials or employees for any discrepancies, errors, or omissions which may exist.



# Proposed Zoning Exhibit

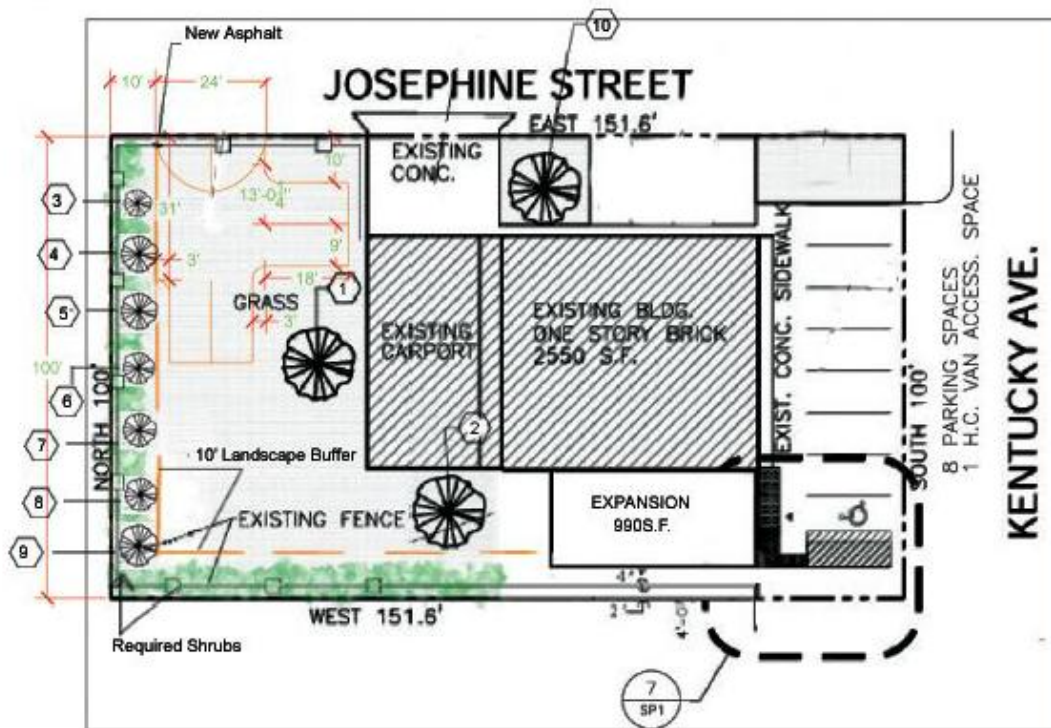

## AREA TABULATIONS

PROPERTY LOT SIZE 151.6FT x 100.0FT = 15,100 S.F.

EXISTING BUILDING AREA = 2550 S.F.

NEW ADDITION = 990 S.F.

TOTAL BUILDING AREA = 3,682 S.F.

TOTAL PERCENT COVERAGE = 25.7%

### PARKING

TOTAL PARKING REQUIRED = 12

TOTAL PARKING PROVIDED = 12

### LANDSCAPE AREA

GROUND COVER BERMUDA GRASS = 7,389 S.F.

### EXISTING TREES:

1. Pecan Tree 31"
2. Pecan Tree 24.5"
3. Hackberry Tree 15"
4. Hackberry Tree 14.5"
5. Chinkapin Oak Tree 9"
6. Bois D'arc Tree 7"
7. Hackberry Tree 2"
8. Bois D'arc Tree 8.5"
9. Hackberry Tree 6"
10. Pecan Tree 24"

### SHRUB ON-SITE

Nielle Stevens Holly

3' at time of planting

6' Ultimate height

3' on center

TOTAL LANDSCAPE COVERAGE = 48.9%

# Staff Recommendation

- Staff recommends approval of the zoning request as outlined in the Staff Report