

### McKINNEY LANDSCAPE ORDINANCE

STREET YARD	15% OF STREET YARD SHALL BE LANDSCAPED	
	REQUIRED	PROVIDED
	19,335 x 15% = 2,900	17,871 SF
SITE AREA	10% OF SITE SHALL BE LANDSCAPED	
	REQUIRED	PROVIDED
	639,553 SF X 10% = 63,955	111,412 SF (17%)
LANDSCAPE BUFFER	20' LANDSCAPE BUFFER AT STREET FRONTAGE	
	REQUIRED	PROVIDED
	20'	20'
WEST	RESIDENTIAL BUFFER TREES @ 1 PER 40 LF	
	REQUIRED	PROVIDED
	535 LF / 40 = 14 TREES	12 TREE CREDITS, 5 TREES
SOUTH	RESIDENTIAL BUFFER TREES @ 1 PER 40 LF	
	REQUIRED	PROVIDED
	913 LF / 40 = 23 TREES	15 TREE CREDITS, 11 TREES
STREET FRONTAGE TREES	1 TREE PER 40' OF STREET FRONTAGE	
	REQUIRED	PROVIDED
	F.M. 546 301 / 40 = 8 TREES	8 TREES
COUNTRY LANE	1 TREE PER 40' OF STREET FRONTAGE	
	REQUIRED	PROVIDED
	679 / 40 = 17 TREES	17 TREES
PARKING LOT TREES	ONE TREE PER 10 PARKING SPACES	
	REQUIRED	PROVIDED
	230 SPACES/10 = 23 TREES ALL PARKING SPACES WITHIN 65' OF TREE ISLAND/TREE AT END OF PARKING ROW	23 TREES
PARKING LOT SCREEN	MINIMUM 75% OF PARKING LOT IS SCREENED	
PARKING LOT BUFFER	5' PERIMETER PARKING LOT BUFFER	
MITIGATION TREES	REQUIRED	PROVIDED
	N/A	N/A

IRRIGATION SHALL BE PROVIDED TO ALL PLANTED AREAS. IRRIGATION SHALL HAVE AN ET BASED CONTROLLER. HYDROMULCH BERMUDA IN ALL DISTURBED AREAS AS IDENTIFIED ON GRADING AND EROSION CONTROL PLANS.

THE CONTRACTOR SHALL VERIFY WATER RESTRICTIONS WITHIN THE CITY OF MCKINNEY AT TIME OF PLANTING. SHOULD WATER RESTRICTIONS NOT ALLOW HYDROMULCH, HYDROSEEDING OR SPRIGGING (STAGE 3 AND STAGE 4 WATER RESTRICTIONS), AN APPROVED ALTERNATIVE FOR GRASSING SHALL BE INSTALLED.

ALL REQUIRED LANDSCAPE AREAS SHALL BE PROVIDED WITH AN AUTOMATIC UNDERGROUND IRRIGATION SYSTEM WITH RAIN AND FREEZE SENSORS, AND SAID IRRIGATION SYSTEM SHALL BE DESIGNED BY A QUALIFIED PROFESSIONAL AND INSTALLED BY A LICENSED IRRIGATOR.

VERIFY ALL CANOPY TREES TO BE 8' MIN AWAY FROM ALL UTILITIES.

APPROVED LANDSCAPE PLAN BY PLANNING REQUIRED TO BE INCLUDED IN THE FINAL SET.

REFERENCE SHEET L-10 FOR PLANTING LEGEND AND NOTES

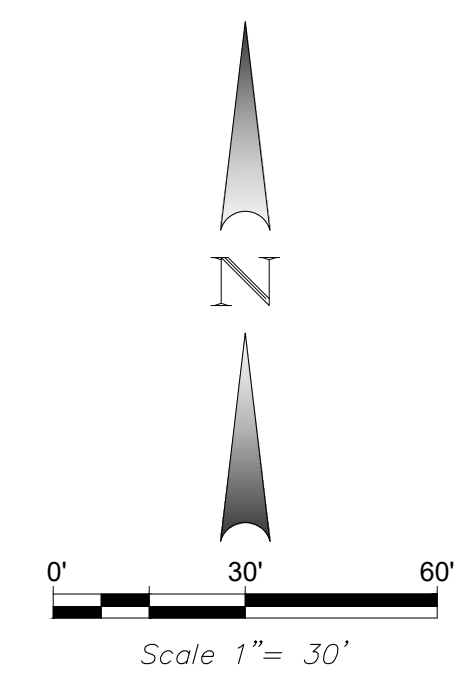

THIS ELECTRONIC DRAWING FILE IS RELEASED UNDER THE AUTHORITY OF GREG CUPPETT, LANDSCAPE ARCHITECT REGISTRATION NUMBER 2672 ON 09/23/20, WHO MAINTAINS THE ORIGINAL FILE. THIS ELECTRONIC DRAWING FILE MAY BE USED AS A BACKGROUND DRAWING. PURSUANT TO RULES 5.103(F) OF THE RULES AND REGULATIONS OF THE TEXAS BOARD OF ARCHITECTURAL EXAMINERS, THE USER OF THIS ELECTRONIC DRAWING FILE AGREES TO ASSUME ALL RESPONSIBILITY FOR ANY MODIFICATION TO OR USE OF THIS DRAWING FILE THAT IS INCONSISTENT WITH THE REQUIREMENTS OF THE RULES AND REGULATIONS OF THE TEXAS BOARD OF ARCHITECTURAL EXAMINERS. NO PERSON MAY MAKE MODIFICATIONS TO THIS ELECTRONIC DRAWING FILE WITHOUT THE LANDSCAPE ARCHITECT'S EXPRESS WRITTEN PERMISSION.

**NOTE:**  
NO LANDSCAPE PLANTINGS  
WITHIN 18" OF PARKING  
LOT CURBS.

**CAUTION!!!**  
UNDERGROUND UTILITIES ARE LOCATED IN THIS AREA. 48 HOURS PRIOR TO ANY CONSTRUCTION ACTIVITIES, CONTACT LINE LOCATES FOR FRANCHISE UTILITY INFO. CALL BEFORE YOU DIG:  
TEXAS EXCAVATION SAFETY SYSTEM (TESS) 1-800-344-8377  
TEXAS ONE CALL SYSTEMS 1-800-245-4545  
LONE STAR NOTIFICATION CENTER 1-800-669-8344 EXT. 5

**BEFORE YOU DIG...**

GAC		REVISED BUILDINGS 1					
		6.	07-08-2019	HODGES	MEETING	COMMENTS	WRW
		5.	07-08-2019	HODGES	MEETING	COMMENTS	WRW
		4.	07-08-2019	HODGES	MEETING	COMMENTS	WRW
		3.	07-08-2019	HODGES	MEETING	COMMENTS	WRW
		2.	07-01-2019	ACCESS	REVISIONS &	MARKUPS	WRW
		1.	09-03-2019	40% SET			WRW
No.		DATE		REVISION			APPROVAL

Winkelmann & Associates, Inc.  
CONSULTING CIVIL ENGINEERS ■ SURVEYORS  
6750 HILLCREST PLAZA DRIVE, SUITE 215 (922) 486-7999  
TEXAS ENGINEERS REGISTRATION NO. 89 (972) 486-7999 FAX  
COPRIGHT © 2019, Winkelmann & Associates, Inc.

**LANDSCAPE PLAN**  
STONEMONT DEVELOPMENT  
MCKINNEY, TEXAS

L-6

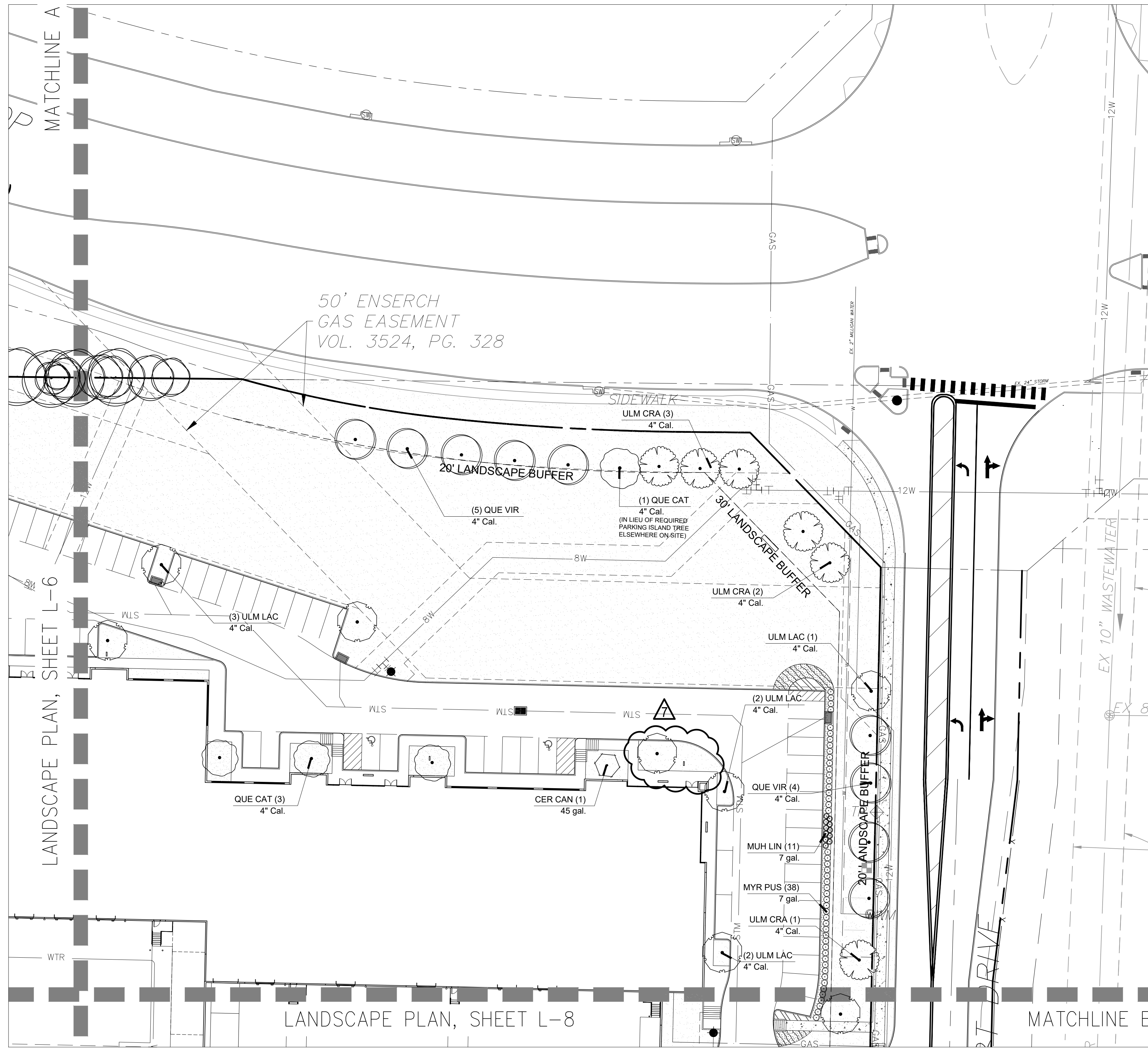

REFERENCE SHEET L-10 FOR PLANT LEGEND AND NOTES

**CAUTION!!!**  
 UNDERGROUND UTILITIES ARE LOCATED IN THIS AREA. 48 HOURS PRIOR TO ANY CONSTRUCTION ACTIVITIES, CONTACT LINE LOCATES FOR FRANCHISE UTILITY INFO. CALL BEFORE YOU DIG: TEXAS EXCAVATION SAFETY SYSTEM (TESS) 1-800-344-8377 TEXAS ONE CALL SYSTEMS 1-800-245-4545 LONE STAR NOTIFICATION CENTER 1-800-669-8344 EXT. 5

BEFORE YOU DIG...

IRRIGATION SHALL BE PROVIDED TO ALL PLANTED AREAS. IRRIGATION SHALL HAVE AN ET BASED CONTROLLER. HYDROMUCH BERMUDA IN ALL DISTURBED AREAS AS IDENTIFIED ON GRADING AND EROSION CONTROL PLANS.

THE CONTRACTOR SHALL VERIFY WATER RESTRICTIONS WITHIN THE CITY OF MCKINNEY AT TIME OF PLANTING. SHOULD WATER RESTRICTIONS NOT ALLOW HYDROMULCH, HYDROSEEDING OR SPRIGGING (STAGE 3 AND STAGE 4 WATER RESTRICTIONS), AN APPROVED ALTERNATIVE FOR GRASSING SHALL BE INSTALLED.

VERIFY ALL CANOPY TREES TO BE 8' MIN AWAY FROM ALL UTILITIES.

APPROVED LANDSCAPE PLAN BY PLANNING REQUIRED TO BE INCLUDED IN THE FINAL SET.

REFERENCE SHEET L-10 FOR PLANTING LEGEND AND NOTES

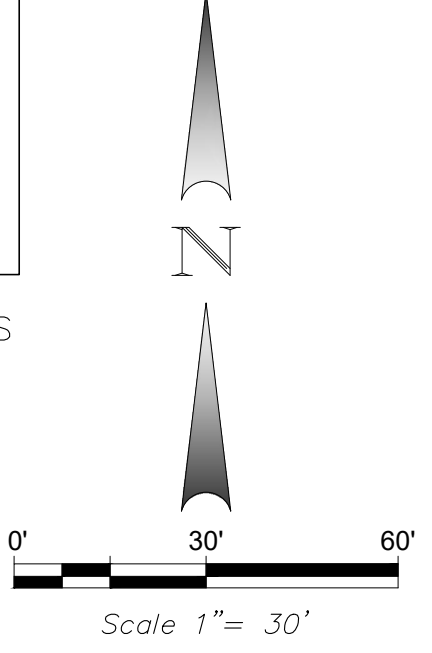

**FAIN • CUPPETT LANDSCAPE ARCHITECTS, LLC**  
 8233 Mid Green Blvd., Suite B  
 North Richland Hills, TX 76182-4781 817-478-0730  
 PAPER AND OPEN SPACE PLANNING • LANDSCAPE ARCHITECTURE • IRRIGATION DESIGN

THIS ELECTRONIC DRAWING FILE IS RELEASED UNDER THE AUTHORITY OF GREG CUPPETT, LANDSCAPE ARCHITECT REGISTRATION NUMBER 2672 ON 09/23/20, WHO MAINTAINS THE ORIGINAL FILE. THIS ELECTRONIC DRAWING FILE MAY BE USED AS A BACKGROUND DRAWING. PURSUANT TO RULE 5.103(D) OF THE RULES AND REGULATIONS OF THE TEXAS BOARD OF ARCHITECTURAL EXAMINERS, THE USER OF THIS ELECTRONIC DRAWING FILE AGREES TO ASSUME ALL RESPONSIBILITY FOR ANY MODIFICATION TO OR USE OF THIS DRAWING FILE THAT IS INCONSISTENT WITH THE REQUIREMENTS OF THE RULES AND REGULATIONS OF THE TEXAS BOARD OF ARCHITECTURAL EXAMINERS. NO PERSON MAY MAKE MODIFICATIONS TO THIS ELECTRONIC DRAWING FILE WITHOUT THE LANDSCAPE ARCHITECT'S EXPRESS WRITTEN PERMISSION.

LANDSCAPE PLAN

LANDSCAPE PLAN  
 STONEMONT DEVELOPMENT  
 MCKINNEY, TEXAS

L-7

No.	DATE	REVISION	APPROVED BY
7.	09-03-2020	GAC	
6.	07-08-2019	HODGES MEETING COMMENTS	WRW
5.	07-08-2019	HODGES MEETING COMMENTS	WRW
4.	07-08-2019	HODGES MEETING COMMENTS	WRW
3.	07-08-2019	HODGES MEETING COMMENTS	WRW
2.	07-01-2019	ACCESS REVISIONS & MARKUPS	WRW
1.	09-03-2019	40% SET	WRW

**Winkelmann & Associates, Inc.**  
 CONSULTING CIVIL ENGINEERS ■ SURVEYORS  
 6750 HILDEBERT PLAZA DR., SUITE 215  
 FORT WORTH, TEXAS 76116  
 (817) 496-7999 FAX  
 (817) 496-1099 FAX  
 LICENSE NO. 26183, WINKELMANN & ASSOCIATES, INC.

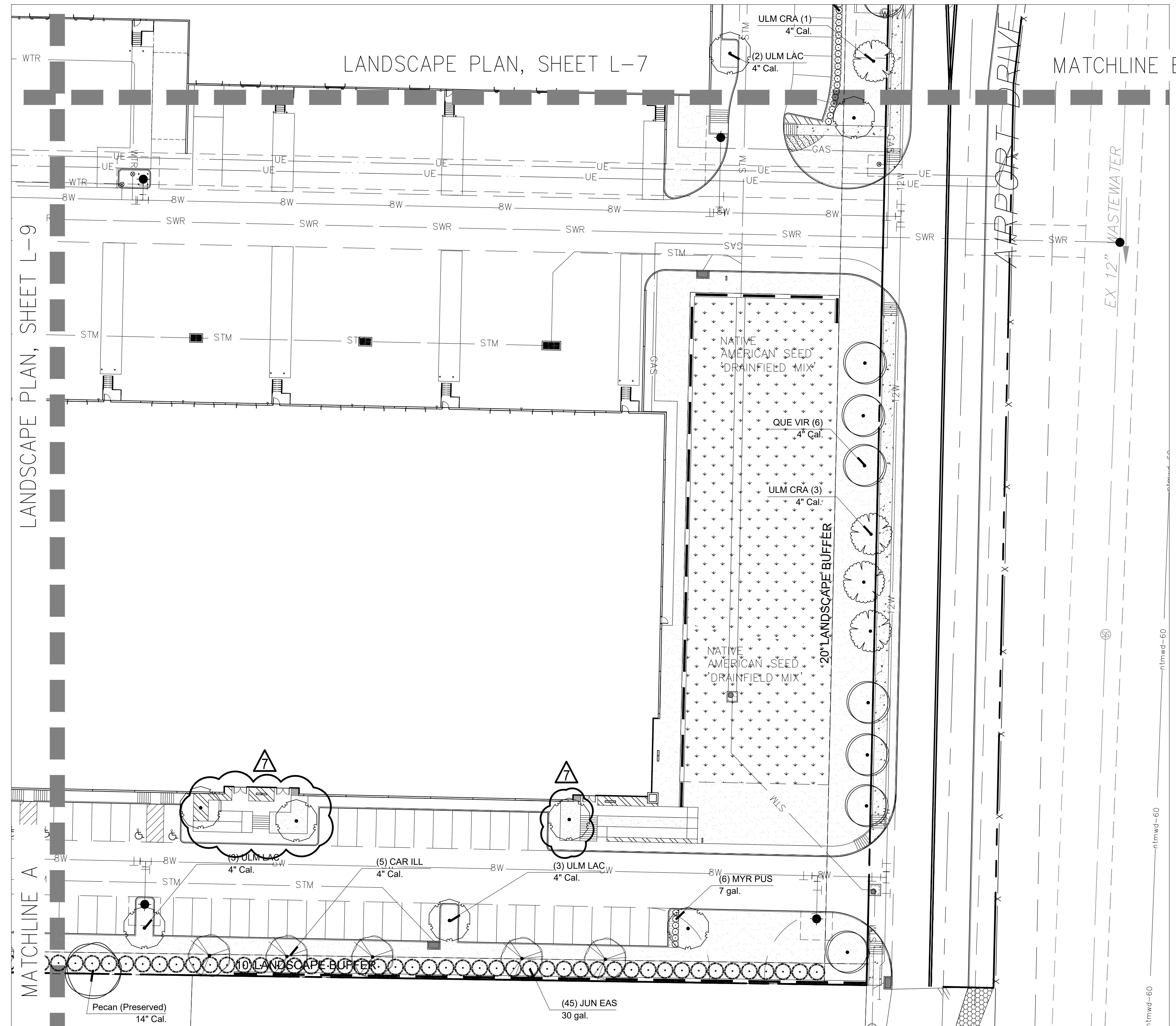

IRRIGATION SHALL BE PROVIDED TO ALL PLANTED AREAS. IRRIGATION SHALL HAVE AN ET BASED CONTROLLER. HYDROMUCH BERMUDA IN ALL DISTURBED AREAS AS IDENTIFIED ON GRADING AND EROSION CONTROL PLANS.

THE CONTRACTOR SHALL VERIFY WATER RESTRICTIONS WITHIN THE CITY OF MCKINNEY AT TIME OF PLANTING. SHOULD WATER RESTRICTIONS NOT ALLOW HYDROMULCH, HYDROSEEDING OR SPRIGGING (STAGE 3 AND STAGE 4 WATER RESTRICTIONS), AN APPROVED ALTERNATIVE FOR GRASSING SHALL BE INSTALLED.

VERIFY ALL CANOPY TREES TO BE 8' MIN AWAY FROM ALL UTILITIES.

APPROVED LANDSCAPE PLAN BY PLANNING REQUIRED TO BE INCLUDED IN THE FINAL SET.

REFERENCE SHEET L-10 FOR PLANTING LEGEND AND NOTES

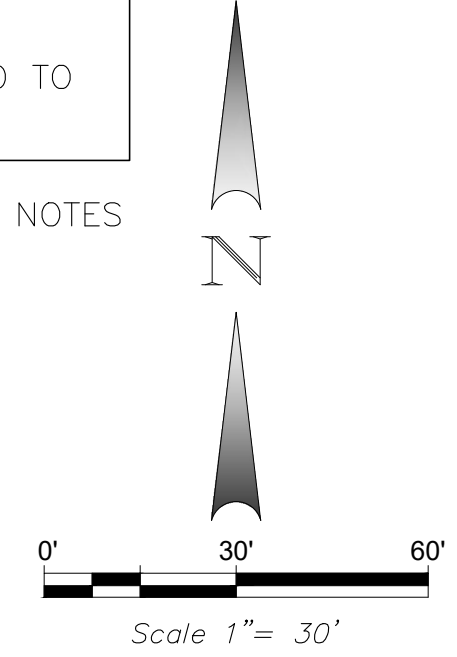
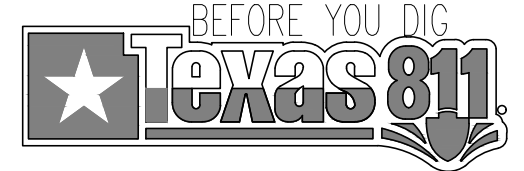

**FAIN • CUPPETT**  
**LANDSCAPE ARCHITECTS, LLC**  
 8233 Mid Creek Blvd., Suite B  
 North Richland Hills, TX 76182-4781 817-478-0730  
 PAPER AND OPEN SPACE PLANNING • LANDSCAPE ARCHITECTURE • IRRIGATION DESIGN

THIS ELECTRONIC DRAWING FILE IS RELEASED UNDER THE AUTHORITY OF GREG CUPPETT, LANDSCAPE ARCHITECT REGISTRATION NUMBER 2672 ON 09/23/20, WHO MAINTAINS THE ORIGINAL FILE. THIS ELECTRONIC DRAWING FILE MAY BE USED AS A BACKGROUND DRAWING. PURSUANT TO RULES 5.103(F) OF THE RULES AND REGULATIONS OF THE TEXAS BOARD OF ARCHITECTURAL EXAMINERS, THE USER OF THIS ELECTRONIC DRAWING FILE AGREES TO ASSUME ALL RESPONSIBILITY FOR ANY MODIFICATION TO OR USE OF THIS DRAWING FILE THAT IS INCONSISTENT WITH THE REQUIREMENTS OF THE RULES AND REGULATIONS OF THE TEXAS BOARD OF ARCHITECTURAL EXAMINERS. NO PERSON MAY MAKE MODIFICATIONS TO THIS ELECTRONIC DRAWING FILE WITHOUT THE LANDSCAPE ARCHITECT'S EXPRESS WRITTEN PERMISSION.

**CAUTION!!!**  
 UNDERGROUND UTILITIES ARE LOCATED IN THIS AREA. 48 HOURS PRIOR TO ANY CONSTRUCTION ACTIVITIES, CONTACT LINE LOCATES FOR FRANCHISE UTILITY INFO. CALL BEFORE YOU DIG:  
 TEXAS EXCAVATION SAFETY SYSTEM (TESS) 1-800-344-8377  
 TEXAS ONE CALL SYSTEMS 1-800-245-4545  
 ONE STAR NOTIFICATION CENTER 1-800-669-8344 EXT. 5

**BEFORE YOU DIG...**

REFERENCE SHEET L-10 FOR PLANT LEGEND AND NOTES

LANDSCAPE PLAN, SHEET L-9

LANDSCAPE PLAN, SHEET L-7

MATCHLINE B

MATCHLINE A

No.	DATE	REVISION	APPROVAL
7.	09-03-2020	REVISED BUILDINGS 1	GAC
6.	07-08-2019	HODGES MEETING COMMENTS	WRW
5.	07-08-2019	HODGES MEETING COMMENTS	WRW
4.	07-08-2019	HODGES MEETING COMMENTS	WRW
3.	07-08-2019	HODGES MEETING COMMENTS	WRW
2.	07-01-2019	ACCESS REVISIONS & MARKUPS	WRW
1.	09-03-2019	40% SET	WRW

**Winkelmann & Associates, Inc.**  
 CONSULTING CIVIL ENGINEERS SURVEYORS  
 6750 HILDCREST PLAZA DR., SUITE 215  
 FORT WORTH, TEXAS 76116  
 (817) 498-7999 FAX  
 (817) 498-7999  
 COPYRIGHT © 2019, Winkelmann & Associates, Inc.

LANDSCAPE PLAN  
 STONEMONT DEVELOPMENT  
 MCKINNEY, TEXAS

L-8

LANDSCAPE PLAN

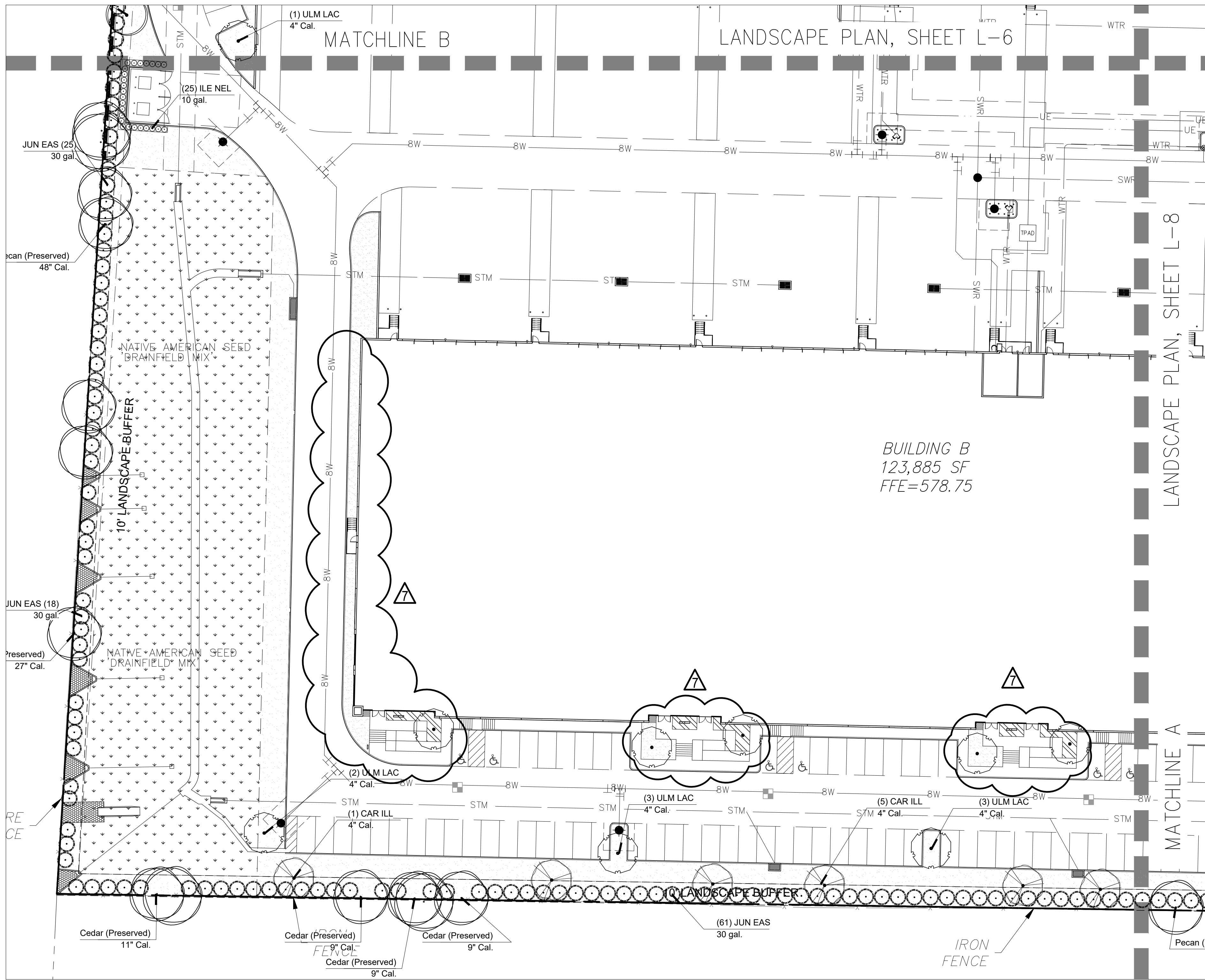

BUILDING B  
123,885 SF  
FFE=578.75

IRRIGATION SHALL BE PROVIDED TO ALL PLANTED AREAS. IRRIGATION SHALL HAVE AN ET BASED CONTROLLER. HYDROMULCH BERMUDA IN ALL DISTURBED AREAS AS IDENTIFIED ON GRADING AND EROSION CONTROL PLANS.

THE CONTRACTOR SHALL VERIFY WATER RESTRICTIONS WITHIN THE CITY OF MCKINNEY AT TIME OF PLANTING. SHOULD WATER RESTRICTIONS NOT ALLOW HYDROMULCH, HYDROSEEDING OR SPRIGGING (STAGE 3 AND STAGE 4 WATER RESTRICTIONS), AN APPROVED ALTERNATIVE FOR GRASSING SHALL BE INSTALLED.

VERIFY ALL CANOPY TREES TO BE 8' MIN AWAY FROM ALL UTILITIES.

APPROVED LANDSCAPE PLAN BY PLANNING REQUIRED TO BE INCLUDED IN THE FINAL SET.

REFERENCE SHEET L-10 FOR PLANTING LEGEND AND NOTES

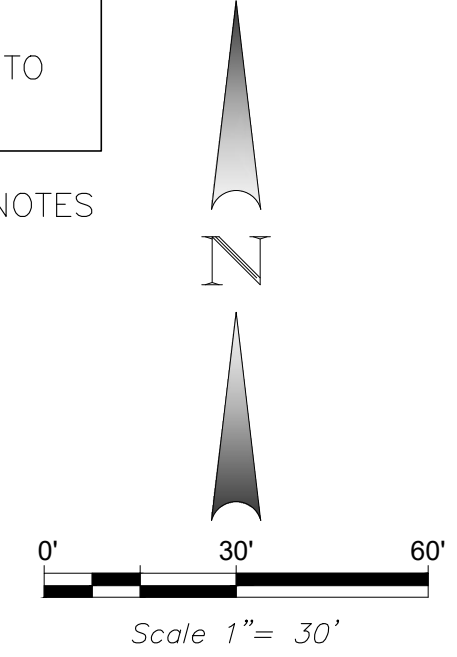

REFERENCE SHEET L-10 FOR  
PLANT LEGEND AND NOTES

**CAUTION!!!**  
UNDERGROUND UTILITIES ARE LOCATED IN THIS AREA. 48 HOURS PRIOR TO ANY CONSTRUCTION ACTIVITIES, CONTACT LINE LOCATES FOR FRANCHISE UTILITY INFO. CALL BEFORE YOU DIG: TEXAS EXCAVATION SAFETY SYSTEM (TESS) 1-800-344-8377 TEXAS ONE CALL SYSTEMS 1-800-245-4545 LONE STAR NOTIFICATION CENTER 1-800-669-8344 EXT. 5

BEFORE YOU DIG...



THIS ELECTRONIC DRAWING FILE IS RELEASED UNDER THE AUTHORITY OF GREG CUPPETT, LANDSCAPE ARCHITECT REGISTRATION NUMBER 2672 ON 09/23/20, WHO MAINTAINS THE ORIGINAL FILE. THIS ELECTRONIC DRAWING FILE MAY BE USED AS A BACKGROUND DRAWING. PURSUANT TO RULES 5.110(F) OF THE RULES AND REGULATIONS OF THE TEXAS BOARD OF ARCHITECTURAL EXAMINERS, THE USER OF THIS ELECTRONIC DRAWING FILE AGREES TO ASSUME ALL RESPONSIBILITY FOR ANY MODIFICATION TO OR USE OF THIS DRAWING FILE THAT IS INCONSISTENT WITH THE REQUIREMENTS OF THE RULES AND REGULATIONS OF THE TEXAS BOARD OF ARCHITECTURAL EXAMINERS. NO PERSON MAY MAKE MODIFICATIONS TO THIS ELECTRONIC DRAWING FILE WITHOUT THE LANDSCAPE ARCHITECT'S EXPRESS WRITTEN PERMISSION.

LANDSCAPE PLAN

No.	DATE	REVISION	APPROVED BY
7.	09-03-2020	REVISED BUILDINGS 1	GAC
6.	07-08-2019	HODGES MEETING COMMENTS	WRW
5.	07-08-2019	HODGES MEETING COMMENTS	WRW
4.	07-08-2019	HODGES MEETING COMMENTS	WRW
3.	07-08-2019	HODGES MEETING COMMENTS	WRW
2.	07-01-2019	ACCESS REVISIONS & MARKUPS	WRW
1.	09-03-2019	40% SET	WRW
		REVISION	APPROVED BY

**Winkelmann & Associates, Inc.**  
CONSULTING CIVIL ENGINEERS ■ SURVEYORS  
6750 HILLCREST PLAZA DRIVE, SUITE 215  
DALLAS, TEXAS 75231  
Texas Engineers Registration No. 89366-01  
Professional Seal No. 12010  
Copyright © 2019, Winkelmann & Associates, Inc.

LANDSCAPE PLAN  
STONEMONT DEVELOPMENT  
MCKINNEY, TEXAS

L-9

**PLANTING NOTES:**

1. PLANT SIZE, TYPE, AND CONDITION SUBJECT TO APPROVAL OF OWNER'S REPRESENTATIVE.
2. ALL PLANT MATERIAL TO BE NURSERY GROWN STOCK.
3. CONTRACTOR RESPONSIBLE FOR MAINTENANCE OF ALL PLANT MATERIAL UNTIL PROJECT ACCEPTANCE.
4. ALL CONTAINER GROWN PLANTS TO HAVE FULL, VIGOROUS ROOT SYSTEM, COMPLETELY ENCOMPASSING CONTAINER.
5. ALL PLANTS WELL ROUNDED AND FULLY BRANCHED. ALL TREES WITH SPREAD 2/3 OF HEIGHT.
6. CONTRACTOR TO PROVIDE OWNER WITH PREFERRED MAINTENANCE SCHEDULE OF ALL PLANTS AND LAWNS.
7. MAINTAIN/PROTECT VISIBILITY TRIANGLE WITH PLANT MATERIAL PER CITY STANDARDS AT ALL ENTRANCES TO SITE.
8. PREP ENTIRE WIDTH OF ALL DEFINED PLANTING BEDS WITH MIX AS OUTLINED IN SPECS. WHERE SHRUBS ARE LOCATED ALONG CURB, SET SHRUBS BACK FROM CURB 3 FT.
9. SEE DETAIL SHEET L-8 FOR PLANTING DETAILS.
10. CONTRACTOR RESPONSIBLE FOR LOCATION OF ALL UTILITIES, INCLUDING BUT NOT LIMITED TO TELEPHONE, TELECABLE, ELECTRIC, GAS, WATER AND SEWER. ANY DAMAGE TO UTILITIES TO BE REPAIRED BY CONTRACTOR AT NO COST TO OWNER.
11. EXISTING TREES ARE SHOWN TO REMAIN, CONTRACTOR SHALL PRUNE WITH APPROVAL OF OWNER AND CITY ARBORIST. WORK TO INCLUDE REMOVAL OF ALL SUCKER GROWTH, DEAD AND DISEASED BRANCHES AND LIMBS; VINES, BRIARS AND OTHER INVASIVE GROWTH; AND ALL INTERFERING BRANCHES, AS WELL AS BRANCHES THAT OBSTRUCT SIGN VISIBILITY. MAKE ALL CUTS FLUSH TO REMAINING LIMB. RETAIN NATURAL SHAPE OF PLANT. ALL WORK SUBJECT TO APPROVAL OF OWNER'S REPRESENTATIVE.
12. QUANTITIES ARE PROVIDED AS A COURTESY AND NOT INTENDED FOR BID PURPOSES. CONTRACTOR TO VERIFY PRIOR TO PRICING.
13. INSTALL EDGING BETWEEN LAWN AND PLANTING BEDS. REFER TO SPECIFICATIONS. FILE ALL CORNERS SMOOTH.
14. INSTALL CURLEX BLANKET (OR EQUAL) PER MANUFACTURER'S INSTRUCTIONS ON ALL GROUND COVER/SHRUB BEDS WITH A SLOPE OF 4:1 OR GREATER.
15. AT TIME OF PLAN PREPARATION, SEASONAL PLANT AVAILABILITY CANNOT BE DETERMINED. IT IS THE RESPONSIBILITY OF THE CONTRACTOR TO SECURE AND RESERVE ALL B&B PLANTS WHEN AVAILABLE IN CASE ACTUAL INSTALLATION OCCURS DURING THE OFF-SEASON. PURCHASE AND HOLD B&B PLANTS FOR LATE SEASON INSTALLATION.
16. BERM ALL PARKING LOT ISLANDS AS SHOWN ON ENCLOSED DETAIL SHEET. (BERMS MAY NOT BE SHOWN ON GRADING PLAN.)
17. PRIOR TO TREE PLANTING, CONTRACTOR SHALL STAKE TREE LOCATIONS FOR APPROVAL BY OWNER.

Contact Information:  
**TREE STAKE SOLUTIONS**  
 www.treestakesolutions.com  
**JEFF TULEY**  
 903-676-6143

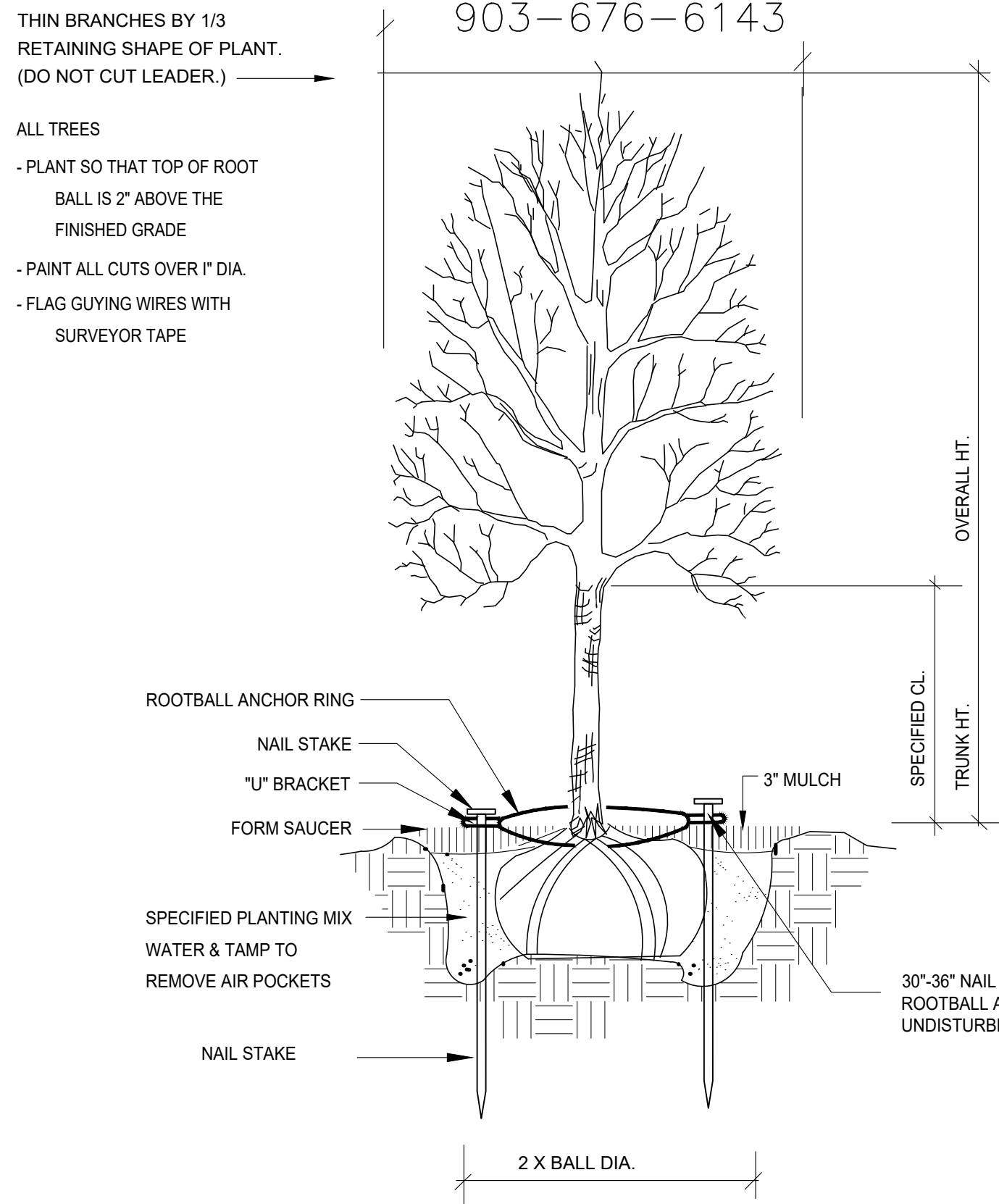

**SAFETY STAKE BY TREE STAKE SOLUTIONS**

SCALE: NOT TO SCALE

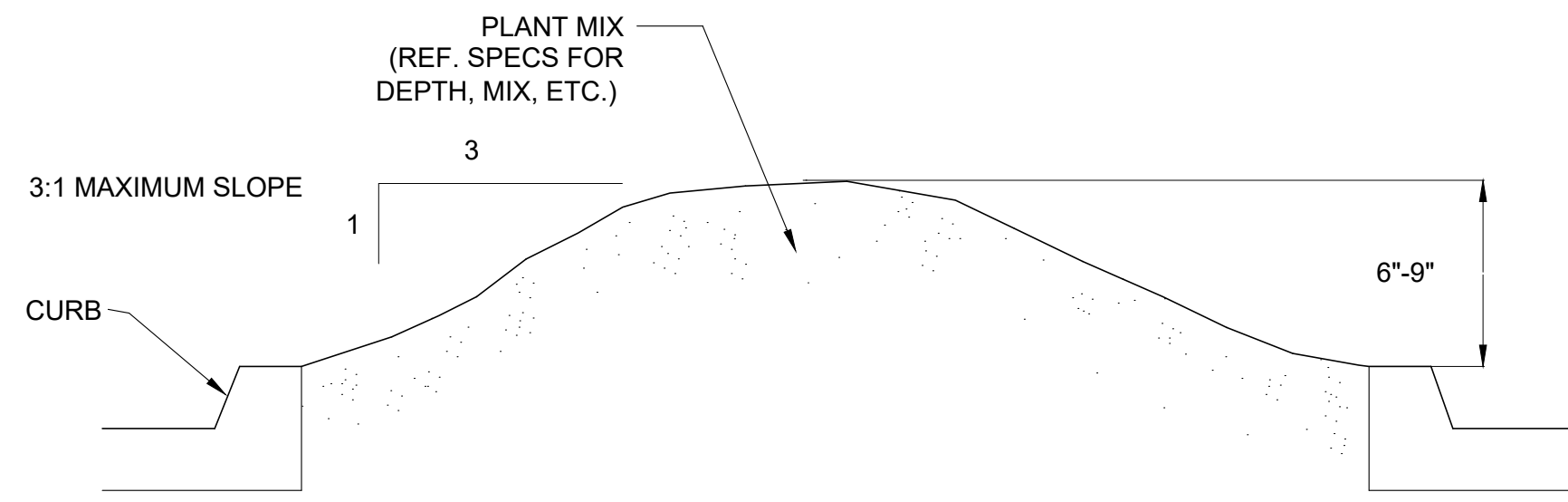
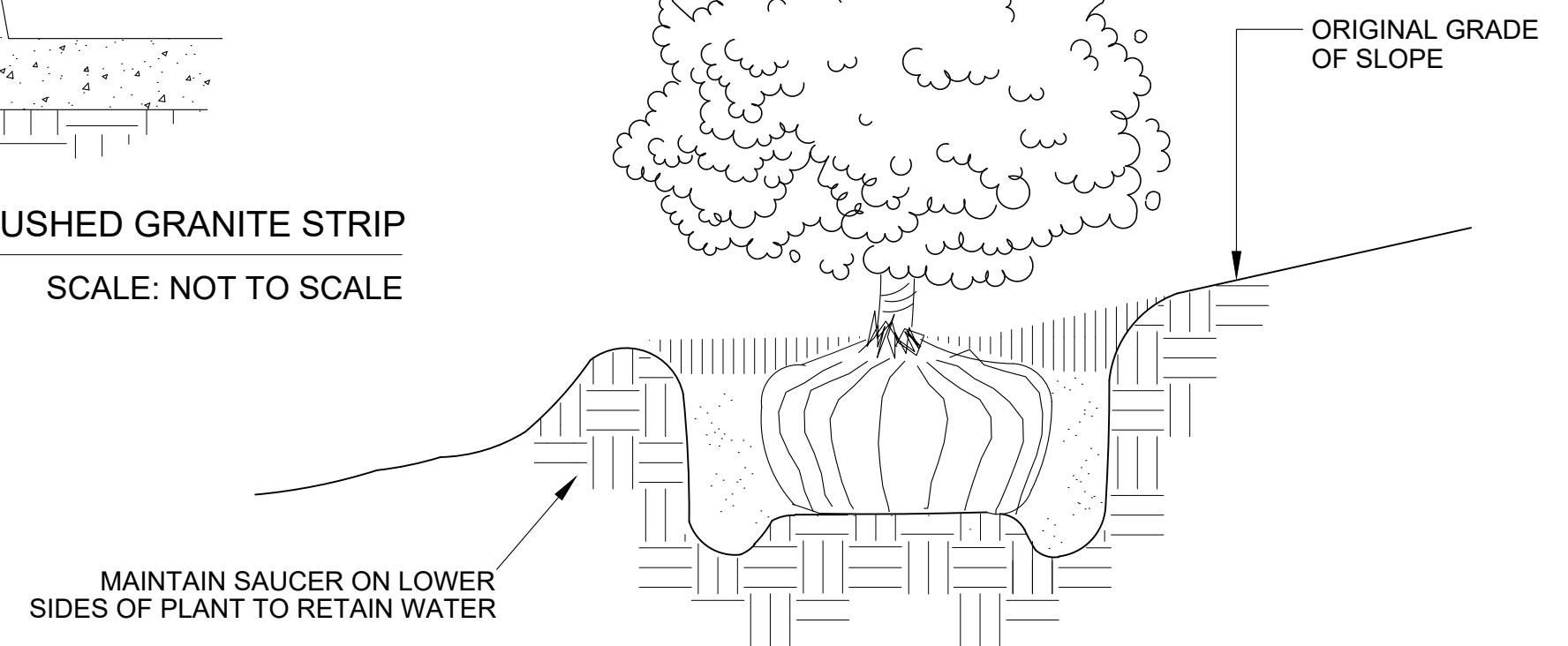
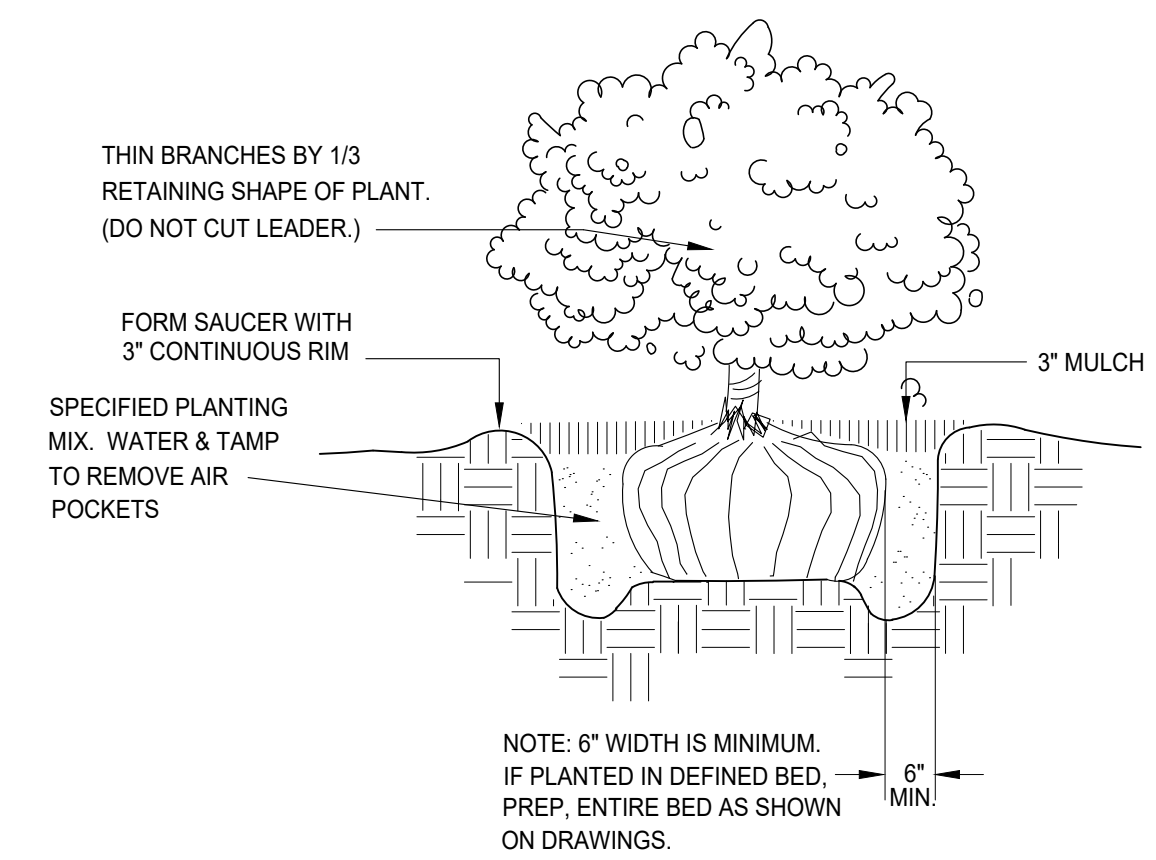
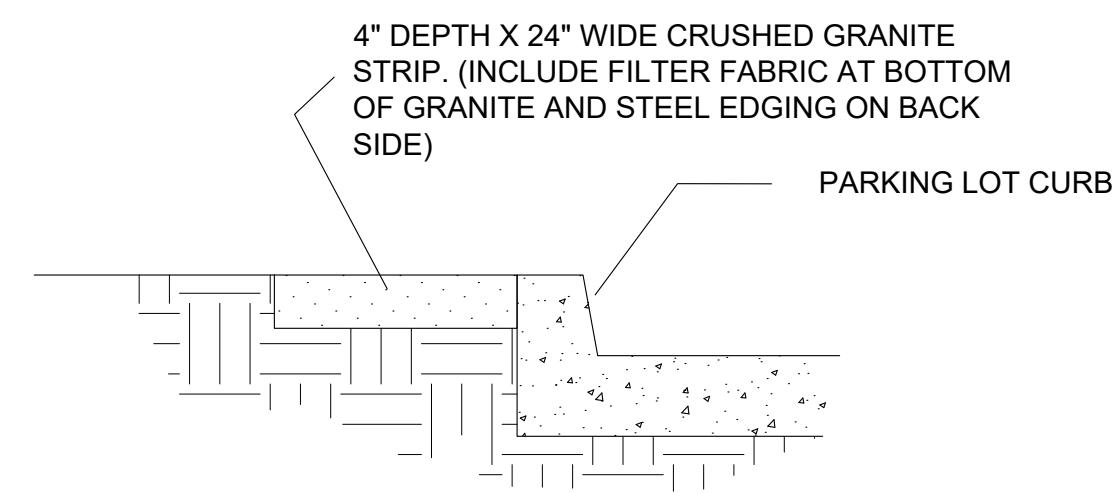
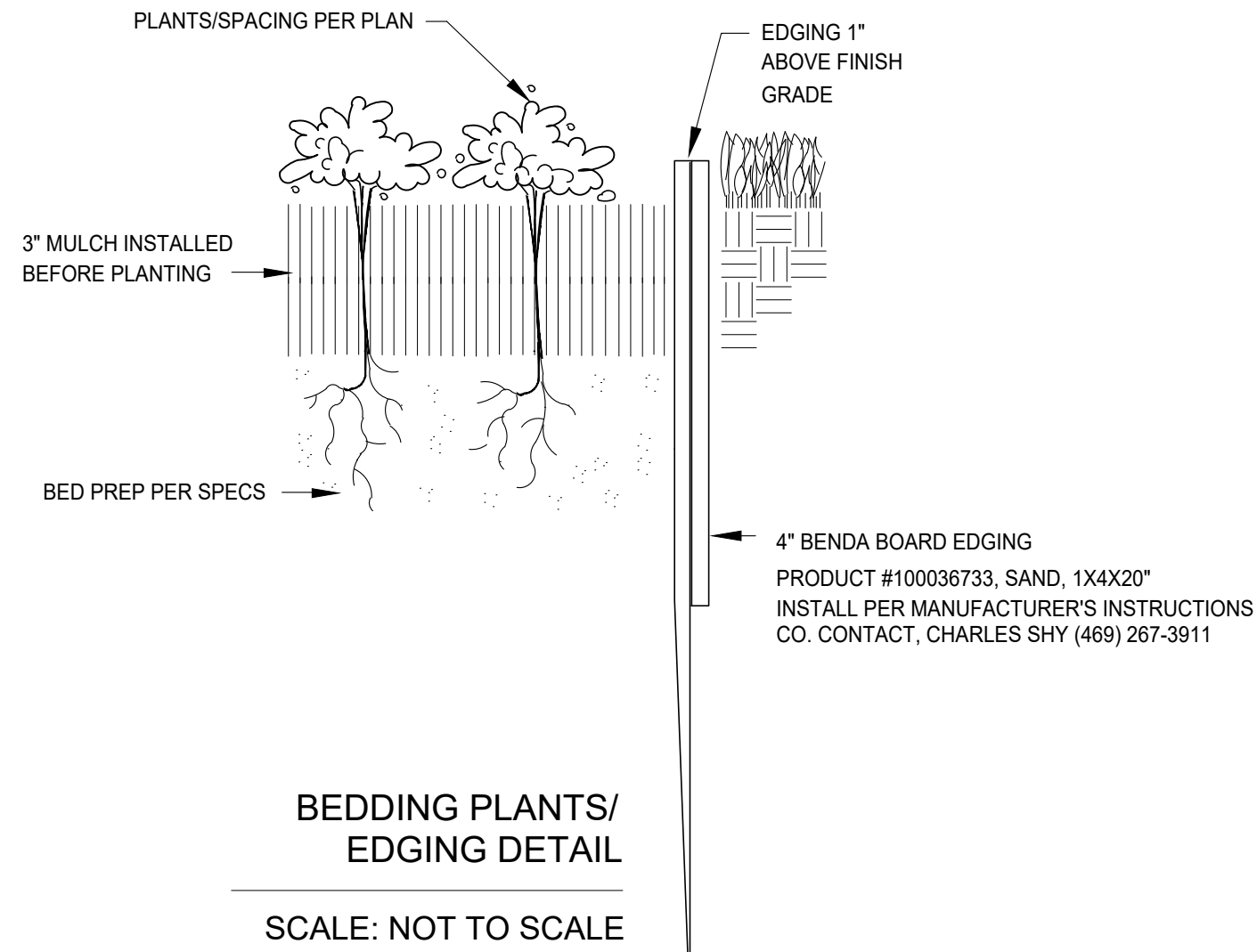

**PLANTING LEGEND**

TREES	CODE	QTY	BOTANICAL NAME	COMMON NAME	SIZE	HEIGHT	SPACING	REMARKS
	CAR ILL	11	Carya illinoensis	Pecan	4" Cal.	12' Min HT	As Shown	B&B/ Single straight trunk
	CER CAN	1	Cercis canadensis	Eastern Redbud	45 gal.	6'-10' HL	As Shown	B&B/ Single straight trunk
	JUN EAS	166	Juniperus virginiana	Eastern Red Cedar	30 gal.	6' Min HT	8' O.C. Min.	Single Straight Trunk, 6' Min ht
	QUE VIR	20	Quercus virginiana	Southern Live Oak	4" Cal.	12' Min HT	As Shown	B&B/ Single straight trunk
	QUE CAT	6	Quercus virginiana 'SDLN' TM	Cathedral Live Oak	4" Cal.	12' Min HT	As Shown	B&B/ Single straight trunk
	ULM CRA	9	Ulmus crassifolia	Cedar Elm	4" Cal.	12' Min HT	As Shown	B&B/ Single straight trunk
	ULM LAC	32	Ulmus parvifolia	Chinese Lacebark Elm	4" Cal.	12' Min HT	As Shown	B&B/ Single straight trunk
SHRUBS	CODE	QTY	BOTANICAL NAME	COMMON NAME	SIZE	HEIGHT	SPACING	REMARKS
	ILE NEL	25	Ilex x 'Nellie R. Stevens'	Nellie R. Stevens Holly	10 gal.	36" Min	36" O.C.	
	MUH LIN	11	Muhlenbergia lindheimeri	Lindheimer's Muhly	7 gal.	24"-36"	36" O.C.	
	MYR PUS	54	Myrica pusilla	Dwarf Southern Wax Myrtle	7 gal.	24"-36"	36" O.C.	
GROUND COVERS	CODE	QTY	BOTANICAL NAME	COMMON NAME	SIZE	HEIGHT	SPACING	REMARKS
	CYN DAC	120,337 sf	Cynodon dactylon	Bermuda Grass	Hydro-Mulch			
	DEC SIP	232 sf	Decomposed Granite	Decomposed Granite	4" depth			w/Weed Barrier
	NAS PON	305 sf	Nassella tenuissima 'Pony Tails'	Mexican Feathergrass	1 gal.		18" O.C.	
	NAT FXM	43,296 sf	Native American Seed	'Drain Field Mix'	seed			
	TRA ASI	548 sf	Trachelospermum asiaticum	Asian Jasmine	4" pots		12" O.C.	



**FAIN • CUPPET**  
**LANDSCAPE ARCHITECTS, LLC**  
 8233 Mid Creek Blvd., Suite B  
 North Richland Hills, TX 76182-4781 817-478-0730  
 PAPER AND OPEN SPACE PLANNING • LANDSCAPE ARCHITECTURE • IRRIGATION DESIGN

THIS ELECTRONIC DRAWING FILE IS RELEASED UNDER THE AUTHORITY OF GREG CUPPETT, LANDSCAPE ARCHITECT REGISTRATION NUMBER 2672 ON 09/23/20, WHO MAINTAINS THE ORIGINAL FILE. THIS ELECTRONIC DRAWING FILE MAY BE USED AS A BACKGROUND DRAWING. PURSUANT TO RULES 1.103(F) OF THE RULES AND REGULATIONS OF THE TEXAS BOARD OF ARCHITECTURAL EXAMINERS. THE USER OF THIS ELECTRONIC DRAWING FILE AGREES TO ASSUME ALL RESPONSIBILITY FOR ANY MODIFICATION TO OR USE OF THIS DRAWING FILE THAT IS INCONSISTENT WITH THE REQUIREMENTS OF THE RULES AND REGULATIONS OF THE TEXAS BOARD OF ARCHITECTURAL EXAMINERS. NO PERSON MAY MAKE MODIFICATIONS TO THIS ELECTRONIC DRAWING FILE WITHOUT THE LANDSCAPE ARCHITECT'S EXPRESS WRITTEN PERMISSION.

GAC	REVISED BUILDINGS	MEETING COMMENTS	DATE	REVISION
WRW	1	HODGES MEETING COMMENTS	07-08-2019	
WRW	2	HODGES MEETING COMMENTS	07-08-2019	
WRW	3	HODGES MEETING COMMENTS	07-08-2019	
WRW	4	HODGES MEETING COMMENTS	07-08-2019	
WRW	5	ACCESS REVISIONS & MARKUPS	07-01-2019	40% SET
WRW	6		09-03-2019	
WRW	7		09-03-2020	

**Winkelmann & Associates, Inc.**  
 CONSULTING CIVIL ENGINEERS ■ SURVEYORS  
 6750 HILLCREST PLAZA BLDG. SUITE 215  
 FORT WORTH, TEXAS 76116  
 (817) 498-7999  
 (817) 498-1099 FAX  
 LICENSE NO. 12418, 12419, 12420, 12421, 12422, 12423, 12424, 12425, 12426, 12427, 12428, 12429, 12430, 12431, 12432, 12433, 12434, 12435, 12436, 12437, 12438, 12439, 12440, 12441, 12442, 12443, 12444, 12445, 12446, 12447, 12448, 12449, 12450, 12451, 12452, 12453, 12454, 12455, 12456, 12457, 12458, 12459, 12460, 12461, 12462, 12463, 12464, 12465, 12466, 12467, 12468, 12469, 12470, 12471, 12472, 12473, 12474, 12475, 12476, 12477, 12478, 12479, 12480, 12481, 12482, 12483, 12484, 12485, 12486, 12487, 12488, 12489, 12490, 12491, 12492, 12493, 12494, 12495, 12496, 12497, 12498, 12499, 12500

**PLANTING DETAILS**  
 STONEMONT DEVELOPMENT  
 MCKINNEY, TEXAS

**L-10**

PLANTING DETAILS

SECTION 02830

TREES, SHRUBS, AND GROUNDCOVERS

PART I GENERAL

1.01 DESCRIPTION OF WORK

- A. Scope
1. Bed prep
2. Metal edging
3. Topsoil
4. Planting
5. Mulching
6. Guarantee
B. Related Work Specified Elsewhere
1. General Requirements - All locations
2. Section 02740 - Irrigation Trenching
3. Section 02750 - Irrigation
4. Section 02800 - Lawns

1.02 QUALITY ASSURANCE

- A. Contractor Qualifications
Minimum of three (3) years experience on projects of similar characteristics and size.
B. Reference Standards:
1. American Joint Committee Of Horticultural Nomenclature: Standardized Plant Names, Second Edition, 1942;
2. American Association Of Nurserymen: American Standard For Nursery Stock, 1973
C. Substitutions
1. Substitutions accepted only upon written approval of Landscape Architect and Owner.
2. Submit substitutions possessing same characteristics as indicated on plans and specifications.
D. Inspection and Testing
1. The project Owner's representative reserves the right to inspect and tag plants at the place of growth with the Contractor.
2. Inspection at place of growth does not preclude the right of rejection due to improper digging or handling.
3. Owner's representative reserves the right to request soil samples and analysis of soil and plant mix. Remove or correct unacceptable soil. Cost of testing by Contractor.

1.03 SUBMITTALS

- A. Certificates
1. Submit State and Federal certificates of inspection with invoice. (Only if required by Landscape Architect.)
2. File certificates with Owner's representative prior to material acceptance.

1.04 PRODUCT DELIVERY, STORAGE, & HANDLING

- A. Preparation of Delivery
1. Balled & Burlaped (B&B) Plants
a. Dig and prepare for shipment in manner that will not damage roots, branches, shape, and future development after replanting.
b. Ball with firm, natural ball of soil, wrapped tightly with burlap covering entire ball.
c. Ball size and ratios: conform to American Association of Nurserymen standards unless otherwise shown on plant list.
2. Pack plant material to protect against climatic & seasonal damage, as well as breakage injuries during transit.
3. Securely cover plant tops with ventilated tarpaulin or canvas to minimize wind-whipping and drying in transit.
4. Pack and ventilate to prevent sweating of plants during transit. Give special attention to insure prompt delivery and careful handling to point of delivery at job site.
B. Delivery
1. Deliver fertilizer, fertilizer tablets, peat, mulch, soil additives, and amendment materials to site in original, unopened containers, bearing manufacturer's guaranteed chemical analysis, name, trade name, trademark, and conformance to State law.
2. Deliver plants with legible identification and size labels on example plants.
3. Protect during delivery to prevent damage to root ball or desiccation of leaves.
4. Notify Owner's representative of delivery schedule in advance so plant material may be inspected upon arrival at job site.
5. Deliver plants to job site only when areas are prepared.
C. Storage
1. Protect roots of plant material from drying or other possible injury with wetted mulch or other acceptable material.
2. Protect from weather.
3. Maintain and protect plant material not to be planted immediately upon delivery.
D. Handling
1. Do not drop plants.
2. Do not damage ball, trunk, or crown.
3. Lift and handle plants from bottom of container or ball.

1.05 JOB CONDITIONS

- A. Planting Season Perform actual planting only when weather and soil conditions are suitable in accordance with locally acceptable practices.
B. Protection Before excavations are made, take precautionary measures to protect areas trucked over and where soil is temporarily stacked.

1.06 GUARANTEE

- A. Guarantee new plant material for one year after acceptance of final installation (ie. Final Acceptance of project).
B. Make replacement (one per plant) during one year guarantee period at appropriate season with original plant type, size and planting mixture.
C. Repair damage to other plants, lawns, & irrigation caused during plant replacement at no cost to Owner.
D. Use only plant replacements of indicated size and species.

PART II PRODUCTS

2.01 MATERIALS

- A. Plant Materials
1. Hardy under climatic conditions similar to locality of project.
2. True to botanical and common name variety.
3. Sound, healthy, vigorous, well branched, and densely foliated when in leaf, with healthy well-developed root system.
4. Free from disease, insects, and defects such as knots, sun-scald, windburn, injuries, disfigurement, or abrasions.
5. Conform to measurements after pruning with branches in normal positions.
6. Conform to American Association of Nurserymen standards unless shown differently on plant list.
7. Trees:
a. Single, straight trunks, unless indicated otherwise
b. Trees with weak, thin trunks not capable of support will not be accepted.
c. All multi-stem trees are to have a minimum of three stems, similar in size and shape, with a spread of approximately 2/3 of the height. All yaupons to be female. Crape myrtle color selection by Landscape Architect.
8. Nursery grown stock only.
9. Subject to approval of Landscape Architect.
10. Seasonal color:
a. Annuals in 4" pots or as specified
b. Perennials in 4" pots, clumps, bulbs as specified
B. Topsoil
1. Natural, fertile, friable soils having a textural classification of loam or sandy loam possessing characteristics of soils in vicinity which produce heavy growth of crops, grass, or other vegetation.
2. Free of subsoil, brush, organic litter, objectionable weeds, clods, shale, stones 3/4" diameter or larger, stumps, roots or other material harmful to grading, planting, plant growth, or maintenance operations.
3. Presence of vegetative parts of Bermuda grass ( Cynodon dactylon), Johnson grass, nut grass (Cyperus rotundus), and other hard to eradicate weeds or grass will be cause for rejection of topsoil.
4. Test topsoil (cost by Contractor):
a. Available nitrogen
b. Available phosphorus
c. Available potash
d. Iron
e. Ph: 5.5 to 7.0
f. Decomposed organic matter: 6-10%
C. Mulch
1. Top Dressing Mulch - Shredded cypress or hard wood only
2. Soil prep - 3 Parts native soil to 1 Part composted landscape mix.
3. In pre-packaged bags only; bulk shredded material is unacceptable
D. Peat Moss Commercially available baled peat moss or approved equivalent.
E. Staking Material
1. Stakes for tree support:
a. Construction grade yellow pine, stain brown
b. Size as noted on plans
2. Wires:
a. Padded with rubber hose to protect tree
b. Galvanized
c. With galvanized turnbuckle
d. Evenly tighten turnbuckles with plant in vertical position.
F. Water
1. Free of oils, acids, alkali, salt, and other substances harmful to plant growth
2. Location: Furnish temporary hoses and connections on site.
G. Sand - Washed builders sand
H. Antidesicant - "Wilt-proof" or equal.
I. Edging - 3/16" X 4" green, new and unused; with stakes.
2.02 MIXES
A. Planting Mixture
1. Existing topsoil - 50%
2. Shredded pine bark - 50%
3. Fertilizer 10:20:10 at 30 lb./1000 SF
B. Planting Mix for Annuals/Perennials
1. Prepare above mix
2. Add 2" of sand
C. Azalea mix: solid peat moss in hole 9" wider than root ball each direction. Plant in solid peat moss and provide mound at base of plant to allow for drainage.
D. Japanese maple, dogwood, camellias: Provide 50/50 peat moss to topsoil mix, raise for drainage.

PART III - EXECUTION

- 3.01 UTILITIES - verify location of all utilities prior to initiating construction; repair any damage caused by construction at no cost to owner.

3.02 INSPECTION

- A. Inspect plants for injury and insect infestation; prune prior to installation.
B. Inspect site to verify suitable job conditions.

3.03 FIELD MEASUREMENTS

- A. Location of all trees and shrubs to staked in the field and approved by Owner's representative prior to installation.
B. Location of all groundcover and seeding limits as shown on plans.

3.04 EXCAVATION FOR PLANTING

- A. Pits
1. Shape - Vertical hand scarified sides and flat bottom.
2. Size for trees - 2 feet wider or twice the root ball, whichever is greater.
3. Size for shrubs - Size of planting bed as shown on drawings.
4. Rototill soil mix thoroughly, full depth.
5. NOTE: If beds are proposed beneath drip line of existing tree canopy, pocket prep plants. Do not roto-till beneath existing trees.
B. Obstructions Below Ground
1. Remove rock or underground obstructions to depth necessary to permit planting.
2. If underground obstructions cannot be removed, notify Owner's representative for instruction.
C. Excess Soil Dispense of unacceptable or excess soil away from the project site at Contractor's expense.

3.05 PLANTING

- A. General
1. Set plants 2" above existing grade to allow for settling.
2. Set plants plumb and rigidly braced in position until planting mixture has been tamped solidly around ball.
3. Apply soil in accordance with standard industry practice for the region.
4. Thoroughly settle by water jetting and tamping soil in 6" lifts.
5. Prepare 3" dish outside root ball after planting.
6. Thoroughly water all beds and plants.
7. Stake trees and large shrubs as indicated on plans.
8. Apply anti-desiccant according to manufacturer's instructions.
9. Apply commercially manufactured root stimulator as directed by printed instruction.
10. Plant and fertilize bedding plants per trade standards.
11. Apply 3" mulch top dressing.
B. Balled Plants
1. Place in pit of planting mixture that has been hand tamped prior to placing plant.
2. Place with burlap intact to ground line. Top of ball to be 2" above surrounding soil to allow for settling.
3. Remove binding at top of ball and lay top of burlap back 6".
4. Do not pull wrapping from under ball, but cut all binding cord.
5. Do not plant if ball is cracked or broken before or during planting process or if stem or trunk is loose.
6. Backfill with planting mixture in 6" lifts.
C. Container Grown Plants
1. Place in pit on planting mixture that has been hand tamped prior to placing plant.
2. Cut cans on two sides with an acceptable can cutter, and remove root ball from can. Do not injure root ball.
3. Carefully remove plants without injury or damage to root balls.
4. Backfill with planting mixture in 6" lifts.
D. Mulching
1. Cover planting bed evenly with 3" of mulch.
2. Water immediately after mulching.
3. Where mulch has settled, add additional mulch to regain 3" thickness.
4. Hose down planting area with fine spray to wash leaves of plants.
E. Pruning
1. Prune minimum necessary to remove injured twigs and branches, dead wood, and succors; remove approximately 1/3 of twig growth as directed by landscape architect; do not cut leaders or other major branches of plant unless directed by landscape architect.
2. Make cuts flush, leaving no stubs.
3. Paint cuts over 1" diameter with approved tree wound paint.
4. Do not prune evergreens except to remove injured branches.

3.06 EDGING

- A. Stake edging alignment with string line prior to installation. Use framing square to insure right angles are true.
B. Install all edging straight and true as indicated on drawings. Where edging layout is circular in design, maintain true and constant radii as shown.
C. When required on slopes, make vertical cuts (approximately 6" on center) on bottom of edging to allow bending without crimping edging.
D. Install edging so that approximately 1" is exposed on lawn side. Edging should not be visible from bed side after application of mulch.
E. Align edging with architectural features (ie pavement joints, windows, columns, wall, etc.) when drawings indicate.
F. Bend all corners, do not cut corners.
G. Interlock all pieces with pre-fabricated connectors.
H. Install with all stakes on inside of planting bed.
I. Remove, file off all sharp corners and burrs.

3.07 CLEAN-UP

- A. Sweep and wash all paved surfaces.
Remove all planting and construction debris from site, including rocks, trash and all other miscellaneous materials.

3.08 MAINTENANCE

- A. Contractor responsible for routine, and regular maintenance of site until Final Acceptance is awarded by Owner. Work includes:
1. Weeding (weekly)
2. Watering (as required)
3. Pruning
4. Spraying
5. Fertilizing
6. Mulching
7. Mowing (weekly)
B. Provide Owner and Landscape Architect with preferred maintenance schedule in writing. Schedule shall include the above-listed tasks and shall address all frequencies, rates, times, levels, etc.

END OF SECTION

Table with columns: GAC, REVISED BUILDINGS, HODGES MEETING COMMENTS, DATE. Rows 7-10.

Winkelman & Associates, Inc. CONSULTING CIVIL ENGINEERS & SURVEYORS. 6750 HILLCREST PLAZA, SUITE 215, DALLAS, TEXAS 75231. (972) 496-7999 FAX (972) 496-7999

PLANTING SPECIFICATIONS. STONEMONT DEVELOPMENT. MCKINNEY, TEXAS.

Stamp: FAIN • CUPPETT LANDSCAPE ARCHITECTS, LLC. 2672. 09/23/20. REGISTERED LANDSCAPE ARCHITECT GREG A. CUPPETT.

FAIN • CUPPETT LANDSCAPE ARCHITECTS, LLC. 2672. 09/23/20. PARKS AND OPEN SPACE PLANNING • LANDSCAPE ARCHITECTURE • IRRIGATION DESIGN.

THIS ELECTRONIC DRAWING FILE IS RELEASED UNDER THE AUTHORITY OF GREG CUPPETT, LANDSCAPE ARCHITECT REGISTRATION NUMBER 2672 ON 09/23/20. WHO MAINTAINS THE ORIGINAL FILE. THIS ELECTRONIC DRAWING FILE MAY BE USED AS A BACKGROUND DRAWING. PURSUANT TO RULES 3.103(F) OF THE RULES AND REGULATIONS OF THE TEXAS BOARD OF ARCHITECTURAL EXAMINERS, THE USER OF THIS ELECTRONIC DRAWING FILE AGREES TO ASSUME ALL RESPONSIBILITY FOR ANY MODIFICATION TO OR USE OF THIS DRAWING FILE THAT IS INCONSISTENT WITH THE REQUIREMENTS OF THE RULES AND REGULATIONS OF THE TEXAS BOARD OF ARCHITECTURAL EXAMINERS. NO PERSON MAY MAKE MODIFICATIONS TO THIS ELECTRONIC DRAWING FILE WITHOUT THE LANDSCAPE ARCHITECT'S EXPRESS WRITTEN PERMISSION.

PLANTING SPECS

**SECTION 02800**  
**FINISH GRADING, LAWN WORK, WILD FLOWERS**

**PART I - GENERAL**

**1.01 DESCRIPTION**

- A. Work includes turf establishment (sod, hydromulch, etc.) as described on drawings.
- B. Make required analysis and material tests for topsoil, fertilizers, and other materials of similar character per current methods of the Association of Official Agricultural Chemists, when required.
- C. Grass seed shall conform to tolerances for germination and purity per applicable standards of U.S. Department of Agriculture.
- D. The turf contractor shall have a stand of grass established prior to substantial completion of the project. If this is not possible due to time of year or schedule, he shall maintain and protect the seeded areas until the grass is established.

**PART II - PRODUCTS**

**2.01 TOPSOIL MATERIAL**

- A. Topsoil material (stockpiled, as specified in Specifications) has been saved for use in finish grading. After sifting out all plant growth, rubbish, and stones, use for areas designated to receive grass. If stockpiled topsoil is not sufficient quantity to complete work, furnish acceptable topsoil from another approved source to provide four inches (4") of topsoil for grass areas unless otherwise noted on drawings. Grass areas shall be defined as the graded areas disturbed during construction not to be paved or built upon.
- B. Acceptable topsoil material shall be defined as natural, fertile, agricultural soil, capable of sustaining vigorous plant growth, uniform composition throughout admixture of subsoil, free of stones, lumps, plants, and their roots, sticks, or other extraneous matter; do not deliver while in a frozen or muddy condition.

**2.02 FERTILIZER**

- A. Provide a commercial balanced fertilizer delivered to the job in bags labeled with manufacturer's guaranteed analysis. Store in weatherproof storage, place in such a manner that its effectiveness will not be impaired.
- B. Fertilizer shall be a grade containing the percentages of plant food elements by weight as specified elsewhere in these specifications.
- C. Availability of various elements shall be per Standards of the Association of Official Agricultural Chemists.

**2.03 GRASS SEED**

- A. Grass seed shall be of the previous season's crop and the date of analysis shown on each bag shall be within nine (9) months of the time of delivery to the project. When requested by the Owner or Representative, the seeding contractor shall furnish a sample of seed from each bag for testing.
- B. The seed shall comply with all provisions of the U.S. Department of Agriculture as to labeling, purity, and germination.

**2.04 MULCHING**

- A. Dry straw or hay of good quality, free of seeds of competing plants and at such rate of 1 1/2 - 2 tons per acre; or,
- B. Wood cellulose or cane fiber mulch at a rate of 1,000 pounds per acre when the slope is 3/4:1 and steeper; or,
- C. A combination of good quality dry straw or hay free of seeds of competing plants at a rate of 2 1/2 tons per acre and wood cellulose or cane fiber mulch at a rate of 500 pounds per acre. This combination shall be used when the slope is flatter than 3/4:1; or,
- D. Sericea lespedza seed bearing hay at a rate of 3 tons per acre. This mulch may be applied green or air dried, but must contain mature seed.
- E. Manufactured mulch materials, such as soil retention blankets, erosion control netting, or others that may be required on special areas of high water concentration or unstable soils. When these materials are used, follow the manufacturer's recommendations for installation.

**2.05 HYDRO-MULCHING**

Wood cellulose fiber or cane fiber mulch will be applied with hydraulic seeding and fertilizing equipment. All slurry ingredients shall be mixed to form a homogeneous slurry and spray applied within one hour after the mixture is made.

When wood cellulose or cane fiber mulch is used at the 500 pound per acre rate, straw or hay mulch with asphalt emulsion is applied over this to complete the mulch.

Wood cellulose or cane fiber mulch at the 1,000 pound per acre rate is used alone where other mulch material will not stick.

Wood cellulose or cane fiber mulch is self anchoring.

**PART III - EXECUTION**

**3.01 RESPONSIBILITY**

The site grading contractor will be responsible to stockpile acceptable topsoil in a sufficient quantity to provide four inches (4") minimum cover for all grass areas, including but not limited to all curbed islands, and topsoil planting mounds/berms at the appropriate height and width as defined and shown on the landscaping and/or planting drawings. The topsoil and grass areas shall be further defined as any area disturbed during the grading and construction process.

The site grading contractor, shall be responsible to spread the topsoil within all perimeter graded areas and future building areas only.

The site grading contractor shall be responsible for backfilling of all curbed islands and planting mounds/berms. They shall also be responsible for removal of all stones, roots, and raking of all topsoil areas hat are to be seeded and/or planted. It will also be the site grading contractor's responsibility to provide fertilizer, grass seed, and any additional topsoil required and mulching.

**3.02 GRASS SEEDING**

- A. Remove stones, roots, rubbish and other deleterious materials from topsoiled areas that are to be seeded.
- B. Immediately prior to sowing seed, scarify ground as necessary; rake until surface is smooth and friable. Sow seed evenly, lightly wood rake into ground, then roll ground with suitable roller; water thoroughly with fine spray. During any weather, keep lawn watered with sprinklers or other approved methods. Re-seed any areas not doing well or damaged. At intervals as may be required according to seasonal conditions, mow and water grass and execute necessary weeding until acceptable and full stand of grass has been obtained.
- C. Provide permanent grass seeding for lawn areas so indicated. Seed in accordance with the following schedule (unless otherwise directed by Owner or Owner's Representative):
  - 1. Sow areas ready for seeding between March 1 and October 1 with Hulled Common Bermuda at a rate of 85 pounds per acre.
  - 2. Sow areas ready for seeding between October 1 and March 1 with Unhulled Common Bermuda at a rate of 90 pounds per acre, and Annual Rye Grass at the rate of 50 pounds per acre.
  - 3. Apply fertilizer at a rate of 20/25 pounds per 1,000 square feet.

**3.03 WILD FLOWERS**

- A. Areas indicated on plans to receive wild flower coverage shall be fine graded, fertilized, and prepared in a manner similar to traditional turf establishment.
- B. Area to be hydromulched with seed mix as follows:
 

Tickseed	10 pounds/acre
Cosmos	15 pounds/acre
Ox-Eyed Daisy	5 pounds/acre
Side Oats Grama	4 pounds/acre
Showy Primrose	0.5 pounds/acre
Plains Coreopsis	2 pounds/acre
Black Eyed Susan	2 pounds/acre
Indian Blanket	10 pounds/acre
Texas Bluebonnet	4 pounds/acre
Little Bluestem	4 pounds/acre

**3.04 MULCH**

- A. All areas to be seeded shall be mulched.
- B. Mulch materials shall be applied uniformly over the seeded area. Mulch shall be straw and shall be at the rate of 1 1/2 - 2 tons per acre
- C. Mulch shall be anchored with an emulsified asphalt binder at the rate of 10 gallons per 1,000 square feet.

**3.05 PROTECTION**

Provide, at no additional cost to Owner, fencing, railing, wire or other types of protection for topsoiled and seeded areas against trespassing and damage. If lawns are damaged prior to Final Acceptance, treat or replace them as directed. Remove protection when so directed.

**3.06 MAINTENANCE**

Provide maintenance from start of work until Final Acceptance. Maintenance includes watering of lawns, weeding, mowing, edging, repairs of wash-outs and gullies, repairs to protection, and other necessary work of maintenance. Maintain slopes against erosion.

**3.07 REHYDROMULCHING**

The Owner's representative will designate areas to be replanted. Areas on which a stand of growing grass is not present in a reasonable length of time, (Bermuda grass seed should be germinating in 6-8 days) shall be prepared, reseeded and remulched, as specified for original planting at no additional cost to Owner. A stand shall be defined as live plants from seed occurring at a rate of not less than 1,000 growing plants per square foot. Replanting required because of faulty operations or negligence on the part of the Contractor shall be performed without cost to Owner.

**3.08 FINAL CLEAN-UP**

- A. At time of final inspection of work, and before final acceptance, clean paved areas that are soiled or stained by operations of work of this section. Clean by sweeping or washing, and remove all defacements or stains.
- B. Remove construction equipment, excess material and tools. Cart away from site any debris resulting from work of this section and dispose of as directed.

**END OF SECTION**

**SECTION 02922**  
**SODDING**

**PART I - GENERAL**

**1.01 DESCRIPTION**

- A. Work Included
  - 1. Sod bed preparation
  - 2. Fertilizing
  - 3. Sodding
  - 4. Miscellaneous management practices
- B. Related Work Specified Elsewhere
  - 1. Finish Grading, Section 02800
  - 2. Lawns and Grasses, Section 02930

**1.02 REFERENCE STANDARDS**

- A. Standardized Plant Names
 

American Joint Committee of Horticultural Nomenclature, Second Edition, 1942.
- B. Texas Highway Department - Standard Specifications for Construction, Item 164, Seeding for Erosion Control.

**1.03 SUBMITTALS**

- A. Vendors Certification That Sod Meets Texas State Sod Law
  - 1. Include labeling requirements.
  - 2. Include purity and type.

**1.04 PRODUCT DELIVERY, STORAGE AND HANDLING**

- A. Sod:
  - 1. Previous season's crop with date of analysis on each bag.
  - 2. Furnish and deliver each variety in separate bags or containers.
  - 3. Sod to be cut no more than three days before delivery.
- B. Fertilizer:
  - 1. Unopened bags labeled with the analysis.
  - 2. Conform to Texas Fertilizer Law.

**1.05 JOB CONDITIONS**

- A. Planting Season:
  - 1. Only during suitable weather and soil conditions.
  - 2. As specifically authorized by the Owner's Representative.
- B. Schedule - Only after all other construction is complete.
- C. Protect and Maintain Sodded Areas
  - 1. From traffic and all other use.
  - 2. Until sodding is complete and accepted.

**PART II - PRODUCTS**

**2.01 MATERIALS**

- A. Sod:
  - 1. Sod: As specified on drawings, weed, insect, and disease free having a minimum of 1 inch of topsoil attached to the roots and cut no more than three days prior to installation.
  - 2. The sod shall be cut in strips of at least 1/2 sq. yd. and not more than 1 sq. yd. Sod shall be cut into strips not less than 12" in width or more than 9' in length. At the time of harvest, the top growth shall not exceed 3" in length.
  - 3. All sod shall conform to the laws of the State and shall be obtained from sources meeting the approval of the Department of Agriculture, Division of Entomology.
- B. Fertilizer:
  - 1. Uniform in composition, free flowing.
  - 2. Suitable for application in approved equipment.
  - 3. Analysis of 16-20-0, 16-8-8 or as directed.
- C. Water:
  - 1. Free of oil, acid, alkali, salts or other substances harmful to growth of grasses.

**PART III - EXECUTION**

**3.01 SOD BED PREPARATION**

- A. Cultivate to a depth of four (4") inches by disking and tilling with a power tiller.
- B. Clear surfaces of all materials:
  - 1. Stumps, stones, and other objects larger than one inch (1").
  - 2. Roots, brush, wire, stakes, etc.
  - 3. Any objects that may interfere with sodding or maintenance.
- C. Prepare sod bed:
  - 1. Remove soil clods larger than one inch (1").
  - 2. Grade areas to smooth, even surface, removing ridges and filling depressions. Final grade to be below finish grade of curbing and edging as shown on details. All grades shall meet approval of Owner's Representative before sodding.

**3.02 SODDING**

- A. Sodding:
  - 1. Lightly water prepared grade, lay sod with staggered joints and with edges touching. Topdress with topsoil at edges if necessary to provide smooth surface. On slopes of 2 to 1 and greater, fasten sod in place with wood pegs (two each piece) or other approved method. Sod damaged by storage or during installation shall be rejected. Following settling, topdress with screened, approved topsoil.
  - 2. Water and fertilize at 5 lbs. per 1,000 sq. ft.
  - 3. Sod shall not be placed during a drought, nor during periods when sod is not normally placed in the area, and shall not be placed on frozen ground. No dry or frozen sod is acceptable.
  - 4. The contractor shall keep all sodded areas moist and growing until Final Acceptance. All areas shall be maintained in an acceptable condition until acceptance by Owner.
- B. Rolling:
  - 1. After placing sod, roll with a hand roller, weighing not more than 100 lbs. per foot of width, in two directions.
  - 2. Eliminate all air pockets; finished surface should be free of excessive undulations.

**3.05 MAINTENANCE AND MANAGEMENT**

- A. Includes protection, replanting, maintaining grades, repair of erosion damage. Also includes weekly mowing at 1 1/2" height until final acceptance.
- B. Resodding:
  - 1. Resod damaged or unacceptable areas.
  - 2. Ruts, ridges, and other surface irregularities shall be corrected.

**END OF SECTION**



THIS ELECTRONIC DRAWING FILE IS RELEASED UNDER THE AUTHORITY OF GREG CUPPETT, LANDSCAPE ARCHITECT REGISTRATION NUMBER 2672 ON 09/23/20, WHO MAINTAINS THE ORIGINAL FILE. THIS ELECTRONIC DRAWING FILE MAY BE USED AS A BACKGROUND DRAWING, PURSUANT TO RULE 3.103(F) OF THE RULES AND REGULATIONS OF THE TEXAS BOARD OF ARCHITECTURAL EXAMINERS. THE USER OF THIS ELECTRONIC DRAWING FILE AGREES TO ASSUME ALL RESPONSIBILITY FOR ANY MODIFICATION TO OR USE OF THIS DRAWING FILE THAT IS INCONSISTENT WITH THE REQUIREMENTS OF THE RULES AND REGULATIONS OF THE TEXAS BOARD OF ARCHITECTURAL EXAMINERS. NO PERSON MAY MAKE MODIFICATIONS TO THIS ELECTRONIC DRAWING FILE WITHOUT THE LANDSCAPE ARCHITECT'S EXPRESS WRITTEN PERMISSION.

REVISED BUILDINGS	1	GAC	
	2	WRW	
	3	WRW	
	4	WRW	
	5	WRW	
	6	WRW	
	7	09-03-2020	07-08-2019
8	07-08-2019	HODGES MEETING COMMENTS	
9	07-08-2019	HODGES MEETING COMMENTS	
10	07-08-2019	HODGES MEETING COMMENTS	
11	07-01-2019	ACCESS REVISIONS & MARKUPS	
12	09-03-2019	40% SET	
13		REVISION	
14		DATE	
15	NO.		
Winkelmänn & Associates, Inc. CONSULTING CIVIL ENGINEERS ■ SURVEYORS 6720 HILLCREST PLAZA, SUITE 215 DALLAS, TEXAS 75231 (972) 496-7099 (972) 496-7099 FAX TEXAS ENGINEERS REGISTRATION NO. 89366-01 LICENSE EXPIRES 09/23/2019 WINKELMANN & ASSOCIATES, INC.			
<b>TURF SPECIFICATIONS</b>  STONEMONT DEVELOPMENT MCKINNEY, TEXAS			
L-12			
TURF SPECS			