

SEWELL



McKinney, Texas

SEWELL AUTOMOTIVE COMPANIES
3860 W. NORTHWEST HIGHWAY
SUITE 100
DALLAS, TEXAS 75220

5420 LBJ FREEWAY,
SUITE 1100
DALLAS TX 75240
TELEPHONE: 214.273.1500
FAX: 214.273.1505

Gensler

LAMBERT'S
LANDSCAPE ARCHITECTS
6333 DENTON DRIVE
DALLAS, TEXAS 75235

| Issue # | Issue Date | Issue Description |
|---------|------------|------------------------|
| C | 06/15/2015 | SITE PLAN REVIEW |
| D | 06/29/2015 | SITE PLAN RESUBMISSION |
| G | 07/06/2015 | SITE PLAN RESUBMISSION |

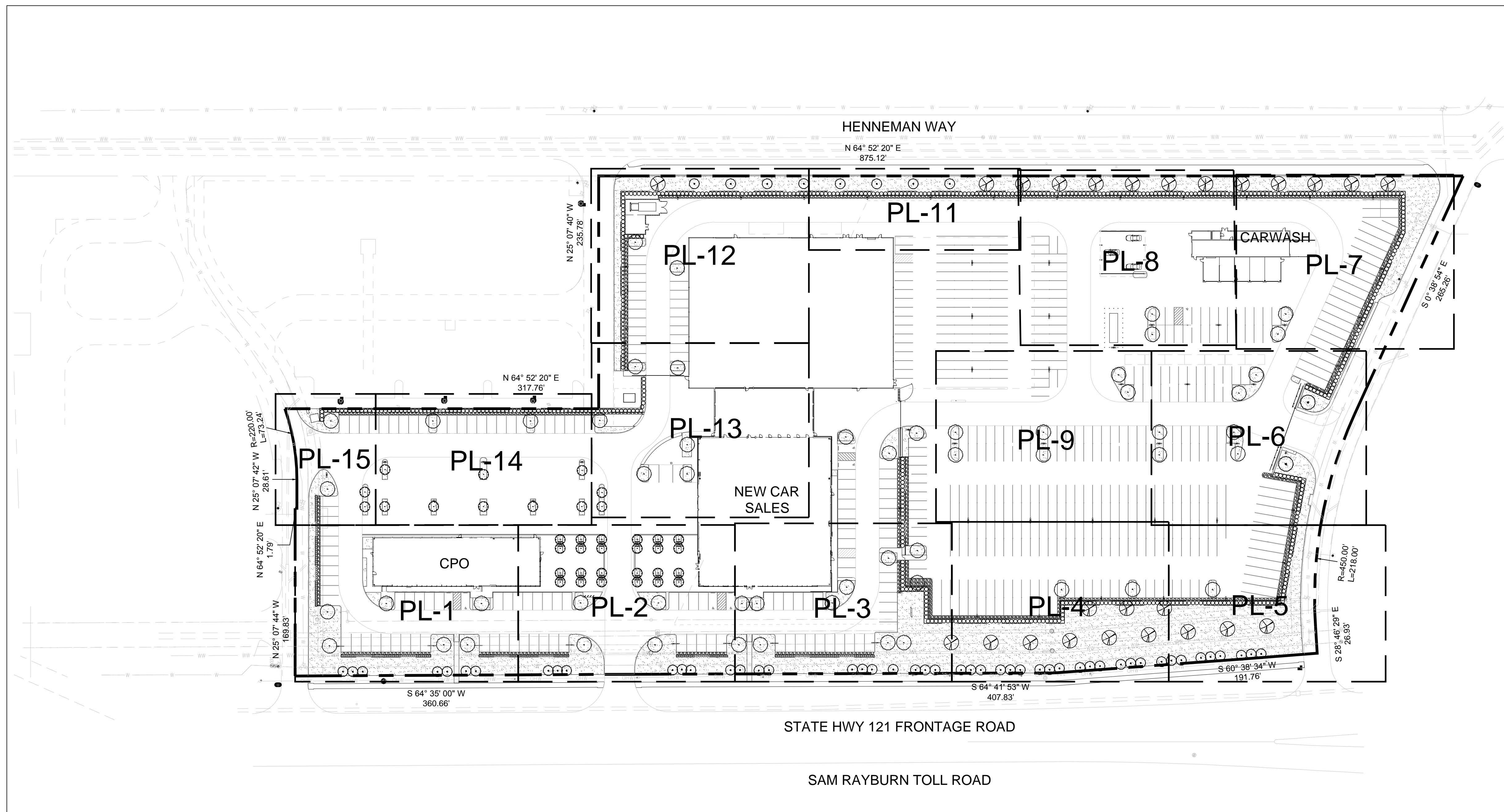

A SHEET LAYOUT

Seal/Signature _____



Project Name _____

Project Number _____

Description _____

Scale
1" = 60'-0"

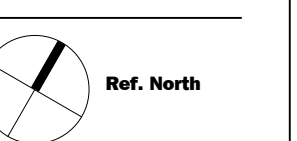

©2015 Gensler 0 15 30 60 120 FT

RECEIVED
By Planning Department at 2:07 pm, Jul 06, 2015

SEWELL



McKinney, Texas

SEWELL AUTOMOTIVE COMPANIES
3860 W. NORTHWEST HIGHWAY
SUITE 100
DALLAS, TEXAS 75220

5420 LBJ FREEWAY,
SUITE 1100
DALLAS TX 75240
TELEPHONE: 214.273.1500
FAX: 214.273.1505

Gensler

LAMBERT'S
LANDSCAPE ARCHITECTS
6333 DENTON DRIVE
DALLAS, TEXAS 75235

| Issue # | Issue Date | Issue Description |
|---------|------------|------------------------|
| C | 06/15/2015 | SITE PLAN REVIEW |
| D | 06/29/2015 | SITE PLAN RESUBMISSION |
| G | 07/06/2015 | SITE PLAN RESUBMISSION |

PLANTING SCHEDULE

| KEY | DESCRIPTION | SIZE | REMARKS |
|------------------------|---|---------------------------|--|
| TREES | | | |
| GB X | GINKGO BILOBA 'PRINCETON SENTRY' | 4" CALIPER, 14-16' HT. | UPRIGHT, SINGLE TRUNK; MALE SPECIMEN ONLY; BALL AND BURLAP |
| LI X | LAGESTROMIA INDICA 'NATCHEZ' CRAPE MYRTLE | 10' -12' HT. | MULTI- TRUNK; WHITE FLOWERING; 'SARAH'S FAVORITE' CAN BE USED AS ALTERNATE; THREE CANE MAXIMUM |
| QV X | QUERCUS VIRGINIANA LIVE OAK | 4" CALIPER, 14-16' HT. | UPRIGHT; BALL AND BURLAP |
| TA X | TAXODIUM ASCENDENS POND CYPRESS | 4" CALIPER, 14-16' HT. | UPRIGHT, 6' HT. CLEAR TRUNK; BALL AND BURLAP |
| UP X | ULMUS PARVIFOLIA 'BOSQUE' ELM | 4" CALIPER, 14-16' HT. | UPRIGHT, 6' HT. CLEAR TRUNK; BALL AND BURLAP |
| MC X | MYRICA CERIFERA WAX MYRTLE | 8' -10' HT.; 2" CAL. MIN. | UPRIGHT TREE FORM, MAX. 3-5 TRUNKS; BALL AND BURLAP |
| SHRUBS AND TURF | | | |
| IC X | ILEX CORNUTA 'DWARF BURFORD' HOLLY | 24" HT. MIN. | FULL TO POT |
| NRS X | ILEX X ATTENUATA 'NELLIE R. STEVENS' HOLLY | 6' HT.; MIN. 5' O.C. | SINGLE, STRAIGHT LEADER; FULL TO GROUND |
| TURF | ZOYSIA | SOD | REF. SPECIFICATIONS FOR PREP |

MATERIALS SCHEDULE

| KEY | DESCRIPTION | SIZE | REMARKS |
|-----------------------------|----------------------------------|------------------|------------------------------|
| AGGREGATE AND EDGING | | | |
| A-1 X | 'SILVER MIST' CRUSHED GRANITE | 1"-1 1/2" LENGTH | CLEAN; UNIFORM COLOR; WASHED |
| ST-1 X | STEEL EDGING | 10 GAUGE | DARK GREEN |

Seal/Signature



Project Name

Project Number

Description

Scale

THE CONTRACTOR SHALL VERIFY WATER RESTRICTIONS WITHIN THE CITY OF MCKINNEY AT TIME OF PLANTING. SHOULD WATER RESTRICTIONS NOT ALLOW HYDROMULCH, HYDROSEEDING, OR SPRIGGING (STAGE 3 AND STAGE 4 WATER RESTRICTIONS), AN APPROVED ALTERNATIVE FOR GRASSING SHALL BE INSTALLED.

SEWELL



Audi

McKinney, Texas

SEWELL AUTOMOTIVE COMPANIES
3860 W. NORTHWEST HIGHWAY
SUITE 100
DALLAS, TEXAS 75220

5420 LBJ FREEWAY,
SUITE 1100
DALLAS TX 75240
TELEPHONE: 214.273.1500
FAX: 214.273.1505

Gensler

LAMBERT'S
LANDSCAPE ARCHITECTS
6333 DENTON DRIVE
DALLAS, TEXAS 75235

| Issue # | Issue Date | Issue Description |
|---------|------------|------------------------|
| C | 06/15/2015 | SITE PLAN REVIEW |
| D | 06/29/2015 | SITE PLAN RESUBMISSION |
| G | 07/06/2015 | SITE PLAN RESUBMISSION |

REF. SHEET L5.0_PL-15

REF. SHEET L5.0_PL-14

REF. SHEET L5.0_PL-2

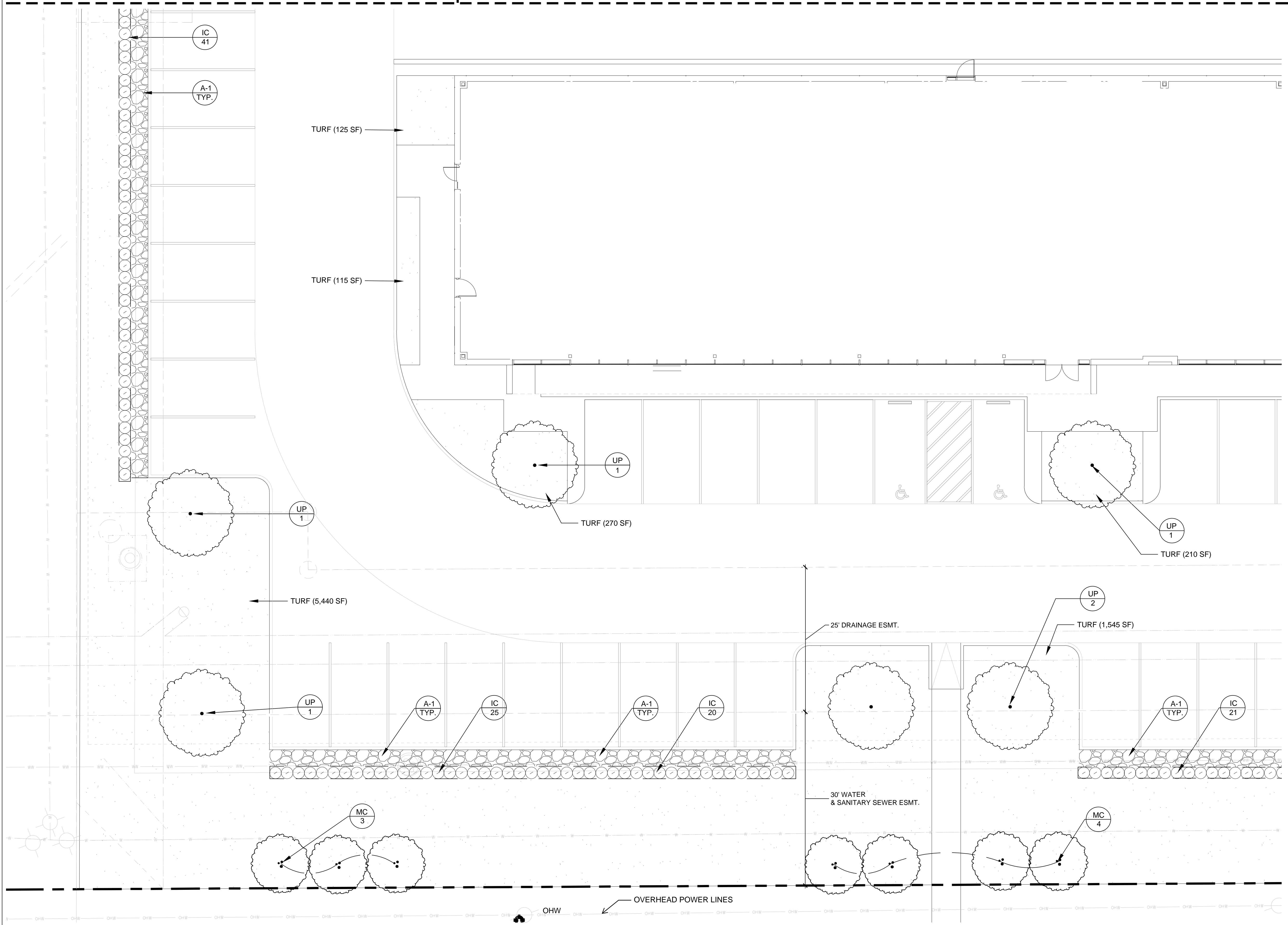

Seal/Signature



Project Name

Project Number

Description
PLANTING PLAN

Scale
1/8" = 1'-0"



L5.0_PL-1

©2015 Gensler 0 2 4 8 16 FT

THE CONTRACTOR SHALL VERIFY WATER RESTRICTIONS WITHIN THE CITY OF MCKINNEY AT TIME OF PLANTING. SHOULD WATER RESTRICTIONS NOT ALLOW HYDROMULCH, HYDROSEEDING, OR SPRIGGING (STAGE 3 AND STAGE 4 WATER RESTRICTIONS), AN APPROVED ALTERNATIVE FOR GRASSING SHALL BE INSTALLED.



McKinney, Texas

SEWELL AUTOMOTIVE COMPANIES
3860 W. NORTHWEST HIGHWAY
SUITE 100
DALLAS, TEXAS 75220

5420 LBJ FREEWAY,
SUITE 1100
DALLAS TX 75240
TELEPHONE: 214.273.1500
FAX: 214.273.1505

Gensler

LAMBERT'S
LANDSCAPE ARCHITECTS
6333 DENTON DRIVE
DALLAS, TEXAS 75235

| Issue # | Issue Date | Issue Description |
|---------|------------|------------------------|
| C | 06/15/2015 | SITE PLAN REVIEW |
| D | 06/29/2015 | SITE PLAN RESUBMISSION |
| G | 07/06/2015 | SITE PLAN RESUBMISSION |

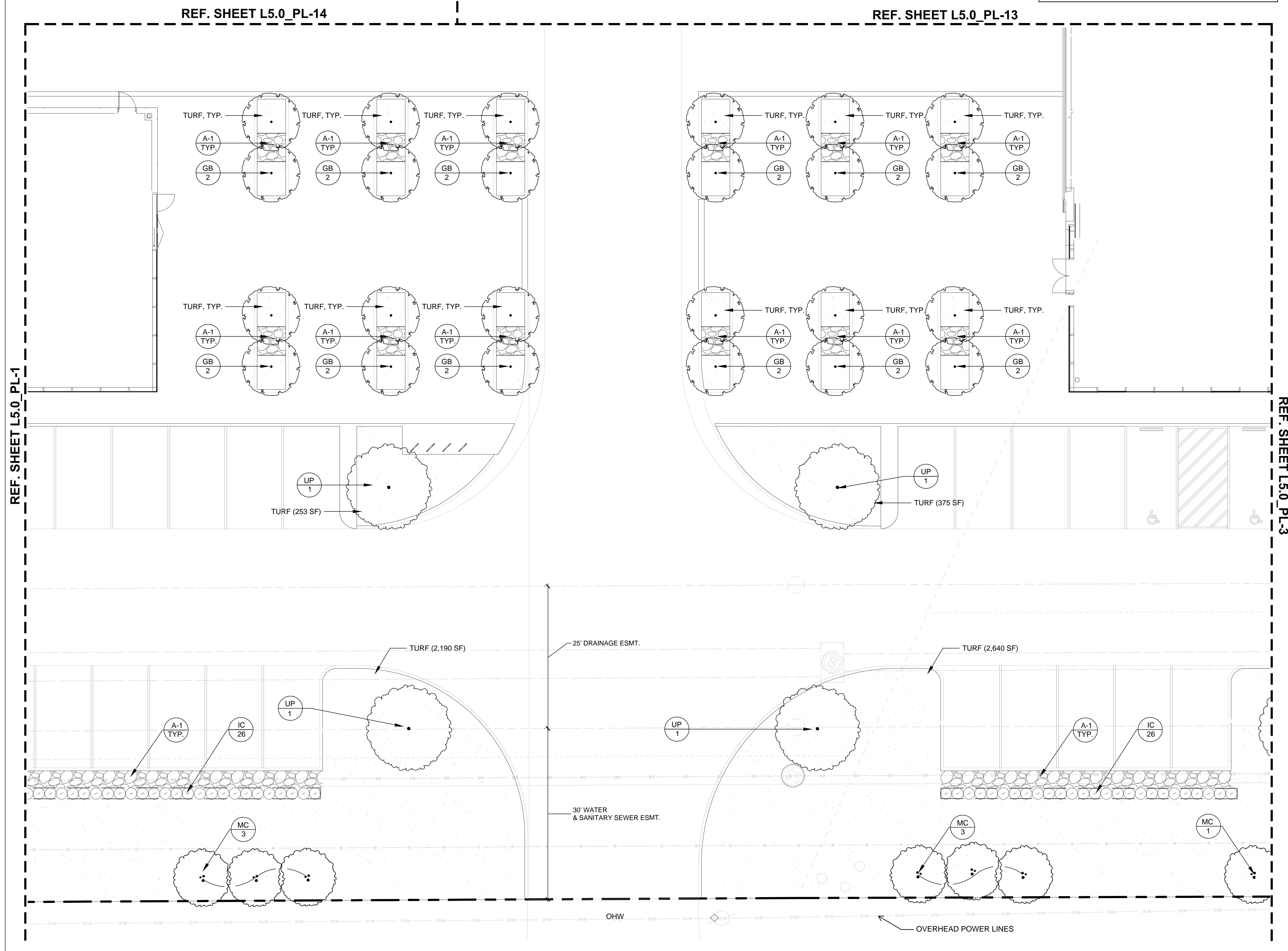

Seal/Signature _____

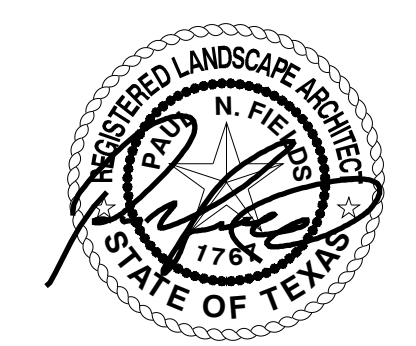

Project Name _____

Project Number _____

Description
PLANTING PLAN

Scale
1/8" = 1'-0"



L5.0_PL-2

©2015 Gensler 0 2 4 8 16 FT

THE CONTRACTOR SHALL VERIFY WATER RESTRICTIONS WITHIN THE CITY OF MCKINNEY AT TIME OF PLANTING. SHOULD WATER RESTRICTIONS NOT ALLOW HYDROMULCH, HYDROSEEDING OR SPRIGGING (STAGE 3 AND STAGE 4 WATER RESTRICTIONS), AN APPROVED ALTERNATIVE FOR GRASSING SHALL BE INSTALLED.

SEWELL



McKinney, Texas

SEWELL AUTOMOTIVE COMPANIES
3860 W. NORTHWEST HIGHWAY
SUITE 100
DALLAS, TEXAS 75220

5420 LBJ FREEWAY,
SUITE 1100
DALLAS TX 75240
TELEPHONE: 214.273.1500
FAX: 214.273.1505

Gensler

LAMBERT'S
LANDSCAPE ARCHITECTS
6333 DENTON DRIVE
DALLAS, TEXAS 75235

| Issue # | Issue Date | Issue Description |
|---------|------------|------------------------|
| C | 06/15/2015 | SITE PLAN REVIEW |
| D | 06/29/2015 | SITE PLAN RESUBMISSION |
| G | 07/06/2015 | SITE PLAN RESUBMISSION |

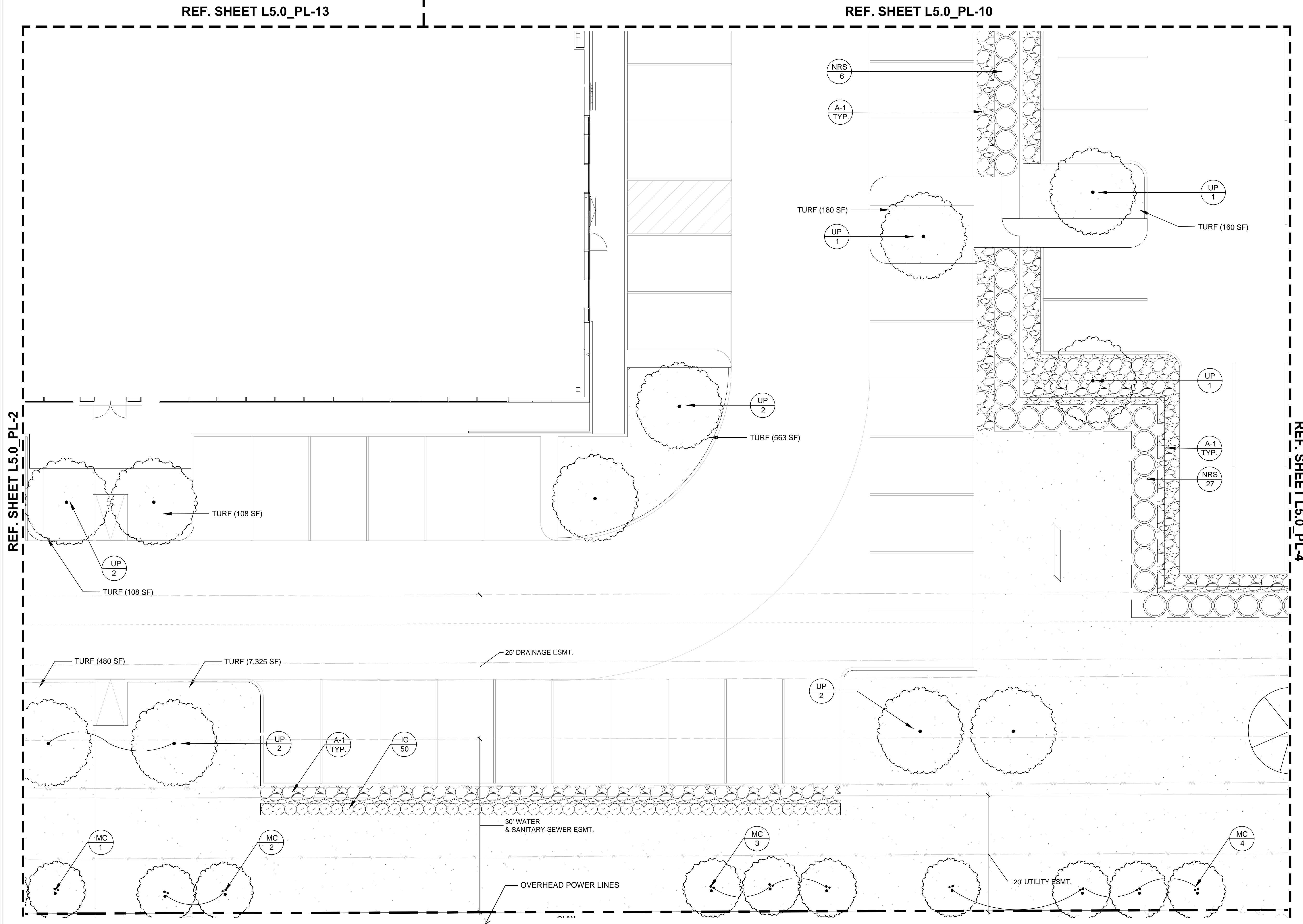

Seal/Signature _____



Project Name _____

Project Number _____

Description
PLANTING PLAN

Scale
1/8" = 1'-0"



L5.0_PL-3

©2015 Gensler 0 2 4 8 16 FT

THE CONTRACTOR SHALL VERIFY WATER RESTRICTIONS WITHIN THE CITY OF MCKINNEY AT TIME OF PLANTING. SHOULD WATER RESTRICTIONS NOT ALLOW HYDROMULCH, HYDROSEEDING OR SPRIGGING (STAGE 3 AND STAGE 4 WATER RESTRICTIONS), AN APPROVED ALTERNATIVE FOR GRASSING SHALL BE INSTALLED.

REF. SHEET L5.0_PL-9

SEWELL



McKinney, Texas

SEWELL AUTOMOTIVE COMPANIES
3860 W. NORTHWEST HIGHWAY
SUITE 100
DALLAS, TEXAS 75220

5420 LBJ FREEWAY,
SUITE 1100
DALLAS TX 75240
TELEPHONE: 214.273.1500
FAX: 214.273.1505

Gensler

LAMBERT'S
LANDSCAPE ARCHITECTS
6333 DENTON DRIVE
DALLAS, TEXAS 75235

| Issue # | Issue Date | Issue Description |
|---------|------------|------------------------|
| C | 06/15/2015 | SITE PLAN REVIEW |
| D | 06/29/2015 | SITE PLAN RESUBMISSION |
| G | 07/06/2015 | SITE PLAN RESUBMISSION |

REF. SHEET L5.0_PL-3

REF. SHEET L5.0_PL-5

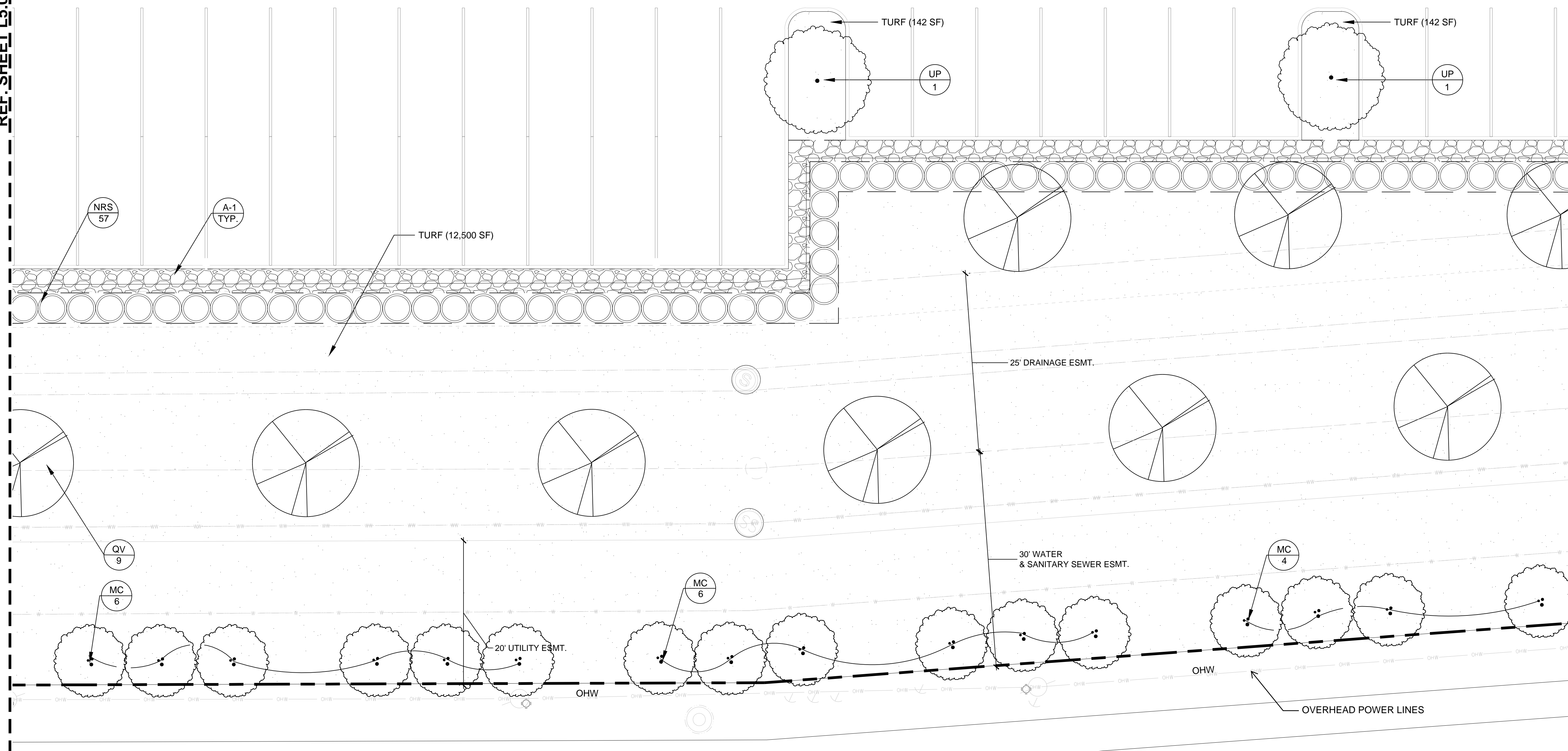

Seal/Signature



Project Name

Project Number

Description
PLANTING PLAN

Scale
1/8" = 1'-0"



L5.0_PL-4

©2015 Gensler 0 2 4 8 16 FT

THE CONTRACTOR SHALL VERIFY WATER RESTRICTIONS WITHIN THE CITY OF MCKINNEY AT TIME OF PLANTING. SHOULD WATER RESTRICTIONS NOT ALLOW HYDROMULCH, HYDROSEEDING OR SPRIGGING (STAGE 3 AND STAGE 4 WATER RESTRICTIONS), AN APPROVED ALTERNATIVE FOR GRASSING SHALL BE INSTALLED.

REF. SHEET L5.0_PL-6

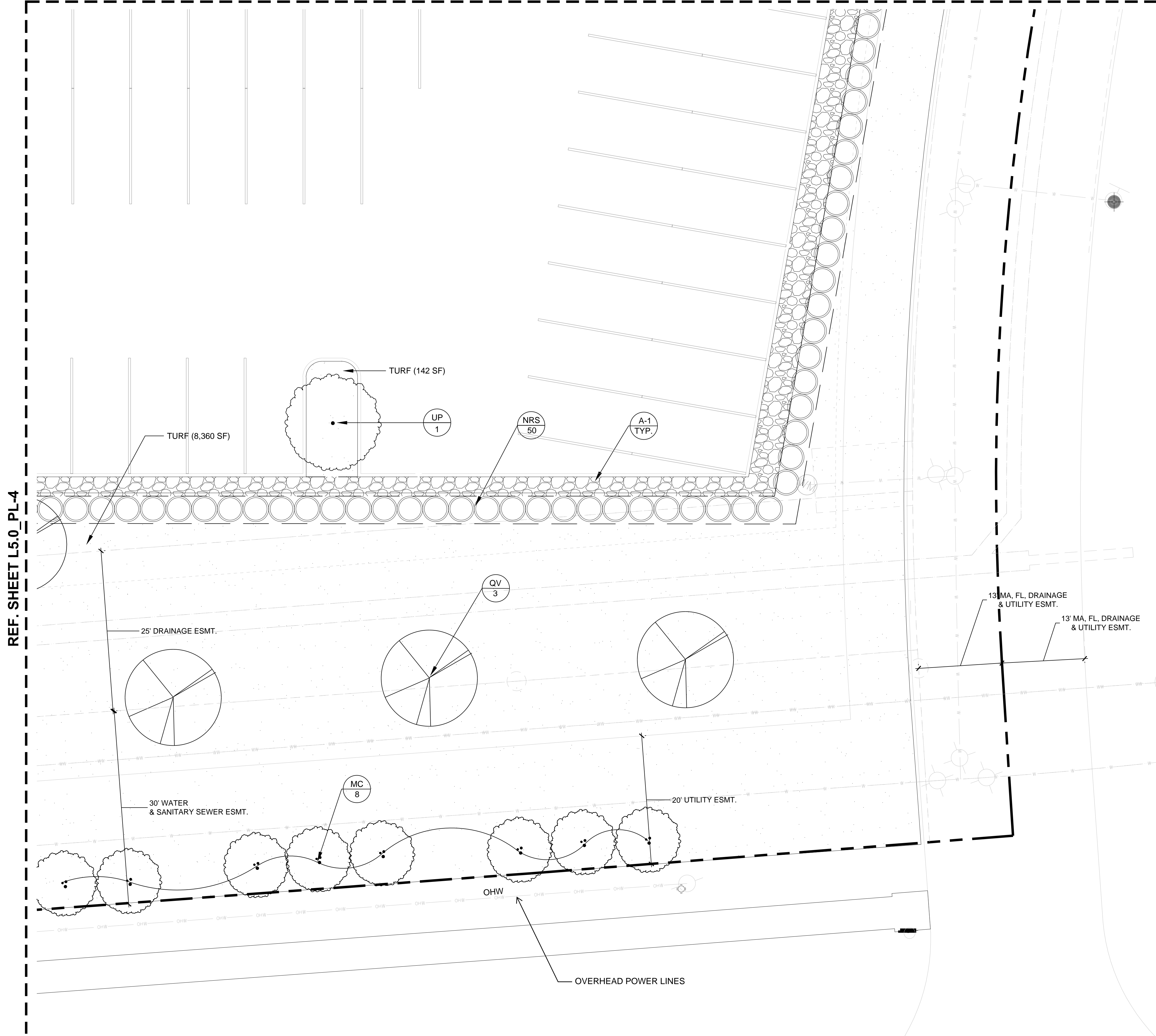

SEWELL



McKinney, Texas

SEWELL AUTOMOTIVE COMPANIES
3860 W. NORTHWEST HIGHWAY
SUITE 100
DALLAS, TEXAS 75220

5420 LBJ FREEWAY,
SUITE 1100
DALLAS TX 75240
TELEPHONE: 214.273.1500
FAX: 214.273.1505

Gensler

LAMBERT'S
LANDSCAPE ARCHITECTS
6333 DENTON DRIVE
DALLAS, TEXAS 75235

| Issue # | Issue Date | Issue Description |
|---------|------------|------------------------|
| C | 06/15/2015 | SITE PLAN REVIEW |
| D | 06/29/2015 | SITE PLAN RESUBMISSION |
| G | 07/06/2015 | SITE PLAN RESUBMISSION |

REF. SHEET L5.0_PL-4

Seal/Signature

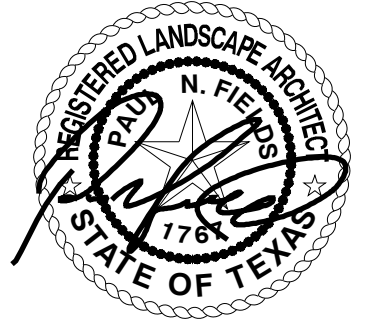

Project Name

Project Number

Description
PLANTING PLAN

Scale
1/8" = 1'-0"



L5.0_PL-5

©2015 Gensler 0 2 4 8 16 FT

REF. SHEET L5.0_PL-8

REF. SHEET L5.0_PL-7

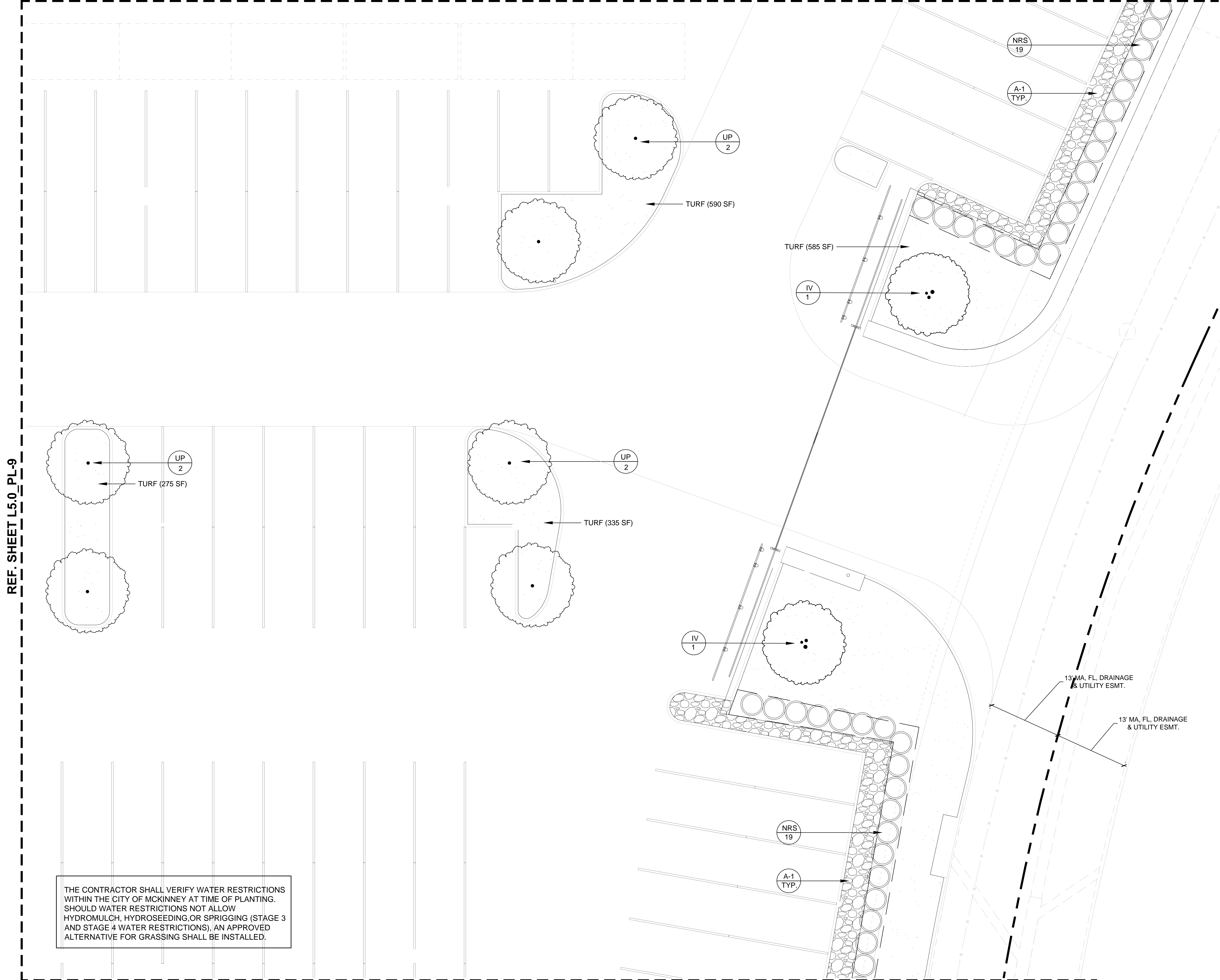

REF. SHEET L5.0_PL-9

THE CONTRACTOR SHALL VERIFY WATER RESTRICTIONS WITHIN THE CITY OF MCKINNEY AT TIME OF PLANTING. SHOULD WATER RESTRICTIONS NOT ALLOW HYDROMULCH, HYDROSEEDING OR SPRIGGING (STAGE 3 AND STAGE 4 WATER RESTRICTIONS), AN APPROVED ALTERNATIVE FOR GRASSING SHALL BE INSTALLED.

REF. SHEET L5.0_PL-5

SEWELL



McKinney, Texas

SEWELL AUTOMOTIVE COMPANIES
3860 W. NORTHWEST HIGHWAY
SUITE 100
DALLAS, TEXAS 75220

5420 LBJ FREEWAY,
SUITE 1100
DALLAS TX 75240
TELEPHONE: 214.273.1500
FAX: 214.273.1505

Gensler

LAMBERT'S
LANDSCAPE ARCHITECTS
6333 DENTON DRIVE
DALLAS, TEXAS 75235

| Issue # | Issue Date | Issue Description |
|---------|------------|------------------------|
| C | 06/15/2015 | SITE PLAN REVIEW |
| D | 06/29/2015 | SITE PLAN RESUBMISSION |
| G | 07/06/2015 | SITE PLAN RESUBMISSION |

Seal/Signature



Project Name

Project Number

Description
PLANTING PLAN

Scale
1/8" = 1'-0"



L5.0_PL-6

©2015 Gensler 0 2 4 8 16 FT

SEWELL



McKinney, Texas

SEWELL AUTOMOTIVE COMPANIES
3860 W. NORTHWEST HIGHWAY
SUITE 100
DALLAS, TEXAS 75220

5420 LBJ FREEWAY,
SUITE 1100
DALLAS TX 75240
TELEPHONE: 214.273.1500
FAX: 214.273.1505

Gensler

LAMBERT'S
LANDSCAPE ARCHITECTS
6333 DENTON DRIVE
DALLAS, TEXAS 75235

| Issue # | Issue Date | Issue Description |
|---------|------------|------------------------|
| C | 06/15/2015 | SITE PLAN REVIEW |
| D | 06/29/2015 | SITE PLAN RESUBMISSION |
| G | 07/06/2015 | SITE PLAN RESUBMISSION |

REF. SHEET L5.0_PL-8

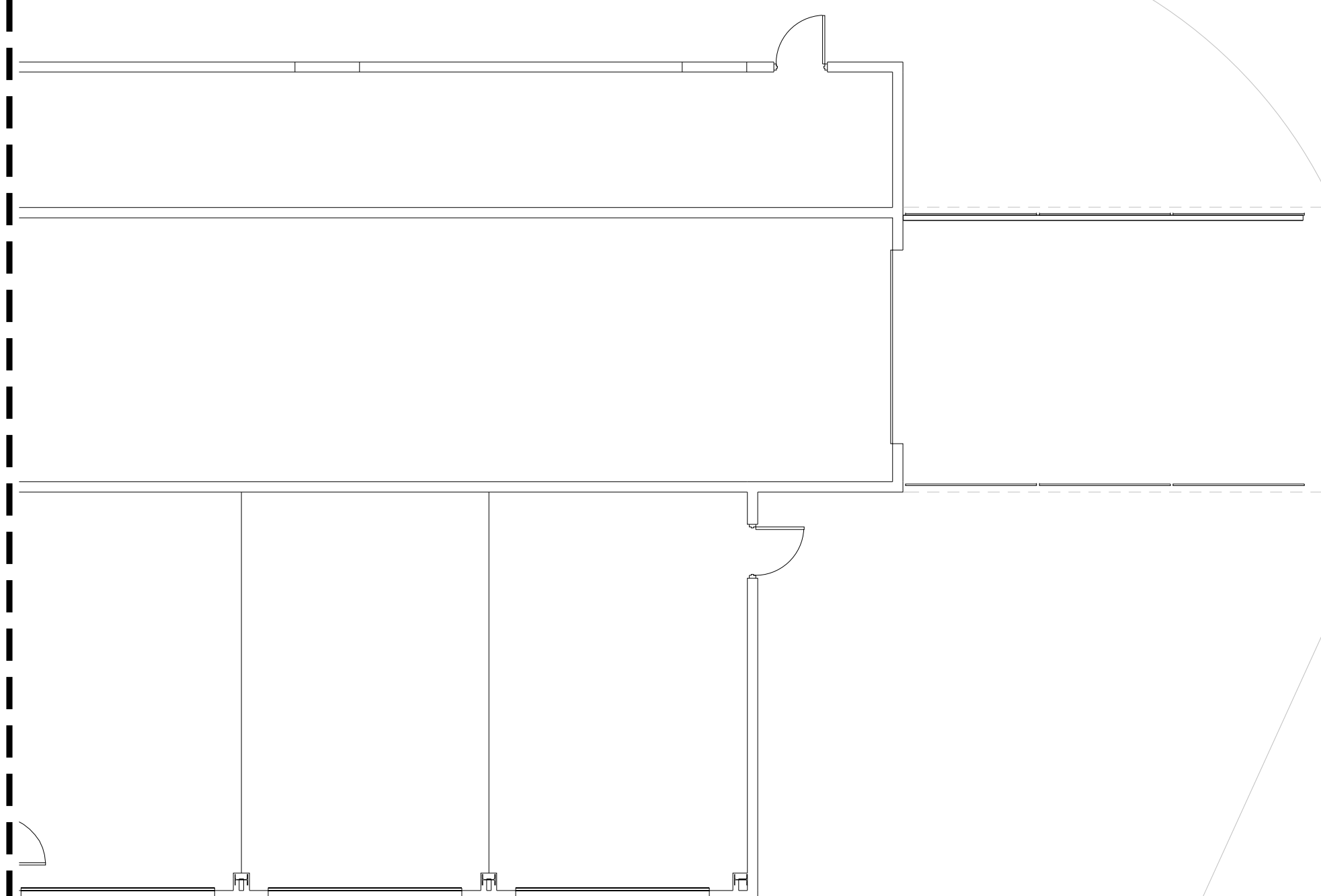

TURF (5,340 SF)

QV
5

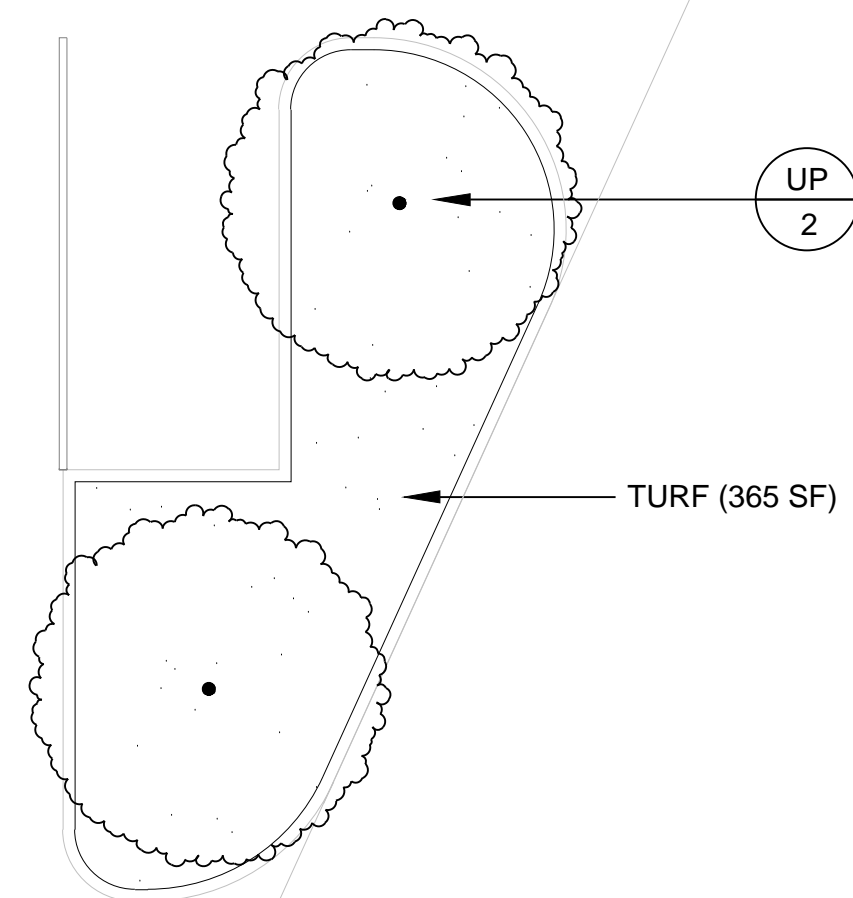

UP
2

TURF (365 SF)

NRS
85

A-1
TYP.

13' MA. FL. DRAINAGE
& UTILITY ESMT.

13' MA. FL. DRAINAGE
& UTILITY ESMT.

THE CONTRACTOR SHALL VERIFY WATER RESTRICTIONS WITHIN THE CITY OF MCKINNEY AT TIME OF PLANTING. SHOULD WATER RESTRICTIONS NOT ALLOW HYDROMULCH, HYDROSEEDING, OR SPRIGGING (STAGE 3 AND STAGE 4 WATER RESTRICTIONS), AN APPROVED ALTERNATIVE FOR GRASSING SHALL BE INSTALLED.

REF. SHEET L5.0_PL-6

Seal/Signature



Project Name

Project Number

Description
PLANTING PLAN

Scale
1/8" = 1'-0"



L5.0_PL-7

©2015 Gensler 0 2 4 8 16 FT

REF. SHEET L5.0_PL-11

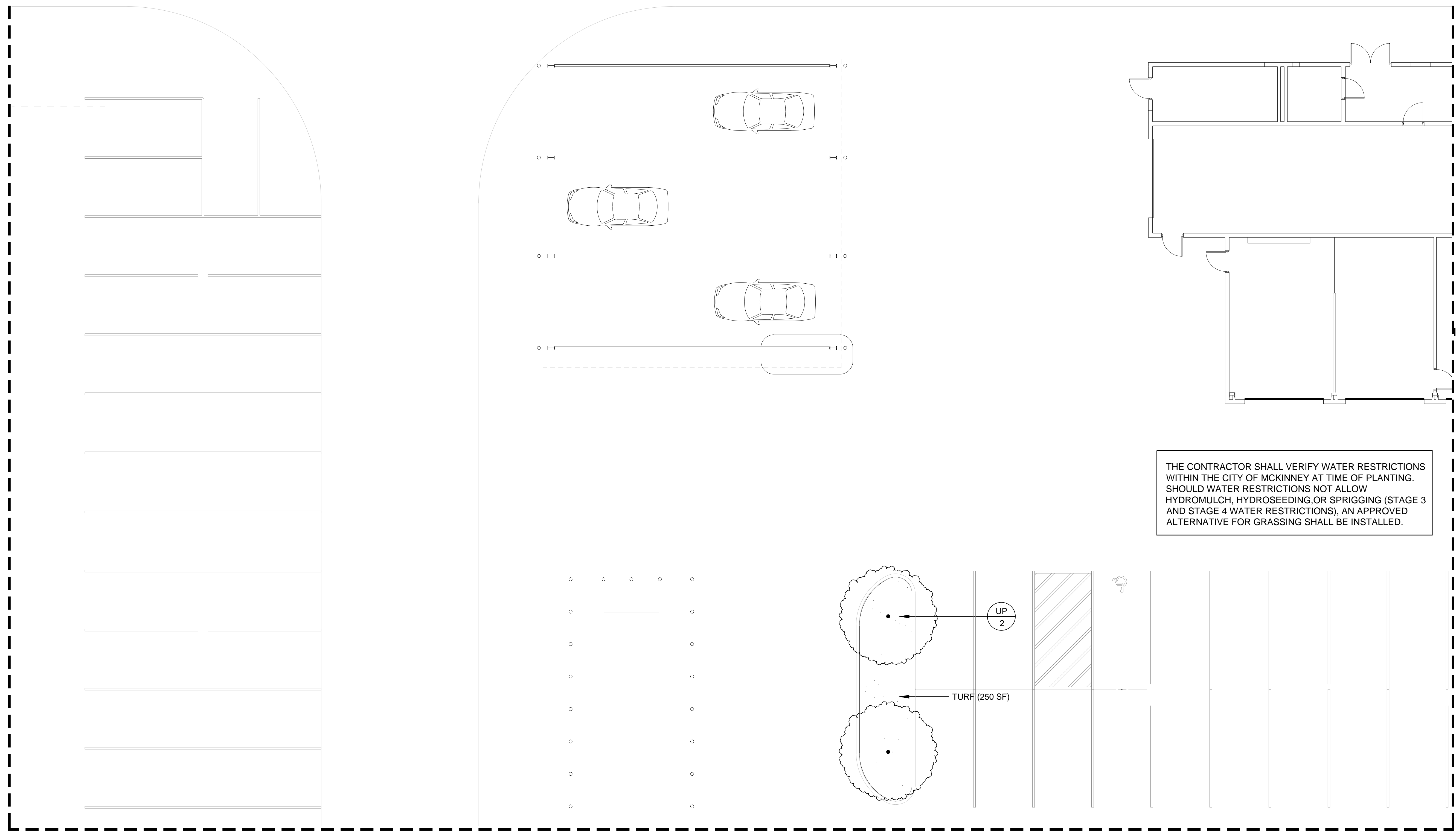
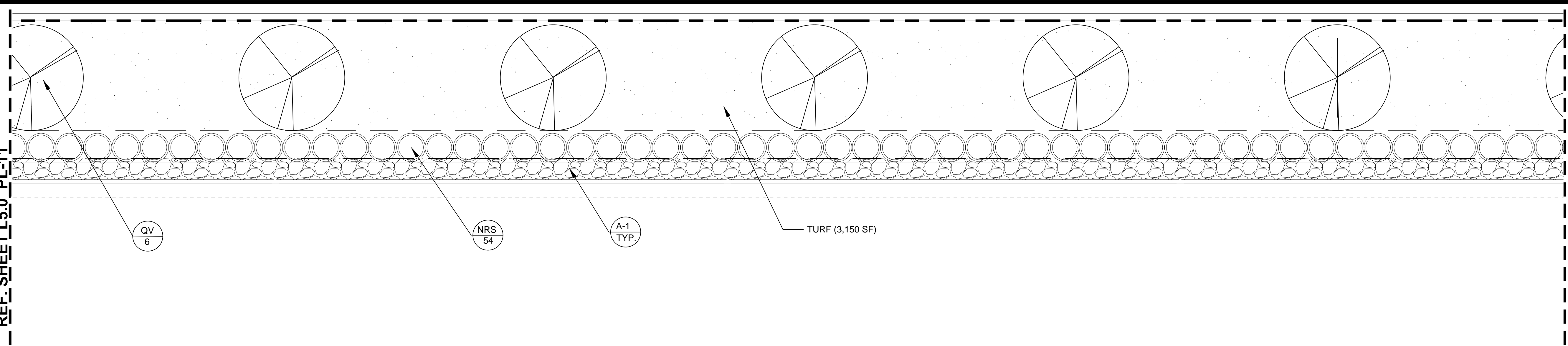

THE CONTRACTOR SHALL VERIFY WATER RESTRICTIONS WITHIN THE CITY OF MCKINNEY AT TIME OF PLANTING. SHOULD WATER RESTRICTIONS NOT ALLOW HYDROMULCH, HYDROSEEDING OR SPRIGGING (STAGE 3 AND STAGE 4 WATER RESTRICTIONS), AN APPROVED ALTERNATIVE FOR GRASSING SHALL BE INSTALLED.

REF. SHEET L5.0_PL-9



McKinney, Texas

SEWELL AUTOMOTIVE COMPANIES
 3860 W. NORTHWEST HIGHWAY
 SUITE 100
 DALLAS, TEXAS 75220

5420 LBJ FREEWAY,
 SUITE 1100
 DALLAS TX 75240
 TELEPHONE: 214.273.1500
 FAX: 214.273.1505

Gensler

LAMBERT'S
 LANDSCAPE ARCHITECTS
 6333 DENTON DRIVE
 DALLAS, TEXAS 75235

| Issue # | Issue Date | Issue Description |
|---------|------------|------------------------|
| C | 06/15/2015 | SITE PLAN REVIEW |
| D | 06/29/2015 | SITE PLAN RESUBMISSION |
| G | 07/06/2015 | SITE PLAN RESUBMISSION |

REF. SHEET L5.0_PL-7

Seal/Signature

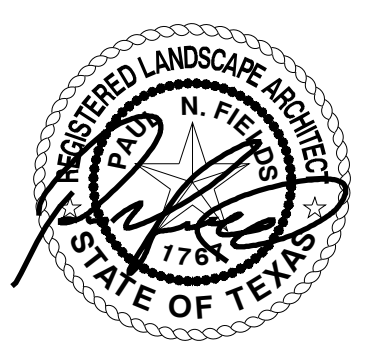

Project Name

Project Number

Description
PLANTING PLAN

Scale
1/8" = 1'-0"



L5.0_PL-8

©2015 Gensler
 0 2 4 8 16 FT



McKinney, Texas

SEWELL AUTOMOTIVE COMPANIES
3860 W. NORTHWEST HIGHWAY
SUITE 100
DALLAS, TEXAS 75220

5420 LBJ FREEWAY,
SUITE 1100
DALLAS TX 75240
TELEPHONE: 214.273.1500
FAX: 214.273.1505

Gensler

LAMBERT'S
LANDSCAPE ARCHITECTS
6333 DENTON DRIVE
DALLAS, TEXAS 75235

| Issue # | Issue Date | Issue Description |
|---------|------------|------------------------|
| C | 06/15/2015 | SITE PLAN REVIEW |
| D | 06/29/2015 | SITE PLAN RESUBMISSION |
| G | 07/06/2015 | SITE PLAN RESUBMISSION |

UP
2

TURF (410 SF)

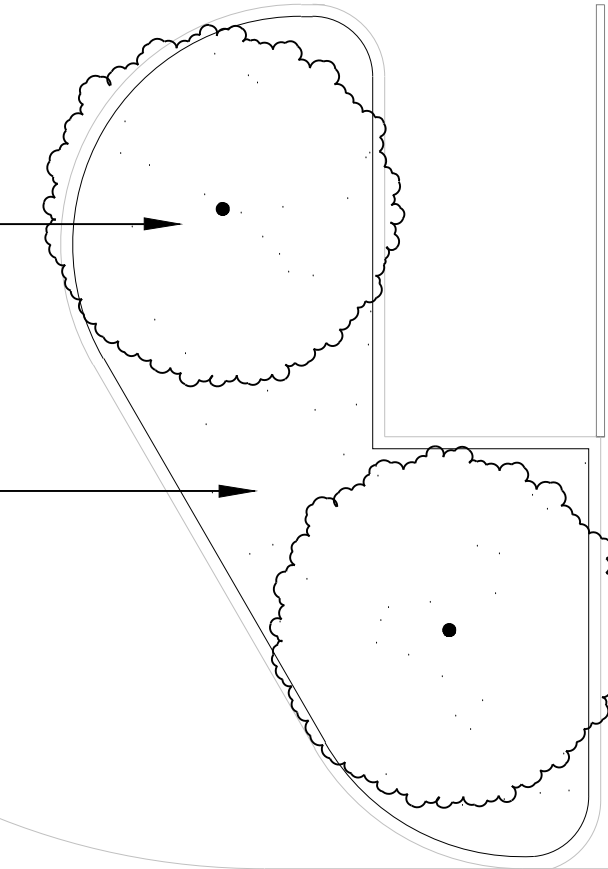

REF. SHEET L5.0_PL-10

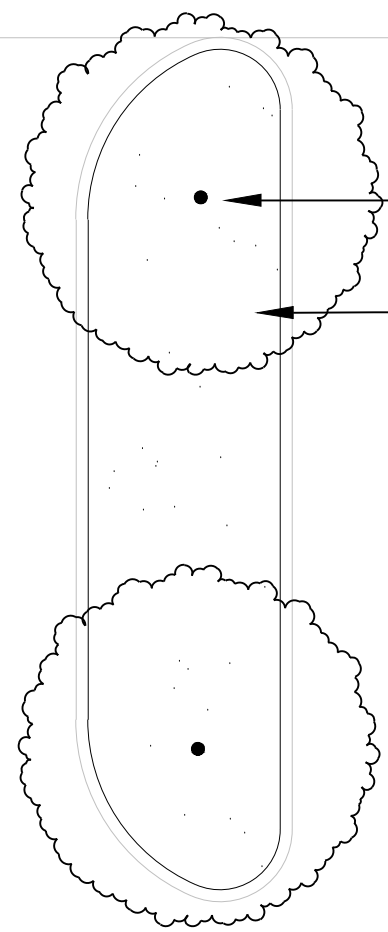

UP
2

TURF (245 SF)

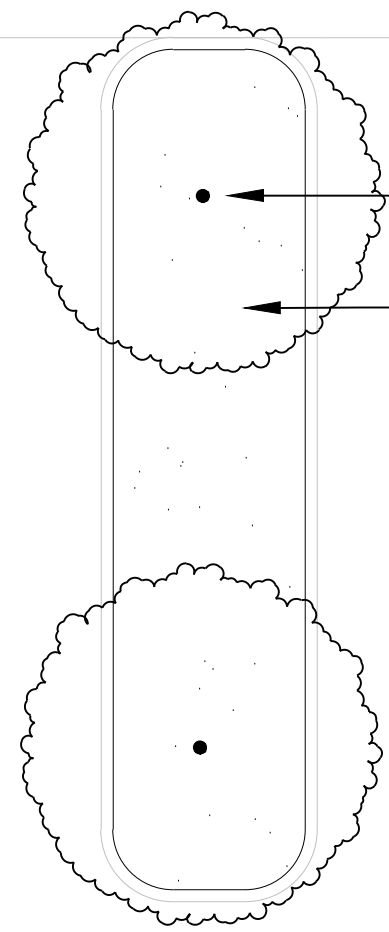

UP
2

TURF (275 SF)

REF. SHEET L5.0_PL-6

Seal/Signature



Project Name

Project Number

Description
PLANTING PLAN

Scale
1/8" = 1'-0"



L5.0_PL-9

©2015 Gensler 0 2 4 8 16 FT

THE CONTRACTOR SHALL VERIFY WATER RESTRICTIONS WITHIN THE CITY OF MCKINNEY AT TIME OF PLANTING. SHOULD WATER RESTRICTIONS NOT ALLOW HYDROMULCH, HYDROSEEDING, OR SPRIGGING (STAGE 3 AND STAGE 4 WATER RESTRICTIONS), AN APPROVED ALTERNATIVE FOR GRASSING SHALL BE INSTALLED.

THE CONTRACTOR SHALL VERIFY WATER RESTRICTIONS WITHIN THE CITY OF MCKINNEY AT TIME OF PLANTING. SHOULD WATER RESTRICTIONS NOT ALLOW HYDROMULCH, HYDROSEEDING OR SPRIGGING (STAGE 3 AND STAGE 4 WATER RESTRICTIONS), AN APPROVED ALTERNATIVE FOR GRASSING SHALL BE INSTALLED.

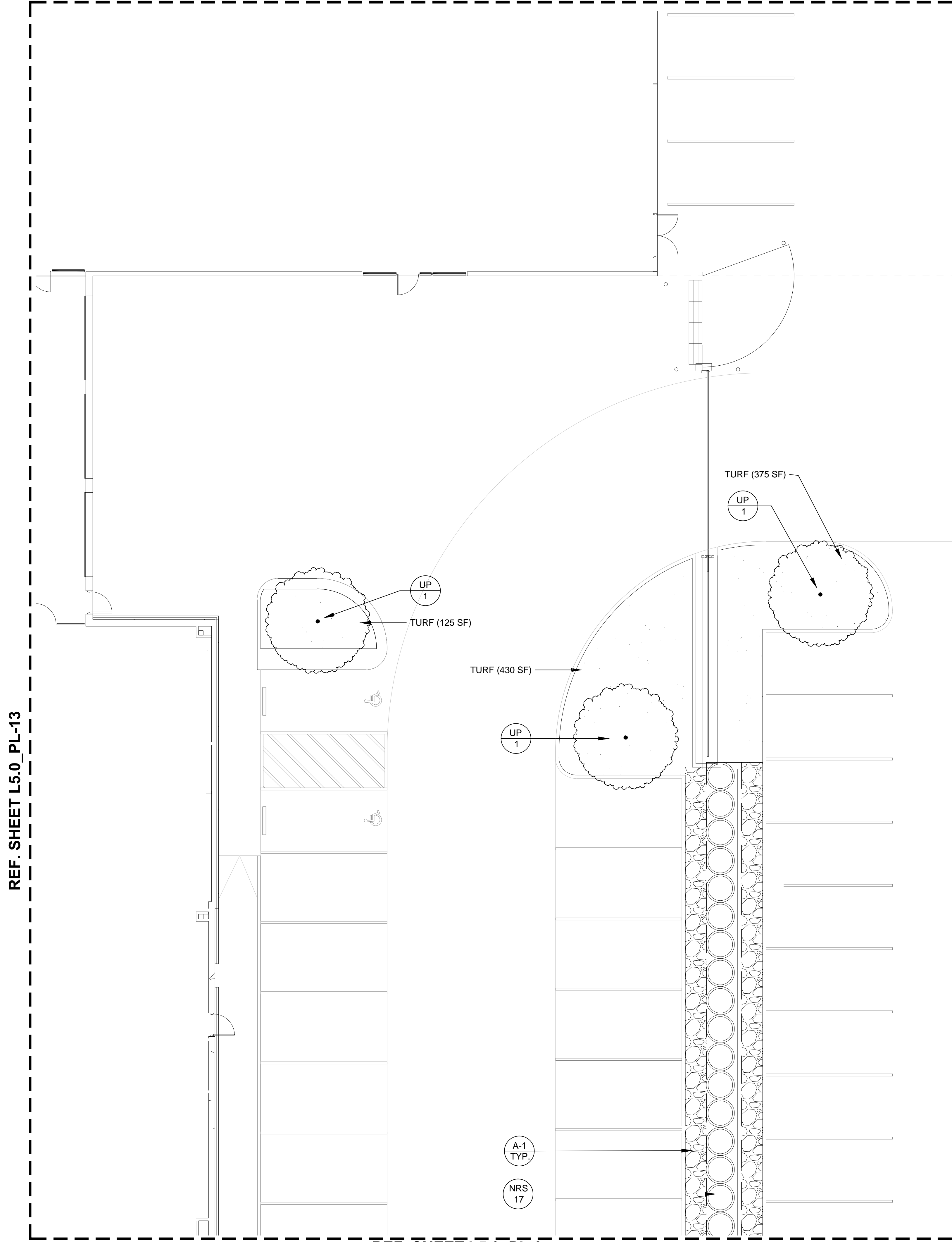

SEWELL



McKinney, Texas

SEWELL AUTOMOTIVE COMPANIES
3860 W. NORTHWEST HIGHWAY
SUITE 100
DALLAS, TEXAS 75220

5420 LBJ FREEWAY,
SUITE 1100
DALLAS TX 75240
TELEPHONE: 214.273.1500
FAX: 214.273.1505

Gensler

LAMBERT'S
LANDSCAPE ARCHITECTS
6333 DENTON DRIVE
DALLAS, TEXAS 75235

| Issue # | Issue Date | Issue Description |
|---------|------------|------------------------|
| C | 06/15/2015 | SITE PLAN REVIEW |
| D | 06/29/2015 | SITE PLAN RESUBMISSION |
| G | 07/06/2015 | SITE PLAN RESUBMISSION |

Seal/Signature

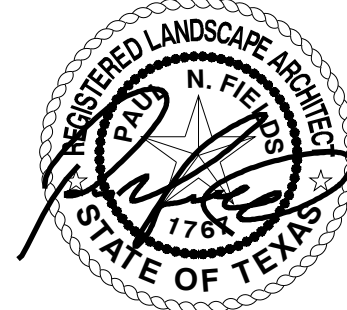

Project Name

Project Number

Description
PLANTING PLAN

Scale
1/8" = 1'-0"



L5.0_PL-10

©2015 Gensler 0 2 4 8 16 FT

SEWELL



McKinney, Texas

SEWELL AUTOMOTIVE COMPANIES
3860 W. NORTHWEST HIGHWAY
SUITE 100
DALLAS, TEXAS 75220

5420 LBJ FREEWAY,
SUITE 1100
DALLAS TX 75240
TELEPHONE: 214.273.1500
FAX: 214.273.1505

Gensler

LAMBERT'S
LANDSCAPE ARCHITECTS
6333 DENTON DRIVE
DALLAS, TEXAS 75235

| Issue # | Issue Date | Issue Description |
|---------|------------|------------------------|
| C | 06/15/2015 | SITE PLAN REVIEW |
| D | 06/29/2015 | SITE PLAN RESUBMISSION |
| G | 07/06/2015 | SITE PLAN RESUBMISSION |

THE CONTRACTOR SHALL VERIFY WATER RESTRICTIONS WITHIN THE CITY OF MCKINNEY AT TIME OF PLANTING. SHOULD WATER RESTRICTIONS NOT ALLOW HYDROMULCH, HYDROSEEDING, OR SPRIGGING (STAGE 3 AND STAGE 4 WATER RESTRICTIONS), AN APPROVED ALTERNATIVE FOR GRASSING SHALL BE INSTALLED.

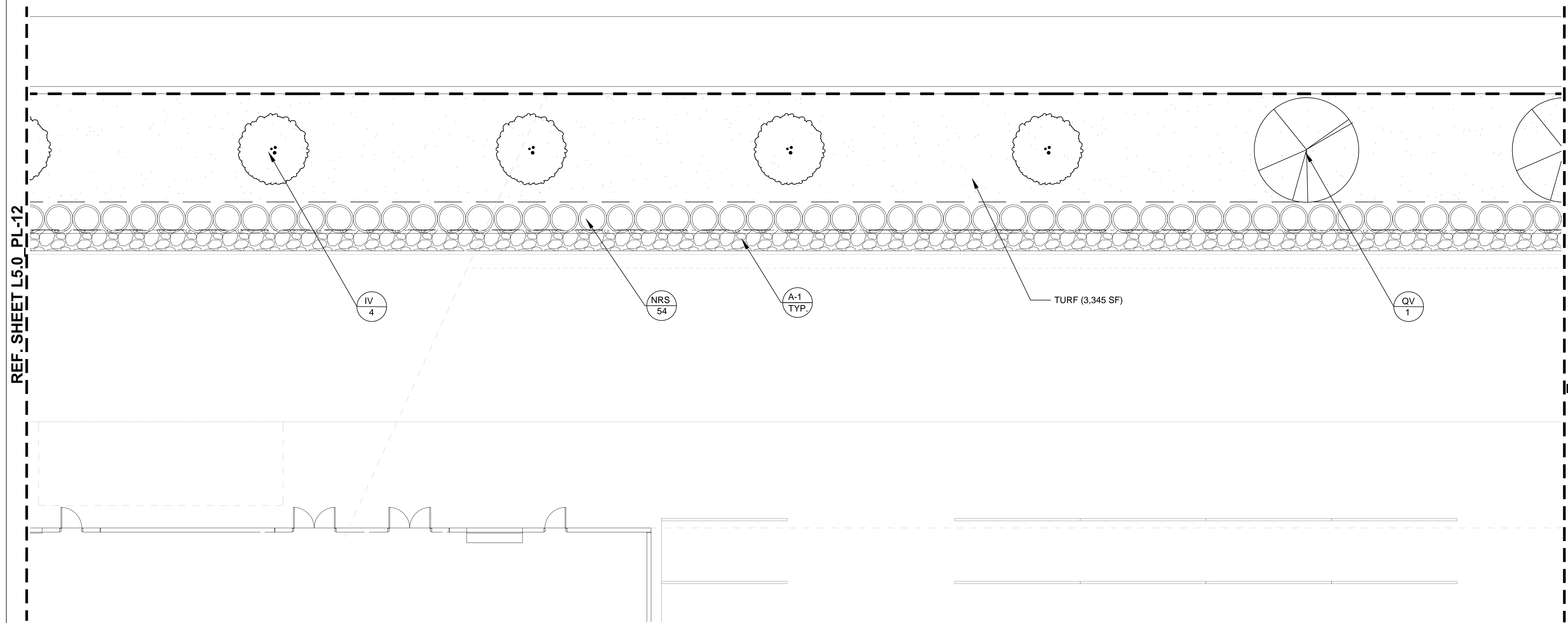

Seal/Signature _____



Project Name _____

Project Number _____

Description
PLANTING PLAN

Scale
1/8" = 1'-0"



L5.0_PL-11

©2015 Gensler



SEWELL



McKinney, Texas

SEWELL AUTOMOTIVE COMPANIES
3860 W. NORTHWEST HIGHWAY
SUITE 100
DALLAS, TEXAS 75220

5420 LBJ FREEWAY,
SUITE 1100
DALLAS TX 75240
TELEPHONE: 214.273.1500
FAX: 214.273.1505

Gensler

LAMBERT'S
LANDSCAPE ARCHITECTS
6333 DENTON DRIVE
DALLAS, TEXAS 75235

| Issue # | Issue Date | Issue Description |
|---------|------------|------------------------|
| C | 06/15/2015 | SITE PLAN REVIEW |
| D | 06/29/2015 | SITE PLAN RESUBMISSION |
| G | 07/06/2015 | SITE PLAN RESUBMISSION |

Seal/Signature



Project Name

Project Number

Description
PLANTING PLAN

Scale
1/8" = 1'-0"



L5.0_PL-12

©2015 Gensler 0 2 4 8 16 FT

REF. SHEET L5.0_PL-11

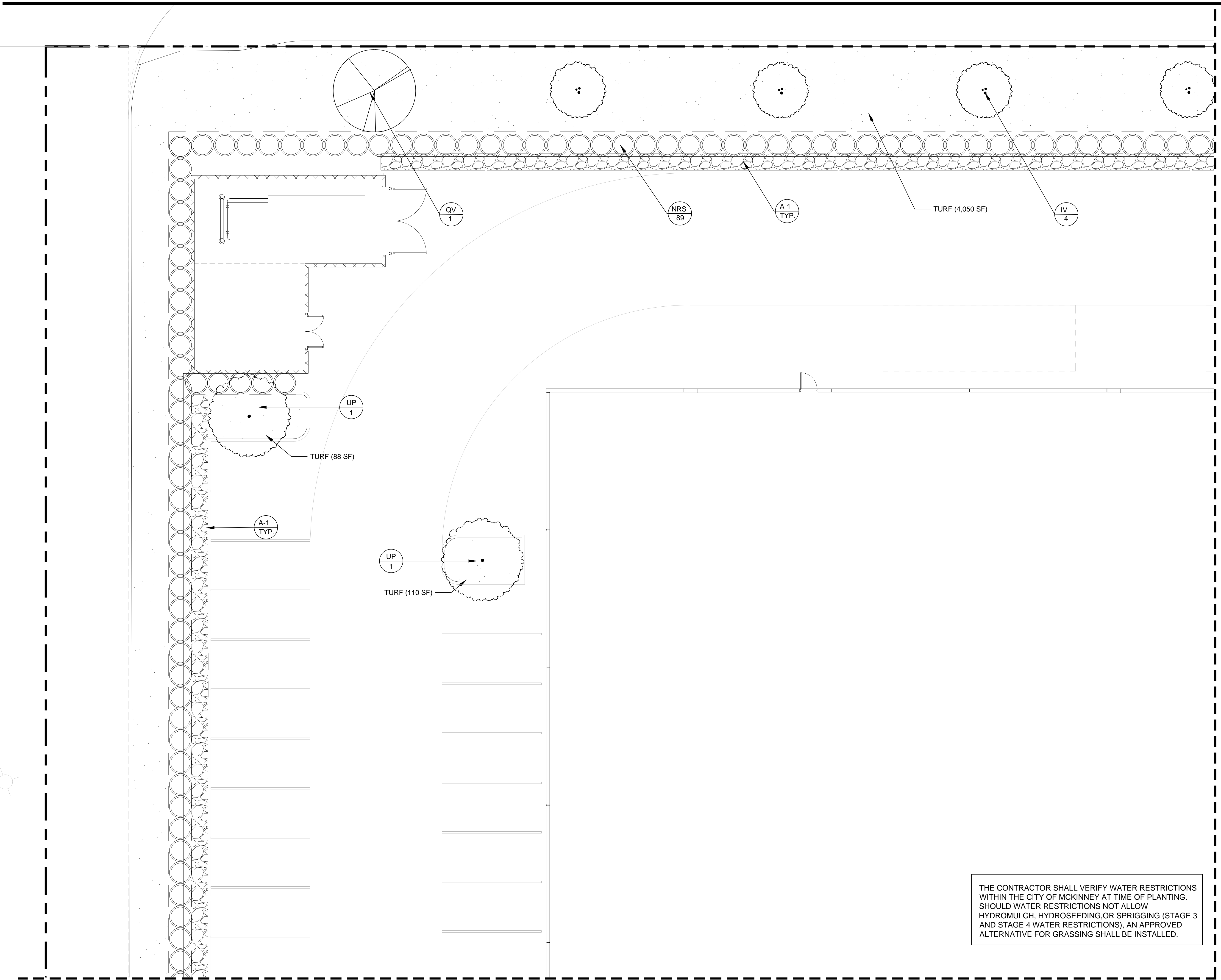

THE CONTRACTOR SHALL VERIFY WATER RESTRICTIONS WITHIN THE CITY OF MCKINNEY AT TIME OF PLANTING. SHOULD WATER RESTRICTIONS NOT ALLOW HYDROMULCH, HYDROSEEDING, OR SPRIGGING (STAGE 3 AND STAGE 4 WATER RESTRICTIONS), AN APPROVED ALTERNATIVE FOR GRASSING SHALL BE INSTALLED.

REF. SHEET L5.0_PL-13

THE CONTRACTOR SHALL VERIFY WATER RESTRICTIONS WITHIN THE CITY OF MCKINNEY AT TIME OF PLANTING. SHOULD WATER RESTRICTIONS NOT ALLOW HYDROMULCH, HYDROSEEDING, OR SPRIGGING (STAGE 3 AND STAGE 4 WATER RESTRICTIONS), AN APPROVED ALTERNATIVE FOR GRASSING SHALL BE INSTALLED.

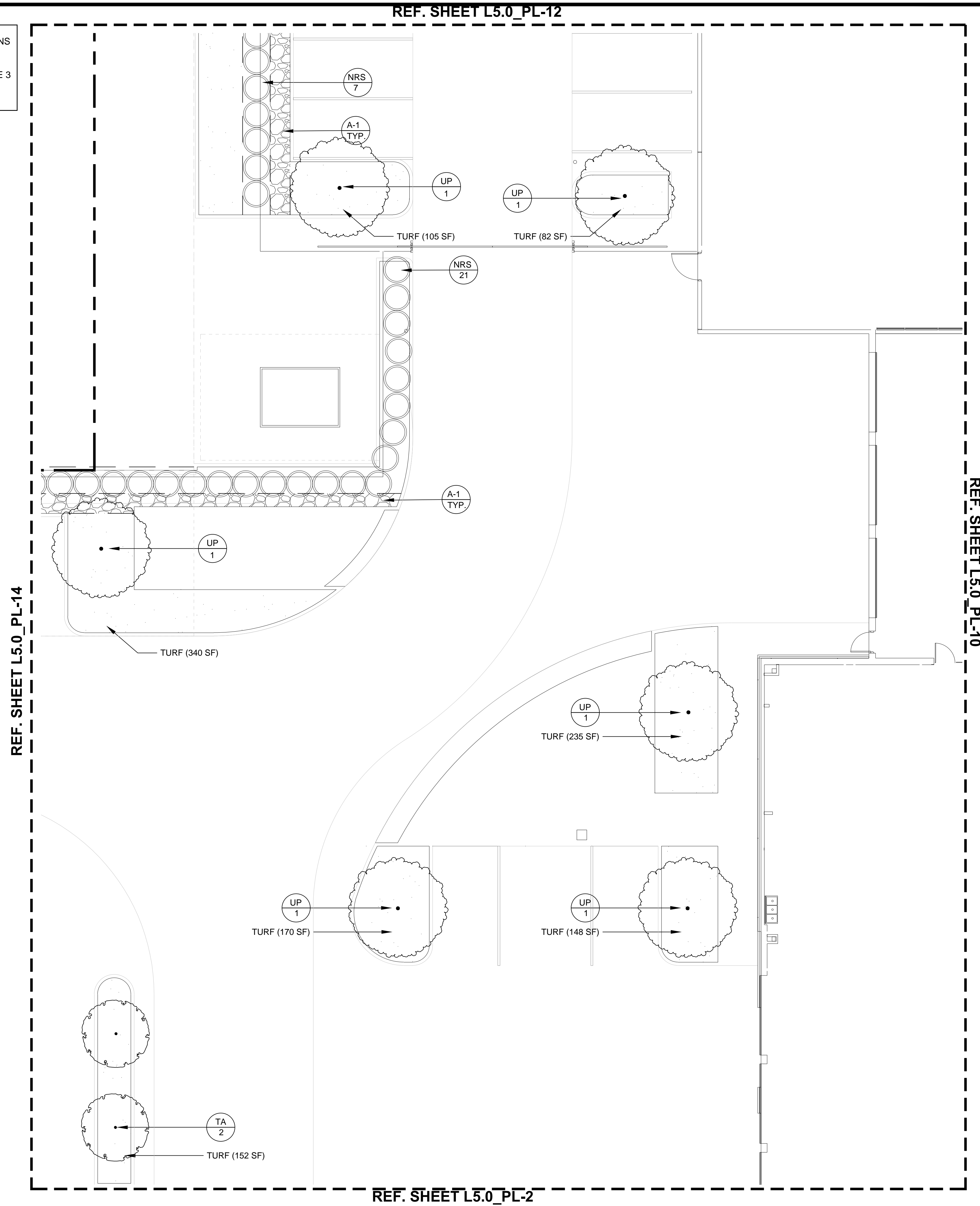

SEWELL



McKinney, Texas

SEWELL AUTOMOTIVE COMPANIES
3860 W. NORTHWEST HIGHWAY
SUITE 100
DALLAS, TEXAS 75220

5420 LBJ FREEWAY,
SUITE 1100
DALLAS TX 75240
TELEPHONE: 214.273.1500
FAX: 214.273.1505

Gensler

LAMBERT'S
LANDSCAPE ARCHITECTS
6333 DENTON DRIVE
DALLAS, TEXAS 75235

| Issue # | Issue Date | Issue Description |
|---------|------------|------------------------|
| C | 06/15/2015 | SITE PLAN REVIEW |
| D | 06/29/2015 | SITE PLAN RESUBMISSION |
| G | 07/06/2015 | SITE PLAN RESUBMISSION |

Seal/Signature



Project Name

Project Number

Description
PLANTING PLAN

Scale
1/8" = 1'-0"



L5.0_PL-13

©2015 Gensler



SEWELL



McKinney, Texas

SEWELL AUTOMOTIVE COMPANIES
3860 W. NORTHWEST HIGHWAY
SUITE 100
DALLAS, TEXAS 75220

5420 LBJ FREEWAY,
SUITE 1100
DALLAS TX 75240
TELEPHONE: 214.273.1500
FAX: 214.273.1505

Gensler

LAMBERT'S
LANDSCAPE ARCHITECTS
6333 DENTON DRIVE
DALLAS, TEXAS 75235

THE CONTRACTOR SHALL VERIFY WATER RESTRICTIONS WITHIN THE CITY OF MCKINNEY AT TIME OF PLANTING. SHOULD WATER RESTRICTIONS NOT ALLOW HYDROMULCH, HYDROSEEDING, OR SPRIGGING (STAGE 3 AND STAGE 4 WATER RESTRICTIONS), AN APPROVED ALTERNATIVE FOR GRASSING SHALL BE INSTALLED.

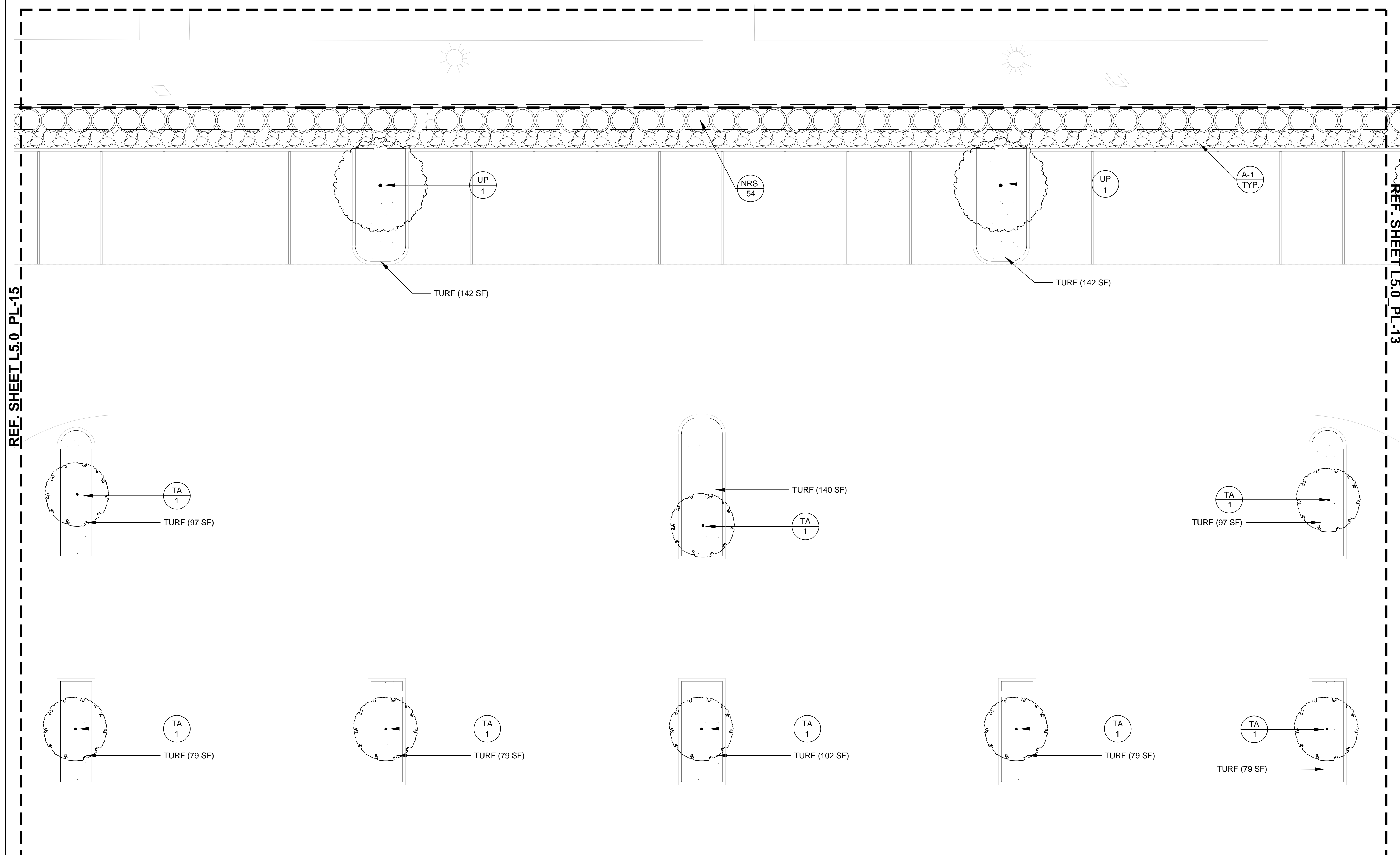

| Issue # | Issue Date | Issue Description |
|---------|------------|------------------------|
| C | 06/15/2015 | SITE PLAN REVIEW |
| D | 06/29/2015 | SITE PLAN RESUBMISSION |
| G | 07/06/2015 | SITE PLAN RESUBMISSION |

REF. SHEET L5.0_PL-15

REF. SHEET L5.0_PL-13

Seal/Signature



Project Name

Project Number

Description
PLANTING PLAN

Scale
1/8" = 1'-0"



L5.0_PL-14

©2015 Gensler



REF. SHEET L5.0_PL-1

SEWELL



McKinney, Texas

SEWELL AUTOMOTIVE COMPANIES
3860 W. NORTHWEST HIGHWAY
SUITE 100
DALLAS, TEXAS 75220

5420 LBJ FREEWAY,
SUITE 1100
DALLAS TX 75240
TELEPHONE: 214.273.1500
FAX: 214.273.1505

Gensler

LAMBERT'S
LANDSCAPE ARCHITECTS
6333 DENTON DRIVE
DALLAS, TEXAS 75235

THE CONTRACTOR SHALL VERIFY WATER RESTRICTIONS WITHIN THE CITY OF MCKINNEY AT TIME OF PLANTING. SHOULD WATER RESTRICTIONS NOT ALLOW HYDROMULCH, HYDROSEEDING, OR SPRIGGING (STAGE 3 AND STAGE 4 WATER RESTRICTIONS), AN APPROVED ALTERNATIVE FOR GRASSING SHALL BE INSTALLED.

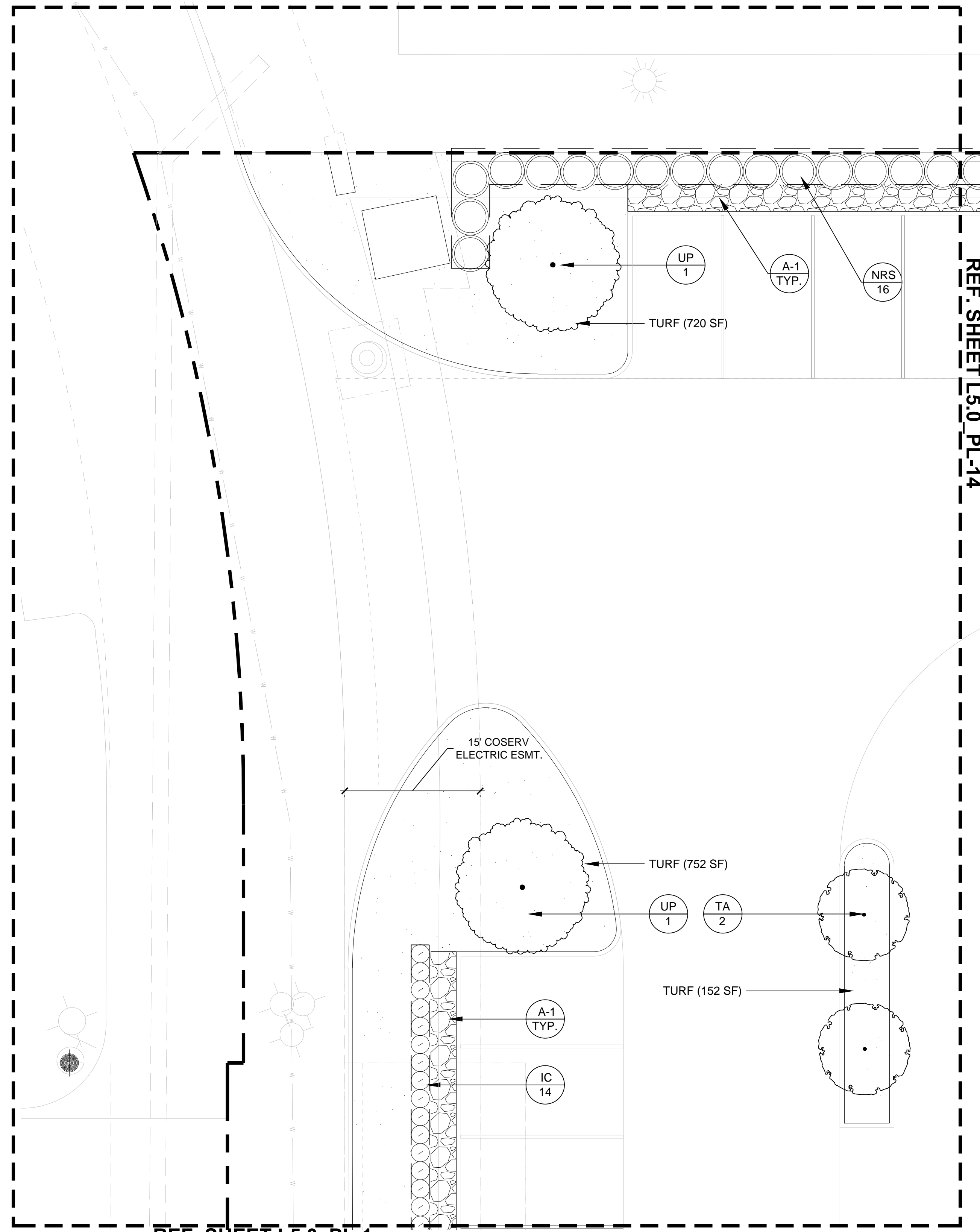

REF. SHEET L5.0_PL-14

REF. SHEET L5.0_PL-1

| Issue # | Issue Date | Issue Description |
|---------|------------|------------------------|
| C | 06/15/2015 | SITE PLAN REVIEW |
| D | 06/29/2015 | SITE PLAN RESUBMISSION |
| G | 07/06/2015 | SITE PLAN RESUBMISSION |

Seal/Signature



Project Name

Project Number

Description
PLANTING PLAN

Scale
1/8" = 1'-0"



L5.0_PL-15

©2015 Gensler 0 2 4 8 16 FT