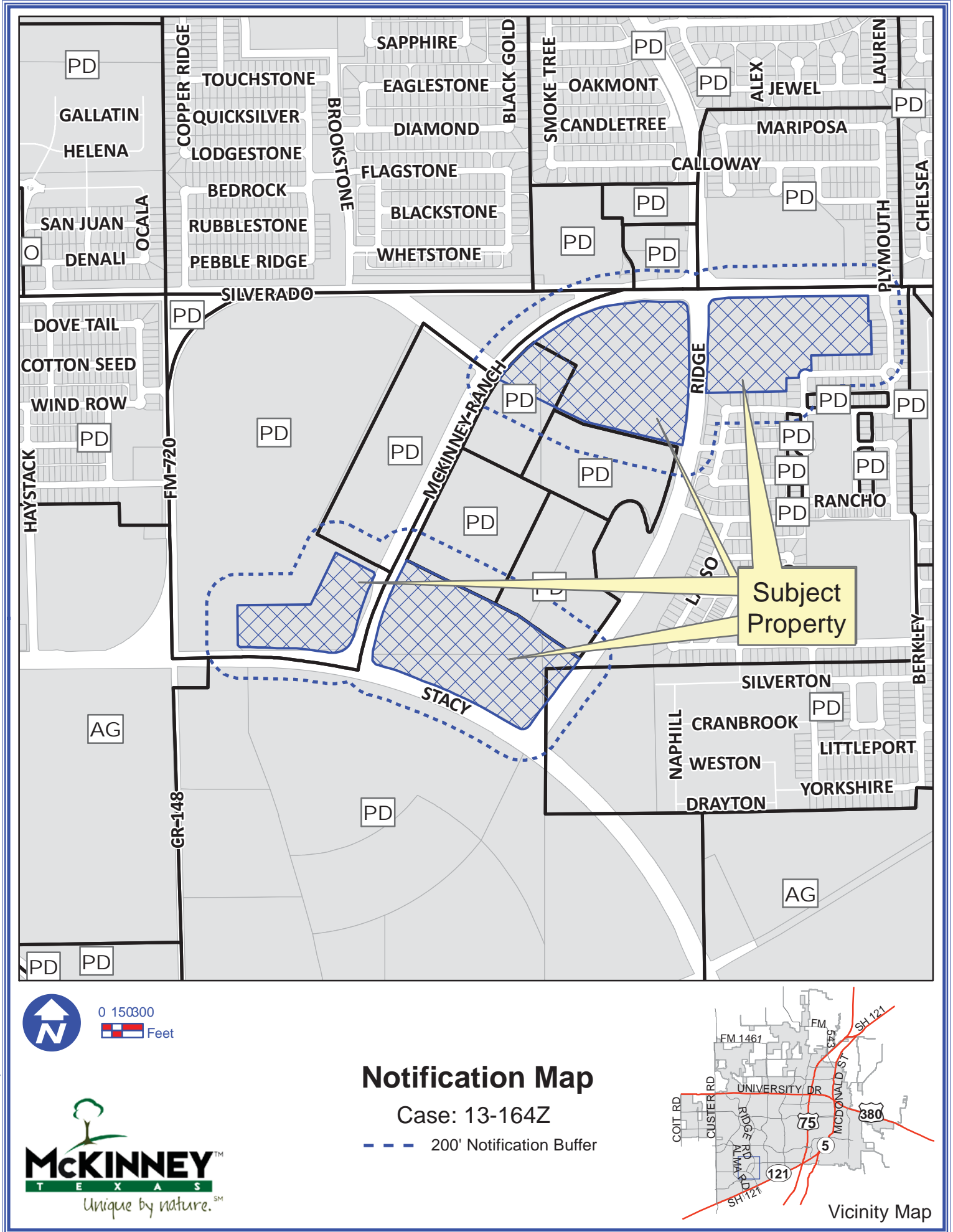

Exhibit A



DISCLAIMER: This map and information contained in it were developed exclusively for use by the City of McKinney. Any use or reliance on this map by anyone else is at that party's risk and without liability to the City of McKinney, its officials or employees for any discrepancies, errors, or variances which may exist.

Exhibit B

EXHIBIT

Scale: SEE GRAPHIC SCALE
Designed by: LAW
Drawn by: COR
Checked by: LAW
Date: APRIL 2013
Project No. 02105-001

ZONING EXHIBIT

MCKINNEY RANCH TOWNSHIP REZONE

THIS DRAWING IS TO BE USED FOR EXHIBIT PURPOSES ONLY

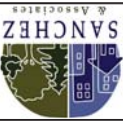

Master Planning (Civil) Engineering Land Development
2200 EAST VILLAGE STREET
MCKINNEY, TX 75069
TEL 972 424 3300
FAX 972 424 3300
CERTIFICATE OF REGISTRATION NO. F-58865

TRACT 4:

Being a tract of land situated in the George F. Lucas Survey, Abstract No. 560 and the Other Hedgebrook Survey, Abstract No. 561, located in the County of Tarrant, State of Texas, and being more particularly described in Volume 6074, Page 6221 of the Deed Records of Collin County, Texas, and being more particularly described in Volume 6074, Page 6221 of the Deed Records of Collin County, Texas, and being more particularly described in Volume 6074, Page 6221 of the Deed Records of Collin County, Texas, also being on the easterly line of Ridge Road as a variable width right-of-way.

BEGINNING at a point for the most westerly corner of South Clark McKinney Ranch Parcel 1, an addition BEING a tract of land situated in the George F. Lucas Survey, Abstract No. 560 and the Other Hedgebrook Survey, Abstract No. 561, located in the County of Tarrant, State of Texas, and being more particularly described in Volume 6074, Page 6221 of the Deed Records of Collin County, Texas, also being on the easterly line of Ridge Road as a variable width right-of-way;

THENCE along a curve to the left having a radius of 1362.00 feet, a central angle of 1 degree 25 minutes 28 seconds, and a chord which bears North 102 degrees 52 minutes 19 seconds East, 87.25 feet; to a northwesterly direction, an arc distance of 87.25 feet to a 5/8 inch iron rod set for corner in the easterly line of Ridge Road;

THENCE North 84 degrees 08 minutes 30 seconds East along the easterly line of Ridge Road a distance of 150.00 feet to a 5/8 inch iron rod set for corner;

THENCE North 00 degrees 37 minutes 13 seconds West along the easterly line of Ridge Road a distance of 101.00 feet to a 5/8 inch iron rod set for corner;

THENCE North 03 degrees 11 minutes 38 seconds East along the easterly line of Ridge Road a distance of 150.33 feet to a 5/8 inch iron rod set for corner;

THENCE North 00 degrees 37 minutes 13 seconds West along the easterly line of Ridge Road a distance of 101.11 feet to a 5/8 inch iron rod set for corner; at the beginning of a curve to the left having a radius of 1362.00 feet, a central angle of 1 degree 25 minutes 28 seconds, and a chord which bears North 102 degrees 52 minutes 19 seconds East, 87.25 feet; to a northwesterly direction, an arc distance of 87.25 feet to a 5/8 inch iron rod set for corner in the easterly line of Ridge Road;

THENCE along said curve to the left in a northwesterly direction, an arc distance of 71.31 feet to a 5/8 inch iron rod set for corner in the southerly line of McKinney Ranch Parkway;

THENCE North 82 degrees 38 minutes 15 seconds East along the southerly line of McKinney Ranch Parkway a distance of 113.15 feet to a 5/8 inch iron rod set for corner;

THENCE North 89 degrees 24 minutes 03 seconds East along the southerly line of McKinney Ranch Parkway a distance of 249.49 feet to a 5/8 inch iron rod set for corner;

THENCE North 09 degrees 37 minutes 13 seconds East along the southerly line of McKinney Ranch Parkway a distance of 249.50 feet to a 5/8 inch iron rod set for corner;

THENCE North 06 degrees 37 minutes 13 seconds East along the southerly line of McKinney Ranch Parkway a distance of 600.46 feet to a 5/8 inch iron rod set for corner;

THENCE South 00 degrees 47 minutes 32 seconds East a distance of 107.21 feet to a 5/8 inch iron rod set for corner;

THENCE North 88 degrees 45 minutes 37 seconds East a distance of 76.35 feet to a 5/8 inch iron rod set for corner;

THENCE South 88 degrees 10 minutes 07 seconds West a distance of 439.38 feet to a 5/8 inch iron rod set for corner;

THENCE South 01 degrees 10 minutes 07 seconds East a distance of 110.00 feet to a 5/8 inch iron rod set for corner;

THENCE South 88 degrees 48 minutes 03 seconds West a distance of 14.11 feet to a 5/8 inch iron rod set for corner; at the beginning of a curve to the left having a radius of 630.00 feet, a central angle of 739 degrees 24 minutes 35 seconds, and a chord which bears South 53 degrees 55 minutes 47 seconds West, 55.19 feet;

THENCE along said curve to the left in a southwesterly direction, an arc distance of 121.88 feet to a 5/8 inch iron rod set for corner;

THENCE South 88 degrees 48 minutes 03 seconds West a distance of 94.14 feet to a 5/8 inch iron rod set for corner;

THENCE South 88 degrees 48 minutes 03 seconds West a distance of 865.89 feet to the point of beginning and containing 228.6 ACRES.

TRACT 3:

Being a tract of land situated in the George F. Lucas Survey, Abstract No. 560 and the Other Hedgebrook Survey, Abstract No. 561, located in the County of Tarrant, State of Texas, and being more particularly described in Volume 6074, Page 6221 of the Deed Records of Collin County, Texas, and being more particularly described in Volume 6074, Page 6221 of the Deed Records of Collin County, Texas, also being on the easterly line of Ridge Road as a variable width right-of-way.

BEGINNING at a point for the northeast corner of a tract of land described by used as C-2 McKinney Ranch Parcel 1, a tract of land situated in the George F. Lucas Survey, Abstract No. 560 and the Other Hedgebrook Survey, Abstract No. 561, located in the County of Tarrant, State of Texas, and being more particularly described in Volume 6074, Page 6221 of the Deed Records of Collin County, Texas, also being on the easterly line of Ridge Road as a variable width right-of-way;

THENCE South 35 degrees 01 minute 19 seconds West along the westerly line of Ridge Road a distance of 76.15 feet to a 5/8 inch iron rod set for corner;

THENCE South 35 degrees 50 minutes 39 seconds West along the westerly line of Ridge Road a distance of 150.00 feet to a 5/8 inch iron rod set for corner;

THENCE South 35 degrees 01 minute 19 seconds West along the westerly line of Ridge Road a distance of 100.00 feet to a 5/8 inch iron rod set for corner;

THENCE South 38 degrees 02 minutes 58 seconds West along the westerly line of Ridge Road a distance of 150.00 feet to a 5/8 inch iron rod set for corner;

THENCE South 34 degrees 59 minutes 48 seconds West along the westerly line of Ridge Road a distance of 150.11 feet to a 5/8 inch iron rod set for corner; at the beginning of a curve to the left having a radius of 1362.00 feet, a central angle of 1 degree 25 minutes 28 seconds, and a chord which bears North 64 degrees 37 minutes 20 seconds West, 88.27 feet;

THENCE along said curve to the left in a northwesterly direction, an arc distance of 71.67 feet to a 5/8 inch iron rod set for corner in the northerly line of Stacy Road;

THENCE North 03 degrees 10 minutes 16 seconds West along the northerly line of Stacy Road a distance of 77.09 feet to a 5/8 inch iron rod set for corner;

THENCE North 02 degrees 12 minutes 27 seconds, and a chord which bears North 64 degrees 12 minutes 24 seconds West, 77.08 feet;

THENCE along said curve to the left in a northwesterly direction, an arc distance of 77.23 feet to a 5/8 inch iron rod set for corner in the northerly line of Stacy Road;

THENCE North 07 degrees 10 minutes 24 seconds West along the northerly line of Stacy Road a distance of 150.00 feet to a 5/8 inch iron rod set for corner;

THENCE North 02 degrees 12 minutes 27 seconds, and a chord which bears North 73 degrees 59 minutes 42 seconds West, 141.15 feet;

THENCE along said curve to the left in a northwesterly direction, an arc distance of 141.10 feet to a 5/8 inch iron rod set for corner in the northerly line of Stacy Road;

THENCE North 03 degrees 12 minutes 15 seconds, and a chord which bears North 47 degrees 56 minutes 55 seconds West, 58.45 feet;

THENCE along said curve to the left in a northwesterly direction, an arc distance of 61.83 feet to a 5/8 inch iron rod set for corner in the northerly line of Stacy Road;

THENCE North 39 degrees 39 minutes 37 seconds East along the westerly line of McKinney Ranch Parkway a distance of 634.74 feet to a 5/8 inch iron rod set for corner;

THENCE North 03 degrees 12 minutes 15 seconds East along the westerly line of McKinney Ranch Parkway a distance of 65.50 feet to a 5/8 inch iron rod set for corner; at the beginning of a curve to the left having a radius of 1540.00 feet, a central angle of 13 degrees 10 minutes 40 seconds, and a chord which bears North 19 degrees 25 minutes 03 seconds East, 162.26 feet;

THENCE along said curve to the left in a northwesterly direction, an arc distance of 451.27 feet to a 5/8 inch iron rod set for corner in the northerly line of Stacy Road;

THENCE North 39 degrees 39 minutes 37 seconds East along the westerly line of McKinney Ranch Parkway a distance of 168.25 feet to a 5/8 inch iron rod set for corner;

THENCE South 85 degrees 45 minutes 00 seconds East a distance of 868.60 feet to a 5/8 inch iron rod set for corner; at the beginning of a curve to the left having a radius of 630.00 feet, a central angle of 739 degrees 24 minutes 35 seconds, and a chord which bears South 53 degrees 55 minutes 47 seconds West, 55.19 feet;

THENCE along said curve to the left in a southwesterly direction, an arc distance of 121.88 feet to a 5/8 inch iron rod set for corner;

THENCE South 88 degrees 48 minutes 03 seconds West a distance of 94.14 feet to a 5/8 inch iron rod set for corner;

THENCE South 88 degrees 48 minutes 03 seconds West a distance of 865.89 feet to the point of beginning and containing 228.6 ACRES.

TRACT 2:

Being a tract of land situated in the George F. Lucas Survey, Abstract No. 560 and the Other Hedgebrook Survey, Abstract No. 561, located in the County of Tarrant, State of Texas, and being more particularly described in Volume 6074, Page 6221 of the Deed Records of Collin County, Texas, and being more particularly described in Volume 6074, Page 6221 of the Deed Records of Collin County, Texas, also being on the easterly line of Ridge Road as a variable width right-of-way.

BEGINNING at a point for the southerly end of a curve at the intersection of the westerly line of McKinney Ranch Parkway a 100.00 foot wide right-of-way with the northerly line of Stacy Road a 130.00 foot wide right-of-way;

THENCE along curve to the right having a radius of 237.00 feet, a central angle of 11 degrees 27 minutes 59 seconds, and a chord which bears North 82 degrees 28 minutes 21 seconds West, 212.17 feet; to a northwesterly direction, an arc distance of 212.17 feet to a 5/8 inch iron rod set for corner in the northerly line of Stacy Road;

THENCE North 88 degrees 30 minutes 13 seconds West along the northerly line of Stacy Road a distance of 160.13 feet to a 5/8 inch iron rod set for corner;

THENCE North 03 degrees 14 minutes 46 seconds, and a chord which bears North 66 degrees 24 seconds West; at the beginning of a curve to the left having a radius of 1362.00 feet, a central angle of 1 degree 25 minutes 28 seconds, and a chord which bears North 66 degrees 24 seconds West, 212.17 feet;

THENCE along said curve to the left in a northwesterly direction, an arc distance of 212.13 feet to a 5/8 inch iron rod set for corner in the northerly line of Stacy Road;

THENCE North 45 degrees 27 minutes 47 seconds West a distance of 12.21 feet to a 5/8 inch iron rod set for corner;

THENCE North 45 degrees 26 minutes 47 seconds West a distance of 279.20 feet to a 5/8 inch iron rod set for corner;

THENCE North 48 degrees 24 minutes 44 seconds East a distance of 52.60 feet to a 5/8 inch iron rod set for corner;

THENCE North 52 degrees 49 minutes 03 seconds East a distance of 310.10 feet to a 5/8 inch iron rod set for corner;

THENCE South 52 degrees 39 minutes 20 seconds East along the westerly line of McKinney Ranch Parkway a distance of 24.22 feet to a 5/8 inch iron rod set for corner; at the beginning of a curve to the left having a radius of 1362.00 feet, a central angle of 1 degree 25 minutes 28 seconds, and a chord which bears South 19 minutes 23 seconds West, 423.53 feet;

THENCE along said curve to the left in a northwesterly direction, an arc distance of 429.26 feet to a 5/8 inch iron rod set for corner in the westerly line of McKinney Ranch Parkway;

THENCE North 45 degrees 27 minutes 47 seconds, and a chord which bears South 21 degrees 20 minutes 39 seconds West, 95.49 feet;

THENCE along said curve to the left in a northwesterly direction, an arc distance of 461.56 feet to a 5/8 inch iron rod set for corner in the northerly line of Stacy Road; at the beginning of a curve to the left having a radius of 1360.00 feet, a central angle of 26 degrees 10 minutes 30 seconds, and a chord which bears South 59 degrees 25 minutes 38 seconds West, 162.26 feet;

THENCE along said curve to the left in a northwesterly direction, an arc distance of 162.26 feet to a 5/8 inch iron rod set for corner in the northerly line of Stacy Road;

TRACT 1:

Being a tract of land situated in the George F. Lucas Survey, Abstract No. 560 and the Other Hedgebrook Survey, Abstract No. 561, located in the County of Tarrant, State of Texas, and being more particularly described in Volume 6074, Page 6221 of the Deed Records of Collin County, Texas, and being more particularly described in Volume 6074, Page 6221 of the Deed Records of Collin County, Texas, also being on the easterly line of Ridge Road as a variable width right-of-way.

BEGINNING at a point for the southeast corner of Lot 1, Block A, T.C.I. McKinney Ranch Survey, an addition BEING a tract of land situated in the George F. Lucas Survey, Abstract No. 560 and the Other Hedgebrook Survey, Abstract No. 561, located in the County of Tarrant, State of Texas, and being more particularly described in Volume 6074, Page 6221 of the Deed Records of Collin County, Texas, also being on the easterly line of Ridge Road as a variable width right-of-way;

THENCE along a curve to the right having a radius of 1440.00 feet, a central angle of 48 degrees 42 minutes 42 seconds East, 144.76 feet; to a 5/8 inch iron rod set for corner in the easterly line of McKinney Ranch Parkway;

THENCE North 81 degrees 46 minutes 04 seconds East along the easterly line of McKinney Ranch Parkway a distance of 115.08 feet to a 5/8 inch iron rod set for corner;

THENCE North 01 degrees 46 minutes 04 seconds East along the easterly line of McKinney Ranch Parkway a distance of 115.08 feet to a 5/8 inch iron rod set for corner;

THENCE North 01 degrees 46 minutes 04 seconds East along the easterly line of McKinney Ranch Parkway a distance of 115.08 feet to a 5/8 inch iron rod set for corner; at the beginning of a curve to the left having a radius of 1362.00 feet, a central angle of 1 degree 25 minutes 28 seconds, and a chord which bears North 53 degrees 14 minutes 19 seconds East, 144.76 feet;

THENCE along said curve to the left in a northwesterly direction, an arc distance of 144.76 feet to a 5/8 inch iron rod set for corner in the northerly line of Stacy Road;

THENCE North 01 degrees 47 minutes 39 seconds, and a chord which bears North 69 degrees 09 minutes 35 seconds East, 33.47 feet;

THENCE South 86 degrees 47 minutes 06 seconds East a distance of 101.70 feet along the southerly line of McKinney Ranch Parkway to a 5/8 inch iron rod set for corner;

THENCE North 88 degrees 24 minutes 04 seconds East along the southerly line of McKinney Ranch Parkway a distance of 87.05 feet to a 5/8 inch iron rod set for corner;

THENCE North 88 degrees 24 minutes 04 seconds East along the southerly line of McKinney Ranch Parkway a distance of 87.05 feet to a 5/8 inch iron rod set for corner;

THENCE North 89 degrees 24 minutes 04 seconds East along the southerly line of McKinney Ranch Parkway a distance of 249.49 feet to a 5/8 inch iron rod set for corner;

THENCE North 09 degrees 37 minutes 13 seconds East along the southerly line of McKinney Ranch Parkway a distance of 249.50 feet to a 5/8 inch iron rod set for corner;

THENCE North 06 degrees 37 minutes 13 seconds East along the southerly line of McKinney Ranch Parkway a distance of 600.46 feet to a 5/8 inch iron rod set for corner;

THENCE South 00 degrees 47 minutes 32 seconds East a distance of 107.21 feet along the westerly line of Ridge Road to a 5/8 inch iron rod set for corner;

THENCE North 88 degrees 45 minutes 37 seconds East a distance of 76.35 feet along the westerly line of Ridge Road to a 5/8 inch iron rod set for corner;

THENCE South 88 degrees 10 minutes 07 seconds West a distance of 439.38 feet to a 5/8 inch iron rod set for corner;

THENCE South 01 degrees 10 minutes 07 seconds East a distance of 110.00 feet to a 5/8 inch iron rod set for corner;

THENCE South 88 degrees 48 minutes 03 seconds West a distance of 14.11 feet to a 5/8 inch iron rod set for corner; at the beginning of a curve to the left having a radius of 630.00 feet, a central angle of 739 degrees 24 minutes 35 seconds, and a chord which bears South 53 degrees 55 minutes 47 seconds West, 55.19 feet;

THENCE along said curve to the left in a southwesterly direction, an arc distance of 121.88 feet to a 5/8 inch iron rod set for corner;

THENCE South 88 degrees 48 minutes 03 seconds West a distance of 94.14 feet to a 5/8 inch iron rod set for corner;

THENCE South 88 degrees 48 minutes 03 seconds West a distance of 865.89 feet to the point of beginning and containing 228.6 ACRES.

Exhibit C

CONCEPTUAL SITE LAYOUT

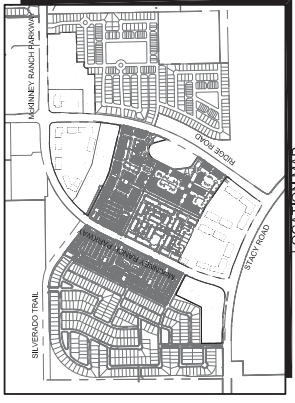
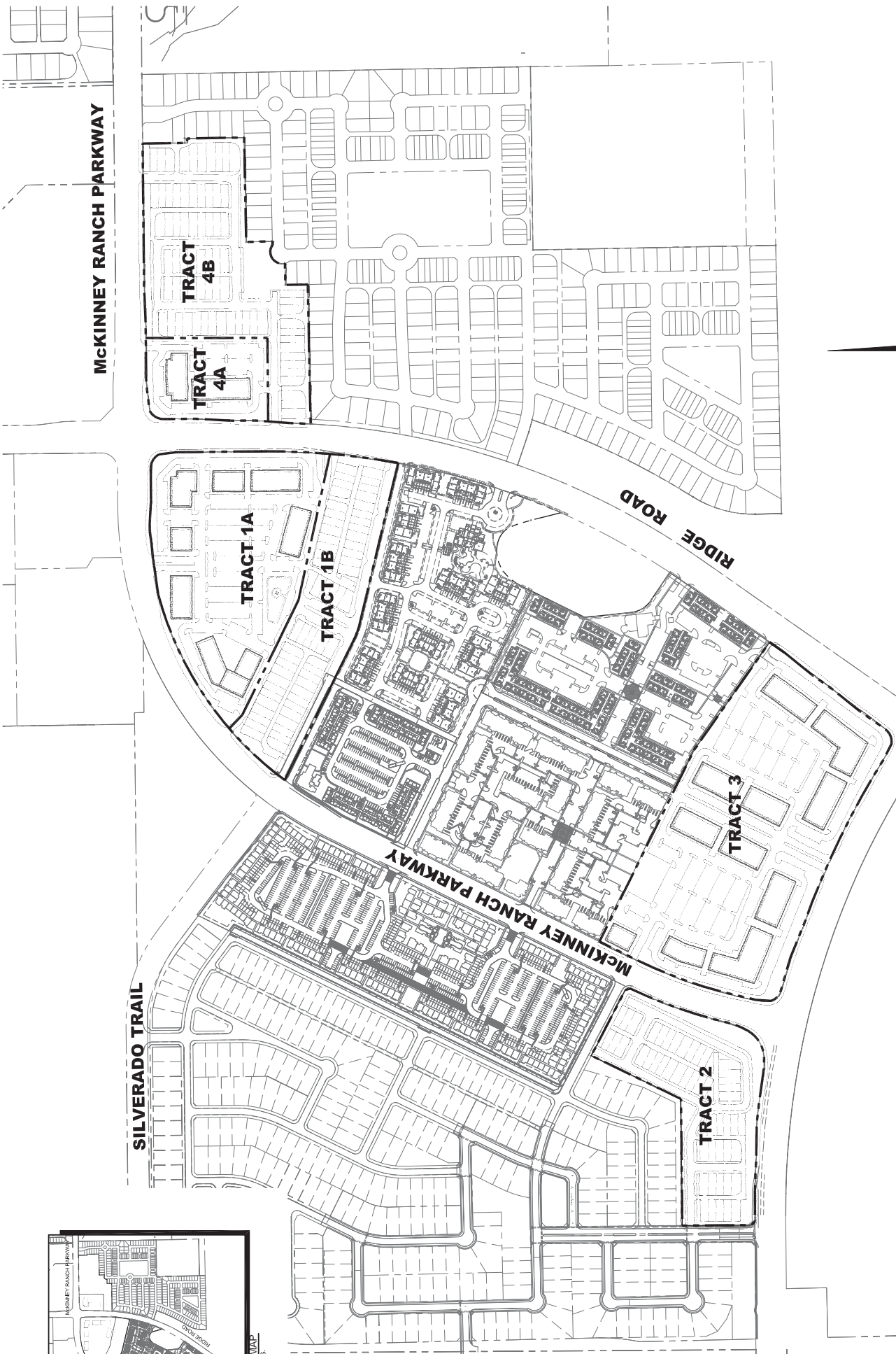
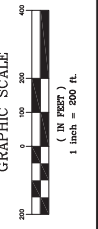

**SANCHEZ**
& Associates

Master Planning
Civil Engineering
Land Development

405 N. University Street
McKinney, TX 75069
Tel: 409.424.5900
Contact: Levi A. Wild, P.E.
Levi.Wild@sanchezassociates.net

McKinney, TX 75069
Project: 2014-11-20
Title: 2014-11-20
Scale: 1/8" = 100' N.T.S.
Author: [unreadable]
Date: 2014-11-20
Project: 2014-11-20
Title: 2014-11-20
Scale: 1/8" = 100' N.T.S.
Author: [unreadable]
Date: 2014-11-20

Exhibit D

McKinney Ranch PLANNED DEVELOPMENT STANDARDS

I. Purpose and Intent

The development standards outlined herein have been established to continue the quality development that exists in the immediate area. The subject property shall generally conform to the attached Master Development Plan. The buildings reflected on the land plan are general representations of the intended development patterns. The building layout may have minor changes as necessary to facilitate architectural design, engineering, fire, or other related needs so long as the urban character and pedestrian-oriented design is preserved, subject to review and approval by the Director of Planning.

II. Special Provisions

- a. The subject property shall develop in general conformance with the proposed Conceptual Site Layout attached. Although the Conceptual Site Layout contemplates townhomes in certain areas, the townhome land use is optional and may be converted to retail/office entirely; therefore the final layout and land uses may change as necessary to facilitate final street layout, natural topography, streams or creeks, or other related needs so long as the overall character and land use assumptions (detailed below) are preserved, subject to review and approval by the Director of Planning. Townhomes may only be allowed in the areas depicted in the Conceptual Site Layout (Tracts 1B, 2, and 4B) and shall be developed according to the *Townhouse (rowhouse) dwellings* standards per the REC Neighborhood Zone, with the exception that there may no more than 6 attached dwelling units per building. Townhomes are not required; they are an allowed use in these areas.
- b. Except for those sites currently developed or approved as multi-family, Multi-family dwelling uses (MF) shall be prohibited on the subject property.
- c. Live-work units, defined generally as residential dwelling units above non-residential uses providing for limited office or retail space and limited general commercial activity, shall be allowed in tracts 1B, 2, and 4B as indicated on the Conceptual Site Layout and shall be developed according to the *Townhouse (rowhouse) dwellings* standards per the REC Neighborhood Zone, with the exception that there may no more than 6 attached dwelling units per building.
- d. One row of parking and a dedicated firelane adjacent to a public right-of-way shall be allowed by right to provide for access and circulation of commercial buildings along Ridge Road, McKinney Ranch Parkway and/or Stacy Road.
- e. The north/south circulation spine/boulevard shall be developed in the general location as reflected by the attached Conceptual Site Layout and shall be constructed in accordance with the attached Cross Section. Parking fields associated with the future commercial development in Tract 3 shall be allowed to connect into the boulevard via dedicated fire lanes and/or driveways. The boulevard shall have a landscaped with sod and shade trees planted every 30 linear feet within the median consistent with the existing boulevard. There shall be no more than 4 median openings along the boulevard to allow access to the parking fields and associated driveways.
- f. The east/west circulation spine/boulevard shall be developed in the general location as reflected by the attached Conceptual Site Layout and shall be constructed in accordance with the attached Cross Section. Parking fields associated with the future development in Tract 1 shall be allowed to connect into the boulevard via dedicated fire lanes and/or driveways. The boulevard shall have a landscaped with sod and shade trees planted every 30 linear feet within the median consistent with the existing north-south boulevard in the immediate vicinity. There shall be no more than 4 median openings along the boulevard to allow access to the parking fields and associated driveways. Traffic calming may be required on an as-needed basis as required by the Director of Engineering.
- g. All required canopy or shade trees on the subject property, shall be planted with a minimum caliper size of 5 inches (measured 6" above the ground) and a minimum height of 12 feet at the time of planting.

Exhibit D

III. Development Standards

a. Tracts 1A, 1B, 2, 4A, and 4B

i. Non-residential uses shall be developed in accordance with the Section 146-85 “BG” - General Business District and “REC” – Regional Employment Center Overlay District of the Zoning Ordinance, except as follows:

1. No Maximum Floor Area Ratio
2. Maximum Height: 4 stories (For Tracts 2 and 4B, a maximum of 2 stories shall be allowed within 150 feet of adjacent single family residential zoning or use adjacent to the subject property)

ii. Prohibited Uses:

1. Auto painting or body shop
2. Auto trailer, light truck, tool rental
3. Auto, motorcycle, boat (sales, repair or storage)
4. Bait shop
5. Building material sales or monument sales
6. Bus station
7. Cleaning plant, laundry
8. Creamery, dairy products
9. Farm implement sales and service
10. Frozen food lockers
11. Funeral homes and mortuaries
12. Garage, auto repair
13. Halfway house
14. Multiple family residential
15. Pawnshops
16. Railroad track or right-of-way
17. Recreation vehicle sales
18. Sexually Oriented Business
19. Single family residential, detached

b. Tract 3

i. Non-residential uses shall be developed in accordance with the Section 146-85 “BG” - General Business District and “REC” – Regional Employment Center Overlay District of the Zoning Ordinance, except as follows:

1. No Maximum Floor Area Ratio
2. Maximum Height: 4 stories

ii. Prohibited Uses:

1. Auto painting or body shop
2. Auto trailer, light truck, tool rental
3. Auto, motorcycle, boat (sales, repair or storage)
4. Bait shop
5. Building material sales or monument sales
6. Bus station
7. Cleaning plant, laundry
8. Creamery, dairy products
9. Farm implement sales and service
10. Frozen food lockers
11. Funeral homes and mortuaries
12. Garage, auto repair
13. Halfway house
14. Multiple family residential
15. Pawnshops
16. Railroad track or right-of-way
17. Recreation vehicle sales
18. Sexually Oriented Business
19. Single family residential, attached
20. Single family residential, detached

Exhibit E

General Cross Section of
Boulevard — Fire Lane

