

# Capital Improvement Program Update

Council Work Session  
November 6, 2017



# Presenters

## Engineering Department

- Nick Ataie, PE, Infrastructure Construction Projects

*Engineering CIP Manager*

## Public Works Department

- Patricia Jackson, PE, Facility Construction Projects

*Facilities Construction Manager*

## Parks, Recreation, and Open Space Department

- Mike Kowski, Park Construction Projects

*Director of Parks & Recreation*



# New CIP Interactive Webmap

**CIP 2018-2022**

HOME 5-YEAR CIP ACTIVE CONSTRUCTION ACTIVE DESIGN

This is an overview of all the Capital Improvement Program (CIP) throughout the City of McKinney for the years 2018 - 2022. Scroll down in this window to see a list of identified projects.

Turn on and off specific layers on the map by clicking the "stacks" icon on the top-left of the map.

Use the search bar on the top-right of the map to locate a specific CIP Project by its project number (some projects do not have a mapped location and will not appear).

AI1648 AIRPORT MASTER PLAN UPDATE  
AI1705 TOYOTA HANGAR EXPANSION  
AI1738 RELOCATE AIRPORT TAXIWAY CONNECTOR  
AI1739 TAXILANE-A REHABILITATION  
AI1740 DESIGN AND CONSTRUCT WEST CENTRAL TAXILANE  
AI1741 TEE/BOX HANGAR TAXILANE CONSTRUCTION  
AI1742 STORMWATER EROSION MITIGATION DES&CONST  
AI3202 AIRCRAFT PARKING RAMP RE-CONSTRUCTION  
AI4315 AIRFIELD MAINTENANCE BUILDING  
AI4377 AIRCRAFT STORAGE HANGAR #2  
CO1606 UPDATE ENG DESIGN/CONSTRUCTION DOCUMENTS  
CO1703 PEARSON FM WADDILL-KENTUCKY  
DR1205 CREEK, LAKE & DAM IMPROVEMENTS  
DR1645 STOVER CREEK MASTER DRAINAGE STUDY  
DR1646 WILSON CREEK UNNAMED TRIBUTARY STUDY  
DR3251 UNNAMED TRIBUTARY DRAINAGE IMPROVEMENTS  
DR4318 CREEK, LAKE, DAM IMPROVEMENT, STUDIES (UMBRELLA)  
DR4319 NRCS EFAL WATERSHED DAM REHAB SITES 15&16  
DR5093 DAM REHABILITATION: NRCS LAKE 4  
DR7158 DAM REHABILITATION: NRCS LAKE 2A  
FC1202 PUBLIC WORKS COMPLEX  
FC1611 DOWNTOWN PARKING (VARIOUS LOTS)  
FC1707 MUNI COMP MASTER PLAN 17  
FC1708 PARKING (9AC) COL REALTY  
FC1709 STARS CENTER EXPANSION  
FC2229 PUBLIC SAFETY PHASE III  
FC2239 ACCESSIBILITY IMPROVEMENTS FOR FACILITIES  
FC4364 POLICE GUN RANGE  
FI3244 FIRE STATION#9-LK FOR/380  
FI1731 FIRE STATION - CRAIG RANCH  
FI3244 FIRE STATION #9 (LAKE FOREST & WILMETH)  
FI4246 FIRE STATION LAND/DESIGN-VIRGINIA/HARDIN

Search for a Project Number

**ST1219**

Project Type: STREETS  
Project Name: VIRGINIA PARKWAY LANES 5 & 6 (BELLEGROVE - US 75)  
Project Number: ST1219  
Project Manager: Blake Sills  
Project Manager Phone: 972-547-3489  
Email Address: [Send Email](#)  
Status: Under Construction  
Notes: Expansion of Virginia Parkway from 4 to 6 lanes  
[Zoom to](#)

HOME 5-YEAR CIP ACTIVE CONSTRUCTION ACTIVE DESIGN

# ACTIVE INFRASTRUCTURE PROJECT SUMMARY

---

## COMBINED INFRASTRUCTURE PROJECTS

PROJECT	DESCRIPTION	PHASE
CO1606	Design Manual Updates	DESIGN
CO1703	Pearson Avenue and Related Drainage Improvements	DESIGN
CO1704	Substandard Utility & Street Rehab (East of SH 5)	DESIGN
CO1705	Substandard Utility & Street Rehab (South of Virginia)	DESIGN
CO1706	Substandard Utility & Street Rehab (North of Virginia)	DESIGN
CO9151	Cole Street Reconstruction	CONSTRUCTION

---



# INFRASTRUCTURE PROJECT OVERVIEW

## ENGINEERING DESIGN MANUAL UPDATE

CO1606

### Description

Includes publishing of a new *Engineering Design Manual* to replace current Street, Drainage, Water/Wastewater Manuals (adopted in 2010). Also includes publishing of new *Construction Standards and Specifications Manual*.

### Schedule / Status

- Current Status: 90% Complete
- Development Underway as of August 2016
- Estimated Manual Adoption End Q1 (2018)

### Current Financial Summary

Prof Serv: \$358,600



Engineering Design Manual



# INFRASTRUCTURE PROJECT OVERVIEW

## PEARSON AVE & RELATED DRAINAGE IMPROVEMENTS

CO1703

### *Description*

Includes complete pavement rehabilitation along Pearson Ave (Waddill – Kentucky), replacement of wastewater main, and installation of storm drain system (West – Coleman).

### *Schedule / Status*

- Current Status: Design (90% Complete)
- Design Underway as of February 2017
- Estimated Construction Early 2018



### *Current Financial Summary*

Prof Serv: \$322,807

Const: \$2.56MM (Est.)





# INFRASTRUCTURE PROJECT OVERVIEW

## SUBSTANDARD UTILITY & STREET REHAB PROJECTS (VARIOUS LOCATIONS)

CO1704, CO1705, CO1706

### *Description*

Includes replacement of approximately 28,000 linear feet of water main and 23,000 linear feet of wastewater mains previously identified as being in substandard condition.

### *Schedule / Status*

- Current Status: Design (60% Complete)
- Design Underway as of February 2017
- Estimated Construction Early 2018

### *Current Financial Summary*

Prof Serv: \$1,140,096

Const: \$15MM (Est.)



# INFRASTRUCTURE PROJECT OVERVIEW

## COLE STREET RECONSTRUCTION

CO9151

### *Description*

Includes a complete reconstruction of Cole Street from Bass Street to College Street including water, wastewater, storm drainage, and paving.

### *Schedule / Status*

- Current Status: Construction (85% Complete)
- Construction Underway as of November 2016
- Estimated Completion November 2017



### *Current Financial Summary*

Const: \$2.31MM





# ACTIVE INFRASTRUCTURE PROJECT SUMMARY

## STREET INFRASTRUCTURE PROJECTS

<b>ST1219/WA9145</b>	<b>Virginia Parkway Lanes 5 &amp; 6 (Bellegrove - US 75)</b>	<b>CONSTRUCTION</b>
<b>ST1231</b>	<b>Virginia Parkway Lanes 5 &amp; 6 (Ridge – Bellegrove)</b>	<b>CONSTRUCTION</b>
ST1232	FM 546 Reconstruction	CONSTRUCTION
ST1612/ST1613	Redbud Blvd Lanes 3&4 and McLarry Drive Improvements	DESIGN
ST1615	US 380 and Airport Dr Intersection Improvements	DESIGN
ST1617	Ridge Rd (US 380 - Wilmeth)	DESIGN
ST1618	Arterial Capacity Improvements 380/Hardin, Westridge/Custer, Virginia/Ridge	DESIGN
ST1622	Street Rehab Umbrella FY17-18	CONSTRUCTION
ST1649	PROW ADA (Eastside)	DESIGN
<b>ST3211 / ST1614</b>	<b>Hardin Lanes 5 &amp; 6 McKinney Ranch Reconstruction</b>	<b>CONSTRUCTION</b>
ST4227	Bloomdale Road Extension - Community to Hardin	DESIGN
ST4331	Laud Howell Parkway Design/Construction	DESIGN
ST4334	Stonebridge Bridge	DESIGN
ST4372	Country Lane Extension Project	DESIGN
ST4417	Hardin Fence	CONSTRUCTION
ST4422	Trinity Falls Parkway	RIGHT-OF-WAY
ST6093	Lake Forest Drive (Wilmeth – Bloomdale)	COMPLETE
ST9115	Custer Road Design & ROW (US 380 – FM 1461)	DESIGN

## TRAFFIC INFRASTRUCTURE PROJECTS

TR1603	TAPS Pedestrian Safety Enhancements	BIDDING
TR1620/TR1702	FY 17 Traffic Signals	DESIGN



# INFRASTRUCTURE PROJECT OVERVIEW

## VIRGINIA PARKWAY LANES 5 & 6

ST1219, ST1231

### *Description*

Includes the construction of an additional travel lane in each direction from east of Ridge Road to US 75.

### *Schedule / Status*

- Current Status: Construction (35% Complete)
- Construction Underway as of February 2017
- Estimated Completion February 2019

### *Current Financial Summary*

Const: \$13.94MM



# INFRASTRUCTURE PROJECT OVERVIEW

## HARDIN LANES 5 & 6 / MCKINNEY RANCH RECONSTRUCTION

ST1614, ST3211

### *Description*

Includes construction of an additional lane in each direction along Hardin Blvd from SH 121 to McKinney Ranch Pkwy and reconstruction of McKinney Ranch Pkwy as a 4-lane divided roadway east of the MISD Stadium site.

### *Schedule / Status*

- Current Status: Overall Construction (60% Complete)
- Construction Underway as of April 2017
- Estimated Completion February 2018

### *Current Financial Summary*

Const: \$3.37MM



# ACTIVE INFRASTRUCTURE PROJECT SUMMARY

---

## WATER INFRASTRUCTURE PROJECTS

WA1624	Redbud Pump Station Transmission Line (794 PP)	CONSTRUCTION
WA1625	University Pump Station - 920 PP Pump	DESIGN
WA1626	McKinney Ranch Pump Station Improvements	DESIGN
WA1629	Water Storage Tank Maintenance (Public Works Inspection List)	DESIGN
WA4266	Club Lake 8-inch Water Line Loop	CONSTRUCTION
WA4340	Redbud Pump Station Transmission Line (850 PP)	DESIGN
WA4415	US 380 Water Line Improvements	DESIGN
WA8132	Redbud Pump Station Site Development	BIDDING
WAXXXX	Club Lake, Forest Hills, Lake Side Water Main Pipe Bursting	DESIGN

---

## WASTEWATER INFRASTRUCTURE PROJECTS

WW1623	US 75 & SRT Lift Station, Force Main, and Gravity Line	CONSTRUCTION
WW2245	Aerial Wastewater Crossing Improvements – Erwin Avenue	RIGHT-OF-WAY
WW3255	Aerial Wastewater Crossing Improvements – Jeans Creek	CONSTRUCTION
WW4213	Oversize Participation Bloomdale (Stover Creek)	DESIGN
WW4351	Sanitary Sewer Evaluation Survey (SSES)	DESIGN
WW4366	Bloomdale Road Sanitary Sewer Trunk Line	COMPLETE

---



# ACTIVE INFRASTRUCTURE PROJECT SUMMARY

---

## DRAINAGE INFRASTRUCTURE PROJECTS

<b>DR1205</b>	<b>King's Lake Bank Stabilization Wall</b>	<b>CONSTRUCTION</b>
DR1646	Glenwood Estates Creek Erosion Study	UNDERWAY
DR5093	NRCS Lake 4 Dam Rehabilitation	DESIGN

---





# INFRASTRUCTURE PROJECT OVERVIEW

## KING'S LAKE BANK STABILIZATION

DR1205

### *Description*

Includes a bank stabilization wall in Stonebridge Lake downstream of a large culvert under Glen Oaks Drive and next to 604 King's Lake Drive. The wall collapsed while under construction in November 2015 and is now being repaired.

### *Schedule / Status*

- Current Status: Contractor On-Site Mobilization
- 65 Calendar Day Expected Construction Duration from Notice to Proceed



### *Current Financial Summary*

Prof Serv: \$115,000

Const: \$322,000



# ACTIVE INFRASTRUCTURE PROJECT FINANCIAL SUMMARY

The FY 2018-2022 CIP includes programmed funding for the following infrastructure projects:

Combined Infrastructure	→	\$14 MM Active
Drainage	→	\$8.5 MM Active
Streets	→	\$111 MM Active
Traffic	→	\$2 MM Active
Water/Wastewater	→	\$89 MM Active
<b>FY 18-22 TOTAL ±\$458 MM</b>	→	<b>±\$224 MM Active</b>



# ACTIVE FACILITIES CONSTRUCTION PROJECT SUMMARY

PROJECT	DESCRIPTION	PHASE	APPROVED FUNDING	FY18-22 BUDGET
<b>AI4377</b>	<b>McKinney Air Center Hangar #2 (MACH2)</b>	<b>CONSTRUCTION</b>	<b>\$ 1,500,000</b>	<b>\$ 1,500,000</b>
IT1601	Council Chambers Audio/Visual Systems Upgrades	PUNCH LIST	\$ 913,000	\$ 913,000
FC1202	Public Works Master Plan & Fleet Expansion	MASTER PLAN COMPLETE	\$ 6,000,000	\$ 8,000,000
<b>FC1611</b>	<b>Downtown Parking Lots #1 &amp; #2</b>	<b>COMPLETE</b>	<b>\$ 1,295,525</b>	<b>\$ 1,295,525</b>
FC1707	Future City Hall Master Planning	PROGRAMMING	\$ 336,800	\$ 336,800
<b>FC1709</b>	<b>Dr Pepper StarCenter Expansion</b>	<b>PRE-DESIGN</b>	<b>\$ 10,750,000</b>	<b>\$ 10,750,000</b>
<b>FC2229</b>	<b>Public Safety Support Building</b>	<b>CONSTRUCTION</b>	<b>\$ 9,064,000</b>	<b>\$ 9,064,000</b>
FC2239	Accessibility Improvements for Facilities	ONGOING	\$ 308,000	\$ 2,300,000
<b>FI3244</b>	<b>Fire Station #9</b>	<b>CONSTRUCTION</b>	<b>\$ 8,556,505</b>	<b>\$ 8,556,505</b>
<b>LI1609</b>	<b>John &amp; Judy Gay Library Expansion &amp; Renovation</b>	<b>DESIGN</b>	<b>\$ 9,500,000</b>	<b>\$ 9,500,000</b>



# FACILITIES CONSTRUCTION PROJECT OVERVIEW

## McKINNEY AIR CENTER HANGER #2 (MACH2)

AI4377

### Description

Includes 10,000 square foot aircraft storage hangar at McKinney National Airport with appropriate parking and apron areas. Project delivery method is Competitive Sealed Proposal.

### Schedule / Status

- Current Status: Construction (85% Complete)
- Design (100% Complete)
- Projected Completion – November 2017

### Current Financial Summary

Project Total: \$1.5 Million



# FACILITIES CONSTRUCTION PROJECT OVERVIEW

## DOWNTOWN PARKING LOTS (MDPL1 & MDPL2)

FC1611

### *Description*

Includes 2 separate parking lots in downtown McKinney – one located at 308 N. Tennessee Street with 124 parking spaces and one located at 415 N. Kentucky Street with 47 parking spaces. Project delivery method was Competitive Sealed Proposal.

### *Schedule / Status*

- Current Status: Construction (100% Complete)
- Design (100% Complete)
- Projected Completion – September 2017



### *Current Financial Summary*

Project Total: \$0.9 Million





# FACILITIES CONSTRUCTION PROJECT OVERVIEW

## FIRE STATION #9 (MFS9)

FI3244

### Description

Includes 15,000 square foot fire station with 3 apparatus bays, interior areas for up to 10 on-site personnel along with a community room with appropriate parking and apron areas. Project delivery method is Construction Manager at Risk.

### Schedule / Status

- Current Status: Construction (75% Complete)
- Design (100% Complete)
- Projected Completion – November 2017

### Current Financial Summary

Project Total: \$8.56 Million



# FACILITIES CONSTRUCTION PROJECT OVERVIEW

## PUBLIC SAFETY – SUPPORT BUILDING (MPSB-SB)

FC2229

### Description

Includes 27,000 square foot Public Safety support building that will house spaces such as the Police Department's crime lab, property storage and quartermaster, as well as, the Fire Department's logistics warehouse, bunker gear and various work rooms. Project delivery method is Construction Manager at Risk.

### Schedule / Status

- Current Status: Construction (80% Complete)
- Design (100% Complete)
- Projected Completion – November 2017

### Current Financial Summary

Project Total: \$9.1 Million



# FACILITIES CONSTRUCTION PROJECT OVERVIEW

## DR PEPPER STARCENTER EXPANSION (DPSCE)

FC1709

### *Description*

Includes approximately 46,000 square feet with one additional sheet of ice and the various locker room and team spaces needed . Project delivery method is Design / Build (D/B).

### *Schedule / Status*

- Current Status: D/B Team under evaluation
- Design (0% Complete)
- Projected Completion – November 2018

### *Current Financial Summary*

Project Total: \$8.5 Million



# FACILITIES CONSTRUCTION PROJECT OVERVIEW

## JOHN & JUDY GAY LIBRARY – EXPANSION & RENOVATION (JJGL-E&R)

LI1609

### Description

Includes approximately 20,000 square feet of additional space essentially doubling the capacity of the library with appropriate new areas for various collections. Project delivery method is Construction Manager at Risk.

### Schedule / Status

- Current Status: In Design
- Design (10% Complete)
- Projected Completion – Summer 2019

### Current Financial Summary

Project Total: \$9.5 Million

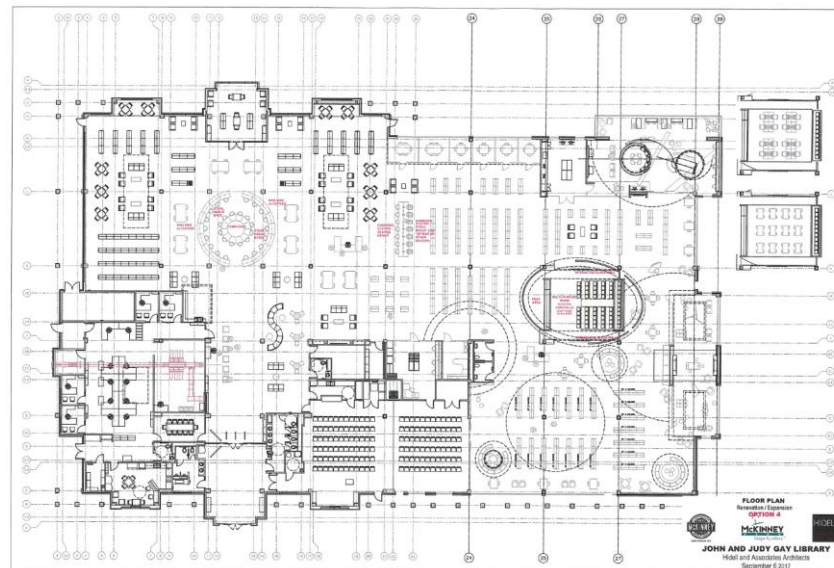

# ACTIVE PARKS PROJECT SUMMARY

PROJECT	DESCRIPTION	PHASE	APPROVED FUNDING	FY18-22 BUDGET
PK1213	HIKE AND BIKE TRAIL CONSTRUCTION	ONGOING	\$ 1,020,000	\$ 2,020,000
PK1701	LAND ACQUISITION (UMBRELLA)	ONGOING	\$ 2,800,166	\$ 2,800,166
PK1735	FY17-18 ZONE J MEDIAN ESCROW	ONGOING	\$ 90,000	\$ 90,000
PK1736	FY17-18 ZONE I MEDIAN ESCROW	ONGOING	\$ 140,000	\$ 140,000
<b>PK4325</b>	<b>PARKS ACCESSIBILITY</b>	<b>ONGOING</b>	<b>\$ 513,369</b>	<b>\$ 1,513,369</b>
PK1643	PROSPER ISD PARK (PRESTWYCK)	LAND ACQUISITION	\$ 2,000,000	\$ 2,000,000
<b>PK9138</b>	<b>STACY ROAD/ROWLETT CREEK H/B - SPCA</b>	<b>LAND ACQUISITION</b>	<b>\$ 540,000</b>	<b>\$ 540,000</b>
PK1211	FINCH PARK PHASE IV	PLANNING	\$ 2,000,000	\$ 2,000,000
PK1737	COTTONWOOD PARK	PLANNING	\$ 150,000	\$ 1,000,000
PK4392	RAUSCHHAUPT RESTROOM RENOVATION	PLANNING	\$ 500,000	\$ 1,000,000
<b>PK4394</b>	<b>SENIOR CENTER EXPANSION</b>	<b>PLANNING</b>	<b>\$ 1,500,000</b>	<b>\$ 9,500,000</b>
PK9143	ERWIN PARK DEV - PHASE I	PLANNING	\$ 200,000	\$ 2,000,000
<b>PK2206</b>	<b>GRAY BRANCH COM. MASTER PLAN</b>	<b>PRE-DESIGN</b>	<b>\$ 1,435,333</b>	<b>\$ 30,000,000</b>
<b>PK3224</b>	<b>GEORGE WEBB PARK</b>	<b>DESIGN</b>	<b>\$ 2,425,000</b>	<b>\$ 2,425,000</b>
<b>PK4396</b>	<b>GABE NESBITT TENNIS EXPANSION</b>	<b>BIDDING</b>	<b>\$ 7,000,000</b>	<b>\$ 7,000,000</b>
PK1644	GOLD STAR FAMILY MEMORIAL	CONSTRUCTION	\$ 165,000	\$ 165,000
PK3222	BONNIE WENK PARK PHASE II	CONSTRUCTION	\$ 8,391,031	\$ 8,391,031
PK4326	COMEGYS CREEK HIKE AND BIKE TRAIL	CONSTRUCTION	\$ 1,133,000	\$ 1,133,000
PK4413	ROWLETT CREEK H/B - 121	CONSTRUCTION	\$ 620,000	\$ 620,000
PK4414	COMMUNITY CENTER PLAYGROUND	CONSTRUCTION	\$ 130,000	\$ 130,000
PK8062	WILSON CREEK HIKE AND BIKE TRAIL	CONSTRUCTION	\$ 986,700	\$ 986,700





# PARKS PROJECT OVERVIEW

## PARK ACCESSIBILITY

PK4325

### Description

Replace and repair areas that are out of ADA compliance. Address citizen complaints as they arise as well as implement the ADA transition plan.

### Schedule / Status

- Current Status: Addressing complaints for ADA swings at several park sites. Added accessible ramp into swing pod at Mary Will Craig Park.
- Completed Artificial Turf Replacement at Al Ruschhaupt Playground

### Current Financial Summary

Project Total: \$250,000 Annually



# PARKS PROJECT OVERVIEW

## STACY ROAD/ROWLETT CREEK/HIKE AND BIKE TRAIL

PK9138

### Description

Includes a 12' concrete hike and bike trail under grade crossing at Stacy Road and Rowlett Creek.

### Schedule / Status

- Current Status: Negotiating Land Acquisition
- Design on hold until easement/land is acquired.

### Current Financial Summary

Project Total: \$500,000



# PARKS PROJECT OVERVIEW

## SENIOR CENTER EXPANSION

PK4394

### *Description*

Renovate the existing facility, increase parking, and add approximately 13,000 SF, effectively doubling the size of the current building.

### *Schedule / Status*

- Current Status: Selection of Design Team



### *Current Financial Summary*

Project Total: \$7,000,000





# PARKS PROJECT OVERVIEW

## GRAY BRANCH MASTER PLAN

PK2206

### Description

Master plan a 212 acre community park that includes lighted ball fields.

### Schedule / Status

- Current Status: Design Contract in negotiations
- Update to existing Master Plan
- Total construction project: +/- \$30 Million

### Current Financial Summary

Project Total: \$935,000



GRAY BRANCH  
212 ACRES

Original - 100 acres - 2009  
Additional - 50 acres - 2013  
62 acres - 2016



# PARKS PROJECT OVERVIEW

## GEORGE WEBB PARK

PK3224

### *Description*

An 11 acre neighborhood park that includes a play structure, musical stations, pavilions, basketball court, interactive dry riverbed, trails, and open space.

### *Schedule / Status*

- Current Status: Construction documents in development
- Design (30% Complete)

### *Current Financial Summary*

Project Total: \$2.4 Million





# PARKS PROJECT OVERVIEW

## GABE NESBITT TENNIS CENTER EXPANSION

PK4396

### Description

Includes 12 additional tennis courts, play structures, pavilions, restrooms, open space, trails, additional parking and a 3,000 square foot maintenance facility that includes public restrooms and a small office

### Schedule / Status

- Current Status: Advertise to bid October 2017
- Design (100% Complete)

### Current Financial Summary

Project Total: \$7 Million

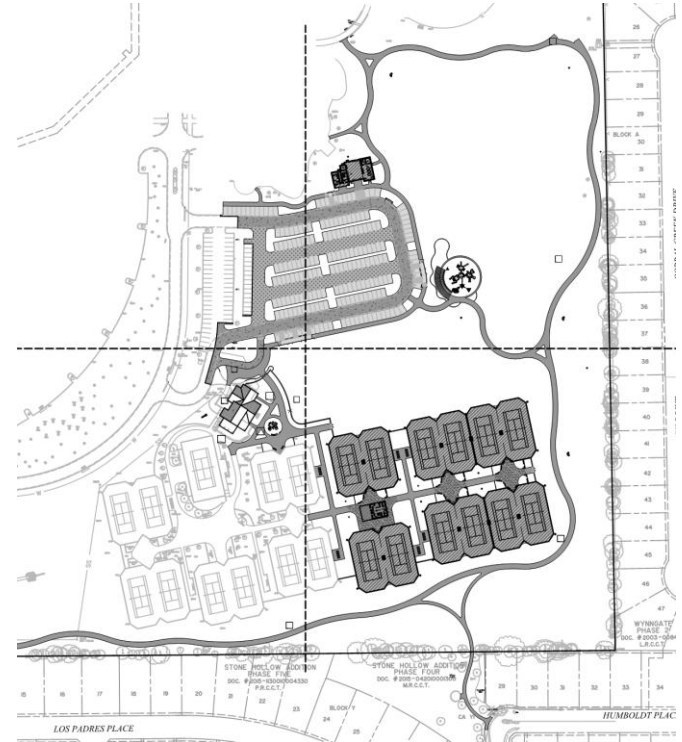

# PARKS PROJECT OVERVIEW

## GOLD STAR FAMILY MEMORIAL

PK1644

### Description

Includes granite monument and eight lighted flag poles.

### Schedule / Status

- Current Status: Construction (75% Complete)
- Design (100% Complete)
- Projected Completion – December 2017

### Current Financial Summary

Project Total: \$165,000



# PARKS PROJECT OVERVIEW

## BONNIE WENK PARK PHASE II

PK3222

### *Description*

Includes two lighted multi-purpose fields, an all inclusive play structure, restrooms, pavilions, trails, parking, and the extension of the park road to Hardin Blvd.

### *Schedule / Status*

- Current Status: Construction (50% Complete)
- Design (100% Complete)
- Projected Completion – June 2018



### *Current Financial Summary*

Project Total: \$8.4 Million



# PARKS PROJECT OVERVIEW

## COMEGYS HIKE AND BIKE TRAIL

PK4326

### *Description*

Includes a 12' concrete hike and bike trail connection from Malvern Elementary to the McKinney Community Center.

### *Schedule / Status*

- Current Status: Construction (90% complete)
- Design (100% Complete)
- Projected Completion – November 2017



### *Current Financial Summary*

Project Total: \$1,043,000





# PARKS PROJECT OVERVIEW

## ROWLETT CREEK/121 HIKE AND BIKE TRAIL

PK4413

### Description

Includes a 12' concrete hike and bike trail connection from the City of Allen trail under Sam Rayburn Tollway (SRT) to the hike and bike trail at the TCP Golf Course.

### Schedule / Status

- Current Status: Construction Substantially Complete
- Design (100% Complete)
- Projected Completion – October 2017

### Current Financial Summary

Project Total: \$540,000



Looking south towards  
SRT at Craig Ranch  
Parkway



On the bridge overpass  
trail looking north down  
on the trail leading  
underneath SRT





# PARKS PROJECT OVERVIEW

## MCKINNEY COMMUNITY CENTER PLAYGROUND

PK4414

### Description

Includes a 5-12 year old (age group) play structure and swings.

### Schedule / Status

- Current Status: Equipment on Order
- Design (100% Complete)
- Projected Completion – December 2017



### Current Financial Summary

Project Total: \$130,000



# PARKS PROJECT OVERVIEW

## WILSON CREEK HIKE AND BIKE TRAIL

PK8062

### *Description*

Includes a 12' concrete hike and bike trail connection from Grady Littlejohn Ballfields to Eldorado Parkway.

### *Schedule / Status*

- Current Status: Construction Substantially Complete
- Design (100% Complete)
- Projected Completion – November 2017



### *Current Financial Summary*

Project Total: \$708,000

