

## G. Photographs

The Waddill Building was built in the early 1890s. It was home to Matthews Brothers from 1906 to 1920. In 1928, a fire destroyed the building. Contractor J. Ed Michaels was responsible for erecting the Ritz Theater building that occupies the site today. The Ritz was designed by Greenville architect George Lindsey and opened in October of 1928.



**Jesse Bone** worked as a salesman in the Matthews Bros. store for two years prior to teaming up with his uncle to start his own shoe business in 1913. Jesse's uncle was insurance agent R.L. Ray who operated his business out of the back of the Bone & Ray Shoe Store.

The location of the Bone & Ray Shoe Store from 1913-1927



The above photo (circa 1929) shows the Ray, Connor & Ray store after Jesse Bone split from his uncle to start a new store. This site on Kentucky Street is also where the old Suttle Shoe Store had been. On the far right of the photo is the new Ritz Theater building that replaced the Matthews Brothers building after it burning in 1928.

## SHOE STORE CHANGES HANDS

A deal was recently consummated in which W. P. Suttle sold his shoe store on the West side of the square to Messrs. J. F. Bone and R. L. Ray, both highly respected and esteemed Christian gentlemen, and who are boosters and live wire workers for anything that will help in the up-building of McKinney and Collin county. Messrs. Bone and Ray will take charge of the store January 1. They have an ad. in the Weekly Democrat-Gazette to which we call your attention.

W. P. Suttle, the pioneer shoe man of McKinney, has been in the shoe business here for more than twenty years, and has at all times enjoyed a good share of the trade of the citizens of McKinney and surrounding country. He has enjoyed a good business. The store will continue to be conducted under those principals of honesty, courtesy and politeness, which principals were inaugurated by Mr. Suttle many years ago. The motto of this store has ever been, and will continue to be under its new managers, "a square deal to all." Messrs. Bone and Ray earnestly solicit a share of your business, when needing anything in the shoe line. They will carry a full stock of the very best shoes, and will be pleased to accommodate anyone desiring to visit their store, showing them through their line of fine shoes.

As has been previously announced in the columns of this paper that Mr. Suttle intended to move to Texas City, where he will continue to reside, and expects to move within the next month or so. Mr. Suttle expects to embark in the shoe business at that place. We regret to see them leave McKinney, but wish them well in their new place of abode.

R. L. Ray has been a resident of McKinney for the past twenty years. He is agent for the Southwestern Life Insurance Company.

Mr. Bone, who is a nephew of Mr. Ray, has resided in Collin county for about twelve years. He was for six years salesman in one of the leading shoe stores at Sherman, and for about three years connected with one of the leading dry goods stores at Howe, having charge of the shoe department. For the past two years Mr. Bone has been one of the salesmen in the big store of Matthews Bros., at this place. Both these gentlemen are honest, sober and upright men, and no doubt they will enjoy a good business, as they have many friends all over Collin county. Mr. Ray will fit up a nice office in the rear of the shoe store, where he will meet his friends and continue to faithfully perform the duties as agent for the Southwestern Life Insurance Co.

## THANKFUL? YES!



First to Him "whose we are and whom we serve." Then to our friends and patrons who have stood so nobly by and helped to make this the banner year for our Texas Company—The Southwestern Life. This year our splendid eighteen-story office building in Dallas has been completed and over 90 per cent of the entire space has been rented, which yields a handsome profit for the owners (the policy holders), as it is deeded to the State of Texas for the protection and benefit of the policy holders.

For 22 years, and more, I have tried to give you the best life insurance on the market and as I haven't found anything better, I am still with the Old Southwestern, ready to give as good as the market affords, and then stay with you and help you keep it up. See me before Dec. 31 if you want to get in before we pass \$20,000,000.00 in paid-for Texas business.

## R. L. RAY

Local Agent, McKinney, Texas

Around the time **Robert L. Ray** moved to McKinney, he married Jesse Bone's aunt in 1893. Mr. Ray was a well-established sales agent for the Southwestern Insurance Company of Dallas years before he teamed up with his nephew. In 1912, he was among the top three sales producers among a field of about 200 agents. In 1910, the Southwestern Life Insurance Co. erected a 16-story building office building on Main Street in Dallas. The building was demolished in 1972.





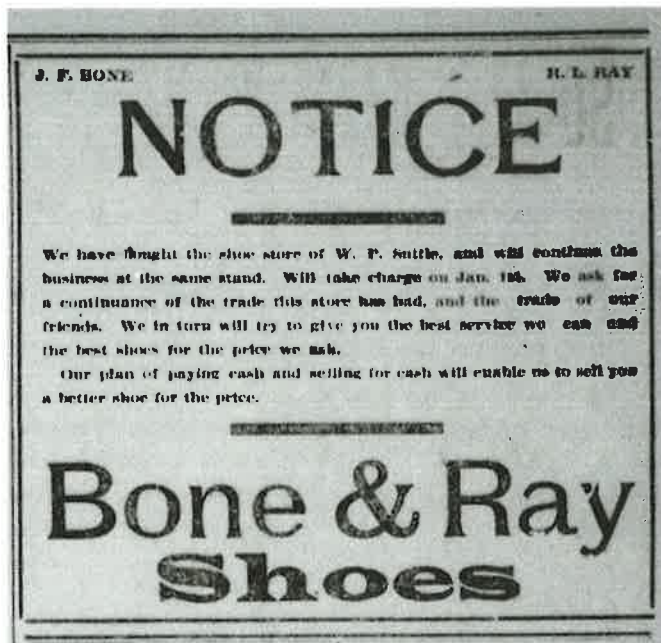

**Jesse Bone** sold his interest in Bone & Ray Shoe to his uncle in 1927. Within two months, Jesse was opening a new store on the north side of the Square in the Estes Building. The building is one of the oldest on the Square, being built around 1875. It became home to the Continental Bank & Trust in 1906. When the bank moved in 1918, the building was used as a Christian Science reading room. Jesse Bone remodeled the building and opened for business in February of 1928. The business occupied the same location for 42 years.



The photo at right shows **Jesse Bone** sizing Miss Ray Ragsdale for a pair of shoes. During World War II the draft board mistook her for a man and sent her a draft card because of her name. Ironically, she ended up working for the draft board a few years later.





## BONE SHOE STORE MAILS \$100 CHECK TO FIREMEN HERE

A check for \$100.00 has been received by the McKinney Volunteer Fire Department from J. F. Bone of the new Bone Shoe store of this city in appreciation of the heroic and efficient work they did early Wednesday morning when fire destroyed the Harris-Price company store next door to the Bone Shoe store.

The letter, which was accompanied by the check, and both of which are greatly appreciated by the Volunteer fire boys, follows: McKinney Fire Department, City.

My Dear Johnnie and the boys:

May we reassure you of our appreciation for your heroic work last Wednesday morning. Words are inadequate to express our gratitude to you.

The enclosed check is only the slightest expression of our appreciation of you.

Yours very truly,  
Bone Shoe Store.

Within hours of Jesse Bone closing his new store on its first day of business on Valentine's Day in 1928 a fire broke out in the building next door that was once the Matthews Brothers Store. The fire completely destroyed the building but the Bone store and stock were spared any significant damage. The grateful Mr. Bone expressed his thanks to the McKinney Fire Department with a \$100 check. The Ritz Building that stands there now was erected that same year

Advance Showing new Spring Styles      No Goods Offered for Sale!

**Music-Entertainment During Reception Hours**

*You are cordially invited!*

to attend the  
**FORMAL OPENING and INSPECTION**  
**TUESDAY EVENING, FEBRUARY 14**

of the new **Bone Shoe Store** North Side Square

After several of planning and building the new Bone Shoe Store to occupy the space in the building vacated by Matthews Brothers, we have opened our doors to the public. We have secured the best of the city's talent to give you a most enjoyable evening. We have secured the best of the city's talent to give you a most enjoyable evening. We have secured the best of the city's talent to give you a most enjoyable evening.

**Store Open for Business Wednesday, February 15**

**New Oxfords**

EXTRAORDINARY VALUES

We are handling the best of shoe stock. We are handling the best of shoe stock. We are handling the best of shoe stock.

**Hosiery**

BY ALL THE LATEST NEW GRADINGS

We are handling the best of hosiery. We are handling the best of hosiery. We are handling the best of hosiery.

**Spring Shoes**

SHOWING NEW

We are handling the best of spring shoes. We are handling the best of spring shoes. We are handling the best of spring shoes.

**Reception Hours**

7:30 to 9:30 p. m.



**Ola Grace Bradshaw** lived in Howe, Texas when Jesse Bone worked for the T.A. Rowe Dry Goods Store located there. The couple married in 1907 and continued to live there until moving to McKinney around 1910. The photo at left shows Ola as a young woman. The photo above shows Ola (far right) at a luncheon in 1972.



The photo above (circa 1908) shows the family home of **Ola (Bradshaw) Bone**, just west of Howe. On the porch from left to right are: husband Jesse Bone, Ola (Bradshaw) Bone, sister Zelda Bradshaw, father Jack Bradshaw, mother Mattie Bradshaw. Upstairs: brother James Bradshaw.



# Pecan Grove Cemetery

This map of Pecan Grove Cemetery in McKinney shows the final resting places of Jesse Bone and his uncle R.L. Ray and their spouses.

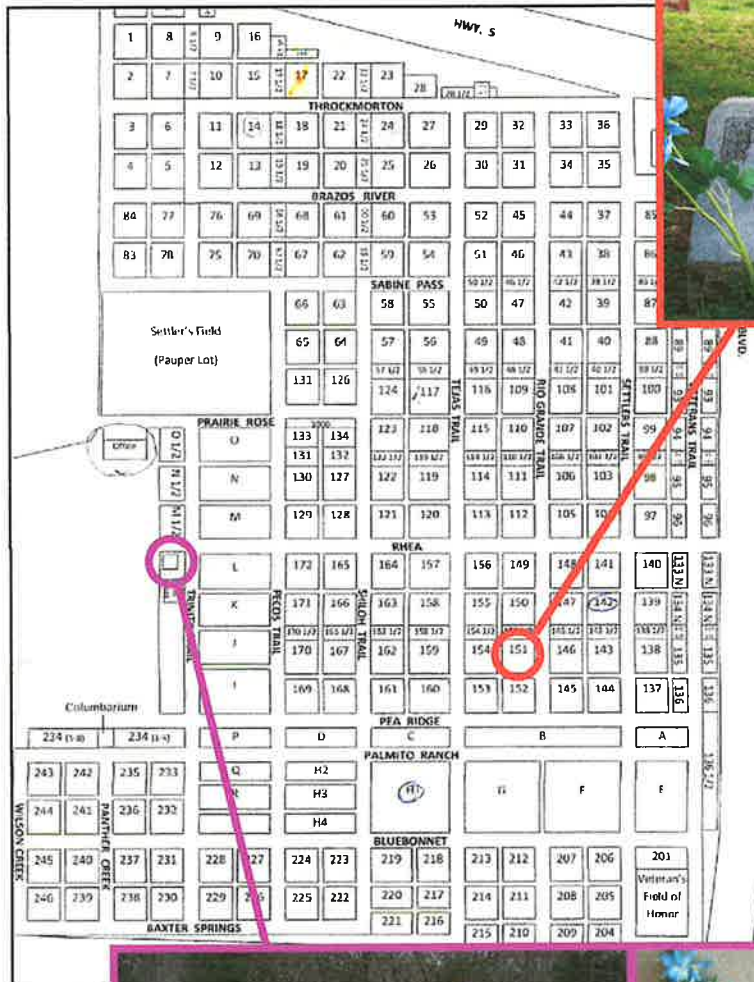

Robert L. Ray, 1866-1940  
Lula H. (Bone) Ray, 1871-1964



Resthaven Mausoleum  
Jesse F. Bone, 1878-1968  
Ola Bone, 1887-1975