

# Subzi Mandi Site Plan

22-0109SP

# Location Map

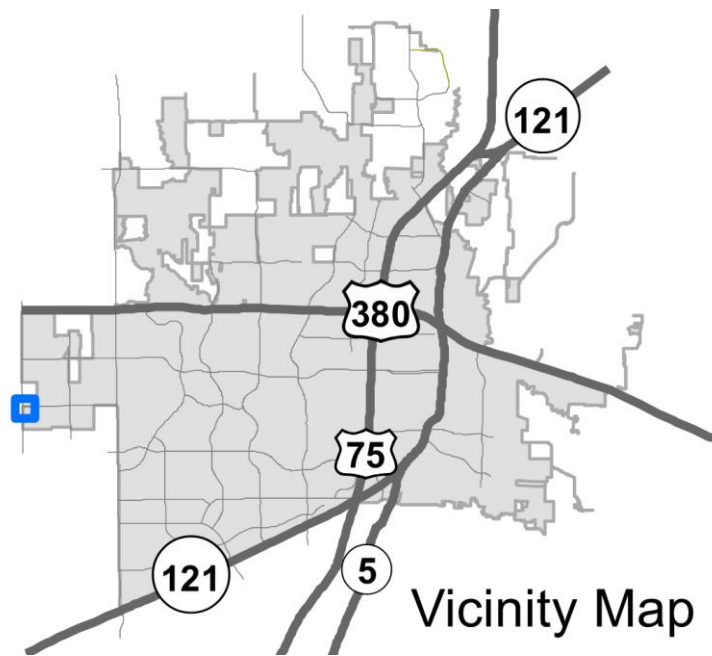
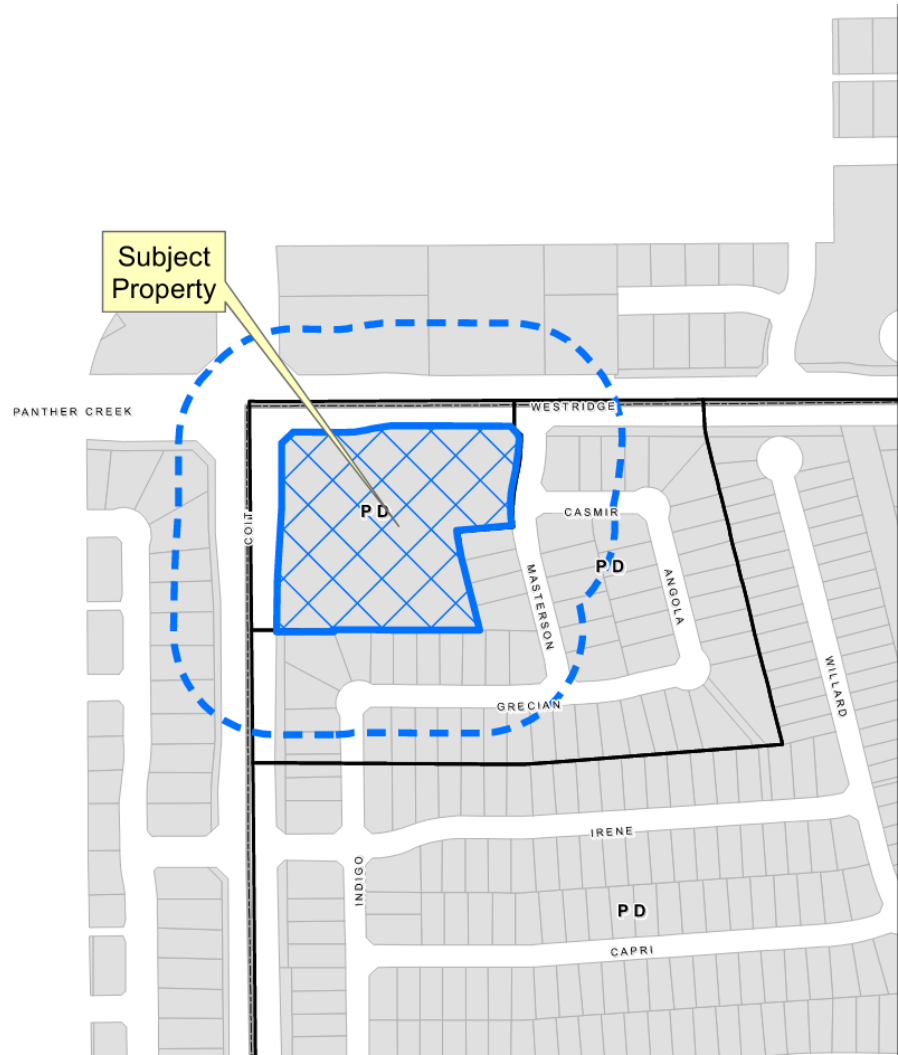

# Aerial Exhibit

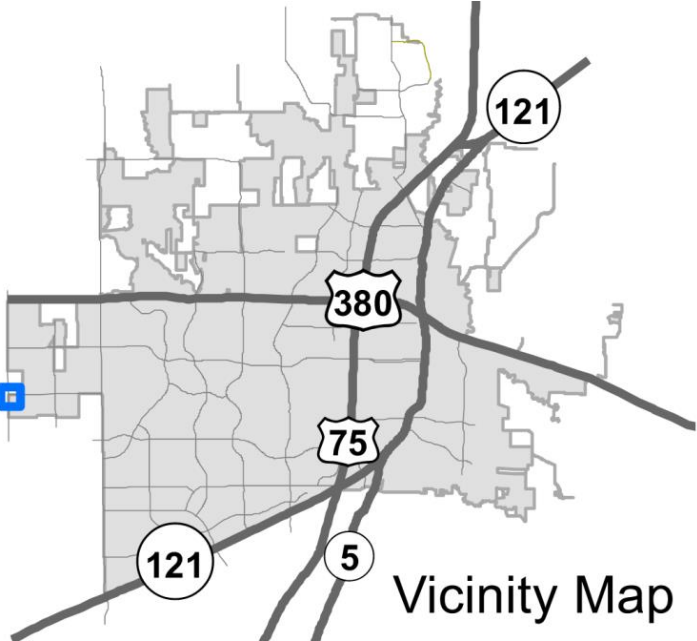



# Proposed Site Plan

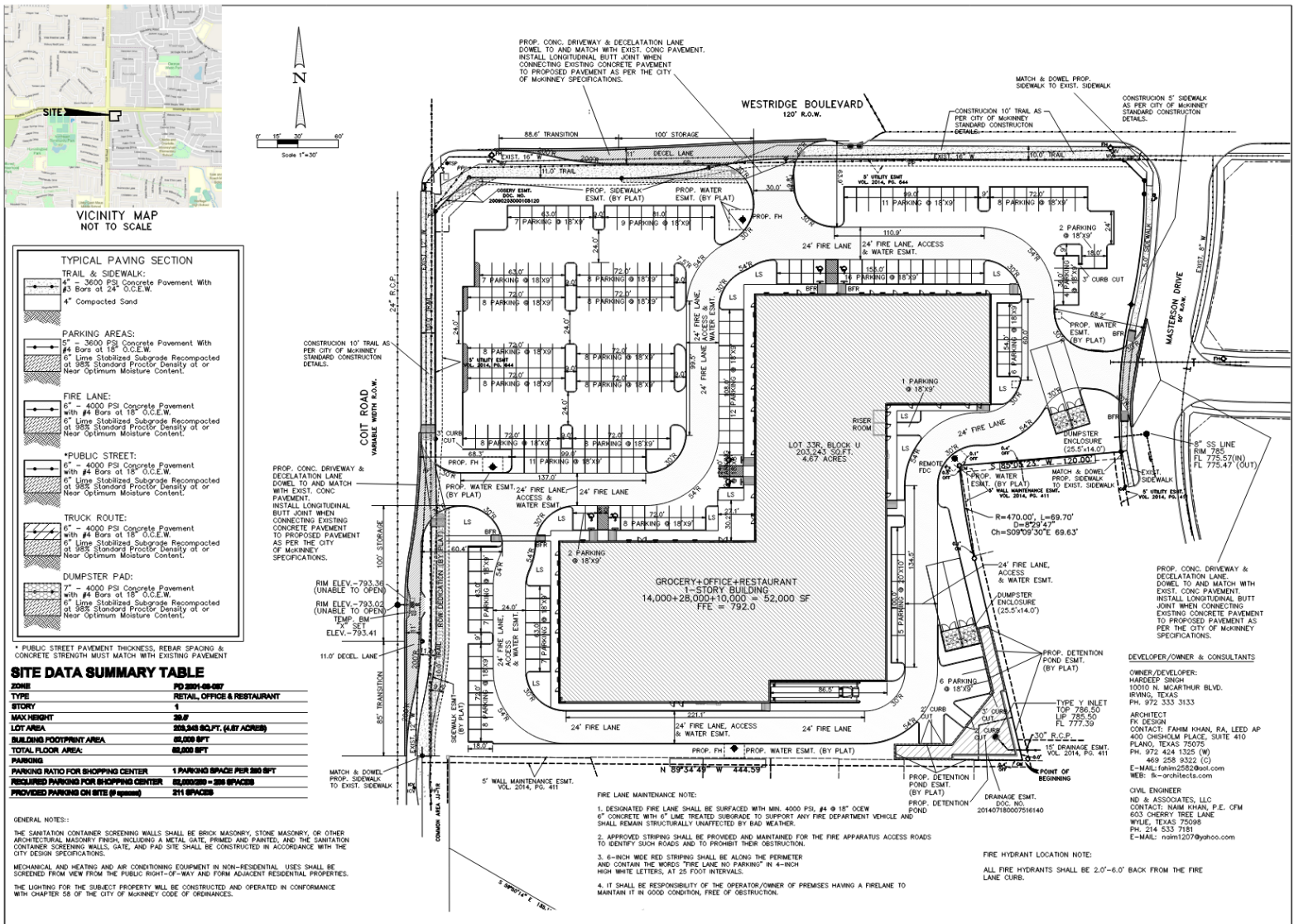

**florarchitect**

400 children place  
suite 210  
plano, texas 75075  
phone: 469-258-9322  
fax: 469-258-9322 (c)  
email: info@florarchitect.com  
www: flr-architect.com

**ND & Associates, LLC**  
Professional Engineer  
1100 N. MEADOWS BLVD., SUITE 100  
PLANO, TEXAS 75075  
PH: 972-333-3133

**Original Date:**  
March 07, 2007  
**Issue Log**

NO.	DATE	REVISION
1		
2		
3		
4		
5		

**COPYRIGHT**

**THE HEIGHTS AT WEST RIDGE MULTI-USE FACILITIES**

DEVELOPER/OWNER & CONSULTANTS  
OWNER/DEVELOPER:  
HARDEE'S DINER  
10010 N. MCARTHUR BLVD.  
IRVING, TEXAS  
PH: 972-333-3133  
ARCHITECT:  
FLOR ARCHITECT  
CONTACT: FAHIM KHAN, RA, LEED AP  
553 CHERRY TREE LANE  
PLANO, TEXAS 75075  
PH: 972-424-1325 (M)  
469-258-9322 (C)  
E-MAIL: fahim.2582@gmail.com  
WEB: flr-architect.com  
CIVIL ENGINEER:  
ND & ASSOCIATES, LLC  
CONTACT: NAIM KHAN, P.E., CFM  
553 CHERRY TREE LANE  
WILEY, TEXAS 75098  
PH: 214-533-7181  
E-MAIL: naim1227@yahoo.com

**SITE PLAN**

DATE: 01/25/2008  
BY: [Signature]  
APP: [Signature]  
SHEET NO: 03

# Proposed Landscape Plan

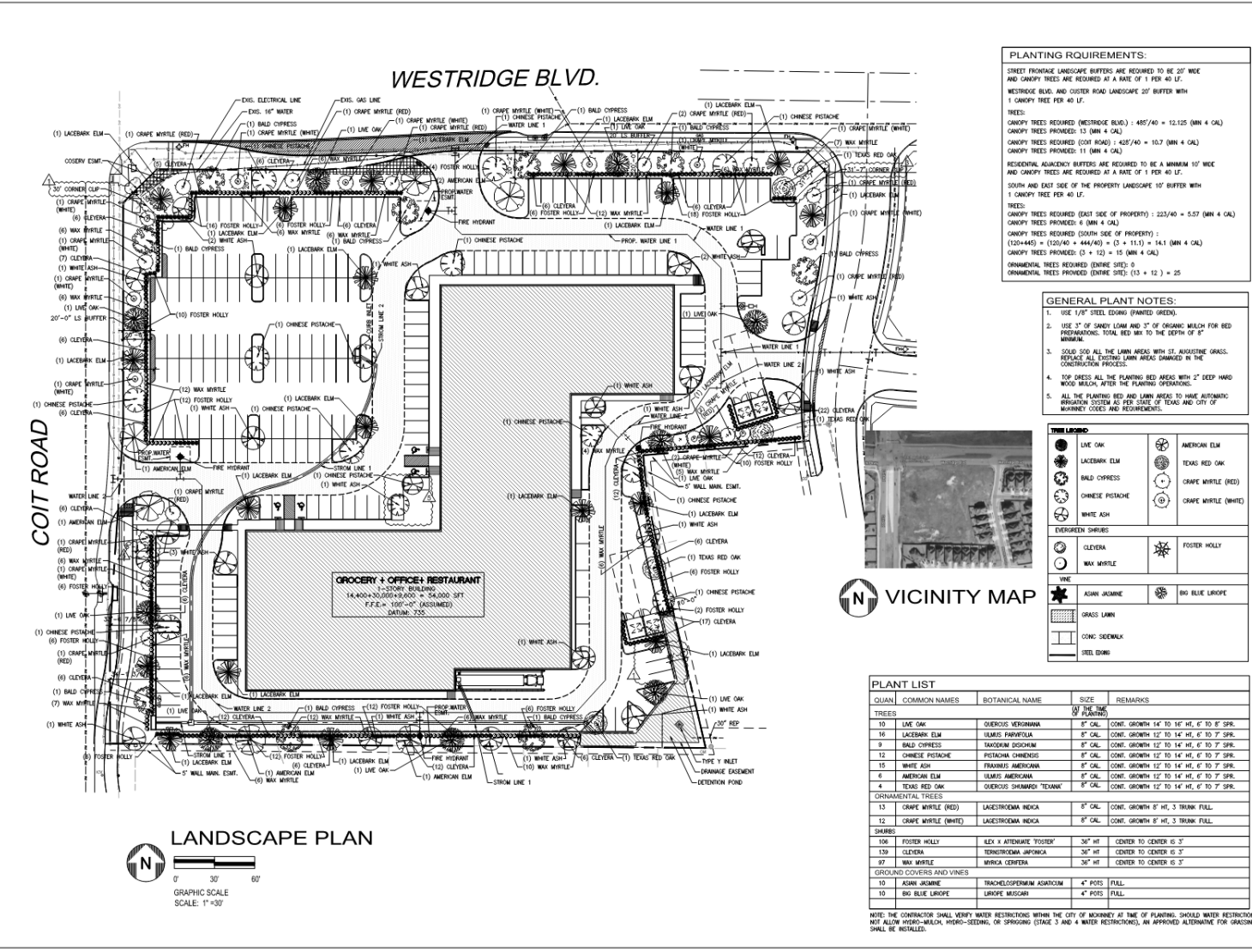

**PLANTING REQUIREMENTS:**

STREET FRONTAGE LANDSCAPE BUFFERS ARE REQUIRED TO BE 20' WIDE AND CANOPY TREES ARE REQUIRED AT A RATE OF 1 PER 40 LF.

WESTRIDGE BLVD. AND COIT ROAD LANDSCAPE 20' BUFFER WITH 1 CANOPY TREE PER 40 LF.

**TREES:**

CANOPY TREES REQUIRED (WESTRIDGE BLVD.) : 485/40 = 12.125 (MIN 4 CAL)

CANOPY TREES PROVIDED: 13 (MIN 4 CAL)

CANOPY TREES REQUIRED (COIT ROAD) : 428/40 = 10.7 (MIN 4 CAL)

CANOPY TREES PROVIDED: 11 (MIN 4 CAL)

RESIDENTIAL AGENCY BUFFERS ARE REQUIRED TO BE A MINIMUM 10' WIDE AND CANOPY TREES ARE REQUIRED AT A RATE OF 1 PER 40 LF.

SOUTH AND EAST SIDE OF THE PROPERTY LANDSCAPE 10' BUFFER WITH 1 CANOPY TREE PER 40 LF.

**TREES:**

CANOPY TREES REQUIRED (EAST SIDE OF PROPERTY) : 223/40 = 5.57 (MIN 4 CAL)

CANOPY TREES PROVIDED: 6 (MIN 4 CAL)

CANOPY TREES REQUIRED (SOUTH SIDE OF PROPERTY) : (120+445) = (120/40 + 445/40) = (3 + 11.13) = 14.13 (MIN 4 CAL)

CANOPY TREES PROVIDED: (3 + 12) = 15 (MIN 4 CAL)

ORNAMENTAL TREES REQUIRED (ENTIRE SITE): 0

ORNAMENTAL TREES PROVIDED (ENTIRE SITE): (13 + 12) = 25

- GENERAL PLANT NOTES:**
- USE 1/8" STEEL BORDS (PAINTED GREEN).
  - USE 3" OF SANDY LOAM AND 3" OF ORGANIC MULCH FOR BED PREPARATIONS. TOTAL BED MAX TO THE DEPTH OF 8".
  - SOLID SSD ALL THE LAWN AREAS WITH ST. AUGUSTINE GRASS. REPLACE ALL EXISTING LAWN AREAS DAMAGED IN THE CONSTRUCTION PROCESS.
  - TOP DRESS ALL THE PLANTING BED AREAS WITH 2" DEEP HARD WOOD MULCH AFTER THE PLANTING OPERATIONS.
  - ALL THE PLANTING BED AND LAWN AREAS TO HAVE AUTOMATIC IRRIGATION SYSTEM AS PER STATE OF TEXAS AND CITY OF HOUSTON CODES AND REQUIREMENTS.

**TIME LOG**

(1) LIVE OAK	(1) AMERICAN ELM
(2) LACINIA	(2) TEXAS RED OAK
(3) BALD CYPRESS	(3) CRAP (WHITE)
(4) CHINESE PISTACHE	(4) CRAP (WHITE)
(5) WHITE ASH	(5) CRAP (WHITE)

**EVERGREEN SHRUBS**

(6) CLEVERA	(6) FOSTER HOLLY
(7) MAX WARTLE	

**VINE**

(8) ASIAN JASMINE	(8) BIG BLUE LIROPE
-------------------	---------------------

**SHRUBS**

(9) GRASS LAWN	
(10) CONG. SEEDMAK	
(11) STEEL BORD	



PLANT LIST				
QUAN	COMMON NAMES	BOTANICAL NAME	SIZE	REMARKS
TREES				
10	LIVE OAK	QUERCUS VERONICA	8" CAL	CONT. GROWTH 12" TO 14" HS. 6" TO 8" SP.
10	LACINIA	ULMUS PARVIFOLIA	8" CAL	CONT. GROWTH 12" TO 14" HS. 6" TO 7" SP.
9	BALD CYPRESS	TAXODIUM GIGIOCHUM	8" CAL	CONT. GROWTH 12" TO 14" HS. 6" TO 7" SP.
12	CHINESE PISTACHE	PISTACHIA CHINESSIS	8" CAL	CONT. GROWTH 12" TO 14" HS. 6" TO 7" SP.
15	WHITE ASH	FRAXINUS AMERICANA	8" CAL	CONT. GROWTH 12" TO 14" HS. 6" TO 7" SP.
6	AMERICAN ELM	ULMUS AMERICANA	8" CAL	CONT. GROWTH 12" TO 14" HS. 6" TO 7" SP.
4	TEXAS RED OAK	QUERCUS SHAMARDYI TEXANUS	8" CAL	CONT. GROWTH 12" TO 14" HS. 6" TO 7" SP.
ORNAMENTAL TREES				
13	CRAP (WHITE)	LAETRODIA INECCA	8" CAL	CONT. GROWTH 8" HS. 3 TRUNK FULL
12	CRAP (WHITE)	LAETRODIA INECCA	8" CAL	CONT. GROWTH 8" HS. 3 TRUNK FULL
106	FOSTER HOLLY	ILEX X ATTENWAE 'FOSTER'	36" HT	CENTER TO CENTER IS 3"
139	CLEVERA	TERSTRICOMA JAPONICA	36" HT	CENTER TO CENTER IS 3"
97	MAX WARTLE	MIRICA CERPENT	36" HT	CENTER TO CENTER IS 3"
GROUND COVERS AND VINES				
10	ASIAN JASMINE	TRACHELOSPERMUM ASATOCUM	4" POTS	FULL
10	BIG BLUE LIROPE	LIROPE MOSCARI	4" POTS	FULL

NOTE: THE CONTRACTOR SHALL VERIFY WATER RESTRICTIONS WITHIN THE CITY OF HOUSTON AT TIME OF PLANTING. SHOULD WATER RESTRICTIONS NOT ALLOW HYDRO-MULCH, HYDRO-SEEDING, OR SPRIGGING (STAGE 3 AND 4 WATER RESTRICTIONS), AN APPROVED ALTERNATIVE FOR GRASSING SHALL BE INSTALLED.

**fk + architect, llc**

4400 chisholm place  
suite 100  
houston, tx 77056  
713-464-1335  
713-464-1335  
713-464-1335  
713-464-1335  
713-464-1335

07/07/2023

Original Date: OCTOBER 16, 2021  
Issue Log

DRP FOR PERM	09/08/21
DRP FOR CONSTRUCTION	09/08/21
CITY OF HOUSTON	09/08/21
CITY OF HOUSTON	09/08/21
CITY OF HOUSTON	09/08/21
CITY OF HOUSTON	09/08/21

100% MFC

COPYRIGHT

**SUBZI MANDI**  
**SHELL AND INTERIOR FINISH-OUT**  
AT LOT 308, BLOCK U  
MOONNET, TEXAS

Sheet Number: **LS100**  
Project Number: 22014

