

105 WESTPARK DR. S
75072 MCKINNEY, TEXAS

1 ZONING EXHIBIT
C1.01 1" = 20' - 0"
LOT 2
BLOCK A

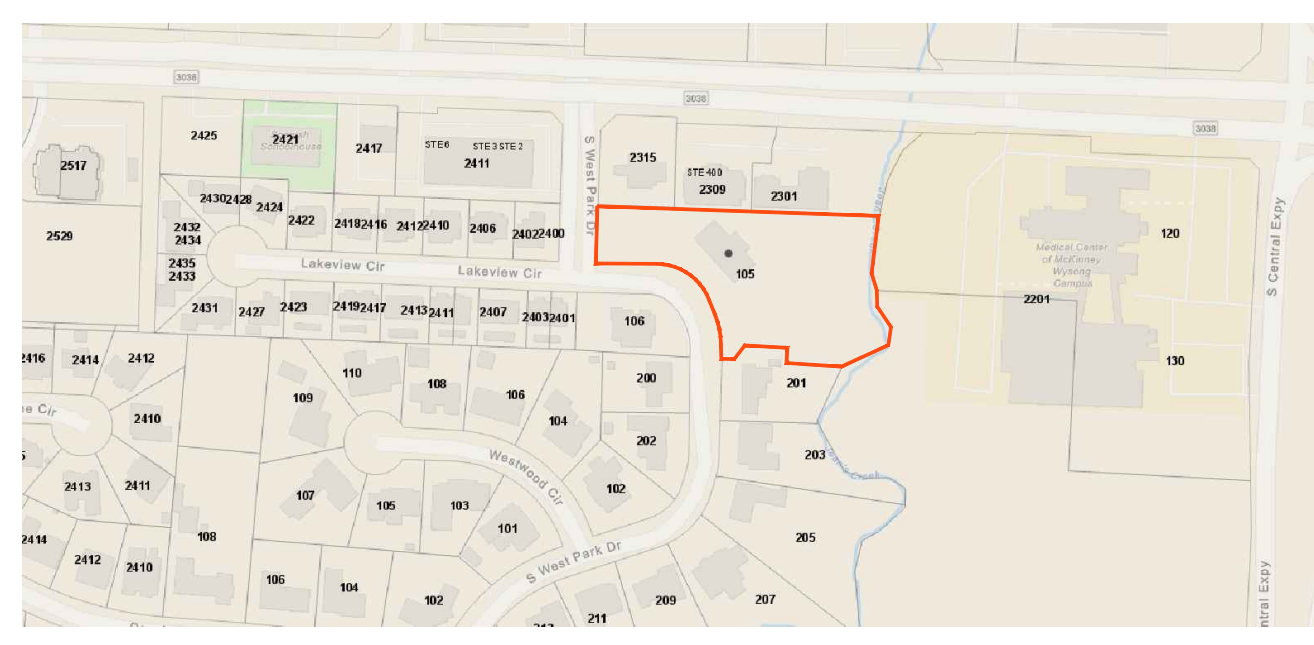

1 VICINITY MAP
C1.01 FOR REFERENCE ONLY

- STANDARD NOTATION
- "Sanitation container screening walls will be brick masonry, stone, masonry, or other architectural masonry finish, including a metal gate, primed and painted, and the sanitation container screening walls, gate, and pad site will be constructed in accordance with the city's design specifications."
 - "Mechanical and heating and air conditioning equipment in non-residential uses shall be screened from view from the public right-of-way and from adjacent residential properties."
 - "Lighting for the subject property will be constructed in conform-ance with Chapter 58 of the City of McKinney Code of Ordinances."

***TRASH ENCLOSURE AND CONSTRUCTION SITE MANAGEMENT SIGN MUST BE POSTED IN AN AREA VISIBLE TO THE INSPECTOR.

SEAL

CONSTRUCTION CONCEPTS INC.
"Planning and Designing a Better Tomorrow"
317 E. JEFFERSON BLVD.
DALLAS, TX. 75203
TEL. (214) 946-4300
FAX. (214) 948-9544

REVISIONS	
DRAFTER	SENT DATE

ADDRESS
105 WESTPARK DR. S
MCKINNEY, TEXAS
75072

DATE
08/03/2023

DRAWN BY
IB

CHECKED BY
ER

DESCRIPTION
**ONE STORY SINGLE FAMILY RESIDENCE
TWO CAR ATTACHED GARAGE**

SCALE
1" = 20' - 0"

SHEET TITLE
ZONING EXHIBIT

SHEET #
C1.01

FILE NAME
C1.01_ZONING_EXHIBIT