

- GENERAL SITE PLAN NOTES
1. ALL DIMENSIONS SHOWN ARE TO FACE OF STUD UNLESS OTHERWISE NOTED.
 2. HOUSE DATUM: X.X' = 6' - 6"

URBAN NEST
development
5555 amesbury drive
dallas, tx
75206
817.522.6248
demon@urbannestdevelopment.com

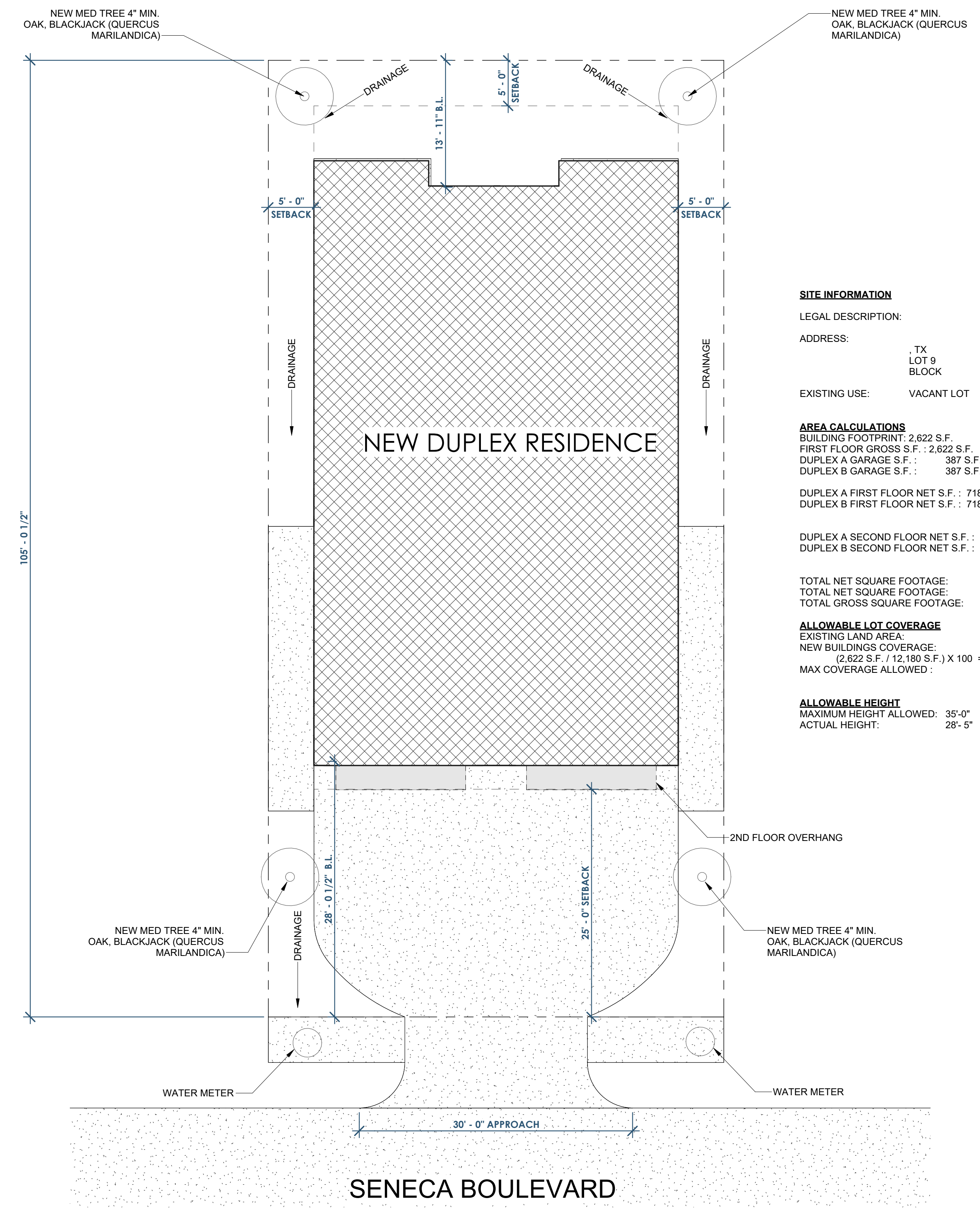
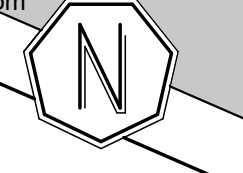

SITE INFORMATION

LEGAL DESCRIPTION:

ADDRESS: TX LOT 9 BLOCK

EXISTING USE: VACANT LOT

AREA CALCULATIONS

BUILDING FOOTPRINT: 2,622 S.F.
FIRST FLOOR GROSS S.F.: 2,622 S.F.
DUPLEX A GARAGE S.F.: 387 S.F.
DUPLEX B GARAGE S.F.: 387 S.F.
DUPLEX A FIRST FLOOR NET S.F.: 718 S.F.
DUPLEX B FIRST FLOOR NET S.F.: 718 S.F.

DUPLEX A SECOND FLOOR NET S.F.: 1,003 S.F.
DUPLEX B SECOND FLOOR NET S.F.: 1,003 S.F.

TOTAL NET SQUARE FOOTAGE: 1,721 S.F. PER SIDE
TOTAL NET SQUARE FOOTAGE: 3,442 S.F.
TOTAL GROSS SQUARE FOOTAGE: 5,003 S.F.

ALLOWABLE LOT COVERAGE

EXISTING LAND AREA: 6,050 SQ. FT.
NEW BUILDINGS COVERAGE:
(2,622 S.F. / 12,180 S.F.) X 100 = 22%
MAX COVERAGE ALLOWED: 60%

ALLOWABLE HEIGHT

MAXIMUM HEIGHT ALLOWED: 35'-0"
ACTUAL HEIGHT: 28'-5"

① Site
1/8" = 1'-0"



AE EQUITY GROUP
FUTURE DUPLEX RESIDENCE AT 501 SENECA BLVD

| Issue Date | Revision |
|------------|----------|
| 01/28/2026 | |
| | |
| | |
| | |

These drawings and details are the sole property of URBAN NESTS DEVELOPMENT, LLC and may be used for this specific project only. They shall not be loaned, copied or reproduced, in whole or in part, for any other purpose or project without the written consent of the Architect.
(C) URBAN NEST DEVELOPMENT LLC, 2026

26009

SITE PLAN

G101