

PLANT SCHEDULE

SYMBOL	CODE	QTY	BOTANICAL / COMMON NAME
TREES			
	CI	15	CARYA ILLINOINENSIS / PECAN
	PC2	10	PISTACIA CHINENSIS / CHINESE PISTACHE
	QMA	12	QUERCUS MACROCARPA / BURR OAK
	UC2	19	ULMUS CRASSIFOLIA / CEDAR ELM
SHRUBS			
	AGE	10	ABELIA X GRANDIFLORA 'EDWARD GOUCHER' / GLOSSY ABELIA
	ID	88	ILEX CORNUTA 'DWARF BURFORD' / DWARF BURFORD HOLLY
	MYP	78	MYRICA PUSILLA / DWARF SOUTHERN WAX MYRTLE
GROUND COVERS			
	EFC	1,075	EUONYMUS FORTUNEI 'COLORATUS' / COLORATUS PURPLE WINTERCREEPER
	TA2	1,339	TRACHELOSPERMUM ASIATICUM / ASIATIC JASMINE
SOD/SEED			
	CD	31,929 SF	CYNODON DACTYLON / BERMUDA GRASS

REFERENCE NOTES SCHEDULE

SYMBOL	DESCRIPTION	QTY	DETAIL
1	STEEL EDGING	477 LF	4/L2.01
2	DECOMPOSED GRANITE	1,093 SF	5/L2.01

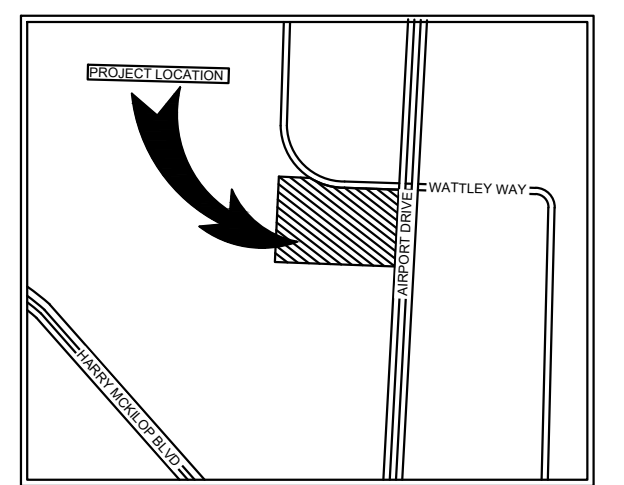

VICINITY MAP
(NOT TO SCALE)

INTERIM REVIEW
THESE DOCUMENTS ARE INTENDED FOR INTERIM REVIEW ONLY AND NOT FOR REGULATORY APPROVAL, PERMITTING, OR CONSTRUCTION.
REGISTERED LANDSCAPE ARCHITECT
TRICK & WALKER
TEXAS REGISTRATION NUMBER 2225

ISSUED FOR PRELIMINARY PRICING PURPOSES ONLY
(SUBJECT TO REVISION PRIOR TO CONSTRUCTION)
THESE DOCUMENTS HAVE BEEN PREPARED BY THE ENGINEER WITH THE INTENT OF COMPLYING WITH ALL CITY STANDARD REQUIREMENTS. THESE DOCUMENTS HAVE NOT BEEN APPROVED AND RELEASED FOR CONSTRUCTION BY THE CITY AS OF THIS DATE AND THEREFORE, REVISIONS MAY BE REQUIRED PRIOR TO CONSTRUCTION. BY ANY USE OF THESE DOCUMENTS, THE USER AFFIRMS THEIR UNDERSTANDING OF THE PRELIMINARY STATUS OF THE PLANS AND THE POTENTIAL FOR REVISION PRIOR TO ANY CONSTRUCTION.

NO.	DATE	ISSUE
3	08/06/2024	CITY RESUBMITTAL
2	07/22/2024	CITY RESUBMITTAL
1	06/10/2024	CITY SUBMITTAL

NO.	DATE	REVISION

Westwood
118 N. OHIO STREET
CELINA, TX 75009
214.451.2765

PLANTING PLAN
FRONTIER WASTE
AIRPORT SITE
1280 FM 546
CITY OF MCKINNEY, COLLIN COUNTY, TEXAS

DESIGN	DRAWN	DATE	SCALE	NOTES	FILE	NO.
SRR	NTH	AUG. 2024	AS SHOWN			L2.00

PLANTING PLAN
1" = 30'-0"

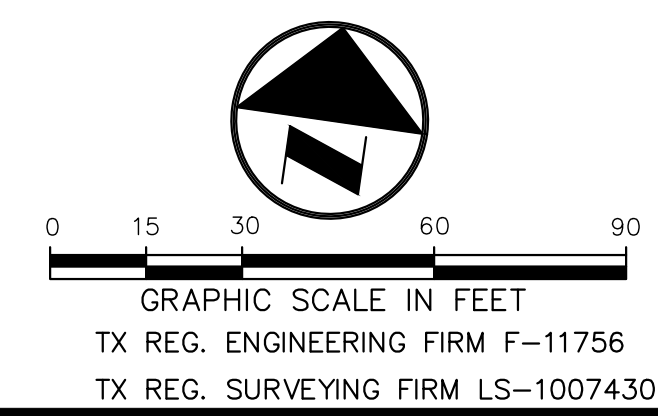

FRONTIER WASTE AIRPORT SITE

PLANT SCHEDULE

SYMBOL	CODE	QTY	BOTANICAL / COMMON NAME	SIZE/COND.	REMARKS	
TREES						
	CI	15	CARYA ILLINOINENSIS / PECAN	4" CAL.	SINGLE, STRAIGHT LEADER, MATCHING, 12 FT HT MIN.	
	PC2	10	PISTACIA CHINENSIS / CHINESE PISTACHE	4" CAL.	SINGLE, STRAIGHT LEADER, MATCHING, 12 FT HT MIN.	
	QMA	12	QUERCUS MACROCARPA / BURR OAK	4" CAL.	SINGLE, STRAIGHT LEADER, MATCHING, 12 FT HT MIN.	
	UC2	19	ULMUS CRASSIFOLIA / CEDAR ELM	4" CAL.	SINGLE, STRAIGHT LEADER, MATCHING, 12 FT HT MIN.	
SYMBOL	CODE	QTY	BOTANICAL / COMMON NAME	SIZE	REMARKS	
SHRUBS						
	AGE	10	ABELIA X GRANDIFLORA `EDWARD GOUCHER` / GLOSSY ABELIA	3 GAL	FULL, MATCHING, 2 FT HT MIN.	
	ID	88	ILEX CORNUTA `DWARF BURFORD` / DWARF BURFORD HOLLY	3 GAL	FULL, MATCHING, 3 FT HT MIN.	
	MYP	78	MYRICA PUSILLA / DWARF SOUTHERN WAX MYRTLE	3 GAL	FULL, MATCHING, 2 FT HT MIN.	
SYMBOL	CODE	QTY	BOTANICAL / COMMON NAME	SIZE	SPACING	REMARKS
GROUND COVERS						
	EFC	1,075	EUONYMUS FORTUNEI `COLORATUS` / COLORATUS PURPLE WINTERCREEPER	4"POT	18" o.c.	FULL, MATCHING
	TA2	1,339	TRACHELOSPERMUM ASIATICUM / ASIATIC JASMINE	4"POT	18" o.c.	FULL, MATCHING
SOD/SEED						
	CD	31,929 SF	CYNODON DACTYLON / BERMUDA GRASS	SOD		SOLID, ROLLED TIGHT, SAND FILLED JOINTS, 100% WEED, PEST AND DISEASE FREE

PLANTING GENERAL NOTES

- ALL PLANTS SHALL BE SET OUT FOR APPROVAL BY THE OWNER'S REPRESENTATIVE PRIOR TO INSTALLATION.
- FINE GRADING SHALL BE PERFORMED IN ALL AREAS TO BE LANDSCAPED. FINE GRADING SHALL INCLUDE THE REMOVAL OF DEBRIS, ROCKS, ETC. FROM THE SITE AND INSURE POSITIVE DRAINAGE IN ALL AREAS.
- THE CONTRACTOR SHALL LOCATE ALL UTILITIES AND EASEMENTS IN THE FIELD PRIOR TO COMMENCEMENT OF WORK. CONTRACTOR IS RESPONSIBLE FOR ANY DAMAGE TO UTILITIES DURING THE COURSE OF CONSTRUCTION.
- WRITTEN DIMENSIONS SHALL GOVERN OVER SCALED DIMENSIONS.
- THE CONTRACTOR SHALL REFER TO THE SPECIFICATIONS FOR ADDITIONAL INFORMATION AND REQUIREMENTS ASSOCIATED WITH THE LANDSCAPE AND ACCESSORIES.
- ALL PLANT MATERIALS SHALL MEET ANSI Z60.1 STANDARDS FOR CALIPER, HEIGHT AND ROOT BALL SIZE. ANY MATERIALS THAT DO NOT MEET OR EXCEED SUCH STANDARDS SHALL BE REJECTED AND REPLACED AT THE CONTRACTOR'S EXPENSE.
- BALLED AND BURLAPPED TREES SHALL HAVE THE TOP HALF OF THE WIRE BASKET REMOVED. THE BURLAP SHALL BE REMOVED TO THE GREATEST EXTENT POSSIBLE, USING A KNIFE TO CUT AND REMOVE THE BOTTOM HALF UNDER THE WIRE BASKET THAT REMAINS.
- QUANTITIES ARE SHOWN FOR CONVENIENCE ONLY. CONTRACTOR IS RESPONSIBLE FOR VERIFYING ALL QUANTITIES

REFERENCE NOTES SCHEDULE

SYMBOL	DESCRIPTION	QTY	DETAIL
①	STEEL EDGING	477 LF	4/L2.01
②	DECOMPOSED GRANITE	1,093 SF	5/L2.01

MCKINNEY LANDSCAPE REQUIREMENTS - FRONTIER WASTE

ZONING : LIGHT INDUSTRIAL			
LIMIT OF CONSTRUCTION LANDSCAPE AREA (10% MIN OF DEVELOPED SITE TO BE PERMANENT LANDSCAPE AREA)			
TOTAL SITE AREA	SITE AREA X 10%	REQUIRED	PROVIDED
277,462 SF	277,462 X .10 =	27,747 SF (10%)	52,723 SF (19%)
STREET FRONTAGE BUFFER (MIN 20 FT LANDSCAPE BUFFER ADJACENT TO MAJOR THOROUGHFARES)			
PROJECT SETBACK 20' FROM MAJOR THOROUGHFARE			
VEHICULAR USE BUFFER (MIN 5 FT LANDSCAPE BUFFER BETWEEN PROPERTY LINE AND EDGE OF PARKING AREAS)			
PROPOSED PARKING AREAS ARE MIN. 5FT FROM PROPERTY BOUNDARIES			
CORNER CLIP LANDSCAPE BUFFER (30 FT LANDSCAPE BUFFER PARALLEL TO THE 25'X25' CORNER CLIP ROW DEDICATION)			
NO CORNER CLIP LANDSCAPE BUFFER REQUIRED			
STREET YARD LANDSCAPE AREA (15% MIN OF STREET YARD TO BE PERMANENT LANDSCAPE AREA)			
TOTAL STREET YARD	STREET YARD X 15%	REQUIRED	PROVIDED
9,231 SF	9,231 X .15 =	1,385 SF	1,385 SF
STREET TREES (1 TREE FOR EVERY 40 OR 30 LF OF STREET FRONTAGE)			
STREET NAME	LINEAR FEET / 40 OR 30	REQUIRED	PROVIDED
WATTLE WAY	574 LF / 40	15	10*
AIRPORT DRIVE	409 LF / 30	14	14
TOTAL STREET TREES		29	29
PARKING LOT TREES			
EACH PARKING SPACE MUST BE WITHIN 65' OF A TREE.** - PROVIDED			
ONE CANOPY TREE MUST BE PROVIDED IN THE PLANTING AREA FOR EVERY 7 PARKING SPACES. - PROVIDED			
A LANDSCAPE ISLAND MUST BE LOCATED AT THE TERMINUS OF EACH PARKING ROW AND INCLUDE AT LEAST ONE CANOPY TREE. - PROVIDED			
PARKING LOT SCREENING (75% OF TOTAL PARKING LOT FRONTAGE TO BE SCREENED)			
TOTAL PARKING LOT FRONTAGE	REQUIRED	PROVIDED	
552	YES	YES	
LOADING DOCK SCREENING (LOADING DOCKS OR STRUCTURES, BAYS AND BAY DOORS MUST BE SCREEN FROM THE R.O.W.)			
REQUIRED	PROVIDED		
N/A	N/A		
TREE MITIGATION REQUIREMENTS			
REQUIRED INCHES	PROVIDED INCHES		
650	220		
*PROTECTED TREES TO COUNT TOWARD STREET TREE REQUIREMENT ON WATTLE WAY.			
**PROTECTED TREES ALONG SOUTH PARKING COUNT TOWARD THE TREE SPACING REQUIREMENT.			
***PAYMENT DEPENDANT ON CITY OF MCKINNEY DIRECTOR OF PLANNING PER ARTICLE 2, SECTION 4 - G OF UNIFIED DEVELOPMENT CODE			

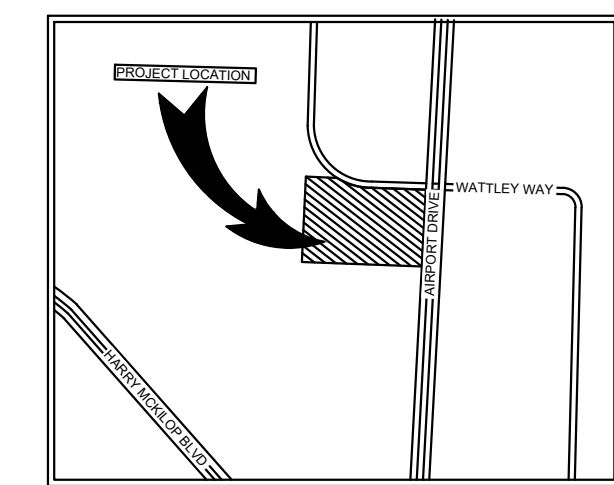

INTERIM REVIEW
 THESE DOCUMENTS ARE INTENDED FOR INTERIM REVIEW ONLY AND NOT FOR REGULATORY APPROVAL/PERMITTING OR CONSTRUCTION.
 REGISTERED LANDSCAPE ARCHITECT
 TRICKS & WALKER
 TEXAS REGISTRATION NUMBER 2225

VICINITY MAP (NOT TO SCALE)

**ISSUED FOR PRELIMINARY PRICING PURPOSES ONLY
(SUBJECT TO REVISION PRIOR TO CONSTRUCTION)**

THESE DOCUMENTS HAVE BEEN PREPARED BY THE ENGINEER WITH THE INTENT OF COMPLYING WITH ALL CITY STANDARD REQUIREMENTS. THESE DOCUMENTS HAVE **NOT** BEEN APPROVED AND RELEASED FOR CONSTRUCTION BY THE CITY AS OF THIS DATE AND THEREFORE, REVISIONS MAY BE REQUIRED PRIOR TO CONSTRUCTION. BY ANY USE OF THESE DOCUMENTS, THE USER AFFIRMS THEIR UNDERSTANDING OF THE PRELIMINARY STATUS OF THE PLANS AND THE POTENTIAL FOR REVISION PRIOR TO ANY CONSTRUCTION.

NO.	DATE	ISSUE
3	08/06/2024	CITY RESUBMITTAL
2	07/22/2024	CITY RESUBMITTAL
1	06/10/2024	CITY SUBMITTAL
NO.	DATE	REVISION

Westwood
 118 N. OHIO STREET
 CELINA, TX 75009
 214.451.2765

PLANTING NOTES AND SCHEDULES FRONTIER WASTE AIRPORT SITE 1280 FM 546 CITY OF MCKINNEY, COLLIN COUNTY, TEXAS

DESIGN	DRAWN	DATE	SCALE	NOTES	FILE	NO.
SRR	NTH	AUG. 2024	AS SHOWN			L2.01

TX REG. ENGINEERING FIRM F-11756
 TX REG. SURVEYING FIRM LS-10074301

FRONTIER WASTE AIRPORT SITE

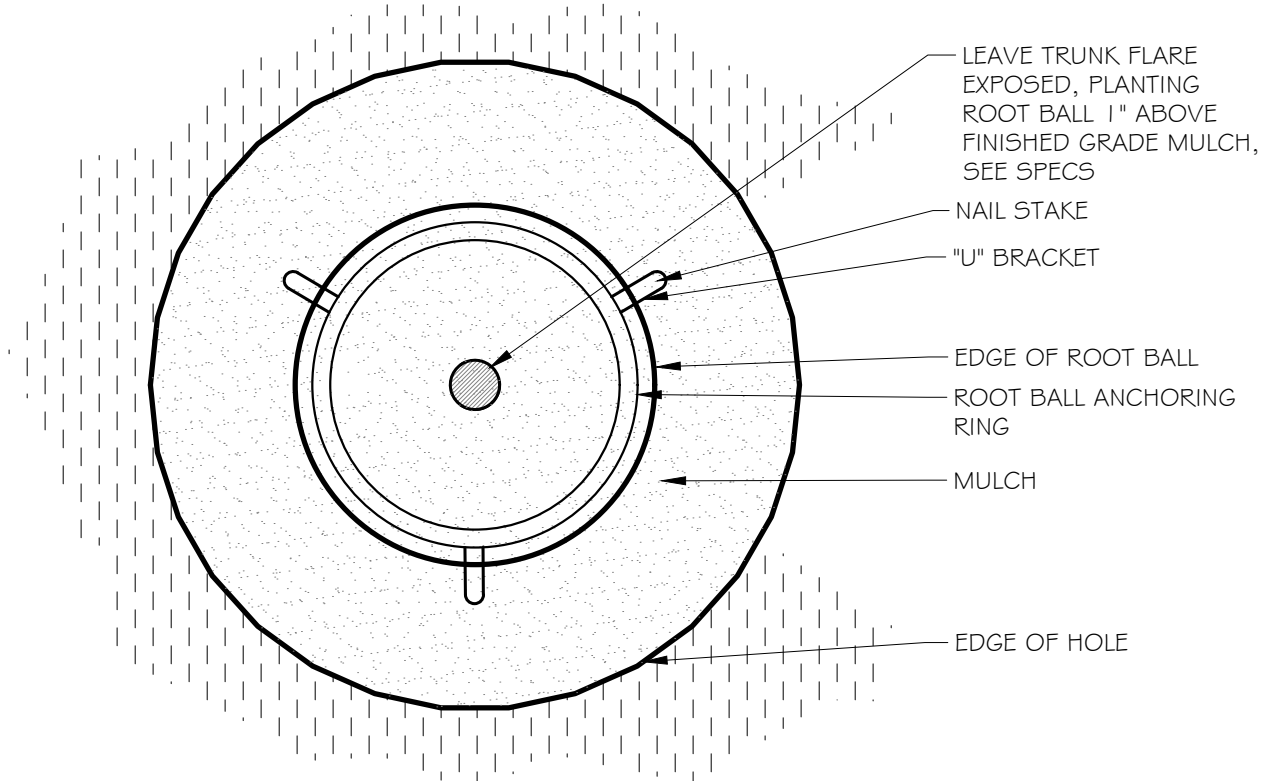

NOTE: DO NOT CREATE WATERING RING (SAUCER) AROUND TREE PIT

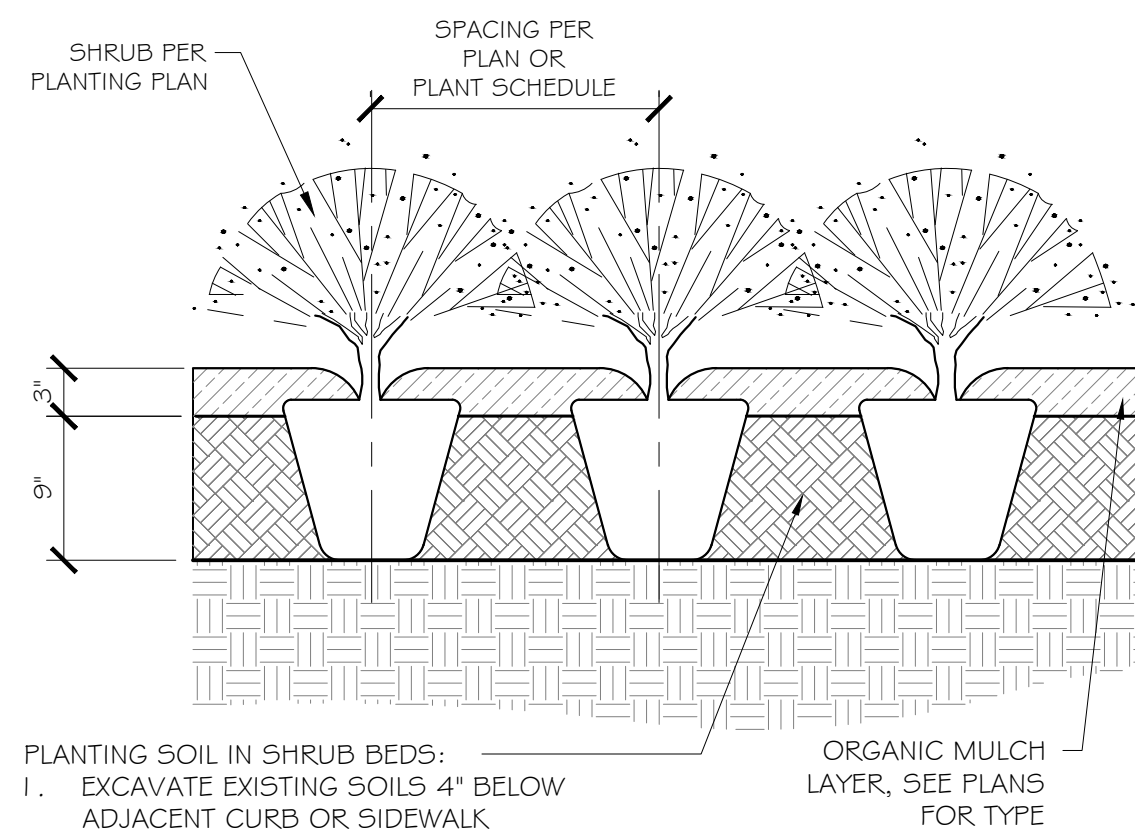

PLANTING SOIL IN SHRUB BEDS:

1. EXCAVATE EXISTING SOILS 4" BELOW ADJACENT CURB OR SIDEWALK
2. ADD 3" COMPOST & TILL INTO 6" EXISTING SOILS, CREATING 9" PLANTING SOIL
3. ADD 3" DARK BROWN FINE-SHREDDED HARDWOOD ORGANIC MULCH AFTER PLANTING

ORGANIC MULCH LAYER, SEE PLANS FOR TYPE

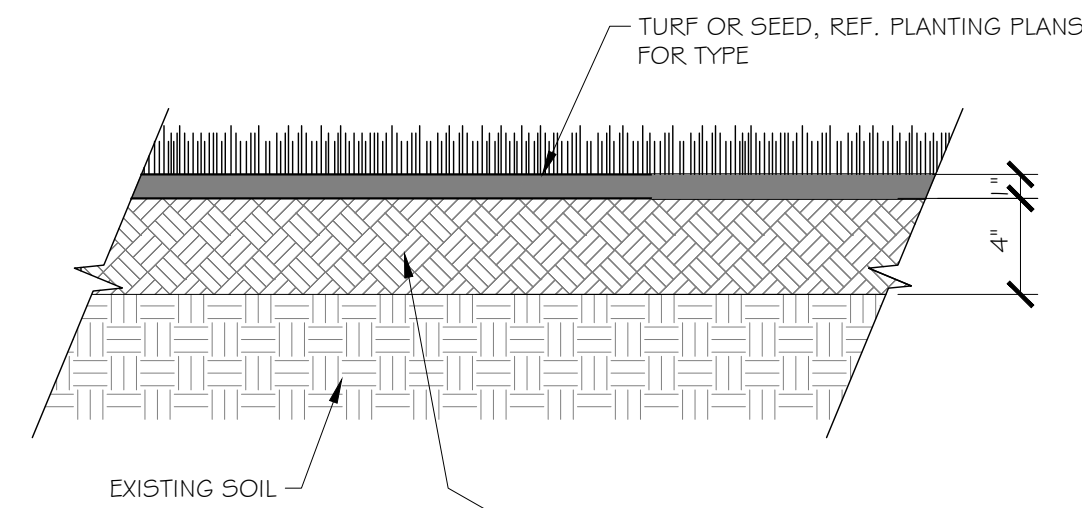

TOPSOIL PREP:

1. FINISH GRADE TOPSOIL BY REMOVING STONES LARGER THAN 1" IN ANY DIMENSION AND STICKS, ROOTS, RUBBISH, AND OTHER EXTRANEEOUS MATTER TO LEGALLY DISPOSE OF THEM OFF OWNER'S PROPERTY.
2. ADD 1" COMPOST ON THE SURFACE, THEN TILL TO 4" DEPTH
3. INSTALL SOD AND SEED AS SHOWN AND NOTED PER SPECIFICATIONS, REF. PLANTING PLANS FOR TYPE

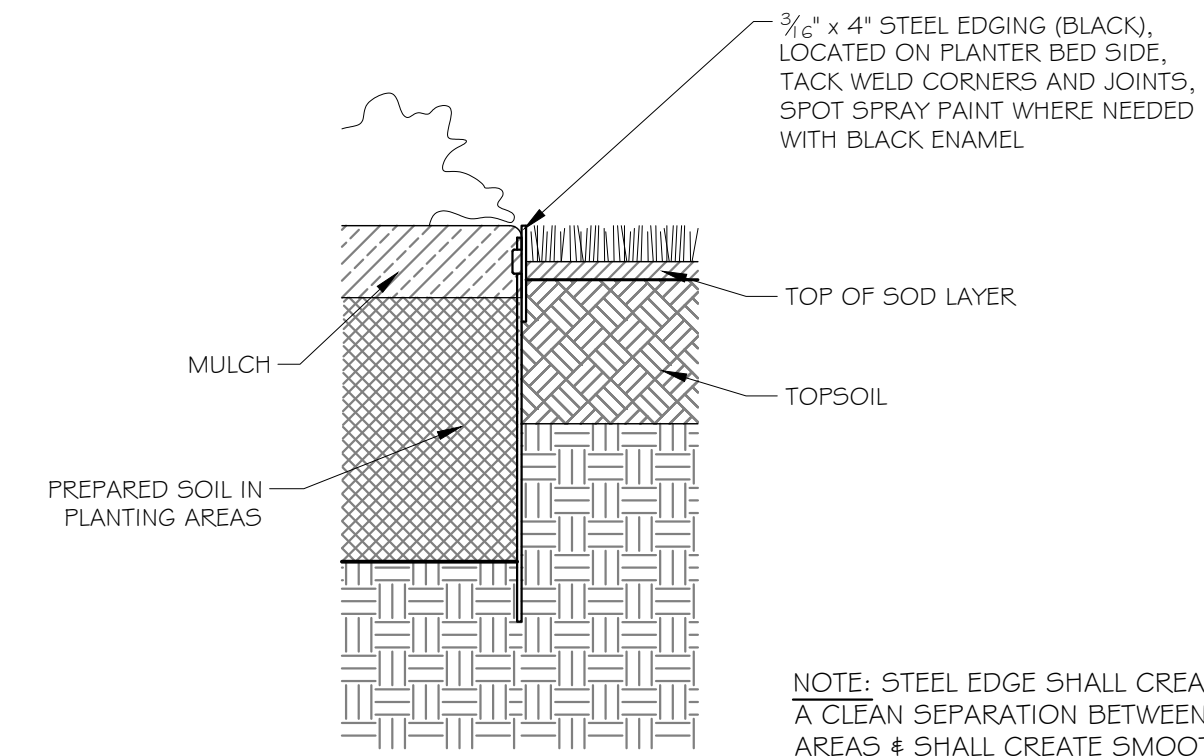

NOTE: STEEL EDGE SHALL CREATE A CLEAN SEPARATION BETWEEN AREAS & SHALL CREATE SMOOTH, EVEN LINES (AS INDICATED ON THE PLANS)

2 TYP. SHRUB PLANTING
1" = 1'-0"

3 SOIL PROFILE FOR SOD & SEED
1 1/2" = 1'-0"

4 STEEL EDGING AT PLANTING
1 1/2" = 1'-0"

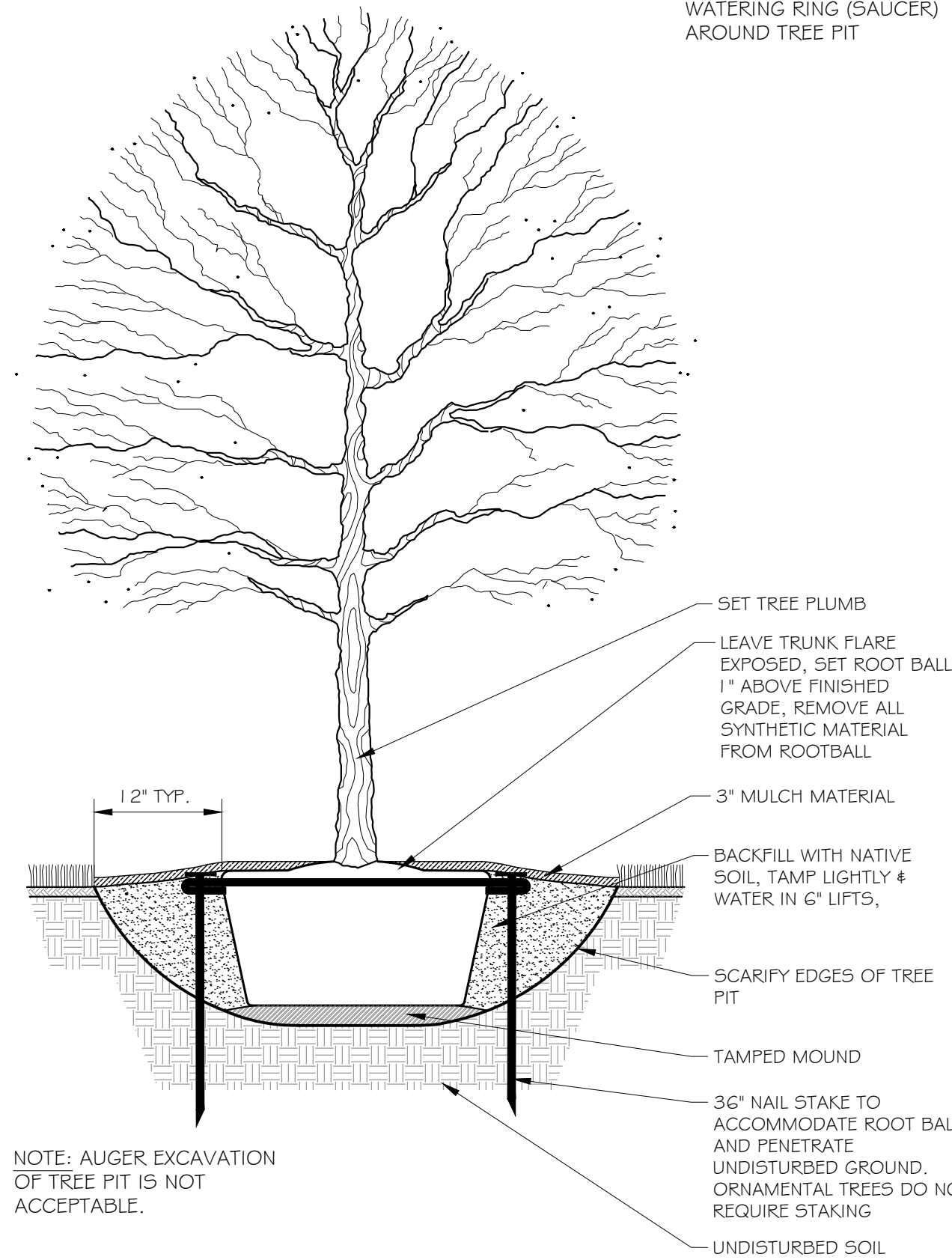

NOTE: AUGER EXCAVATION OF TREE PIT IS NOT ACCEPTABLE.

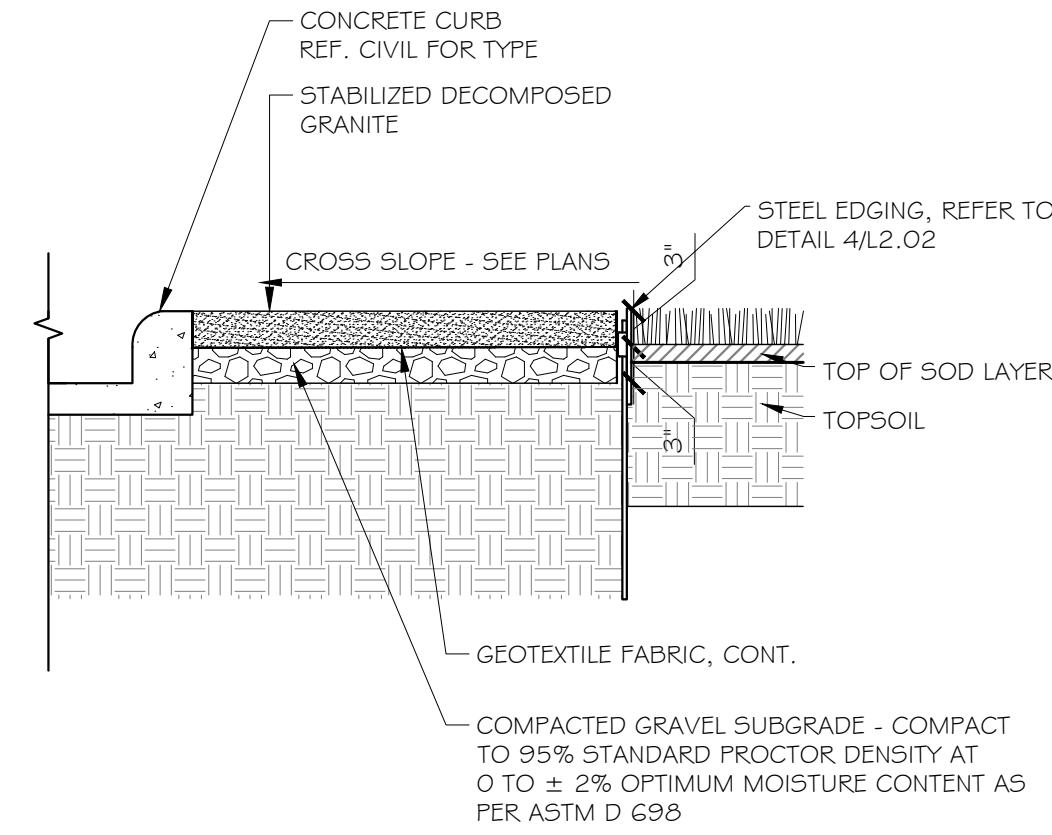

5 DECOMPOSED GRANITE
3/4" = 1'-0"

1 CANOPY TREE W/ UNDERGROUND STAKES
3/4" = 1'-0"

INTERIM REVIEW
THESE DOCUMENTS ARE INTENDED FOR INTERIM REVIEW ONLY AND NOT FOR REGULATORY APPROVAL, PERMITTING, OR CONSTRUCTION.
REGISTERED LANDSCAPE ARCHITECT
TRICK & WALKER
TEXAS REGISTRATION NUMBER 2225

ISSUED FOR PRELIMINARY PRICING PURPOSES ONLY
(SUBJECT TO REVISION PRIOR TO CONSTRUCTION)

THESE DOCUMENTS HAVE BEEN PREPARED BY THE ENGINEER WITH THE INTENT OF COMPLYING WITH ALL CITY STANDARD REQUIREMENTS. THESE DOCUMENTS HAVE NOT BEEN APPROVED AND RELEASED FOR CONSTRUCTION BY THE CITY AS OF THIS DATE AND THEREFORE REVISIONS MAY BE REQUIRED PRIOR TO CONSTRUCTION. BY ANY USE OF THESE DOCUMENTS, THE USER AFFIRMS THEIR UNDERSTANDING OF THE PRELIMINARY STATUS OF THE PLANS AND THE POTENTIAL FOR REVISION PRIOR TO ANY CONSTRUCTION.

NO.	DATE	ISSUE
3	08/06/2024	CITY RESUBMITTAL
2	07/22/2024	CITY RESUBMITTAL
1	06/10/2024	CITY SUBMITTAL
NO.	DATE	REVISION

Westwood
118 N. OHIO STREET
CELINA, TX 75009
214.451.2765

PLANTING DETAILS
FRONTIER WASTE
AIRPORT SITE
1280 FM 546

CITY OF MCKINNEY, COLLIN COUNTY, TEXAS

DESIGN	DRAWN	DATE	SCALE	NOTES	FILE	NO.
SRR	NTH	AUG. 2024	AS SHOWN			L2.02

TX REG. ENGINEERING FIRM F-11756
TX REG. SURVEYING FIRM LS-10074301

WW FILE: 0052915.00

FRONTIER WASTE AIRPORT SITE