



HISTORIC RESOURCES SURVEY '23

Historic Preservation Office
City of McKinney



WHAT IS A HISTORIC RESOURCES SURVEY?

Photo Documentation

Photographs historic
resources from the public
right of way

Inventory

Creates an inventory of
historic properties, sites, &
objects

Recommendations

Potential landmarks,
districts, & preservation
priorities

WHAT IS A HISTORIC RESOURCE?

According to the National Park Service a historic resource is:

“A constructed work ... consciously created to serve some human activity. Historic structures are usually immovable, although some have been relocated and others are mobile by design.”

This may include:

- Buildings and structures
- Walls, fences, and stockades,
- Structure ruins
- Outdoor Sculpture
- Parks & landscapes
- Cemeteries
- Bridges, dams, and roads (and railroads)
- Nautical vessels and railroad stock
- Temple & burial mounds, Kivas
- Cemeteries



WHAT MAY BE A HISTORIC LANDMARK?

A building, structure, landscape, or object that is at least 50 years old **AND**

For this survey that means it was erected before 1975

Meets at least one of the below requirements:

- Is historically, architecturally, archeologically, or culturally significant
- Is associated with events that made a significant contribution to the broad patterns of local, regional, state, or national history;
- Is associated with the lives of persons significant in our past;
- Embodies the distinctive characteristics of a type, period, or method of construction;
- Represents the work of a master designer, builder, or craftsman; or
- Represents an established and familiar visual feature of the city

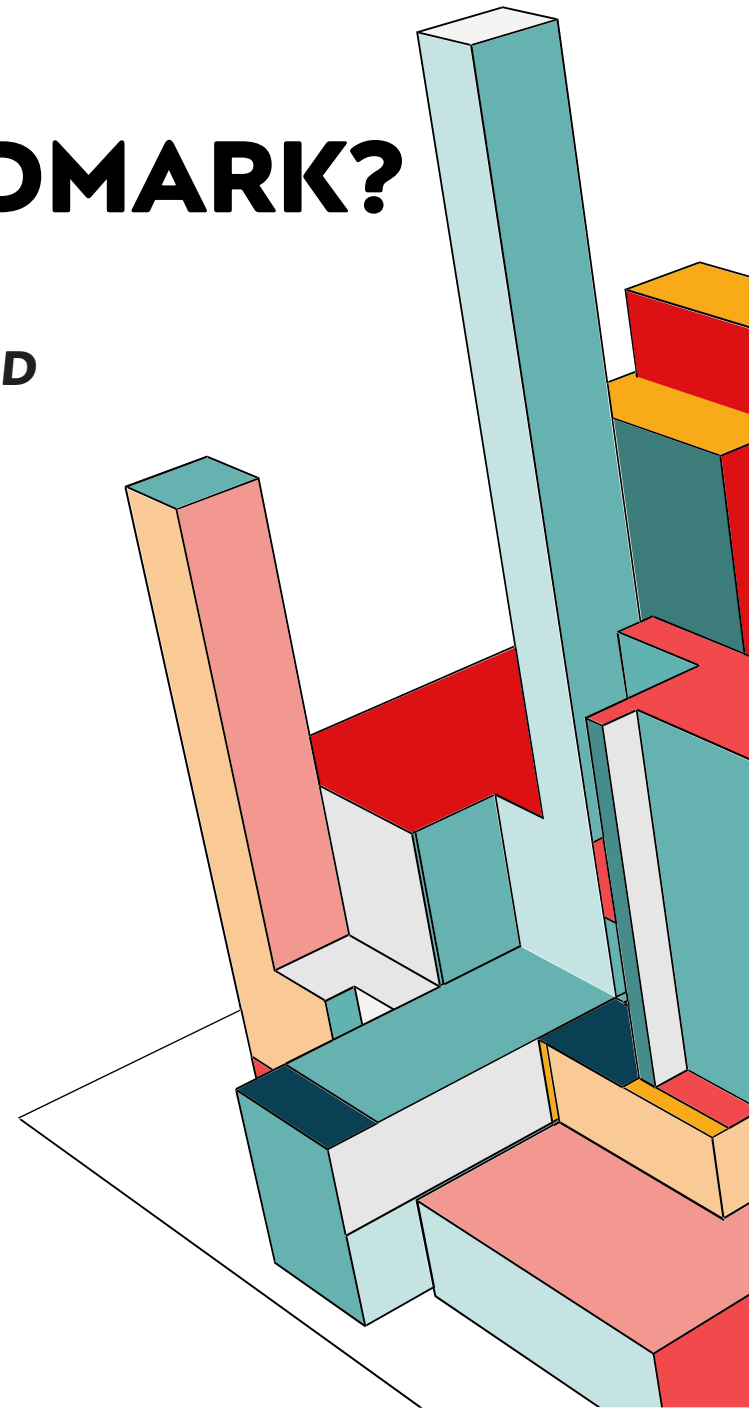

WHY SURVEY HISTORIC PROPERTIES?

Building Inventory

Taking stock of the kinds of historic buildings we have in McKinney

Identify Significant Resources

And in turn, identify areas where redevelopment could be appropriate



Informed Policy Decisions

Anticipating redevelopment pressures, planning development around historic properties

Can lead to...

National Register of Historic Places
HNIZ applications
Historic Overlay District inclusion

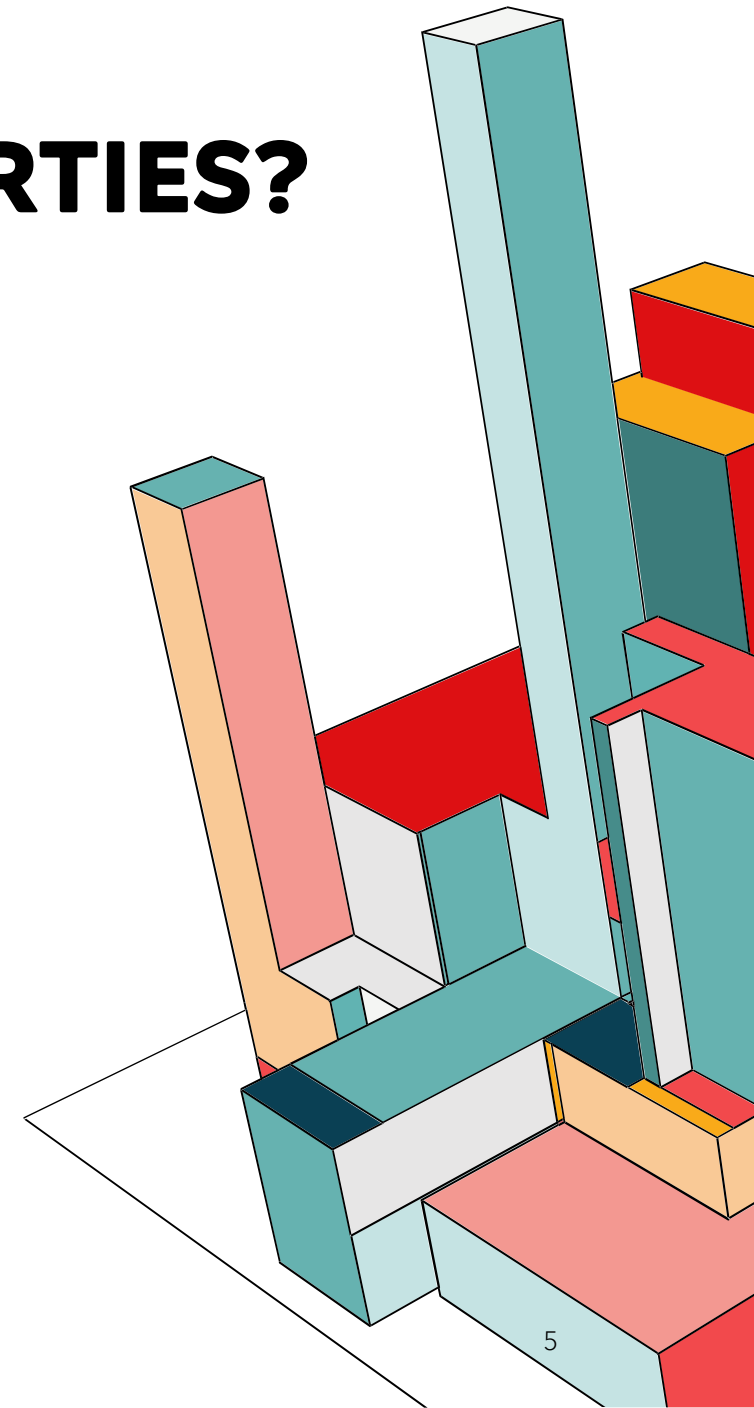

WHERE ARE WE SURVEYING?

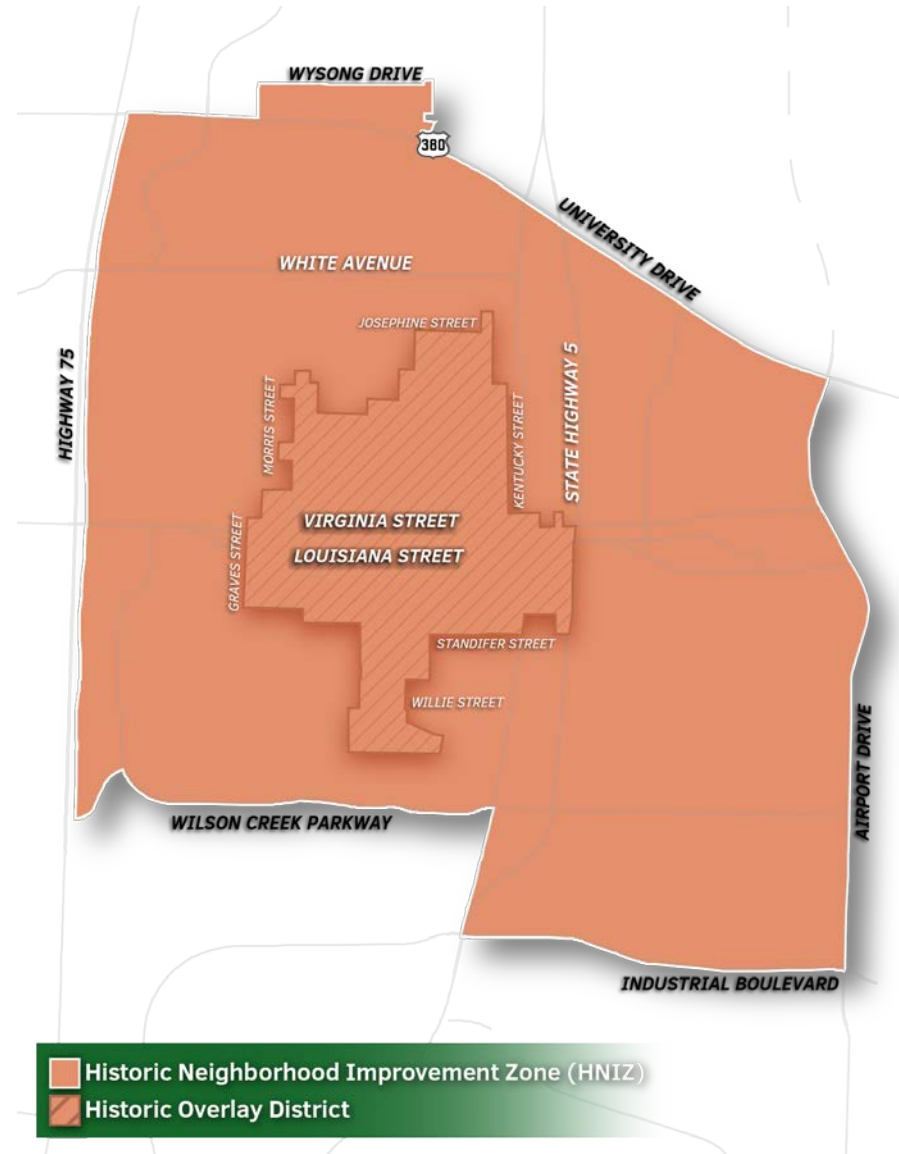

WHAT ARE WE SURVEYING?

ARCHITECTURE

- Of the home and/or structure, identifying the style, unique (character defining) features, and accessory structures
- Changes over time

SITES and OBJECTS

- Unique or significant sites and objects such as murals, sculptures, etc.

HISTORY

- Of McKinney
- Of Potentially significant properties, sites, objects

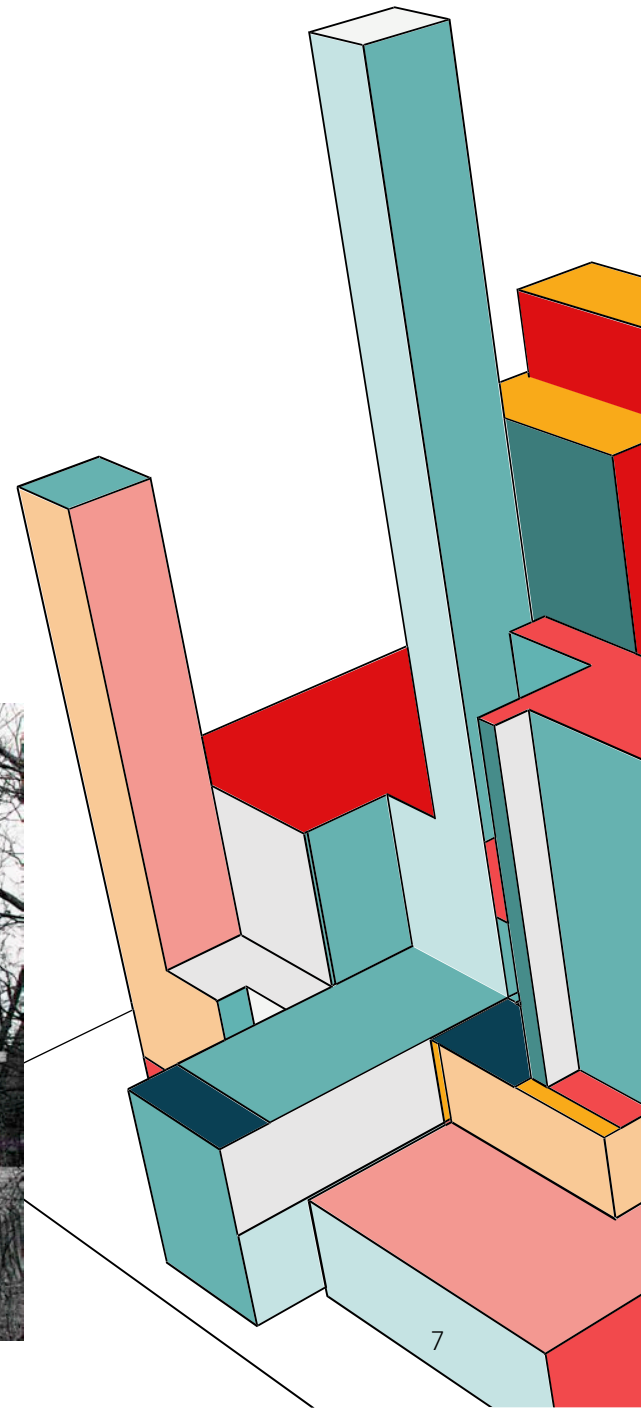

WHO IS CONDUCTING THE SURVEY?



ENVIRONMENTAL
ARCHEOLOGICAL
AND PLANNING
CONSULTANTS



Angela Gaudette
Hicks & Company
Project Manager/Lead Historian



Rick Mitchell
Mead & Hunt
Lead Historian



Elizabeth Porterfield
Burns & McDonnell
Lead Historian



Brandy Harris
Burns & McDonnell
Lead Historian



Shannon Barrientes
Hicks & Company
Data Mgmt & Public Involvement



Samantha Champion
Hicks & Company
QA/QC & Public Involvement

WHEN IS THE SURVEY HAPPENING?

(Approximate)

SUMMER 2023

Meetings with stakeholders
about survey

Survey work beginning in
neighborhoods

FALL 2023

Survey work continues

Documentation of Resources

EARLY 2024

Final Report

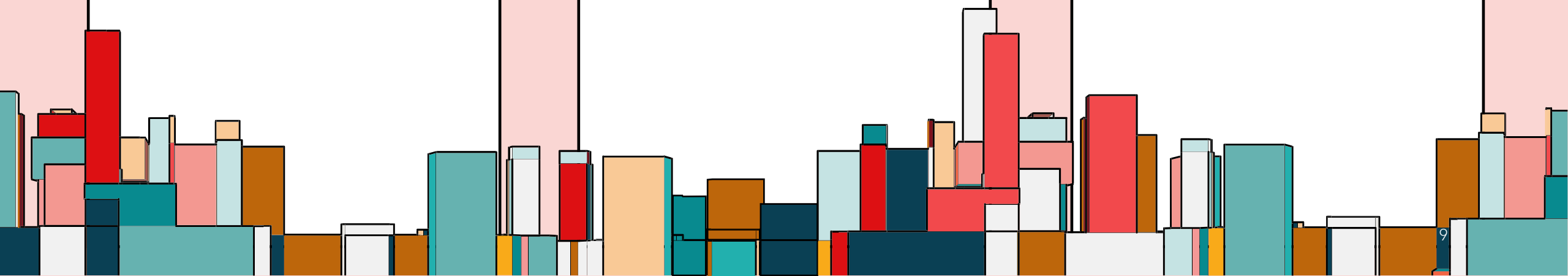

WHAT TO EXPECT

- Fieldwork
 - Photographs
 - Documentation
- Invitation to Contribute
- Report & Recommendations



A photograph of a community meeting. A woman in a light-colored coat stands on the left, holding a microphone and facing a group of people seated in rows of chairs. In the foreground, a person is seated in a blue walker, facing away from the camera towards the speaker. The room has large windows with blinds and a projector screen on the left wall. The text "BOARD & COMMUNITY FEEDBACK" is overlaid in large white letters across the center of the image.

BOARD & COMMUNITY FEEDBACK



WHAT SPACES ARE IMPORTANT TO YOU?

- Buildings
- Sites
- Objects
- Structures

WHAT PLACE BASED HISTORY CAN YOU SHARE?

The history of a place with
significance to the broad
history McKinney including:

- People
- Events
- Cultures
- Extraordinary examples
of design & construction



FINAL REPORT

- Documents the inventory
- Maps the resources
- Includes research results
- Recommends potential landmarks and districts

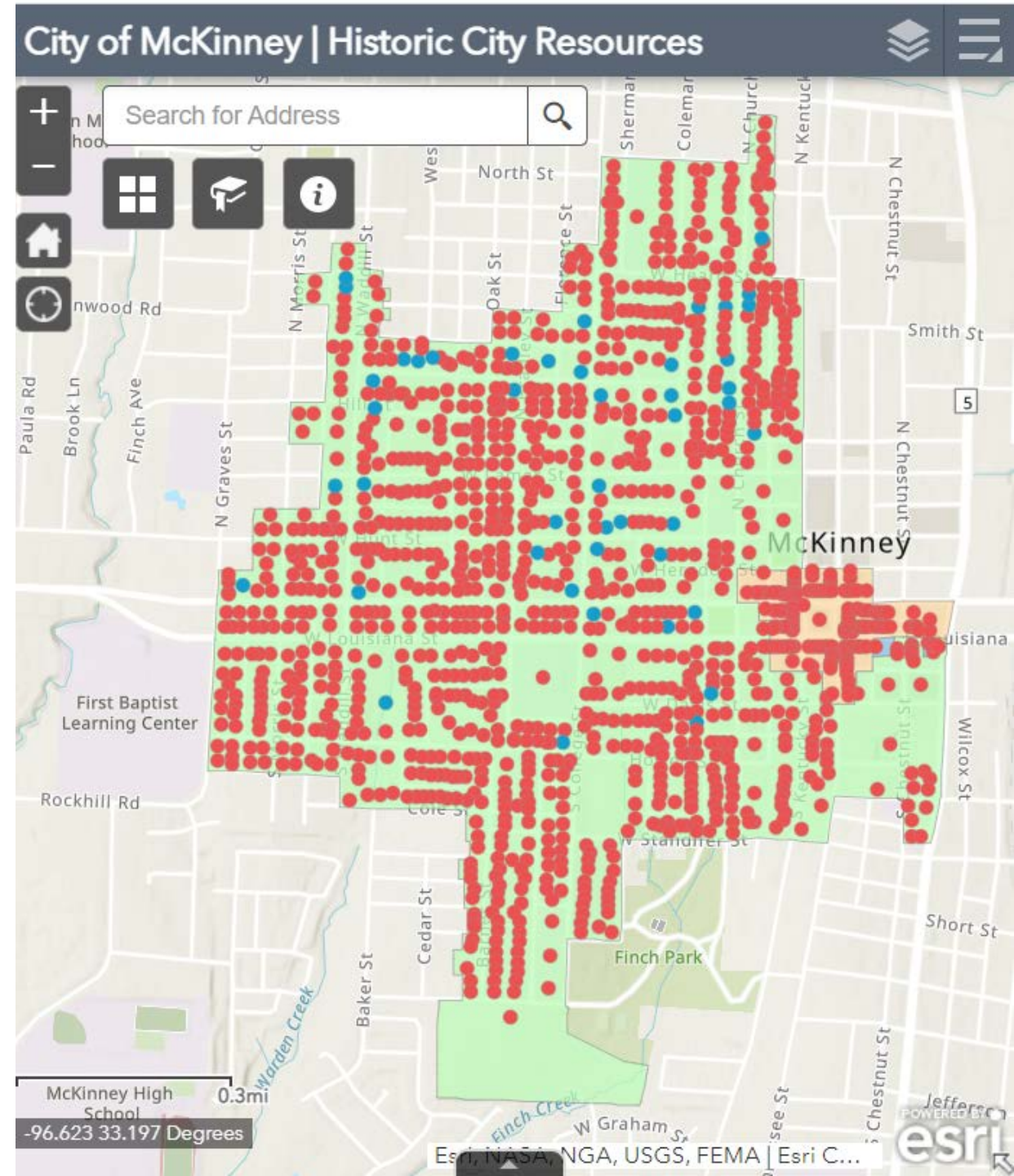



HOW TO LEARN MORE?

Contact Cassie Bumgarner,
Historic Preservation Planner,
City of McKinney

contact-planning@mckinneytexas.org // 972-547-2000