

These drawings are the sole property of Lanarc Design Inc. The use of these drawings is hereby restricted to the original site for which they were prepared. Reproduction or reuse of these drawings in whole or in part without written permission of Lanarc Design Inc. is strictly prohibited.

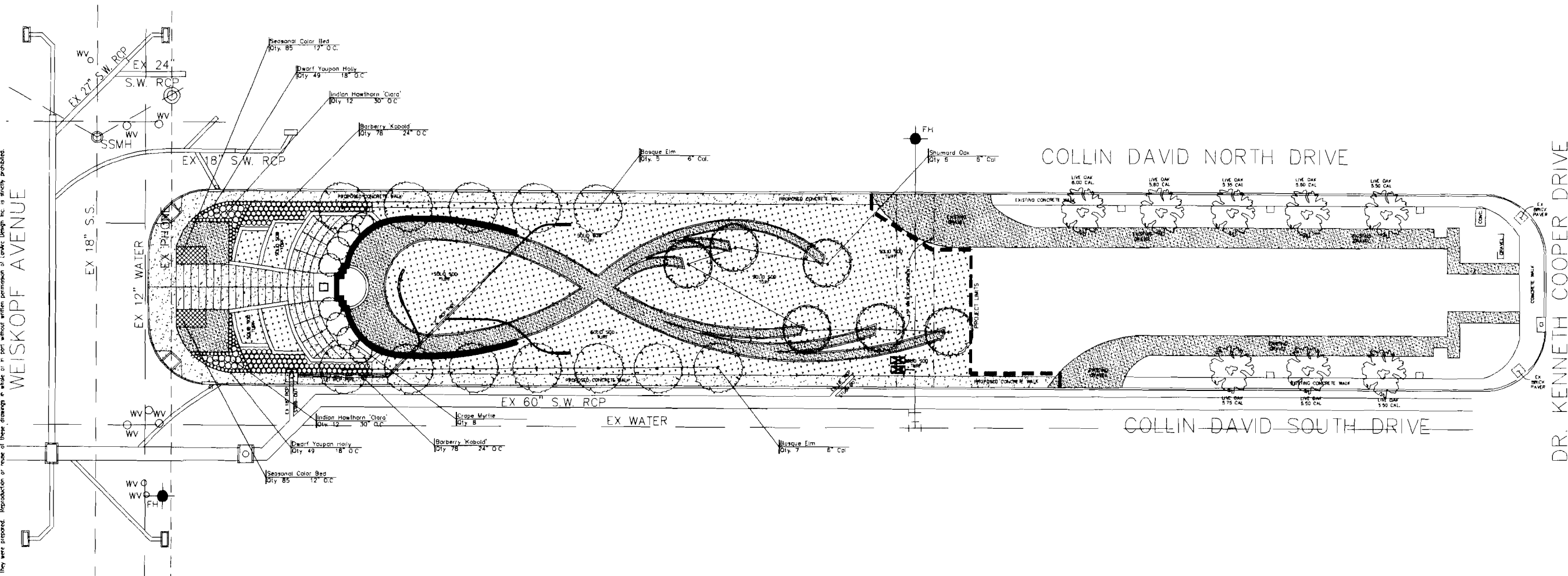

NOTES:

The Contractor shall be responsible for setting all grades, lines, and measurements necessary to the proper performance and control of the work.

The Contractor shall be responsible for filling or cutting as necessary to ensure that all portions of the site drain.

The Contractor shall verify all existing grades and site conditions by a field inspection before submitting a bid.

All logs, stones, stumps, branches, roots, rubbish or other objectionable materials discovered in the soil during the grading process shall be removed from the site by the contractor.

All materials and construction methods of the contract shall be as stated in the Standard Specifications for Public Works Construction, North Central Texas Council of Governments (NCTCOG).

Any damage to the existing street paving, curbs, or other existing elements shall be repaired at the Contractor's expense.

The Contractor shall be responsible for shooting all spot elevations necessary to construct the project.

Contractor shall determine the amount of cut and fill necessary to complete the earthwork as shown on these plans and include a fee for completion of the earthwork in the base bid. Soil shall not contain rocks 6" or larger in any dimension. The top 6" of soil shall not contain rocks larger than one-half inch (1/2") in their longest dimension.

Trees shall not be removed without the specific consent of the Owner's Project representative. The Contractor will be responsible for replacing trees removed without receiving proper approval.

The Contractor is responsible for the protection of trees, shrubs and other plant materials within the limits of work. Plants materials which are damaged shall be replaced at the Contractor's expense if the Owner's Representative determines that damage committed by the Contractor and/or his subcontractors, agents, etc precludes measures to save the plants.

The Contractor is responsible for acquiring and paying all permits and inspections from all jurisdictional agencies and corporations. The Contractor will not be required to pay permit fees to the City.

Written explanation of benchmark locations for elevational control will be provided to the Contractor prior to commencement of construction.

Upon completion of site stripping/grubbing operations, areas underlying the plaza area should be scarified a minimum of six (6) additional inches and recompacted to 95 percent of the maximum density as obtained by ASTM D-698 at or a maximum of four (4) percentage points above optimum moisture. Subgrades for these elements shall be prepared in compliance with the plans and specifications. Areas underlying fill but not underlying structures shall be scarified a minimum of six (6) additional inches and recompacted to 90 percent of the maximum density as outlined above.

The location of underground facilities indicated on the plans is taken from public records. It is the Contractor's responsibility to make arrangements with the owners of such underground facilities prior to working in the area to confirm their exact location and to determine whether any additional facilities other than those shown on the plans may be present. The Contractor shall preserve and protect all underground facilities.

The Contractor shall restore all areas disturbed by construction to original condition or better. Restored areas include, but are not limited to trench boxfill, side slopes, fences, culvert pipes, drainage ditches, driveways, private yards and roadways. All areas disturbed by construction will be turfed.

Adequate measures shall be taken to prevent erosion in the event that significant erosion occurs as a result of construction, the Contractor shall restore the eroded area to original condition.

Discrepancies, if any, should be brought to the attention of the Landscape Architect before work commences.

PLANT LIST					
QTY	SCIENTIFIC NAME	COMMON NAME	CONTAINER	CALIPER	REMARKS
12	Ulmus parviflora	Bosque Elm	B+B	8"	14'-18" Ht., 8" dbh
6	Quercus shumardii	Shumard Red Oak	B+B	6"	14'-18" Ht., 9" dbh
6	Liquidambar styraciflua 'Stanger's Pink'	Stranger's Pink Liquidambar	B+B	5 - 2"	9'-12" Ht., 7" dbh (5 copies)
158	Berberis thunbergii 'Kobold'	Kobold Japanese Barberry	5 Gal		24" O.C.
24	Rhododaphne indica 'Clara'	Indian Hawthorn 'Clara'	5 Gal		30" O.C.
98	Ilex vomitoria 'Nana'	Dwarf Yaupon Holly	3 Gal		18" O.C.
170	Seasonal Color Bed	Seasonal Color	4" Pot		12" O.C.
12,800	Cynodon dactylon	Common Bermuda Grass Sod			

NOTE:
All required canopy, shade or ornamental trees shall have their caliper inches measured 24 inches above ground level at time of planting.
All required landscape areas shall be provided with an automatic underground irrigation system with rain and freeze sensors and ET weather based controller, as required by Owner.

LANDSCAPE SUMMARY

PROPOSED SITE TREES: QTY: 18 6" CALIPER MIN TOTAL CALIPER INCHES = 108

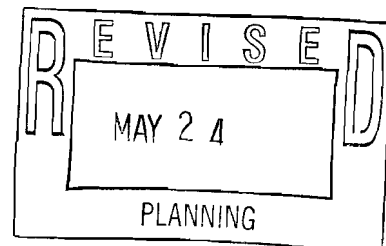

LEGEND

- COMMON BERMUDA GRASS - SOLID SOD
- SEASONAL COLOR BED
- EXISTING TREES TO REMAIN
- PROPOSED TREE



Preliminary
Review Set
Not for
Construction

LANARC DESIGN INC.
LANDSCAPE ARCHITECTURE
808 S. COLLEGE, SUITE 223
MCKINNEY, TEXAS 75069
PH: 214.733.8806 FAX: 214.733.8806

**VETERANS MEMORIAL
PARK IN MCKINNEY**

MCKINNEY
TEXAS
Unique by nature

DATE:
MAY 24, 2010

JOB:
000411-03

TITLE:
LANDSCAPE
PLAN

SHEET:
LP-1