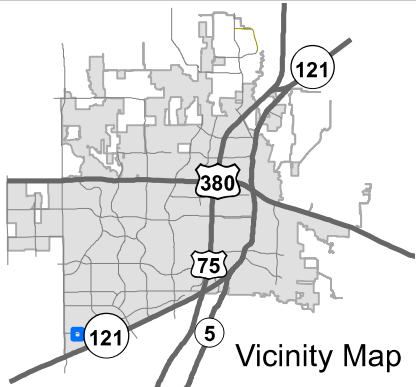
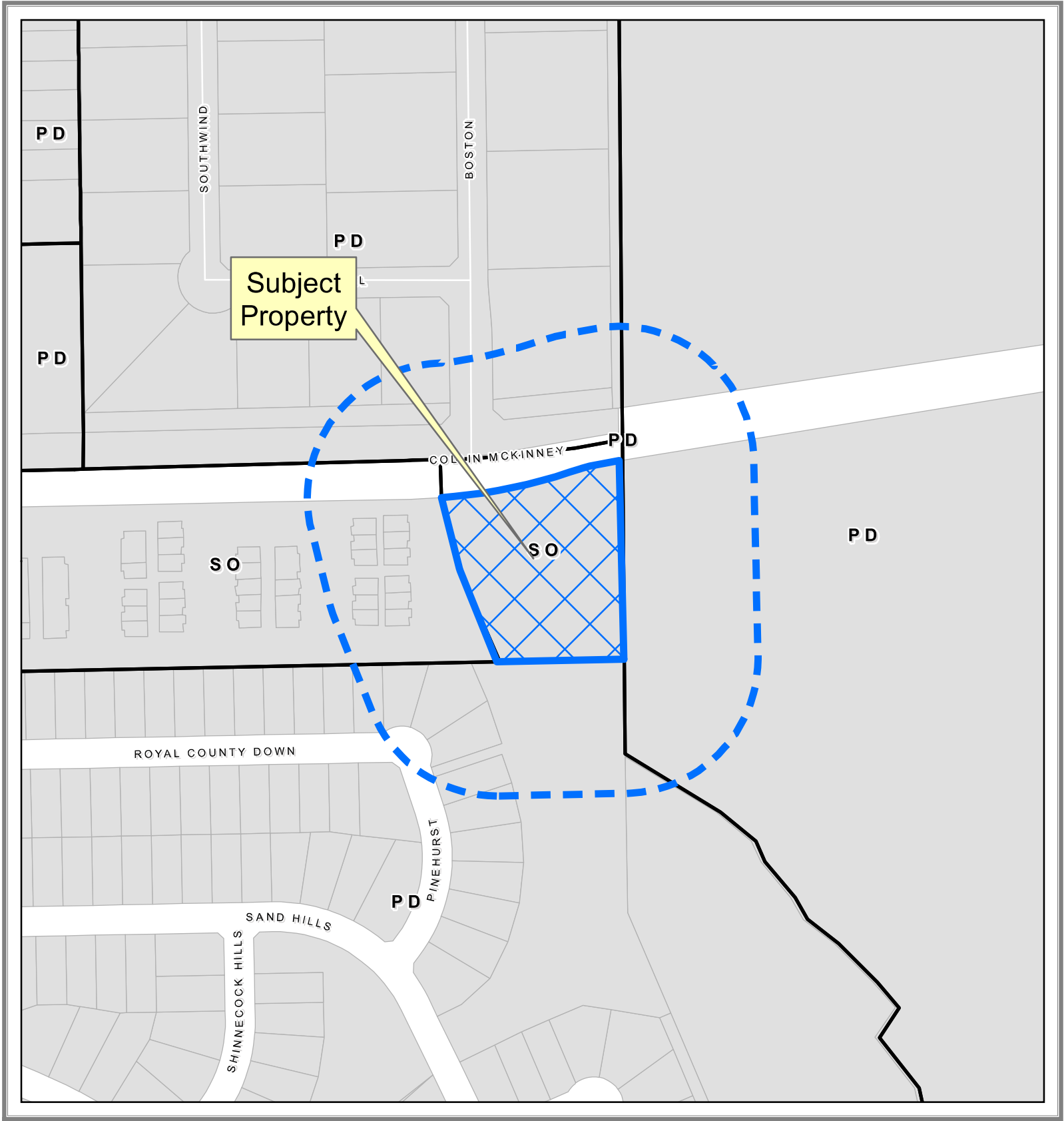

EXHIBIT A



Property Owner Notification Map

SUP2023-0009

0 100 200 Feet



DISCLAIMER: This map and information contained in it were developed exclusively for use by the City of McKinney. Any use or reliance on this map by anyone else is at that party's risk and without liability to the City of McKinney, its officials or employees for any discrepancies, errors, or variances which may exist.



EXHIBIT B

WHEREAS D.R. Horton – Texas, Ltd. Is the owner of all that tract of land in the City of McKinney, Collin County, Texas, being a part of the Henry Slack Survey, Abstract No. 840 and being a part of that 333.861 acre tract of land conveyed to D.R. Horton – Texas, Ltd. As recorded in Volume 6051. Page 44, Collin County Deed Records, and being further described as follows:

BEGINNING at a one-half inch iron rod with yellow cap stamped “JBI” found at the southwest corner of The Reserve at Westridge, Common Area S3, Block S, an addition to the City of McKinney, as recorded County Clerk’s Document Number 2012-171 Plat Records Collin County, Texas and said point being in the northerly line of Hidden Haven Drive (a 60 foot right-of-way);

THENCE Northwesterly, 452.14 feet along the northerly line if said Hidden Drive and along a curve to the right having a central angle of 18 degrees 36 minutes 00 seconds, a radius of 1,392.77 feet, a tangent of 228.08 feet, and whose chord bears North 59 degrees 03 minutes 42 seconds West, 450.16 feet to a five-eighths inch iron rod with cap stamped “TNP” found at the south corner of Lot 1, Block A, Bluestem Addition, an addition to the City of McKinney, as recorded in County Clerk’s Document Number 2018-431, Plat Records Collin County, Texas;

THENCE North 26 degrees 35 minutes 50 seconds East. 894.34 feet to a one-half inch rod with cap stamped “TNP” found at the east corner of said Lot 1, Block A and said point being in the westerly line of said The Reserve at Westridge, Common Area S3, Block S;

THENCE along the westerly line of said The Reserve at Westridge, Common Area S3, Block S as follows:

South 24 degrees 07 minutes 13 seconds East, 543.63 feet to a one-half inch iron rod with yellow cap stamped “JBI” found for corner;

South 23 degrees 50 minutes 44 seconds West, 584.89 feet to the POINT OF BEGINNING and containing 324,304 square feet or 73445 acres of land

EXHIBIT C

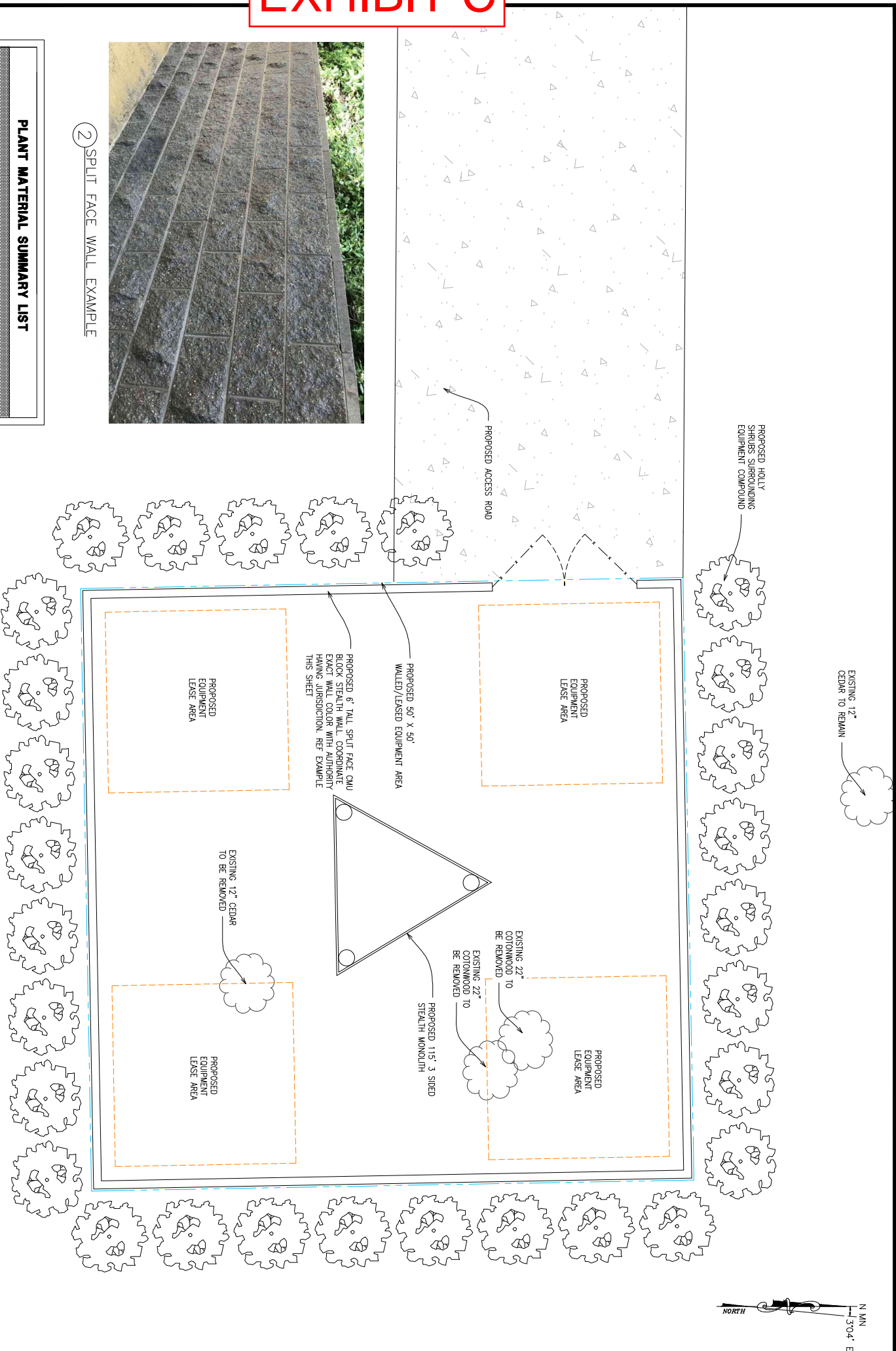

PLANT MATERIAL SUMMARY LIST			
PLANT SPECIES	SIZE	QUANTITY	DISTANCE BETWEEN PLANTS
STANDARD BURFORD HOLLY	10 GALLON	APPROX. 52	3' MIN. O.C.

② SPLIT FACE WALL EXAMPLE

[illegible]

SITE NAME
MCKINNEY

DETAIL SITE PLAN

Project number	22-XXXX
Date	07/12/2023
Drawn by	KDR
Checked by	ZG
LE.03	
Scale	

Celeris Group Consulting Engineers
605 E. Border Street
Arlington, TX 76010
Phone: 817-446-1700
Fax: 817-460-0677
www.celerisgroup.com

Engineer:
Celaris Group Consulting Engineers
605 E. Border Street
Arlington, TX 76010
Phone: 817-448-1700
Fax: 817-460-0877
Registration No.: F-13992

Registration No: F-13992

PRELIMINARY
NOT FOR CONSTRUCTION

NOT FOR CONSTRUCTION

THIS DOCUMENT IS RELEASED FOR THE PURPOSE OF INTERIM REVIEW UNDER THE AUTHORITY OF ZHENJING GUO, P.E. LICENSE # 84667. IT IS NOT TO BE USED FOR CONSTRUCTION, BIDDING OR PERMIT PURPOSES.

STAMM



Engineer:
Celins Group Consulting Engineers
605 E. Border Street
Arlington, TX 76010
Phone: 817-446-1700
Fax: 817-460-0877
Registration No.: F-13992

Registration No: F-13992

STAMP:

PRELIMINARY
NOT FOR CONSTRUCTION

THIS DOCUMENT IS RELEASED FOR THE PURPOSE
OF INTERIM REVIEW UNDER THE AUTHORITY OF
ZHENQUAN GUO, P.E. LICENSE # 84867. IT IS NOT
TO BE USED FOR CONSTRUCTION, BIDDING OR
PERMIT PURPOSES.

[illegible]

SITE NAME
MCKINNEY

TOWER ELEVATION

Project number	22-XXXX
----------------	---------

Date	07/12/2023
------	------------

Checked by ZG

Checked by ZG

LE.04

EXHIBIT C

1 TOWER ELEVATION

SCALE: (34" X 22") N.T.S.
SCALE: (17" X 11") N.T.S.

