

VENU Sunset Amphitheater Site Plan

24-0069SP

Location Map

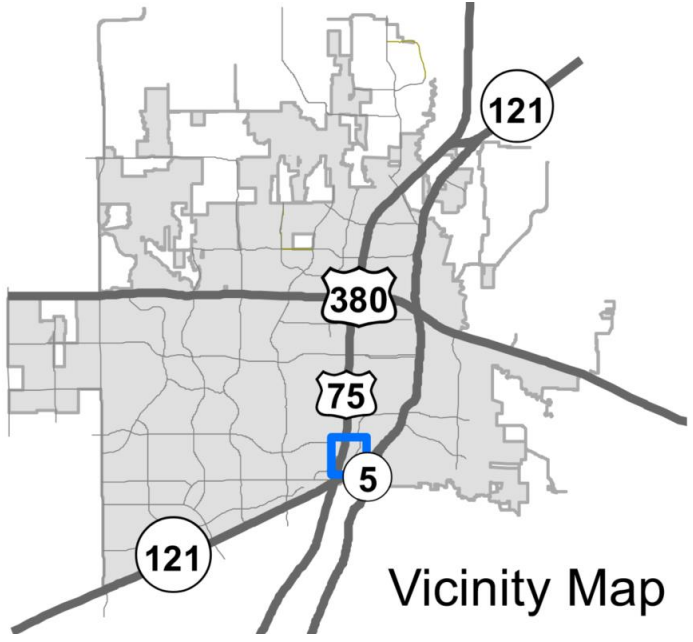

Vicinity Map

Aerial Exhibit

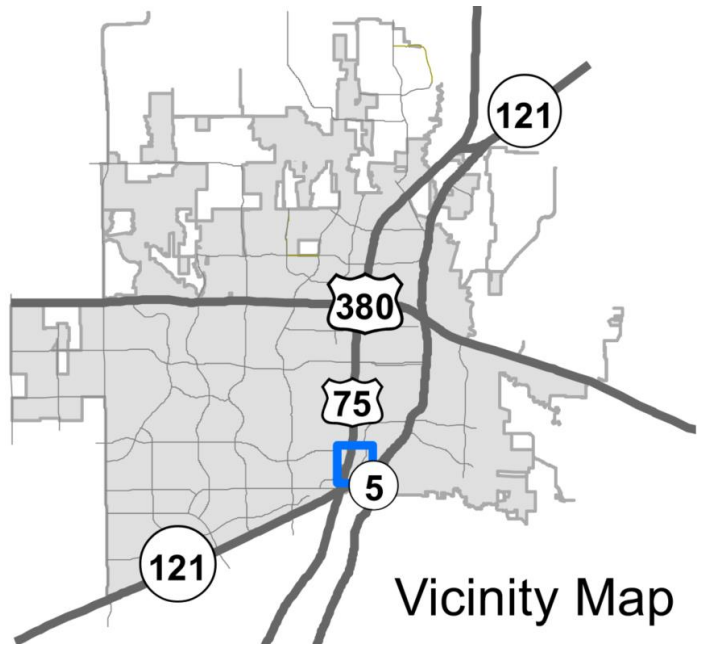

Proposed Site Plan

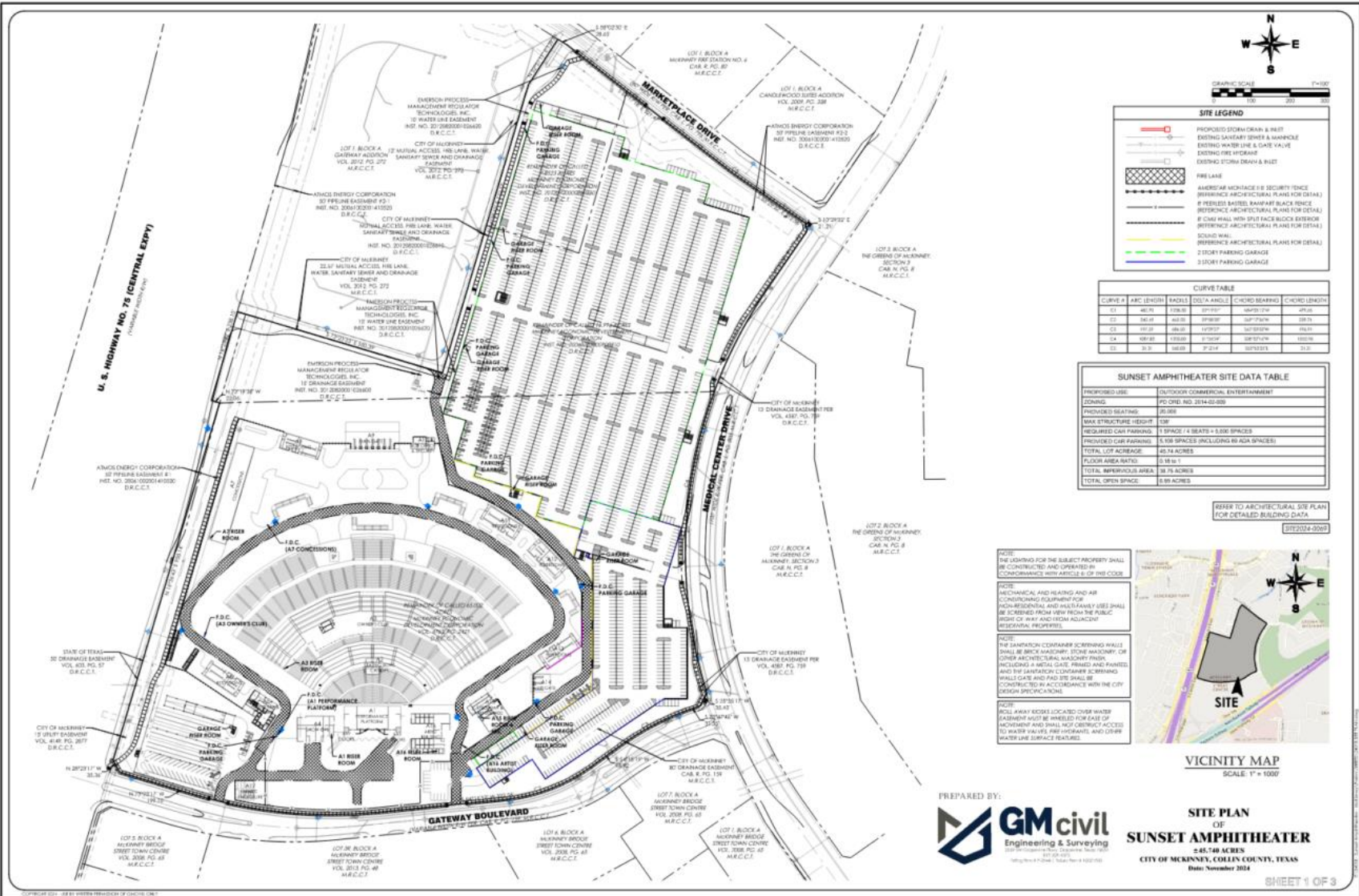

SITE LEGEND

- PROPOSED DOWN DRAIN & RISE
- EXISTING SANITARY MAIN & MANHOLE
- EXISTING WATER LINE & GATE VALVE
- EXISTING FIRE HYDRANT
- EXISTING STORM DRAIN & RISE
- FIRE LANE
- AMERICAN MACHINERY & SECURITY FENCE (REFERENCE ARCHITECTURAL PLANS FOR DETAILS)
- IF REELED BATES RAINPANT BLACK FENCE (REFERENCE ARCHITECTURAL PLANS FOR DETAILS)
- 8' CURB WALL WITH SPOT TACK BLOCK EXTERIOR (REFERENCE ARCHITECTURAL PLANS FOR DETAILS)
- SCOUR WALL (REFERENCE ARCHITECTURAL PLANS FOR DETAILS)
- 2 STORY PARKING GARAGE
- 3 STORY PARKING GARAGE

CURVE TABLE

CURVE #	ARC LENGTH	RADIUS	DELTA ANGLE	CHORD BEARING	CHORD LENGTH
01	54.00	170.00	39.000°	S47.000°E	47.00
02	54.00	400.00	39.000°	S47.000°E	100.00
03	107.00	400.00	107.000°	S47.000°E	100.00
04	107.00	170.00	71.000°	S07.000°E	100.00
05	53.50	168.00	37.500°	N07.000°E	50.00

SUNSET AMPHITHEATER SITE DATA TABLE

PROPOSED USE	OUTDOOR COMMERCIAL ENTERTAINMENT
PC DOWNSIDE	PC DOWNSIDE NO. 2014-02-020
PROPOSED SEATING	21,000
MAX STRUCTURE HEIGHT	130'
REQUIRED CAR PARKING	1 SPACE / 4 SEATS + 5.00% SPACES
PROPOSED CAR PARKING	6,100 SPACES (INCLUDING 60 ADA SPACES)
TOTAL LOT ACRES	62.74 ACRES
FLOOR AREA RATIO	0.30 IN
TOTAL IMPERVIOUS AREA	38.74 ACRES
TOTAL OPEN SPACE	0.81 ACRES

REFER TO ARCHITECTURAL SITE PLAN FOR DETAILED BUILDING DATA
 SITE2024-0009

- NOTE: THE LIGHTING FOR THE SUBJECT PROPERTY SHALL BE CONSTRUCTED AND OPERATED IN ACCORDANCE WITH ARTICLE 8 OF THIS CODE.
- NOTE: MECHANICAL AND HEATING AND AIR CONDITIONING EQUIPMENT FOR NON-RESIDENTIAL AND MULTIFAMILY USES SHALL BE SCREENED FROM VIEW FROM THE PUBLIC SIDE OF WAY AND FROM ADJACENT RESIDENTIAL PROPERTIES.
- NOTE: THE SANITATION CONTAINER SCREENING WALLS SHALL BE BRICK MASONRY, STONE MASONRY, OR OTHER ARCHITECTURAL MASONRY FINISH INCLUDING A METAL GATE, PRIME AND PAINTED, AND THE SANITATION CONTAINER SCREENING WALLS GATE AND PAD STE SHALL BE CONSTRUCTED IN ACCORDANCE WITH THE CITY DESIGN PROFESSIONAL.
- NOTE: ROLL AWAY DECKS LOCATED OVER WATER EXISTENCE MUST BE ANNELED FOR EASE OF MOVEMENT AND SHALL NOT OBSTRUCT ACCESS TO WATER VALVES, FIRE HYDRANTS, AND OTHER WATER LINE SURFACE FEATURES.



VICINITY MAP
 SCALE: 1" = 1000'

PREPARED BY:

GMcivil
 Engineering & Surveying
 2008 W. Highway 101, Suite 400, Dallas, Texas 75241
 Tel: 972.444.1111 Fax: 972.444.1112
 www.gmcivil.com

SITE PLAN
 OF
SUNSET AMPHITHEATER
 245,740 ACRES
 CITY OF MCKINNEY, COLLIN COUNTY, TEXAS
 Date: November 2024

